



**Seattle**  
Department of  
Transportation

PO Box 34996  
Seattle, WA 98124-4996

PRSRT STD  
US Postage  
PAID  
Seattle, WA  
Permit No. 2871

#### New safety enhancements are coming to Rainier Ave S!

Please call for translation: (206) 727-8697

አዳዲስ ደህንነት ማበረታቻዎች ወደ ሬይነር መንገድ እየመጡ ናቸው። ለትርጉም በሚከተለው ይደውሉ፡ (206) 727-8697

我們將在RAINIER AVE 行新的安全改進。請致電要求翻譯：(206) 727-8697

Nageenya foyyeessuun haarawaa gara Daandii Rayineer S dhufaa jira. Maaloo hiikaadhaaf bilbila: (206) 727-8697

Hagaajino ammaan cusub ayaa lagu samayn doonaa Waddada Rainier Ave S. Fadlan ka wac turjumaanida: (206) 727-8697

Próximamente: nuevas mejoras para la seguridad de la Avenida Rainier sur. Por favor, llame para servicios de traducción al: (206) 727-8697

Mga panibagong pagpabuti ukol sa inyong kaligtasan ang darating sa Rainier Ave S. Mangyaring tumawag para sa pagsasalin: (206) 727-8697

ሓደሽቲ ናይ ድሕነት መጠናኸርቲታት ናብ RAINIER AVE S ይመጽኡ ኣለው። ብኽብረትካ ኣገልግሎት ትርጉም ንምርካብ ተላፎን ደውል፡ (206) 727-8697

Các cải tiến về an toàn mới đang đến với Đại lộ Rainier Ave S. Xin gọi phiên dịch số: (206) 727-8697

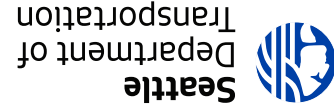

## CHANGES TO RAINIER AVE S COMING SOON!

**2019**

Change the street layout in sections and improve intersections to address crash patterns

**2020**

Complete the new street layout within the remaining project area to improve safety and bus reliability

## RAINIER IMPROVEMENTS - PHASE 2

### Improving safety and keeping buses moving on Rainier Ave S

#### WHY?

Rainier Ave S is the top corridor for crashes in Seattle. We're working to make it safer for everyone. In 2014, we launched a collaborative process to improve Rainier as part of Seattle's Vision Zero program to reach zero traffic fatalities and serious injuries by 2030. During Phase 1, we redesigned the street between S Alaska St and S Kenny St and successfully improved safety. This year and next year we'll complete Phase 2 between S Kenny St and S Henderson St.

#### WHAT'S NEXT?

In 2017, we asked for your feedback on potential changes. The top themes we heard were support for improving safety and keeping buses moving.

After reviewing community feedback, working with our partners at King County Metro, and conducting traffic modeling, we're building improvements at every major intersection (see map) this year. We're also phasing in a new street layout this year in sections and throughout the whole project area next year (see below).

#### WHAT WILL THE STREET LOOK LIKE?

The street layout concept typically includes a parking lane (either on the west or east side of the street), one driving lane in each direction, center turn lane, and bus lanes. **We're maintaining about 70% of the parking, but some sections will include a bus lane in place of the parking lane.** We're reaching out to adjacent neighbors to get input on changes to the street layout.

#### THANK YOU FOR YOUR INPUT!

Outreach included over 1,200 survey responses in multiple languages, dozens of meetings with residents and business groups, and attendance at various community events.

We're continuing to engage adjacent businesses and residents by going door-to-door and meeting with community groups. Contact us to learn more!

**RainierAveS@seattle.gov | (206) 727-8697**  
[www.seattle.gov/visionzero/projects/rainier-ave-s](http://www.seattle.gov/visionzero/projects/rainier-ave-s)

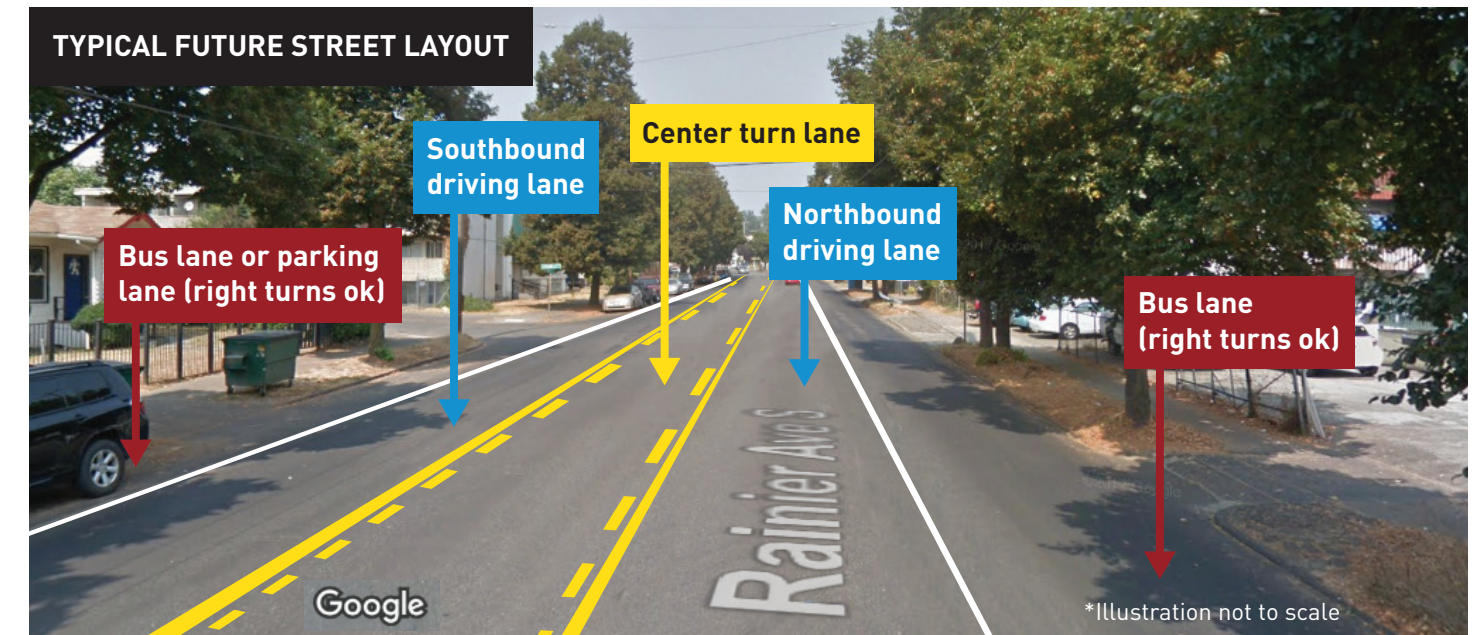

#### WHY REDUCE THE NUMBER OF TRAVEL LANES?

Reducing the number of general purpose travel lanes has been proven to reduce speeding – a key factor in the frequency and severity of crashes.

Adding a center turn lane will improve business and neighborhood access and adding bus lanes will keep buses moving. We'll closely monitor speeds and vehicle counts on and near the project area and make changes as needed.

# 2019 SAFETY & BUS IMPROVEMENTS

## What are these changes for?

We studied the crash patterns at all major intersections. These improvements are designed to slow down drivers, keep buses moving, and make it easier to walk across Rainier.

## How do I read the map?

The orange numbers on the project map correspond with the zoomed-in intersection maps. The purple arrows show where we're changing the street layout this year. We'll complete the new street layout within the whole project area next year.

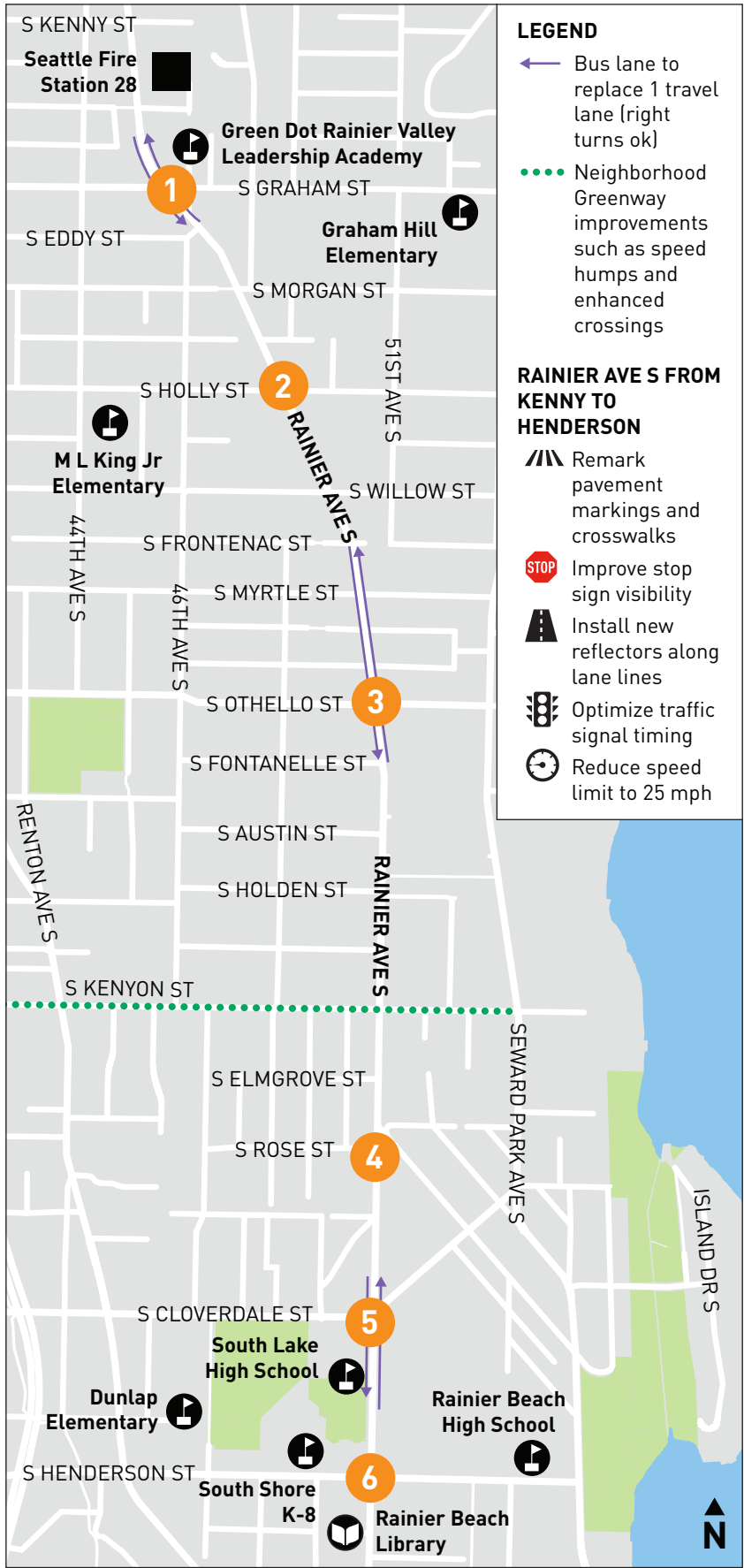

### 1 Rainier & Graham Safe Routes to School

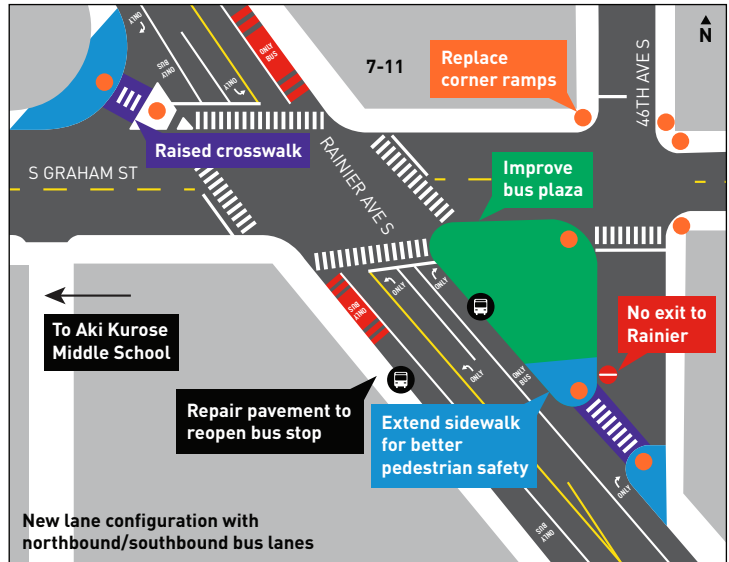

### 2 Rainier & Holly

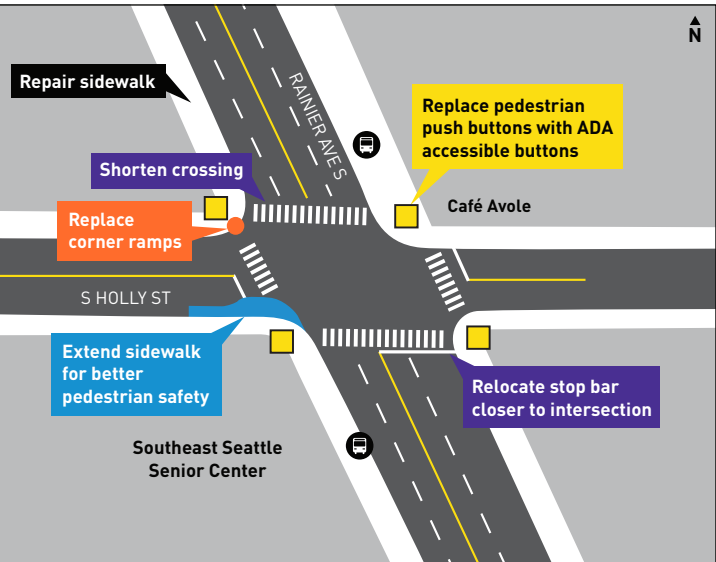

### 3 Rainier & Othello

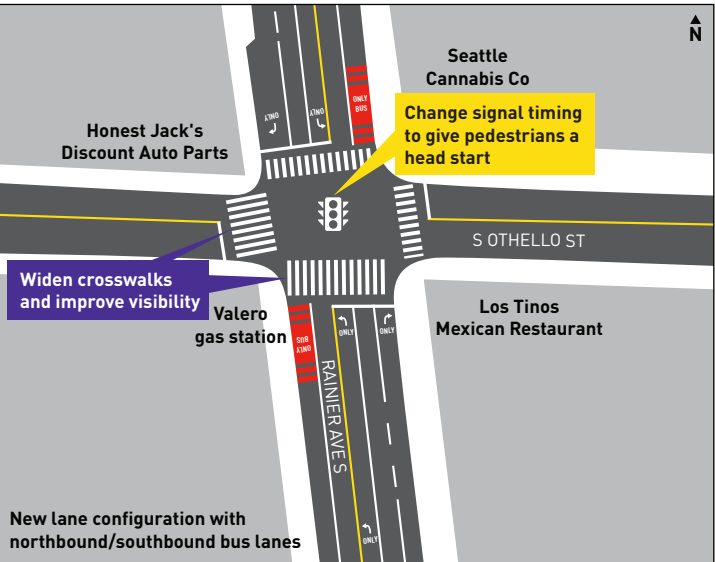

### 4 Rainier & Rose

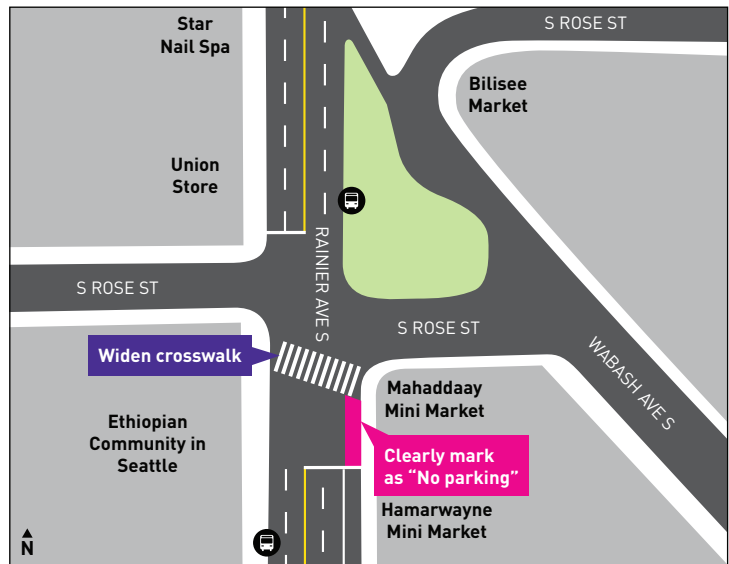

### 5 Rainier & Cloverdale

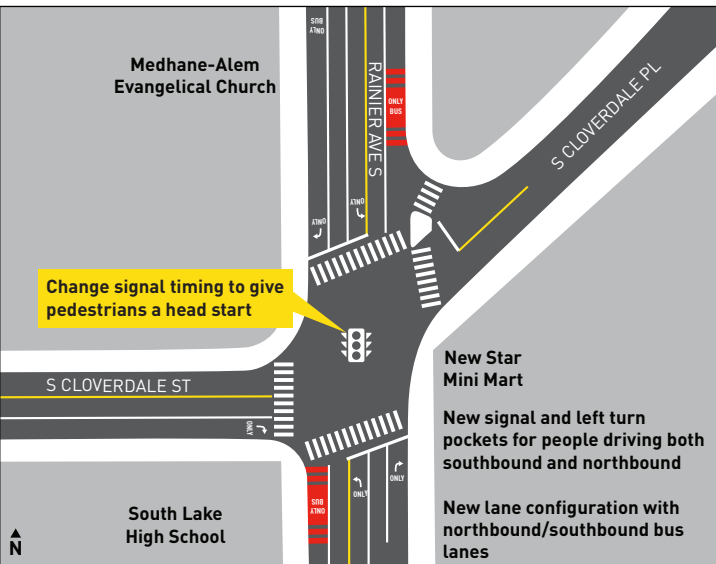

### 6 Rainier & Henderson

