

LOCAL ACCESS DURING CONSTRUCTION

May 2018 through Summer 2019 (project construction through early 2020; access changes for bridge ramp work)

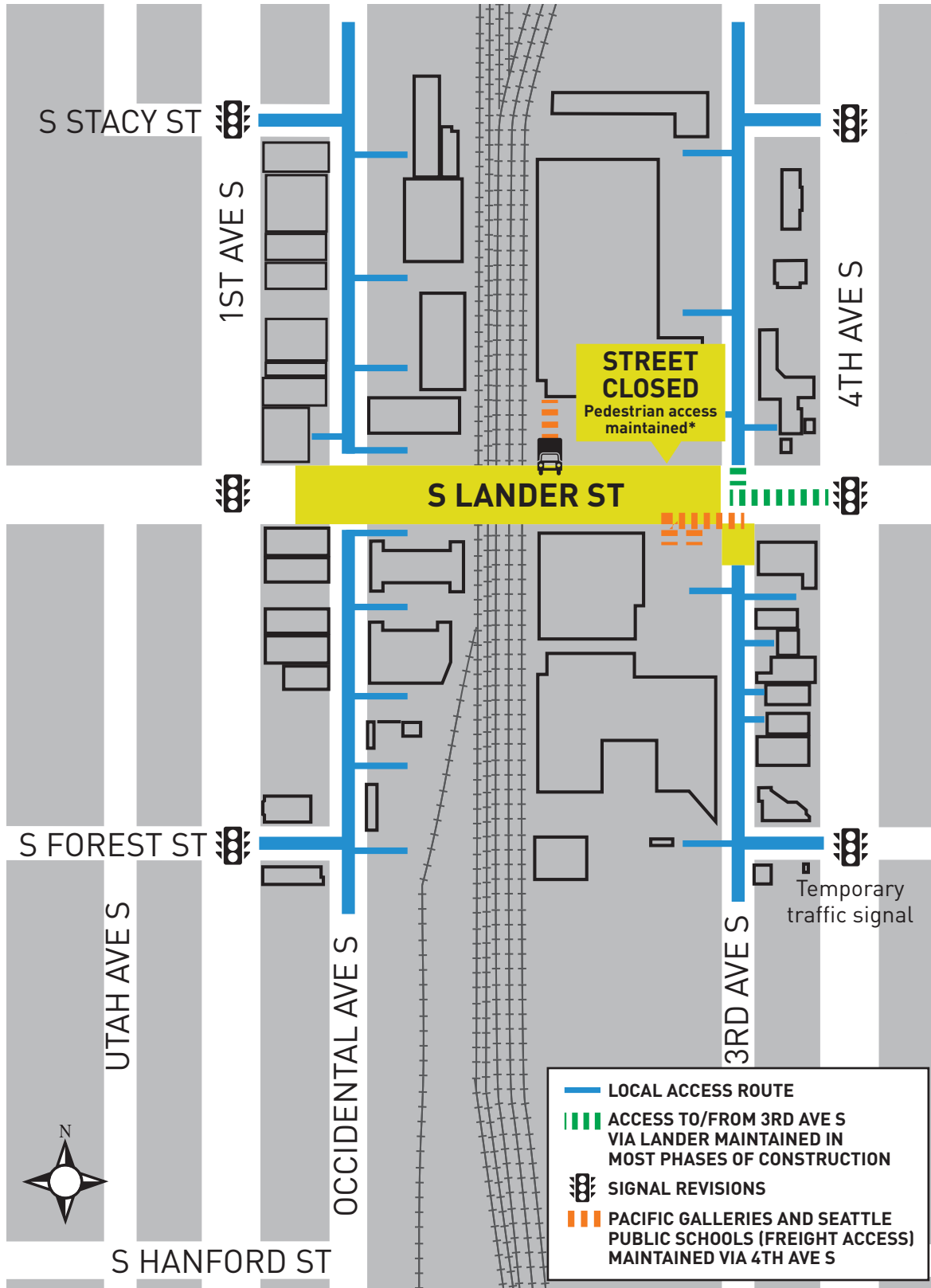

*Pedestrian access will be maintained across Lander St throughout construction
See S Lander St detour map on other side

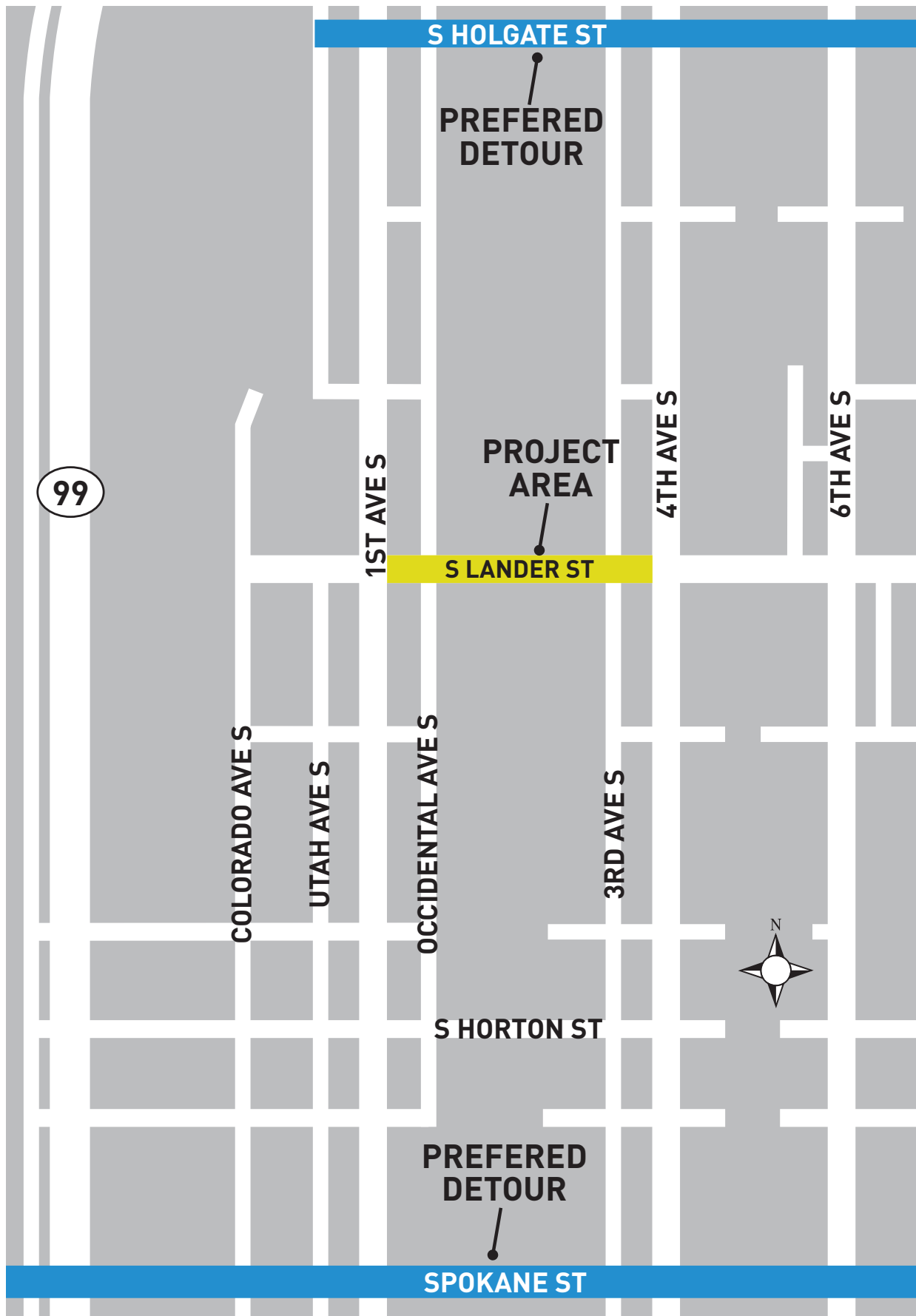

LANDER ST BRIDGE

www.seattle.gov/transportation/lander_bridge.htm

MAY 2018



Seattle
Department of
Transportation