

# Vision Zero 12 Ave S

## International Special Review District Board



# Presentation overview

- Evolution of the Vision Zero 12 Ave S project
- Project Details
- Proposed Schedule and Construction Coordination



# VZ 12 Ave S project origins

## Vision Zero Project Goals

- Install safety enhancements for people walking and biking at S King, S Weller St and S Charles St
- Reduce speeds of vehicular traffic on 12th Ave S at the Jose Rizal Bridge
- Improve the walking and bicycle connections along and across 12th Ave S

## Bicycle Master Plan Project Goals

- Create an all-ages-and-abilities bicycle facility between the S King St Neighborhood Greenway and the Mountains to Sound/I-90 Trail

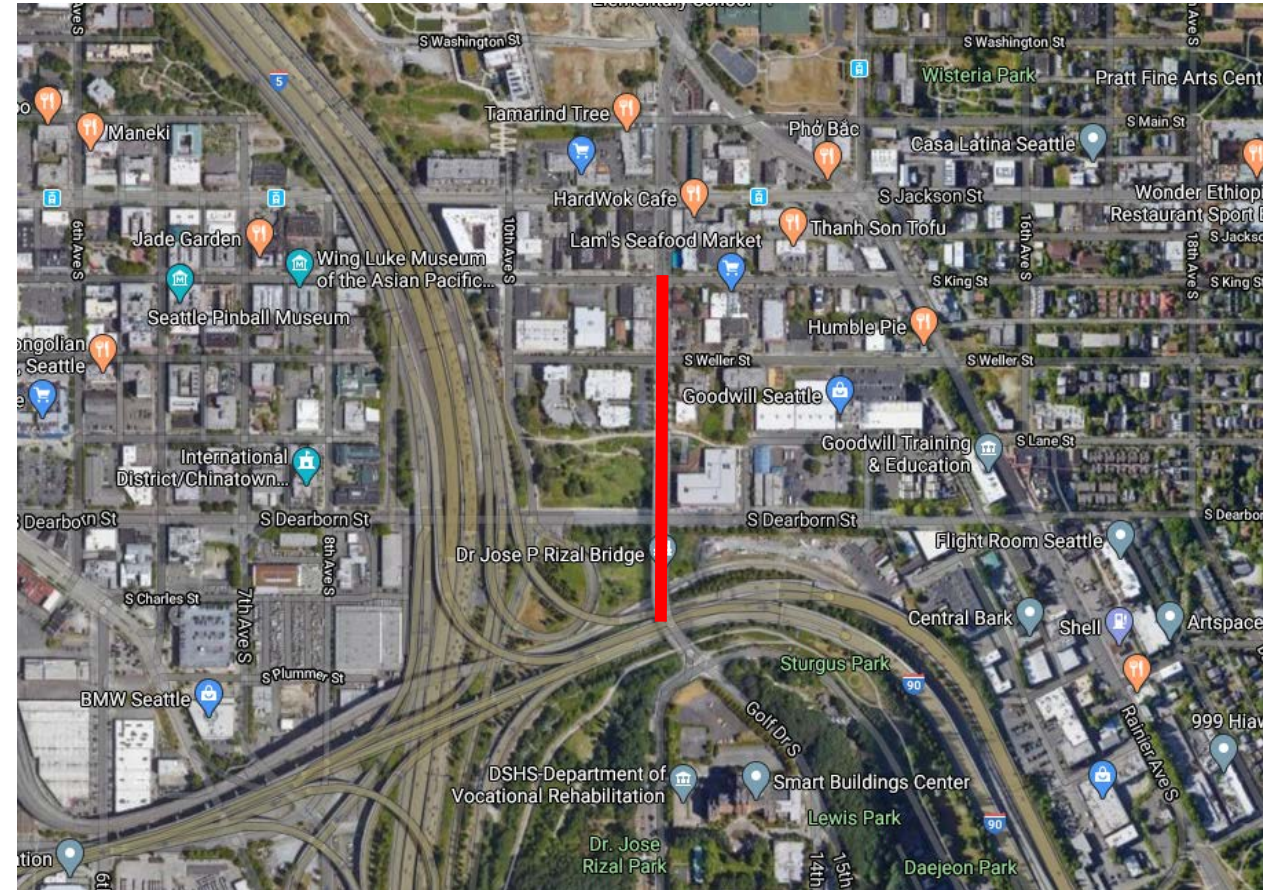



# Safety Focus

- This corridor was prioritized because:
  - High number of pedestrian and bicycle collisions
  - High motor vehicle speeds on the Jose Rizal Bridge
- 34 crashes between 1/1/2004 and 9/1/2018 (10 bicyclists, 14 pedestrians)
- Special focus on S Weller St (19 crashes)



*12 Ave S and S  
Weller St,  
looking south*

# Project Components

Safety: Curb bulbs and protected left turn lane at S Weller St

Protected Bike Lane: S King St to S Charles St to connect Mountains to Sound trail and S King St Neighborhood Greenway

- Signs, markings, posts and a bicycle counter on 12 Ave S

Neighborhood Greenway improvements: 12 Ave S and S King St intersection

- Raised crosswalk on west leg of intersection
- Curb bulbs onto S King St

Pedestrian lighting: installed at locations around Little Saigon

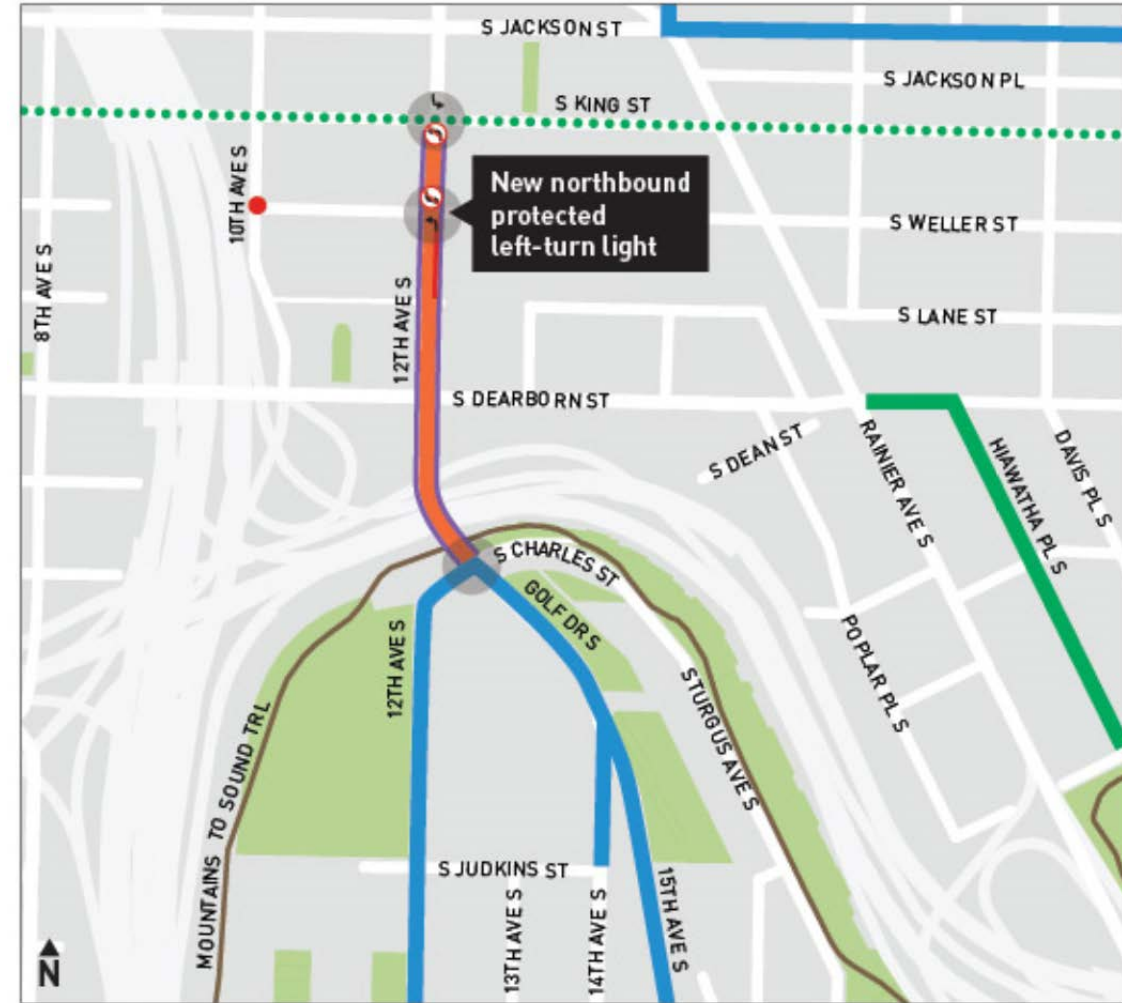

# Design Development: original design

- Northbound and south protected left turns at S Weller St
- Two-way Protected Bike Lane on east side of 12 Ave S

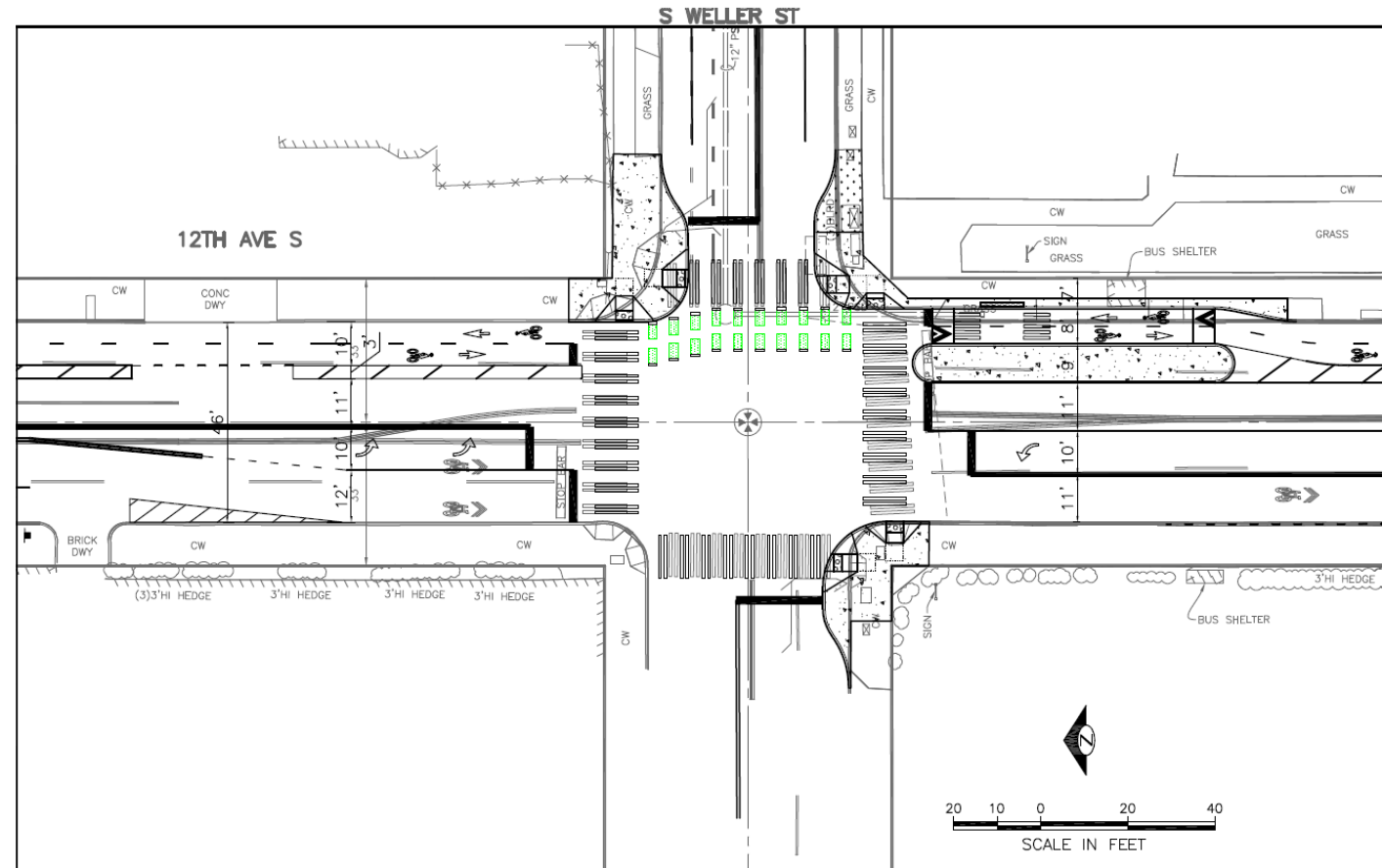

# Design Development: revised design

- Northbound and south protected left turns at S Weller St
- One-way Protected Bike Lanes on each side of 12 Ave S
- Shared bus stop/bike lane

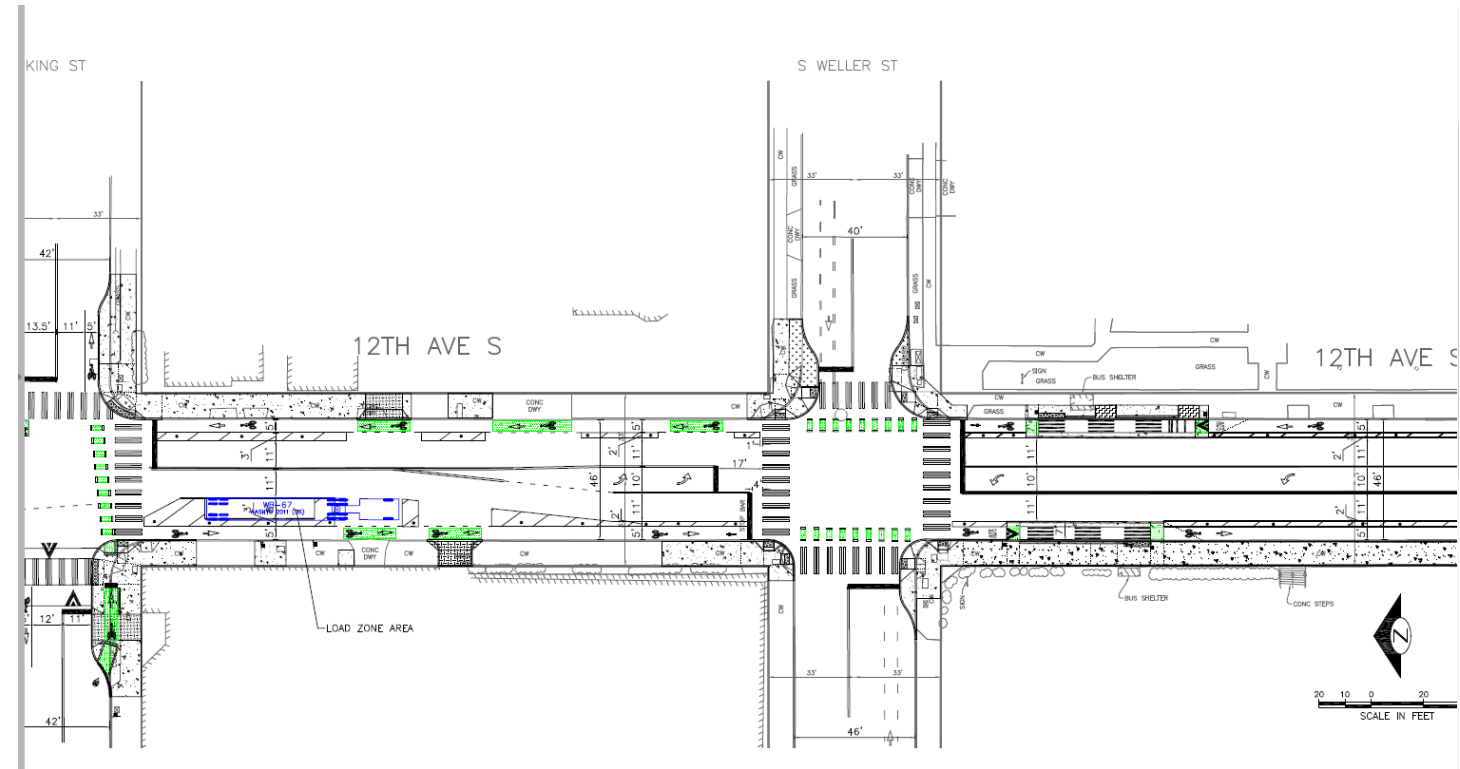
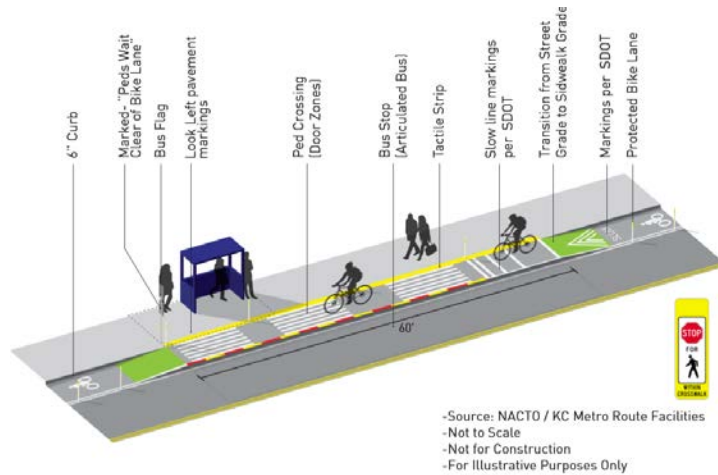



# Design Development: final design

- Northbound protected left turns at S Weller St
- Southbound left turn restricted at S Weller St
- One-way Protected Bike Lanes on each side of 12 Ave S
- Shared bus stop/bike lane
- Load zone maintained on west side of 12 Ave S
- New wayfinding signs

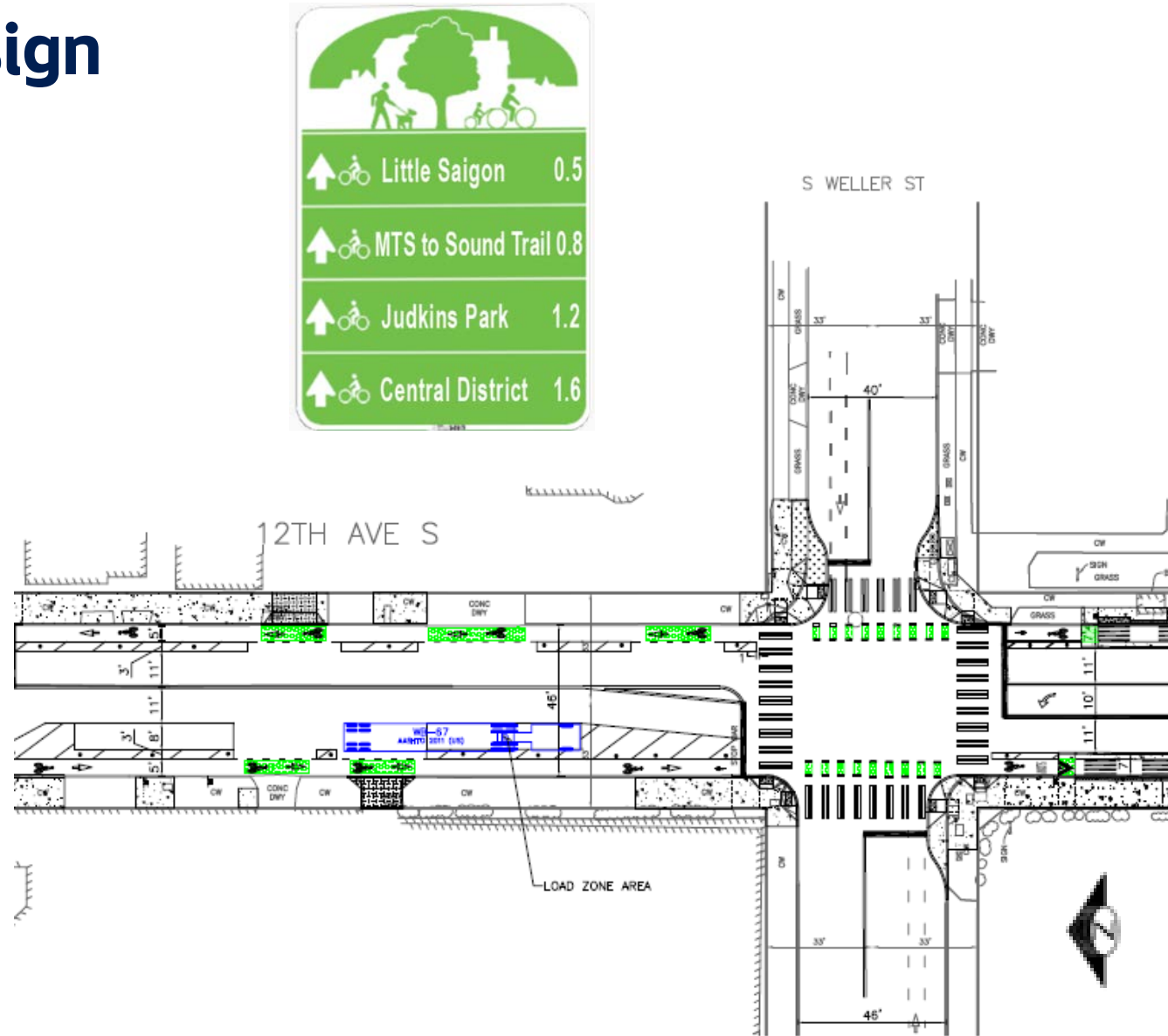



# Final Design maintains these community priorities

- Bus stops maintained at S Weller St
- Loading zone maintained on west side of 12 Ave S between S King & S Weller
- Southbound left turn at S King St
- Northbound left turn at S Weller St

Makes several changes to access:

- No northbound left turn at S King St
- No southbound left turn at S Weller St
- Legal distance maintained at corners (no parking within 20 feet)

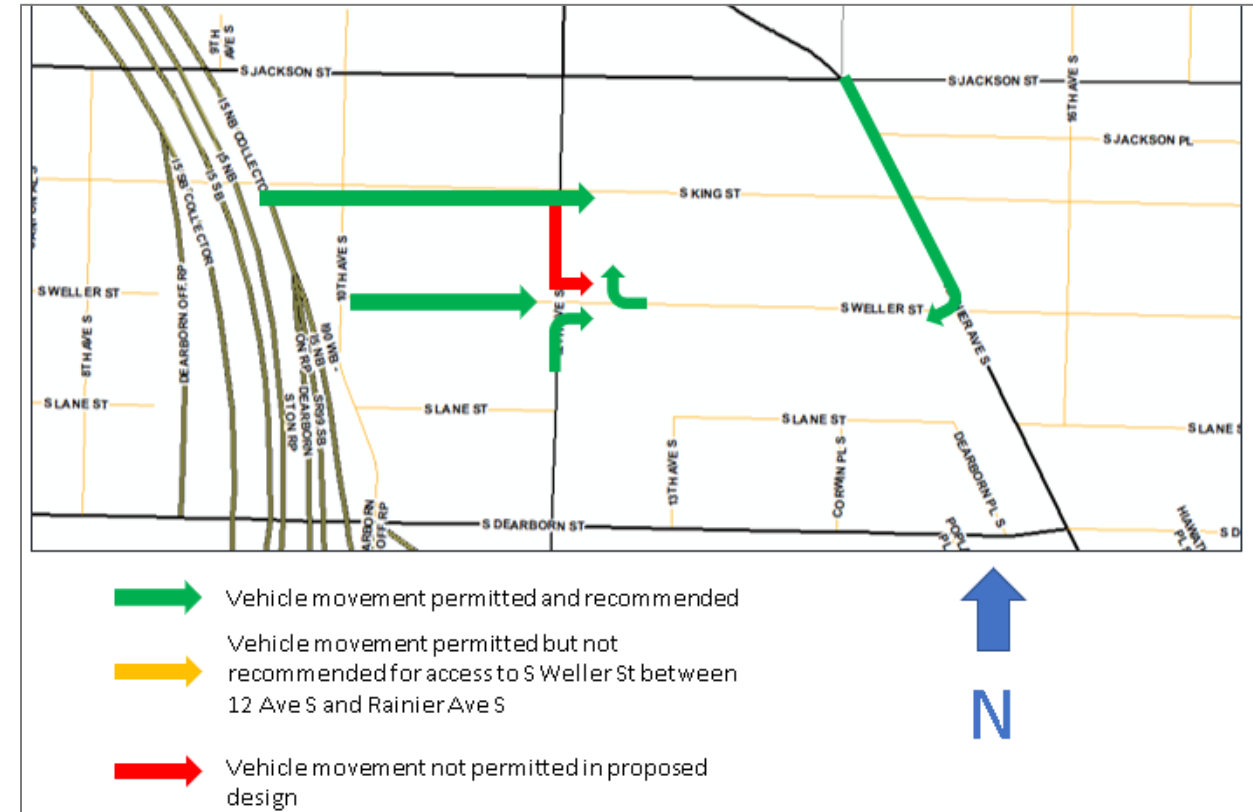

# 12 Ave S and S King St Neighborhood Greenway Design

- Continues S King St Neighborhood Greenway work started in 2019
- Provides bicycle crossings of 12 Ave S on S King St
- Adds Lead Pedestrian Interval at traffic signal
- Constructs raised crosswalk on west side of intersection and curb bulbs onto S King St



*Rendering of S King St and 12 Ave S, looking east*

# Pedestrian Lighting in Little Saigon

- Initial design for 14 pedestrian lights on S King St under I-5
- Revised design prompted by Seattle City Light project to brighten existing lights
- New pedestrian light locations:
  - S King St west of 10 Ave S (2 lights)
  - West side of 12 Ave S between S Weller St and S Lane St
  - 12 Ave S between S King St and S Weller St

## Priority locations not included in this final design:

- S King St at new park/Nisei Veteran's Hall (lack of space, very expensive)
- East side of 12 Ave S between S Weller St and S Lane St (Pearl Warren Building future development by SISC will impact sidewalk)



# Public outreach and concerns addressed

Twelve stakeholder meetings held August 2018 – October 2019

Public open house held fall 2019

## Main concerns:

- Safety
- Traffic flow on 12 Ave S
- Parking
- Load zones/business access
- Retain existing bus stops at S Weller St





# Corridor images - proposed project



Jose Rizal Bridge, looking south



10 Ave S and S Weller St – looking north

# Corridor images – proposed project

## 12 Ave S between S Weller St and S Lane St

### South end of block



West side of 12 Ave S



East side of 12 Ave S



# Corridor images – proposed project

## 12 Ave S between S Weller St and S Lane St

### North end of block



West side of 12 Ave S



East side of 12 Ave S

# Corridor images - proposed project

## 12 Ave S between S King St and S Weller St

### South end of block



West side of 12 Ave S



East side of 12 Ave S



# Corridor images – proposed project

## 12 Ave S between S King St and S Weller St

### North end of block



West side of 12 Ave S



East side of 12 Ave S

# Corridor images - proposed project

## 12 Ave S and S King St



Northeast corner of 12 Ave S and S King St



Northwest corner of 12 Ave S and S King St



# Construction timeline and approach

We will work with our contractor to stage construction in a way that keeps businesses operating and customer access a priority.

- Weekly updates
- After-hours contact when work could impact business access
- Work coordinated whenever possible to be less of an impact

If approved by ISRD tonight, construction would start in September 2020. Construction expected to last five months. May require suspension for pavement marking weather and coordination with Lunar New Year moratorium.

# Questions?

megan.hoyt@seattle.gov | (206) 255-8615

ching.chan@seattle.gov | (206) 615-0786

<https://www.seattle.gov/transportation/projects-and-programs/safety-first/vision-zero/projects/12th-ave-s>

[www.seattle.gov/transportation](http://www.seattle.gov/transportation)

