



Urban Forestry Commission

Seattle Tree Loss

The Good

The Bad

The Ugly

David Moehring, AIA NCARB



Urban Forestry Commission

Seattle Tree Loss

The Good

The Bad

The Ugly





Before

After

2000 NW 61st
Street and
6105 20th Ave
NW



Seattle Tree Canopy - An Important Resource for All

4 NW 61st St



2017

6111

20th Ave NW

2020

2014

2008

2010

6109

6107

6105

2006

2004

2000

1770

2000 NW 61st Street and 6105 20th Ave NW NW 61st St

Seattle Tree Canopy - An Important Resource for All

Before / During

After



2030 and 2042
NW 62nd Street₆



Urban Forestry Commission

Seattle Tree Loss

The Good

The Bad

The Ugly

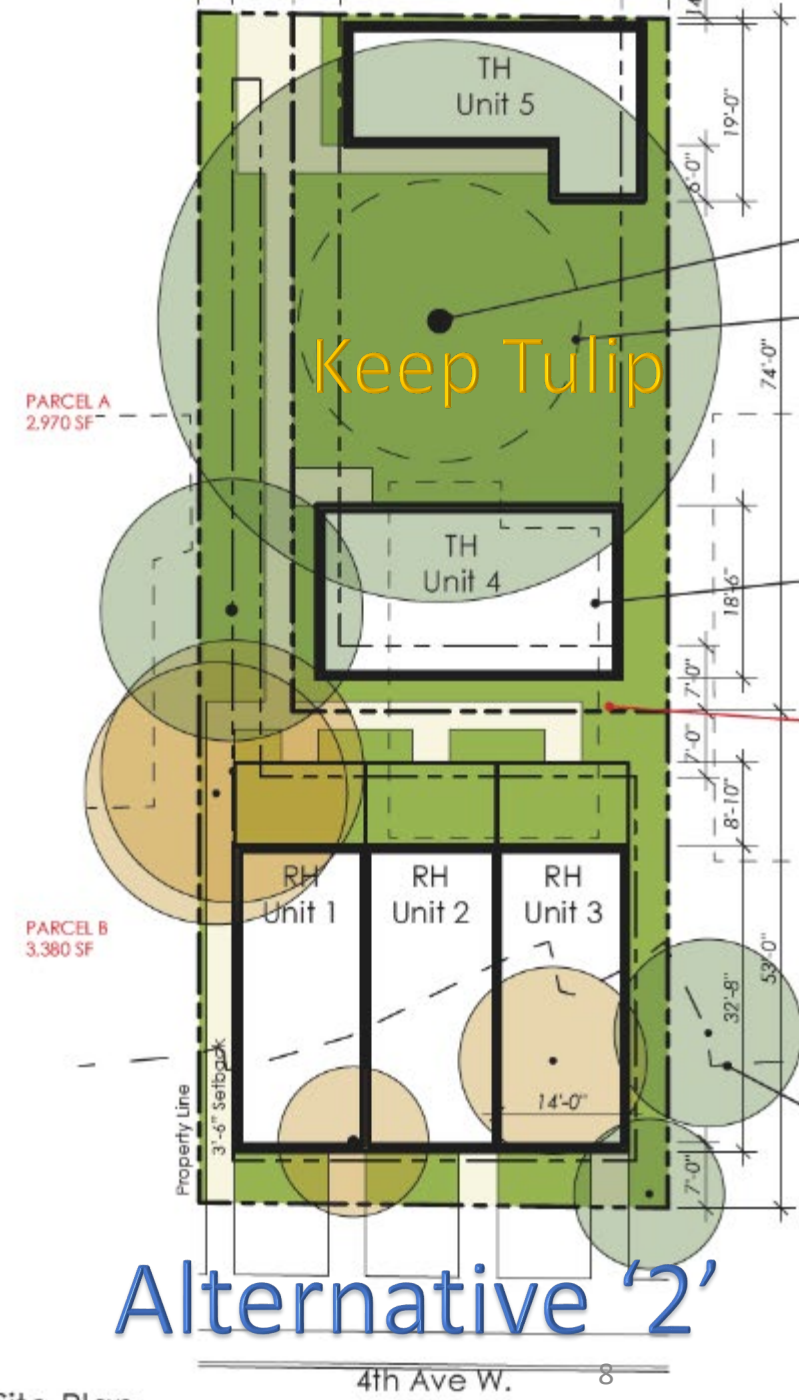
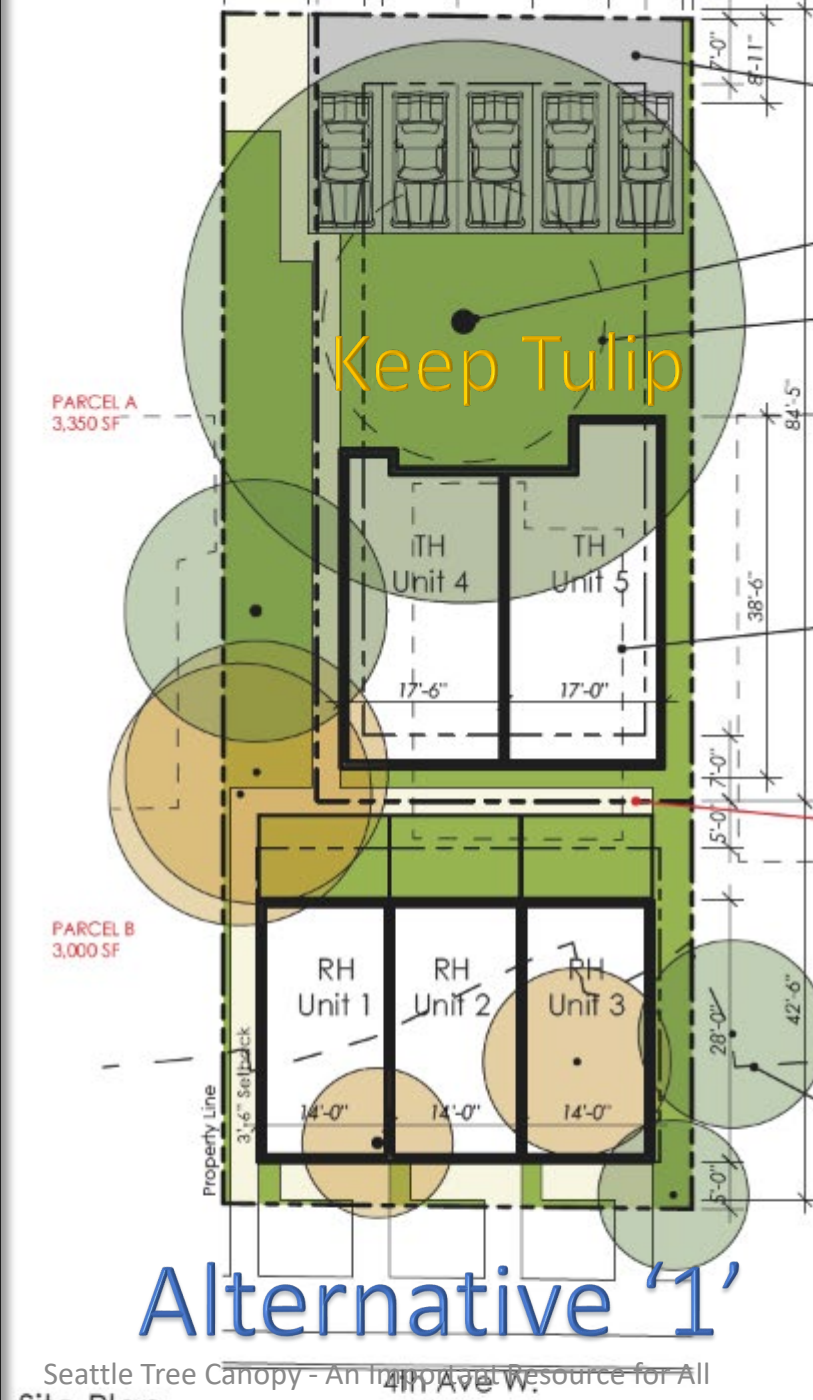
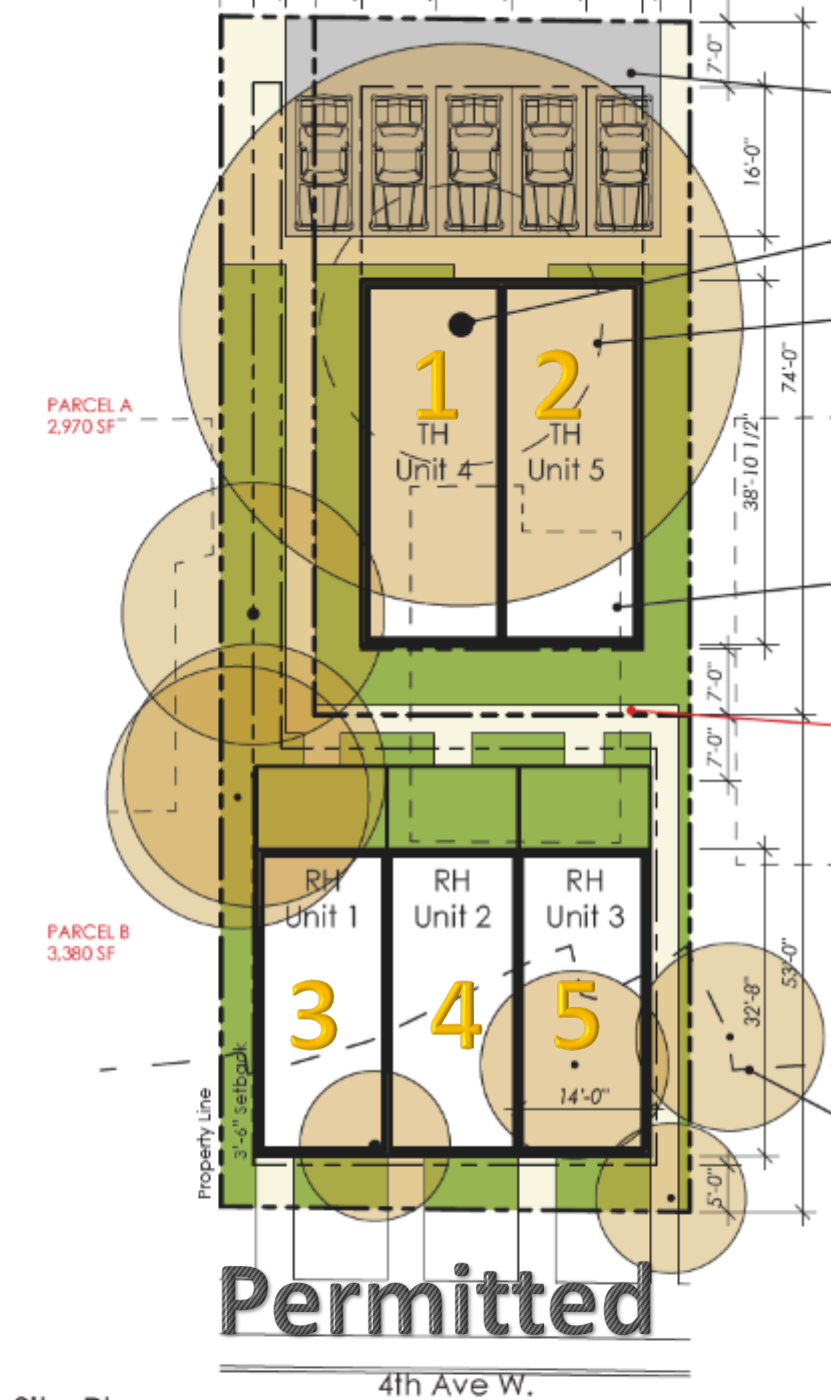

Seattle Tree Canopy - An Important Resource for All

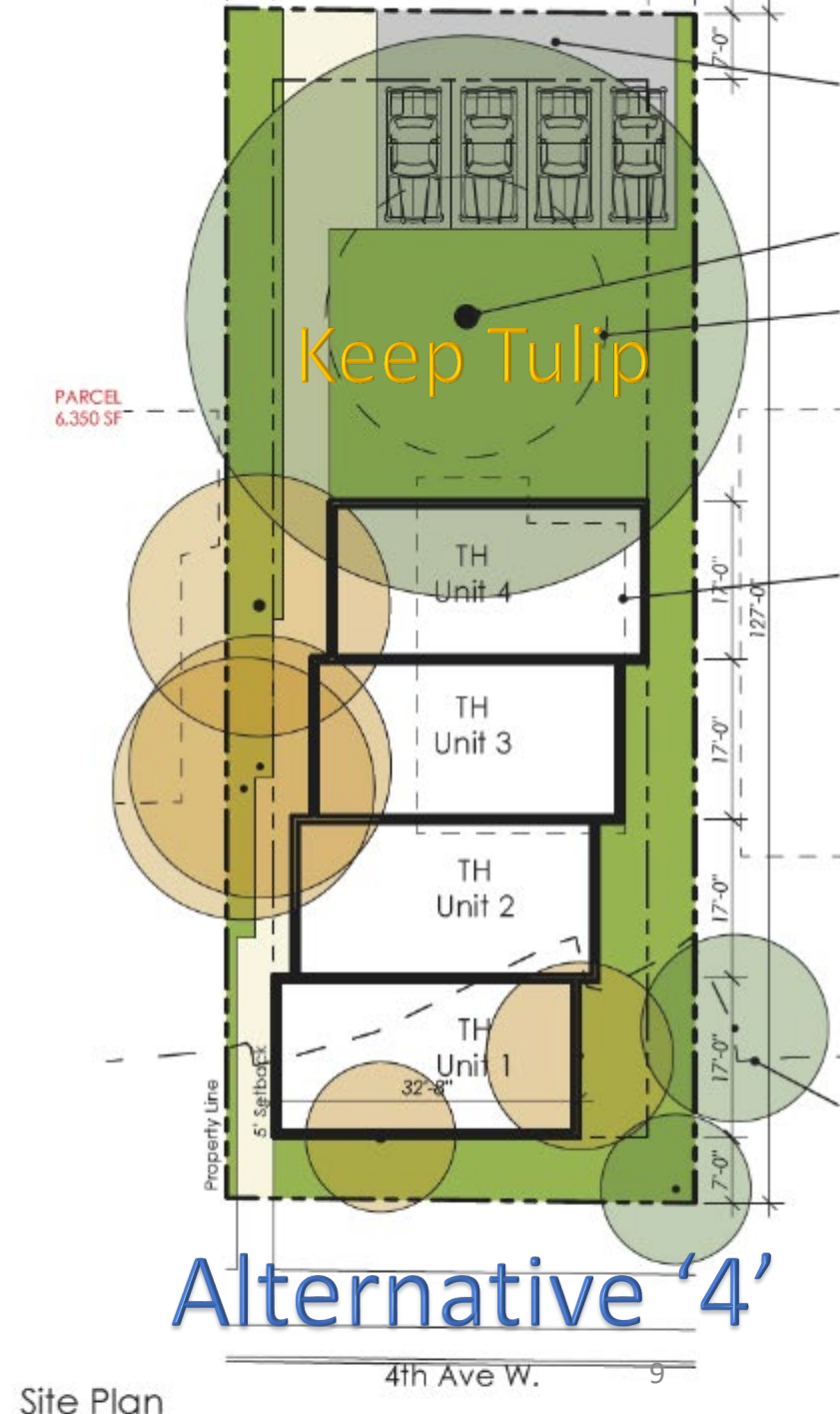
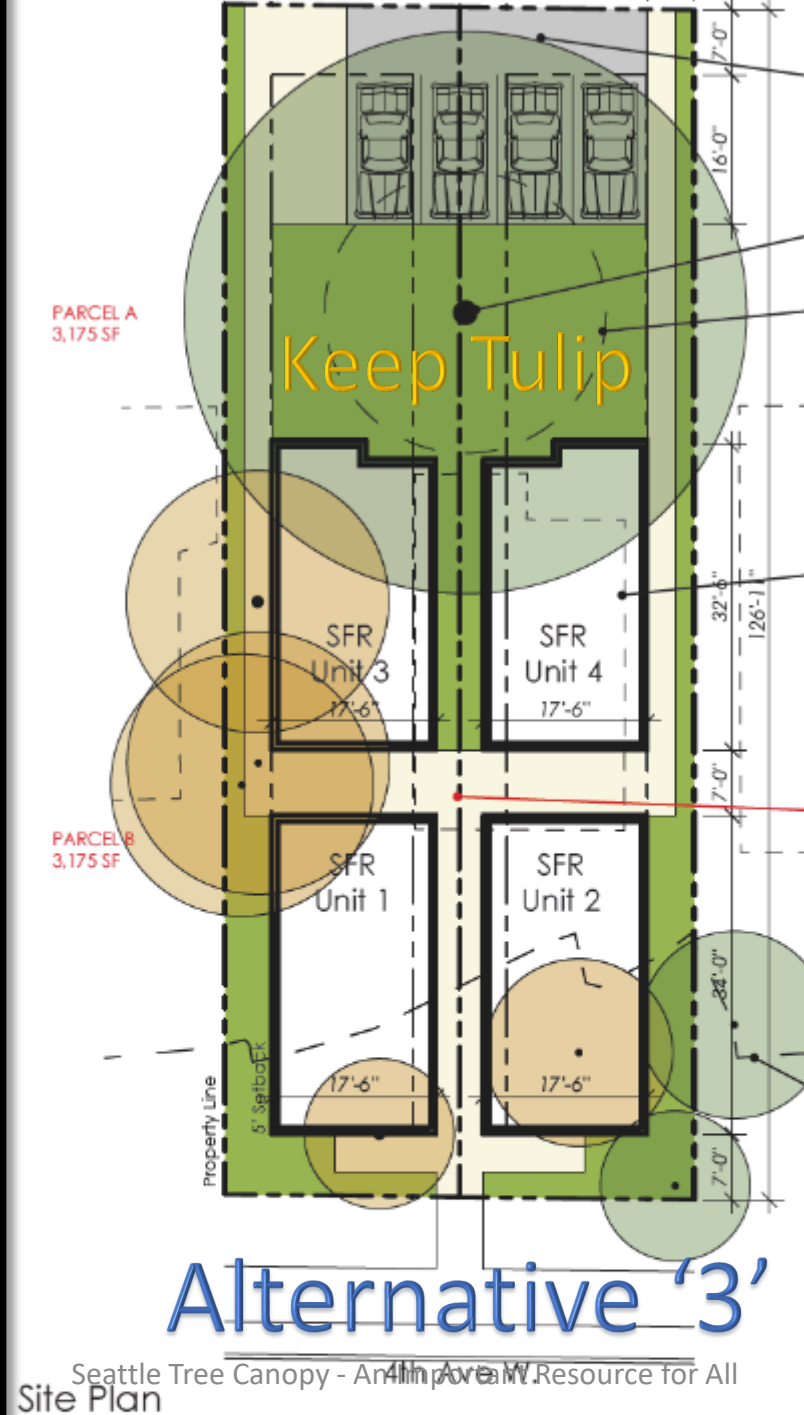
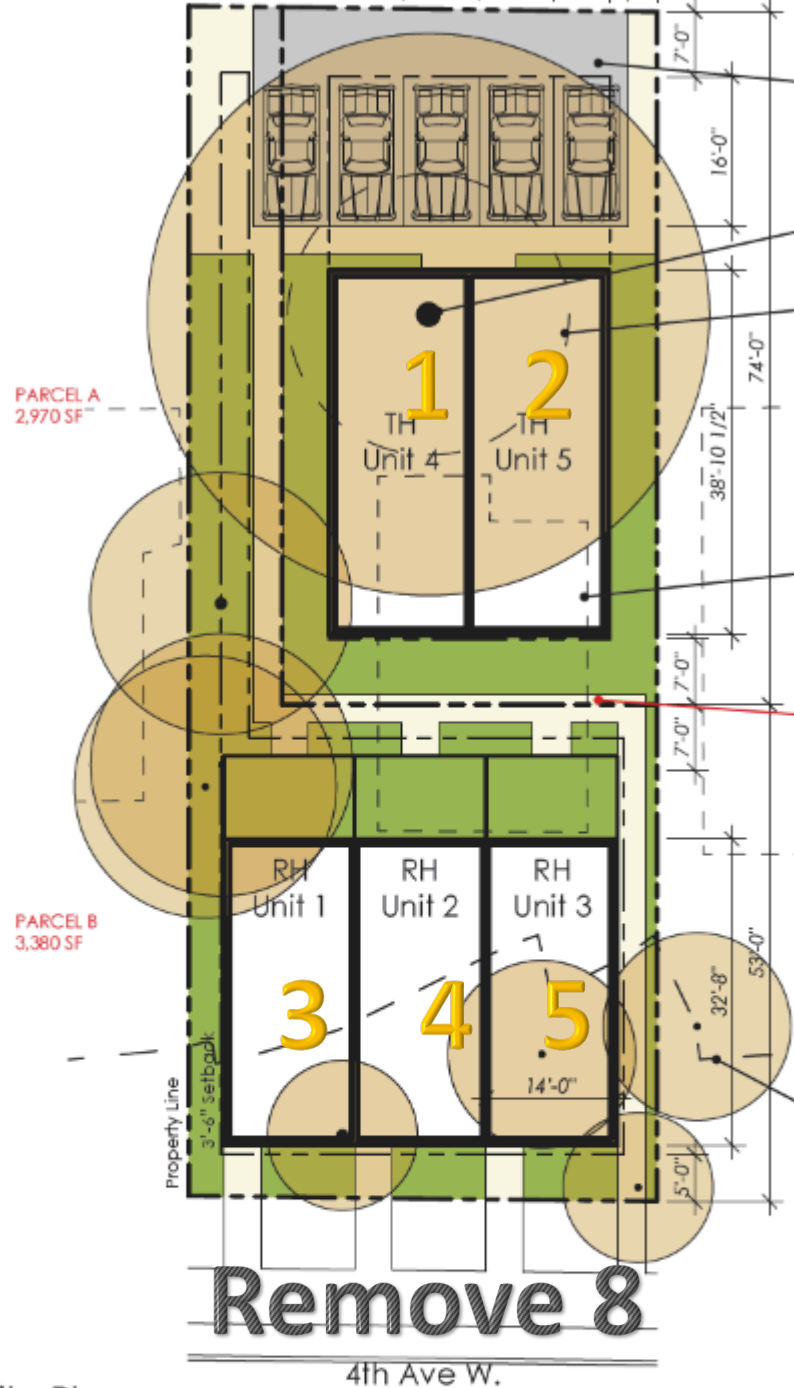



Urban Forestry Commission

Seattle Tree Loss

The Good

The Bad

The Ugly

The Ugly

Ballard Tree Grove Massacre

Seattle, Ballard Urban Village, 2213 NW 63rd Street

November 28, 2017 to June 3, 2019





Before

2203 NW 63rd Street (left)

And

2213 NW 63rd Street (below)

Tree Grove lay in between.





November 28, 2017

Eight trees with at least 12-inch diameter trunks (measured at breast height) makes a protected tree grove.

An existing garage foundation wall has been demolished on the development near trees 4 and 5.

The area along the fence was allocated as surface parking for the new row-houses so that the existing grove of trees would not be damaged by excavation.

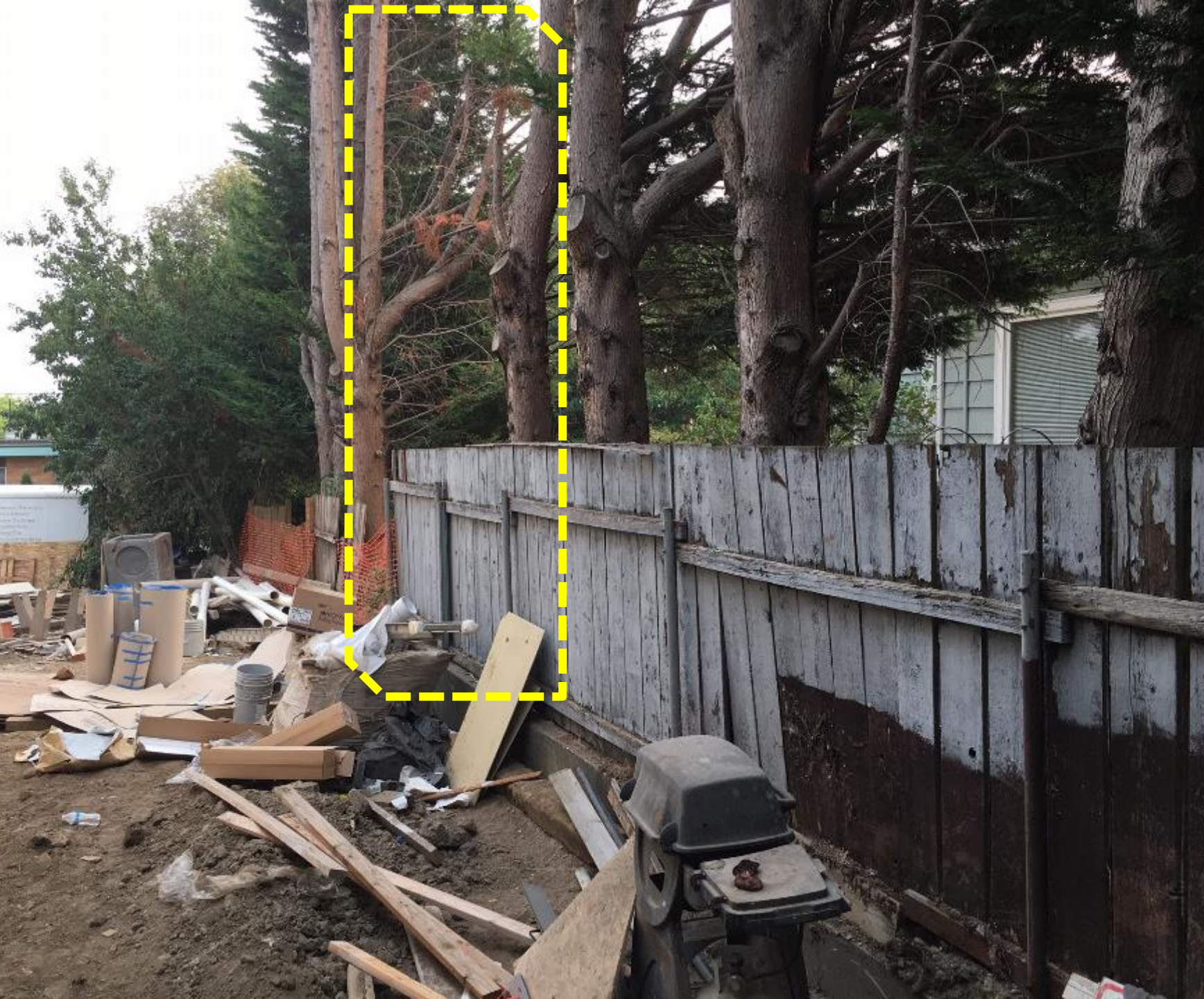

January 20, 2018

Two of the trees in the grove were reportedly destabilized and began to tip toward the neighboring owner's house.

Corner lot builder convinced the tree grove owner to have the two trees removed.

Several written complaints were made. This situation with a damaged grove is left uncorrected for eight months later as photographed again on AUGUST 22.

Neighbor (house shown) decides to put their property for sale soon after, and sells for \$1-million to another developer.



August 22, 2018

Tree Grove damage left unaddressed after eight months.

Contractor continued on construction of 7 corner lot townhouses (compliant with code).



Neighbor's Trees Removed

1 2 3 4 5 6 7 8

June 3, 2019

After selling their property in early 2018 for \$1-million to another developer, the architect submits their proposal on June 19, 2018 to remove all the trees in the grove to make way for a driveway to a Single Family residence to be located behind three new market-rate row-houses.

(Seattle Code allows houses behind restricted townhouses but prohibits dwelling behind unrestricted row-houses as done here.)

One year later, the entire grove is gone.



June 3, 2019

The protected tree grove included eight healthy trees providing shade, carbon sequestration, natural habitats, storm water absorption, and biophilic living environments.

Instead of the grove, this is now a 10-foot wide driveway from the street to the middle of the lot for 3 rowhouses along the street and one noncompliant detached house in the back.

No new trees were added to replace the loss of the grove or tree canopy.

Urban Forestry Commission

The Good

The Bad

The Ugly

Street Trees

November 21st

Environmental Justice

Trees for Seattle | Street Trees

Contact us about

Urban Forestry

Explore Street Trees

Street Tree Management

Urban Tree Canopy

Environmental Justice

Urban Forest Resilience

Stewardship

Environmental Justice

Environmental Equity and Justice

ROW Canopy and Environmental Equity

By looking at the right-of-way (ROW) canopy cover data, particularly the ROW canopy deficit data, and the results of Racial and Social Equity Index Mapping, one can identify **highly disadvantaged census tracts** (those that are ranked most and second most disadvantaged), which

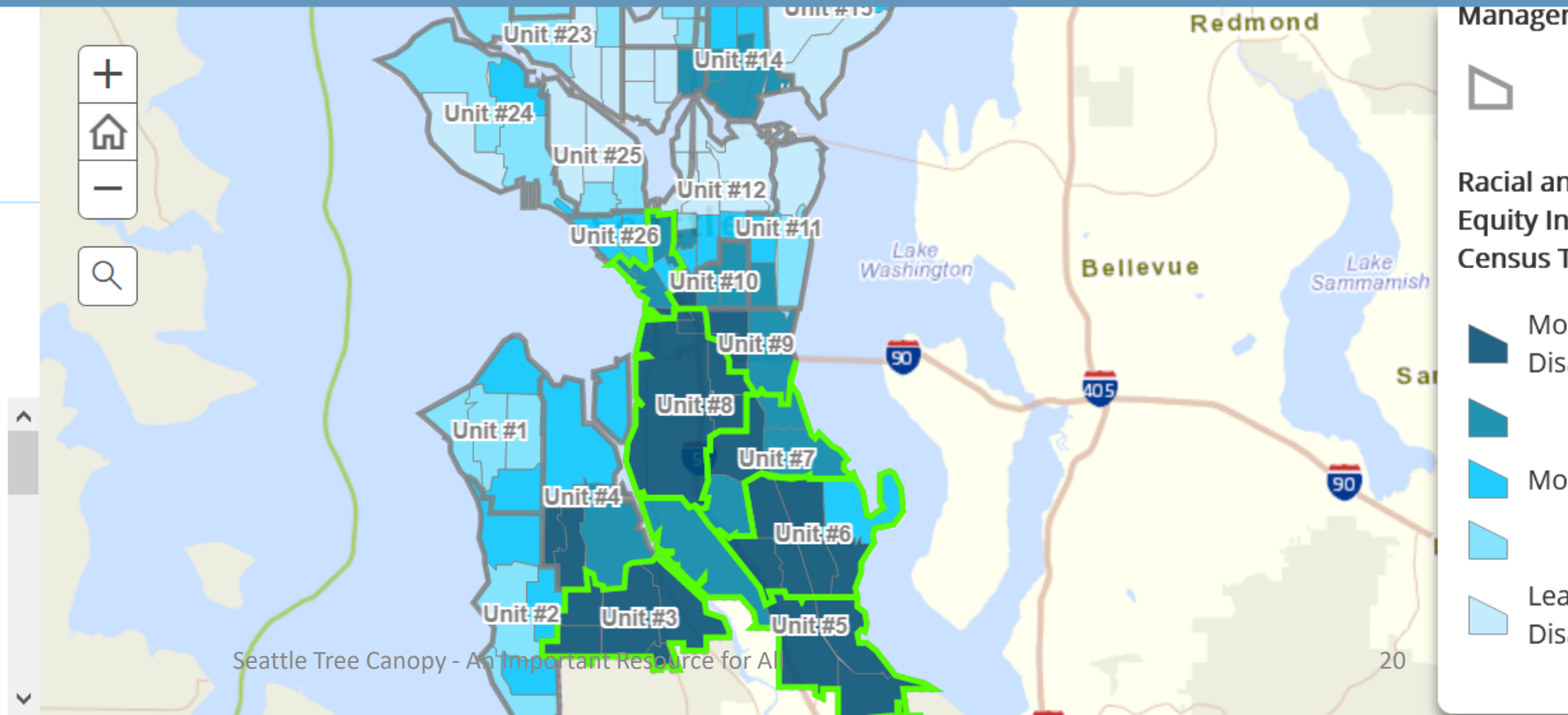

Trees for Seattle | Street Trees

- Urban Forestry
- Explore Street Trees
- Street Tree Management
- Urban Tree Canopy
- Environmental Justice
- U

Urban Tree Canopy

Seattle's Canopy Cover

Canopy cover is the percent of the City that is covered by trees, as seen in an aerial view. Canopy cover is an important management tool for the City to understand the extent and distribution of trees in Seattle. Seattle's goal, established in 2007, is to reach 30% canopy cover by 2037.

The City of Seattle's most recent

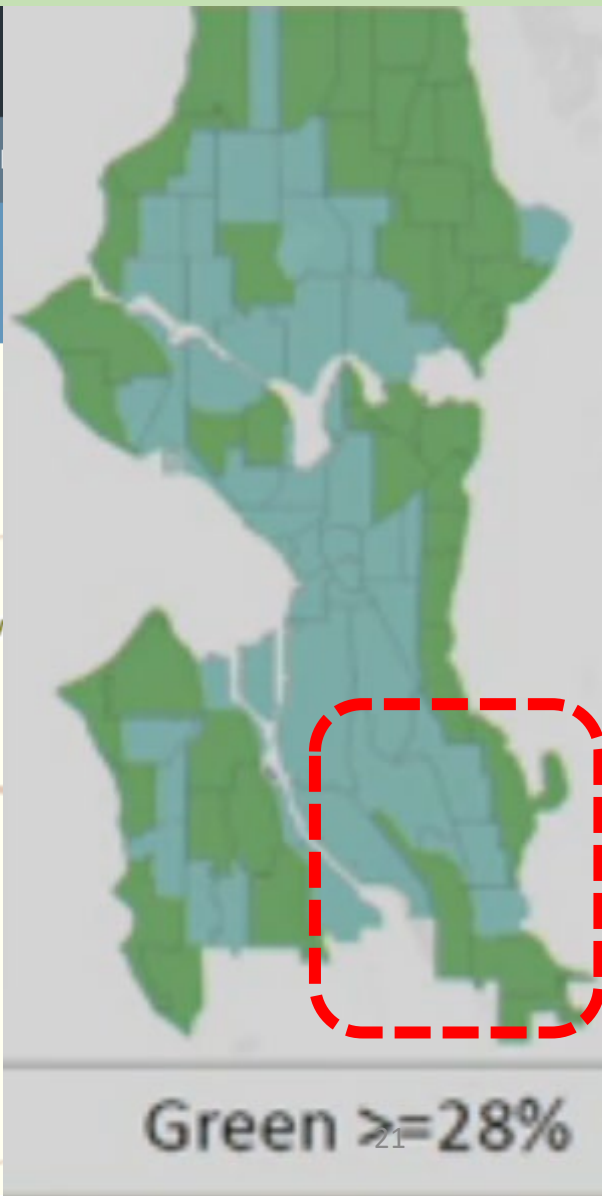
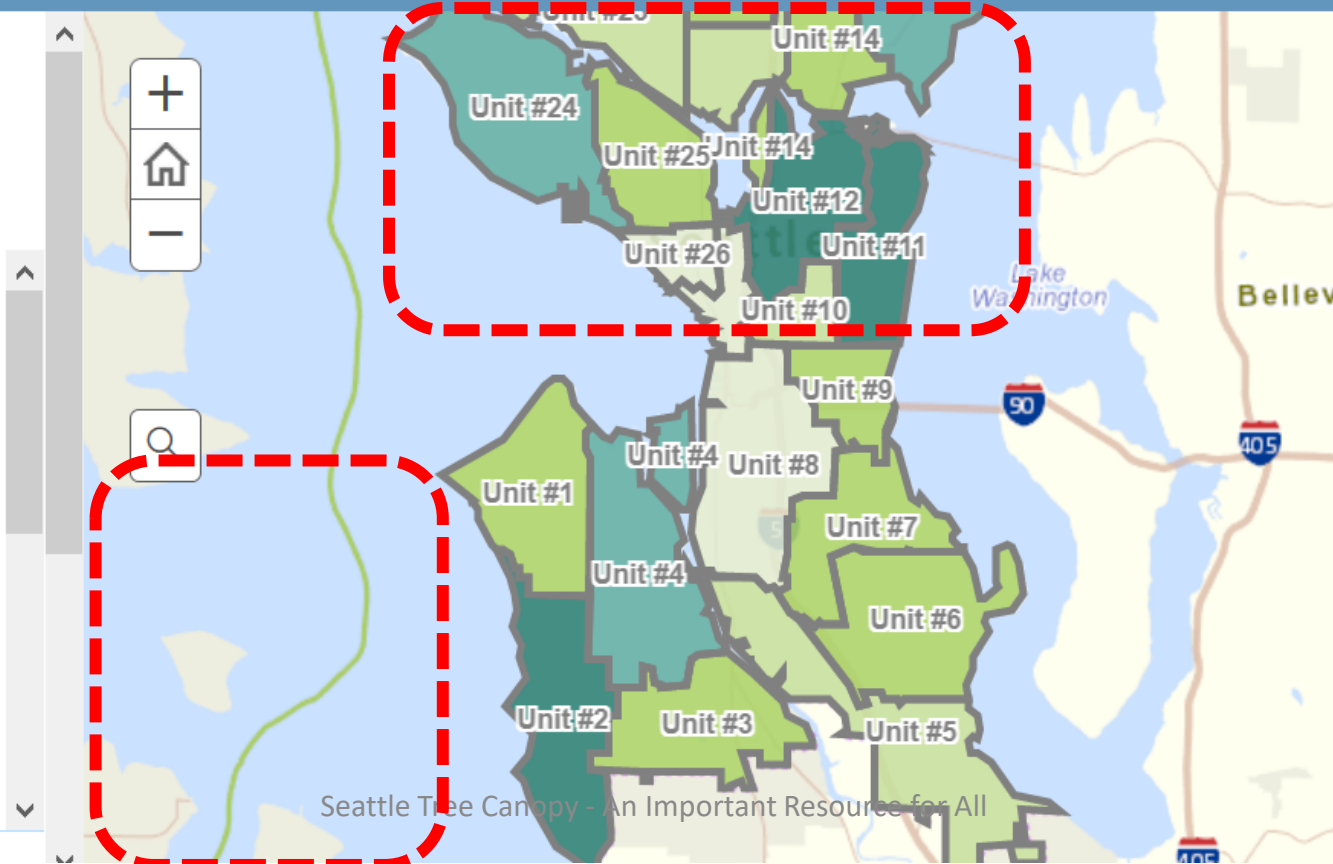

SDCI GIS Map of Trees in Seattle

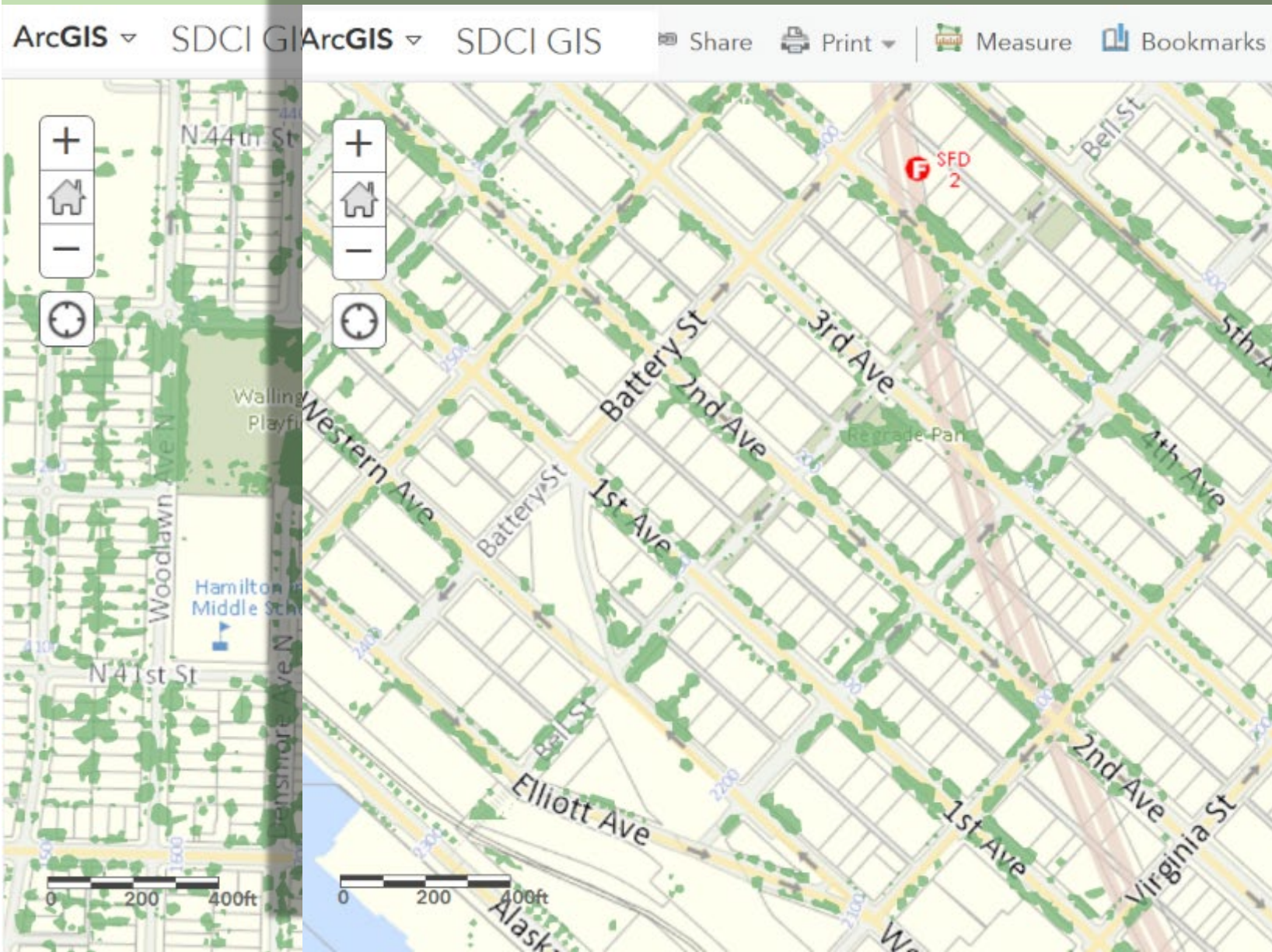

Analyzed SDOT spreadsheet with over 17,000 rows, separated into years

**Permitted Trees for Removal and Planting
2007- September 2019**

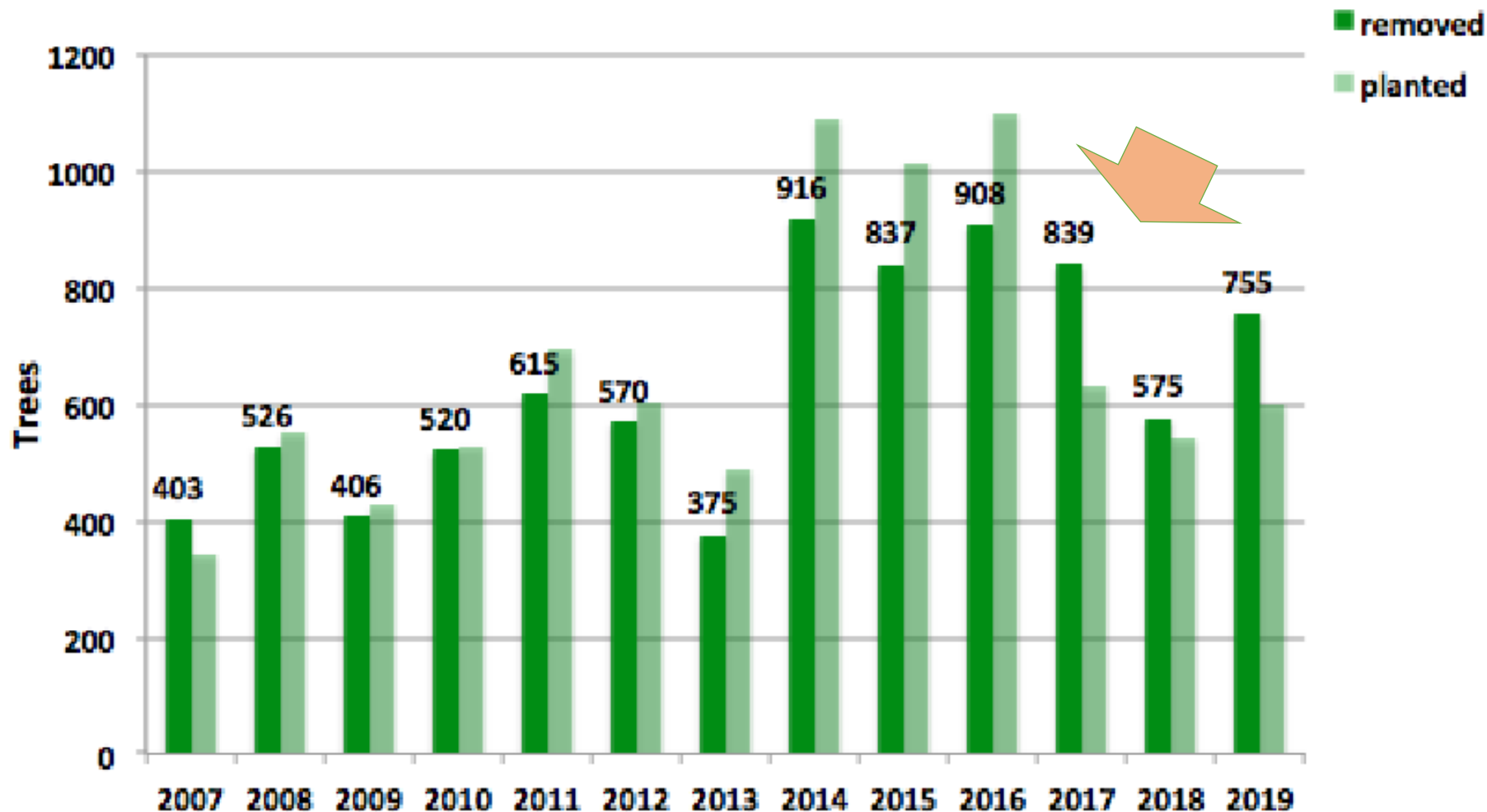

Here's the data in bar graph form. From 2007 through September 2019, 8,245 trees were removed by permit and 8,601 trees were slated to be planted.

[compiled by Bernice Maslan]



Urban Forestry Commission

Seattle Tree Loss



Our Goal



Seattle Today!



TREES *AND* DENSITY or... JUST DENSITY

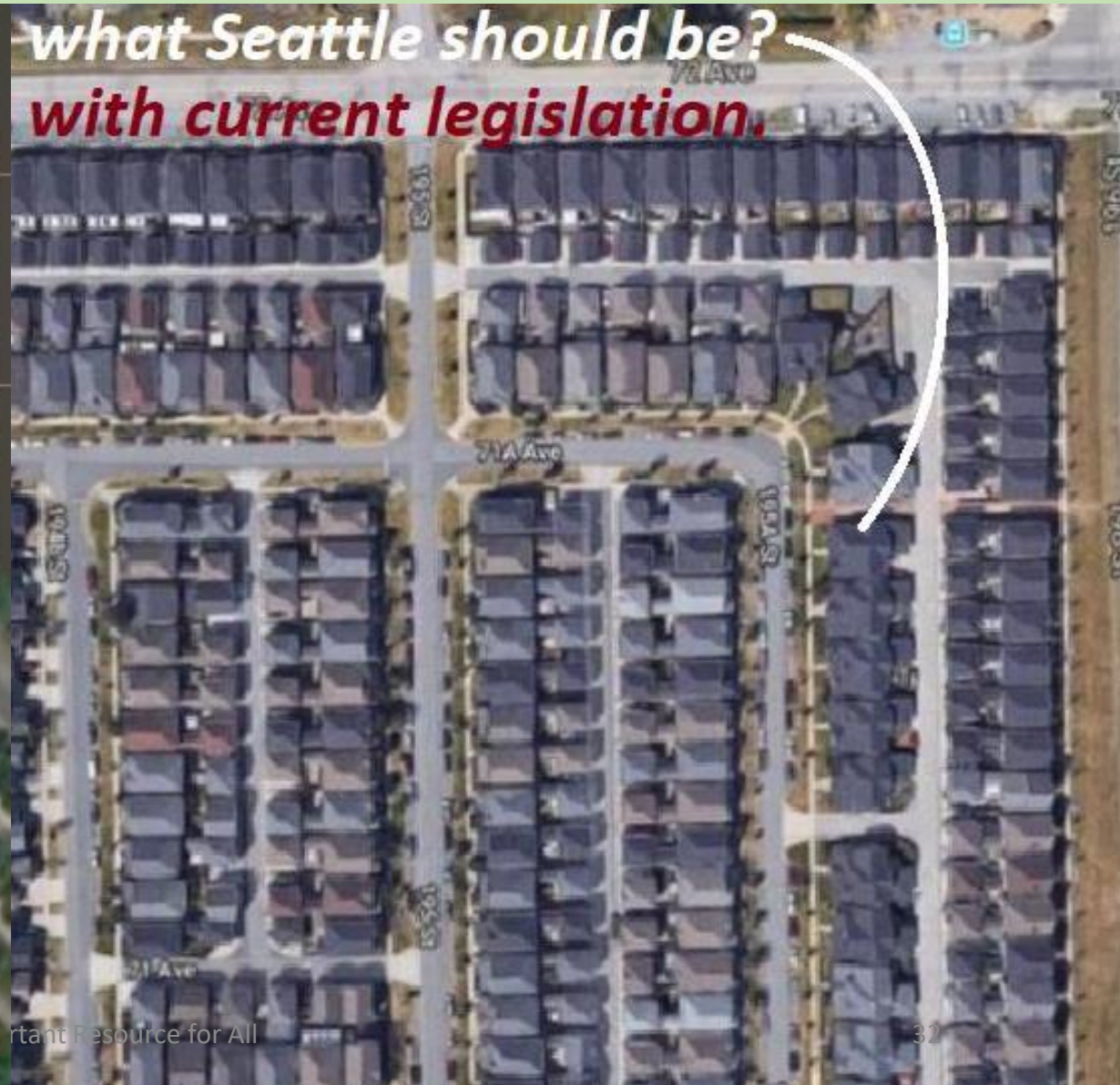



No Room for Trees...

Is this Seattle in 50 years?



Canopy: An Important Resource for All



Or will Seattle still have a
full Tree Canopy in 50
years?