



**King County**

Department of Natural Resources and Parks  
Wastewater Treatment Division

# Alki Standby Generator Project

October 2023

## Enhancing the 63rd Ave Pump Station for Reliability and a Cleaner Puget Sound

King County is working to provide reliable electrical power to the 63rd Ave Pump Station. This will ensure protection against stormwater combined with wastewater from overflowing into your neighborhood and Puget Sound.

### Standby Generator Construction starting as early as Spring 2024:

To bring power from Alki Wet Weather Treatment Station (WWTS) to the 63rd Ave Pump Station (PS), we will install conduit under the road along the dotted line in the image below. This work will involve excavation and lane closures. **We will provide more details about street use impacts of the project along with Spring 2024 community site walks. Dates and times of community site walks to be shared in early 2024.**

We will restore all work areas according to the City's direction once construction is complete. By putting the generator at the Alki WWTS facility up the road and using it to power the pump station we can minimize the amount of equipment we have to add to the pump station, which means smaller changes to the footprint and visual impacts from the road.



# Alki Standby Generator Project



**King County**

Department of  
Natural Resources and Parks  
Wastewater Treatment Division

## Two Work Phases:

**PHASE 1** of this project, **beginning as early as March 2024**, will be constructing the transformer vault at the 63rd Ave pump station.

**PHASE 2**, **beginning as early as April 2024**, will require trenching in the street to route the conduit from the Alki facility to the 63rd Ave pump station. Trenching and conduit installation is expected to be done by Fall 2024.

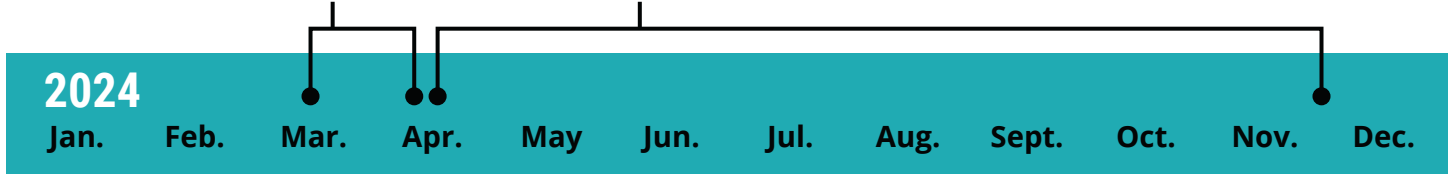

We will install a vault, a transformer cabinet, and new conduits at the pump station. The transformer must be well ventilated and in a structure above the high tide and splash zone. The height of the transformer will depend on the model that is available once a contractor is hired.

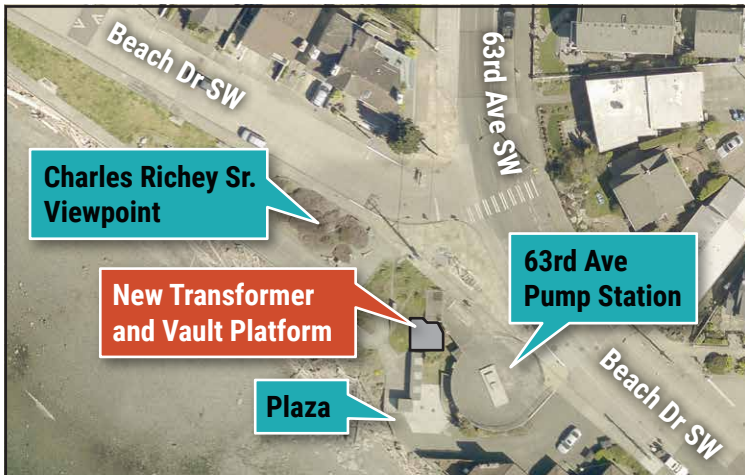

*Aerial view showing location of new transformer*

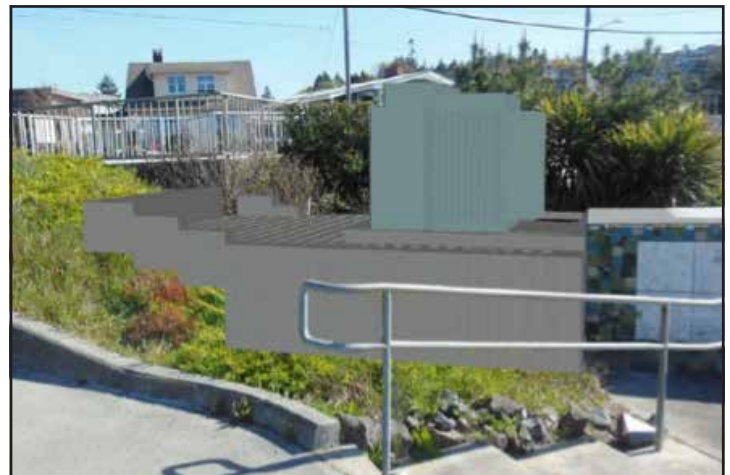

*Conceptual view of the new transformer and vault platform from the park.*



*Conceptual view showing the approximate location of the conduits. Conduits will be on the water side of the railing.*

## For more information contact

**Julia Yen**

**King County Wastewater Treatment Division**

Phone: 206-263-3512

Email: [juyen@kingcounty.gov](mailto:juyen@kingcounty.gov)

@KingCountyWTD



Alternative Formats Available

206-477-5371 / 711 (TTY Relay)