



22ND AVE NW

BALLARD AVE NW

NW VERNON PL

BALLARD AVE NW

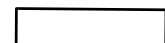
LEGEND

-  INSTALL
-  REMOVE
-  RELOCATE/MAINTAIN

CHANNELIZATION LEGEND

- L-T/SL16 THERMOPLASTIC 16" STOPLINE
- L-T/XWK THERMOPLASTIC 8" CROSSWALK
- L-P/4WS 4" SOLID WHITE LINE
- L-P/4WD DOUBLE 4" SOLID WHITE LINES
- L-P/4W2 DASHED 4" WHITE LINE, 2' PAINT/4' SKIP
- L-P/8WS 8" SOLID WHITE LINE
- L-P/4YB DASHED 4" YELLOW LINE, 10' PAINT/20' SKIP

SIGNAGE LEGEND

- R1-1 STOP (RED BACKING)
- R1-3P ALL WAY
- R6-2L ONE WAY, LEFT ARROW
- R6-2R ONE WAY, RIGHT ARROW
- R7-WI30 NO PARKING WITHIN 30 FEET
- SNS STREET NAME SIGN(S)
- TS-10 10-FOOT SIGN POST PER STD PLAN NO 625
- TS-(XX)RW XX-FOOT SIGN POST PER STD PLAN NO 625 WITH RED AND WHITE STRIPED POST SLEEVE
- SNSPOST STREET NAME SIGN POST
- SIGNPOST TRAFFIC SIGN POST

MATCH LINE - SEE BELOW LEFT

MATCH LINE - SEE ABOVE RIGHT

MATCH LINE - SEE SHEET CH2

36" Diameter Owner Furnished Planters
Install 7' OC, 18" offset from face of planter to far edge of curb stripe

Removable Channelizer Post 5' OC
To be installed by Owner.

INSTALL 6' WHEEL STOP
3' FROM STREET CAFE
(TYPICAL)

VAULT SERIAL NO.	DATE	MARK	NATURE	MADE CHKD	REVD

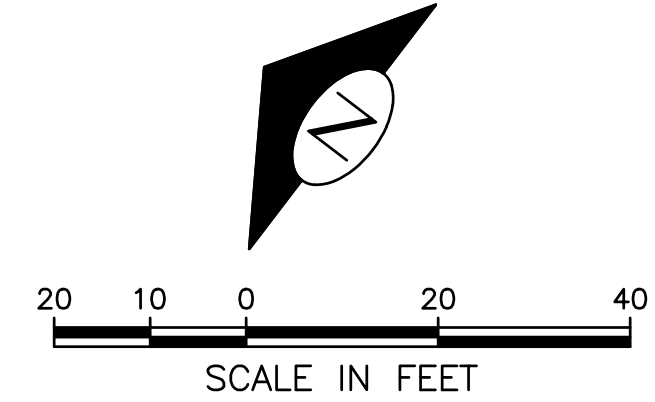

CHANGE ORDER

PW#

APPROVED FOR ADVERTISING
LIZ ALZEER
DEPARTMENT OF FINANCE & ADMINISTRATIVE SERVICES
SEATTLE, WASHINGTON 20

BY:
PURCHASING AND CONTRACTING DIRECTOR

INITIALS AND DATE		INITIALS AND DATE	
DESIGNED	CHECKED	REVIEWED:	CONST.
		DES.	PROJ. MGR.
		SDOT	
DRAWN	CHECKED	RECEIVED	
		REVISED AS BUILT	
ALL WORK SHALL BE DONE IN ACCORDANCE WITH THE CITY OF SEATTLE STANDARD PLANS AND SPECIFICATIONS AND OTHER DOCUMENTS CALLED FOR IN SECTION 0-02.3 OF THE PROJECT MANUAL.			

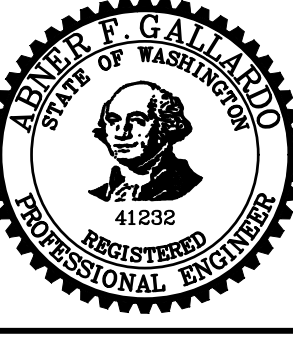

Seattle
Department of
Transportation

ORDINANCE NO. PW NO.
FUND:

SCALE: H. 1"=20', V. 1"=10'

CHANNELIZATION AND SIGNING

BALLARD AVE SAFETY IMPROVEMENTS

PC	
CO	
VPI #	
CH1	
SHEET	1 OF 2

P:\S01000\TRC0478_Ballard Ave Safety Improvements (20th-22nd)\A-Plot Sheets\TRC0478_P-MRK04.dwg
Jun-06-22 1:58pm

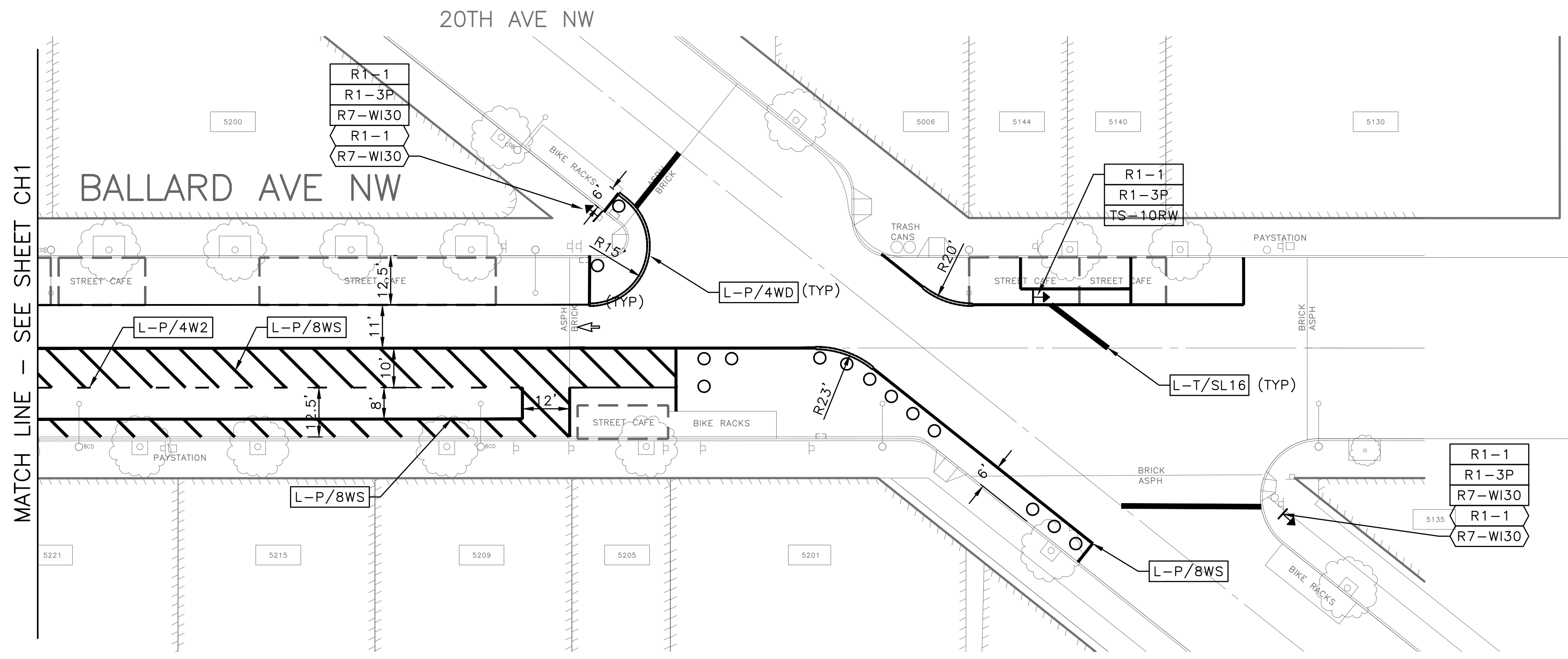

LEGEND

-  INSTALL
-  REMOVE
-  RELOCATE/MAINTAIN

CHANNELIZATION LEGEND

- L-T/SL16 THERMOPLASTIC 16" STOPLINE
- L-T/XWK THERMOPLASTIC 8" CROSSWALK
- L-P/4WS 4" SOLID WHITE LINE
- L-P/4WD DOUBLE 4" SOLID WHITE LINES
- L-P/4W2 DASHED 4" WHITE LINE, 2' PAINT/4' SKIP
- L-P/8WS 8" SOLID WHITE LINE
- L-P/4YB DASHED 4" YELLOW LINE, 10' PAINT/20' SKIP

SIGNAGE LEGEND

- R1-1 STOP (RED BACKING)
- R1-3P ALL WAY
- R6-2L ONE WAY, LEFT ARROW
- R6-2R ONE WAY, RIGHT ARROW
- R7-WI30 NO PARKING WITHIN 30 FEET
- SNS STREET NAME SIGN(S)
- TS-10 10-FOOT SIGN POST PER STD PLAN NO 625
- TS-(XX)RW XX-FOOT SIGN POST PER STD PLAN NO 625 WITH RED AND WHITE STRIPED POST SLEEVE
- SNSPOST STREET NAME SIGN POST
- SIGNPOST TRAFFIC SIGN POST

VAULT SERIAL NO.	DATE	MARK	NATURE	MADE CHKD	REVD

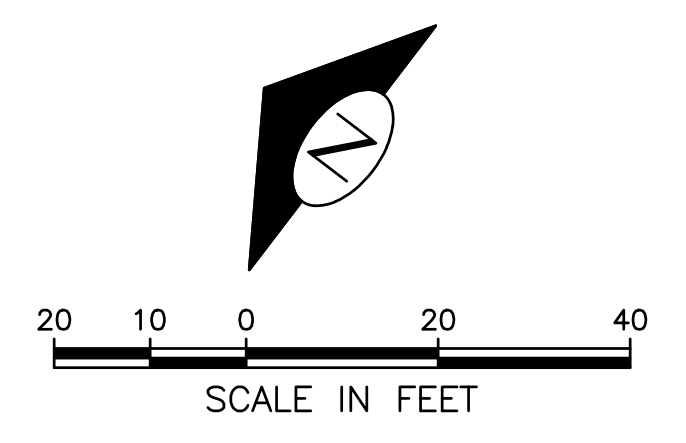

CHANGE ORDER

PW#

APPROVED FOR ADVERTISING
LIZ ALZEER
DEPARTMENT OF FINANCE & ADMINISTRATIVE SERVICES
SEATTLE, WASHINGTON 20

BY:
PURCHASING AND CONTRACTING DIRECTOR

INITIALS AND DATE		INITIALS AND DATE	
DESIGNED	CHECKED	REVIEWED:	CONST.
		DES.	PROJ. MGR.
		SDOT	
DRAWN	CHECKED	RECEIVED	
		REVISED AS BUILT	

ALL WORK SHALL BE DONE IN ACCORDANCE WITH THE CITY OF SEATTLE STANDARD PLANS AND SPECIFICATIONS AND OTHER DOCUMENTS CALLED FOR IN SECTION 0-02.3 OF THE PROJECT MANUAL.

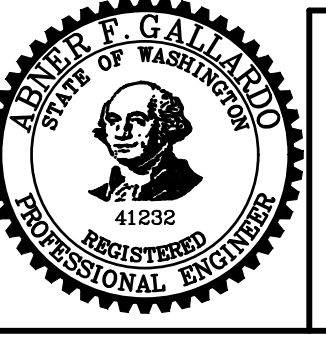

Seattle Department of Transportation

ORDINANCE NO. FW NO.
FUND:
SCALE: H. 1"=20', V. 1"=10'

CHANNELIZATION AND SIGNING

BALLARD AVE SAFETY IMPROVEMENTS

JOB # PC
CO
VPI #
CH2
SHEET 2 OF 2

P:\S001CF\TRC0478_Ballard Ave Safety Improvements (20th-22nd)\A-Plot Sheets\TRC0478_P-MRK04.dwg
Jun-06-22 1:58pm