



- WELCOME
- PROJECT OVERVIEW
- USER EXPERIENCE
- SAFETY
- ENVIRONMENTAL
- OTHER WALKING AND BIKING INVESTMENTS
- DESIGN SURVEY
- MORE WAYS TO BE INVOLVED

NORTHGATE PED/BIKE BRIDGE PROJECT



ONLINE OPEN HOUSE—AUGUST 3-24



WELCOME!

(PAGE 1 OF 8)

The purpose of this online open house is to update you on the revised Northgate Ped/Bike Bridge design, get your feedback, and provide you with information on how to stay involved in the various transportation projects in the Northgate area.

Throughout this online open house, you will be asked questions and have the opportunity to provide your feedback. The site will be live through August 24.

HOW TO USE THIS ONLINE OPEN HOUSE

To advance through the open house, read a page and provide your feedback where prompted, then either click the "Go to Next Page" button at the bottom of the page or select the tab you want at the top.

The "Notes" boxes at the bottom of most pages are for making comments as you go along; on the last page of the open house you will be able to submit them, if you choose.

Sign up to receive email updates using the form in the footer of the page.

THANK YOU FOR YOUR INVOLVEMENT!

[GO TO NEXT PAGE](#)

SIGN UP FOR EMAIL UPDATES ON THIS PROJECT:

First Name

Last Name

City

Email

* = REQUIRED FIELD

[SUBSCRIBE](#)

SHARE THIS WEBSITE:



CONTACT US:

NorthgateBridge@seattle.gov | (206) 615-0925
www.seattle.gov/transportation/NorthgatePedBridge.htm



WELCOME

PROJECT OVERVIEW

USER EXPERIENCE

SAFETY

ENVIRONMENTAL

OTHER WALKING AND BIKING INVESTMENTS

DESIGN SURVEY

MORE WAYS TO BE INVOLVED

NORTHGATE PED/BIKE BRIDGE PROJECT



ONLINE OPEN HOUSE—AUGUST 3-24



PROJECT OVERVIEW

(PAGE 2 OF 8)

The Seattle Department of Transportation's (SDOT) mission is to deliver a high-quality transportation system for Seattle. Through the Northgate Bridge project, we will improve connections between the east and west sides of the Northgate community, helping knit together a neighborhood historically divided by a 10-lane interstate and maximizing the use of transit facilities.

When complete, the bridge will help connect the neighborhood's thriving job and retail centers with the rest of the city and region.

THE GOALS OF THE PROJECT INCLUDE:

1. Connecting services and opportunities on the east and west sides of I-5
2. Adding a new, accessible walking/biking route in Northgate that connects to the citywide network
3. Providing better access to regional transit, including the existing transit center and future Link light rail station

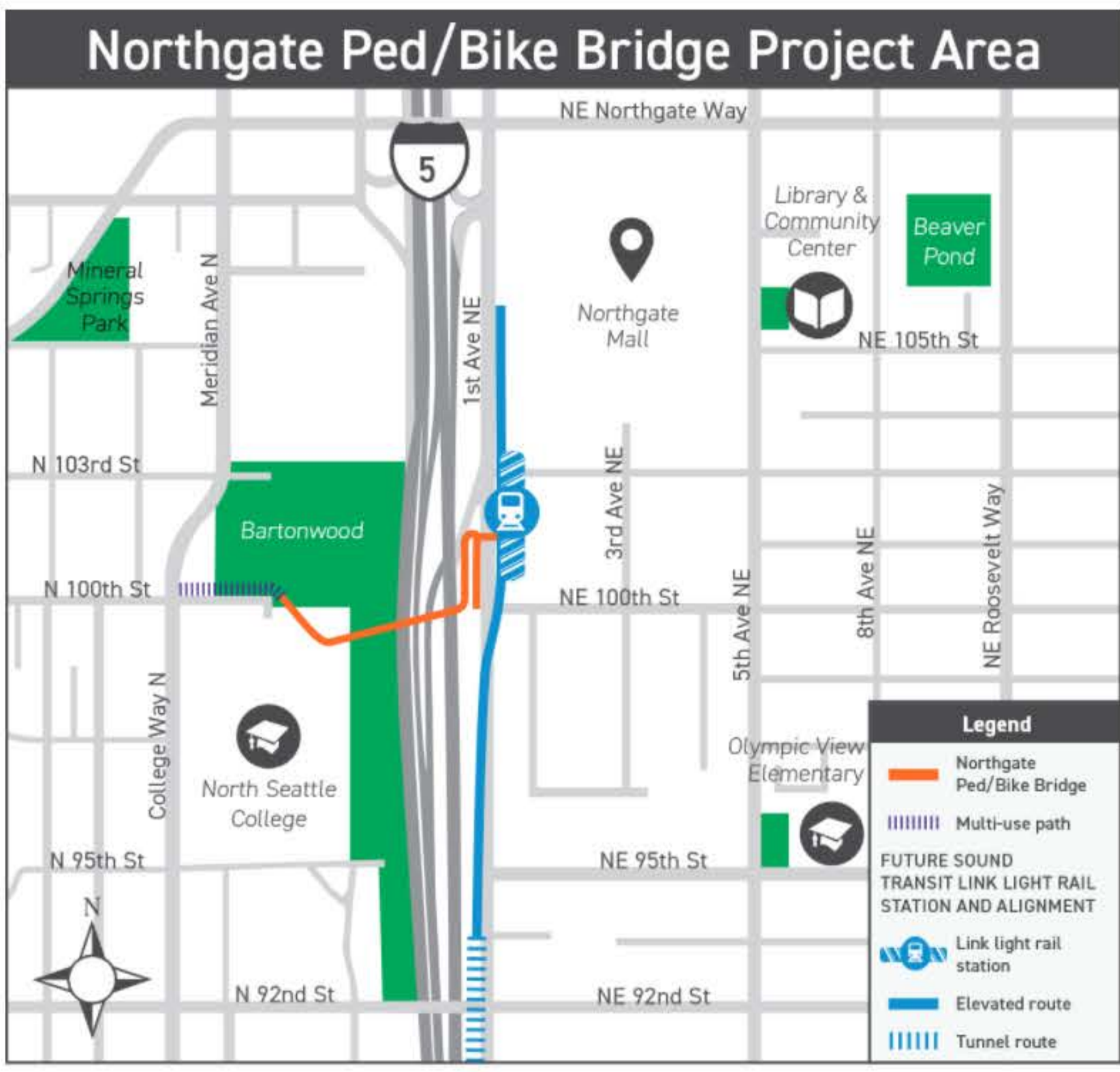

WHERE WE'VE BEEN

2006 2012 2014 2015 2016 2017

Northgate Coordinated Transportation Investment Plan addressed safety and mobility for people walking and biking, transit, freight and automobiles in the Northgate Urban Center and surrounding neighborhoods for the next 25 years.

NORTHGATE TODAY



The revised bridge design allows walkers and bikers to travel more efficiently between the east and west sides of Northgate.

Northgate is one of Seattle's fastest growing areas. In addition to being a major residential and employment hub, Northgate is also:

- 1 of 6 "urban centers" in Seattle's Comprehensive Plan
- Listed as a regional growth center in the Puget Sound Regional Council's Vision 2040 regional growth management plan
- Poised to become one of the region's most active transit hubs with the completion of Sound Transit's Link light rail station in 2021

Notes you make in this box will appear in the comment form on the last page of the open house.

GO TO NEXT PAGE

SIGN UP FOR EMAIL UPDATES ON THIS PROJECT:

First Name

Last Name

City

Email

* = REQUIRED FIELD

SHARE THIS WEBSITE:



CONTACT US:

NorthgateBridge@seattle.gov | (206) 615-0925
www.seattle.gov/transportation/NorthgatePedBridge.htm

SUBSCRIBE



NORTHGATE PED/BIKE BRIDGE PROJECT



ONLINE OPEN HOUSE—AUGUST 3-24



USER EXPERIENCE

(PAGE 3 OF 8)

Click a label on the illustration to see a detail rendering of the user experience on that area of the bridge.

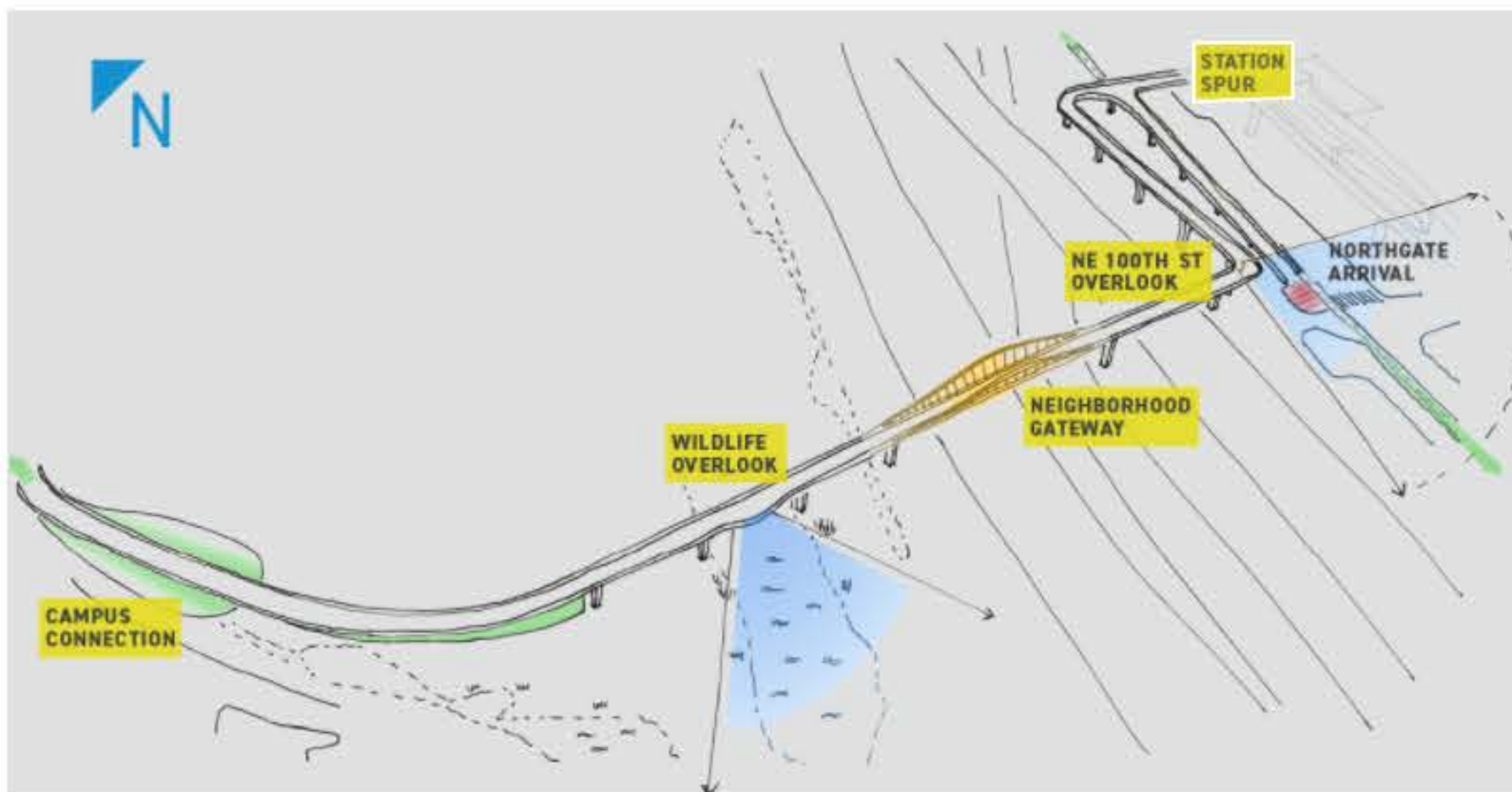

NORTHGATE PED/BIKE BRIDGE USER EXPERIENCE

View of the bridge from 1st Ave NE.

Click image for a larger view.

WATCH OUR VIDEO

Press play below to get a sense of what it will feel like to use the bridge.

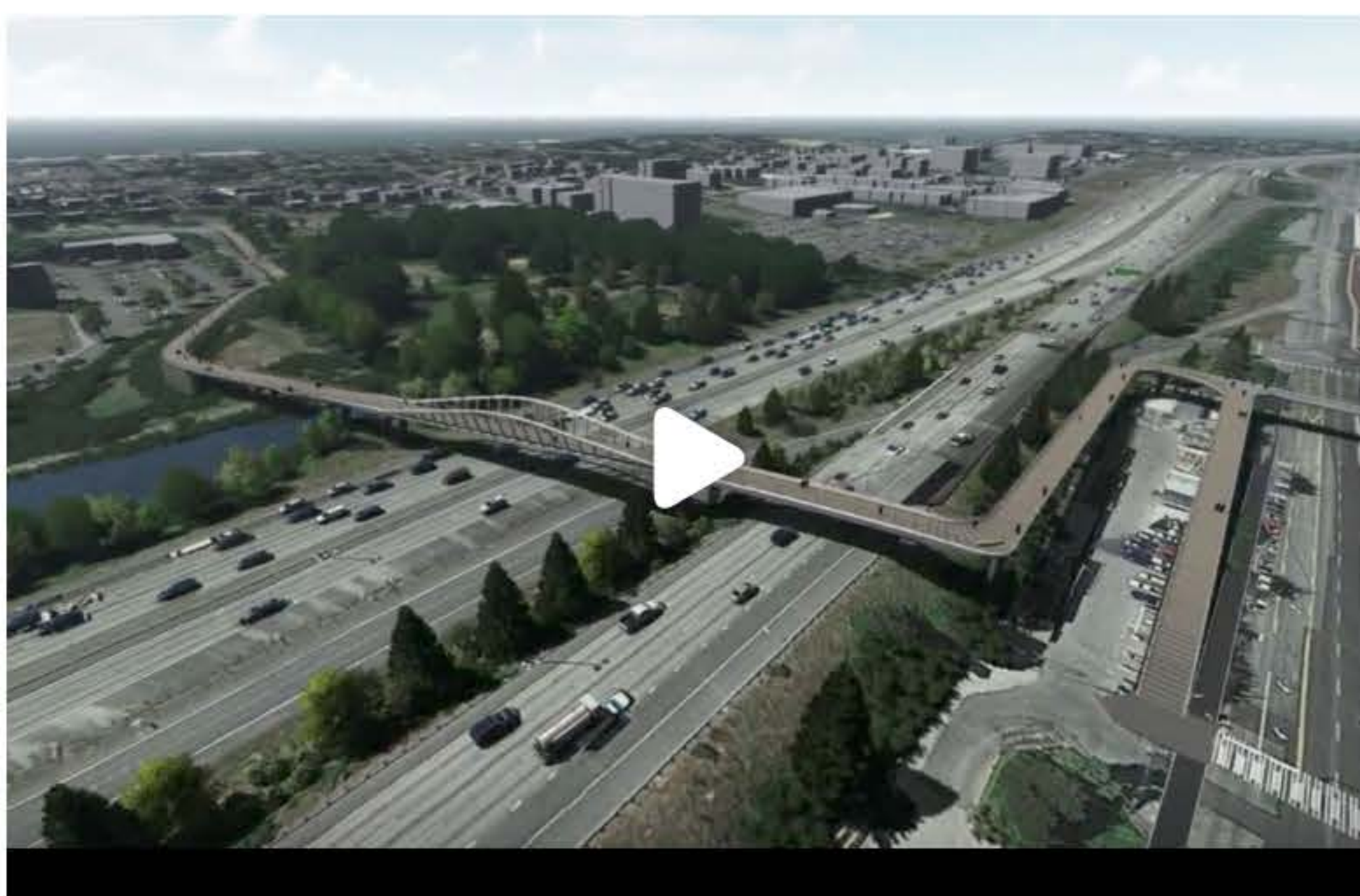

THE REVISED DESIGN

After pausing in 2016 to conduct an independent cost validation, we found that the existing design exceeded the project budget. In response, we decided to form a new design team to get a fresh perspective and reduce project costs. The following design elements are included in the revision:

- New points of rest at overlooks, with added bridge width so you can pause and enjoy the view
- Improved sight lines
- Reduced conflicts at east landing
- Open structure with graceful design
- Simpler construction approach

Notes you make in this box will appear in the comment form on the last page of the open house.

GO TO NEXT PAGE

SIGN UP FOR EMAIL UPDATES ON THIS PROJECT:

First Name

Last Name

City

Email

* = REQUIRED FIELD

SUBSCRIBE

SHARE THIS WEBSITE:



CONTACT US:

NorthgateBridge@seattle.gov | (206) 615-0925
www.seattle.gov/transportation/NorthgatePedBridge.htm



WELCOME

PROJECT OVERVIEW

USER EXPERIENCE

SAFETY

ENVIRONMENTAL

OTHER WALKING AND BIKING INVESTMENTS

DESIGN SURVEY

MORE WAYS TO BE INVOLVED

NORTHGATE PED/BIKE BRIDGE PROJECT



ONLINE OPEN HOUSE—AUGUST 3-24



SAFETY

(PAGE 4 OF 8)

As we design the bridge, we're using a multi-disciplinary approach called Crime Prevention Through Environmental Design (CPTED). CPTED strategies aim to deter crime and are based on the idea that people's behavior in an urban environment is influenced by the environment's design.

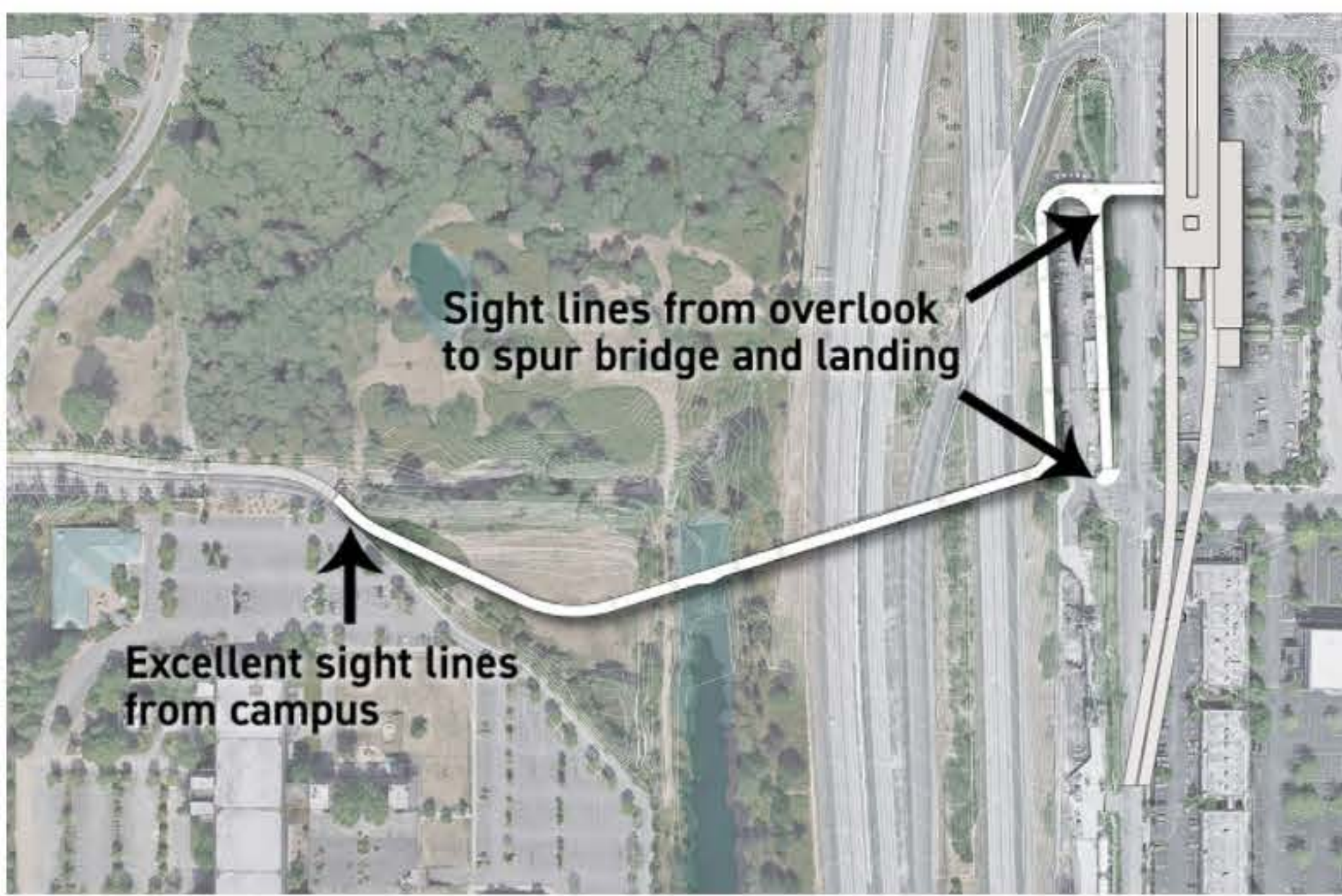

CRIME PREVENTION THROUGH ENVIRONMENTAL DESIGN (CPTED)

CPTED strategies include:

- Providing ample lighting to avoid blind spots
- Maximizing sight distance and visibility
- Using materials that promote easy maintenance of aesthetic and functional qualities

For example, you'll find the Northgate Bridge has excellent lines of sight—both across the bridge from end to end and from the bridge when you look down and around at your surroundings. The revised bridge design provides a more open, less enclosed space, as well as less surface area for vandalism. A 10-foot-tall cable net throw barrier will prevent people from climbing or throwing things over the portion of the bridge above I-5. Finally, lighting across the length of the bridge should make it comfortable if you're crossing at night.

PROVIDING SPACE FOR ALL USERS

The bridge width is also an important safety consideration. The revised bridge is 16 feet wide, providing more than enough space for all modes in both directions. State code requires 10 feet width, with 2 feet on each side as buffers.

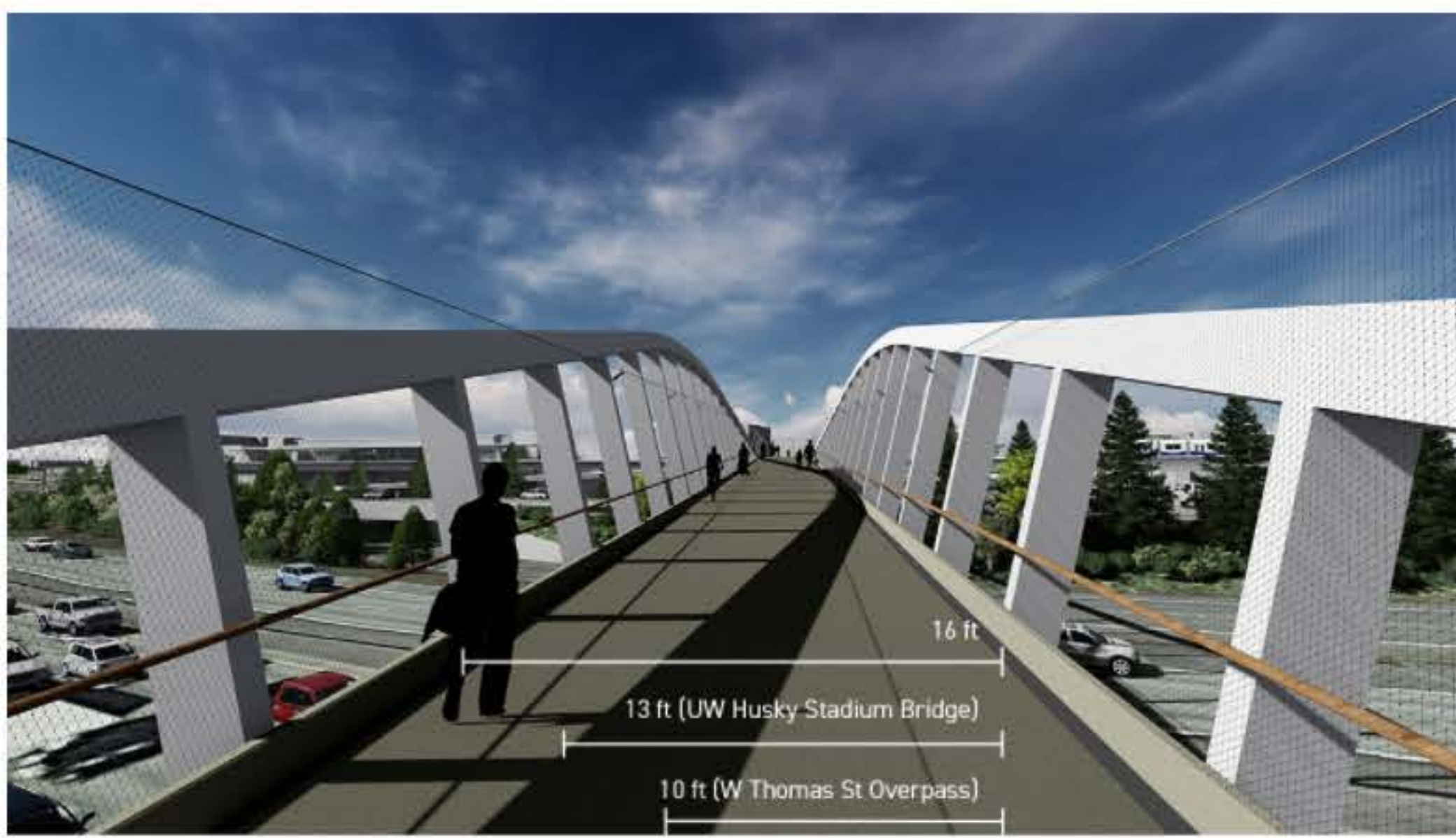

To help you get a sense of the bridge width, here's how it compares with a handful of other local pedestrian bridges.

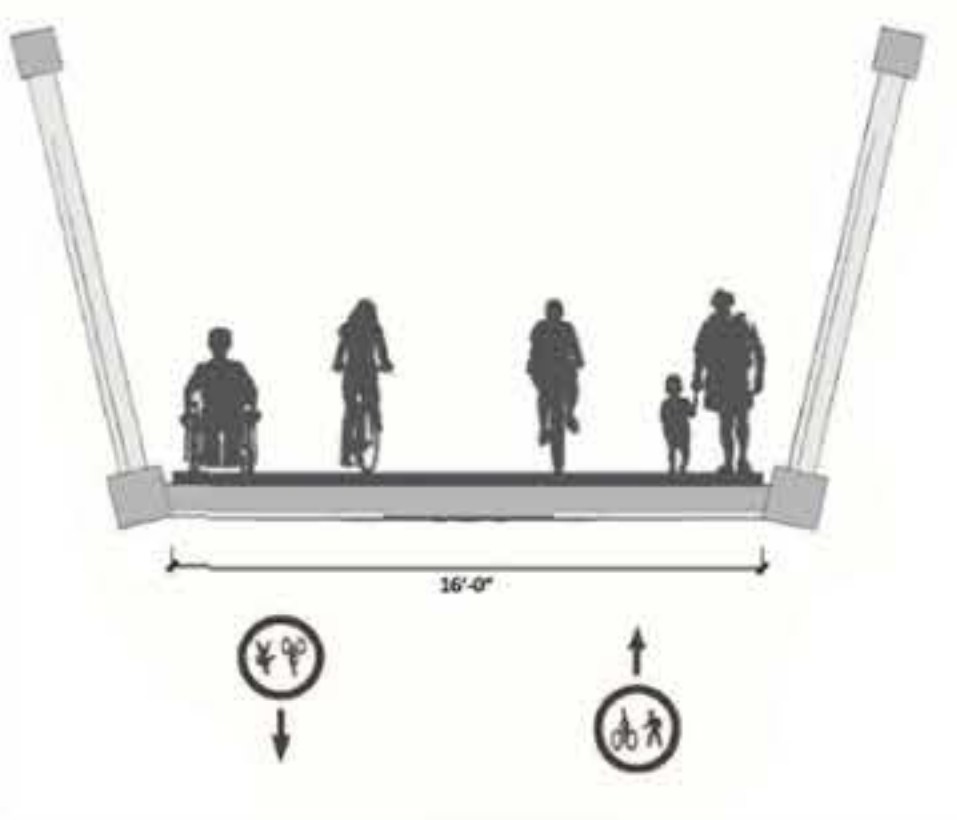

We will encourage all users to "keep right."

DIMENSIONS OF NEARBY PEDESTRIAN BRIDGES



THE SEATTLE TIMES

Boeing Museum of Flight Bridge
Width: 10 feet Length: 340 feet



SEATTLE BIKE BLOG

University of Washington Husky Stadium Bridge
Width: 13 feet Length: 378 feet



CAM FU

W Thomas Pedestrian Overpass
Width: 10 feet Length: 1009 feet

Notes you make in this box will appear in the comment form on the last page of the open house.

GO TO NEXT PAGE

SIGN UP FOR EMAIL UPDATES ON THIS PROJECT:

First Name

Last Name

City

Email

* = REQUIRED FIELD

SUBSCRIBE

SHARE THIS WEBSITE:



CONTACT US:

NorthgateBridge@seattle.gov | (206) 615-0925
www.seattle.gov/transportation/NorthgatePedBridge.htm

NORTHGATE PED/BIKE BRIDGE PROJECT



ONLINE OPEN HOUSE—AUGUST 3-24



ENVIRONMENTAL

(PAGE 5 OF 8)

We're examining the environmental impacts of constructing and operating the Northgate Bridge. Upon completion, we'll submit National Environmental Policy Act (NEPA) documents to the Washington State Department of Transportation and Federal Highway Administration for approval. Once they're approved, we'll issue a Determination of Non-Significance to satisfy the State Environmental Policy Act (SEPA). We will then issue a SEPA checklist or adopt the NEPA document in lieu of a checklist, which we'll make available for public review and comment.

As we conduct our environmental review, we are looking at the following resources:

VISUAL



- View of neighborhood and Bartonwood from bridge and east approach
- View of bridge from 1st Ave, I-5 and North Seattle College

RECREATION/NATURAL AREAS

HISTORICAL/CULTURAL

TRANSPORTATION

NATURAL RESOURCES

EXISTING CONDITIONS



ENVIRONMENTAL PROCESS

This graphic shows the steps to complete the environmental review process. Click on the tabs below to learn more about each phase

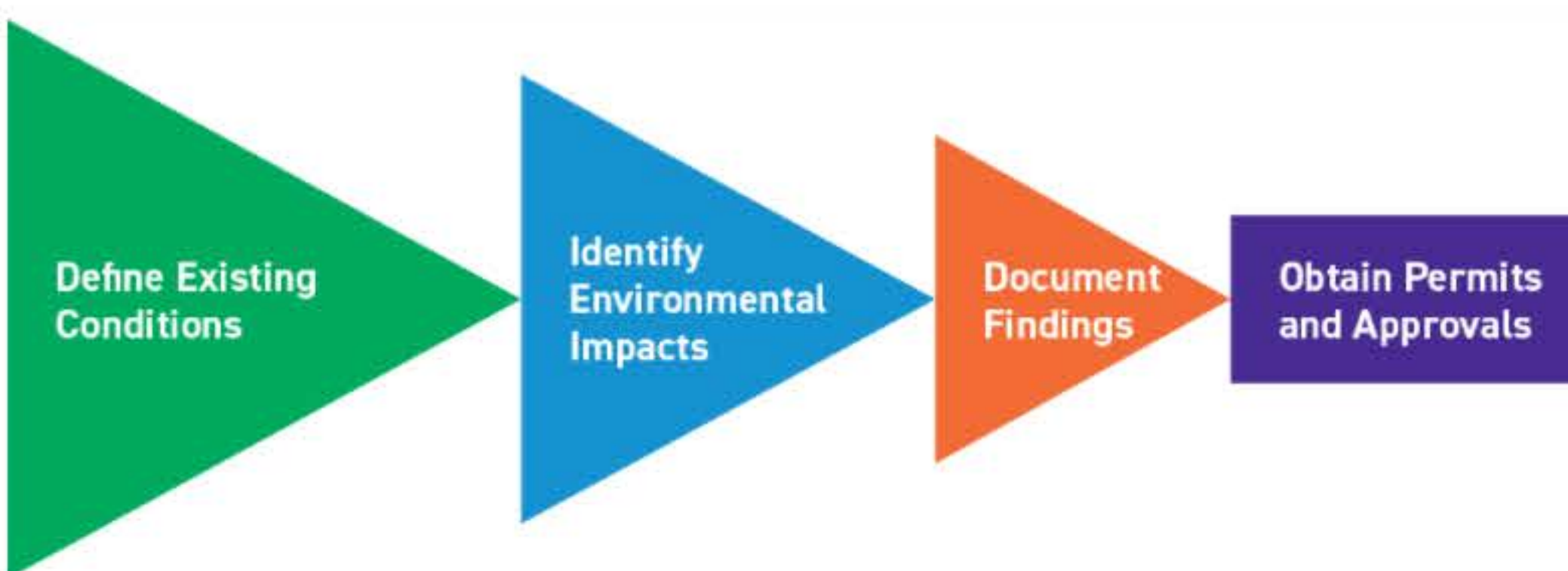

Define existing conditions | Identify Environmental Impacts | Document Findings | Obtain Permits and Approvals

- Collect current information to set an environmental baseline

Notes you make in this box will appear in the comment form on the last page of the open house.

GO TO NEXT PAGE

SIGN UP FOR EMAIL UPDATES ON THIS PROJECT:

First Name

Last Name

City

Email

* = REQUIRED FIELD

SUBSCRIBE

SHARE THIS WEBSITE:



CONTACT US:

NorthgateBridge@seattle.gov | (206) 615-0925
www.seattle.gov/transportation/NorthgatePedBridge.htm

NORTHGATE PED/BIKE BRIDGE PROJECT



ONLINE OPEN HOUSE—AUGUST 3-24



OTHER WALKING AND BIKING INVESTMENTS

(PAGE 6 OF 8)

1ST AVE NE BIKE/WALK TRAIL

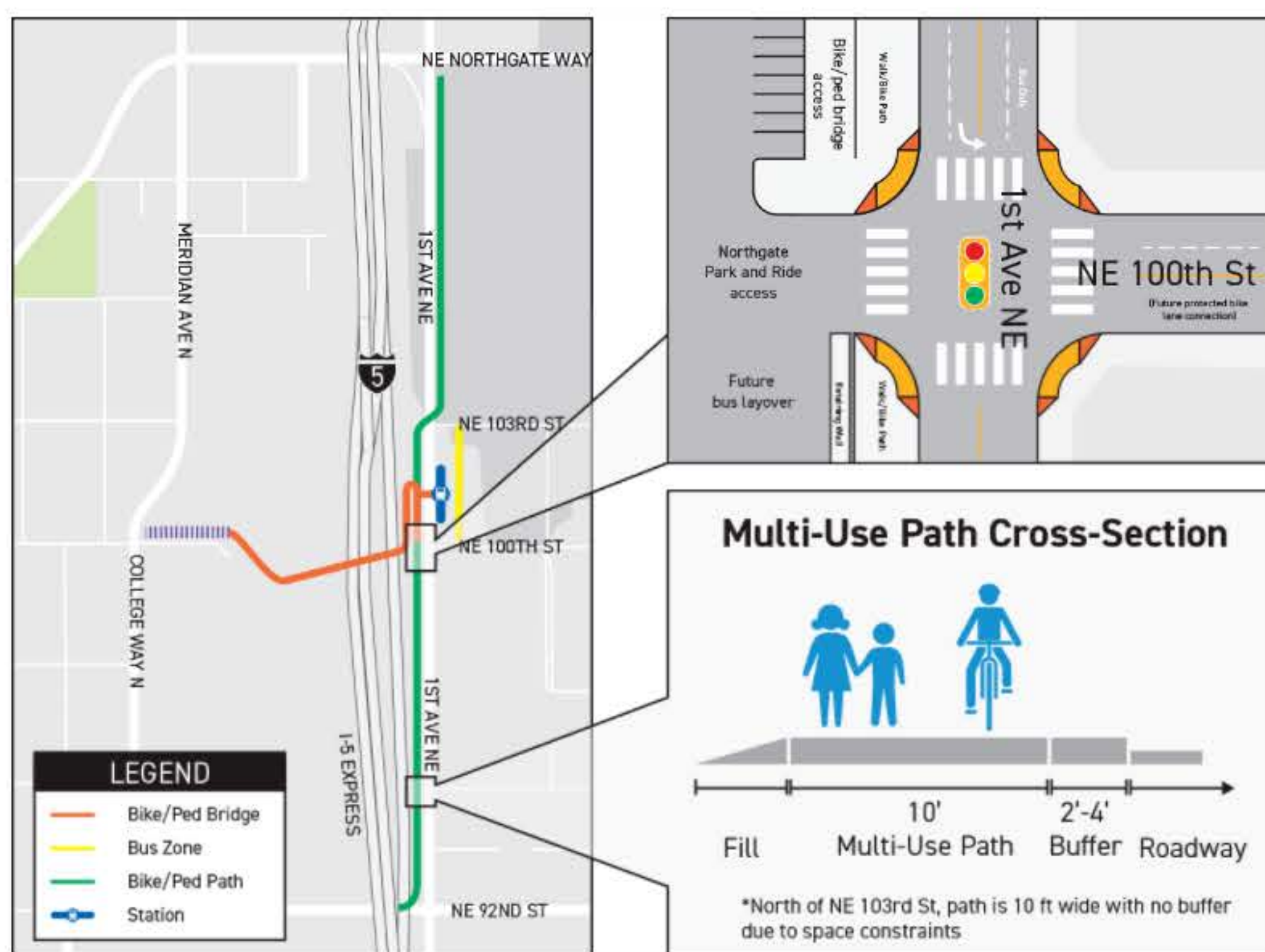

As part of the Northgate Bridge project, we're also building a bike/walk trail on 1st Ave NE between NE Northgate Way and NE 92nd St. In most places, the trail will be 10 feet wide, with 2-4 feet of buffer between the trail and 1st Ave NE.

A MORE WALKABLE AND BIKEABLE NORTHGATE

The Northgate Bridge is one of many improvements we're planning for the area. We'll create a more walkable and bikeable Northgate through investments that benefit all ages and abilities. This map highlights bike and pedestrian improvements in the area.

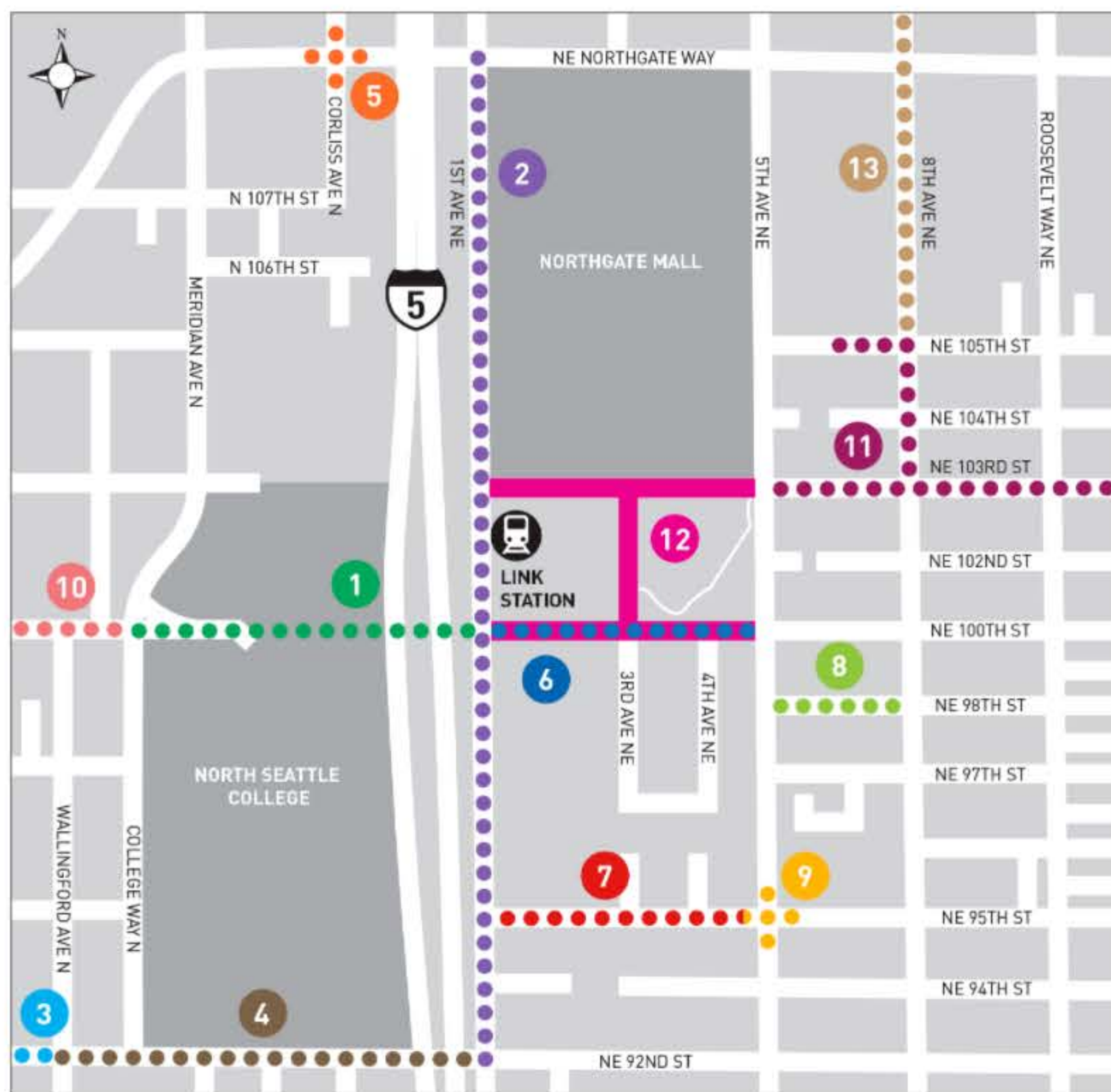

- 1 Northgate Ped/Bike Bridge
- 2 Multi-use path
- 3 Safe Routes to School Neighborhood Greenway
- 4 Protected bike lanes
- 5 Crossing improvements
- 6 Streetscape improvements & protected bike lanes
- 7 Sidewalk
- 8 Sidewalk
- 9 Crossing improvements
- 10 North Seattle Neighborhood Greenway (west to Crown Hill)
- 11 Northgate Neighborhood Greenway
- 12 Street concept plan (will inform private development street frontage improvements)
- 13 Northgate Neighborhood Greenway - Phase 2

RELATED PROJECTS

Projects we're coordinating with include:

- Northgate Neighborhood Greenway
- North Seattle Neighborhood Greenway & School Safety Project
- Northgate Street Concept Plan
- Sound Transit Northgate Link Light Rail
- King County Metro's Northgate Transit Oriented Development project

We're looking at improvements through a "multi-project" lens to make sure we coordinate outreach to the community and streamline information.

We're also coordinating closely with our partners at Sound Transit, King County Metro, and the Washington State Department of Transportation (WSDOT).

Notes you make in this box will appear in the comment form on the last page of the open house.

GO TO NEXT PAGE

SIGN UP FOR EMAIL UPDATES ON THIS PROJECT:

First Name

Last Name

City

Email

* = REQUIRED FIELD

SHARE THIS WEBSITE:



CONTACT US:

NorthgateBridge@seattle.gov | (206) 615-0925
www.seattle.gov/transportation/NorthgatePedBridge.htm

SUBSCRIBE



NORTHGATE PED/BIKE BRIDGE PROJECT



ONLINE OPEN HOUSE--AUGUST 3-24



DESIGN SURVEY

(PAGE 7 OF 8)

We're still designing the bridge and are eager to hear your feedback! Please take a moment to complete the questions below to tell us how you will use the bridge. The survey will be open through August 24. Thank you for your participation!

At right, you can learn more about our project artist, Charles Sowers.

ABOUT THE PROJECT ARTIST

Charles Sowers is an artist whose practice links art, science, and physical phenomena. An exhibit developer at the Exploratorium in San Francisco since 1998, he has created numerous works that directly engage the viewer. This has led to the creation of a kind of aesthetic/scientific instrumentation that reacts to a site and allows us insight into normally invisible or unnoticed phenomena. Through such work he hopes to engage people in an unexpected dialogue with their locale and provoke a desire to take notice of the beauty and curiousness of the world around them.

This artwork project is commissioned with SDOT 1% for Art funds.



WE NEED YOUR INPUT!

1 Which North Seattle neighborhood do you live in?

- Northgate
- Licton Springs
- Maple Leaf
- Haller Lake
- Bitter Lake
- Evergreen
- Lake City
- Olympic Hills
- Pinehurst
- Victory Heights
- Other (please specify):

My neighborhood:

2 What is your home zip code?

- 98125
- 98115
- 98133
- 98103
- 98117
- Other (please specify):

My zipcode:

3 How do you usually get around your neighborhood? (Choose your top 3)

- Walk (or use mobility device)
- Bike
- Bus, trolley, or train
- Personal car, truck, or van
- Rideshare (taxi, Uber, Lyft, etc.)
- Carshare (Car2Go, Zipcar, etc.)

4 Do you plan on using the bridge?

- Yes, for walking (or using a mobility device)
- Yes, for biking
- Yes, for both biking and walking (or using a mobility device)
- No, I don't plan on using the bridge
- Other (please specify):

My plans for using the bridge:

5 If yes, what will you use it for? (Choose all that apply)

- Commuting to work
- Commuting to school
- Accessing transit
- Making nearby trips in my neighborhood
- Other (please specify):

What I may use the bridge for:

6 If yes, how often do you think you'll use the bridge?

- Daily
- Weekly
- Monthly
- A few times a year

7 If you plan to use the bridge, will you use it to access any of the following locations? (Choose all options that apply to you)

- Retail
- Sound Transit Link light rail station
- King County transit center
- North Seattle College
- Area schools and parks
- Local bike network (greenways, bike lanes, etc.)
- Area neighborhoods such as:

Neighborhoods I may access:

- Other (please specify):

Other locations I may access:

8 How familiar are you with this bridge project?

- Very
- Somewhat
- Not at all

9 Please rank the following project goals from 1 to 4, in order of importance to you, with 1 being most important and 4 being least important.

- 0 Reduce travel times between the east and west sides of I-5
- 0 Add a new, accessible walking/biking route in Northgate that connects to the citywide network
- 0 Connect to regional transit, including the existing transit center and future Link light rail station
- 0 Connect to North Seattle College

10 Pavement textures and colors can create wayfinding and distinct places along the bridge. They also provide visual and tactile guidance to areas of slower travel during times of high traffic.



Tell us what you think.

11 Lighting will increase visibility and create a more comfortable experience for people crossing the bridge at night. Here are some examples.

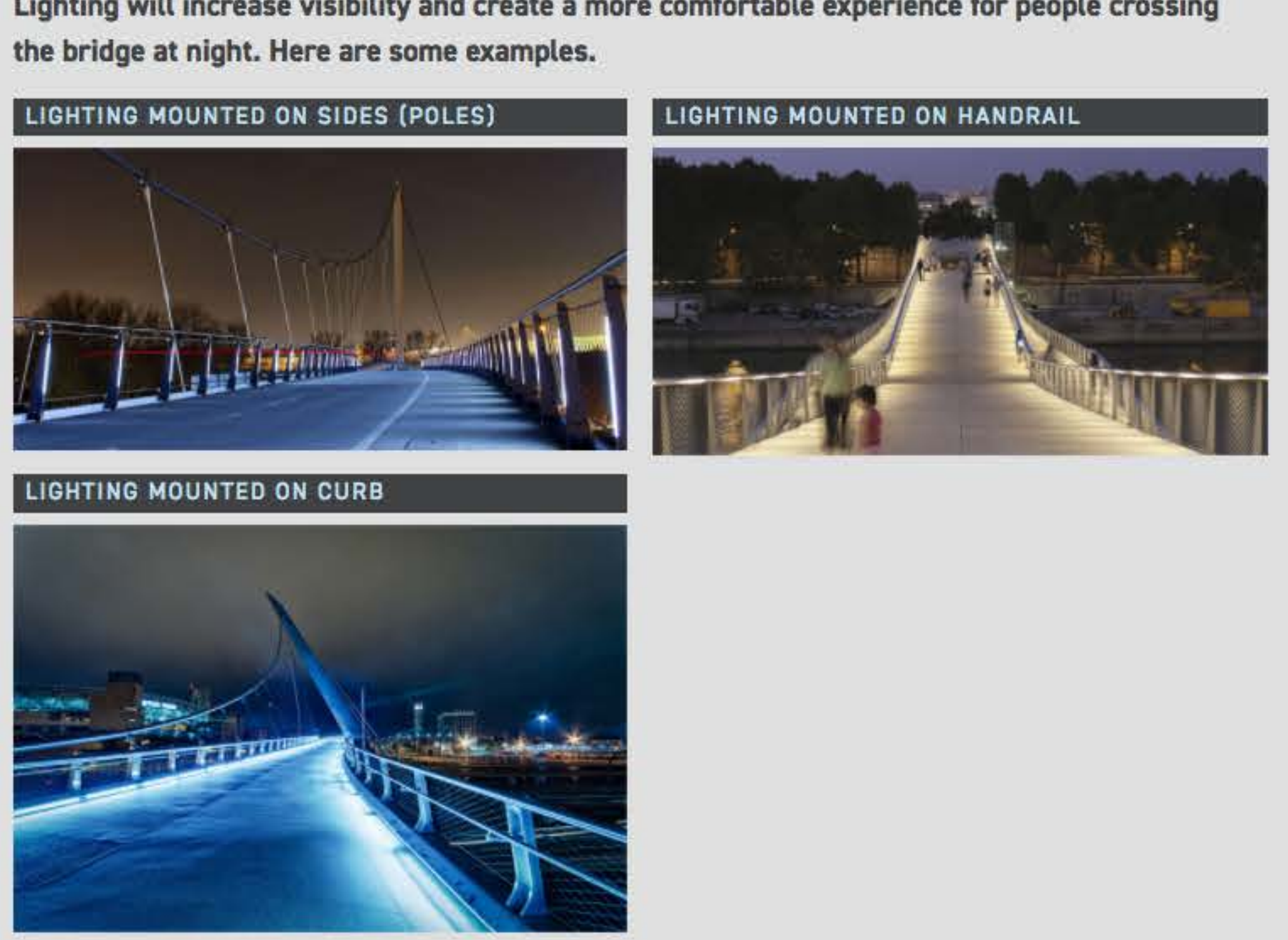

Tell us what you think.

12 The bridge landings, where the bridge connects with at-grade connections, are supported by short walls. Below are descriptions of treatments for the east and west landings.

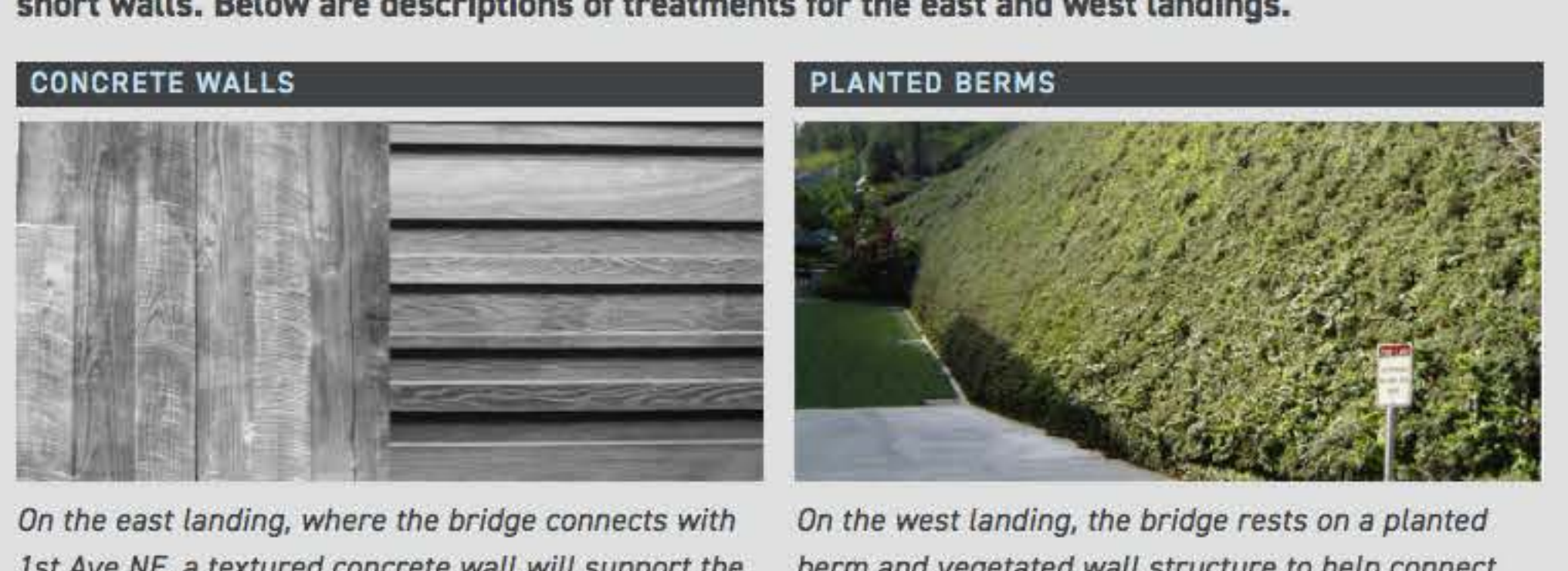

On the east landing, where the bridge connects with 1st Ave NE, a textured concrete wall will support the approach structure, and allow for plants to cover the surface. On the west landing, the bridge rests on a planted berm and vegetated wall structure to help connect the structure to the at-grade path.

Tell us what you think.

13 Is there additional feedback you'd like to share?

OPTIONAL

Please tell us a little bit more about you so that we can understand how inclusive our outreach has been.

What is your age?

- 19 or younger
- 20-24
- 25-34
- 35-44
- 45-54
- 55-64
- 65 or older
- I'd rather not say

Do you have a disability? (Check all that apply)

- Mobility
- Vision
- Hearing
- Cognitive
- None
- Other (please specify):

Other disability:

What race/ethnicity best describes you?

- Asian or Pacific Islander
- Black or African-American
- Hispanic or Latino
- White or Caucasian
- Two or more races
- I'd rather not say
- Other (please specify):

Other (write-in):

What gender do you identify with?

- Female
- Male
- Transgender or genderqueer
- I'd rather not say
- Optional self-identification:

Other self-identification:

What is your annual household income?

- \$7,500 or less
- \$7,501 to \$15,000
- \$15,001 to \$25,000
- \$25,001 to \$35,000
- \$35,001 to \$55,000
- \$55,001 to \$75,000
- \$75,001 to \$100,000
- \$100,001 to \$150,000
- \$150,001 to \$200,000
- More than \$200,000
- I don't know
- I'd rather not say

What is your current housing situation?

- Rent single-family home
- Rent apartment, room, duplex, or dorm
- Own single family home
- Own condominium, co-op, duplex
- Stay with friends or family
- Homeless

How did you hear about this online open house? (Check all that apply)

- City of Seattle/SDOT mailer
- City of Seattle/SDOT email
- Web
- Poster
- Social media (Facebook, blogs, etc.)
- My employer
- An organization I'm involved with
- Friend
- Other

How you heard about us:

SUBMIT SURVEY RESPONSES

GO TO NEXT PAGE

SIGN UP FOR EMAIL UPDATES ON THIS PROJECT:

First Name Last Name
City Email

* = REQUIRED FIELD

SUBSCRIBE

SHARE THIS WEBSITE:



CONTACT US:

NorthgateBridge@seattle.gov | (206) 415-0925
www.seattle.gov/transportation/NorthgatePedBridge.htm



NORTHGATE PED/BIKE BRIDGE PROJECT



ONLINE OPEN HOUSE—AUGUST 3-24



MORE WAYS TO BE INVOLVED

(PAGE 8 OF 8)

In the year ahead, as we finalize design of the bridge project, you'll have opportunities to learn more about it. Our team will be in the community making presentations, sending information to project neighbors, and hosting pop-up tables at busy public spaces.

FOLLOW ALONG

	2017	2018	2019	2020	2021
Planning and design	██████████	██████████			
Environmental review and approval	██████████	██████████		Bridge opens!	Sound Transit Link light rail station opens
Bridge construction			██████████	██████████	

HERE ARE A FEW WAYS TO STAY INVOLVED:

- Attend an interest group roundtable. In September we plan to hold a few roundtables focused on bike connectivity and accessibility. If you are interested, [email us](#) to let us know. Please remember to note whether your interest is Bike Connectivity or Accessibility.
- Sign up for email updates below
- Send us your questions and comments. You can do this today through this open house, or if you have questions later on, feel free to email us: NorthgateBridge@seattle.gov

THANK YOU!

SIGN UP FOR EMAIL UPDATES ON THIS PROJECT:

First Name

Last Name

City

Email

* = REQUIRED FIELD

SUBSCRIBE

SHARE THIS WEBSITE:



CONTACT US:

NorthgateBridge@seattle.gov | (206) 615-0925
www.seattle.gov/transportation/NorthgatePedBridge.htm