



Beacon Ave S / 15th Ave S Safety Project 90% Design Milestone & Parking Management Plan

November 2023



Project Team



Janet Loriz
Project Manager



Hallie O'Brien
Project Developer



Brian Hamlin
Curbside Management Specialist



Ching Chan
Public Engagement Lead



Our Vision, Mission, Values, & Goals

Seattle is a thriving equitable community powered by dependable transportation. We're on a mission to deliver a transportation system that provides safe and affordable access to places and opportunities.

Core Values & Goals:

Equity, Safety, Mobility, Sustainability, Livability, and Excellence.



Agenda

- Project background
- Community feedback themes
- 90% design plans
- Finalized Parking Management Plan
- Project schedule and next steps
- Questions



Project goals

- **Improve Safety**
- **Create connections**
- **Enhance access**

for all community members and travelers

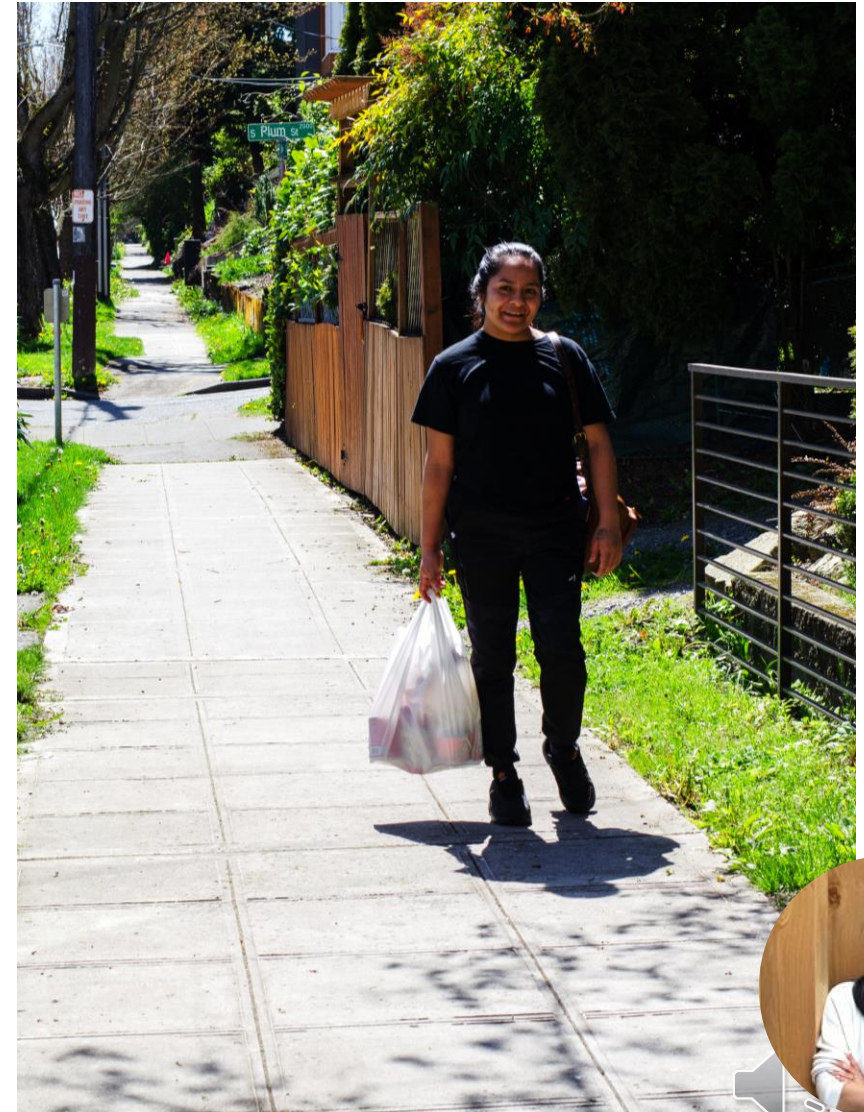

Community feedback themes



- Unsafe driving
- Poor street and sidewalk conditions, including drainage issues
- Racial and economic equity consideration
- Loss of parking concerns
- Maintain access to homes and businesses



90% Design Plans



What's changed since 60% design

- Installed new all-way stop at the intersection of 14th Ave S/15th Ave S/Golf Dr S (speed cushion will be removed)
- Add new speed cushion on 15th Ave S between S Atlantic St and 14th Ave S
- Add two ADA-compliant curb ramps at 15th Ave S & S Bayview St
- Finalized parking management plan
- Early pavement repairs on 15th Ave S between Golf Dr S and Beacon Ave S



90% Design



S Charles St and Golf Dr S

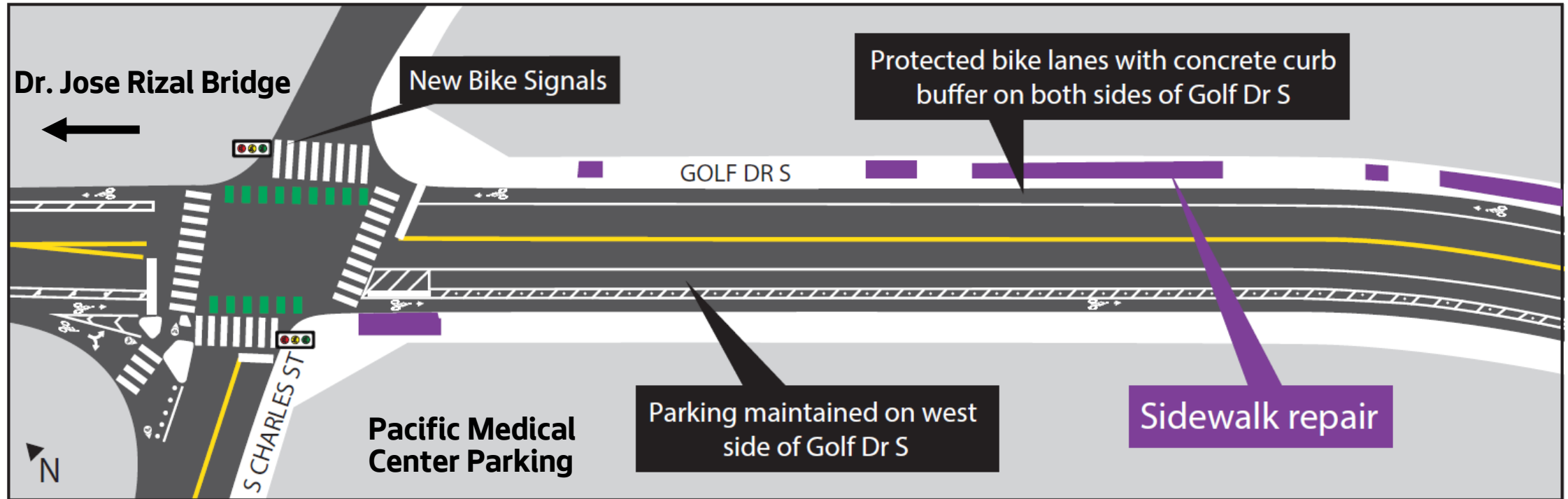

90% Design



15th Ave S and 14th Ave S intersection (Updated)

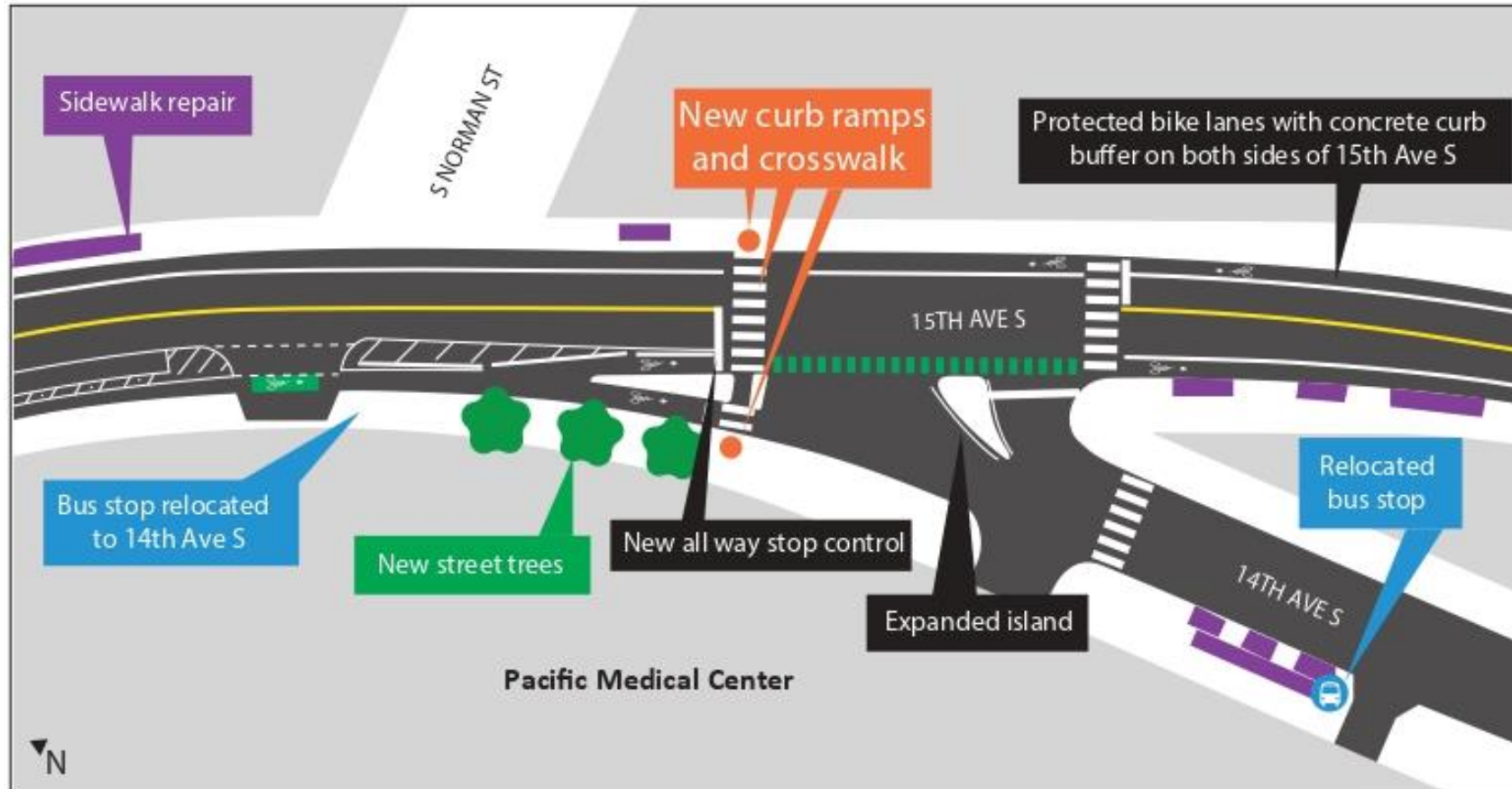

90% Design



15th Ave S and S Judkins St

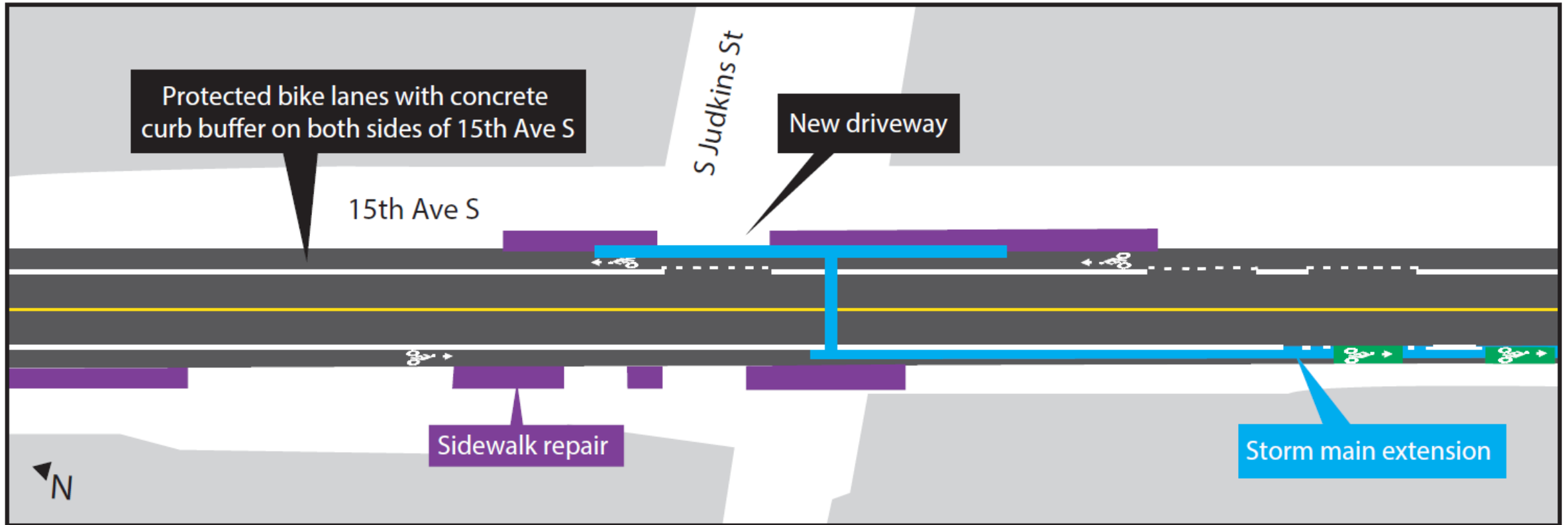



90% Design

15th Ave S and S Atlantic St (Updated)

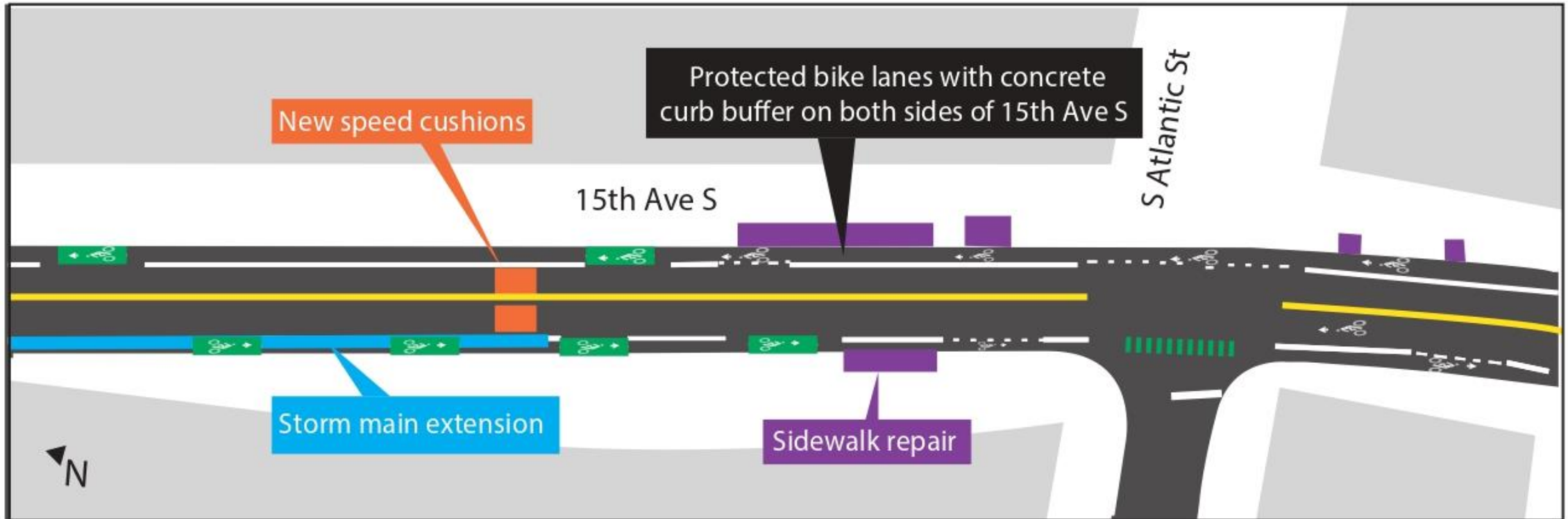

90% Design



15th Ave S and S Massachusetts St

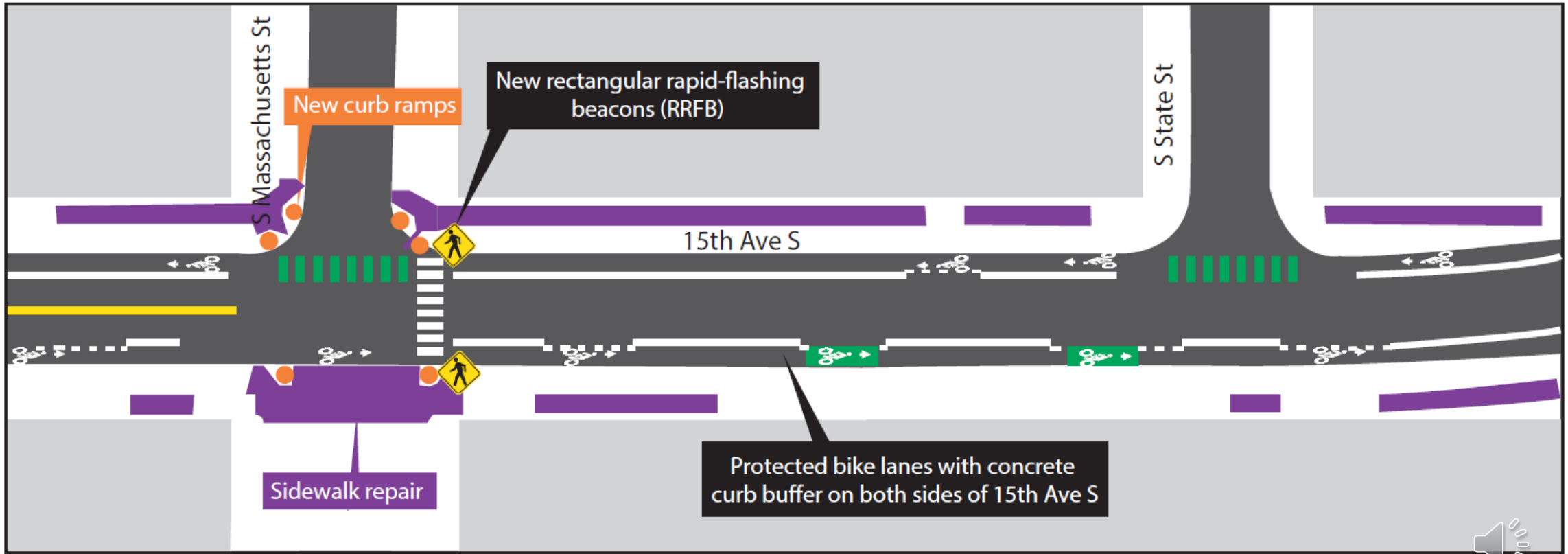

90% Design



15th Ave S between S Hill St and S Walker St

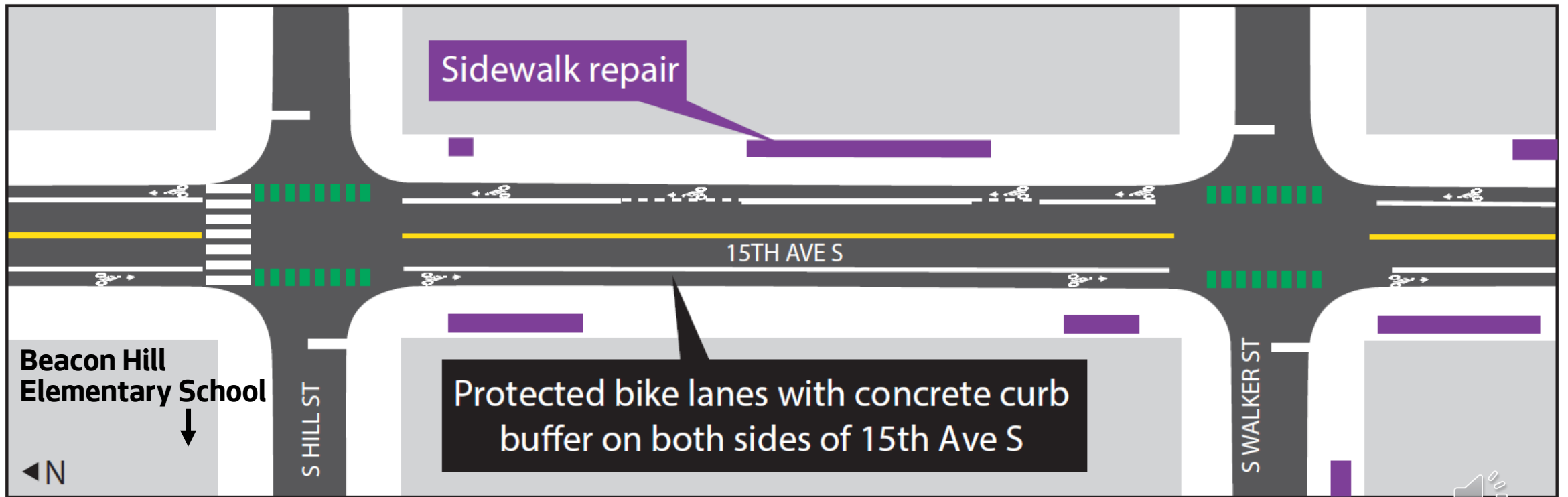

Sidewalk repair

15TH AVE S

Beacon Hill Elementary School

S HILL ST

Protected bike lanes with concrete curb buffer on both sides of 15th Ave S

S WALKER ST



90% Design



15th Ave S and S College St

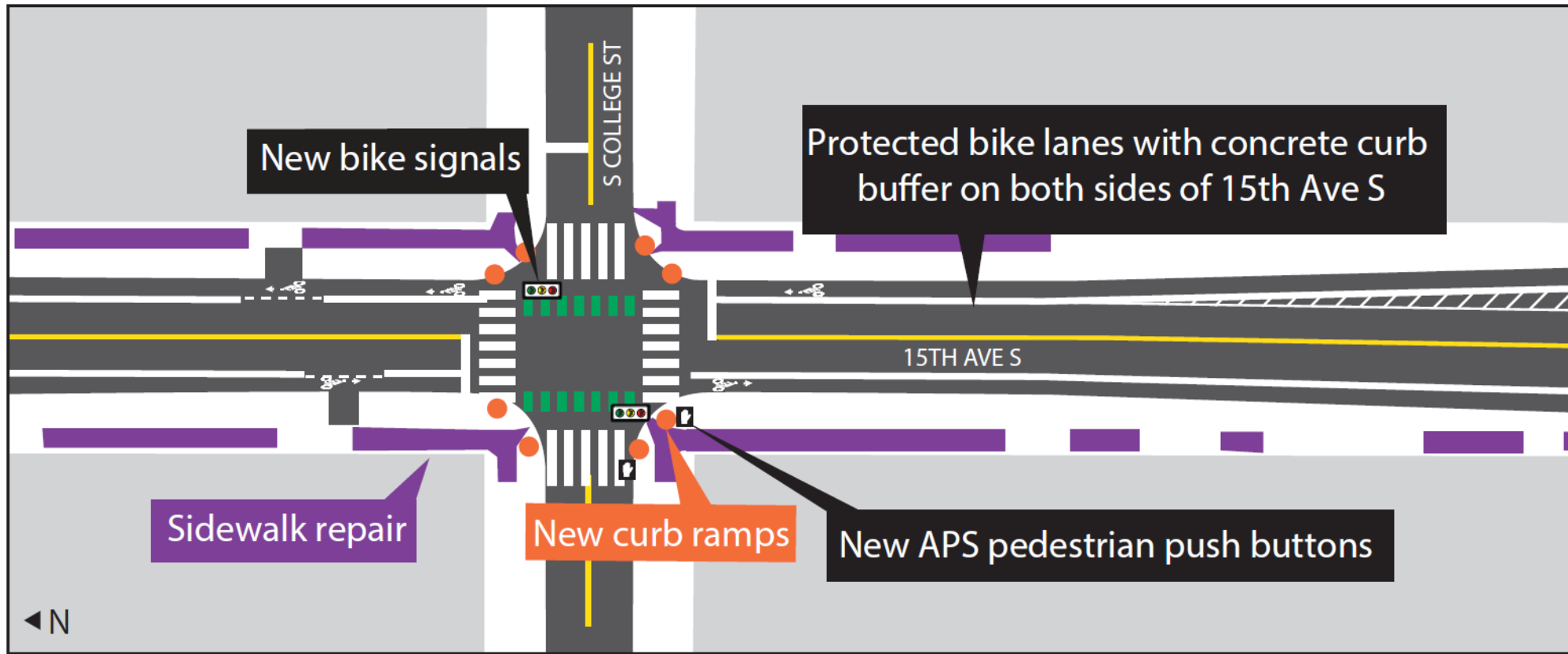

90% Design



15th Ave S between S College St and S Bayview St

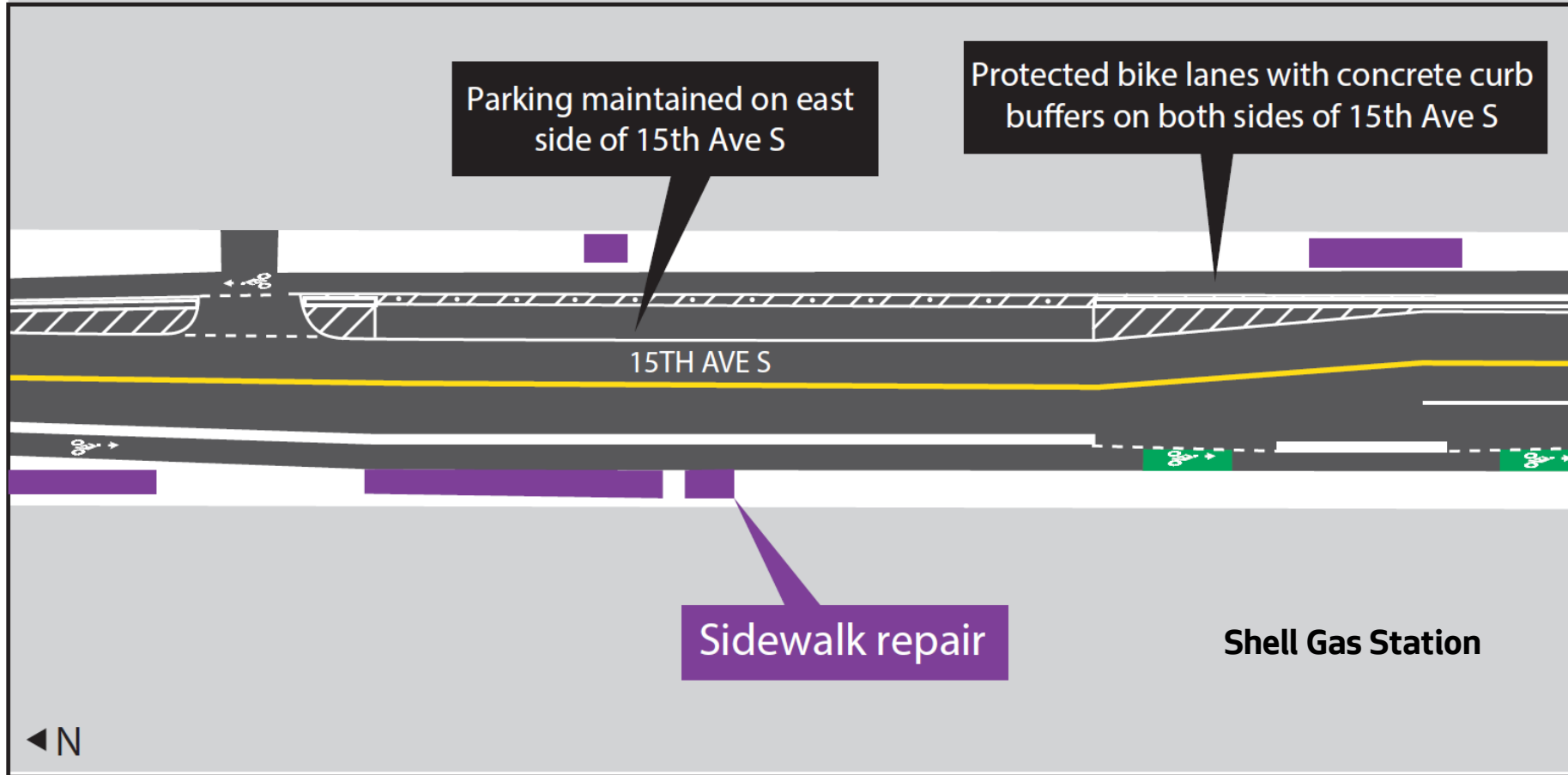



90% Design

15th Ave S and Beacon Ave S Intersection (Updated)

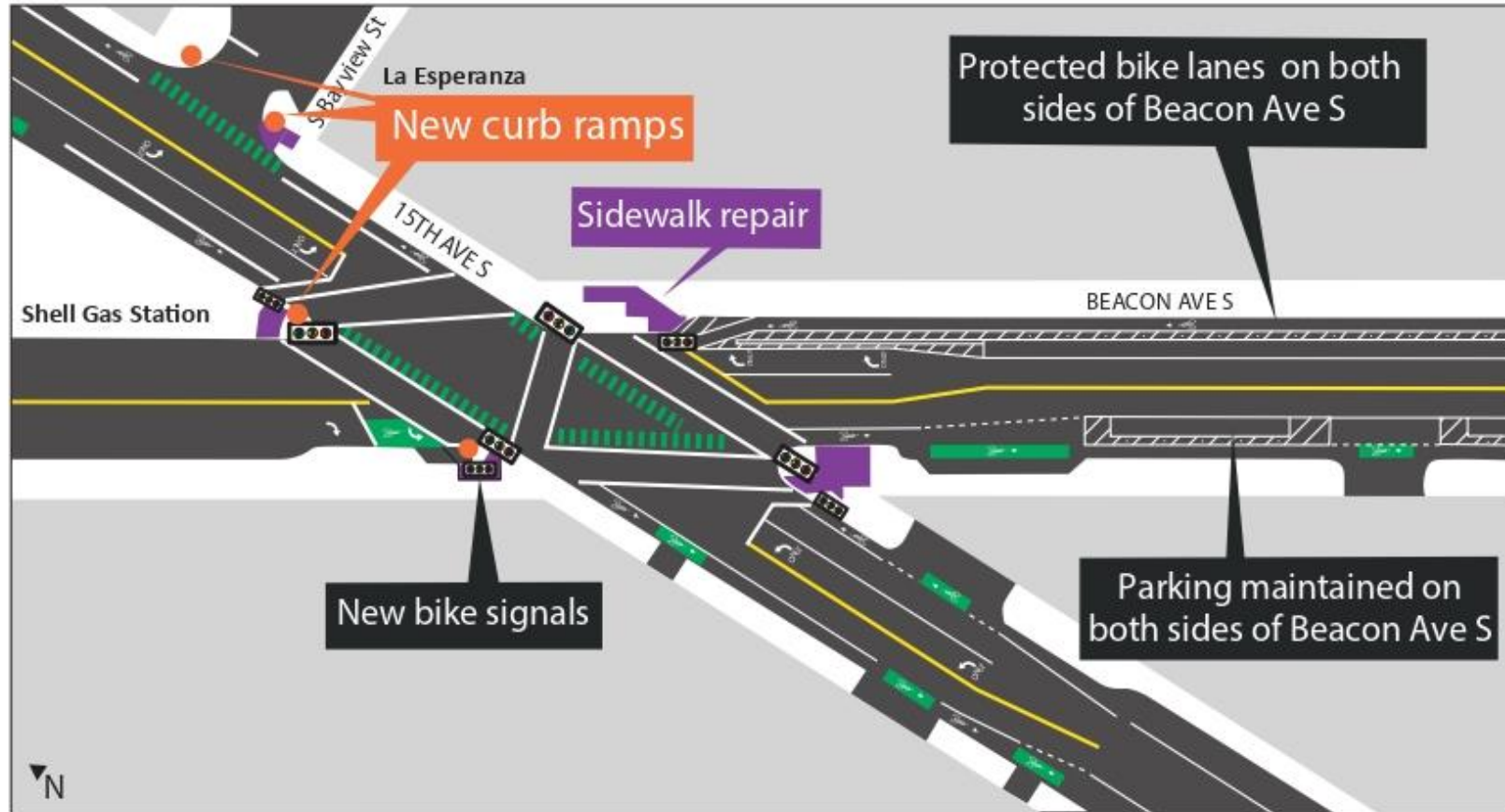



90% Design

Beacon Ave S and S Lander St (Light Rail Station)

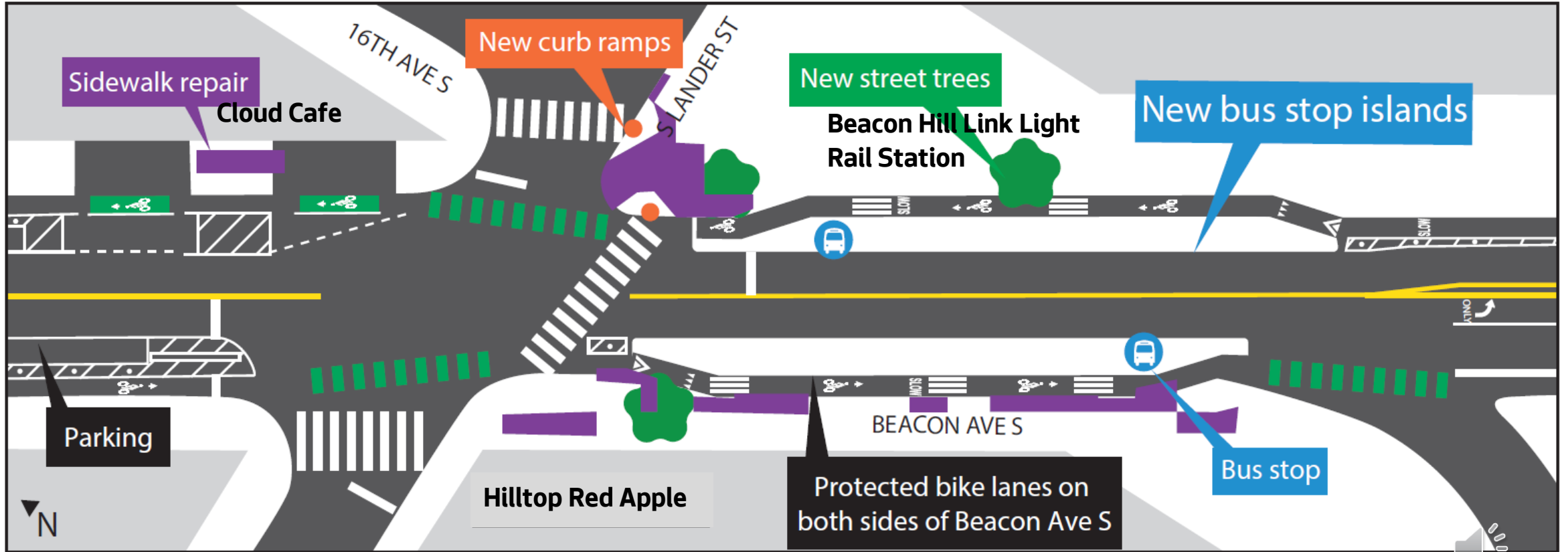

90% Design



Beacon Ave S and S McClellan St

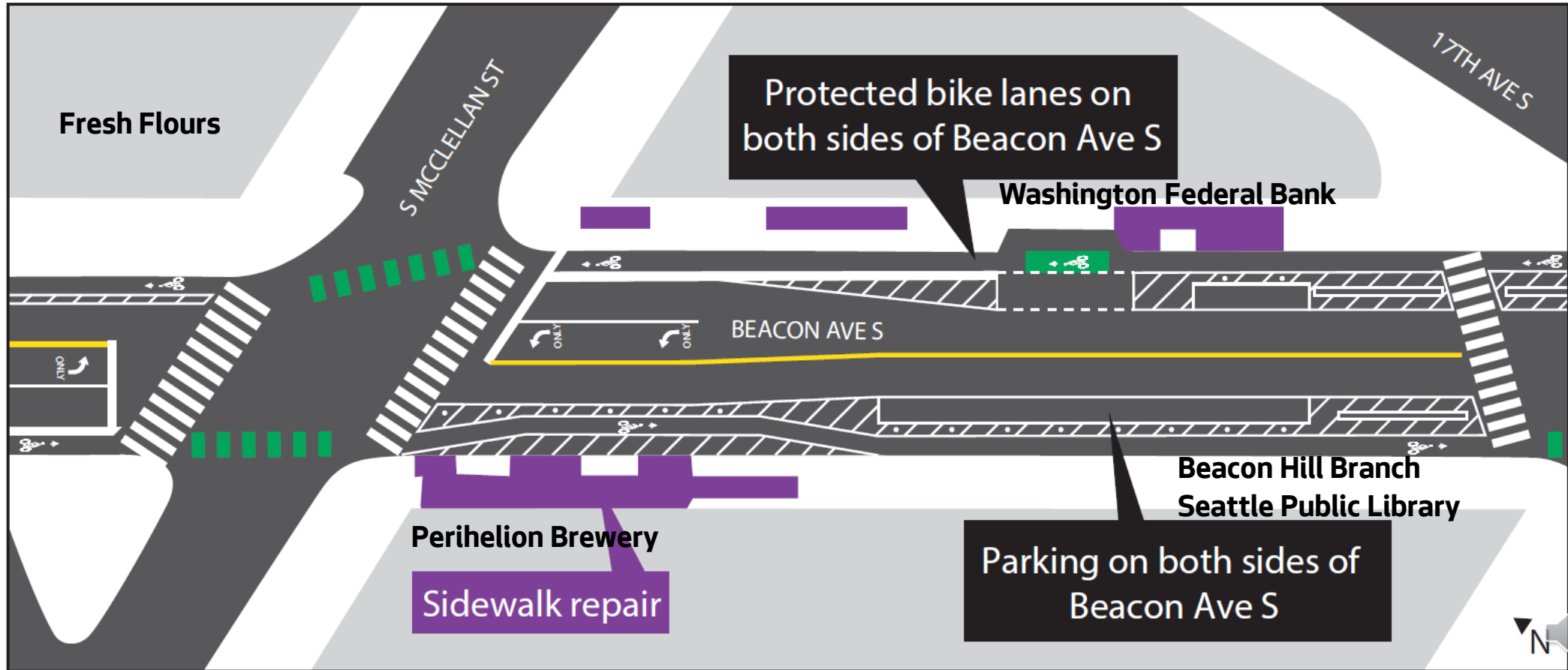

90% Design



Beacon Ave S and S Forest St

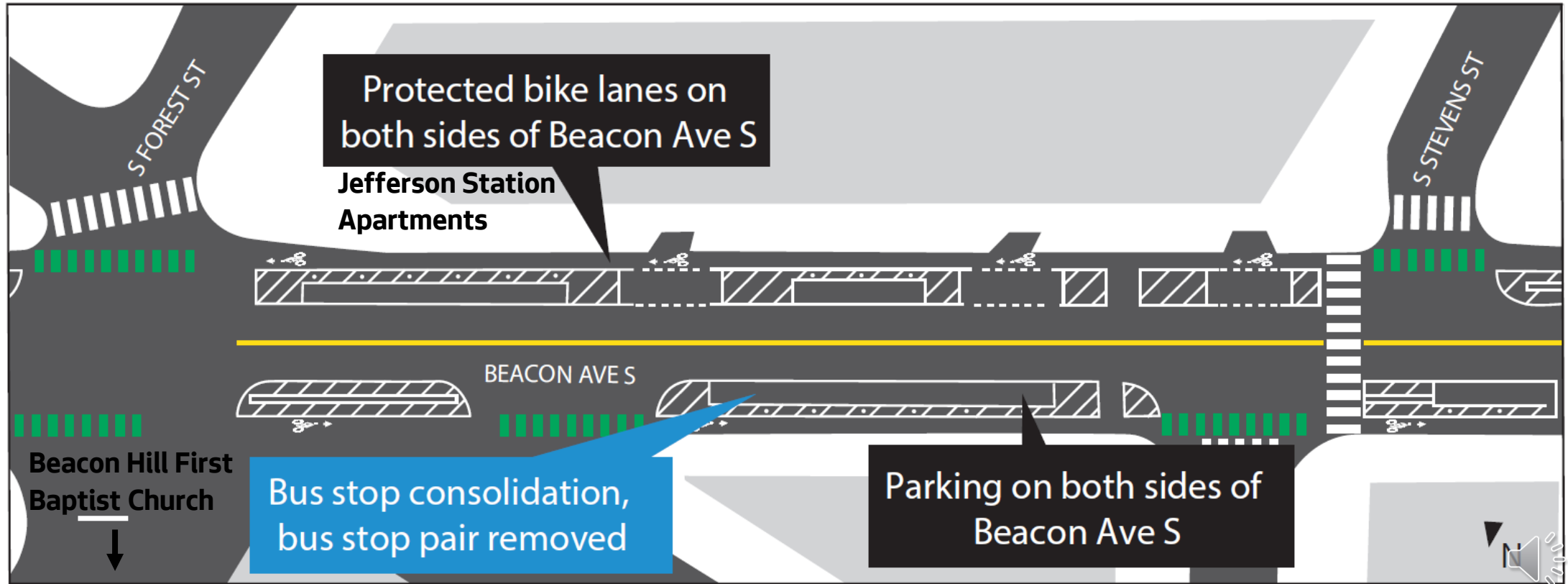

90% Design



Beacon Ave S and S Stevens St

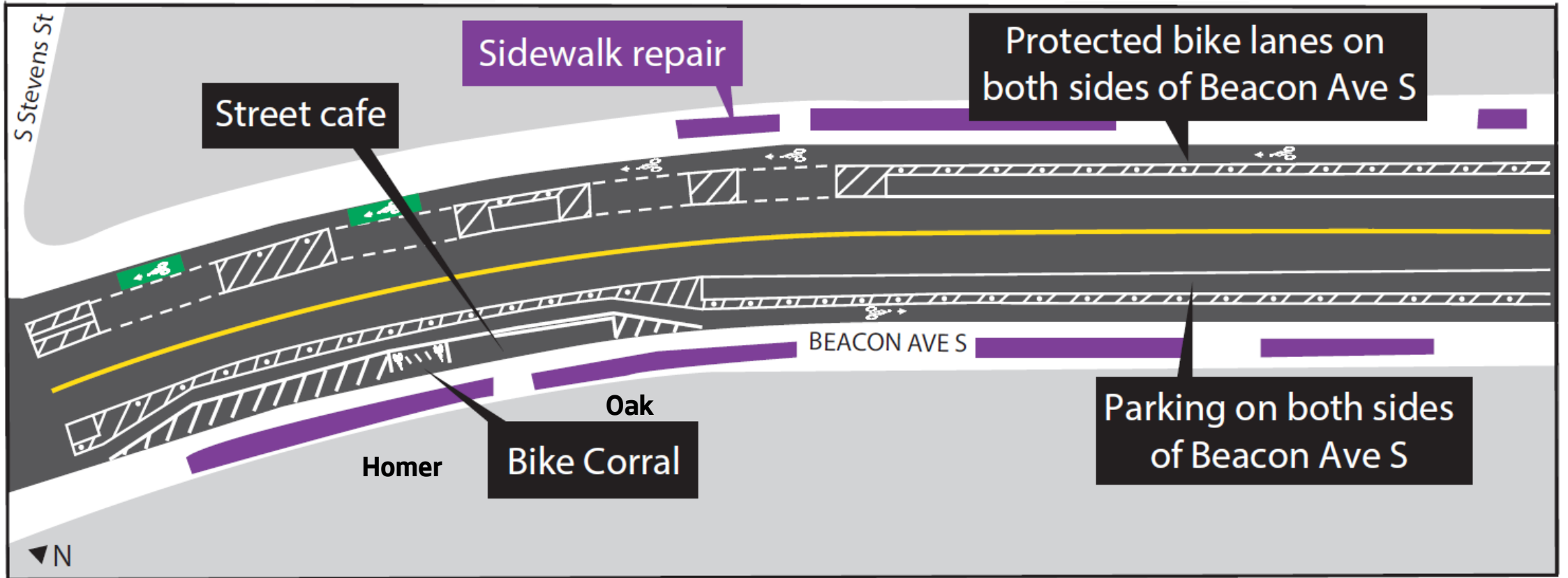

90% Design



Beacon Ave S and S Hanford St

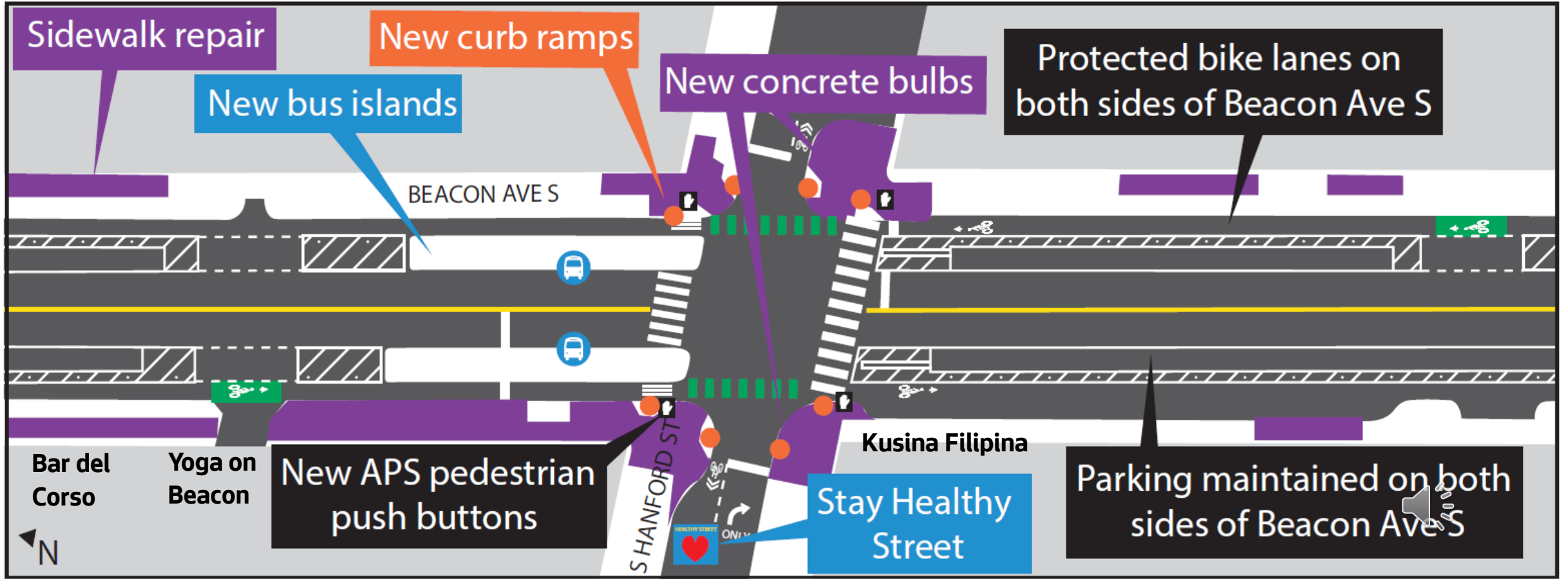

90% Design



Beacon Ave S and S Horton St

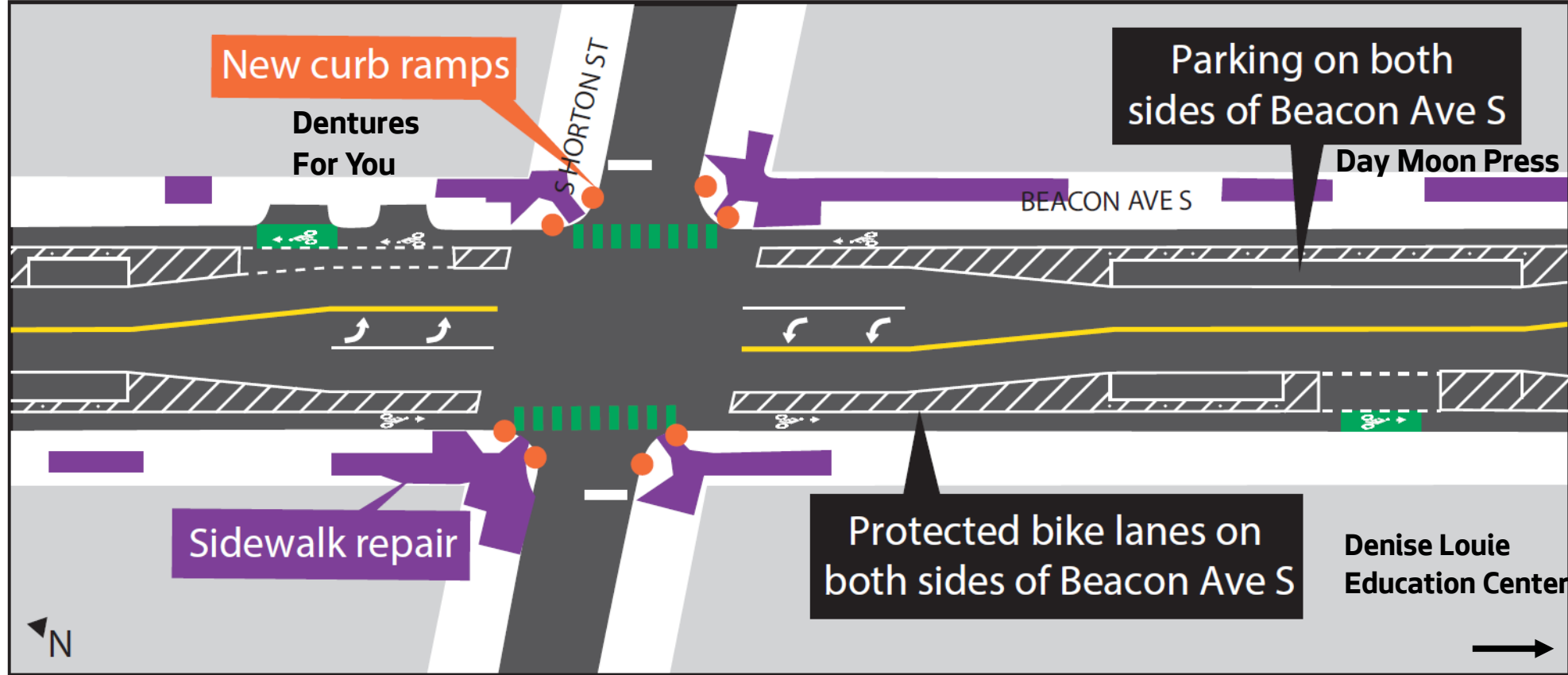

90% Design



Beacon Ave S between S Hinds St and S Spokane St (Updated)

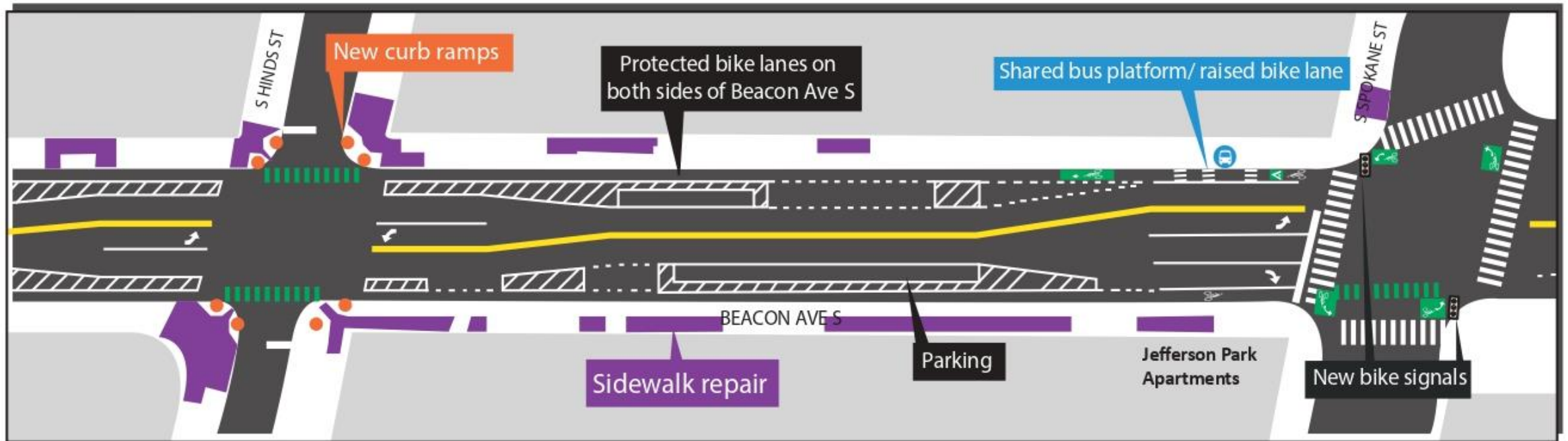

Final Parking Management Plan



Parking Management Plan (North)

• Background

- Plan driven by community request and feedback, informed by [third-party parking study](#) (summer 2022)
- Parking study = neighborhood parking can absorb, some residents will need to walk a little further
- Majority of residents have off-street parking or side street access

• **Strong desire** from community for parking improvements where feasible

• **What we've been up to**

- Evaluated every block within 2-3 streets of 15th Ave S
- 4 locations identified for on-street parking improvements and reorganization

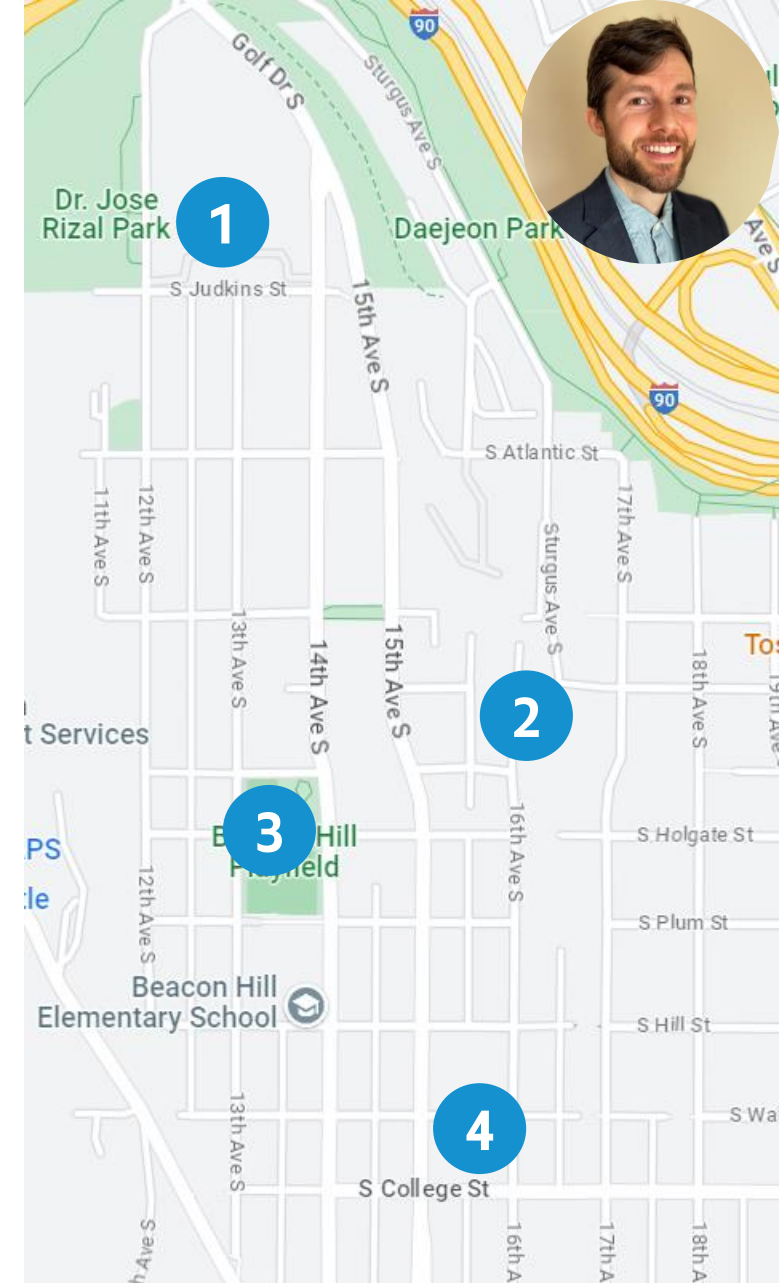

1 S Judkins St b/w 12th Ave S and 14th Ave S



Spring 2024

2 S Grand St b/w 16th Ave S and Sturgus Ave S



ASAP

3 14th Ave S b/w S Grand St and S Plum St



Spring 2024

4 S College St b/w 15th Ave S and 16th Ave S

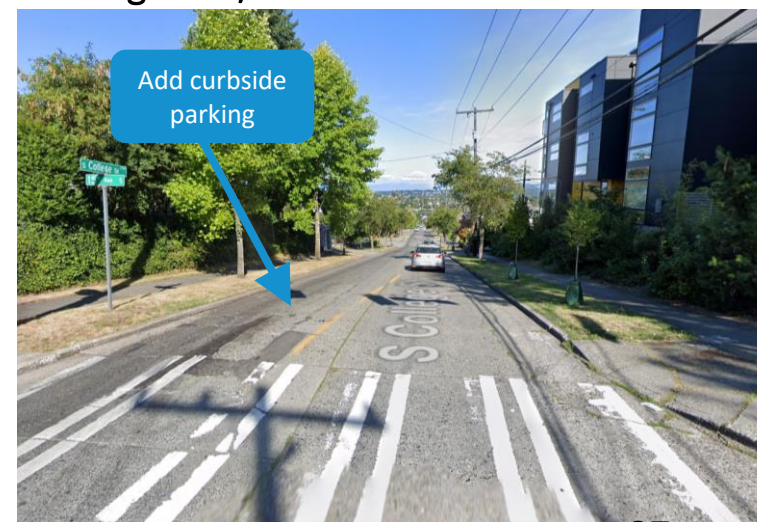

ASAP

27



Parking Management Plan (North)

Next steps

- Notify residents of RPZ expansion on S Judkins St in winter 2024
- Communicate low income RPZ permit option to residents who can benefit (\$10)
- Work with residents interested in further expanding RPZ boundaries
- Begin sign changes for added parking after notifications sent
- Continue work on new parking on west side of 14th Ave S (adjacent to Beacon Hill Elementary) between S Grand St and S Holgate St

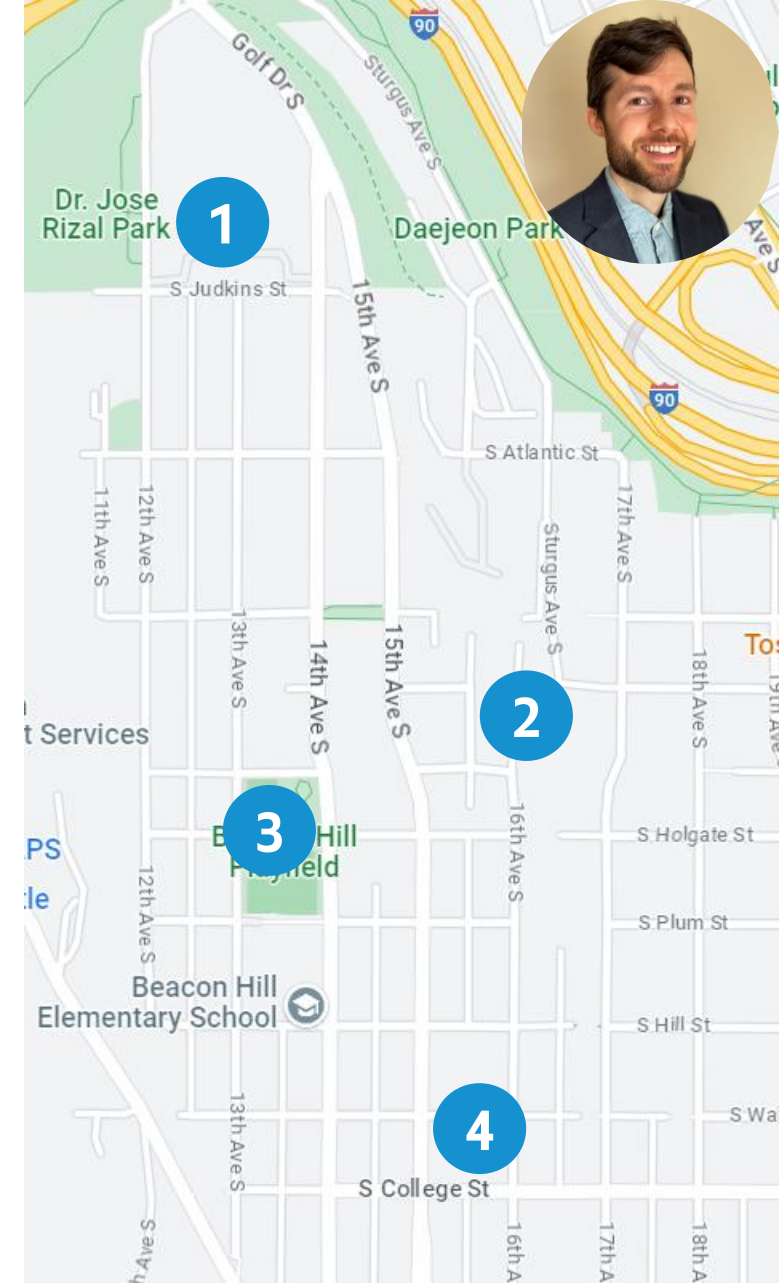

Next steps



Continue Door-to-Door Outreach

Identifying individual parking needs on 15th Ave S

- What we've heard:
 - Many have off-street parking options
 - Concern about:
 - Neighbors who rely on 15th Ave S for parking
 - Where delivery services, caregivers, visitors, etc. will park
 - Garbage, recycling, and compost pick-ups
- What's next:
 - Parking changes on 15th Ave S may begin as soon as summer 2024
 - Continue door-to-door and share on-street parking options nearby to provide flexibility and help neighbors plan ahead

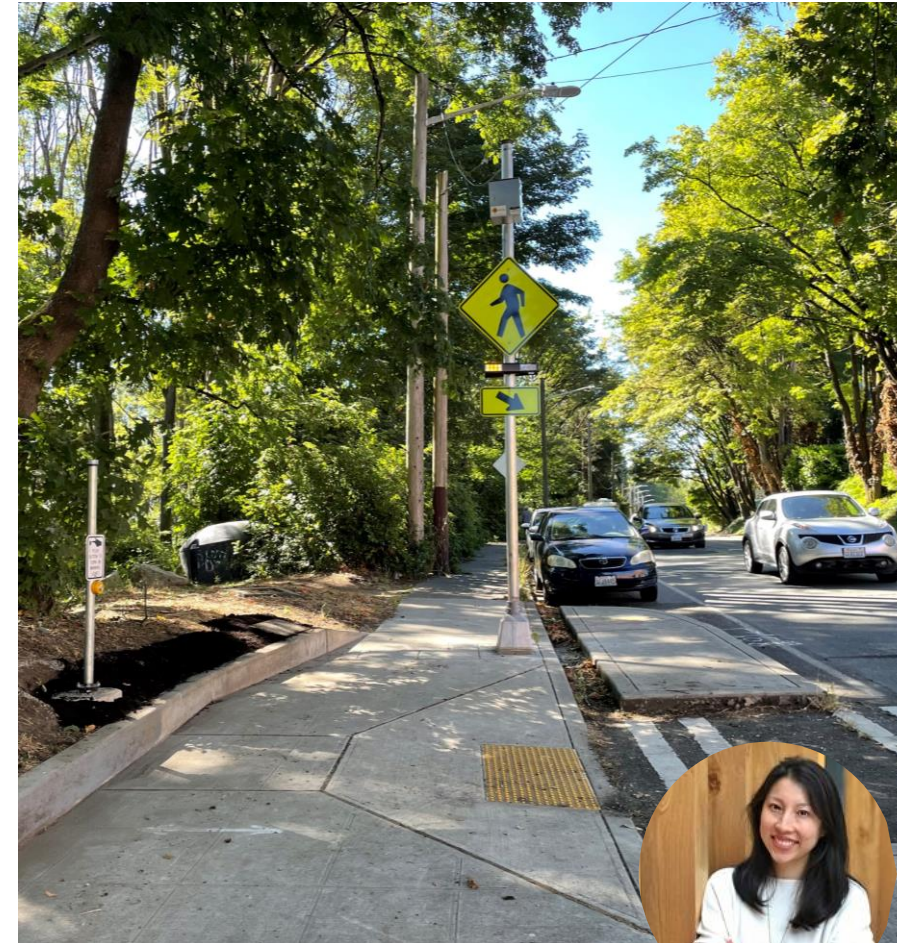



Project Schedule

- Ongoing outreach (parking changes, load zones for businesses, bike parking, etc.)
- Final design is expected in early 2024
- Call for contractor bids spring 2024
- Construction in 2024

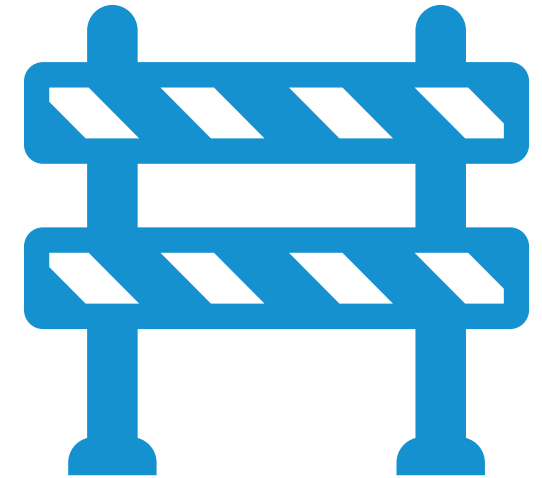

we are here →



Questions?

Stay in touch:



Beacon15thSafety@seattle.gov



206.900.8728



www.seattle.gov/transportation/Beacon15thSafety

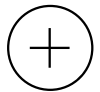

From the entire SDOT Team:
Thank you!

