

Appendix A

Conceptual Design Plans (Recommendation)

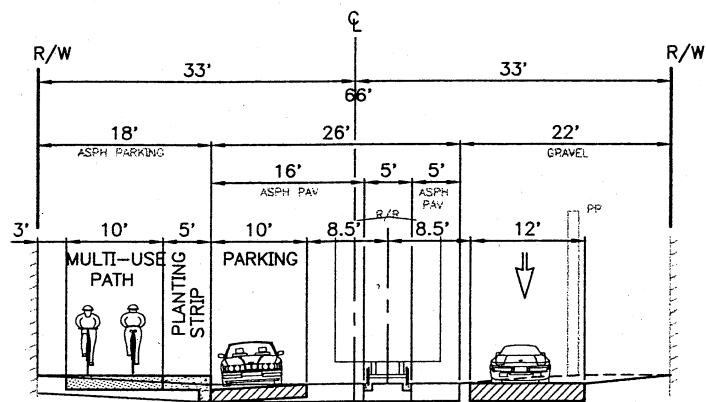

SECTION C-C₁
NW 45TH ST
11TH AVE NW TO 14TH AVE NW
SCALE: 1" = 10'

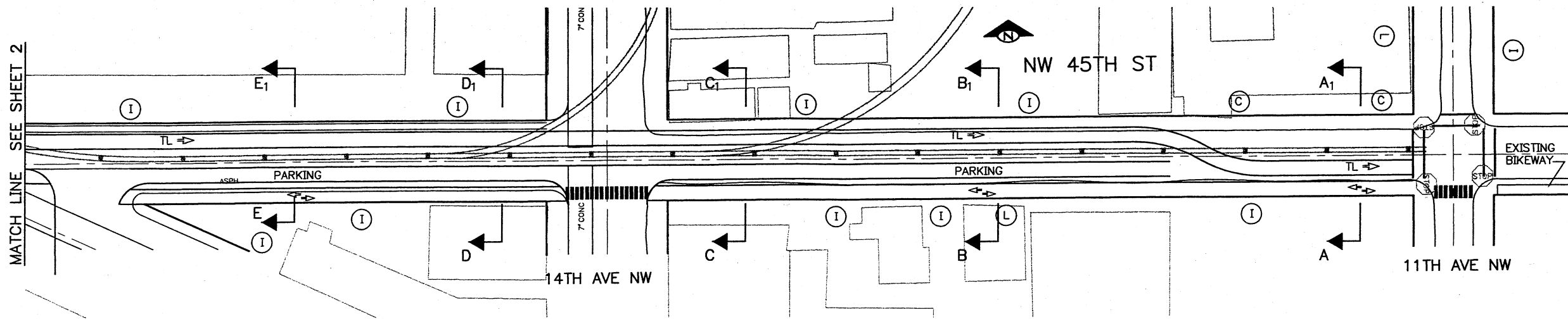
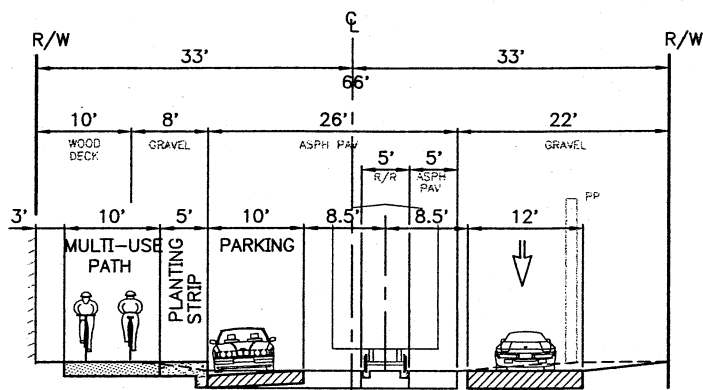

SECTION B-B₁
MID-BLOCK OF NW 45TH ST
11TH AVE NW TO 14TH AVE NW
SCALE: 1" = 10'

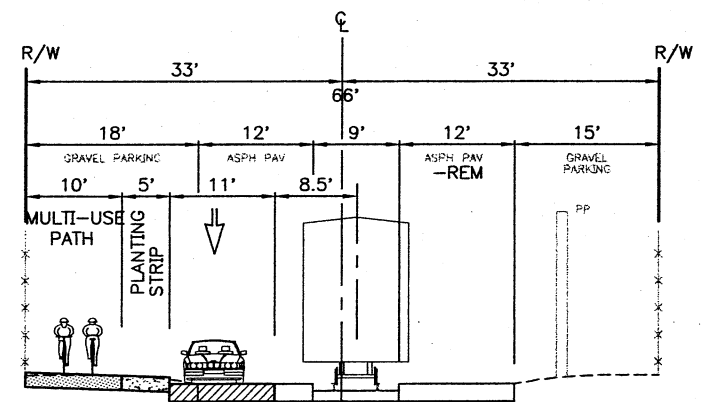

SECTION A-A₁
NW 45TH ST
11TH AVE NW TO 200' N
SCALE: 1" = 10'

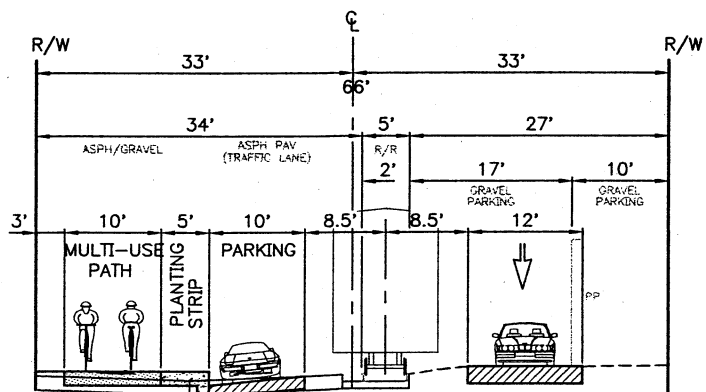

SECTION E-E₁
NW 45TH ST
14TH AVE NW TO 15TH AVE NW
SCALE: 1" = 10'

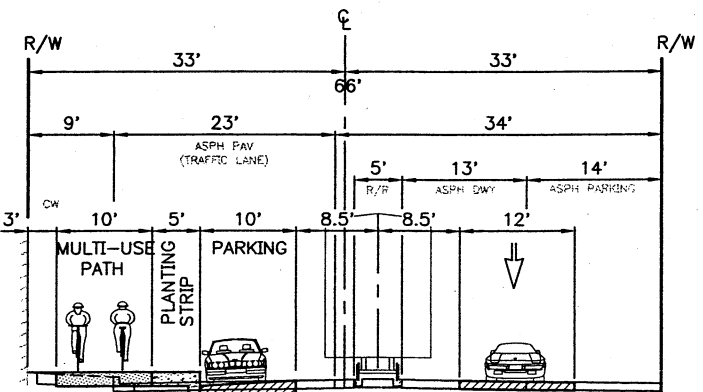

SECTION D-D₁
NW 45TH ST
14TH AVE NW TO 100' W
SCALE: 1" = 10'

DRIVEWAY LEGEND

- (R) = RESIDENTIAL
- (C) = COMMERCIAL
- (I) = INDUSTRIAL
- (L) = LOADING DOCK

RECOMMENDED ROUTE

P:\STREET\TS3547P\RECOMMENDED_FINAL.DWG

IMPORTANT!!!
Please be advised that this plan sheet is just one piece of a technical design study to evaluate SEVERAL options for routing pedestrians and bicycles through the South Ballard corridor from roughly 11th Ave NW to the Ballard Locks. This plan sheet represents one piece of one alternative included in the conceptual design. For more information on the study and the routes included in the study, please visit the project web site:
www.cityofseattle.net/td/bcdd11thlocks.asp

APPROVED FOR ADVERTISING
SEATTLE, WASHINGTON 20
BY:
CONTRACTING MANAGER

NAME OR INITIALS AND DATE	INITIALS AND DATE
DESIGNED	REVIEWED:
CHECKED	DES. SPU CONST.
	TRANS. PROJ. MGR.
DRAWN	RECEIVED
CHECKED	REVISED AS BUILT
ALL WORK DONE IN ACCORDANCE WITH THE CITY OF SEATTLE STANDARD PLANS AND SPECIFICATIONS AND OTHER DOCUMENTS CALLED FOR IN SECTION 0-02.3 OF THE PROJECT MANUAL.	

City of Seattle
SEATTLE TRANSPORTATION
ORDINANCE NO. APPROVED
FUND:
SCALE: H. V. INSPECTOR'S BOOK.

BALLARD CORRIDOR DESIGN STUDY
(11TH AVE NW TO LOCKS)

NO.	PC	TS3547P
BY	R/W	TS3547P
DATE	CO	XXX-XX
VAULT PLAN NO.		XXX-XX
SHEET 1 OF 6		

DRIVEWAY LEGEND

- (R) = RESIDENTIAL
- (C) = COMMERCIAL
- (I) = INDUSTRIAL
- (L) = LOADING DOCK

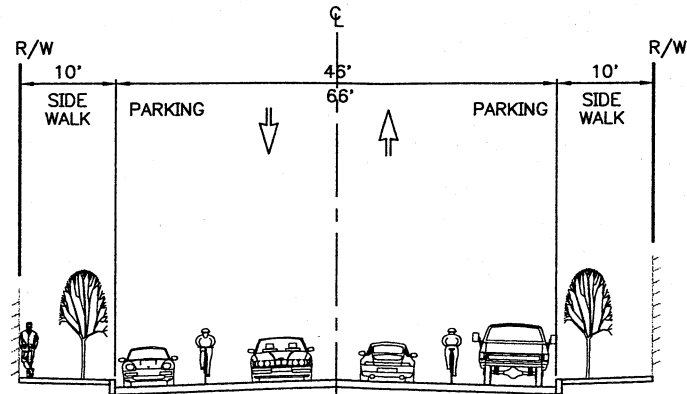

SECTION B-B2
BALLARD AVE NW
17TH AVE NW TO NW VERNON PL
(SIGNED BIKE ROUTE)
SCALE: 1" = 10'

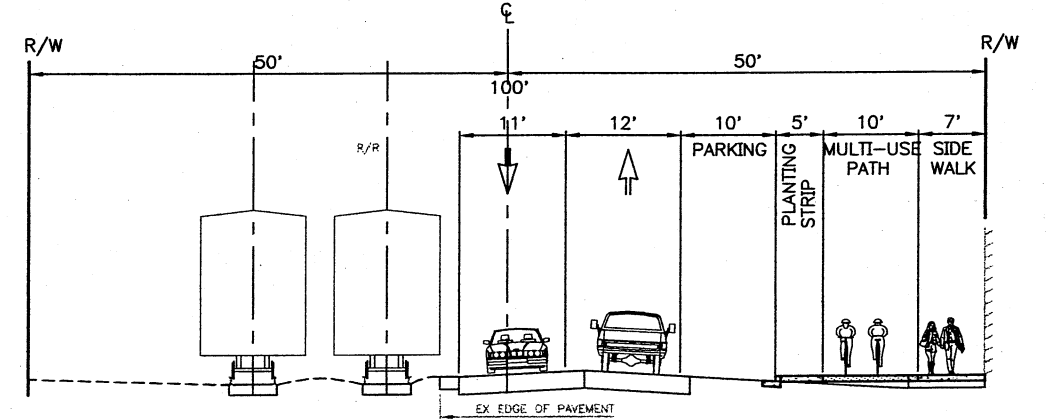

SECTION A-A2
SHILSHOLE AVE NW
@ 17TH AVE NW
SCALE: 1" = 10'

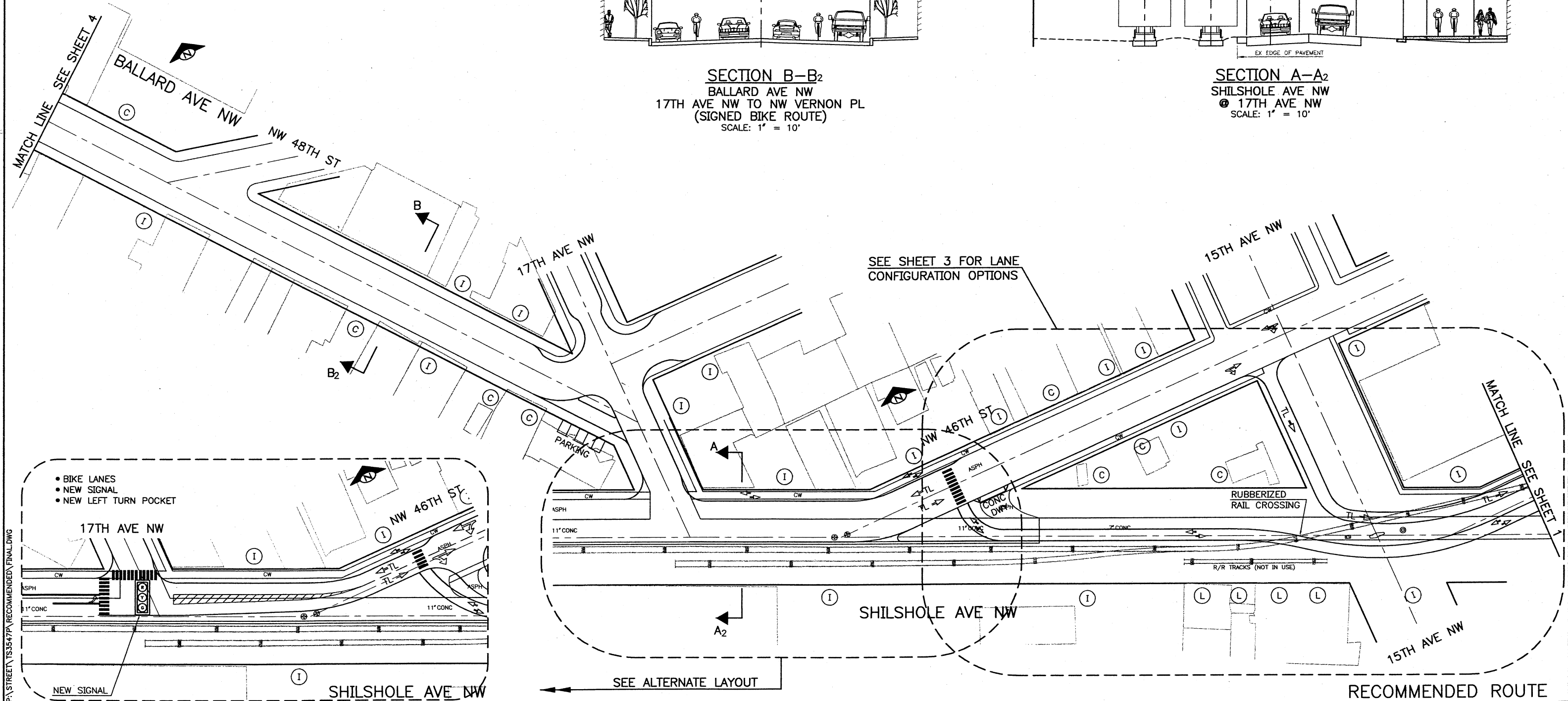

- BIKE LANES
- NEW SIGNAL
- NEW LEFT TURN POCKET

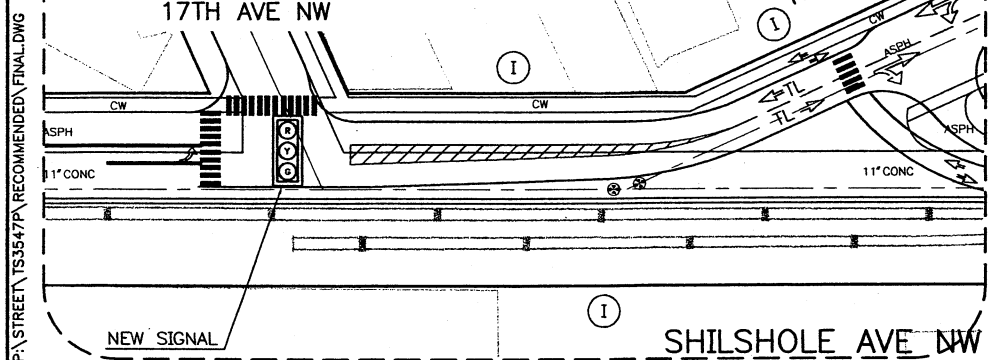

P:\STREET\TS3547P\RECOMMENDED_FINAL.DWG

IMPORTANT!!!
Please be advised that this plan sheet is just one piece of a technical design study to evaluate SEVERAL options for routing pedestrians and bicycles through the South Ballard corridor from roughly 11th Ave NW to the Ballard Locks. This plan sheet represents one piece of one alternative included in the conceptual design. For more information on the study and the routes included in the study, please visit the project web site:
www.cityofseattle.net/td/bcds11thlocks.asp

APPROVED FOR ADVERTISING
SEATTLE, WASHINGTON 20
BY:
CONTRACTING MANAGER

NAME OR INITIALS AND DATE	INITIALS AND DATE
DESIGNED:	REVIEWED:
CHECKED:	DES: SPU CONST.
	TRANS: PROJ. MGR.
DRAWN:	RECEIVED:
CHECKED:	REVISED AS BUILT

ALL WORK DONE IN ACCORDANCE WITH THE CITY OF SEATTLE STANDARD PLANS AND SPECIFICATIONS AND OTHER DOCUMENTS CALLED FOR IN SECTION 0-02.3 OF THE PROJECT MANUAL.

City of Seattle
SEATTLE
TRANSPORTATION

ORDINANCE NO. APPROVED:

FUND:

SCALE: H. V. INSPECTOR'S BOOK.

BALLARD CORRIDOR DESIGN STUDY
(11TH AVE NW TO LOCKS)

NO.	PC	TS3547P
R/W	R/W	TS3547P
CO	CO	TS3547P
VAULT PLAN NO.		XXX-XX
SHEET	2	OF 6

OPTION 1

NW 45TH ST = 1-WAY EASTBOUND FROM 15TH AVE NW TO 11TH AVE NW
 SHILSHOLE AVE = CLOSED TO GENERAL TRAFFIC (LOCAL ACCESS ONLY) W/ 2-WAY BIKE PATH FROM NW 46TH ST TO 15TH AVE NW
 15TH AVE NW = 1-WAY SOUTHBOUND FROM FROM NW 46TH ST TO SHILSHOLE AVE NW

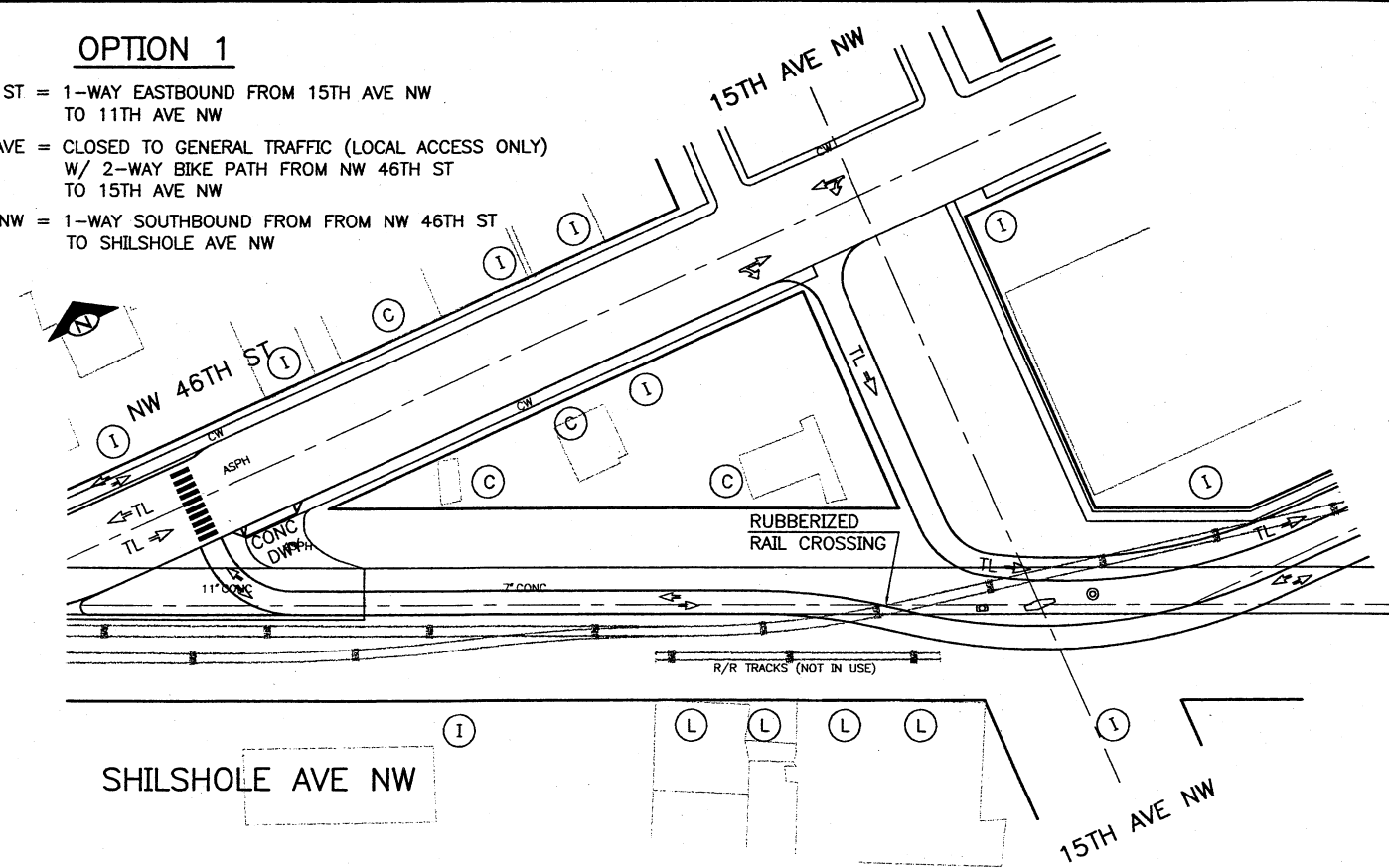

OPTION 2

NW 45TH ST = 1-WAY EASTBOUND FROM 15TH AVE NW TO 11TH AVE NW
 SHILSHOLE AVE = 1-WAY EASTBOUND W/ 2-WAY BIKE PATH FROM NW 46TH ST TO 15TH AVE NW

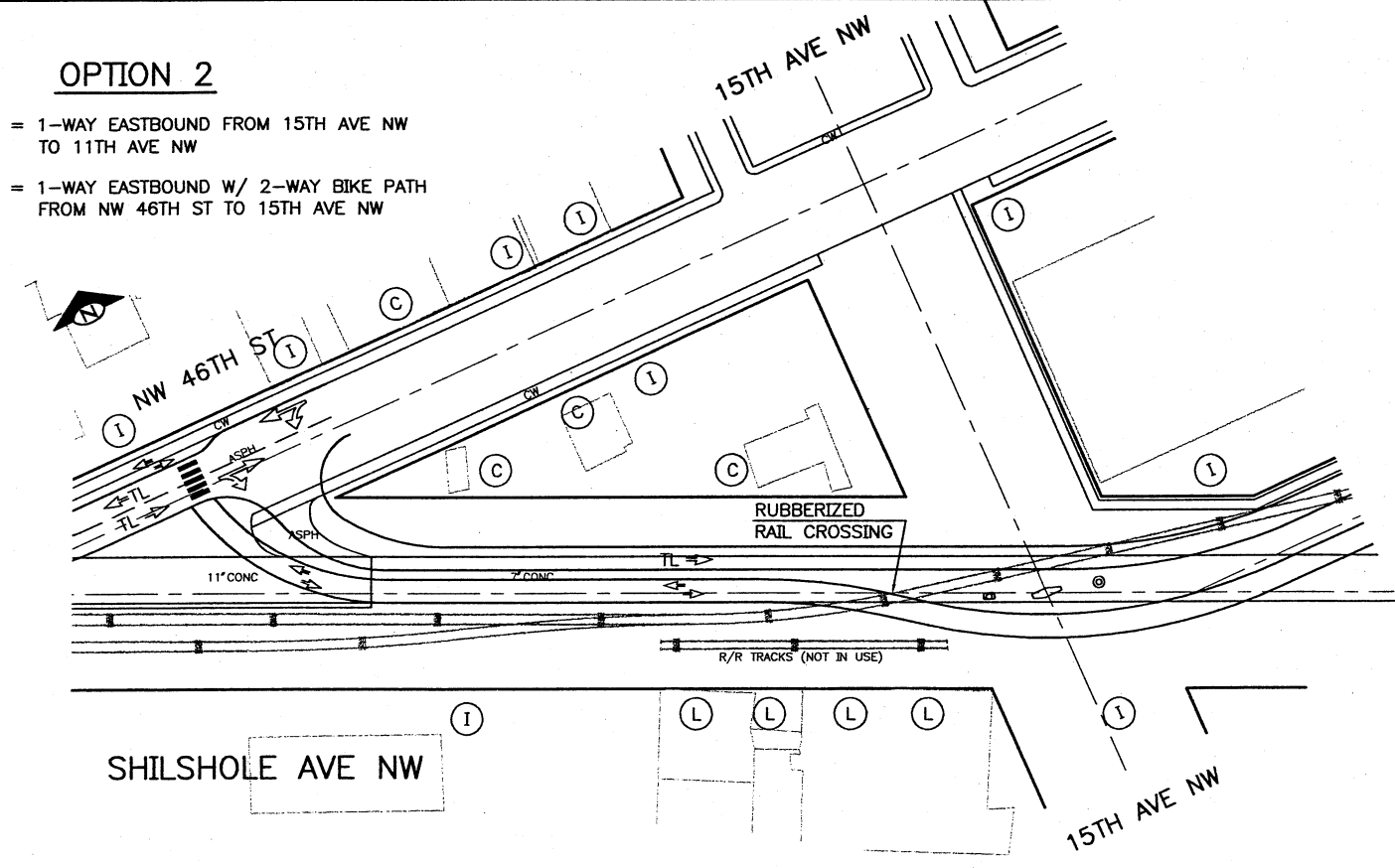

OPTION 3

NW 45TH ST = 2-WAY FROM 15TH AVE NW TO 11TH AVE NW
 SHILSHOLE AVE = 1-WAY EASTBOUND W/ 2-WAY BIKE PATH FROM NW 46TH ST TO 15TH AVE NW
 15TH AVE NW = 1-WAY NORTHBOUND FROM FROM SHILSHOLE AVE NW TO NW 46TH ST

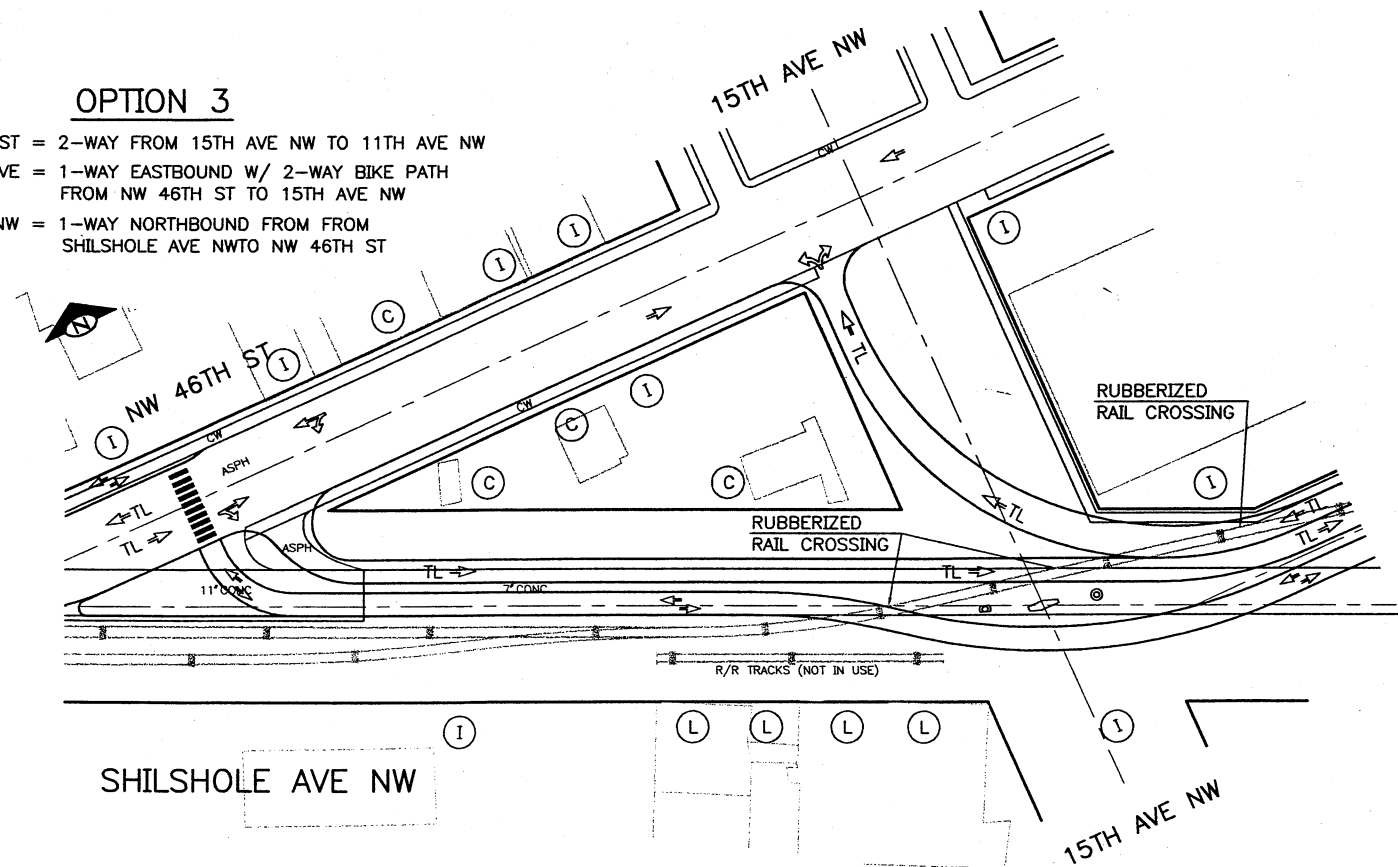

OPTION 4

NW 45TH ST = 2-WAY FROM 15TH AVE NW TO 11TH AVE NW
 SHILSHOLE AVE = CLOSED TO GENERAL TRAFFIC (LOCAL ACCESS ONLY) W/ 2-WAY BIKE PATH FROM NW 46TH ST TO 15TH AVE NW
 15TH AVE NW = 2-WAY FROM NW 45TH ST TO NW 46TH ST

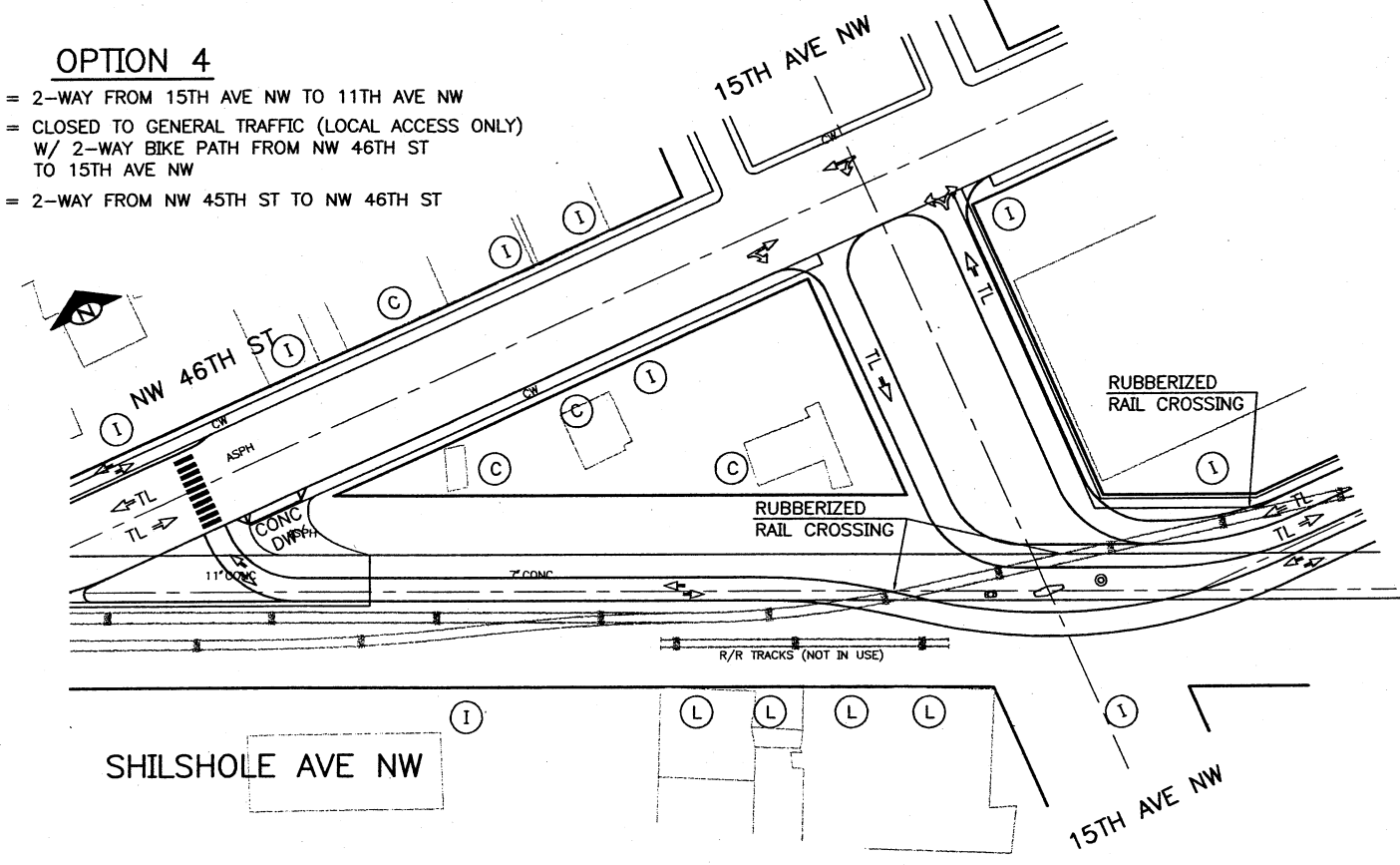

LANE CONFIGURATION OPTIONS

P:\STREET\TS3547P\RECOMMENDED\FINAL.DWG

IMPORTANT!!!
 Please be advised that this plan sheet is just one piece of a technical design study to evaluate SEVERAL options for routing pedestrians and bicycles through the South Ballard corridor from roughly 11th Ave NW to the Ballard Locks. This plan sheet represents one piece of one alternative included in the conceptual design. For more information on the study and the routes included in the study, please visit the project web site:
www.cityofseattle.net/td/bcds11thlocks.asp

APPROVED FOR ADVERTISING
 SEATTLE, WASHINGTON 20
 BY: _____
 CONTRACTING MANAGER

NAME OR INITIALS AND DATE	INITIALS AND DATE
DESIGNED: _____	REVIEWED: _____
CHECKED: _____	DES: _____ SPU CONST.
	TRANS: _____ PROJ. MGR.
DRAWN: _____	RECEIVED: _____
CHECKED: _____	REVISED AS BUILT
ALL WORK DONE IN ACCORDANCE WITH THE CITY OF SEATTLE STANDARD PLANS AND SPECIFICATIONS AND OTHER DOCUMENTS CALLED FOR IN SECTION 0-02.3 OF THE PROJECT MANUAL.	

City of Seattle
SEATTLE TRANSPORTATION
 ORDINANCE NO. _____ APPROVED _____
 FUND: _____
 SCALE: H. V. INSPECTOR'S BOOK.

BALLARD CORRIDOR DESIGN STUDY
(11TH AVE NW TO LOCKS)

PC	TS3547P
R/W	TS3547P
CO	XXX-XX
Vault Plan No.	XXX-XX
SHEET	3 OF 6

DRIVEWAY LEGEND

- (R) = RESIDENTIAL
- (C) = COMMERCIAL
- (I) = INDUSTRIAL
- (L) = LOADING DOCK

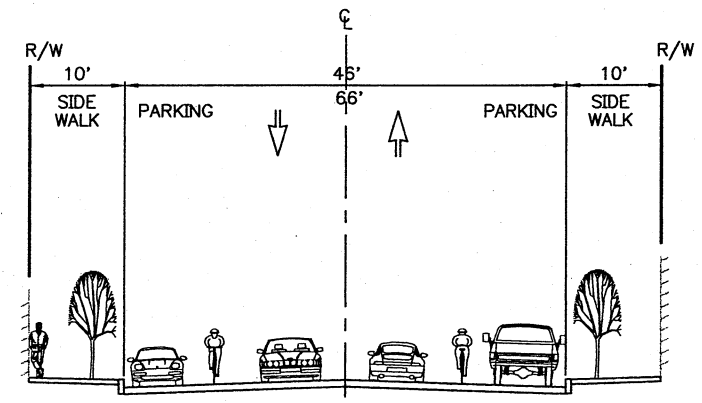
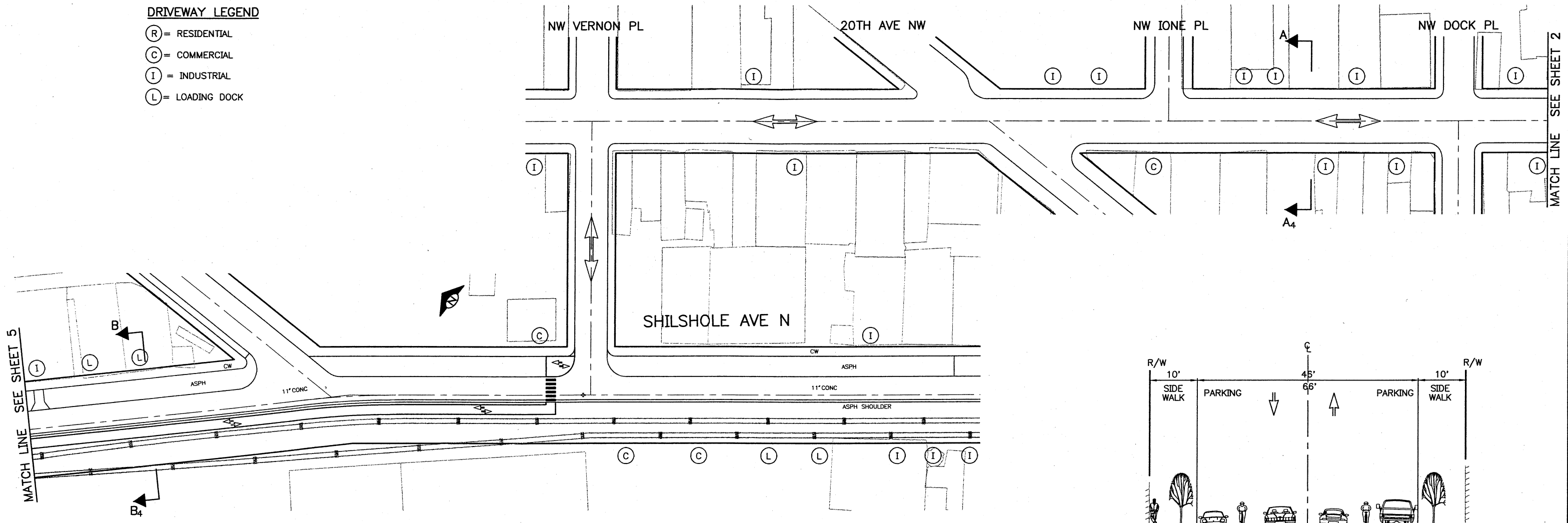

SECTION A-A₄
 BALLARD AVE NW
 17TH AVE NW TO NW VERNON PL
 (SIGNED BIKE ROUTE)
 SCALE: 1" = 10'

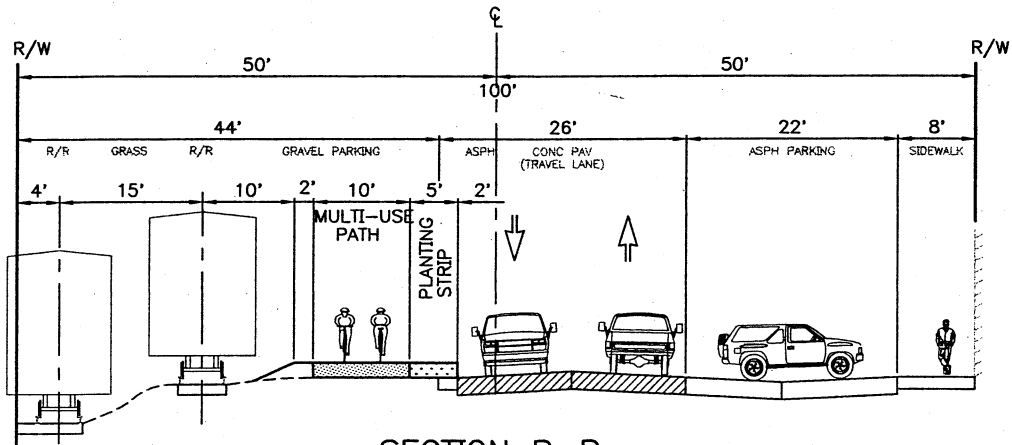

SECTION B-B₄
 SHILSHOLE AVE NW
 22ND AVE NW TO 24TH AVE NW
 SCALE: 1" = 10'

RECOMMENDED ROUTE

P:\STREET\TS3547P\RECOMMENDED_FINAL.DWG

IMPORTANT!!!
 Please be advised that this plan sheet is just one piece of a technical design study to evaluate SEVERAL options for routing pedestrians and bicycles through the South Ballard corridor from roughly 11th Ave NW to the Ballard Locks. This plan sheet represents one piece of one alternative included in the conceptual design. For more information on the study and the routes included in the study, please visit the project web site:
www.cityofseattle.net/td/bcds11thlocks.asp

APPROVED FOR ADVERTISING
 SEATTLE, WASHINGTON 20
 BY: _____
 CONTRACTING MANAGER

NAME OR INITIALS AND DATE	INITIALS AND DATE
DESIGNED: _____	REVIEWED: _____
CHECKED: _____	DES: SPU CONST.
	TRANS: PROJ. MGR.
DRAWN: _____	RECEIVED: _____
CHECKED: _____	REVISED AS BUILT
ALL WORK DONE IN ACCORDANCE WITH THE CITY OF SEATTLE STANDARD PLANS AND SPECIFICATIONS AND OTHER DOCUMENTS CALLED FOR IN SECTION 9-02.3 OF THE PROJECT MANUAL.	

City of Seattle
SEATTLE TRANSPORTATION
 ORDINANCE NO. _____ APPROVED: _____
 FUND: _____
 SCALE: H. V. INSPECTOR'S BOOK.

BALLARD CORRIDOR DESIGN STUDY
(11TH AVE NW TO LOCKS)

PC	TS3547P
R/W	TS3547P
CO	TS3547P
VAULT PLAN NO.	XXX-XX
SHEET	4 OF 6

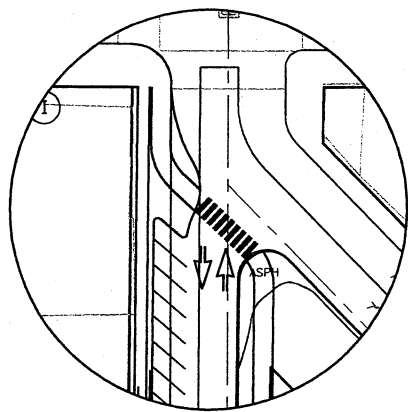
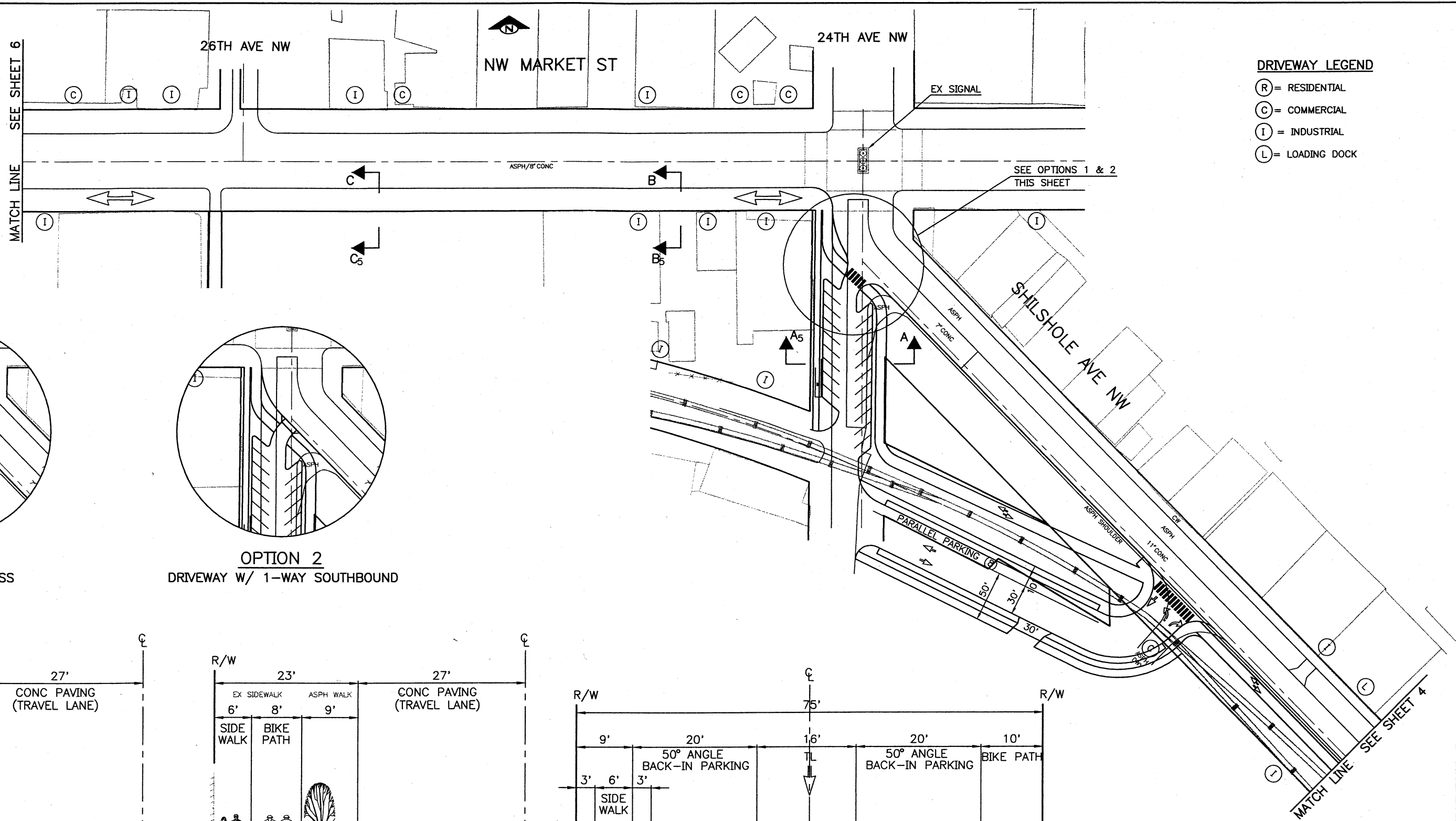

OPTION 1
2-WAY LOCAL ACCESS

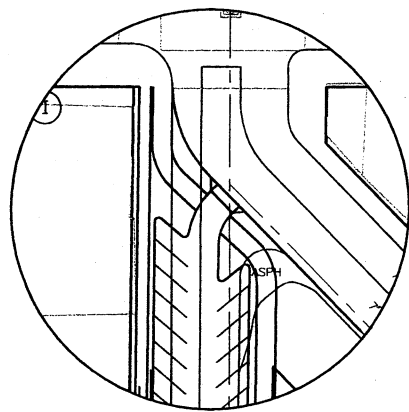

OPTION 2
DRIVEWAY W/ 1-WAY SOUTHBOUND

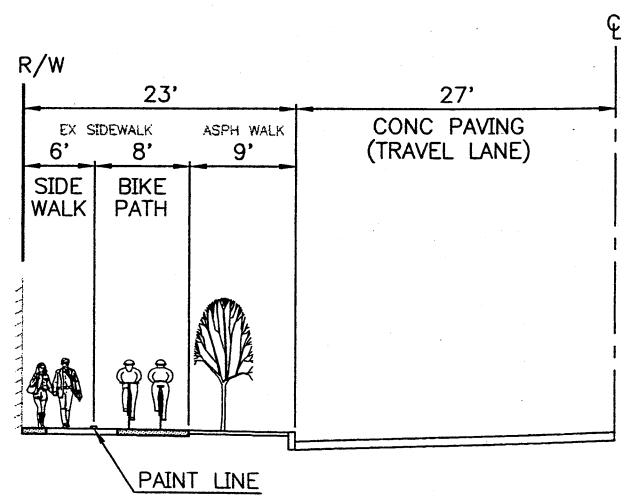

SECTION C-C₅
NW MARKET ST
MID-BLOCK CROSSING TO 26TH AVE NW
SCALE: 1" = 10'

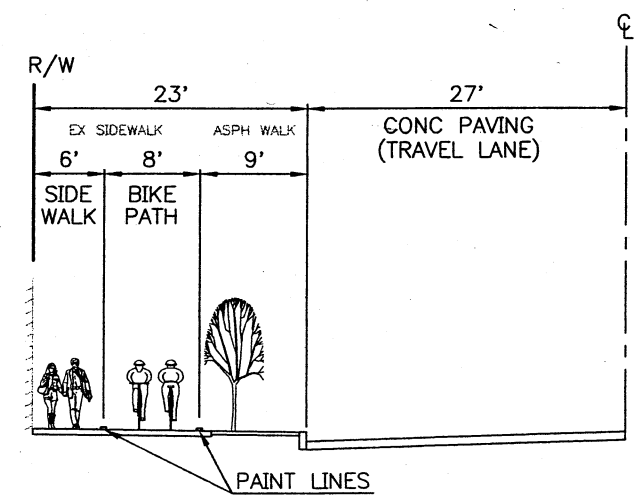

SECTION B-B₅
NW MARKET ST
24TH AVE NW TO MID-BLOCK CROSSING
SCALE: 1" = 10'

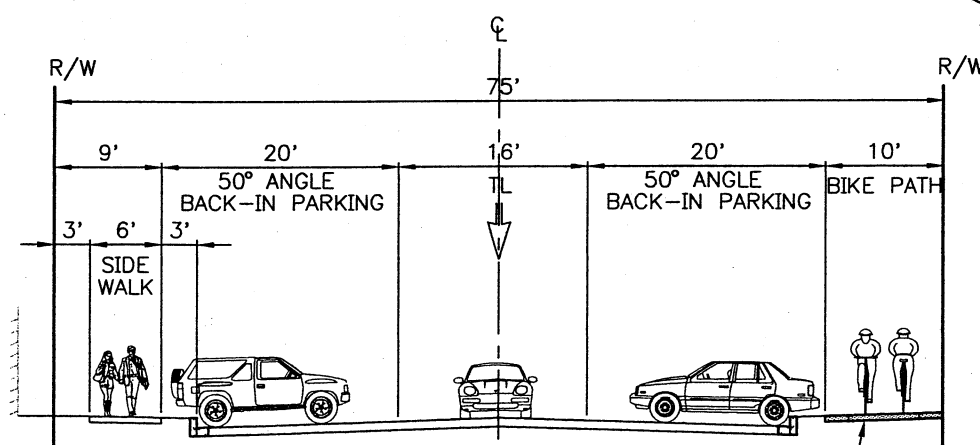

SECTION A-A₅
24TH AVE NW
NW MARKET ST TO RAILROAD R/W
SCALE: 1" = 10'

RECOMMENDED ROUTE

P:\STREET\TS3547P\RECOMMENDED_FINAL.DWG

IMPORTANT!!!
Please be advised that this plan sheet is just one piece of a technical design study to evaluate SEVERAL options for routing pedestrians and bicycles through the South Ballard corridor from roughly 11th Ave NW to the Ballard Locks. This plan sheet represents one piece of one alternative included in the conceptual design. For more information on the study and the routes included in the study, please visit the project web site: www.cityofseattle.net/td/bcds11thlocks.asp

APPROVED FOR ADVERTISING
SEATTLE, WASHINGTON 20
BY: _____
CONTRACTING MANAGER

NAME OR INITIALS AND DATE	INITIALS AND DATE
DESIGNED	REVIEWED:
CHECKED	DES. SPU CONST.
	TRANS. PROJ. MGR.
DRAWN	RECEIVED
CHECKED	REVISED AS BUILT
ALL WORK DONE IN ACCORDANCE WITH THE CITY OF SEATTLE STANDARD PLANS AND SPECIFICATIONS AND OTHER DOCUMENTS CALLED FOR IN SECTION 0-02.3 OF THE PROJECT MANUAL.	

City of Seattle
SEATTLE TRANSPORTATION

ORDINANCE NO. APPROVED

FUND:

SCALE: H. V. INSPECTOR'S BOOK.

BALLARD CORRIDOR DESIGN STUDY
(11TH AVE NW TO LOCKS)

PC	TS3547P
R/W	TS3547P
CO	XXX-XX
VAULT PLAN NO.	XXX-XX
SHEET	5 OF 6

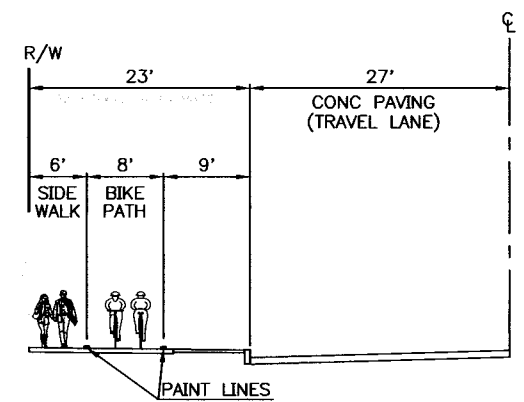
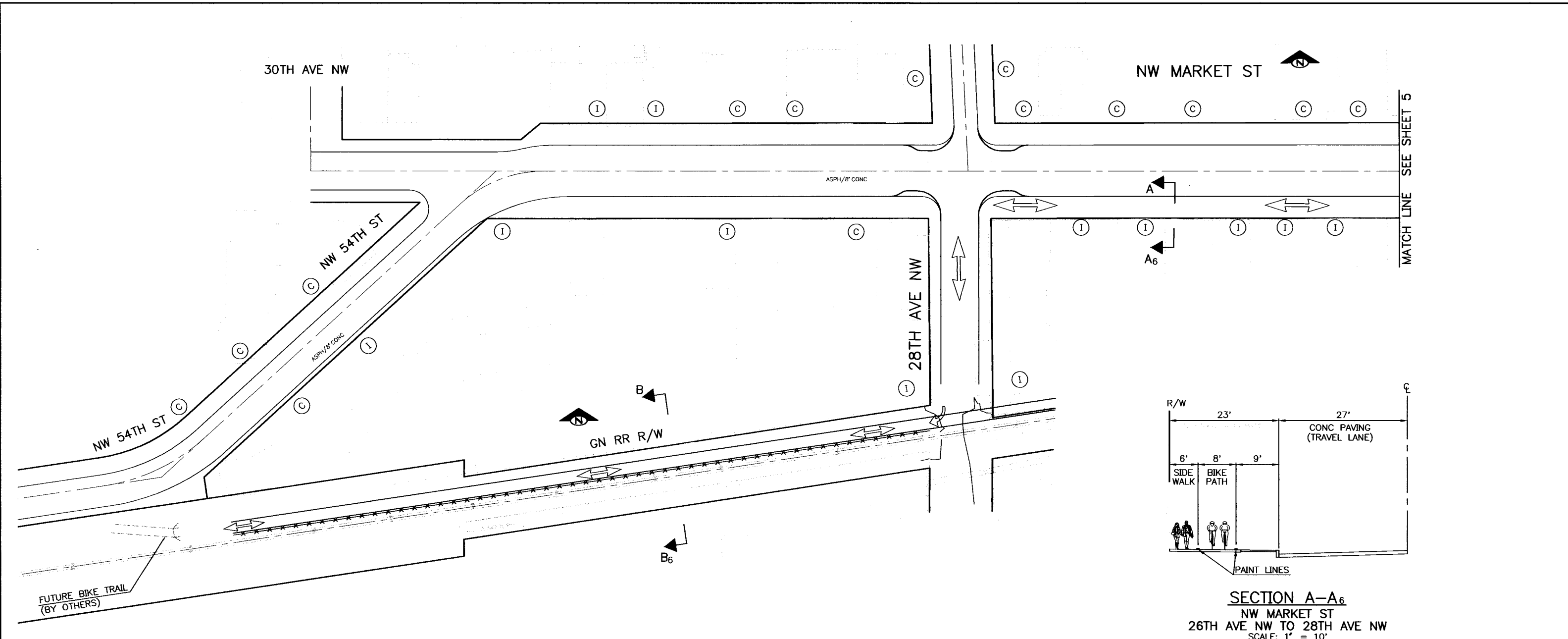

SECTION A-A₆
 NW MARKET ST
 26TH AVE NW TO 28TH AVE NW
 SCALE: 1" = 10'

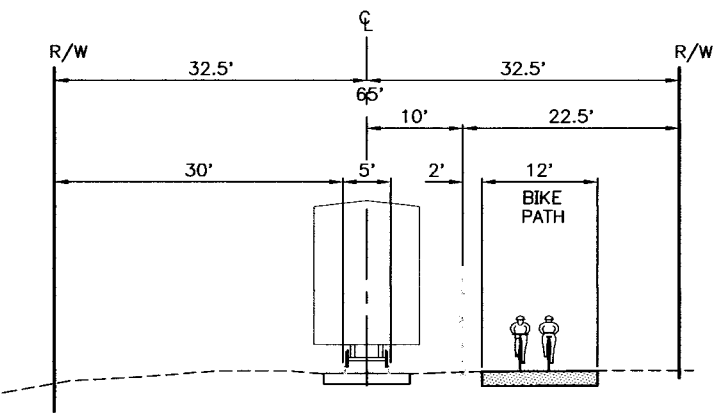

SECTION B-B₆
 RAILROAD CORRIDOR
 28TH AVE NW TO BALLARD LOCKS
 SCALE: 1" = 10'

DRIVEWAY LEGEND

- (R) = RESIDENTIAL
- (C) = COMMERCIAL
- (I) = INDUSTRIAL
- (L) = LOADING DOCK

RECOMMENDED ROUTE

P:\STREET\TS3547P\RECOMMENDED_FINAL.DWG

IMPORTANT!!
 Please be advised that this plan sheet is just one piece of a technical design study to evaluate SEVERAL options for routing pedestrians and bicycles through the South Ballard corridor from roughly 11th Ave NW to the Ballard Locks. This plan sheet represents one piece of one alternative included in the conceptual design. For more information on the study and the routes included in the study, please visit the project web site:
www.cityofseattle.net/td/bcds11thlocks.asp

APPROVED FOR ADVERTISING
 SEATTLE, WASHINGTON 20
 BY:
 CONTRACTING MANAGER

NAME OR INITIALS AND DATE	INITIALS AND DATE
DESIGNED	REVIEWED:
CHECKED	DES. SPU CONST.
DRAWN	TRANS. PROJ. MGR.
CHECKED	RECEIVED
	REVISED AS BUILT

ALL WORK DONE IN ACCORDANCE WITH THE CITY OF SEATTLE STANDARD PLANS AND SPECIFICATIONS AND OTHER DOCUMENTS CALLED FOR IN SECTION 0-02.3 OF THE PROJECT MANUAL.

City of Seattle
SEATTLE
TRANSPORTATION
 ORDINANCE NO. APPROVED

BALLARD CORRIDOR DESIGN STUDY
(11TH AVE NW TO LOCKS)

JOB NO.	PC TS3547P
R/W	CO TS3547P
VAULT PLAN NO.	XXX-XX
SHEET	6 OF 6