



City of Seattle  
**Department of Planning & Development**

## 2006 SRC Code Solution

Sec. R202  
Stair Penthouse Within a Dwelling Unit  
Release Date: March 20, 2009

*The following interpretation, policy or code alternate is intended to provide guidance to staff for consistency of review and is subject to change without notice. Application of this interpretation, policy or code alternate to specific projects may vary.*

### Code Issue:

Within a dwelling unit, under what conditions does DPD consider a stair penthouse a story?

### Interpretation:

A stair penthouse within a dwelling unit is not considered a story when the following conditions are met:

- The enclosed floor area at the top of the stairs is not greater than the larger of 25 square feet or the minimal area necessary to provide a code-complying landing for the stair and a door;
- The stair penthouse provides access to a roof deck for the dwelling unit; and
- The area at the top of the stairs does not have any furnishings, fixtures, built in shelves or appliances.

See the following common arrangements that satisfy this interpretation:

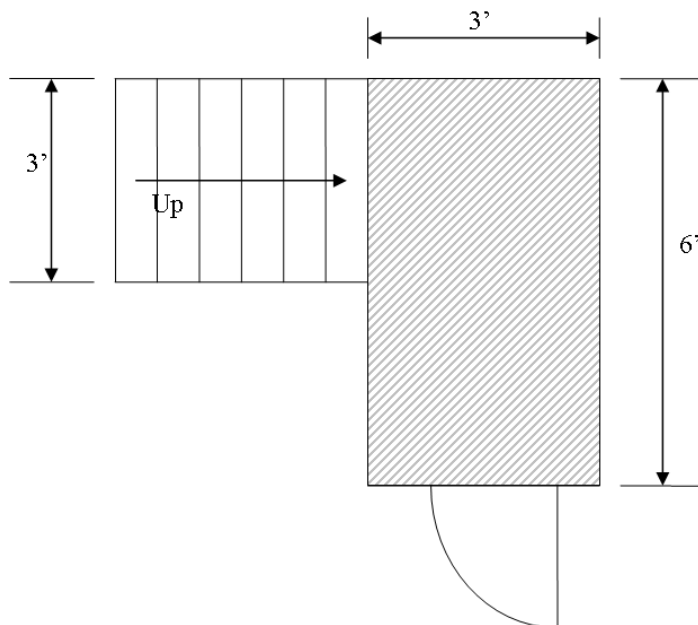

## Construction Review & Inspection Quality

Jonathan Siu, Principal Engineer

City of Seattle  
**Department of Planning & Development**

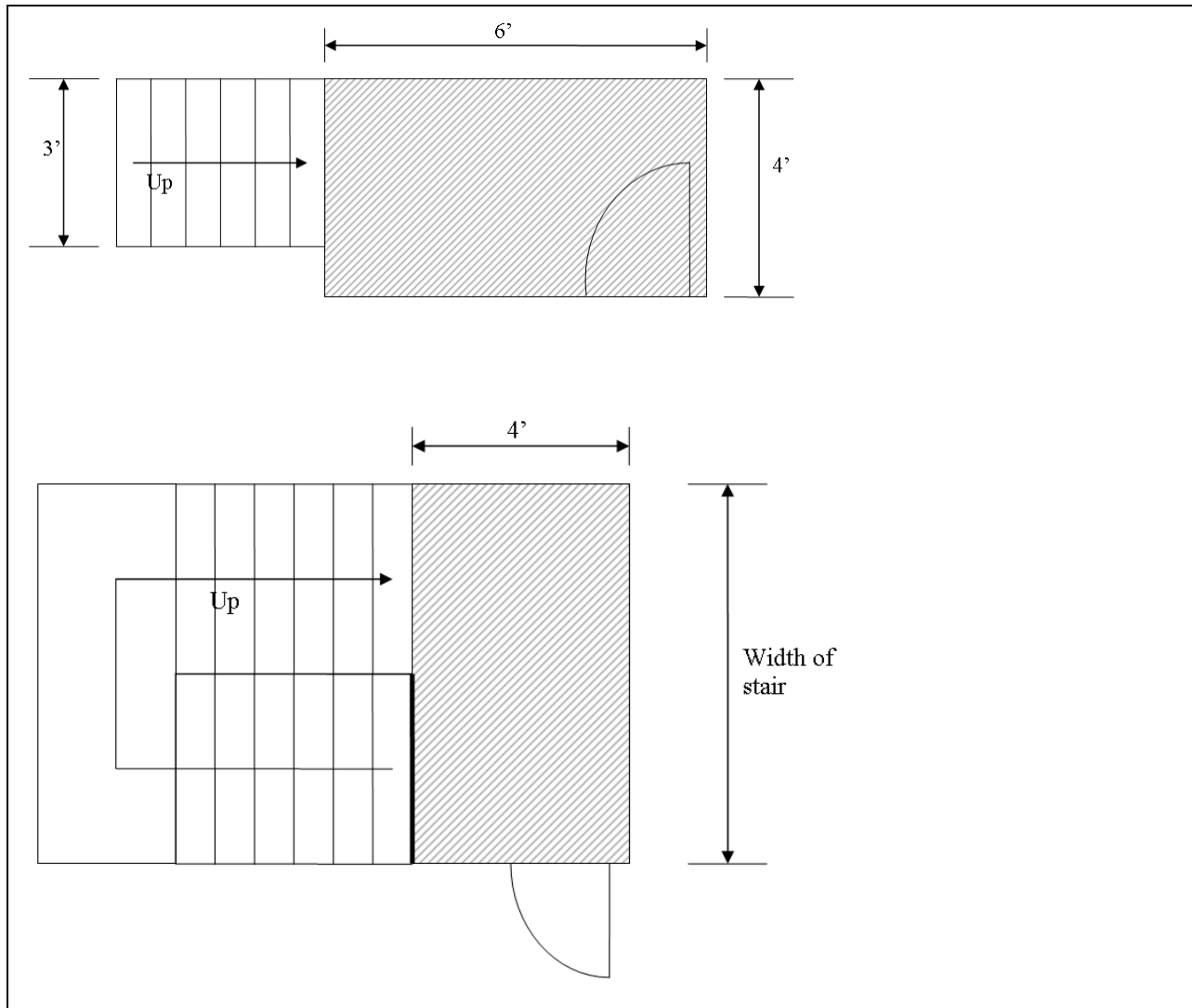

If you have questions about whether this code solution applies to your project:

- If you have submitted a permit application, contact the Building Code plan reviewer assigned to your application
- If you have not submitted an application, contact DPD Building Code Technical Support at 206-684-4630 or in person at the Applicant Services Center. Visit the Applicant Services Center website for more information about hours and location [http://www.seattle.gov/dpd/Permits/Process\\_Overview/Location\\_Hours/default.asp](http://www.seattle.gov/dpd/Permits/Process_Overview/Location_Hours/default.asp)



**Construction Review & Inspection Quality**

Jonathan Siu, Principal Engineer