

UNIVERSITY *of* WASHINGTON

Intercollegiate Athletics Basketball Training Facility

June 13, 2023



Introduction & Agenda

Troy Stahlecker, Director
UW Facilities, Project Delivery Group

Agenda:

1. Project Overview (review & update)
 - Location, Goals, Program/Function
 - Development Standards, View Corridor
2. Site Circulation & Landscape
3. Building Massing & Material Palette
4. Project Schedule



Goals & Objectives

- Provide a 1st-class training facility “home” for men’s and women’s basketball with **24/7 practice courts**. The Training Facility will demonstrate the University’s **commitment to Title IX** by creating equitable spaces for each program.
- Point of arrival and interior circulation will **enhance student athlete access** and maximize the **appeal of Husky Basketball for prospective recruits**.
- The facility will **connect** to the existing arena floor level of **Hec Ed** and to **Graves Annex** Strength & Conditioning space.
- Be **cost effective** and the aesthetic quality will be consistent with recent ICA Capital Projects.



Aerial View



Recap of Project Site & Development Standards



Location: East Camus
Site 59 as designated in 2019 CMP

Basketball Training Facility

- 2 stories
- No spectator/assembly events

Excerpt from 2019 Campus Master Plan (CMP)

Description	2019 CMP Development Standard	Proposed Project
Total Max. GSF	75,000 gsf	38,000 gsf (new constr.) 4,200 gsf (Hec Ed TI)
Demolition GSF	27,045 gsf	27,045 gsf
Net New GSF	47,955 gsf	10,955 gsf
Max. Height (ft.)	105'	40-45'
View Corridors	View 3	Protect View



Recap of Existing & Proposed Conditions

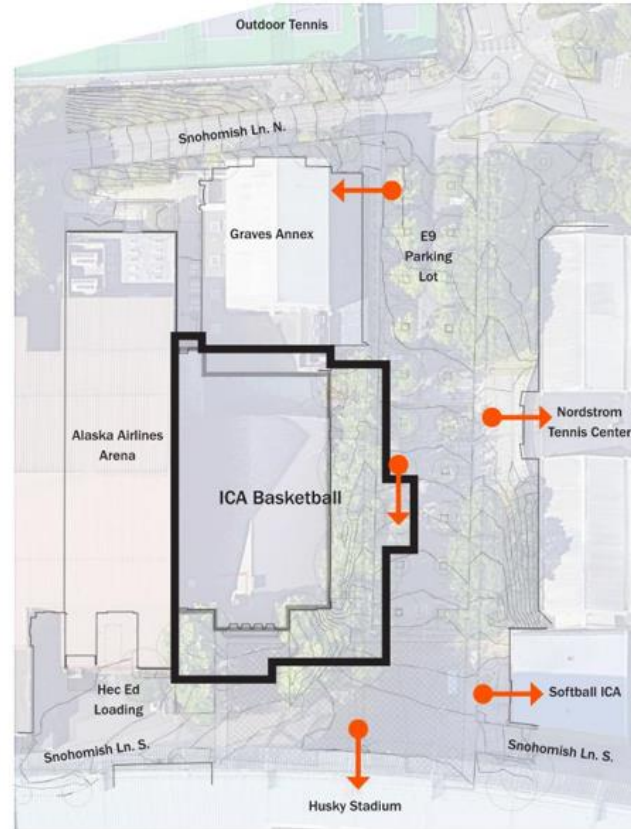
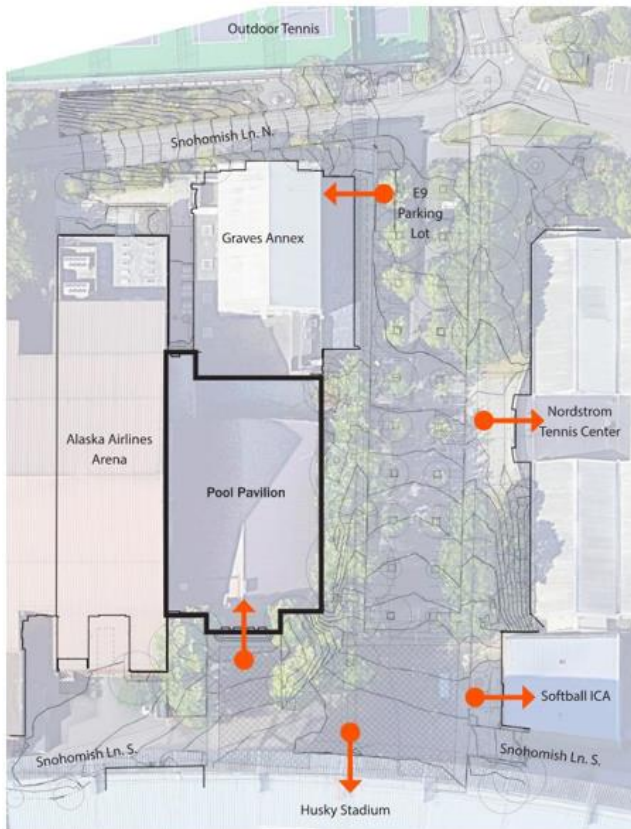

Big Moves:

- New building footprint will be larger than pool
- Parking reduction in E9
- New landscape/hardscape

Site Response:

- Multi-modal passage (ADA, pedestrian, vehicle, cyclists)
- Game-day operations & crowd flow



Site Circulation

Overview

Fire Lane

E9 Permit Parking

ADA Parking

Shared Use Zone:
Pedestrian, Cyclist,
Limited Vehicle Access

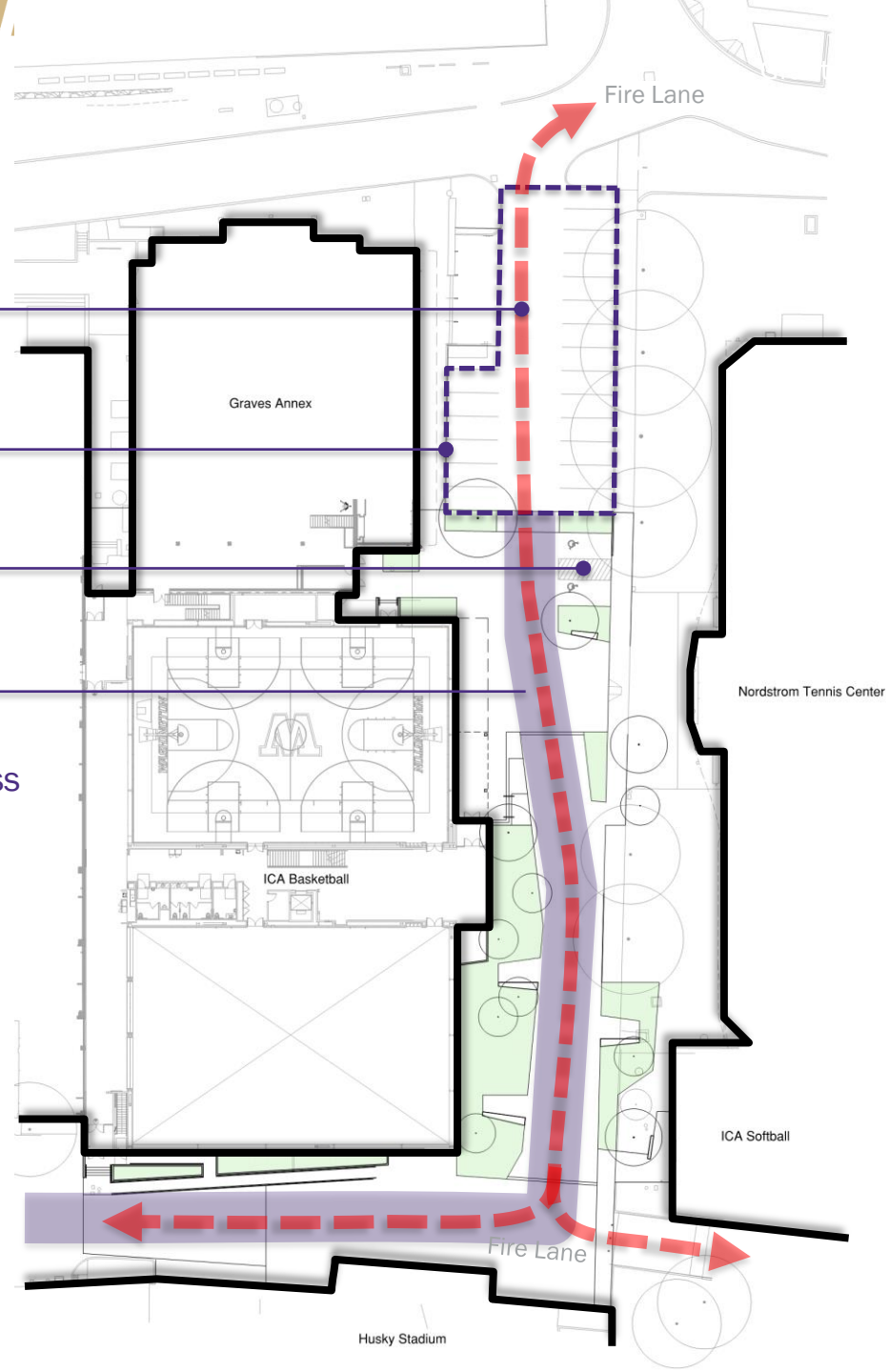

Site Circulation

ADA Pathways

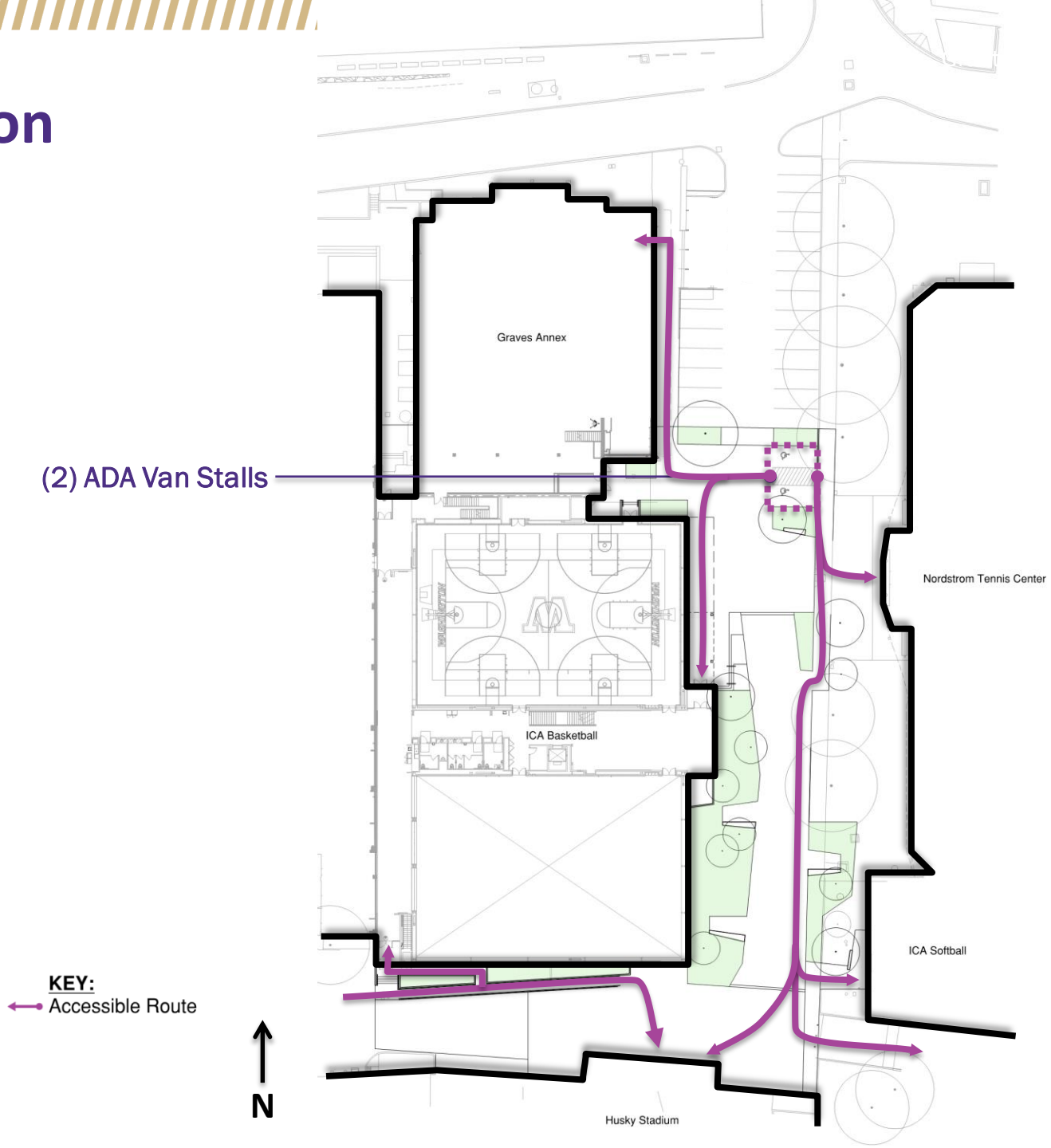

Site Circulation & Landscape

Shared Use

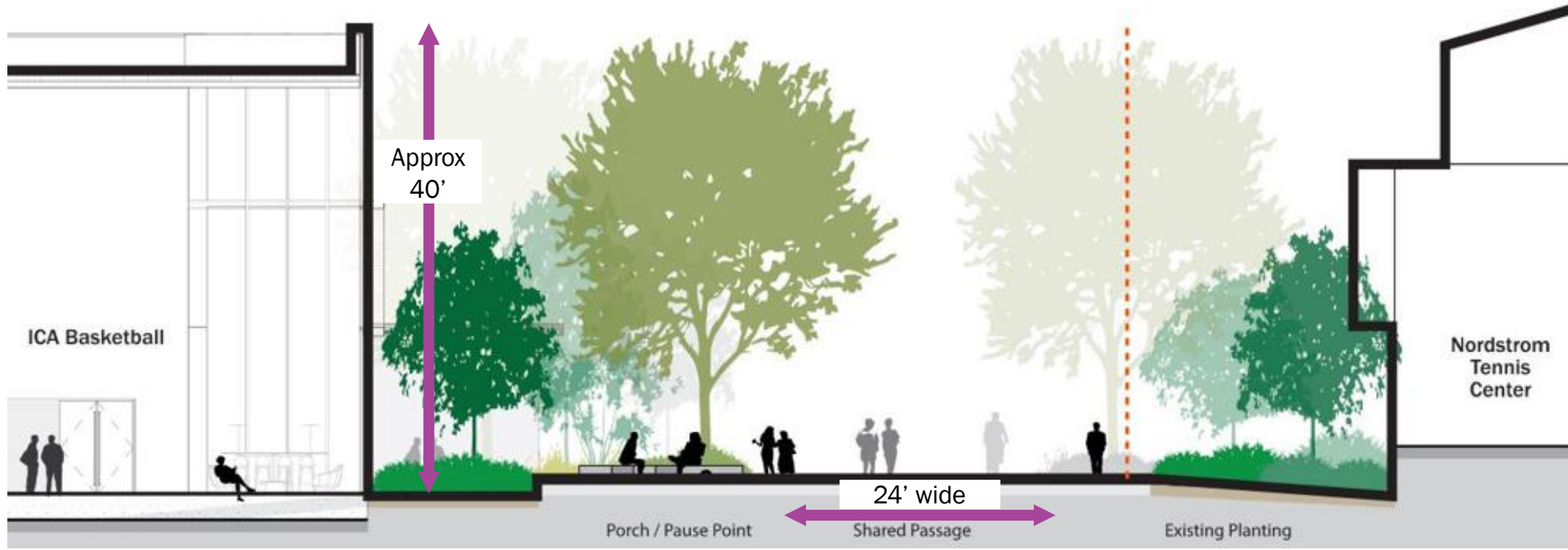

Landscape Concept Design

2019 CMP identifies this zone as a "Passage" –

"making connection between destinations memorable and enjoyable"

Existing mature trees to remain

"Porch" seating & social

"Passage"

Pedestrian pause points

Pedestrian path lighting

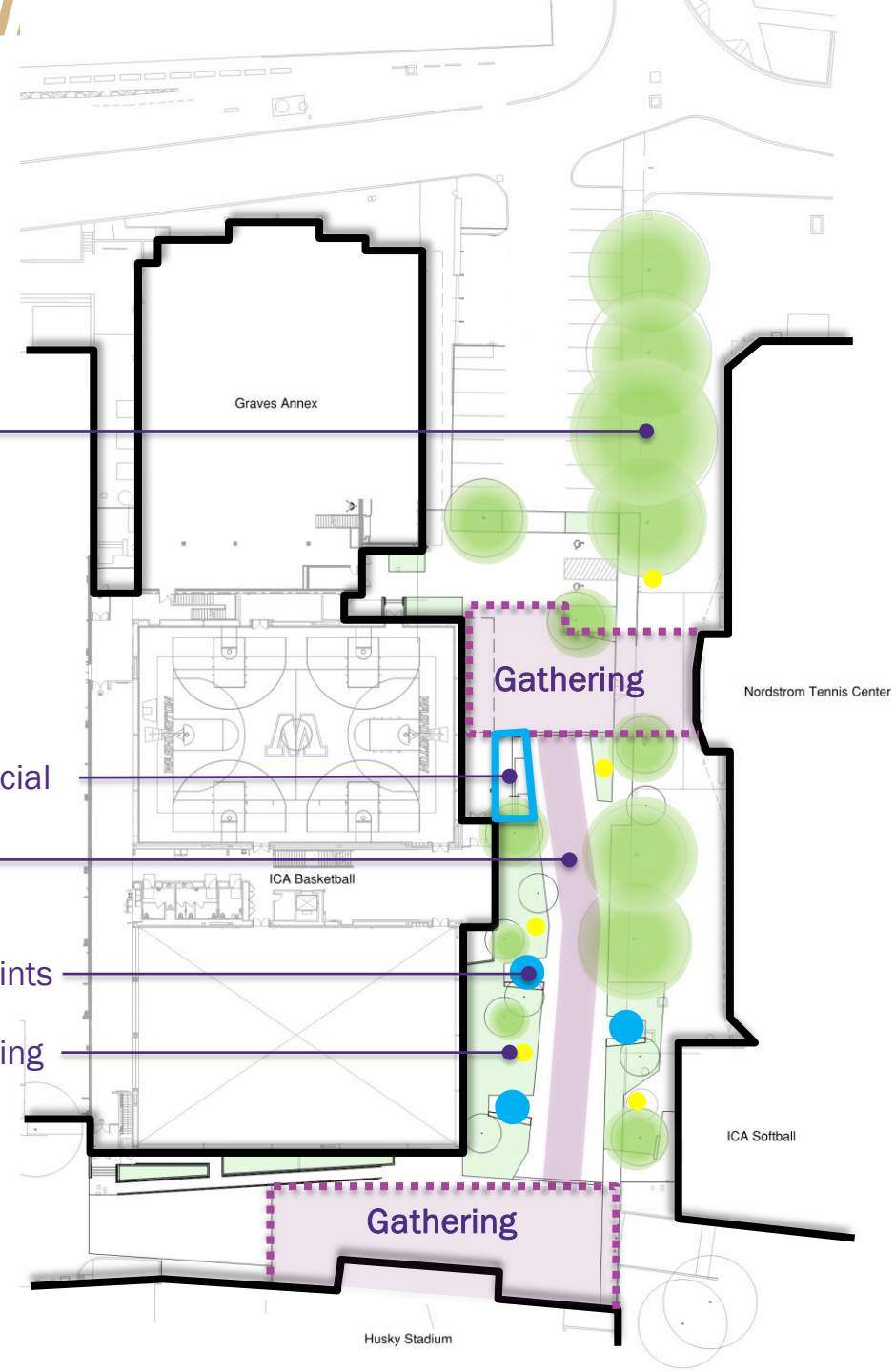

Graves Annex

Gathering

Nordstrom Tennis Center

ICA Basketball

ICA Softball

Gathering

Husky Stadium

Building Diagram

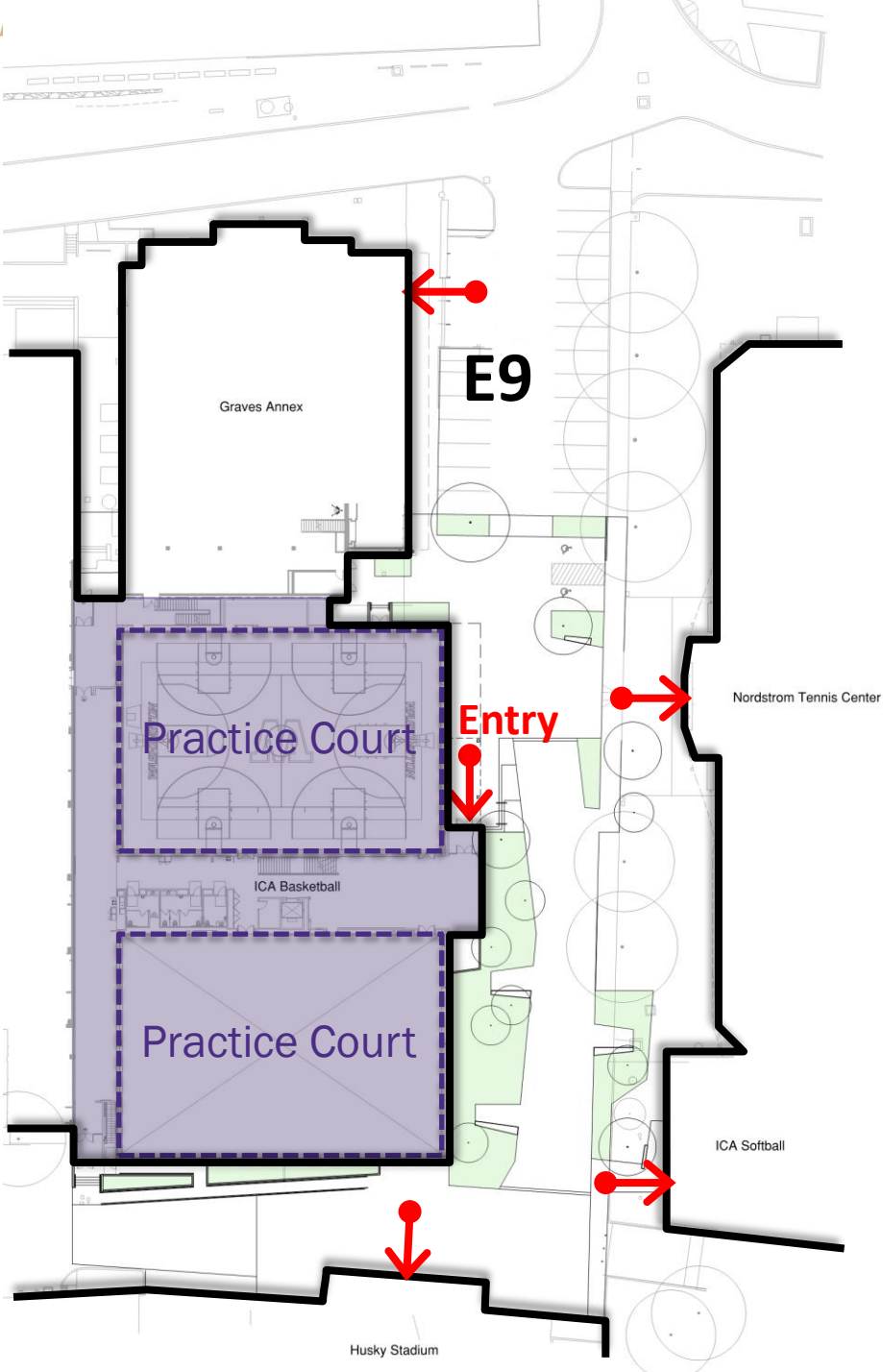

Massing Diagram

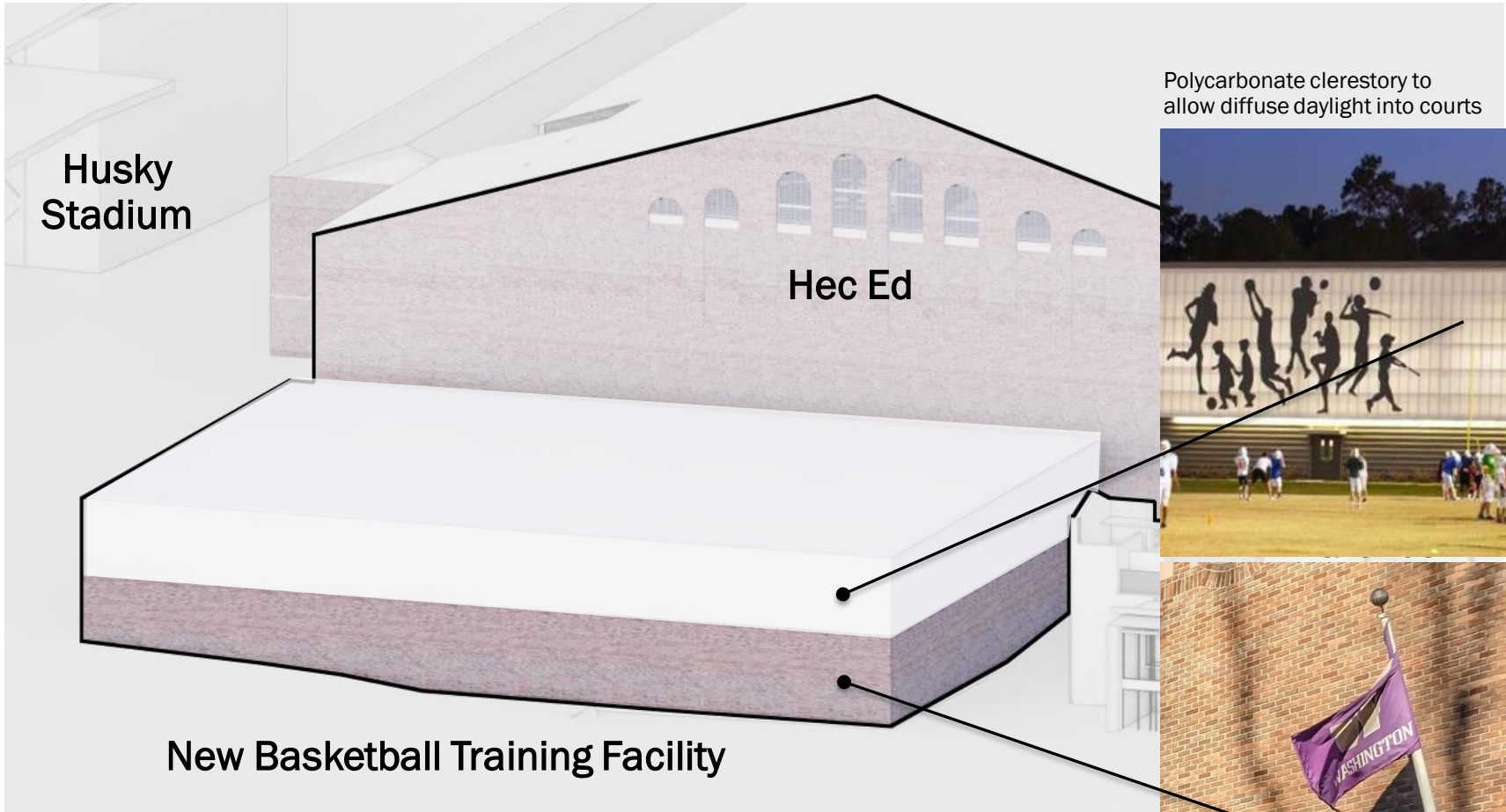

Husky Stadium

Hec Ed

New Basketball Training Facility

Looking west

Polycarbonate clerestory to allow diffuse daylight into courts



Brick base to complement Hec Ed brick

Massing Diagram

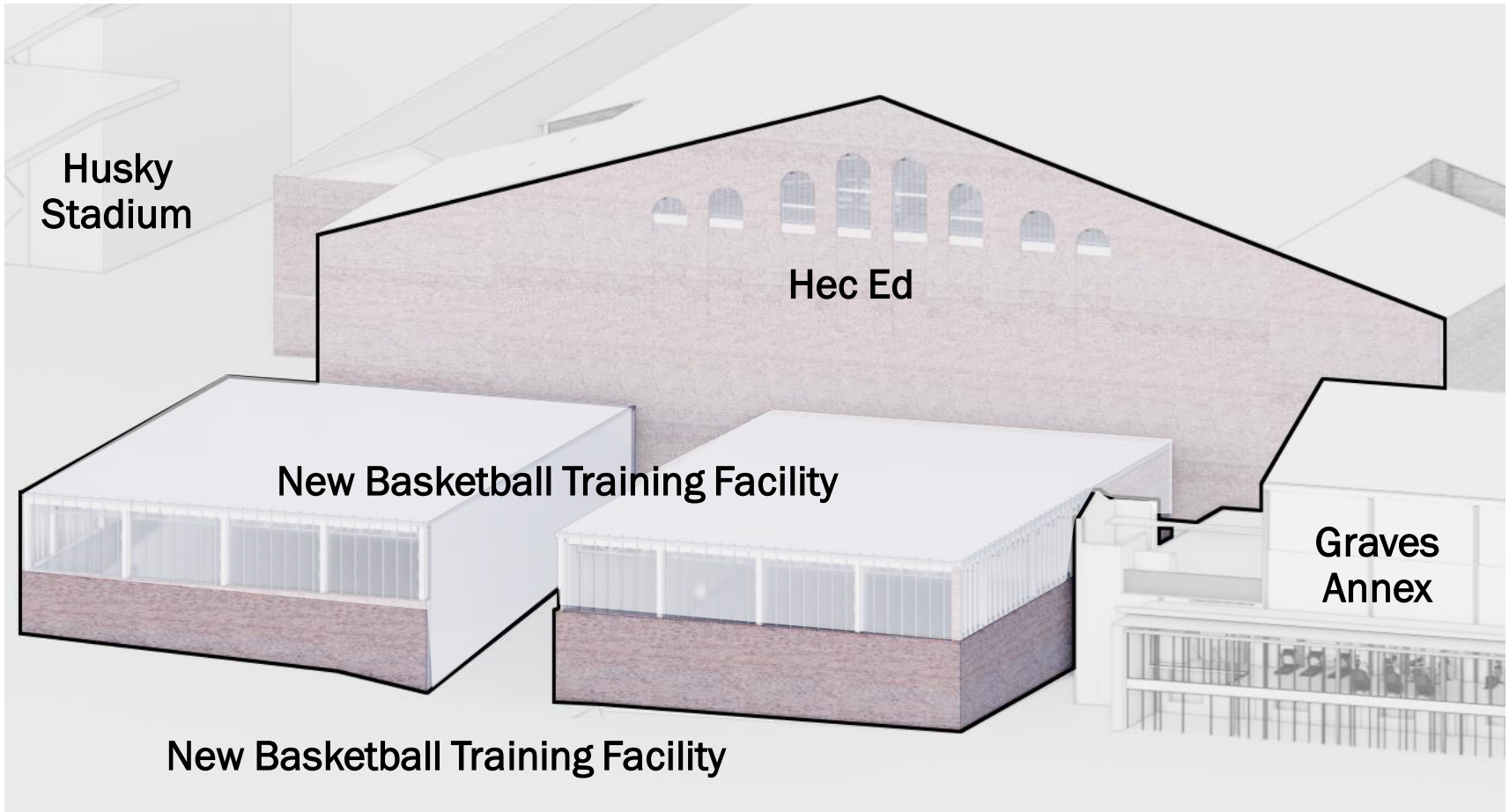

Looking west



Massing Diagram

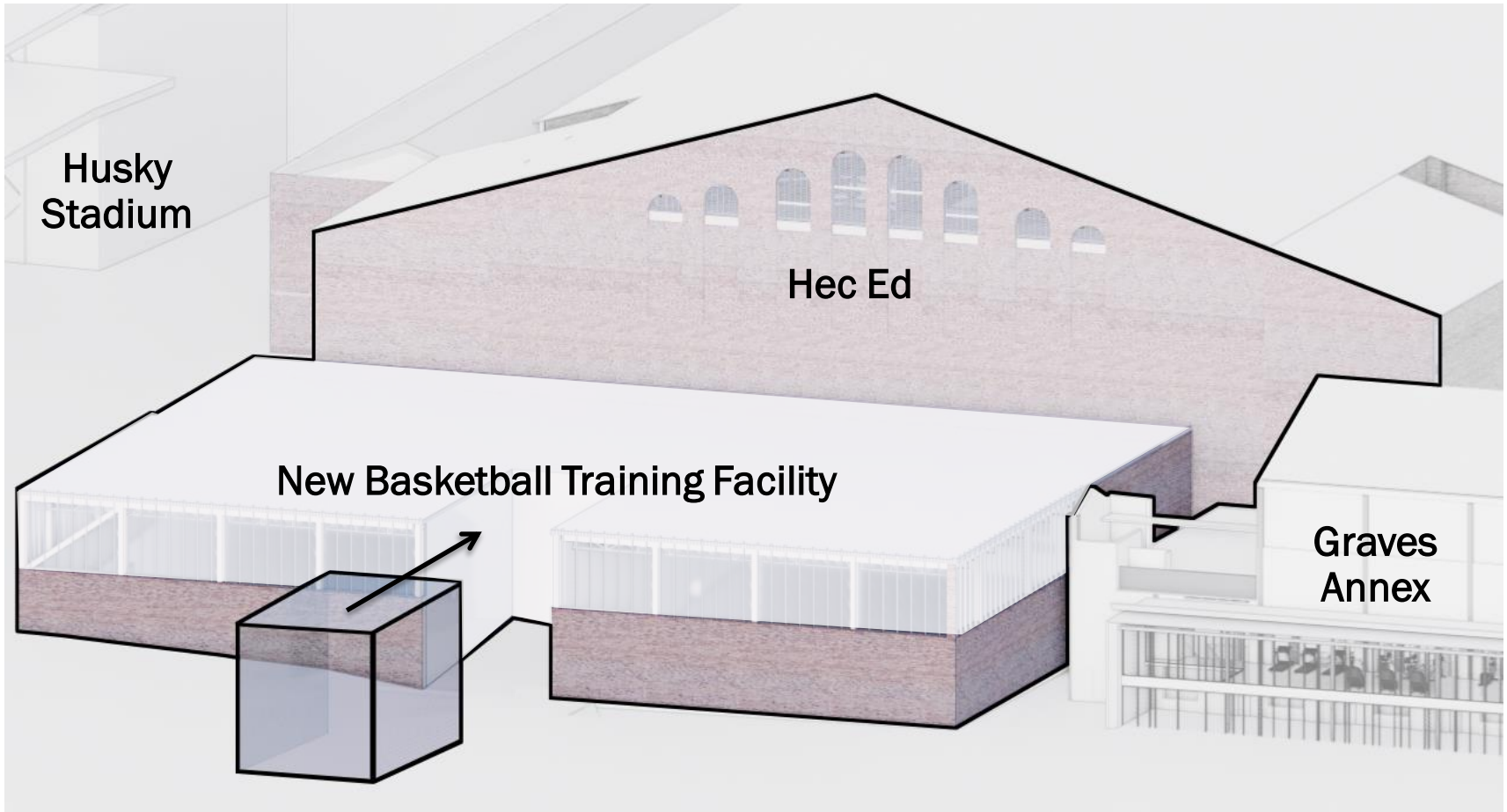

Looking west

N →

Early Concept Rendering





SCHEDULE

Project Definition

Design/Preconstruction

Construction

Occupancy

to conclude February 2023

March 2023 – March 2024

March 2024 – August 2025

August/September 2025





DISCUSSION

W