



CLIMATE PLEDGE ARENA  
**PLAZA STATUES LANDMARKS PROPOSAL**

FEBRUARY 23, 2024



CPA PLAZA STATUES LANDMARKS PROPOSAL

**Traditional Statue Precedents**

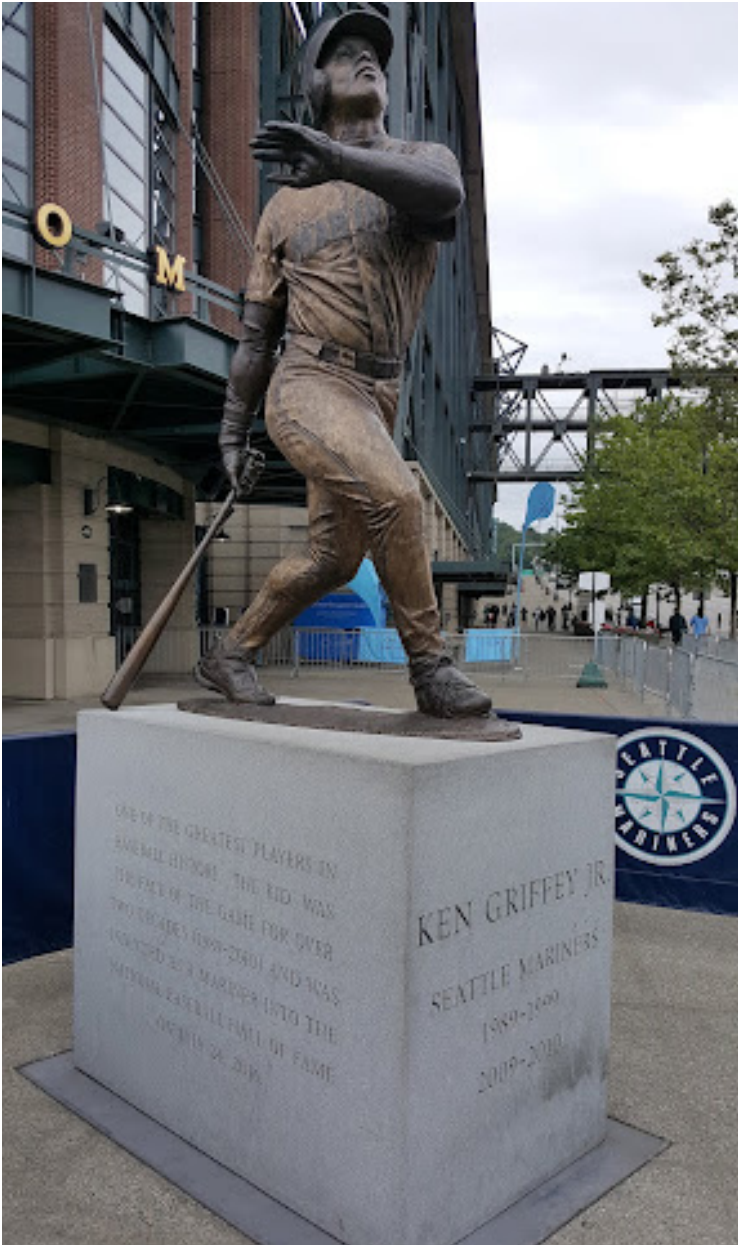



CPA PLAZA STATUES LANDMARKS PROPOSAL

**Abstract Statue Precedents**





CPA PLAZA STATUES LANDMARKS PROPOSAL

**Traditional Statue Precedents**



CHRIS CORNELL STATUE AT MOPOP

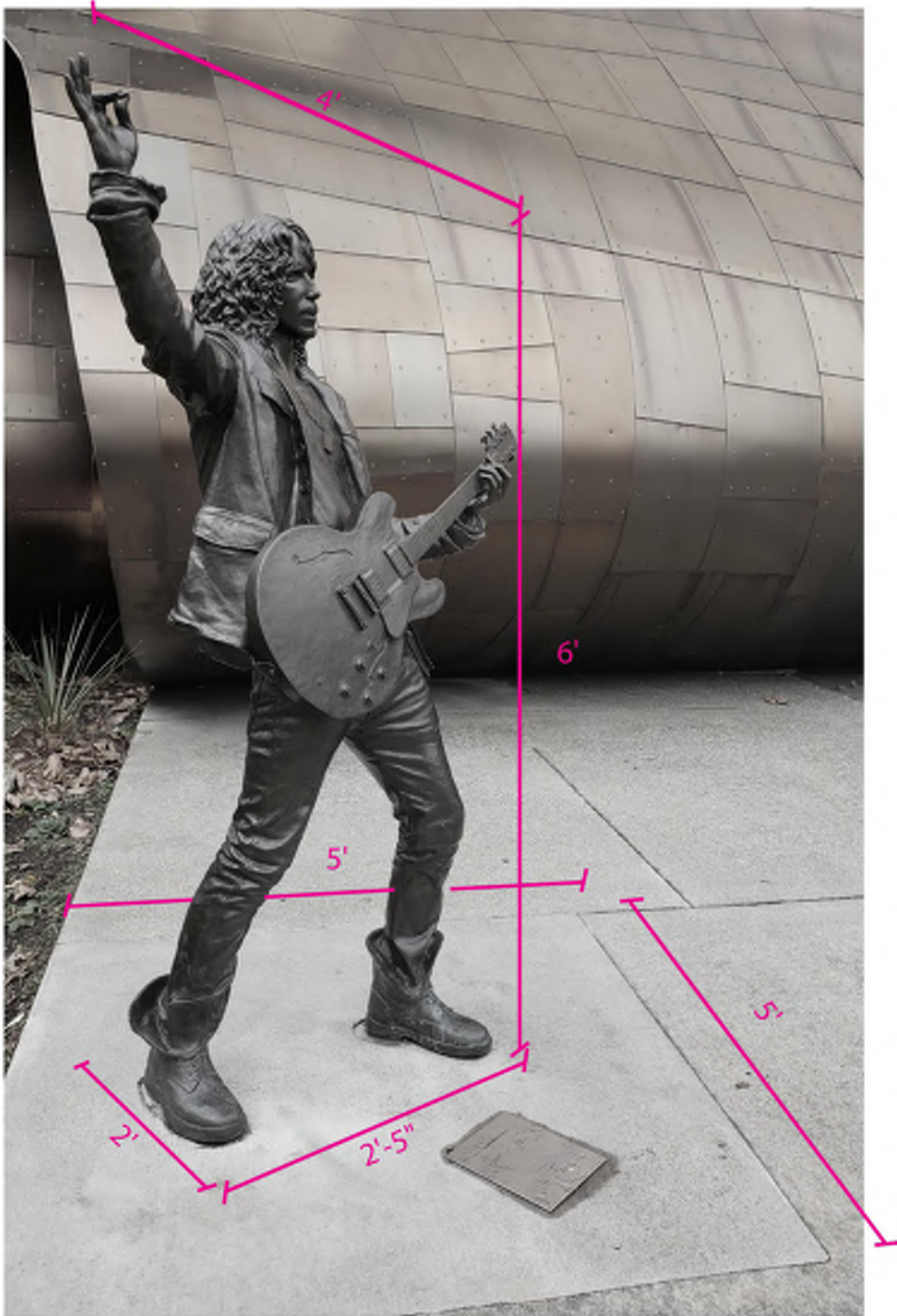

CHRIS CORNELL STATUE AT MOPOP - DIMENSIONS



12" RAISED CONCRETE PEDESTAL



NATURAL STONE PEDESTAL



LIGHTING IN CONCRETE OR IN PEDESTAL



CPA PLAZA STATUES LANDMARKS PROPOSAL

**Statue Location Opportunities**





CPA PLAZA STATUES LANDMARKS PROPOSAL

# Statue Location Opportunities

Overview:

The Intent of the following diagrams is to provide illustrations and rationale for potential sculpture locations within the context surrounding the CPA site.

Individual sculpture locations are generally open and accessible to the public, however are more limited by spatial constraints.

Grouped sculpture locations include spaces with less spatial constraints and could accommodate groupings of sculptures of various sizes and types.

The proposed locations for sculptures have taken into consideration the location of existing public art installments on the arena site, with the intent of providing each with sufficient latitude.

- Individual Statues / Artwork Numbers
- Grouped Statues / Artwork Letters
- Existing Public Art Location

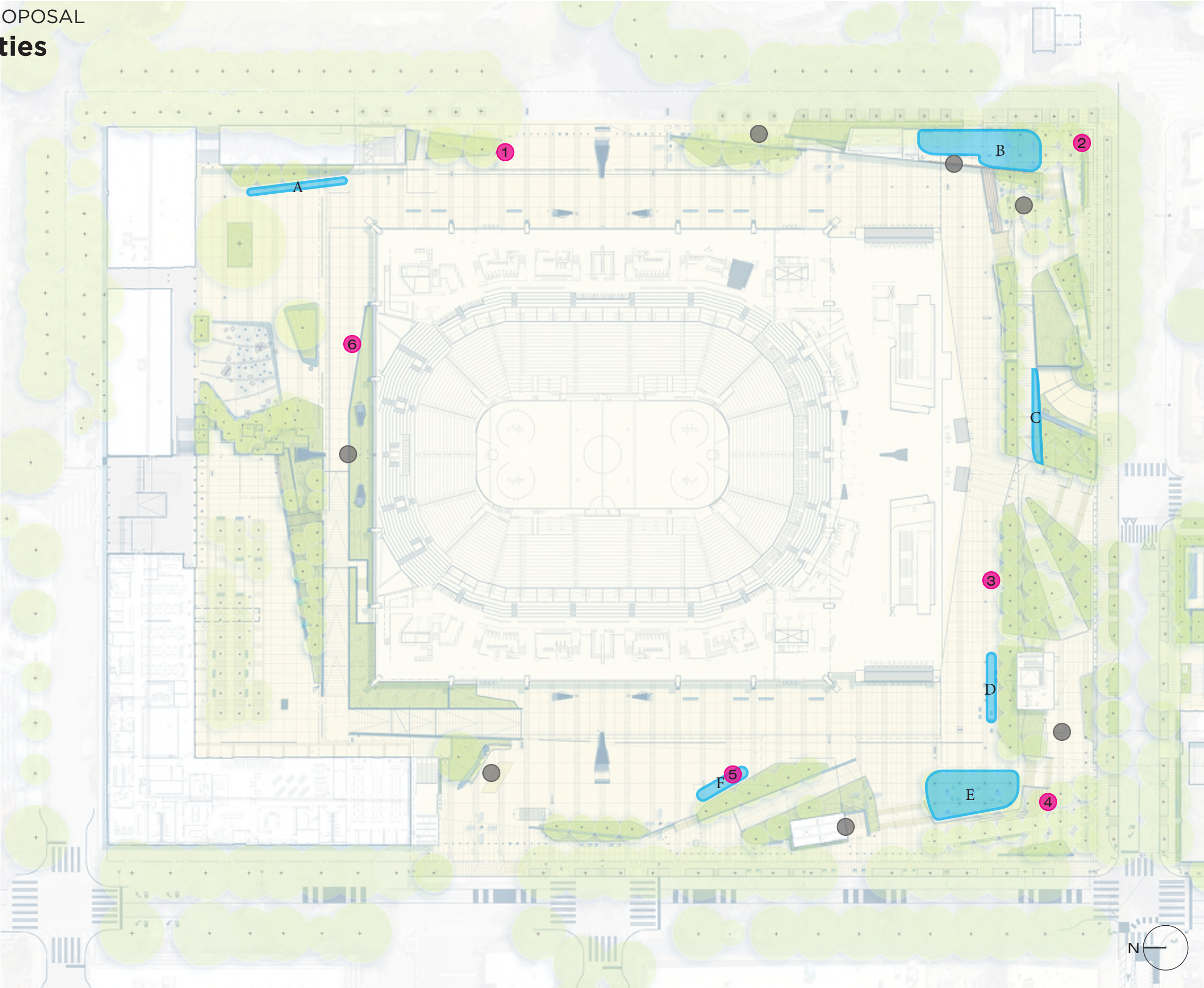



CPA PLAZA STATUES LANDMARKS PROPOSAL

Location Evaluation Criteria

<div><div></div></div> <div>0%25%50%75%100%</div>				
<b>Electrical Feasibility</b> <ul style="list-style-type: none"><li>Difficult location due to being above arena footprint therefore normal trenching for conduit will not be available - exposed conduit required.</li><li>Potential conflict with existing lighting.</li></ul>	<ul style="list-style-type: none"><li>Difficult location due to being above arena footprint therefore normal trenching for conduit will not be available - exposed conduit required.</li><li>Alt trenching through planting areas.</li></ul>	<ul style="list-style-type: none"><li>No issue or positive benefit to these locations.</li></ul>	<ul style="list-style-type: none"><li>Easy to tie into a nearby lighting electrical circuit therefore no need to add circuits or have a conduit path back to the building.</li><li>Minimizes exposed electrical conduit.</li></ul>	
<b>Structural Feasibility</b>	<ul style="list-style-type: none"><li>Located on structure. Structure designed for lower non-motorable loads with lower load rated geofoam.</li><li>Heavy statue loads NOT recommended.</li></ul>	<ul style="list-style-type: none"><li>Located on structure. Structure designed for heavier landscape + motorable loads.</li><li>Better-suited for individual statues, however groupings of statues and associated loads are problematic.</li></ul>	<ul style="list-style-type: none"><li>Located off structure, no structural constraints. Smaller grouped statues could be supported directly on paving slab. Adding a foundation requires removal and replacement of paving slab.</li></ul>	
<b>Site Integration</b> <ul style="list-style-type: none"><li>Presents significant operational challenges for Seattle Center or Climate Pledge Arena operations.</li></ul>	<ul style="list-style-type: none"><li>Limited footprint, coordination needed with maintenance and major pedestrian circulation pathways.</li><li>May compete with adjacent art, requires coordination.</li></ul>	<ul style="list-style-type: none"><li>Limited footprint, coordination needed with maintenance and major pedestrian circulation pathways.</li></ul>	<ul style="list-style-type: none"><li>Coordination needed with existing event programing and/or existing CPA lease line.</li></ul>	<ul style="list-style-type: none"><li>No issue to these locations.</li></ul>
<b>Experiential Enhancement</b> <ul style="list-style-type: none"><li>Location has many existing visual elements which may limit experiential impact.</li><li>Limited visibility from other areas in Seattle Center.</li></ul>	<ul style="list-style-type: none"><li>Location has many existing visual elements which may limit experiential impact.</li></ul>	<ul style="list-style-type: none"><li>No issue or positive benefit to these locations.</li></ul>	<ul style="list-style-type: none"><li>Excellent visibility from adjacent spaces.</li></ul>	<ul style="list-style-type: none"><li>Location is open and would benefit from addition of place-making art.</li><li>Excellent visibility from adjacent spaces.</li></ul>



CPA PLAZA STATUES LANDMARKS PROPOSAL

## Location Analysis & Images

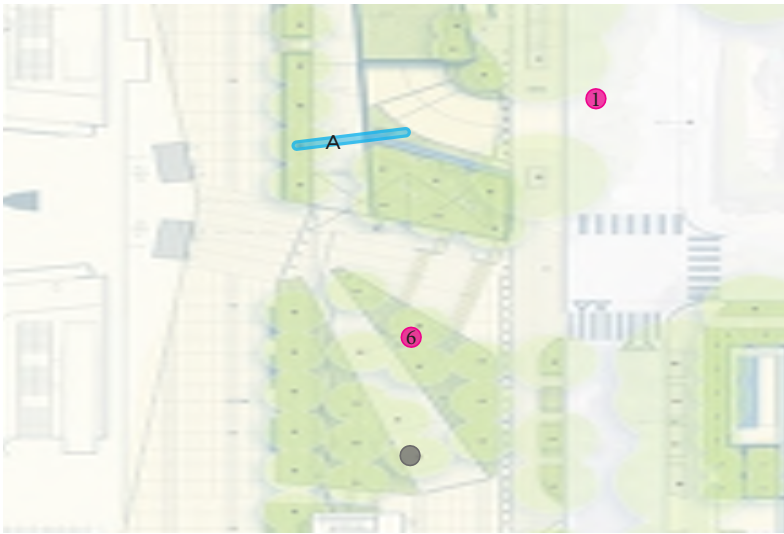

- **Grouped Statues / Artwork**  
Letters
- **Individual Statues / Artwork**  
Numbers
- **Existing Public Art Locations**



Electrical Feasibility



Structural Feasibility



Site Integration



Experiential Enhancement



Average Location Score:

**N/A**



### Site A - Opportunities:

- Open/ long space immediately adjacent (west) of the planting bed curb.
- Opportunity to bring life to the expansive space when otherwise empty.
- Access to power in the adjacent planter could support new/sculpture specific lighting or power connectivity.
- Excellent visibility from the adjacent spaces, and would provide a screen / foil in front of the pavilion wall that suffer from exposed mechanical equipment.
- Existing light from adjacent tall site poles might provide sufficient illumination.

### Constraints:

- Location was previously intentionally left empty for opportunities from SIFF / Seattle Center to locate outdoor movie screens / stages for events.
- Presents significant operational challenges for Seattle Center operations.
- The majority of this zone is outside the CPA lease line with Seattle Center and therefore is the location is not feasible.



CPA PLAZA STATUES LANDMARKS PROPOSAL

# Location Analysis & Images

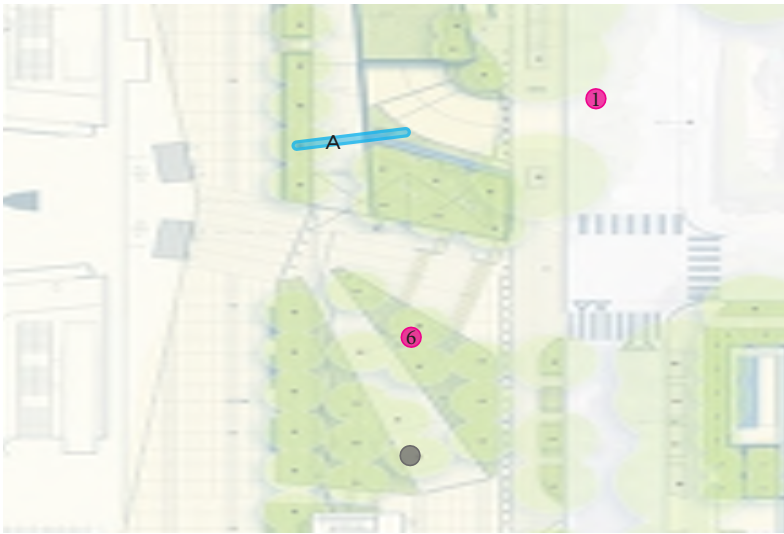

- **Grouped Statues / Artwork**  
Letters
- **Individual Statues / Artwork**  
Numbers
- **Existing Public Art Locations**

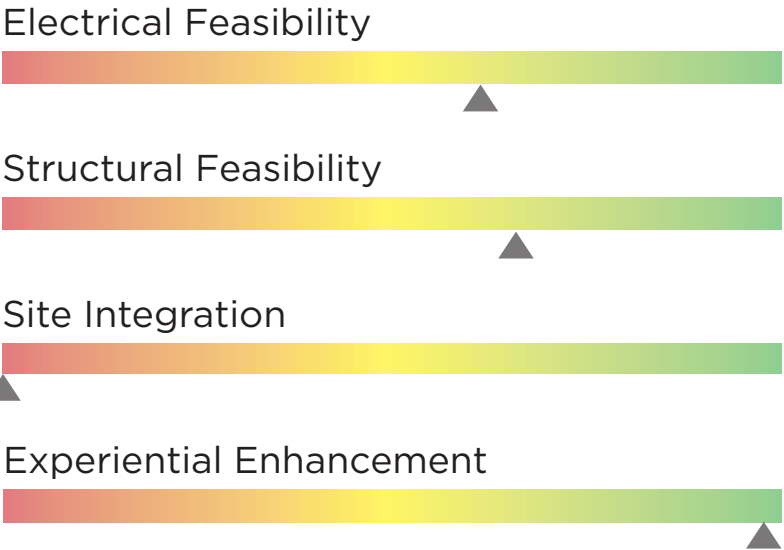

Average Location Score: **60**



## Site 1 - Opportunities:

- Open space immediately adjacent (south) edge of the planting bed in an area protected by the bollard alignment.
- Access to power in the adjacent lantern could support new/sculpture specific lighting or power connectivity.
- On-grade (east of CPA plaza structure below pavement) reduces challenges with conduit and pavement replacement.
- Highly visible from the heart of Seattle Center and major public pedestrian access routes.

## Constraints:

- Location has limited area due to the pathway for event and maintenance access through the hydraulic bollards to the south.
- Presents significant operational challenges for Seattle Center operations.
- Ambient light conditions might not be sufficient, requires testing with light meter.
- Requires coordination of statue foundations with bollard foundations.



CPA PLAZA STATUES LANDMARKS PROPOSAL

Location Analysis & Images

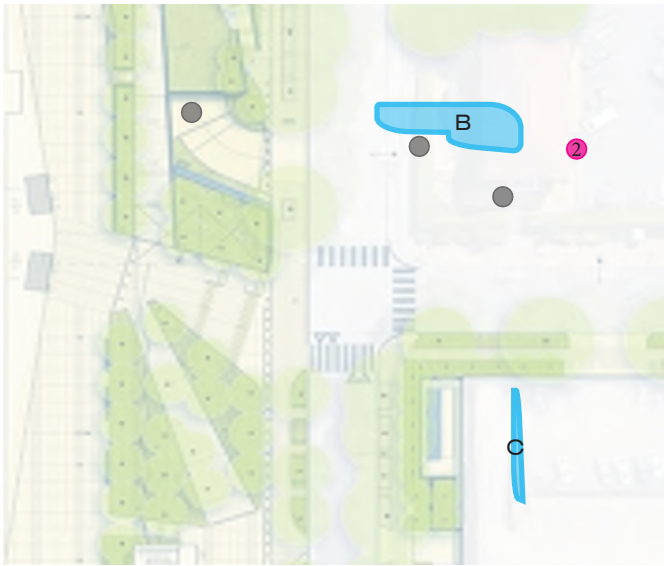

- **Grouped Statues / Artwork**  
Letters
- **Individual Statues / Artwork**  
Numbers
- **Existing Public Art Locations**

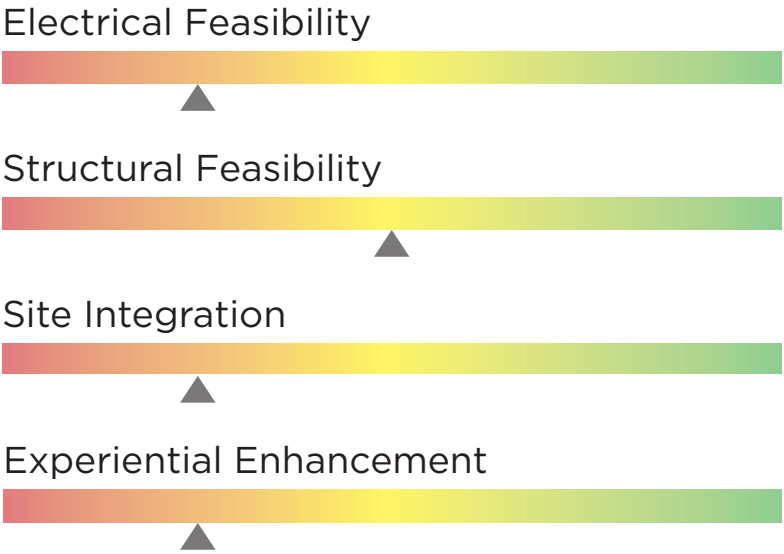

Average Location Score: **45**

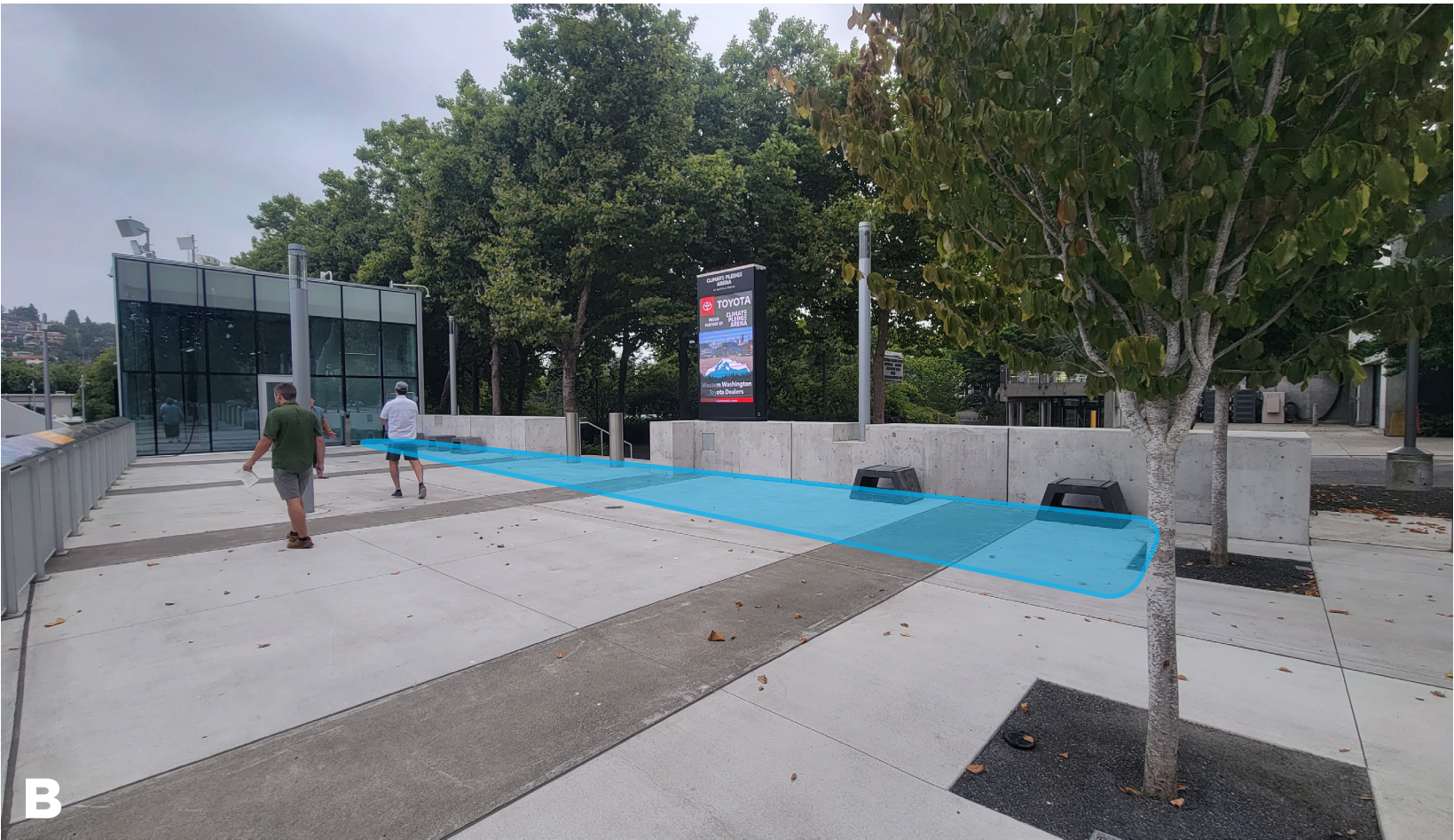

Site B - Opportunities:

- Small open space immediately adjacent the ADA elevator in an area protected by the site walls.
- Access to power in the adjacent planter (through the wall) could support new/ sculpture specific lighting or power connectivity.
- Moderate visibility from the heart of Seattle Center and major public pedestrian access routes.

Constraints:

- Location has limited area due to the ADA pathway for event and maintenance access through the hydraulic bollards to the north.
- Ambient light conditions might not be sufficient, requires testing with light meter.
- Entirely on-structure over the CPA exit stair. All foundations for statues will likely require removal and replacement of paving slab, and will need to be coordinated with several adjacent items.
- Above exit stair below, issue for electrical raceway, requires passing through wall into planter north of wall as the stair is a “no-fly” zone.



CPA PLAZA STATUES LANDMARKS PROPOSAL

Location Analysis & Images

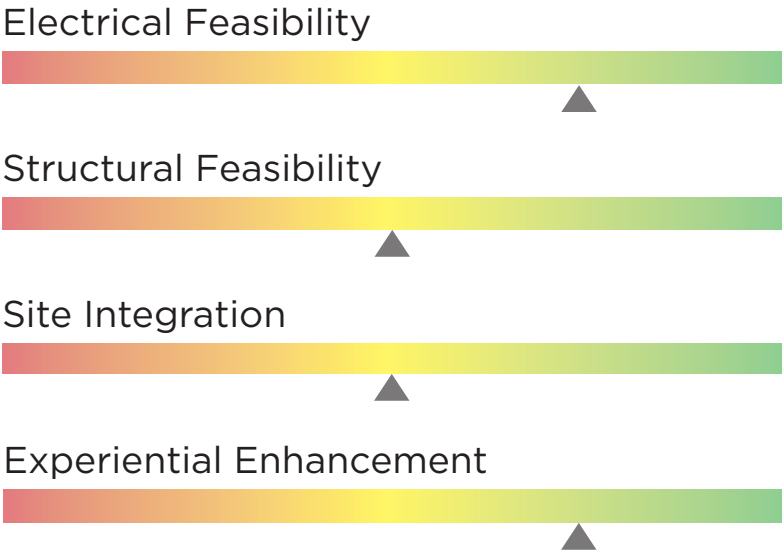
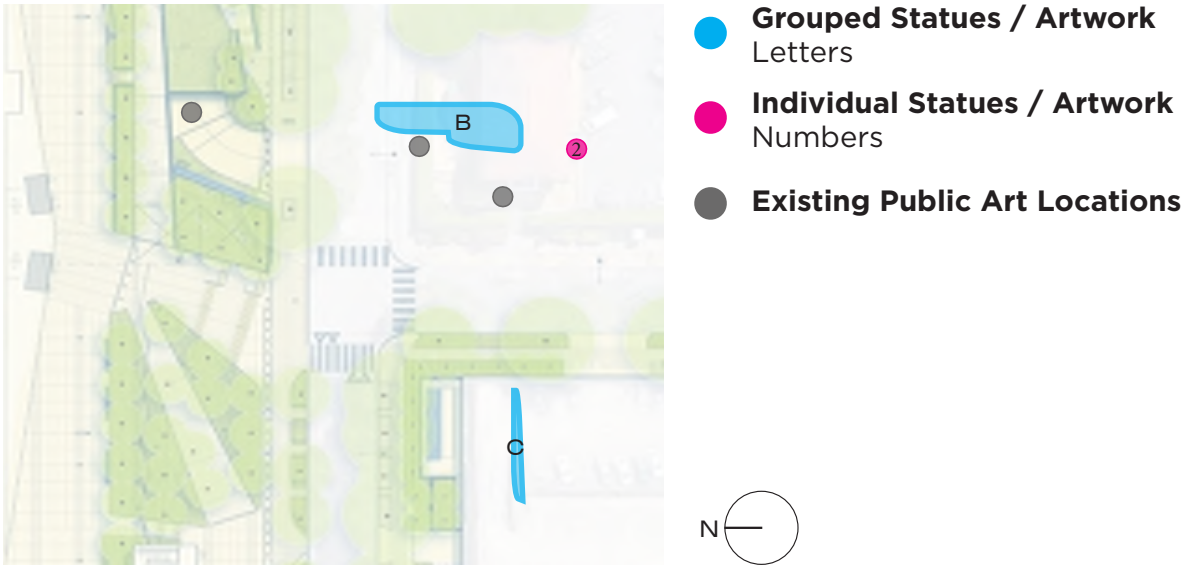

Average Location Score: 70



- Site 2 - Opportunities:
- Small open space immediately adjacent the SE pedestrian entry to the site.
  - Access to power in the adjacent planter (through the wall) could support new/ sculpture specific lighting or power connectivity.
  - High visibility from the heart of Seattle Center and major public pedestrian access routes.
- Constraints:
- Would recommend the spot to the south for less clutter around and better backdrop with the Arena.
  - On structure. Structure designed for higher tree/soil loads with lower load rated geofoam and thinner paving. Statue foundation requires coordination with bollard and wall foundations.



CPA PLAZA STATUES LANDMARKS PROPOSAL

## Location Analysis & Images

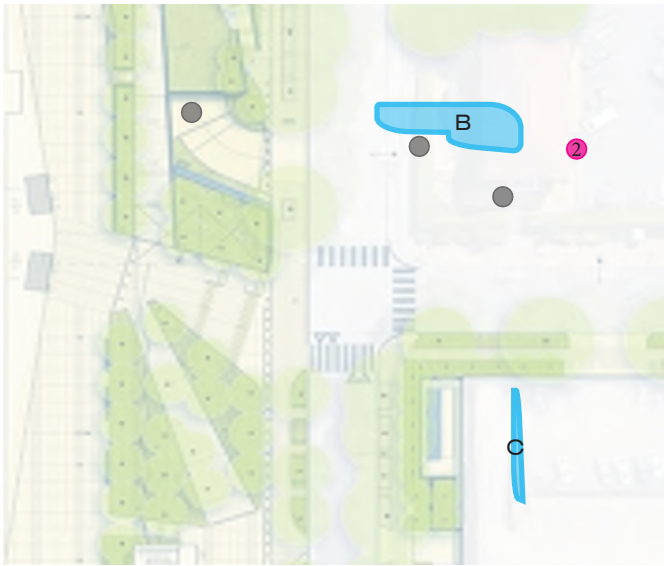

- **Grouped Statues / Artwork**  
Letters
- **Individual Statues / Artwork**  
Numbers
- **Existing Public Art Locations**



Electrical Feasibility



Structural Feasibility



Site Integration



Experiential Enhancement



Average Location Score: **75**



### Site C - Opportunities:

- Small space along the south edge of the sloped walk and guardrail above the garage entry drive.
- Access to power in the planter could support new/sculpture specific lighting or power connectivity.
- Excellent visibility from the adjacent spaces.

### Constraints:

- Limited feasible size of sculptures to not impact the walking zone for pedestrians.
- Challenging access to power - likely required to feed from the base of the rail/site wall to support new/sculpture specific lighting or power connectivity.
- Located on structure that is designed for lower non-motorable loads with lower load rated geofoam and thinner paving. Grouped statue foundation likely requires removal and replacement of paving slab with thicker larger foundation



CPA PLAZA STATUES LANDMARKS PROPOSAL

## Location Analysis & Images

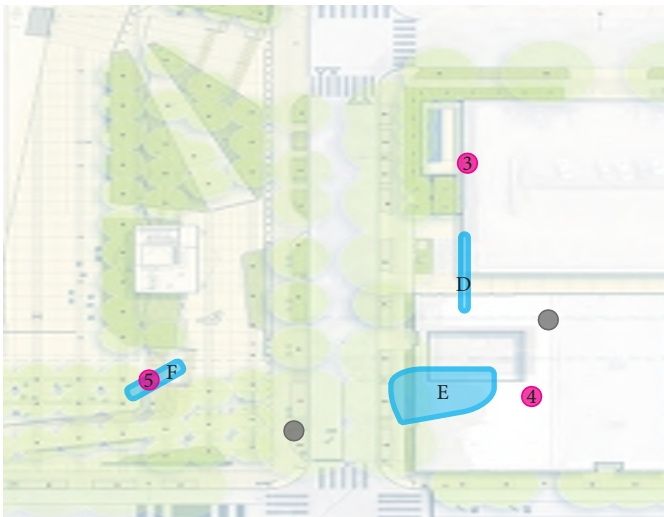

- **Grouped Statues / Artwork Letters**
- **Individual Statues / Artwork Numbers**
- **Existing Public Art Locations**



Electrical Feasibility



Structural Feasibility



Site Integration



Experiential Enhancement



Average Location Score: **55**



### Site 3 - Opportunities:

- Long open space immediately adjacent the planter and primary south pedestrian entry to the site.
- Access to power in the adjacent planter could support new/sculpture specific lighting or power connectivity.
- High visibility from both inside and outside the CPA atrium.
- Possible to integrate into the edge of landscape bed.
- Located on structure that is designed for motorable loads with higher load rated geofoam. Smaller grouped statues could possibly be supported directly on paving slab.

### Constraints:

- Large benches are fixed, so art would go around benches.
- Big digital reader board scale.
- Ambient light conditions might not be sufficient, requires testing with light meter.
- Entirely on-structure over the CPA roof.
- Conduit runs limited to within planter.
- Competes with front view of arena and south buttress.



CPA PLAZA STATUES LANDMARKS PROPOSAL

Location Analysis & Images

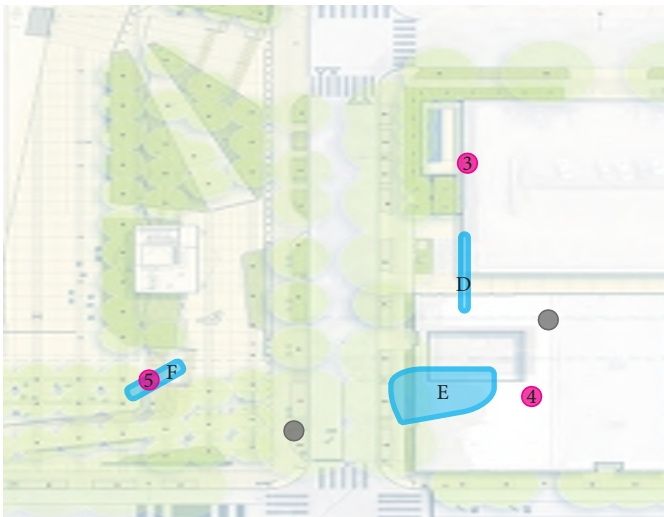

- Grouped Statues / Artwork Letters
- Individual Statues / Artwork Numbers
- Existing Public Art Locations

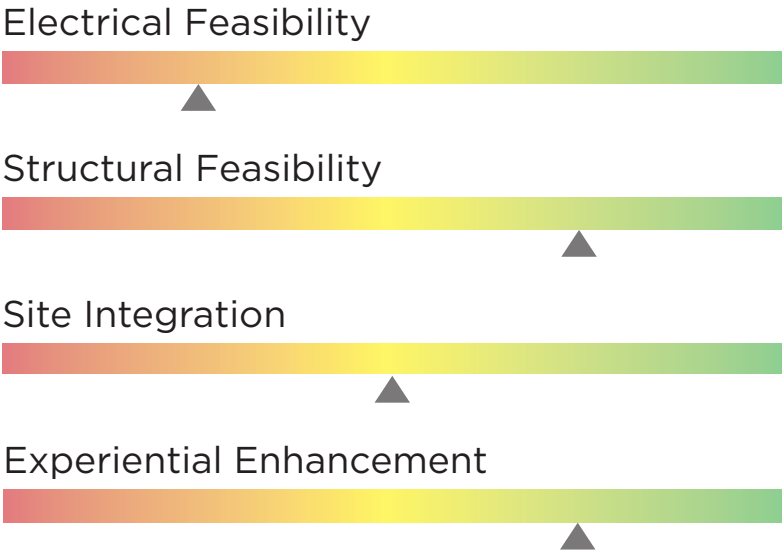

Average Location Score: 55



Site D - Opportunities:

- Long open space immediately adjacent the planter and primary south pedestrian entry to the site.
- Access to power in the adjacent planter could support new/sculpture specific lighting or power connectivity.
- High visibility from both inside and outside the CPA atrium.
- Structure below rated for higher motorable loads.

Constraints:

- Large benches are fixed, so art would go around benches.
- Big digital reader board scale.
- Ambient light conditions might not be sufficient, requires testing with light meter.
- Entirely on-structure over the CPA roof.
- Conduit runs limited to within planter.
- Competes with front view of arena and south buttress.



CPA PLAZA STATUES LANDMARKS PROPOSAL

# Location Analysis & Images

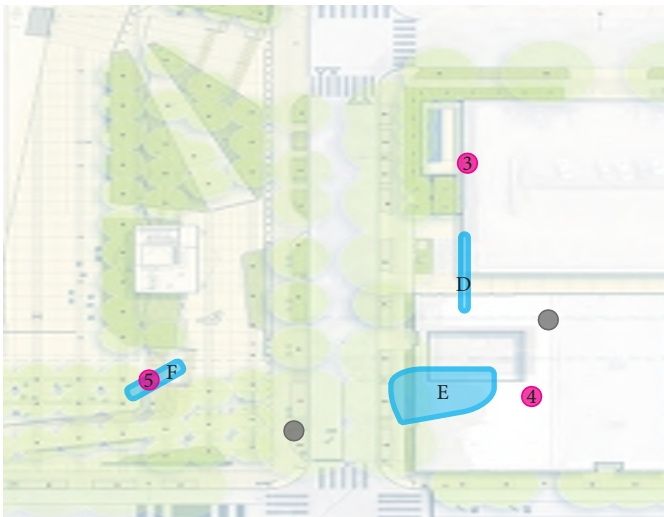

- **Grouped Statues / Artwork**  
Letters
- **Individual Statues / Artwork**  
Numbers
- **Existing Public Art Locations**



Electrical Feasibility



Structural Feasibility



Site Integration



Experiential Enhancement



Average Location Score: **70**



## Site 4 - Opportunities:

- Small open space immediately adjacent the SW entry of the CPA steps and primary south pedestrian entry to the site.
- High visibility from both the site and public ROW.
- Great 'selfie-spot' .

## Constraints:

- Ambient light conditions might not be sufficient, requires testing with light meter.
- Potential conflicts over site stormwater detention tank and/or piping.
- Difficult location for new / sculpture specific power and lighting.



CPA PLAZA STATUES LANDMARKS PROPOSAL

# Location Analysis & Images

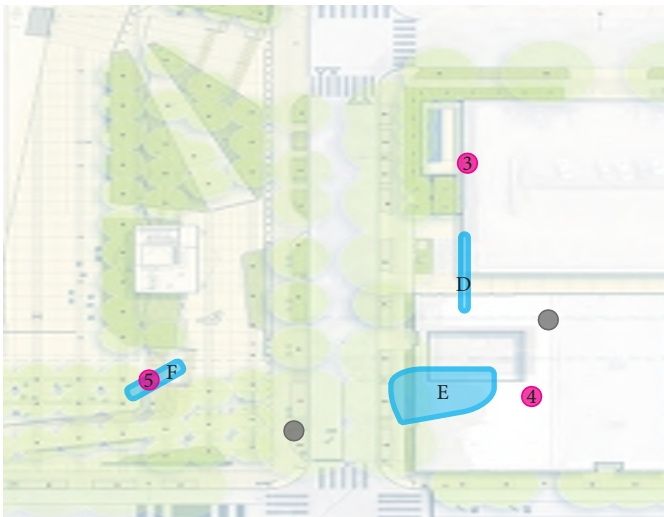

- **Grouped Statues / Artwork**  
Letters
- **Individual Statues / Artwork**  
Numbers
- **Existing Public Art Locations**



Electrical Feasibility



Structural Feasibility



Site Integration



Experiential Enhancement



Average Location Score: **80**



## Site E - Opportunities:

- Located on structure, but there are no constraining impacats.
- Allows for some play with scale in and amongst the trees
- High visibility location from both the atrium and streetscape.

## Constraints:

- This location was the where the“Go Kraken” sign was placed for the playoff run. This would require a new home for that signage.
- Requires coordiation around, and likely removal of, soil cells.



CPA PLAZA STATUES LANDMARKS PROPOSAL

Location Analysis & Images

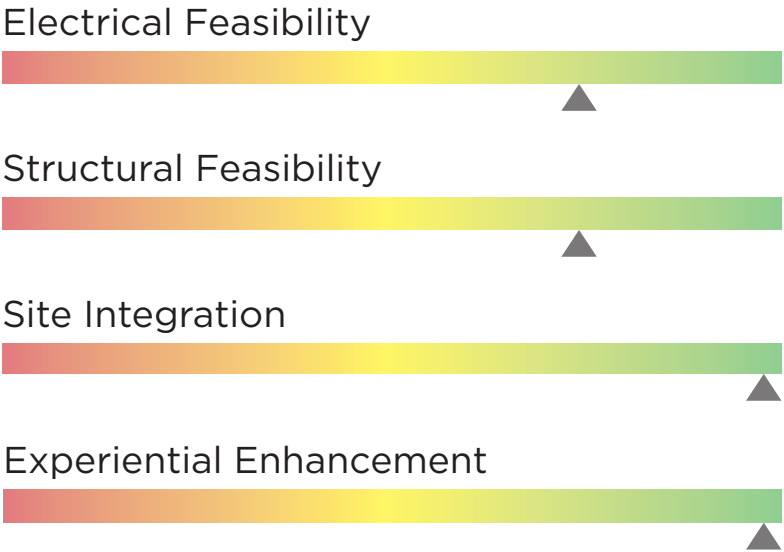
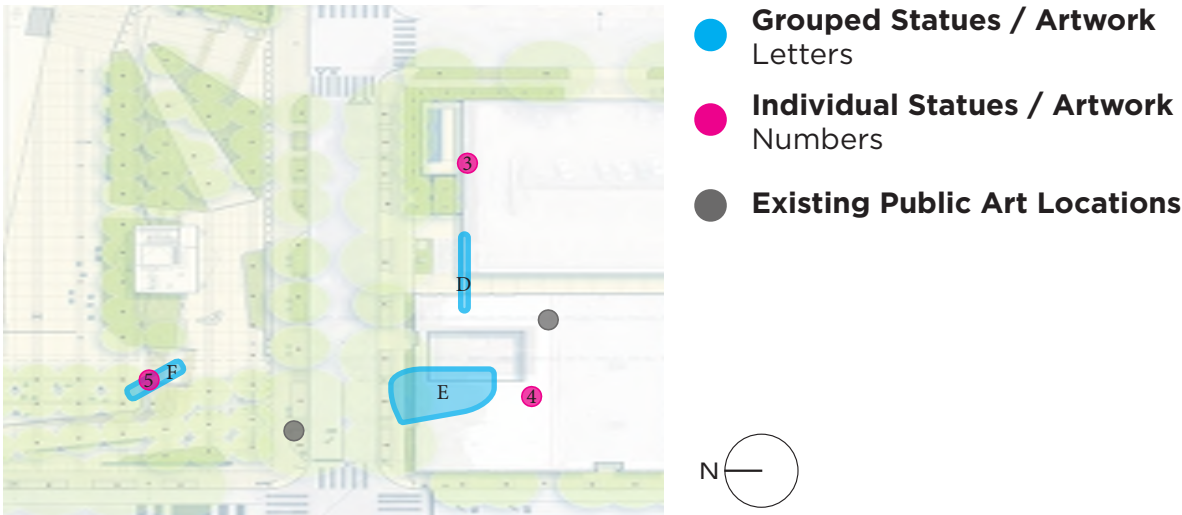

Average Location Score: 90



- Site F / 5 - Opportunities:
- Open/ long space immediately adjacent the planting bed.
  - Opportunity to bring life to the expansive space along the pedestrian corridor.
  - Access to power in the adjacent planter could support new/sculpture specific lighting or power connectivity.
  - Excellent visibility from the adjacent spaces.
- Constraints:
- Ambient light conditions might not be sufficient, requires testing with light meter.



CPA PLAZA STATUES LANDMARKS PROPOSAL

## Location Analysis & Images

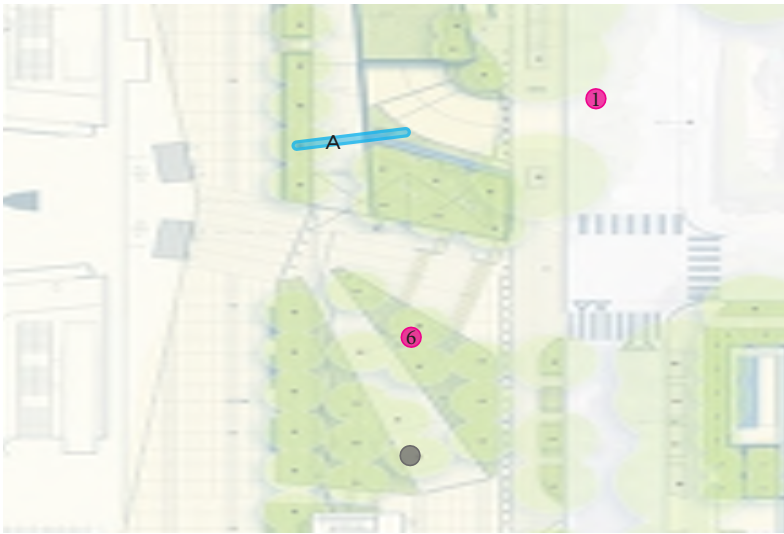

- **Grouped Statues / Artwork**  
Letters
- **Individual Statues / Artwork**  
Numbers
- **Existing Public Art Locations**



Electrical Feasibility



Structural Feasibility



Site Integration



Experiential Enhancement



Average Location Score:

45



### Site 6 - Opportunities:

- Open/ long space immediately adjacent (north) of the planting bed wall.
- Opportunity to bring life to the expansive space along the pedestrian corridor.
- Access to power in the adjacent planter could support new/sculpture specific lighting or power connectivity.
- Excellent visibility from the adjacent spaces.

### Constraints:

- Competes with the DuPen Fountain sculptures to the north.
- Entirely above structure for CPA plaza framing, though this structure is designed to take large vehicle loads.
- Ambient light conditions might not be sufficient, requires testing with light meter.
- Electrical routing limited to within planting bed.
- Presents significant operational challenges for Seattle Center operations - access easements exist in this zone.



CPA PLAZA STATUES LANDMARKS PROPOSAL

Scoring Summary

Location	Score
A	N/A
1	60
B	45
2	70
C	75
3	55
D	55
4	70
E	80
F / 5	90
6	45

- Individual Statues / Artwork Numbers
- Grouped Statues / Artwork Letters
- Existing Public Art Location

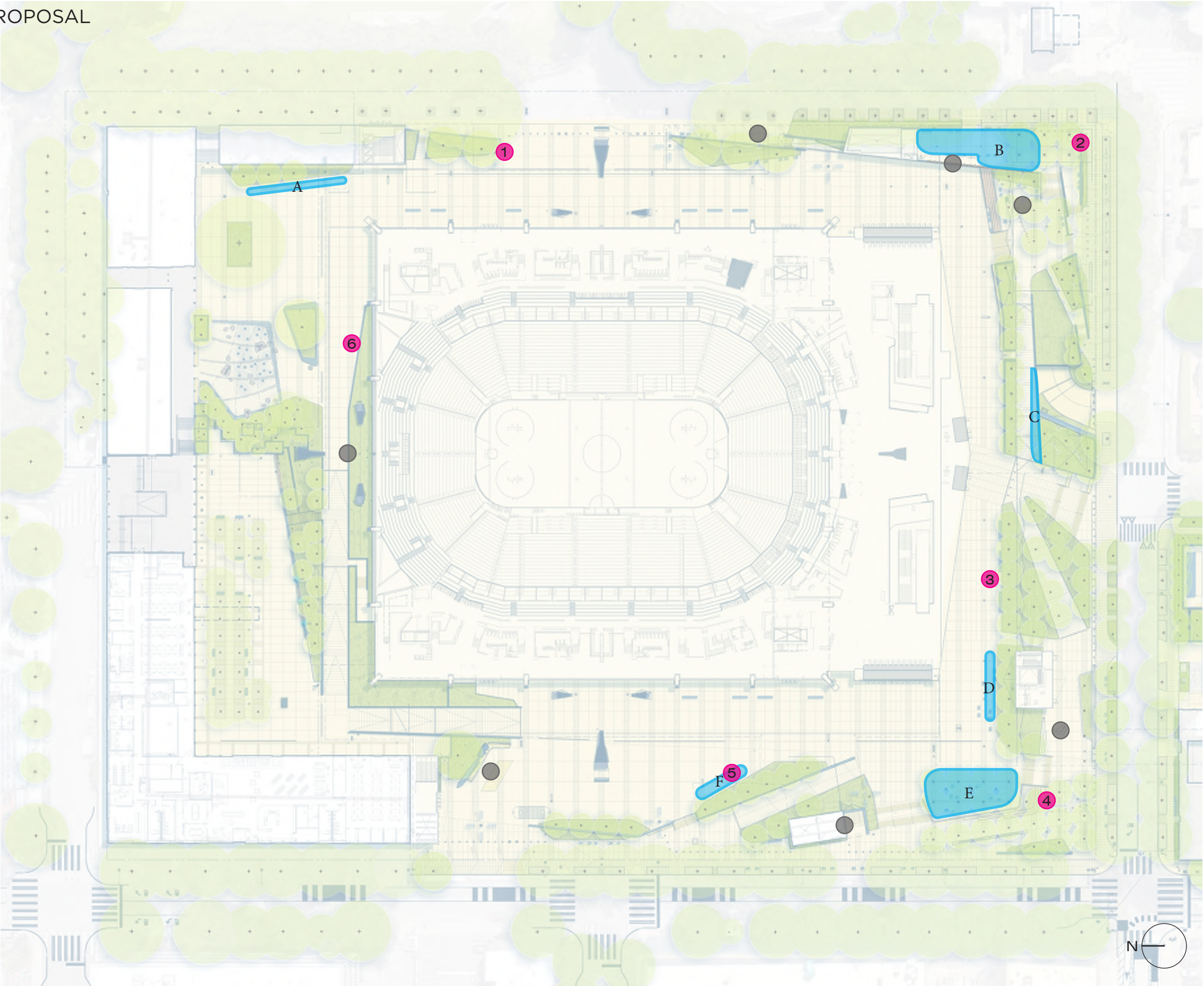



CPA PLAZA STATUES LANDMARKS PROPOSAL

**Preferred Statue Location - F/5**



- **Grouped Statues / Artwork**  
Letters
- **Individual Statues / Artwork**  
Numbers

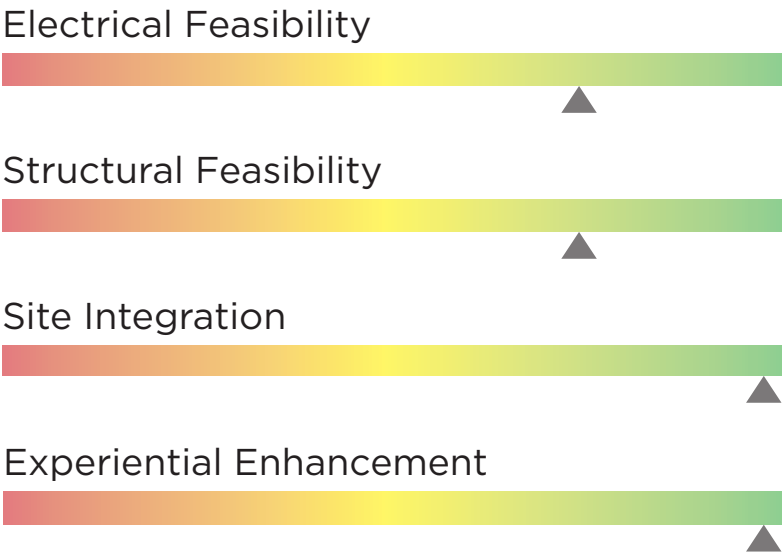

Average Location Score: **90**



- Site F / 5 - Opportunities:**
- Open/ long space immediately adjacent the planting bed.
  - Opportunity to bring life to the expansive space along the pedestrian corridor.
  - Access to power in the adjacent planter could support new/sculpture specific lighting or power connectivity.
  - Excellent visibility from the adjacent spaces.
- Constraints:**
- Partially over the stormwater detention tank, though the tank is designed for a high imposed load.
  - Ambient light conditions might not be sufficient, requires testing with light meter.



## Statue Design Parameters

**STATUE TYPE:** traditional

**STATUE QUANTITY:** two (2) initial statues + up to three (3) additional future statues

**PEDESTAL DIMENSIONS:** pedestals to be 5'-0" wide x 7'-0" long x 2'-0" high\*

**PEDESTAL MATERIAL:** stone or concrete material, intended to match color and appearance of existing precast or CIP concrete site furnishings

**STATUE HEIGHT:** approximately 7'-0" tall statue figures (statue height is in addition to pedestal height)

**STATUE MATERIAL:** marine silicone bronze

**LIGHTING:** uplighting in statue base, or new light pole(s) in adjacent planter area

**OTHER FEATURES:** name/identification plaque or engraving integrated into statue pedestals

*(\*dimensions are maximums)*



CPA PLAZA STATUES LANDMARKS PROPOSAL

**Preferred Statue Location - F/5**

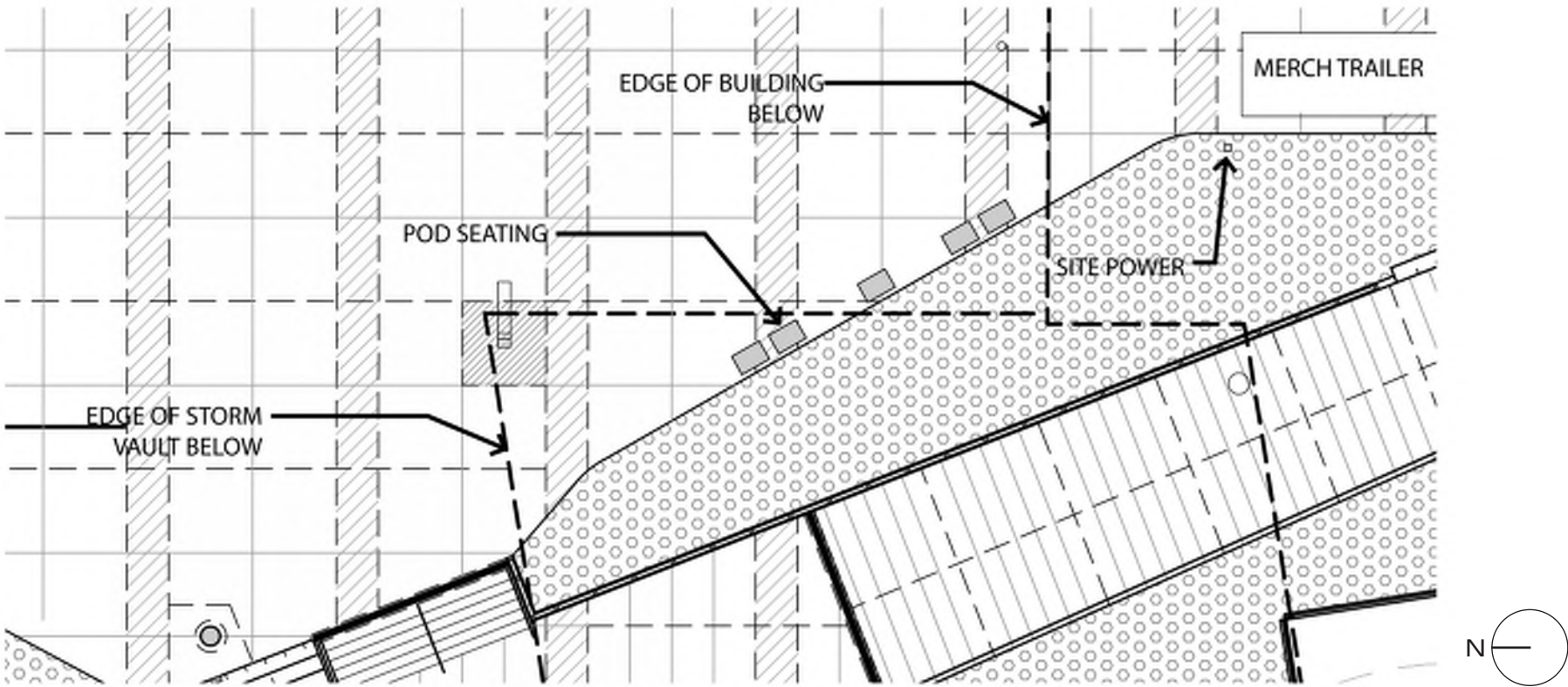

STATUE SITE LOCATION - CURRENT LAYOUT

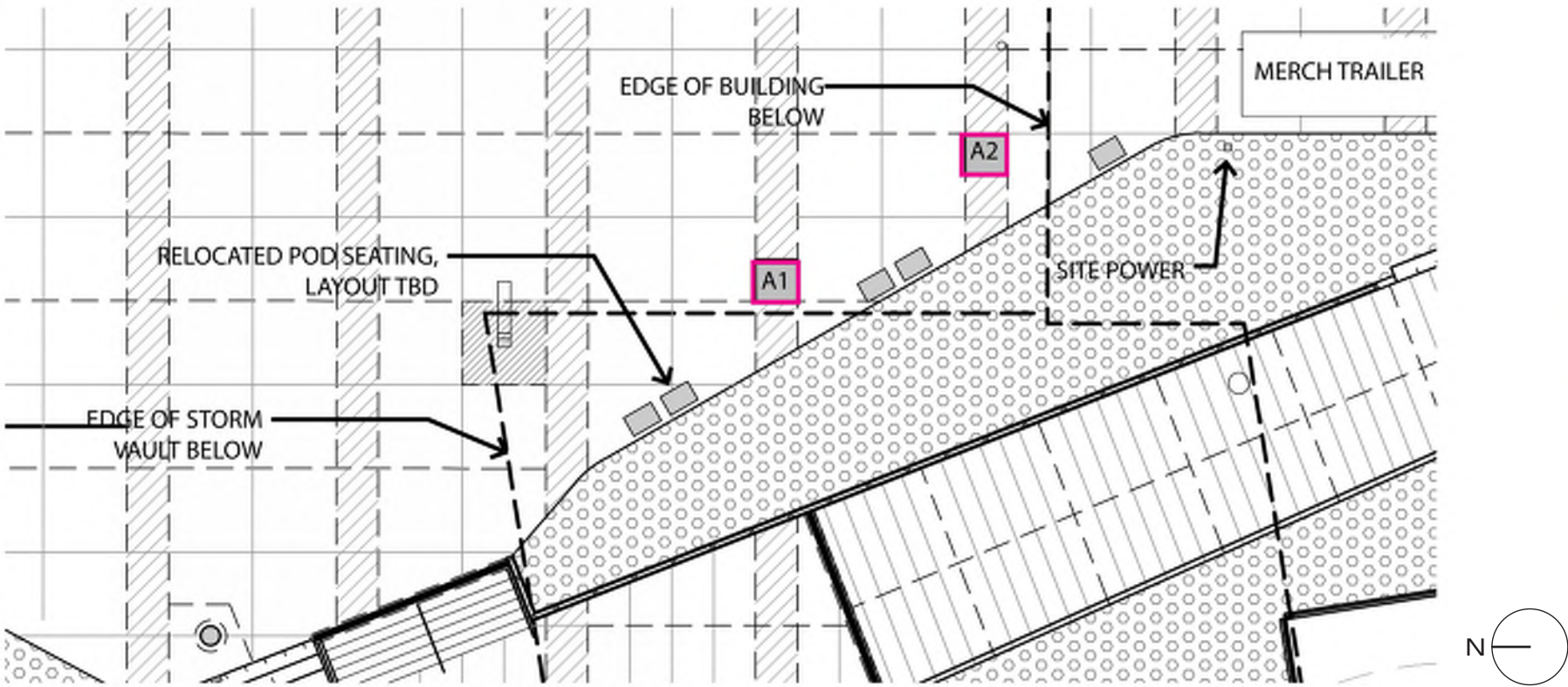

STATUE SITE LOCATION - PROPOSED TWO STATUES



STATUE SITE LOCATION - LOOKING NORTHWEST

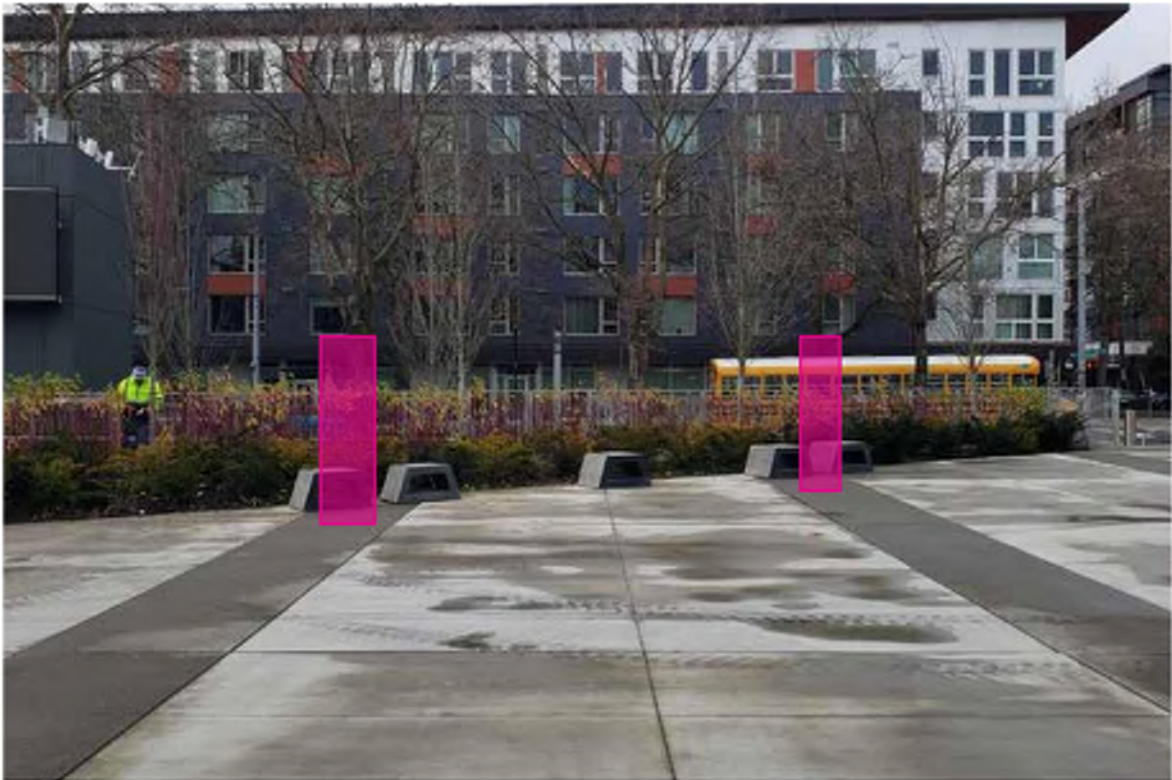

STATUE SITE LOCATION - LOOKING WEST



CPA PLAZA STATUES LANDMARKS PROPOSAL

**Preferred Statue Location - F/5**

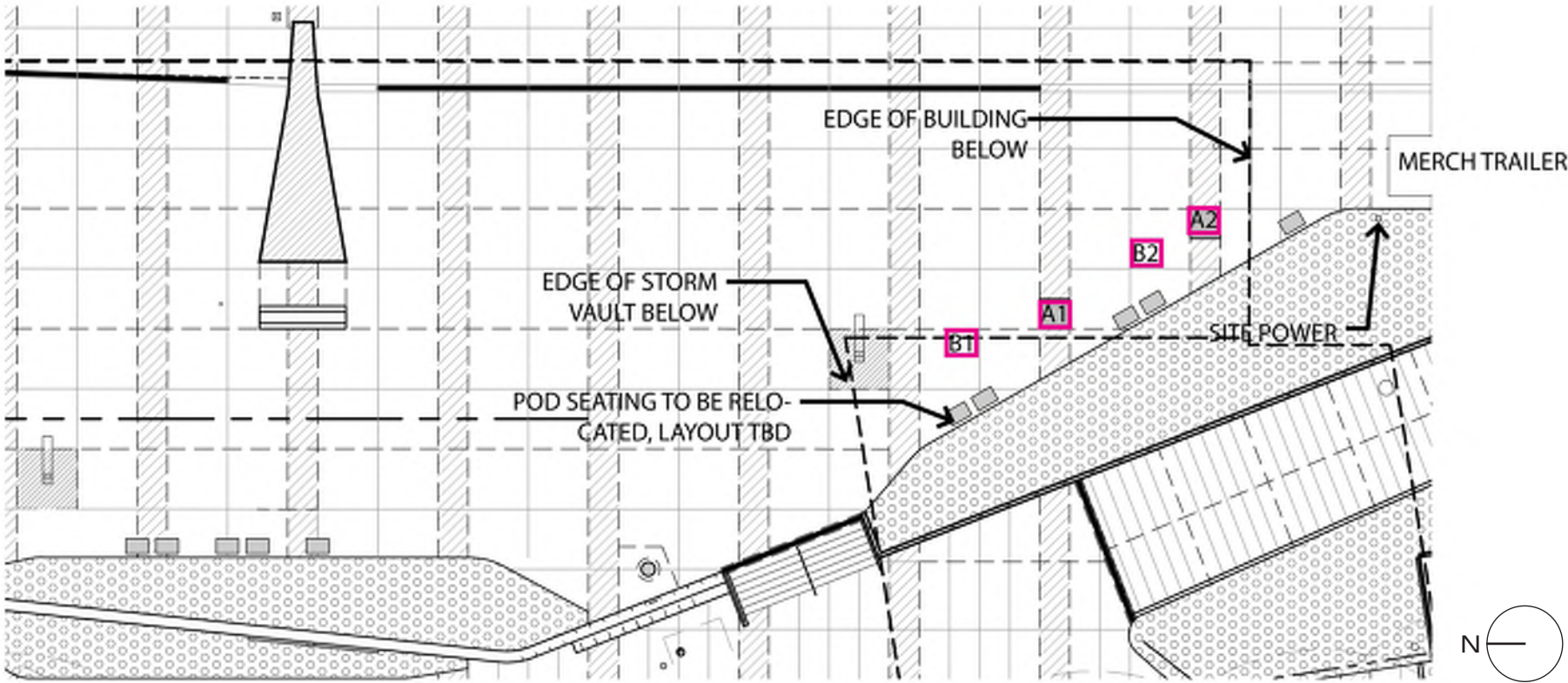

STATUE SITE LOCATION - FUTURE PLAN 2+ STATUES

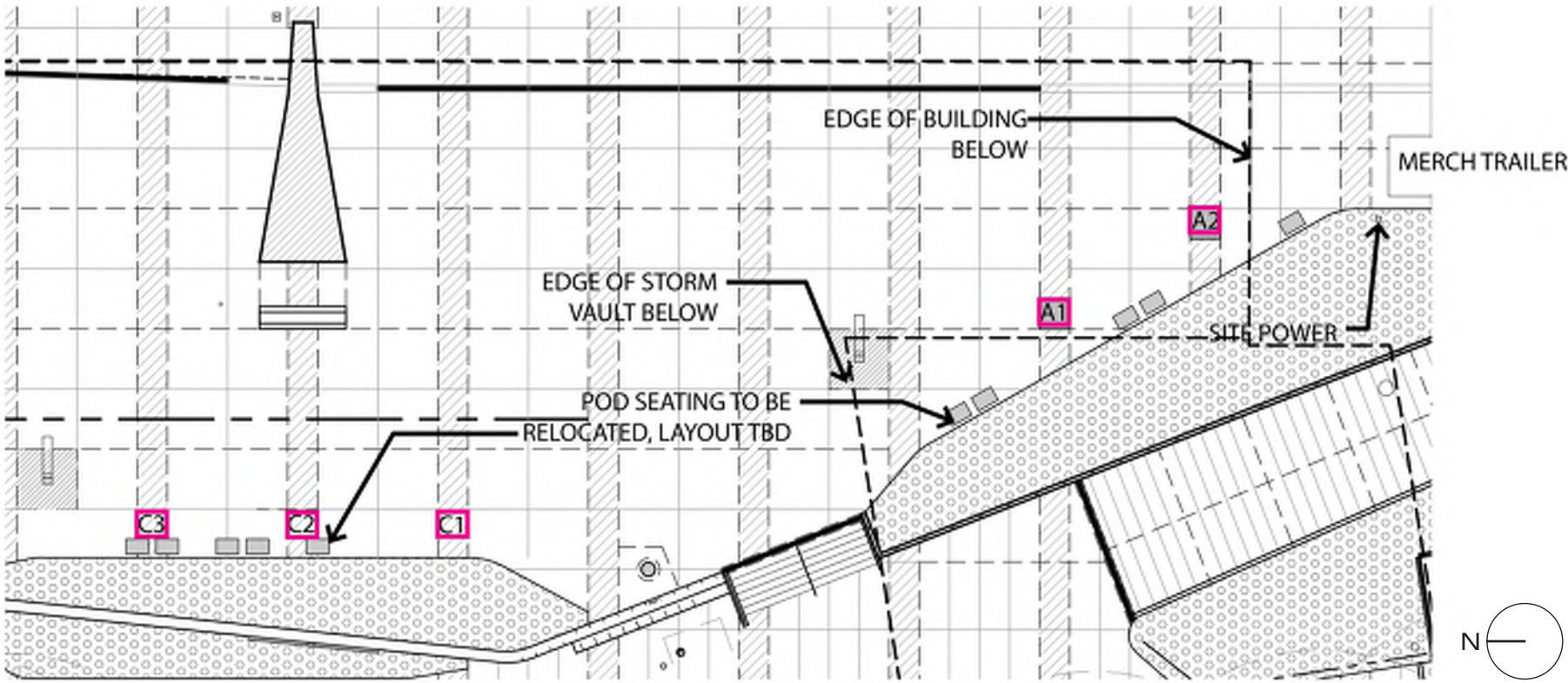

STATUE SITE LOCATION - FUTURE PLAN 2+ STATUES- ALT

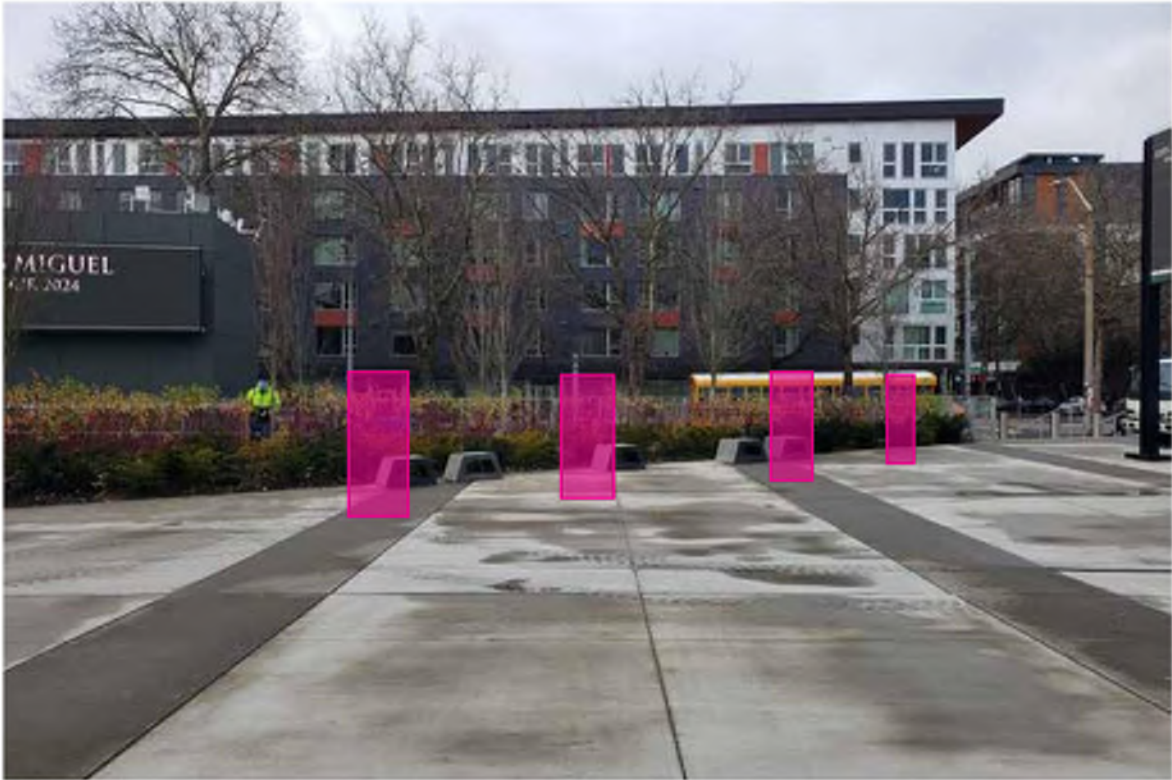

STATUE SITE LOCATION - LOOKING WEST

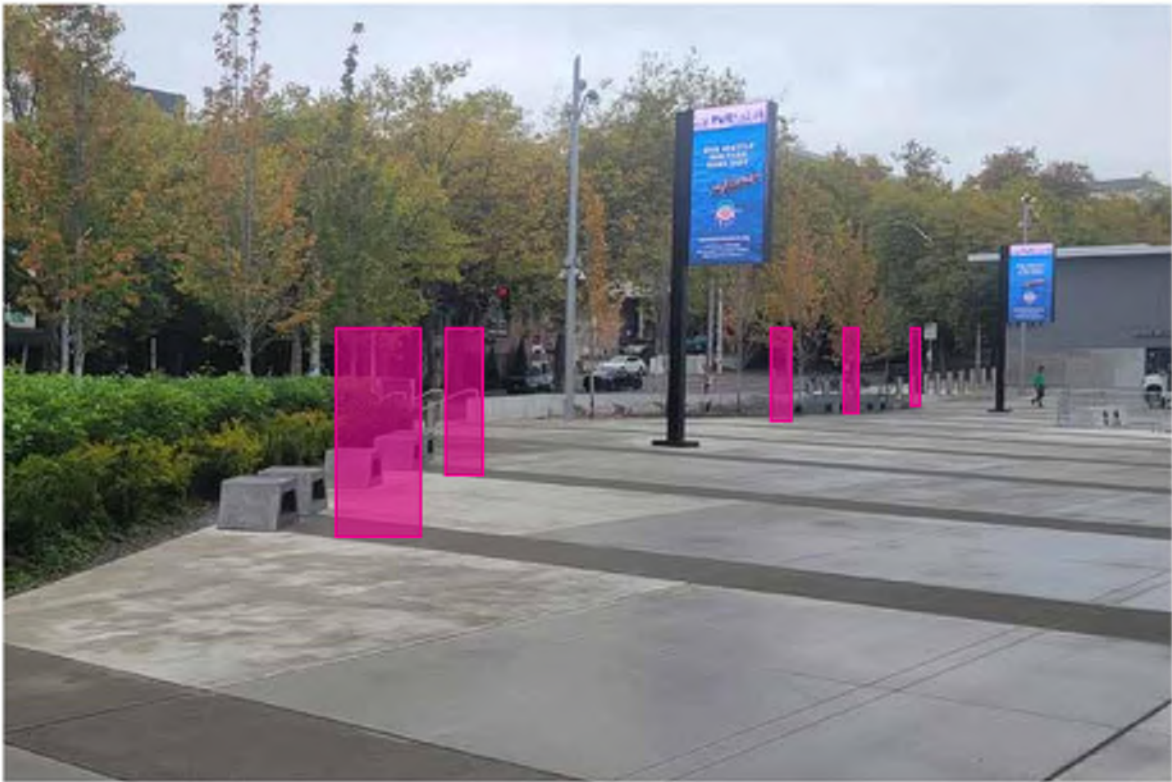

STATUE SITE LOCATION - LOOKING NORTHWEST



CPA PLAZA STATUES LANDMARKS PROPOSAL

**Statue Pedestal Design**



PRECEDENT - HISTORIC ARENA STRUCTURE



PRECEDENT - CURRENT CUSTOM CPA SEAT PODS

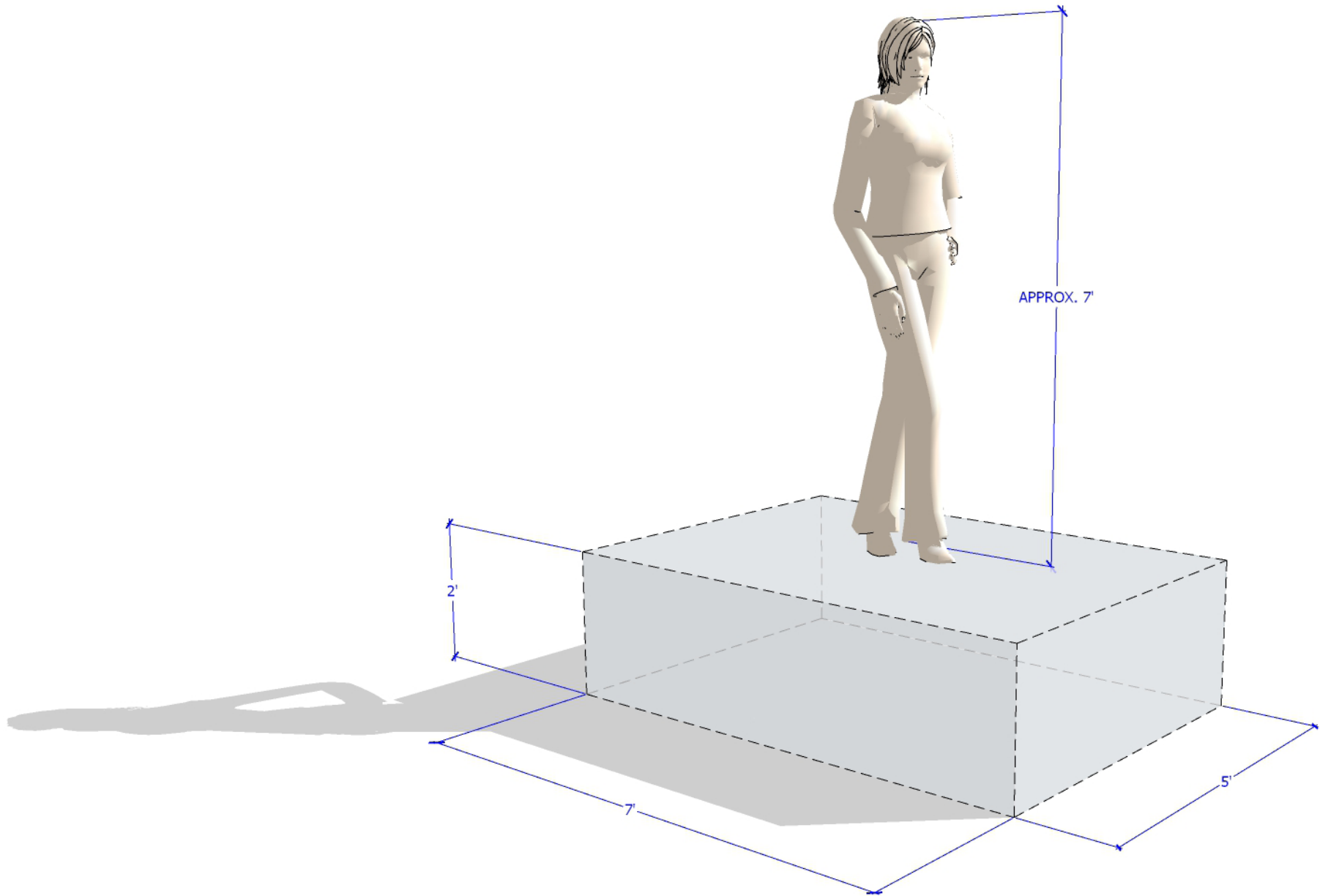

PEDESTAL DIMENSIONS (\*MAXIMUMS)



CPA PLAZA STATUES LANDMARKS PROPOSAL

# Statue Lighting Design



PRECEDENT - INTEGRAL PEDESTAL UP-LIGHTING

## ERCO Tesis In-ground luminaire

Lens wallwasher

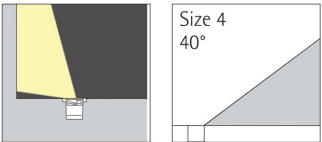
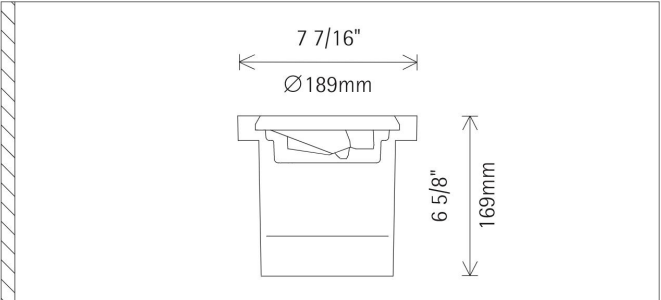

**35073.023**  
LED 16W 1680lm 3000K warm white  
0-10V dimmable  
Version 9  
Size 4  
Lens system, wallwash

**Product description**  
Housing: polymer, black.  
Control gear 120V/277V, 60Hz, dimmable. Longitudinally watertight cable 5xAWG14, L 31 1/2" / 800mm.  
LED module: high-power LEDs on metal-core PCB. Rotatable through 360°. Lens system made of optical polymer.  
Wallwasher reflector: polymer, aluminum vaporized, silver, ribbed, partially black lacquered, with lower diffuser. Optical cut-off 40° from horizontal.  
Screw-fastened cover ring with flush safety glass: stainless steel. Safety glass: 9/16" / 15mm, clear.  
Installation with separate connection sleeve.

Mounting in recessed housing: can be driven over in vehicles with pneumatic tyres. Load 4500lb.wt / 20kN.  
Dimming with external dimmers possible (0-10V).  
Suitable for wet location (IP68): dust-proof.  
Weight 5.07lbs / 2.30kg  
Version with 3000K CRI 97 or 2700K, 3500K, 4000K CRI 92 available on request.

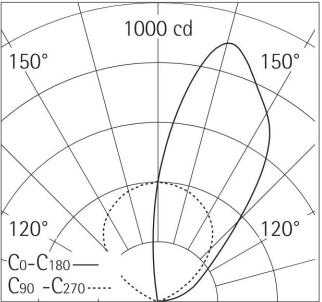

BASIS-OF-DESIGN LIGHT FIXTURES



CPA PLAZA STATUES LANDMARKS PROPOSAL

# Statue Lighting Design



PRECEDENT - STAND ALONE POLE LIGHTING

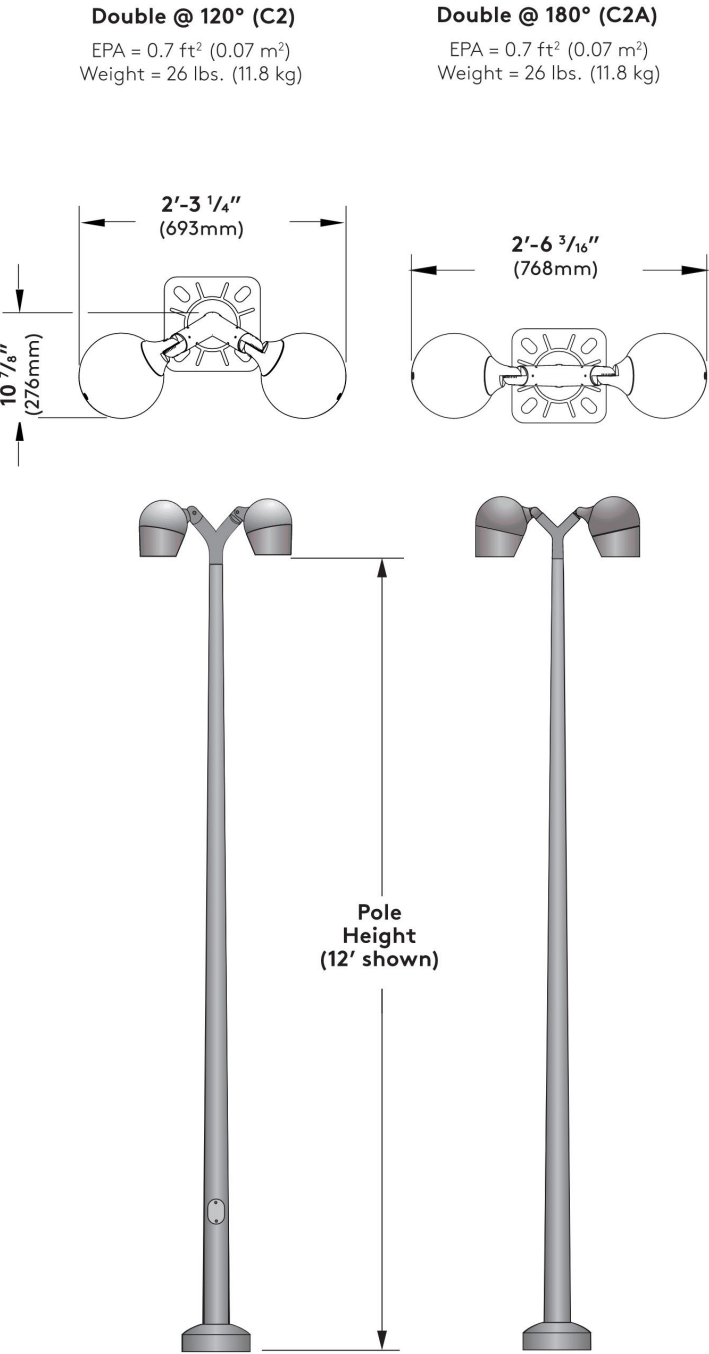

BASIS-OF-DESIGN LIGHT FIXTURES

Olivio Medio LED - Candelabra Pole Top

**Pole Information**  
Refer to pole specification sheets for construction details, anchorage information, and additional options.

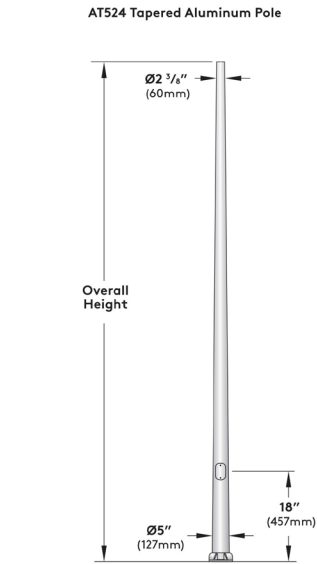

**BC3 Optional Base Cover**  
Die cast aluminum, two piece field installable base cover

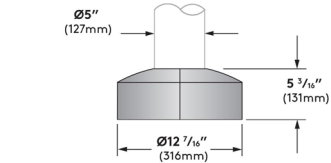

**Base Cover Information**  
Refer to pole specification sheets for construction details, anchorage information, and additional options.

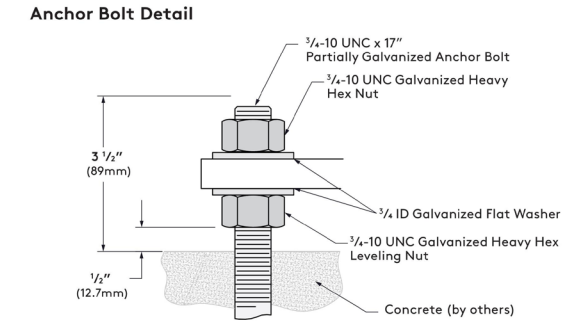
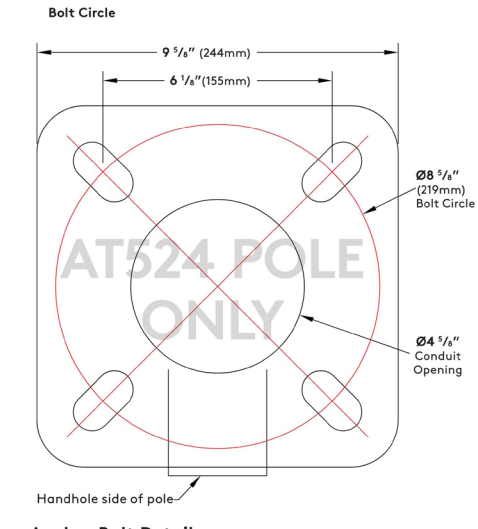

Pole Data Chart																	
Pole Series	Bolt Circle	Wall	EPA Information												Height	Finish	Options
			Basic Wind Speed (mph)														
			85	90	100	110	120	130	140	150	160	170	180				
AT524 5" to 2.4" Round Tapered Aluminum Pole	8 1/4"	0.188"	12.6	11.2	9.0	7.4	6.1	5.2	4.4	3.8	3.3	2.9	2.5	13' 13ft	WH White BK Black BL Semi-Matte Black	BC3 Die Cast Two-Piece Aluminum decorative Base Cover REC1 GFCI Receptacle with weatherproof cover	
AT524 5" to 2.4" Round Tapered Aluminum Pole			12.6	11.2	9.0	7.4	6.1	5.2	4.4	3.8	3.3	2.9	2.5	14' 14ft	BZ Bronze SV Silver SP Specify Premium Color	REC2' GFCI Receptacle with padlockable in-use cover REC3' USB & Duplex Receptacle with weatherproof cover	
AT524 5" to 2.4" Round Tapered Aluminum Pole			12.6	11.2	9.0	7.4	6.1	5.2	4.4	3.7	3.1	2.7	2.3	15' 15ft		REC4' USB & Duplex Receptacle with weatherproof padlockable in-use cover	
AT524 5" to 2.4" Round Tapered Aluminum Pole			12.6	11.2	9.0	7.4	5.8	4.7	3.9	3.2	2.7	2.3	1.9	16' 16ft			
Other pole configurations available, consult factory			EPA calculations allow for 1.3 Gust Factor						See Mounting Page for fixture w/arm EPA values								



CPA PLAZA STATUES LANDMARKS PROPOSAL

**Preferred Statue Location - F/5**





CPA PLAZA STATUES LANDMARKS PROPOSAL

**Preferred Statue Location - F/5**







**CLIMATE PLEDGE**  
ARENA

**POPULOUS**

**SWIFT COMPANY LLC**