

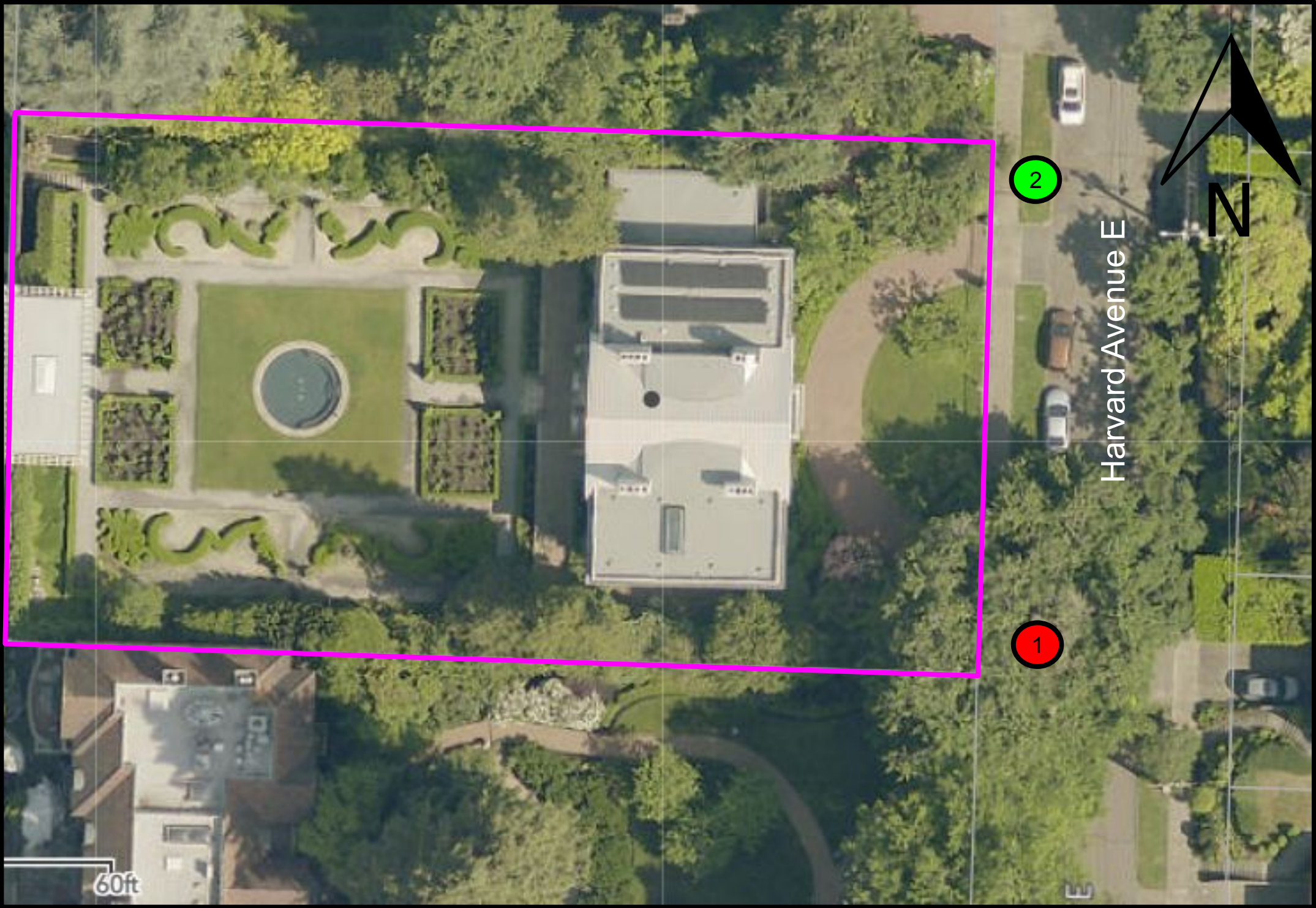

Paperbark Maple
Acer griseum



OK Under Wires: **Yes** Native: **No** Drought Tolerance: **Moderate**
Mature Shape: **Oval** Mature Height: **30 ft** Flower: **N/A** Exposure: **Full Sun**



SDOT requires street trees be planted to the following standards:

- 3 ½ feet back from the face of the curb
- 5 feet from all underground utility lines (Call 811 to locate lines)
- 10 feet from power poles
- 7 ½ feet from driveways (10 feet recommended)
- 20 feet from street lights and other existing trees
- 30 feet from street intersections (avoid driver sightline issues)

PROPERTY ADDRESS:
919 Harvard Avenue East, Seattle, WA, 98102

PROPERTY OWNER/CONTACT:
Charles Wright
charlie@cwright.io

APPLICANT NAME:
Hannah Swanson
ISA Certified TRAQ Arborist PN-9361a

**MAP
LEGEND**

- Property line
- Tree marked for removal
- Approximate location of replacement tree: Must follow required SDOT setbacks

| SPECIES & TREE # | DSH | REMOVAL? |
|---|--------------------------------|--------------|
| #1 American white elm (Ulmus americana) | 40.5" | Yes |
| #2 Paperbark Maple (Acer griseum) | 1" caliper at time of planting | No - Replant |



Arborist Consulting

For projects that require additional documentation, tree assessment, permit assistance or other arborist consulting services, Seattle Tree Care offers these services by an ISA Certified Arborist & Tree Risk Assessment Qualified professional at an hourly rate of \$185 per hour. You will be given a time required estimate before we proceed. Total billing encompasses site visits including travel time, up to a Level II visual assessment of the tree and property, off-site report writing, documentation and municipal permit application. This does not include any municipal permit fees, which will be billed separately.

Price listed is an estimate. Final cost is determined by the time to complete the permit application and the Municipal fee.

Fees are calculated in 1/4 hour increments.

Team: **Equipment:**

► Notes

► Workorder Events

| Team | Estimated Time | Actual Time | Equipment Equipment setup: |
|------|----------------|-------------|-------------------------------|
|------|----------------|-------------|-------------------------------|

2025-06-30 14:50:06 PM

