

Share

Google

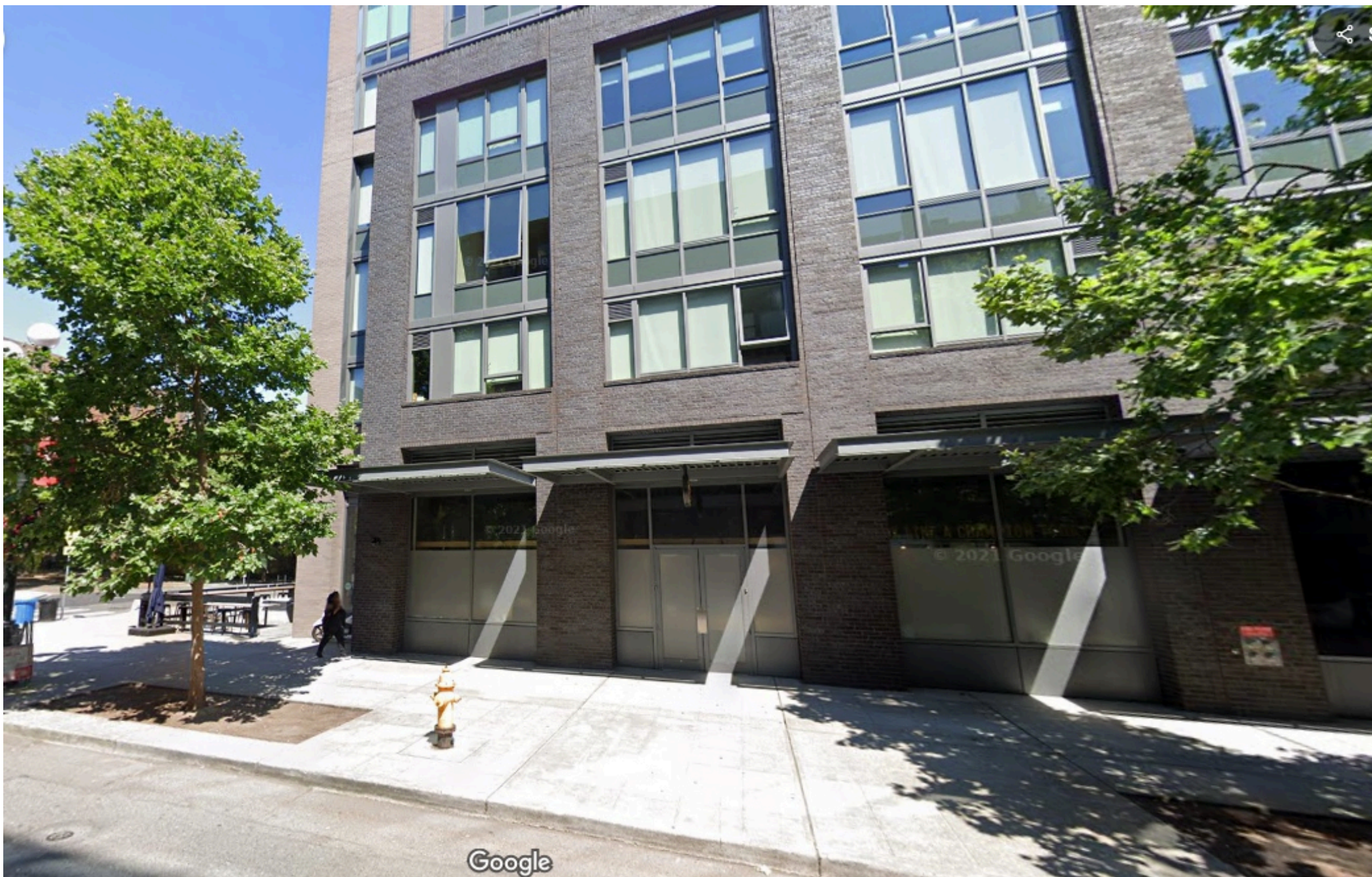

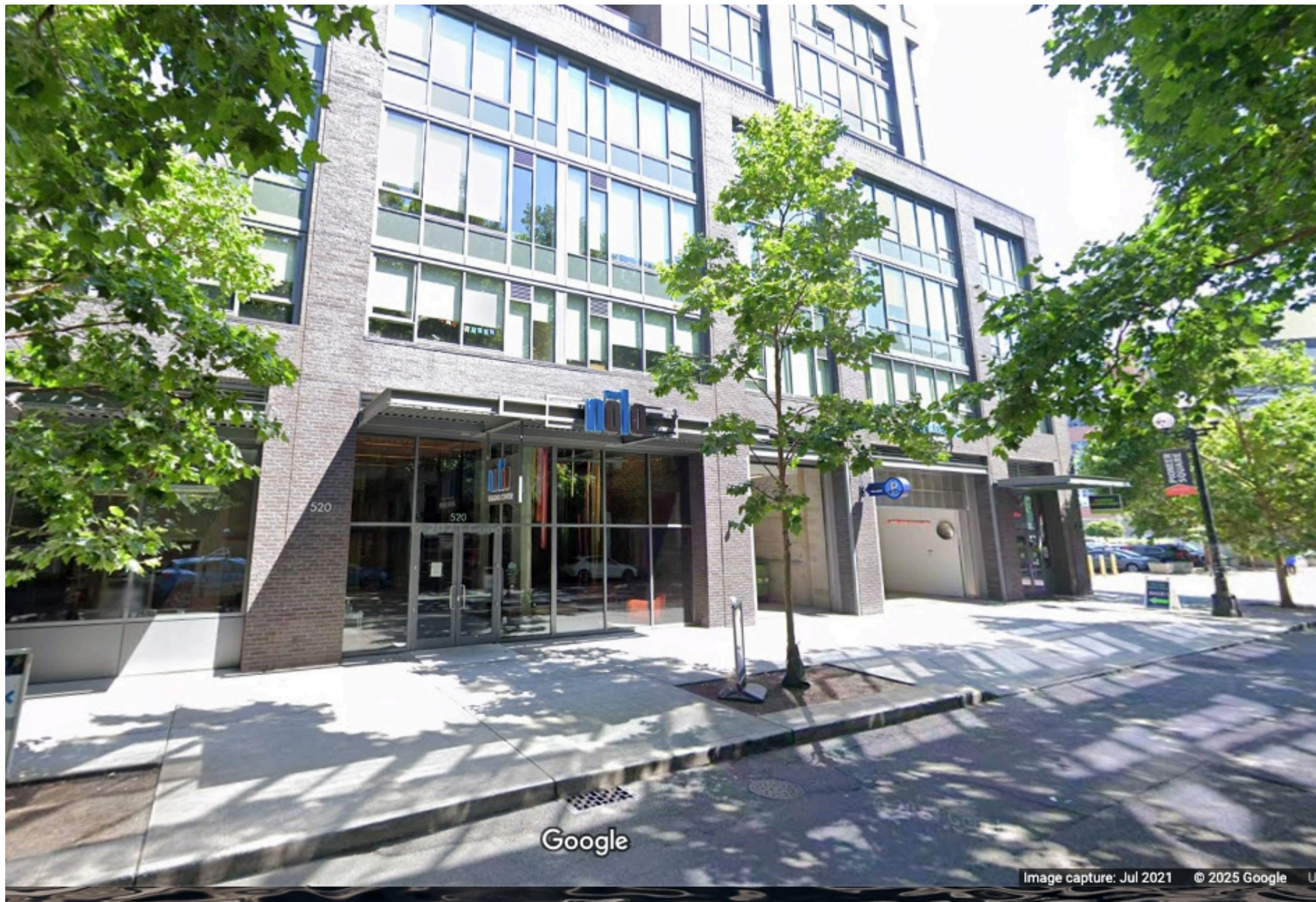



121 S King St

Seattle, WA 98104

J O B # 2 4 0 4 5 2 - 0 8

TOM's

WATCH BAR



WEST COAST HQ.
2231 S. Dupont Drive
Anaheim, CA 92806
800-655-9972

SITE PLAN



SIGNAGE SPECIFICATIONS

- 1.1

1.2
- ILLUMINATED CHANNEL LETTERS w/ BACKER PANEL MOUNTED ON RACEWAY:
Manufacture and Install (2) Two Sets of Channel Letters.
- 2.0
- D/F ILLUMINATED BLADE SIGN w/ HALO ILLUM. LTRS:
Manufacture & Install (1) D/F Blade Sign.

AREA MAP



VICINITY MAP

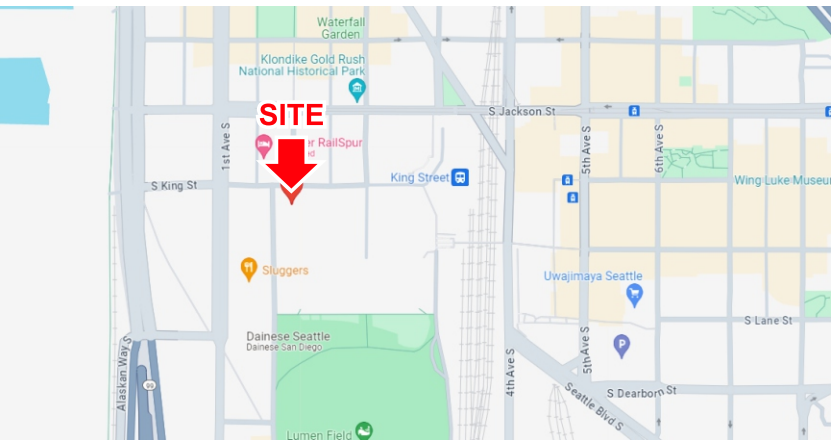

PS 127:1

P R O J E C T

C L I E N T

J O B / D R A W I N G #



WEST COAST HQ.
2231 S. Dupont Drive
Anaheim, CA 92806
800-655-9972

Project Name: Tom's Watch Bar
Address: 121 S King St
City, State, Zip: Seattle, WA 98104

Client Approval:
Landlord Approval:
Designer: Jesthan D
Sales:

All ideas, designs, arrangements, and plans indicated or represented by this drawing are owned by and the property of Signage-Solutions, and were created, evolved and developed for use on and in connection with the specified project. None of such ideas, designs, arrangements or plans shall be used by or disclosed to any person, firm or corporation for any purpose what so ever without written permission.

#	Designer:	Date:	Revision Notes:
1	Jesthan D	05/21/24	
2	Jesthan D	08/13/24	
3	Jesthan D	01/13/25	
4	Jesthan D	01/17/25	
5	Jesthan D	02/19/25	
6	Jesthan D	02/24/25	
7	Jesthan D	03/06/25	
8	Jesthan D	03/07/25	
9			
10			



240452-08



EXISTING BUILDING CONDITIONS

Scale: NTS



PROPOSED HALO ILLUMINATED CHANNEL LETTERS w/ BACKER PANEL ON RACEWAY

Scale: Approx. $1/8'' = 1'-0''$

NOTE:
FIELD VERIFY ALL DIMENSION
AND CONDITION PRIOR TO
MANUFACTURING



EXISTING BUILDING CONDITIONS

Scale: NTS



PROPOSED HALO ILLUMINATED CHANNEL LETTERS w/ BACKER PANEL ON RACEWAY

Scale: Approx. 1/4" = 1'-0"

NOTE:
FIELD VERIFY ALL DIMENSION
AND CONDITION PRIOR TO
MANUFACTURING



WEST COAST HQ.
2231 S. Dupont Drive
Anaheim, CA 92806
800-655-9972

Project Name: Tom's Watch Bar
Address: 121 S King St
City, State, Zip: Seattle, WA 98104

Client Approval:
Landlord Approval:
Designer: Jesthan D Sales:

All ideas, designs, arrangements, and plans indicated or represented by this drawing are owned by and the property of Signage-Solutions, and were created, evolved and developed for use on and in connection with the specified project. None of such ideas, designs, arrangements or plans shall be used by or disclosed to any person, firm or corporation for any purpose what so ever without written permission.

#	Designer:	Date:	Revision Notes:
1	Jesthan D	05/21/24	
2	Jesthan D	08/13/24	
3	Jesthan D	01/13/25	
4	Jesthan D	01/17/25	
5	Jesthan D	02/19/25	
6	Jesthan D	02/24/25	
7	Jesthan D	03/06/25	
8	Jesthan D	03/07/25	
9			
10			



240452-08

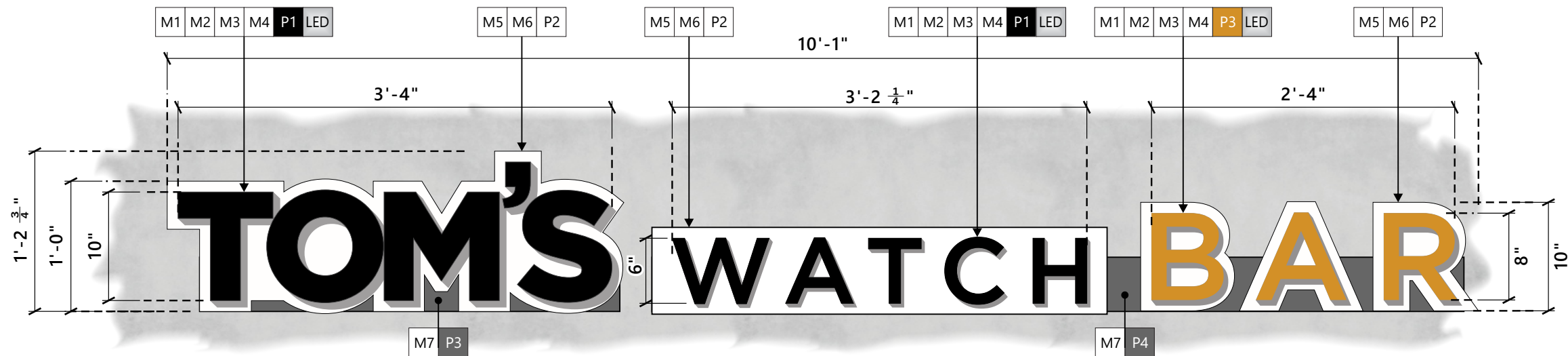

1.1 1.2 SIGN ELEVATION / HALO ILLUMINATED CHANNEL LETTERS w/ BACKER PANEL ON RACEWAY
Quantity: Two (2) Required

Scale: 1" = 1'-0"



ILLUMINATED SIGN NIGHT VIEW

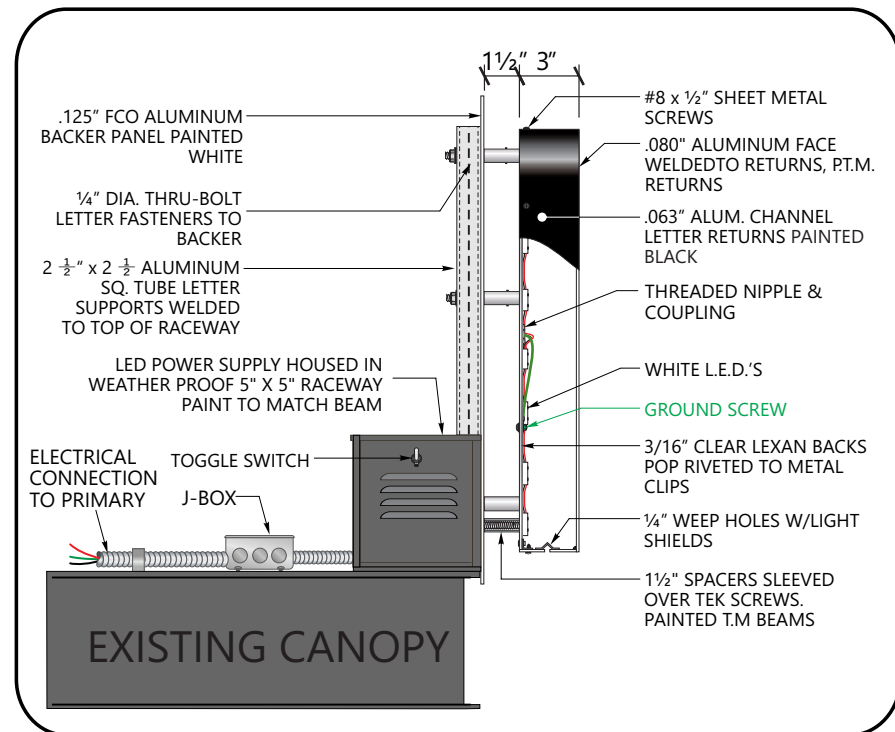

1 SECTION DETAIL / HALO ILLUM. CHNL. LTRS. / BACKER on RACEWAY
Scale: NTS

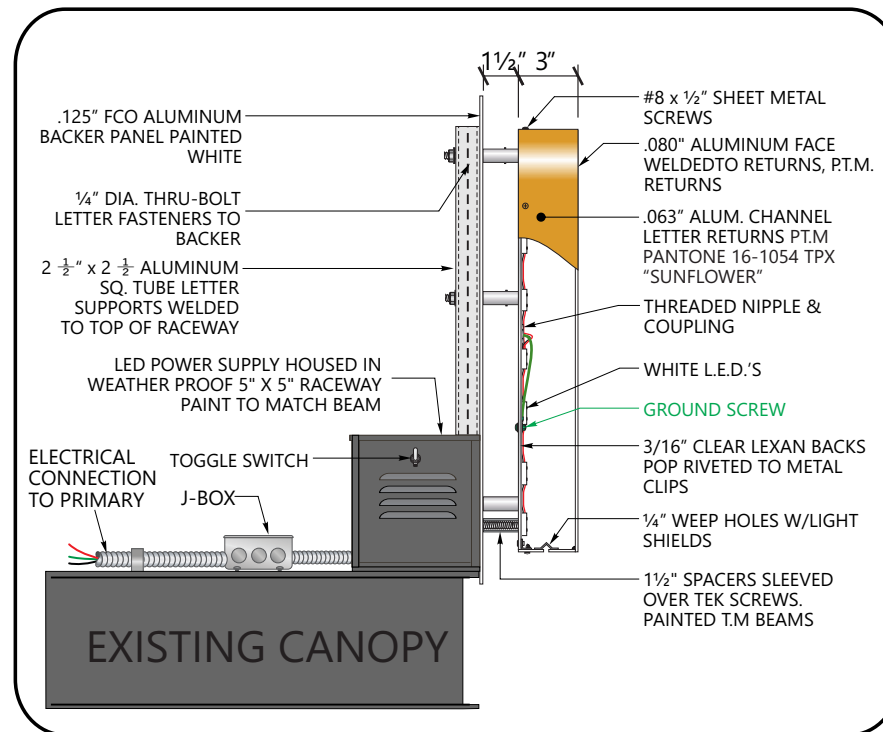

2 SECTION DETAIL / HALO ILLUM. CHNL. LTRS. / BACKER on RACEWAY
Scale: NTS

SIGNAGE SQ. FOOTAGE	
12.41 SQ. FOOTAGE	
M1	.080" ALUMINUM FACES
M2	.063" ALUMINUM RETURNS
M3	3/16" CLEAR LEXAN BACKS
M4	1 1/2" SPACERS PT.M. BACKER
M5	.125" FCO ALUMINUM BACKER
M6	1"x1" ALUM S/T SUPPORT
M7	5"x5" ALUM. RACEWAY
PAINT FINISH	
P1	BLACK SATIN FINISH
P2	WHITE SATIN FINISH
P3	PANTONE "SUNFLOWER" 16-1054 TPX
P4	PTM CANOPY
ILLUMINATION	
LED	WHITE L.E.D. MODULES
ELECTRICAL REQUIREMENTS	
Approx. A load of (amps)	
(1) 120V 20A circuit req'd	
UL labels required away from public view.	
IMPORTANT NOTE	
UL COMPLIANT NEC AND MANUFACTURING RECOMMENDATIONS, ALL ELECTRICAL PRIMARY CIRCUITS MUST BE DEDICATED ISOLATED CIRCUITS PROVIDED BY CLIENT/ OWNER.	
GC TO PROVIDE ACCESSIBILITY TO REMOTE TRANSFORMERS AND OR BALLASTS FOR INSTALL AND SERVICE.	
FINAL ELECTRICAL HOOK UP BY OTHERS.	
THIS SIGN IS INTENDED TO BE INSTALLED IN ACCORDANCE WITH THE REQUIREMENTS AS PER NEC 2008 ART: 600.6 FBC ELECTRIC CODE AND/OR OTHER APPLICABLE LOCAL CODES. THIS INCLUDES PROPER GROUNDING AND BONDING OF SIGN.	



PS 127:1

P R O J E C T

C L I E N T

J O B / D R A W I N G #



WEST COAST HQ.
2231 S. Dupont Drive
Anaheim, CA 92806
800-655-9972

Project Name: Tom's Watch Bar
Address: 121 S King St
City, State, Zip: Seattle, WA 98104

Client Approval:

Landlord Approval:

Designer: Jesthan D

Sales:

All ideas, designs, arrangements, and plans indicated or represented by this drawing are owned by and the property of Signage-Solutions, and were created, evolved and developed for use on and in connection with the specified project. None of such ideas, designs, arrangements or plans shall be used by or disclosed to any person, firm or corporation for any purpose what so ever without written permission.

#	Designer:	Date:	Revision Notes:
1	Jesthan D	05/21/24	
2	Jesthan D	08/13/24	
3	Jesthan D	01/13/25	
4	Jesthan D	01/17/25	
5	Jesthan D	02/19/25	
6	Jesthan D	02/24/25	
7	Jesthan D	03/06/25	
8	Jesthan D	03/07/25	
9			
10			



240452-08

Page 5 of 7



EXISTING BUILDING CONDITIONS

Scale: NTS



BLADE SIGN NIGHT VIEW



PROPOSED ILLUMINATED CHANNEL LETTERS & BLADE SIGN

Scale: 1/8" = 1'-0"

NOTE:
FIELD VERIFY ALL DIMENSION
AND CONDITION PRIOR TO
MANUFACTURING



WEST COAST HQ.
2231 S. Dupont Drive
Anaheim, CA 92806
800-655-9972

Project Name: Tom's Watch Bar
Address: 121 S King St
City, State, Zip: Seattle, WA 98104

Client Approval:
Landlord Approval:
Designer: Jesthan D Sales:

All ideas, designs, arrangements, and plans indicated or represented by this drawing are owned by and the property of Signage-Solutions, and were created, evolved and developed for use on and in connection with the specified project. None of such ideas, designs, arrangements or plans shall be used by or disclosed to any person, firm or corporation for any purpose what so ever without written permission.

#	Designer:	Date:	Revision Notes:
1	Jesthan D	05/21/24	
2	Jesthan D	08/13/24	
3	Jesthan D	01/13/25	
4	Jesthan D	01/17/25	
5	Jesthan D	02/19/25	
6	Jesthan D	02/24/25	
7	Jesthan D	03/06/25	
8	Jesthan D	03/07/25	
9			
10			



240452-08

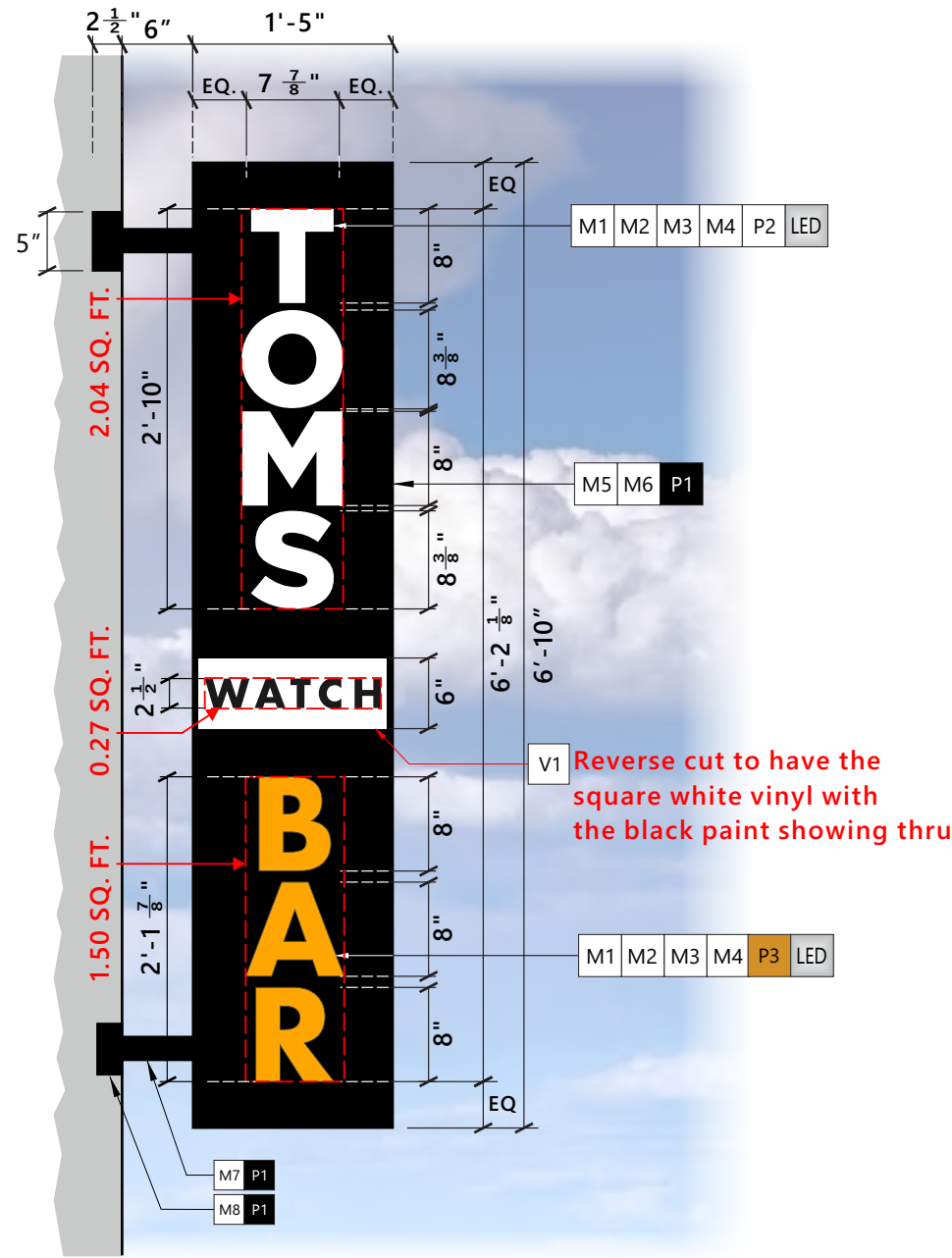

2.0 SIGN ELEVATION / D/F ILLUM. BLADE SIGN W/CHNL. LTRS.
Quantity: One (1) Signs Required Scale: 3/4" = 1'-0"

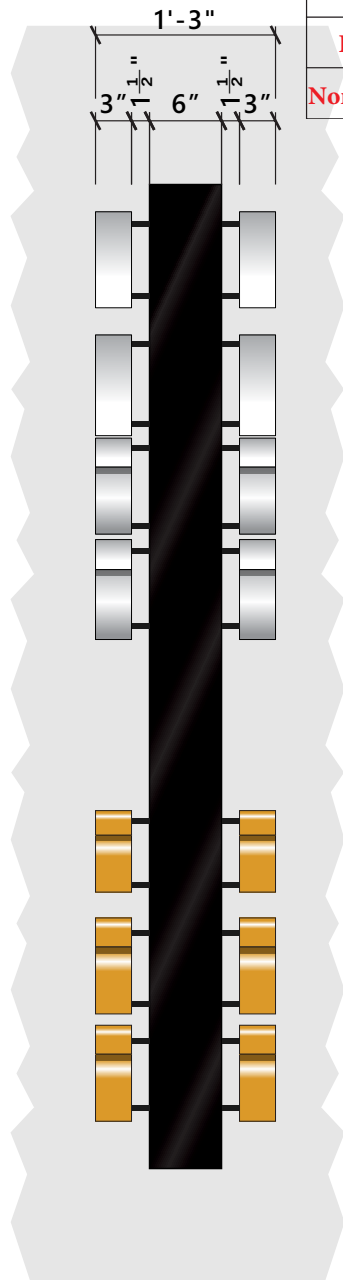

SIGN SIDE VIEW
Scale: 3/4" = 1'-0"

SQUARE FOOTAGE	
Overall 9.68 SQ. FT. PROPOSED	
Illuminated Copy 3.54 SQ. FT. PROPOSED	
Non Illuminated Copy 0.27 SQ. FT. PROPOSED	
MATERIALS	
M1	.080" ALUMINUM FACES
M2	.063" ALUMINUM RETURNS
M3	3/16" CLEAR LEXAN BACKS
M4	1½" SPACERS P.T.M. CLADDING
M5	.125" ALUMINUM CLADDING
M6	1½" ALUM SQ. TUBE FRAME
M7	2" x 2" ALUM TUBE SUPPORTS
M8	¼" ALUM MOUNTING PLATE
PAINT FINISH	
P1	BLACK SATIN FINISH
P2	WHITE SATIN FINISH
P3	PANTONE "SUNFLOWER" 16-1054 TPX
DIGITALS / VINYL	
V1	#7725-10 "WHITE"
ILLUMINATION	
LED	WHITE L.E.D. MODULES

IMPORTANT NOTE

UL COMPLIANT NEC AND MANUFACTURING RECOMMENDATIONS, ALL ELECTRICAL PRIMARY CIRCUITS MUST BE DEDICATED ISOLATED CIRCUITS PROVIDED BY CLIENT/ OWNER.

GC TO PROVIDE ACCESSIBILITY TO REMOTE TRANSFORMERS AND OR BALLASTS FOR INSTALL AND SERVICE.

FINAL ELECTRICAL HOOK UP BY OTHERS.

THIS SIGN IS INTENDED TO BE INSTALLED IN ACCORDANCE WITH THE REQUIREMENTS AS PER NEC 2008 ART: 600.6 FBC ELECTRIC CODE AND/OR OTHER APPLICABLE LOCAL CODES. THIS INCLUDES PROPER GROUNDING AND BONDING OF SIGN.

ELECTRICAL REQUIREMENTS

Approx. A load of (amps)
(1) 120V 20A circuit req'd
UL labels required away from public view.



ALL WALL PENETRATION
MUST BE SEALED W/
SCS1200 SILICONES

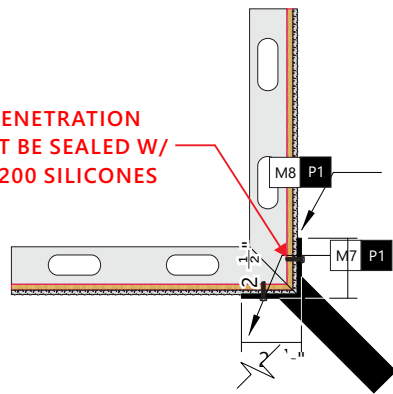

CORNER PLAN VIEW
Scale: 1½" = 1'-0"

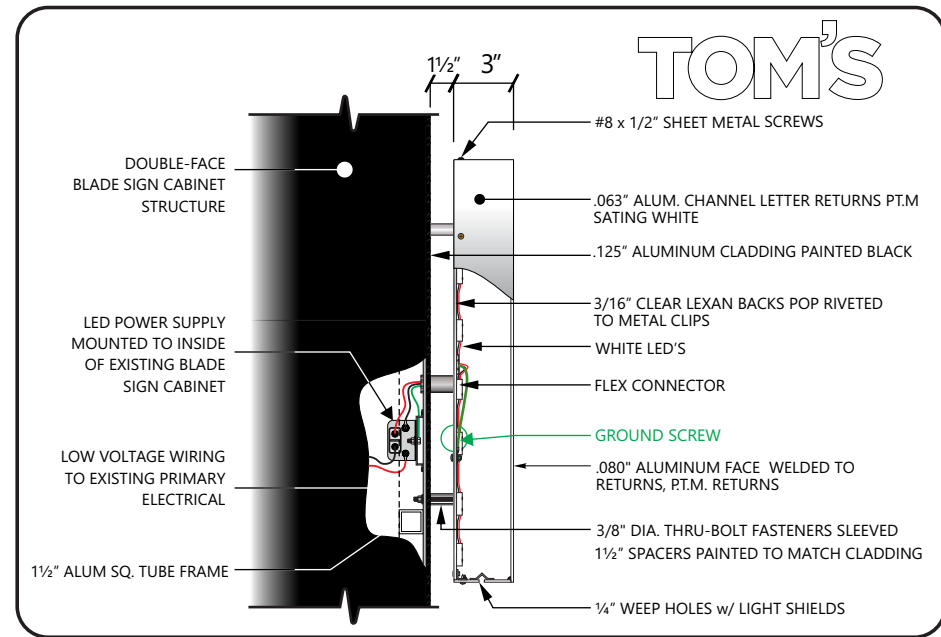

1 SECTION DETAIL / HALO-LIT CHANNEL LETTERS
Scale: 1" = 1'-0"

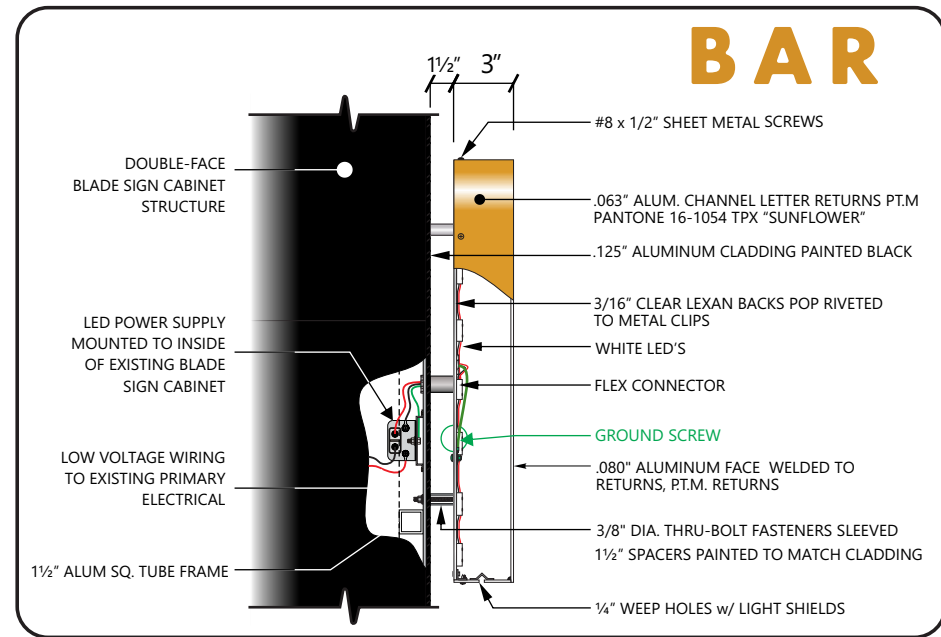

2 SECTION DETAIL / HALO-LIT CHANNEL LETTERS
Scale: 1" = 1'-0"

PS 127:1

P R O J E C T

C L I E N T

J O B / D R A W I N G #



WEST COAST HQ.
2231 S. Dupont Drive
Anaheim, CA 92806
800-655-9972

Project Name: Tom's Watch Bar
Address: 121 S King St
City, State, Zip: Seattle, WA 98104

Client Approval:
Landlord Approval:
Designer: Jesthan D Sales:

All ideas, designs, arrangements, and plans indicated or represented by this drawing are owned by and the property of Signage-Solutions, and were created, evolved and developed for use on and in connection with the specified project. None of such ideas, designs, arrangements or plans shall be used by or disclosed to any person, firm or corporation for any purpose what so ever without written permission.

#	Designer:	Date:	Revision Notes:
1	Jesthan D	05/21/24	
2	Jesthan D	08/13/24	
3	Jesthan D	01/13/25	
4	Jesthan D	01/17/25	
5	Jesthan D	02/19/25	
6	Jesthan D	02/24/25	
7	Jesthan D	03/06/25	
8	Jesthan D	03/07/25	
9			
10			



240452-08

Page 7 of 7