



The City of Seattle

Pike Place Market Historical Commission

Mailing Address: PO Box 94649, Seattle WA 98124-4649

Street Address: 600 4th Avenue, 4th Floor

CERTIFICATE OF APPROVAL FOR USE

Date: March 19, 2023

MHC 42/24

Applicant: Babak Ziraknejad

Property Owner: Susan Brems, PDA

Business: Pizza and Past Bar

Business Address: 1530 Post Alley # 7 Seattle, WA 98101, Post Alley Market Building

Project Address: Public seating area 1500 block Post Alley, west side

Record Number: DONH-COA-01196

At its meeting of March 13, 2024 the Pike Place Market Historical Commission approved the following:

Proposal for temporary exclusive use of outdoor dining area from April 1, 2024 – September 30, 2024.

The Commission considered the following District Guidelines when making the decision:

- 2.1 General Principles for Uses in the Market
- 2.3 Pedestrian Qualities
- 2.9 Temporary Uses
- 2.11 Street Use, Street Vendors and Sidewalk Cafes

(This action is categorically exempt from SEPA by the provisions of WAC 197-11-800.)

The Certificate is issued with the understanding that the applicant will obtain all other permits and approvals that may be required.

Grace Leong, Commission Chairperson

By:

A handwritten signature in black ink, appearing to read 'Minh Chau Le'.

Minh Chau Le, Commission Coordinator
Pike Place Market Historical Commission



SPECIAL DISTRICT AND LANDMARK REVIEW

Property or District: Pike Place Market Historical District

LPB Document No.: MHC 42/24

Reviewed By: LeM

On: March 19, 2024

Comments on Pages:

Total Pages: 4



SPECIAL DISTRICT AND LANDMARK REVIEW

This page: ☒ APPROVED

By LeM

Post Alley seating area

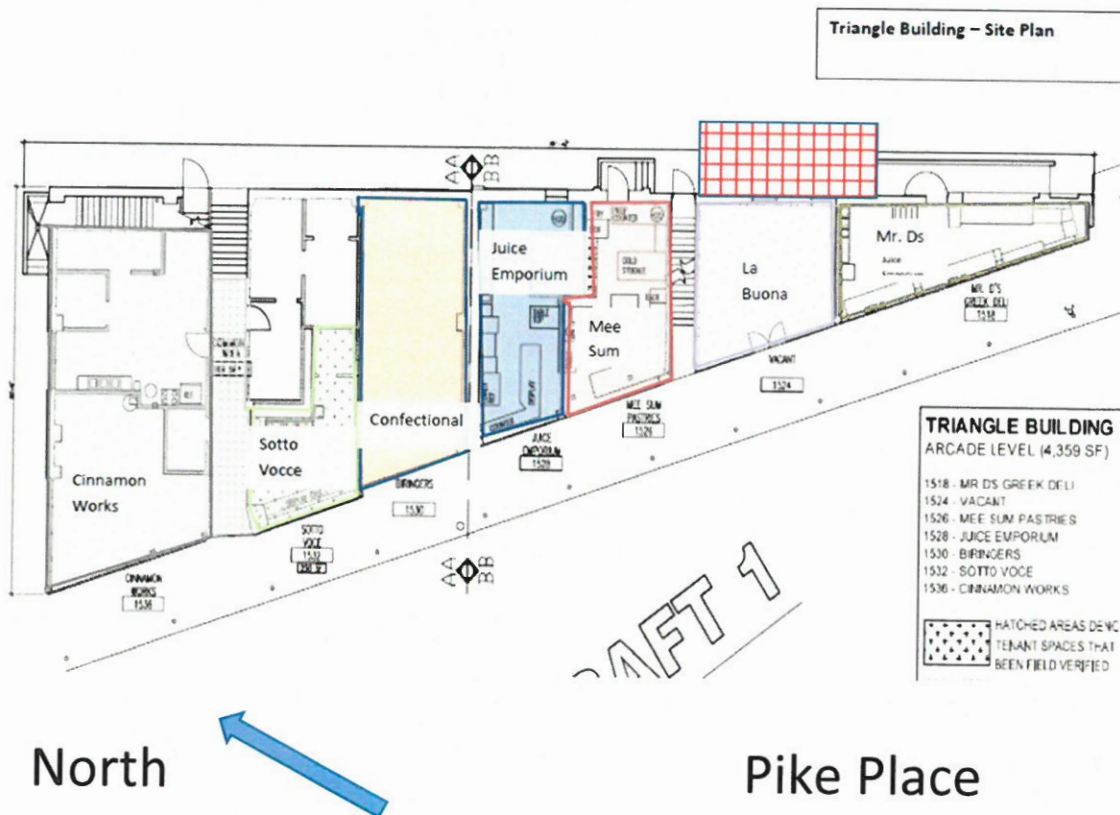



SPECIAL DISTRICT AND LANDMARK REVIEW

This page: ☒ APPROVED

By LeM

PIZZA AND PASTA
BAR PATIO

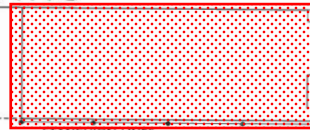

PROPOSED
18"X24" SIGN

STANCHION LINES
40" HIGH

POST ALLEY

PIKE PLACE CHOWDER
OUTDOOR SEATING

PIKE PLACE
CHOWDER

MAIN ENTRANCE

MADE IN
WASHINGTON

PIZZA AND
PASTA BAR

METAL BASEBOARD
TO COVER THE ENTIRE
RED MARK

SITE PLAN



This page: ☒ APPROVED

By LeM

Pike Place

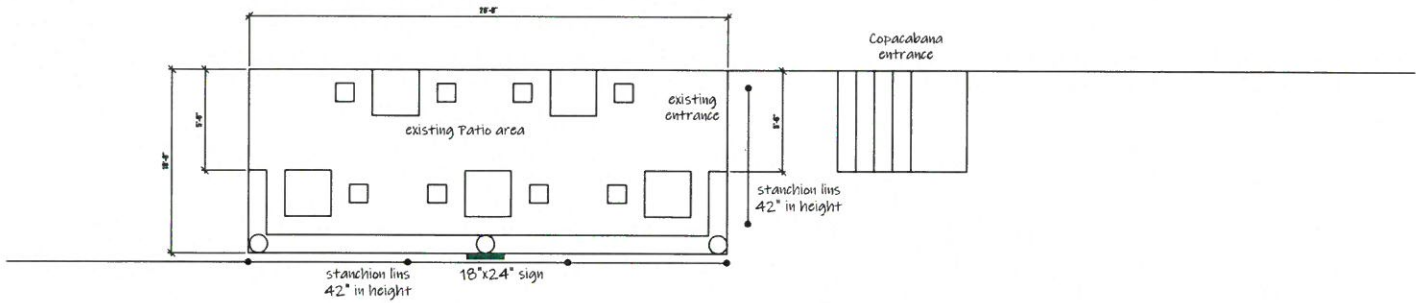

Post alley

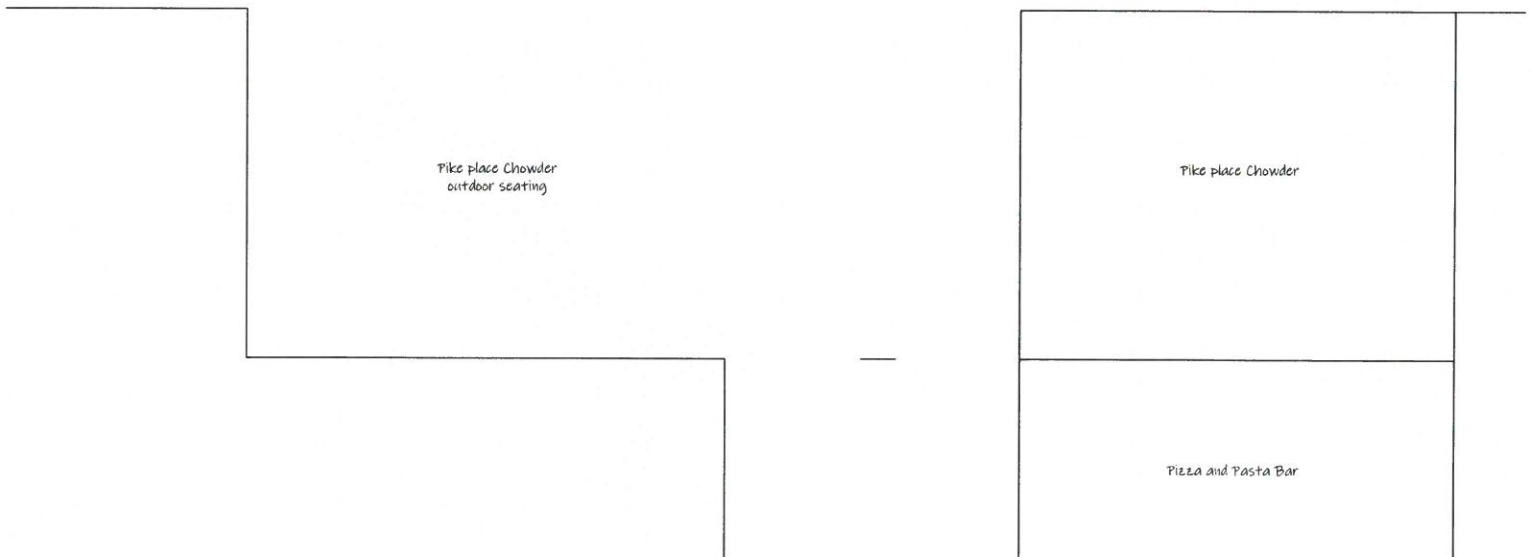

Pike Place



SPECIAL DISTRICT AND LANDMARK REVIEW

This page: ☒ APPROVED

By LeM

PIZZA AND PASTA
BAR PATIO

COPACABANA
ENTRANCE.

PROPOSED
18"X24" SIGN

STANCHION LINES
40" HIGH

24'-0"

POST ALLEY

PATIO PLAN