

•

•

rōjō

ORGANIC JUICE

MHC Design

Site Plan – Marketview

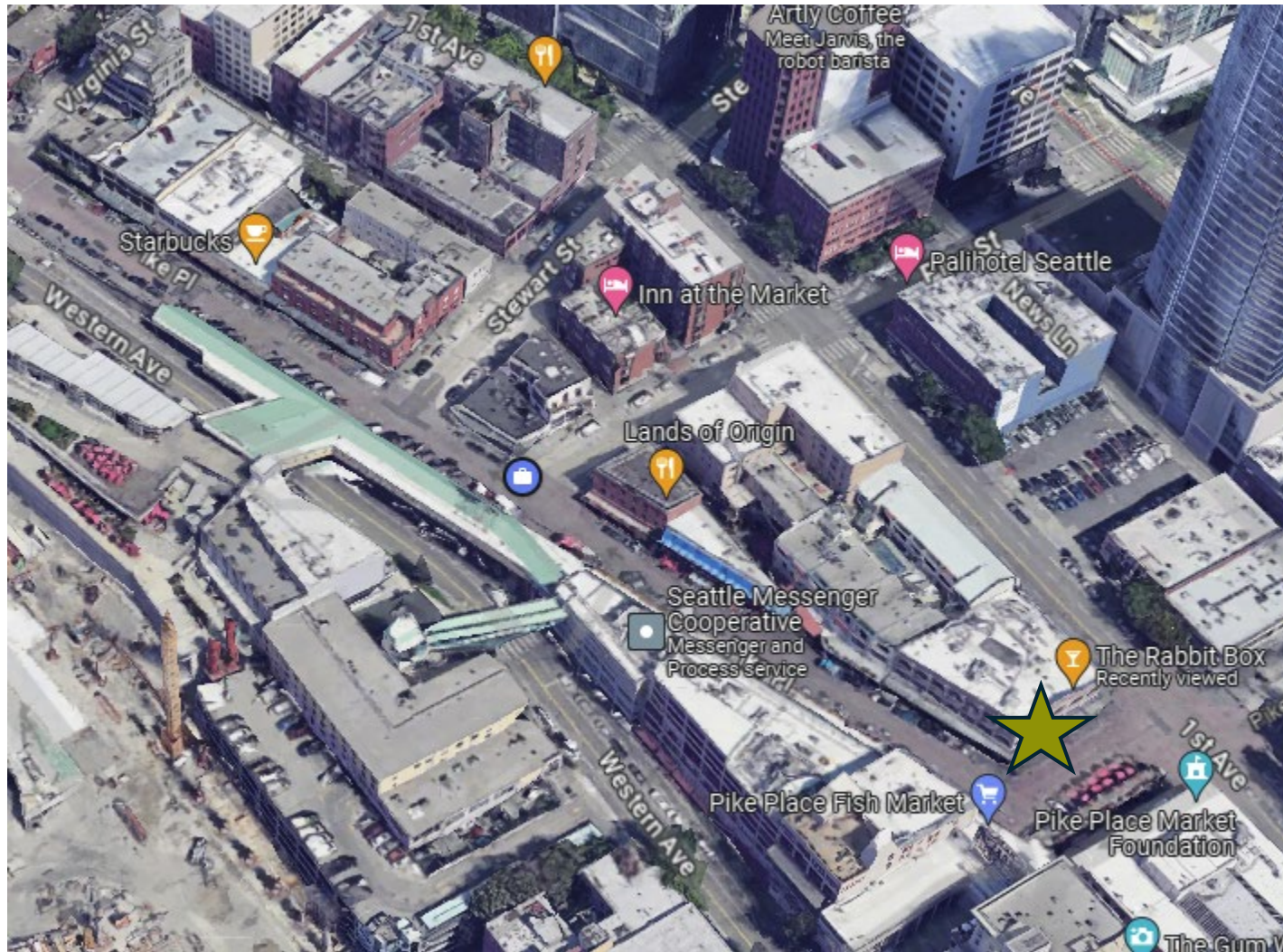

Site Plan - Detailed

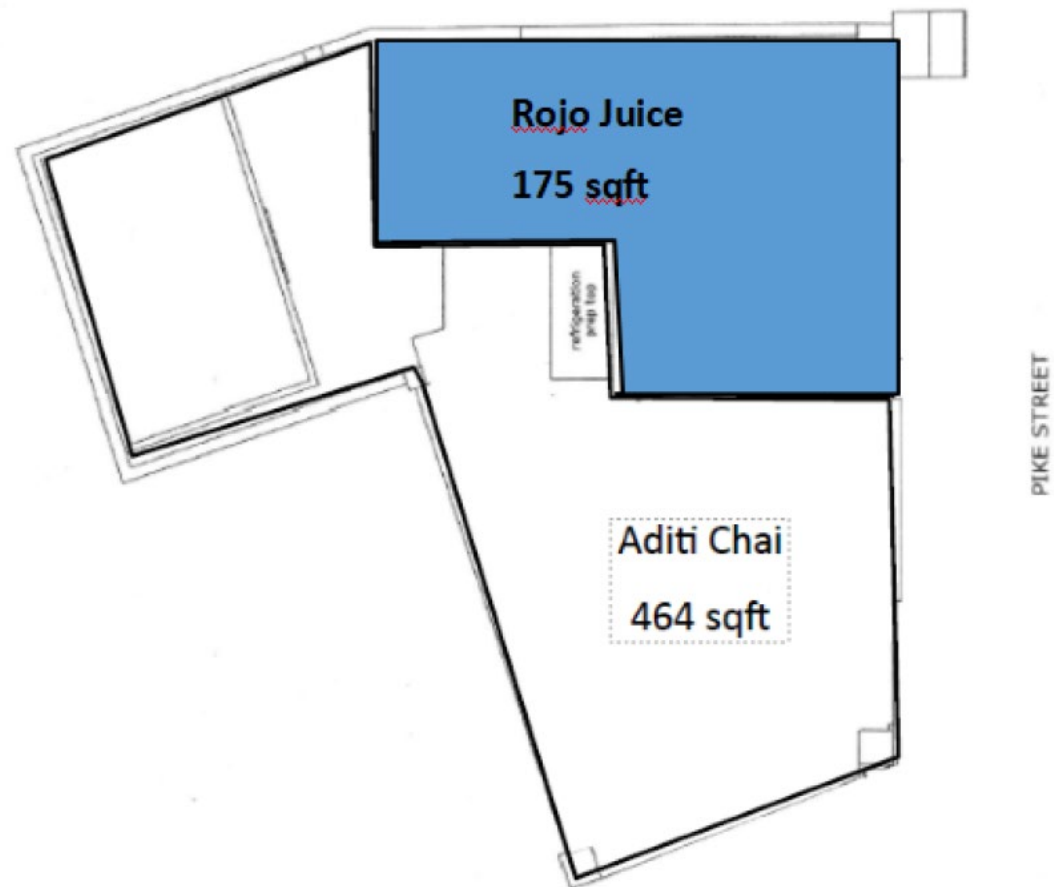

Neon “Rojo” Sign

NEON H.30" x W.30" x D.6"



Organic Juice Sign

H. 35" x W. 117 5/8"

Substrate

1/8" Di-bond

Graphics

3M ink jet print on self adhesive vinyl
with clear matte vinyl laminate overlay

Installation

Hardware

3M VHB tape

clear silicone

3/16 x 1.5" stainless steel pan head wood screws



Double Sided Entrance Sign

H. 15" x W. 40"

Substrate
1/8" Di-bond
double sided
ceiling mount

Graphics
cut vinyl lettering and logo

Installation Hardware

2" heavy duty stainless steel eye bolts

**1/8" thick x 1.43" long stainless steel quick link /
carabiners =**
(200 lb. working load limit = sign weight is only
10lb.)

black matte traditional stainless steel chains (440
lb working load limit)



ORGANIC JUICE

Double Sided Entrance Sign (attachment)

Screw Eyes (304) Stainless Steel 2 Inch Screw Hooks Heavy Duty
Screw in Hooks Ring 40 Pack



3/16" x 1-1/2" Stainless Steel Pan Head Wood Screw
Item #:51612805

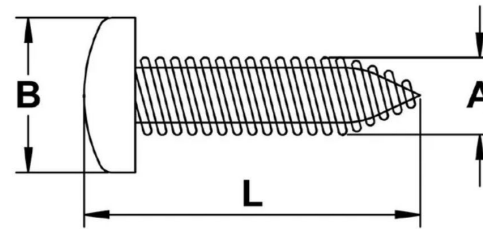

Thread Diameter (A): 3/16 inches
Head Diameter (B): 0.4 inches
Overall Length (L): 1-1/2 inches

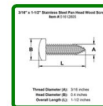

66CM
/25.98"



8CM
/3.2"

2.5CM/0.98"

3.5CM/1.38"

0.5CM/0.19"



Juice Fridge

10" x W. 30"

