

Project Background:

The gas work related was done on job order/notification 109080485/11075394 and was completed in 2016. The project has some outstanding restoration. The restoration work is to be done on job order/notification 109159570/12053464. The Seattle permit number related used to be 218412 but was later updated to SUUMP0000469. Puget Sound Energy has applied for a permit revision (SUUMP0000469-A001) with updated ramp designs that align with the modern times. There are additional traffic control plans, ADA ramp designs and MEFs to account for the updated ramp designs.

Description of Proposed Work:

This project is to restore the middle ADA ramp, concrete curb, and replace the brick in the intersection of 1st Ave & Pike St. The ramp, curb, and brick is outlined in the satellite photo below. The existing north and south most ramp (Existing North Ramp and Existing South Ramp) will not be worked.

The ADA ramp will use cast iron tactile tiles.
PSE will use Pike Place Market brick that has been removed in the past. This brick has been approved in the past. Pictures attached.
If new brick us used, new bricks used will be a ratio of 80% Rembrandt and 20% Georgian. Email from supplier attached.
Brass inlays will be photographed before removal, and new hooves with the same engraving will be replaced in kind.

Working Hours:

Work will be performed from 8am to 4pm. There would be road closures overnight to allow brickwork to cure for 24 hours. There are traffic control plans for each situation.

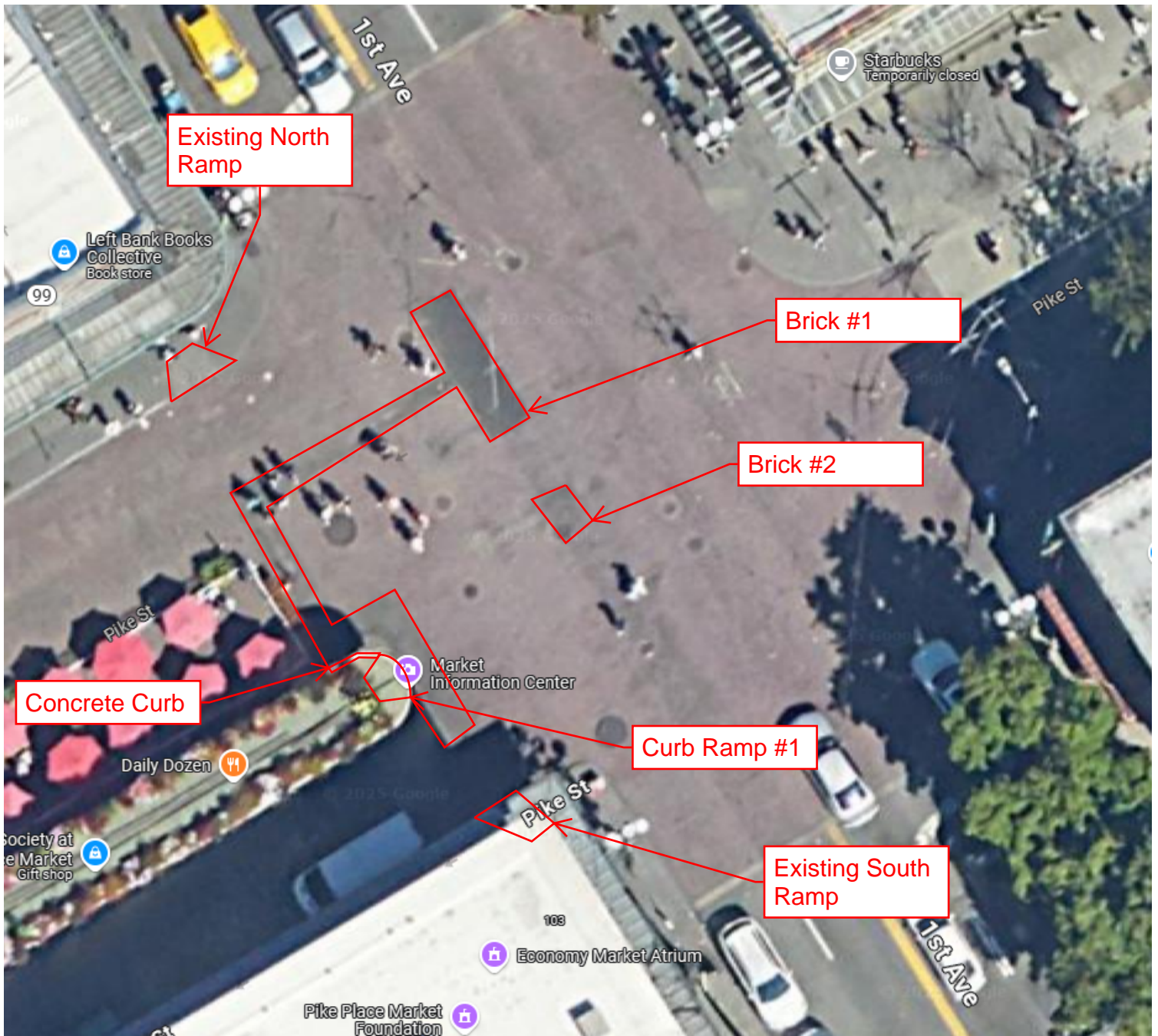

Satellite Overview

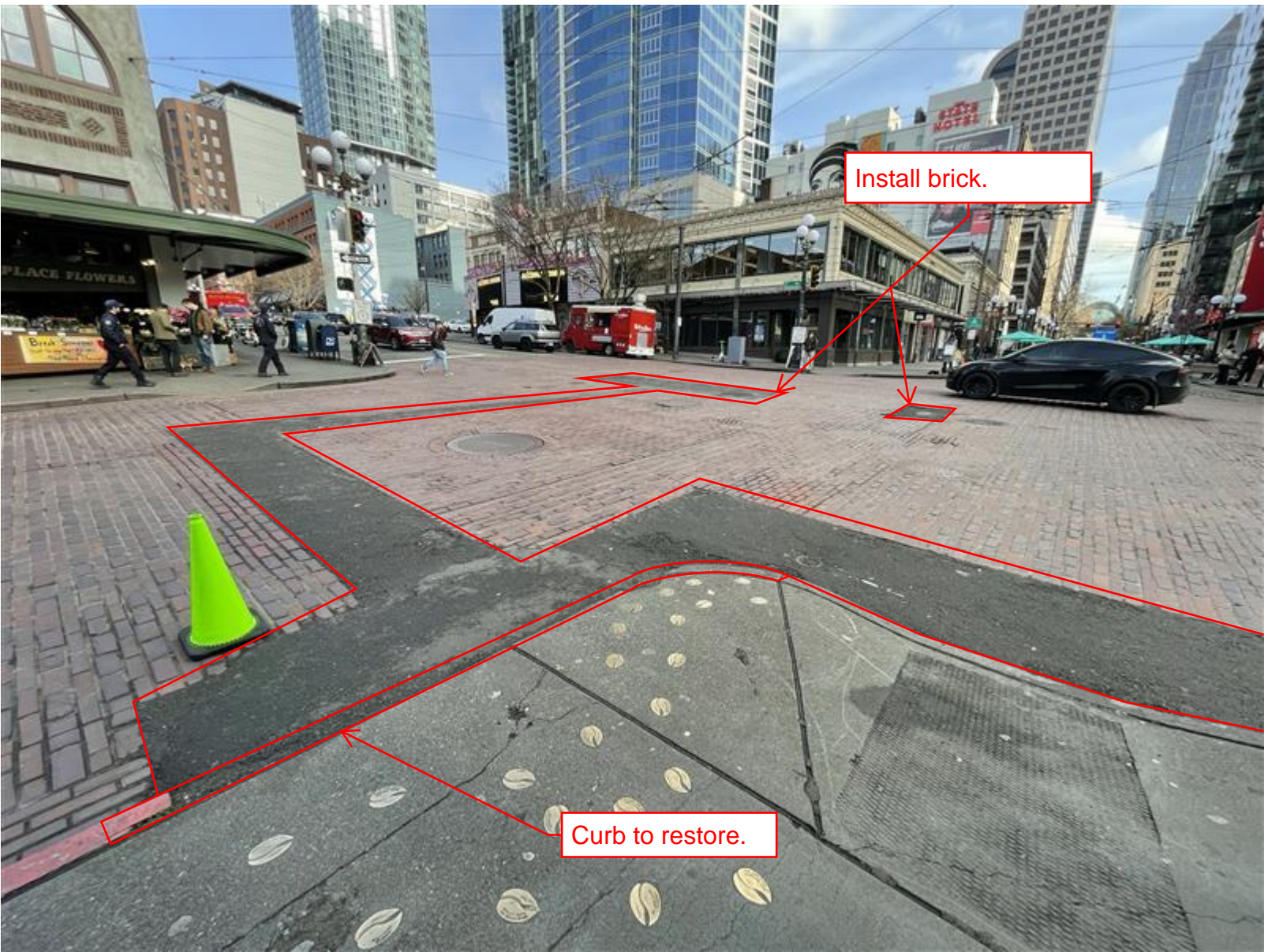

Ramp not marked out on this photo.

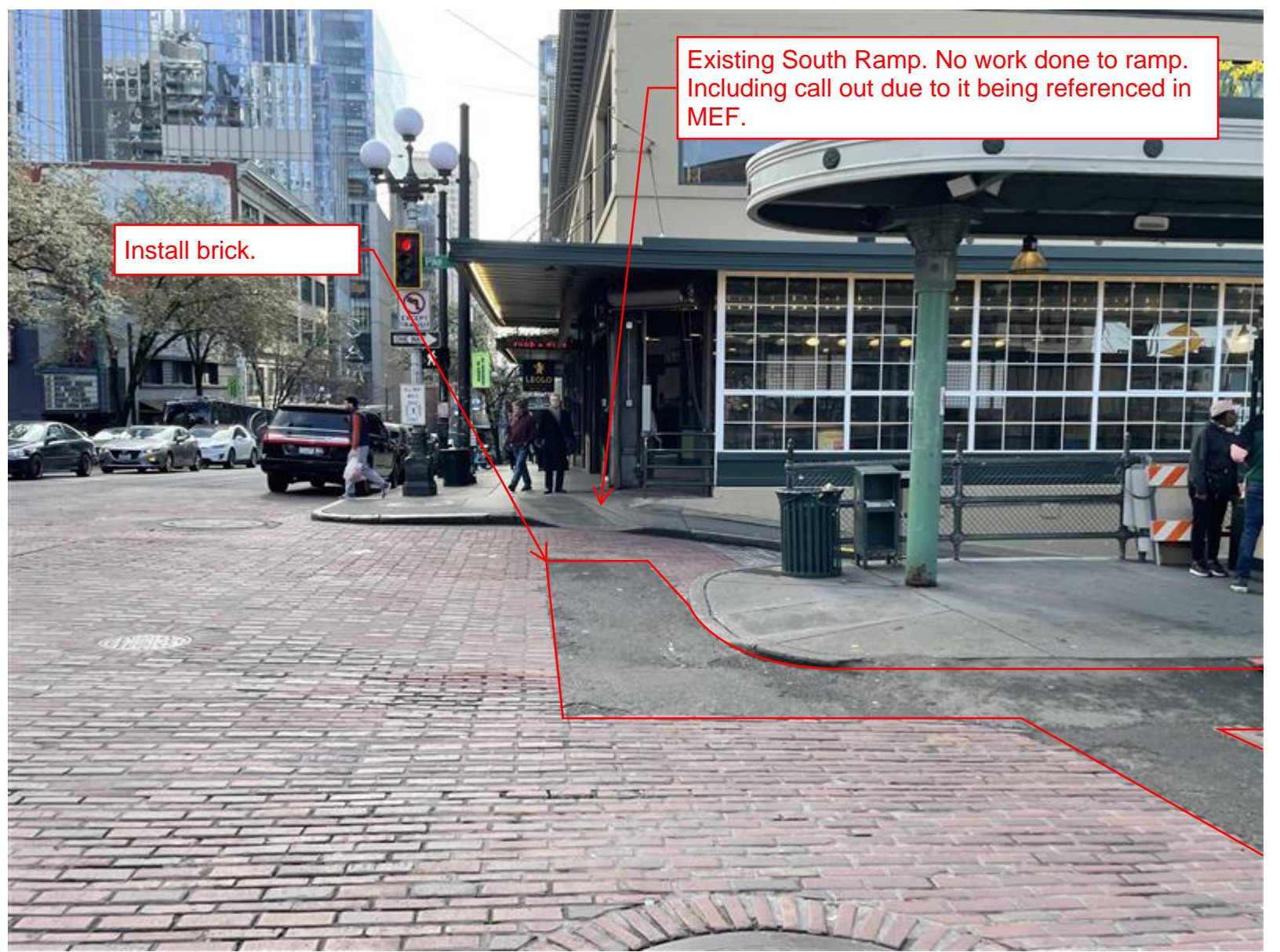

Install brick.

Existing South Ramp. No work done to ramp. Including call out due to it being referenced in MEF.

Ramp and curb not marked out on this photo.

Existing North Ramp. No work done to ramp. Including call out due to it being referenced in MEF.





Decorative brass foot steps in concrete. Photograph and document original layout prior to work. Replace decorative inlays to match original layout.

Curb Ramp #1, Redone to accommodate today's standards. Truncated domes similar to waterfront (cast iron tactile tile) will be installed.

Existing Conditions:



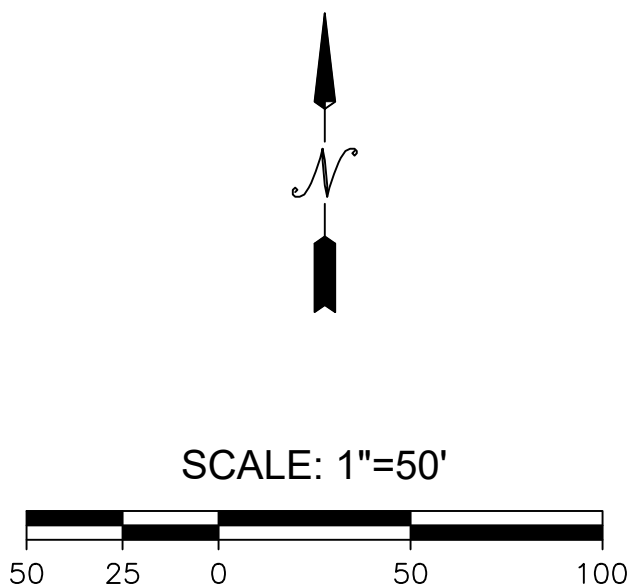

Sheet Index

Sht. No.	Description
1	COVER SHEET
2	GENERAL NOTES
3	CURB RAMP DETAILS

CURB RAMP NOTES:

UNLESS OTHERWISE NOTED ON THE DRAWINGS:

- ALL NEWLY CONSTRUCTED PEDESTRIAN ACCESS ROUTES INCLUDING SIDEWALK AND CURB RAMPS MUST MEET CURRENT ADA STANDARDS AND GUIDELINES TO THE MAXIMUM EXTENT FEASIBLE.
- WHERE THE DRAWINGS DENOTE "MEF" FOR CURB RAMP ELEMENTS, THIS DESIGNATION IS FOR THE REFERENCE ONLY, AND MUST BE FIELD VERIFIED BY THE ENGINEER. THE CONTRACTOR MUST NOTIFY THE ENGINEER PER SECTION 8-14.3(7) AND ALLOW THE ENGINEER THE OPPORTUNITY TO INSPECT THE CURB RAMP LAYOUT AND DIRECT ADJUSTMENTS AS NECESSARY. EVERY EFFORT WILL BE MADE TO ACHIEVE AN ADA COMPLIANT RAMP.
- THE CONTRACTOR MUST NOTIFY THE ENGINEER IF A CURB RAMP CANNOT BE CONSTRUCTED PER THE DRAWINGS, RESULTING IN NON-COMPLIANT SLOPES AND/OR DIMENSIONS. PRIOR TO INSTALLING THE CURB RAMP, THE ENGINEER MUST APPROVE THE CURB RAMP LAYOUT.
- PEDESTRIAN ACCESS THROUGH THE PROJECT MUST BE MAINTAINED IN COMPLIANCE WITH SDOT PEDESTRIAN MOBILITY IN AND AROUND WORK ZONES, AND CURRENT SDOT TRAFFIC CONTROL MANUAL FOR IN-STREET WORK.
- FOR ASSET MANAGEMENT PURPOSES, THIS PROJECT INCLUDES THE FOLLOWING:

NEW CURB RAMPS	0
REBUILT CURB RAMPS	1
PROJECT TOTAL	1

PROJECT LOCATOR MAP SCALE: 1"=9000'

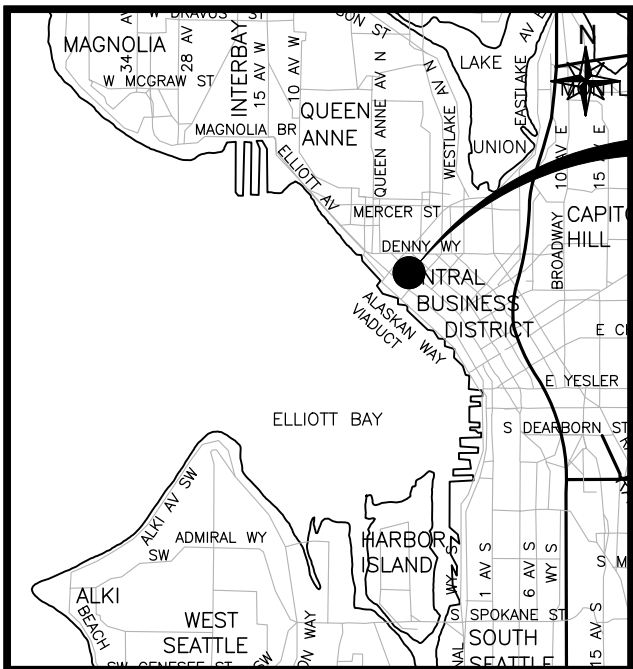

PROJECT LOCATION

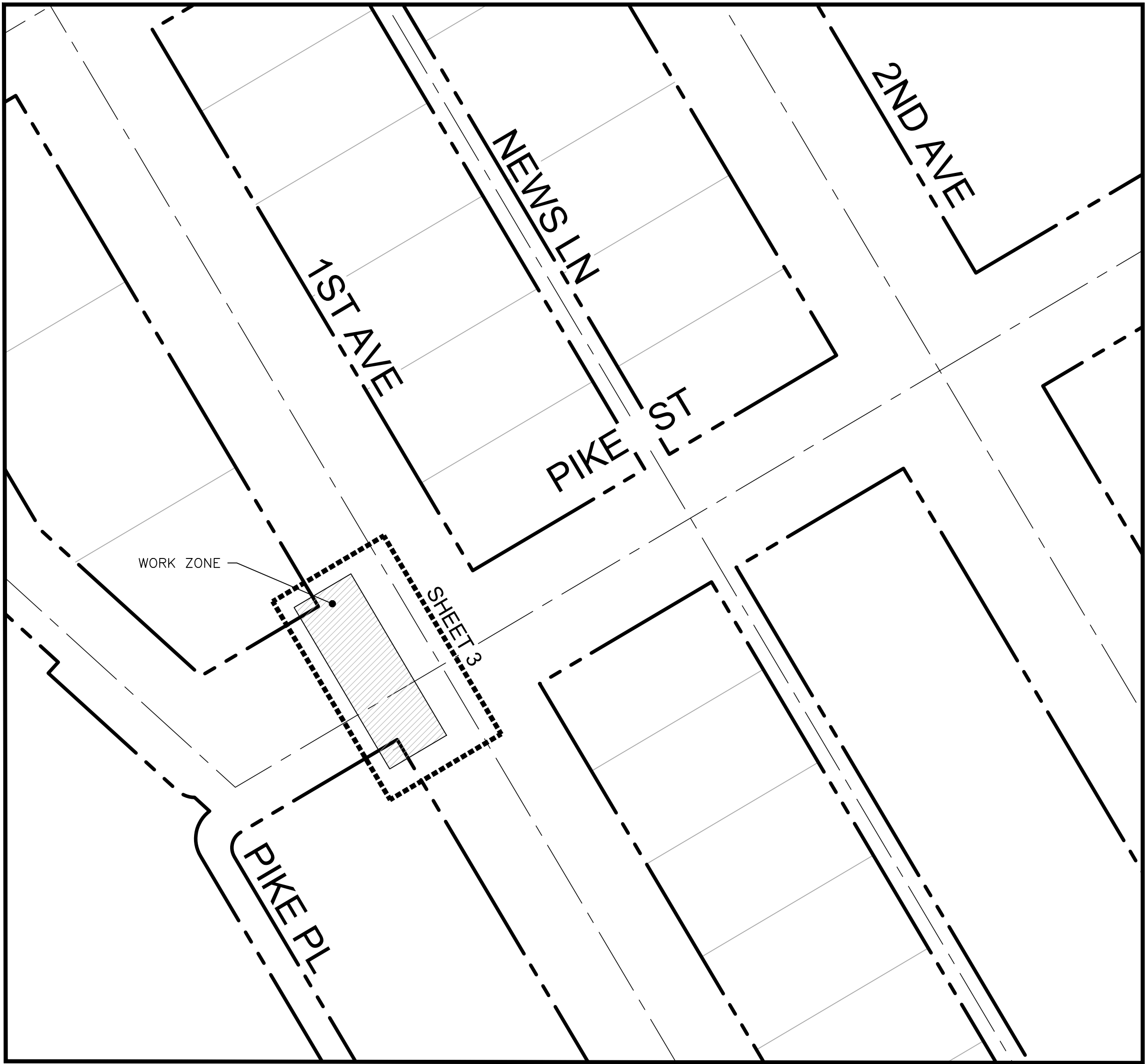

KEY MAP
SCALE: 1"=50'

KEY TO SERVICE ACTION

T&T ###	TEST & TIE SERVICE
PEI T&T ###	POLYETHYLENE INSERTED SERVICE
####	REPLACE COMPLETE SVC
T&T ###	REPLACE STUB AND TEST & TIE EXTENSION
###	INSTALL NEW SERVICE ADDRESS
C&C ###	CUT & CAP SERVICE
RWM ###	RETIRE WITH MAIN (RETIRE ABOVE GROUND RISER)

METHOD OF CONSTRUCTION	
OPEN TRENCH	
INSERTION	
HOLE HOG	
BORE	

CONSTRUCTION NOTES:

UTILITIES WERE LOCATED PRIOR TO SURVEY USING RECORDS PROVIDED BY EACH OWNER AND CITY RECORDS. EACH UTILITY WAS THEN FIELD VERIFIED BY GROUND PENETRATING RADAR AND OTHER METHODS. THE UTILITIES WILL BE POTHOLED PRIOR TO GAS INSTALLATION AND CLEARANCES WILL BE VERIFIED IN ACCORDANCE WITH SEATTLE STANDARD SPECIFICATIONS AS WELL AS STATE AND FEDERAL REQUIREMENTS.

LEGEND

BIKE RACK	POWER MANHOLE	RIGHT OF WAY LINE
BOLLARD	SIGNAL CONTROL BOX	TV CABLE, BURIED
CURB RAMP	SIGNAL JUNCTION BOX	FIBER OPTIC LINE
INFORMATION SIGN	TRAFFIC SIGNAL POLE	GAS
CABLE TV VAULT	FIBER OPTIC MANHOLE	POWER, BURIED
SANITARY SEWER MANHOLE	TELEPHONE JUNCTION BOX (UG)	STORM
STORM DRAIN CATCH BASIN	TELEPHONE MANHOLE	TELEPHONE, BURIED
STORM DRAIN MANHOLE	UTILITY CLEAN OUT	WATER
YARD DRAIN	FIRE HYDRANT	SANITARY SEWER
LUMINAIRE W/ARM	WATER MANHOLE	OVERHEAD TROLLEY
LUMINAIRE	WATER METER	CENTERLINE
GAS MANHOLE LID	MONITORING WELL	TREE DRIPLINE
GAS VALVE	WATER VALVE	AREAWAY
GAS VAULT	DECIDUOUS (DC)	BRICK PAVER RESTORATION
GUY POLE	FOUND CASED MONUMENT	PROPOSED CURB RAMP
ELECTRICAL JUNCTION PULL/BOX	FOUND OTHER MONUMENT	PROPOSED CURB RAMP
FOUND SURVEY PK NAIL	FOUND SURVEY REBAR & CAP	
FOUND SCRIBE	JUNCTION BOX	
POWER POLE	POWER POLE WITH LUMINAIRE	

ABBREVIATIONS

ASPH	ASPHALT	PVLT	POWER VAULT
CB	CATCH BASIN	ROW	RIGHT OF WAY
CC	CONCRETE CULVERT	SSMH	SANITARY SEWER MANHOLE
C/L	CENTERLINE	SSS	SIDE SEWER SANITARY
DWY	DRIVEWAY	SDMH	STORM DRAIN MANHOLE
EX	EXISTING	SL	STREET LIGHT
FH	FIRE HYDRANT	SS	STREET SIGN
F/L	FLOWLINE	TMH	TELEPHONE MANHOLE
GS	GAS SERVICE	TJB	TELEPHONE JUNCTION BOX
GV	GAS VALVE	TVLT	TELEPHONE VAULT
HH	HAND HOLE	TS	TRAFFIC SIGNAL POLE
IM	IRRIGATION METER	TYP	TYPICAL
JB	JUNCTION BOX	UP	UTILITY POLE
MB	MAILBOX	WMH	WATER MANHOLE
MW	MONITORING WELL	WM	WATER METER
OHT	OVERHEAD TROLLEY	WS	WATER SERVICE
PSS	PIPE SEWER SANITARY	WV	WATER VALVE
PSD	PIPE STORM DRAIN		

PAGE #	QUANTITY	SIZE	MATERIAL

SIGNATURES

PROJECT MANAGER _____ DATE _____
INSPECTOR _____ DATE _____

Project Manager Contact Information:
Name: ERIK ALVARADO
Cell Phone: 425-326-6028
E-Mail: Erik.Alvarado@pse.com

For contacts below dial 1-888-CALL PSE (225-5773)
CALL (800) 424-5555
2 BUSINESS DAYS BEFORE YOU DIG

"Locates Required" Yes <input type="checkbox"/> No <input type="checkbox"/>				"Flagger Required" Yes <input type="checkbox"/> No <input type="checkbox"/>			
REAL ESTATE/EASEMENT				PERMIT SUUMP #0000469-A001			
REV#	DATE	BY	DESCRIPTION	FUNCTION	CONTACT	PHONE NO	DATE
1				PROJECT MGR	ERIK ALVARADO	425-326-6028	
2				ENGR - GAS	D FRIEZE	425-462-3862	
3				DRAWN BY	A STAUFFER	425-456-2722	
4				CHECKED BY	S FRANCISCO	425-462-3960	
APPROVED BY				CP APPROVAL			
COUNTY KING				Emer Sect			
1/4 SEC N/A				OP MAP N/A			
GAS WK CTR N/A				PLAT MAP N/A			
MAPPING							

JOINT FACILITIES ARRANGEMENTS

UTILITIES	N/A	N/A	N/A	N/A
CONTACT	N/A	N/A	N/A	N/A
PHONE#	N/A	N/A	N/A	N/A
SAP Sup Order Nbr 109159570				ESM-109159570-RAMP
SCALE 1"=50'				PAGE 1/3

PSE
PUGET SOUND ENERGY
DESIGNED BY PUGET SOUND ENERGY

1501 PIKE PL
SEATTLE, WA
COVER SHEET



ESM
CONSULTING ENGINEERS, LLC
33400 8th Avenue So, Ste #205
Federal Way, WA 98003
LYNNWOOD (425) 297-9900
FEDERAL WAY (253) 838-6113
www.esmcivil.com

ESM PROJECT # 300-2151-024
SUUMP #0000469-A001
SUIP #86614
DATE: 07/09/2025

109159570

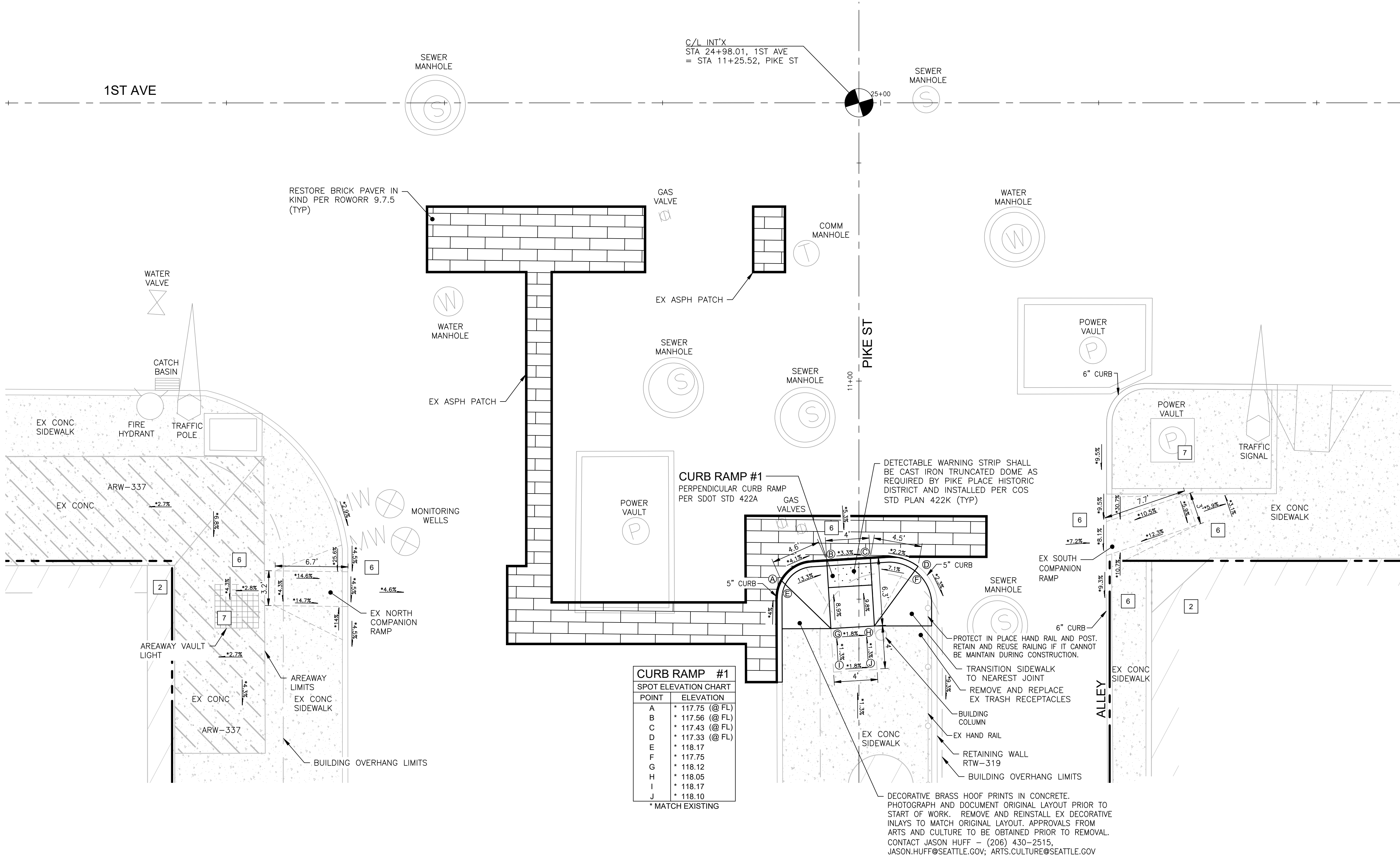

CURB RAMP DETAILS
SCALE: 1"=5'

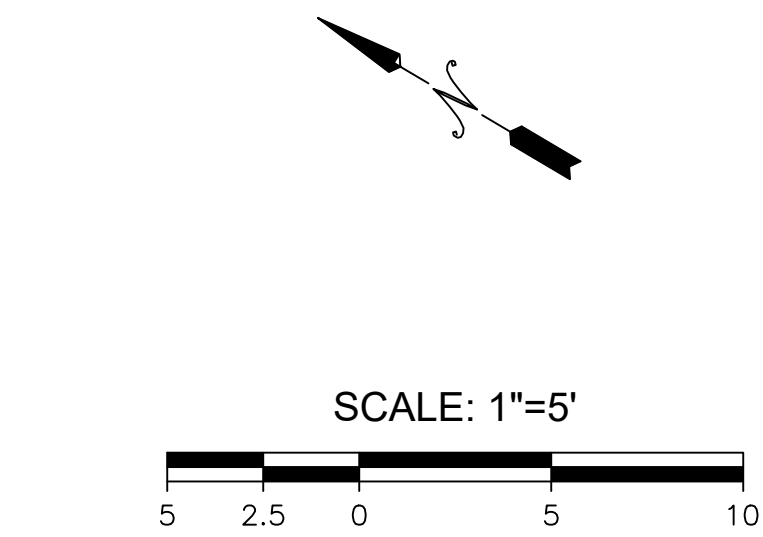

CURB RAMP NON-STANDARD JUSTIFICATION CODES	
1	RIGHT-OF-WAY AVAILABILITY
2	ROADWAY STRUCTURAL CONSTRAINT: WALL, AREAWAY, OR BRIDGE
3	ADJACENT DEVELOPED FACILITY
4	DRAINAGE
5	HISTORIC FEATURE
6	EXISTING ROAD/SIDEWALK SLOPES
7	EXISTING UTILITY VAULT OR UTILITY STRUCTURE
8	(OTHER)



07/09/2025
ESM
CONSULTING ENGINEERS, LLC
33400 8th Avenue So, Ste #205
Federal Way, WA 98003
LYNNWOOD (425) 297-9900
FEDERAL WAY (253) 838-6113
www.esmcivil.com

ESM PROJECT # 300-2151-024
SUUMP #0000469-A001
SUIP #86614

Project Manager Contact Information: Name: ERIK ALVARADO Cell Phone: 425-326-6028 E-Mail: Erik.Alvarado@pse.com				For contacts below dial 1-888-CALL PSE (225-5773)			
				CALL (800) 424-5555			
				2 BUSINESS DAYS BEFORE YOU DIG			
				THIS SKETCH NOT TO BE RELIED UPON FOR EXACT LOCATION OF EXISTING FACILITIES			
"Locates Required" Yes <input type="checkbox"/> No <input type="checkbox"/>				REAL ESTATE/EASEMENT N/A		PERMIT SUUMP #0000469-A001	
"Flagging Required" Yes <input type="checkbox"/> No <input type="checkbox"/>							
REV#	DATE	BY	DESCRIPTION	FUNCTION	CONTACT	PHONE NO	DATE
1				PROJECT MGR	ERIK ALVARADO	425-326-6028	
2				ENGR - GAS	D FRIEZE	425-462-3862	
3				DRAWN BY	A STAUFFER	425-456-2722	
				CHECKED BY	S FRANCISCO	425-462-3960	
COUNTY KING		Emer Sect 17	GAS WK CTR	APPROVED BY			
1/4 SEC SE 31-25-04		OP MAP 188.068	PLAT MAP 191.069A	CP APPROVAL M GALLARDO		425-462-3859	
				MAPPING			
JOINT FACILITIES ARRANGEMENTS							
UTILITIES		N/A	N/A	N/A		N/A	
CONTACT		N/A	N/A	N/A		N/A	
PHONE#		N/A	N/A	N/A		N/A	
 PUGET SOUND ENERGY DESIGNED BY INFRASOURCE						1501 PIKE PL CURB RAMP DETAILS SEATTLE, WA	
						SAP Sup Order Nbr 109159570	
						ESM-109159570-RAMP	
SCALE 1"=5'						PAGE 3/3	

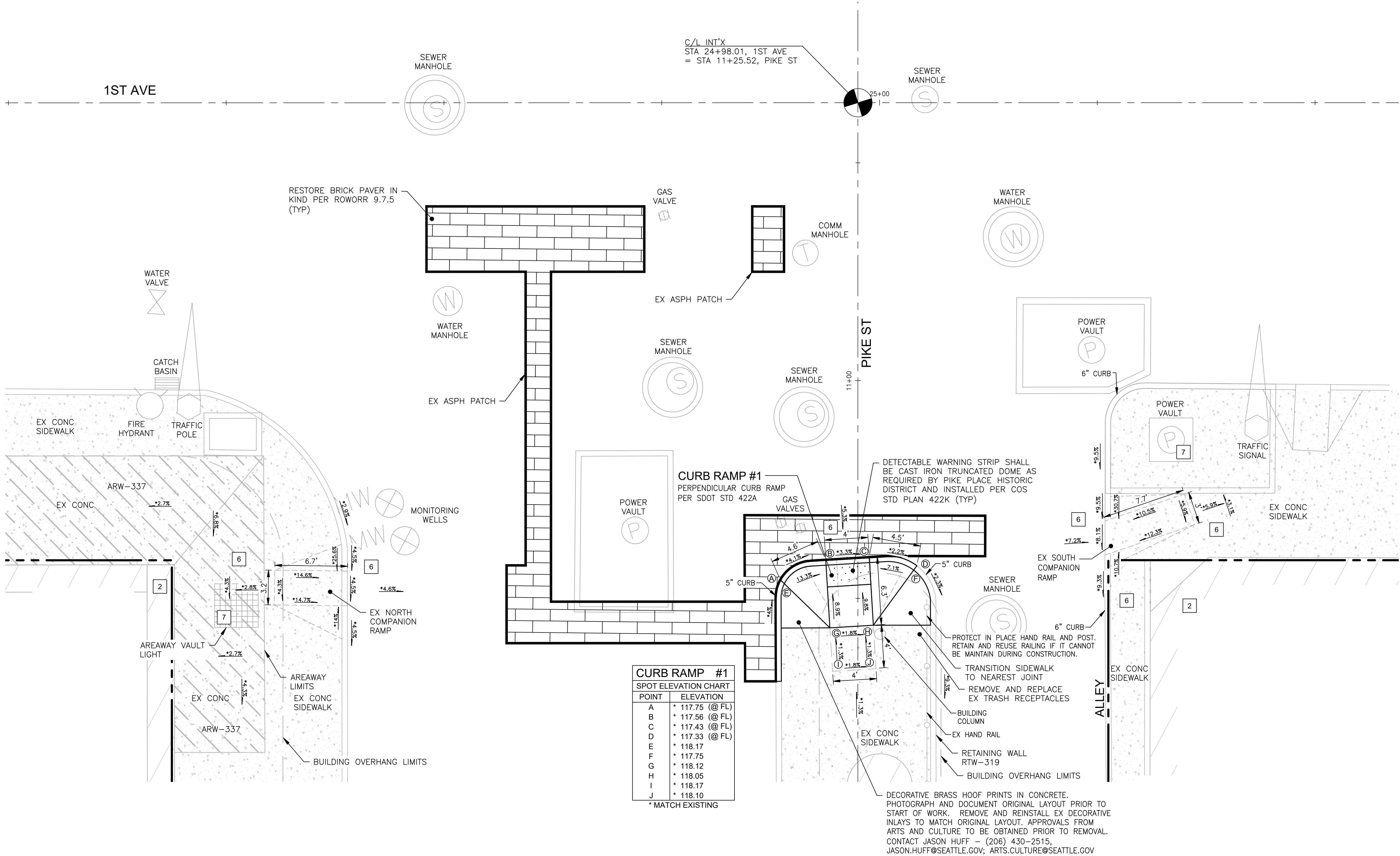

CURB RAMP DETAILS
SCALE: 1"=5'

CURB RAMP NON-STANDARD JUSTIFICATION CODES	
1	RIGHT-OF-WAY AVAILABILITY
2	ROADWAY STRUCTURAL CONSTRAINT: WALL, AREAWAY, OR BRIDGE
3	ADJACENT DEVELOPED FACILITY
4	DRAINAGE
5	HISTORIC FEATURE
6	EXISTING ROAD/SIDEWALK SLOPES
7	EXISTING UTILITY VAULT OR UTILITY STRUCTURE
8	(OTHER)



07/09/2025
ESM
CONSULTING ENGINEERS, LLC
33400 8th Avenue So, Ste #205
Federal Way, WA 98003
LYNNWOOD (425) 297-9900
FEDERAL WAY (253) 838-6113
www.esmcivil.com

ESM PROJECT # 300-2151-024
SUUMP #0000469-A001
SUIP #86614

Project Manager Contact Information: Name: ERIK ALVARADO Cell Phone: 425-326-6028 E-Mail: Erik.Alvarado@pse.com				For contacts below dial 1-888-CALL PSE (225-5773)				
				CALL (800) 424-5555				
				2 BUSINESS DAYS BEFORE YOU DIG				
THIS SKETCH NOT TO BE RELIED UPON FOR EXACT LOCATION OF EXISTING FACILITIES								
"Locates Required" Yes <input type="checkbox"/> No <input type="checkbox"/>				REAL ESTATE/EASEMENT N/A		PERMIT SUUMP #0000469-A001		
"Flagging Required" Yes <input type="checkbox"/> No <input type="checkbox"/>								
REV#	DATE	BY	DESCRIPTION	FUNCTION	CONTACT	PHONE NO	DATE	
1				PROJECT MGR	ERIK ALVARADO	425-326-6028		
2				ENGR - GAS	D FRIEZE	425-462-3862		
3				DRAWN BY	A STAUFFER	425-456-2722		
				CHECKED BY	S FRANCISCO	425-462-3960		
COUNTY KING		Emer Sect 17	GAS WK CTR	APPROVED BY				
1/4 SEC SE 31-25-04		OP MAP 188.068	PLAT MAP 191.069A	CP APPROVAL M GALLARDO		425-462-3859		
				MAPPING				
JOINT FACILITIES ARRANGEMENTS								
UTILITIES		N/A	N/A	N/A		N/A		
CONTACT		N/A	N/A	N/A		N/A		
PHONE#		N/A	N/A	N/A		N/A		
PSE PUGET SOUND ENERGY DESIGNED BY INFRASOURCE						1501 PIKE PL CURB RAMP DETAILS SEATTLE, WA		SAP Sup Order Nbr 109159570
								ESM-109159570-RAMP
						SCALE 1"=5'	PAGE 3/3	



Pike Place Market Brick. This brick is currently being cleaned and evaluated for use. This Pike Place brick has been approved in the past for other projects. A random sample from each bin was photographed and is below.



Alvarado, Erik

From: Stacey Hillesland <stacey.hillesland@willamettegraystone.com>
Sent: Wednesday, June 4, 2025 12:12 PM
To: Alvarado, Erik
Subject: Belden Brick details
Attachments: Test Report Rembrandt.pdf

CAUTION - EXTERNAL EMAIL
Phishing? Click the PhishAlarm "Report Phish" button.

Hi Erik,

See attached regarding the Clay pavers ordered by the City of Seattle for Pikes Street. Colors ordered were the Rembrandt and the Georgian. 75% Rembrandt and 25% Georgian. These selections are generally stocking and available to ship.

Let me know if you have any further questions.
Thanks.



f p



f p

REMBRANDT PAVERS

Type	Paver
Color	Brown
Texture	Sandmold
Plant	Plant 3
Manufacturing Method	Molded
Coating	Sand
Series	Crestline

GEORGIAN PAVERS

Type	Paver
Color	Red
Texture	Sandmold
Plant	Plant 3
Manufacturing Method	Molded
Coating	Sand
Series	Crestline



Designed for Durability Engineered for Ultimate Strength

Advantage® Cast Iron Premier ADA Tactile Detectable Warning Tiles are manufactured in strict accordance with ASTM A-48, Class 35B Grey Cast Iron. The Advantage® Cast In Place Premier System is lightweight with exceptional high strength, and utilizes the most advanced metallurgical Engineering Science and Technology to meet and exceed the most stringent accessibility standards. This new self-threading corrosion-resistant anchor system allows the installer to position the anchors with ease and full control. Advantage® Cast Iron Premier is aesthetically pleasing, has exceptional longevity and incorporates integral texture for a permanent slip resistant surface.

Advantage® Cast Iron Premier Detectable Warning Tiles can be used to meet ADA compliance in the following applications:

- Curb Ramps
- Pedestrian Crossings
- Transit Platforms
- Vehicular Passage Ways
- Parking Areas
- Top of Stair Landings

COMPLIANCE

Advantage® Cast Iron Tactile Systems are in full compliance with ADA Accessibility Guidelines and state requirements. Advantage® Tactile Systems is your one stop source for all tactile systems for internal and external applications while providing a complete range of products designed for safety, convenience and code compliance.



PRODUCT FEATURES

- Lightweight and easy to install
- Self-threading corrosion-resistant composite nylon anchors
- Complies with "Buy America" domestic content requirements
- Engineered to endure the toughest conditions such as snow plows, maintenance and excessive vehicular loads
- Maintenance-free natural patina finish
- ASTM A48, Class 35B Grey Cast Iron
- Can be recycled after its lifecycle
- 10 year manufacturer's warranty

Advantage® Cast Iron Premier

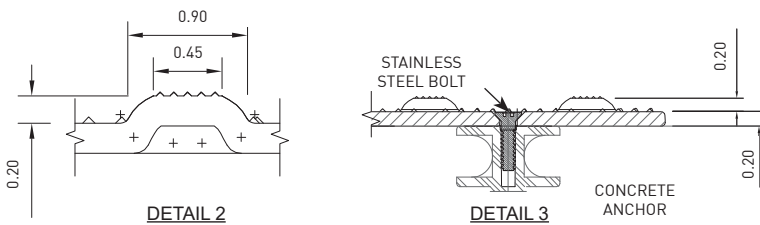
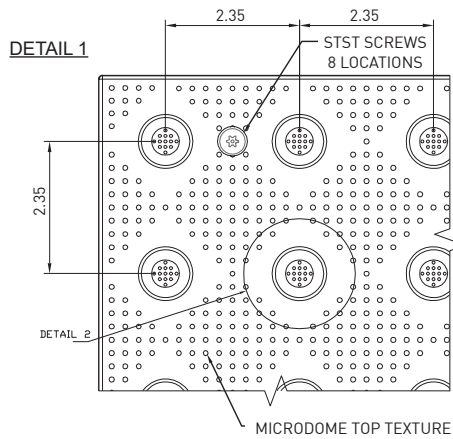
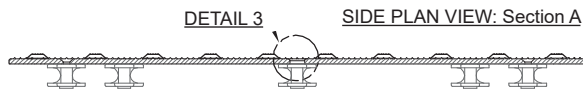
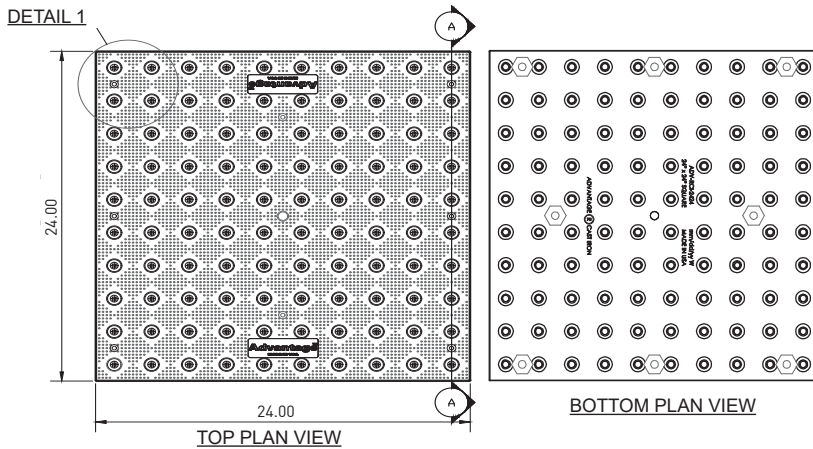

STANDARD COLOR

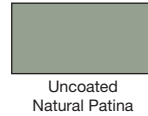

OPTIONAL COLORS

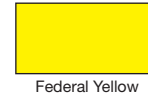

ADVANTAGE® CAST IRON PREMIER SIZE

Standard	Radial
24" x 12"	15'
24" x 18"	20'
24" x 24"	25'
24" x 30"	30'

TILE SPECIFICATIONS

Gray Cast Iron Detectable/Tactile Warning Surface Indicator Tiles shall meet or exceed the following test criteria:

ASTM Reference	Test Description	Value
ASTM C 1028	Static Coefficient of Friction	≥ 1.0 wet/dry
AASHTO T4 33	Impact Resistance	No damage @ 54 J
ASTM A 48	Gray Iron Castings	Class 35B
ASTM C 501	Abrasive Wear Index on Walking Surface	≥ 70
	Anchor Pullout Test	795 lbs per anchor

Tiles to be fastened with stainless steel security screws and glass reinforced nylon anchors.

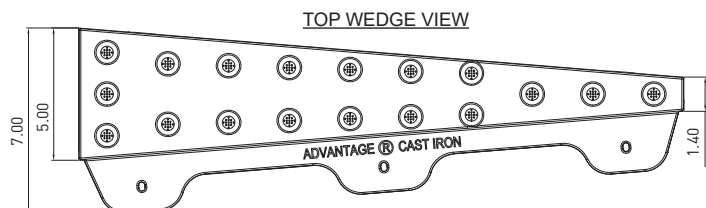

Advantage Tactile Systems Inc.

241 Main Street, Suite 100
Buffalo, NY 14203
USA

Phone: (800) 679-4022
Fax: (800) 769-4463
www.advantagetactile.com



Installation Instructions Cast-In-Place Cast Iron Detectable Warning

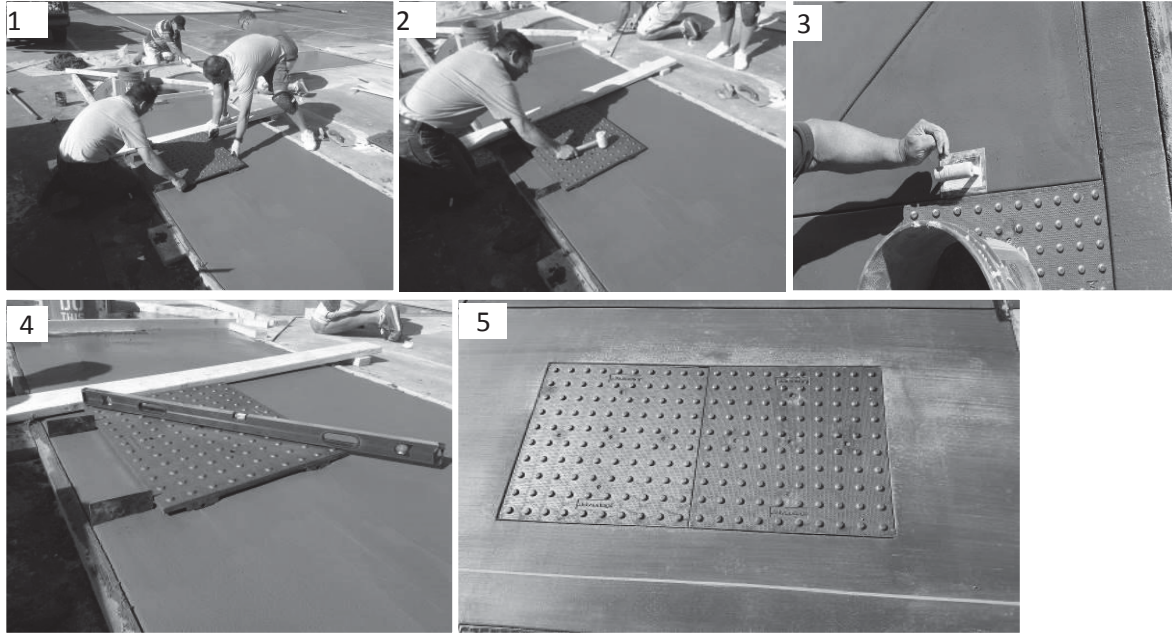

1. Maintaining a 4-7 slump range, pour and float the concrete and prepare for tile installation.
2. Without removing any concrete, place the tile on the curb ramp 6"-8" from the curb line.
3. Tamp the tile in grid pattern across the top face, embedding the tile into the concrete using a rubber mallet or vibrate into place using a vibrating mechanism fixed with a soft base such as wood.
4. Create an edge around the perimeter of the tile using a 3/8" radius edging tool then float the concrete around the tile's perimeter using a steel trowel.
5. Using a smart level make sure ramp and tile are in compliance with ADA requirements and in accordance with contract documents.
6. Apply a broom-finish to the curb ramp and ensure face of tile is clean and free of any concrete debris.

Please call 1(800) 679-4022 with any additional questions regarding the installation.



Installation Instructions Cast-In-Place Cast Iron Detectable Warning

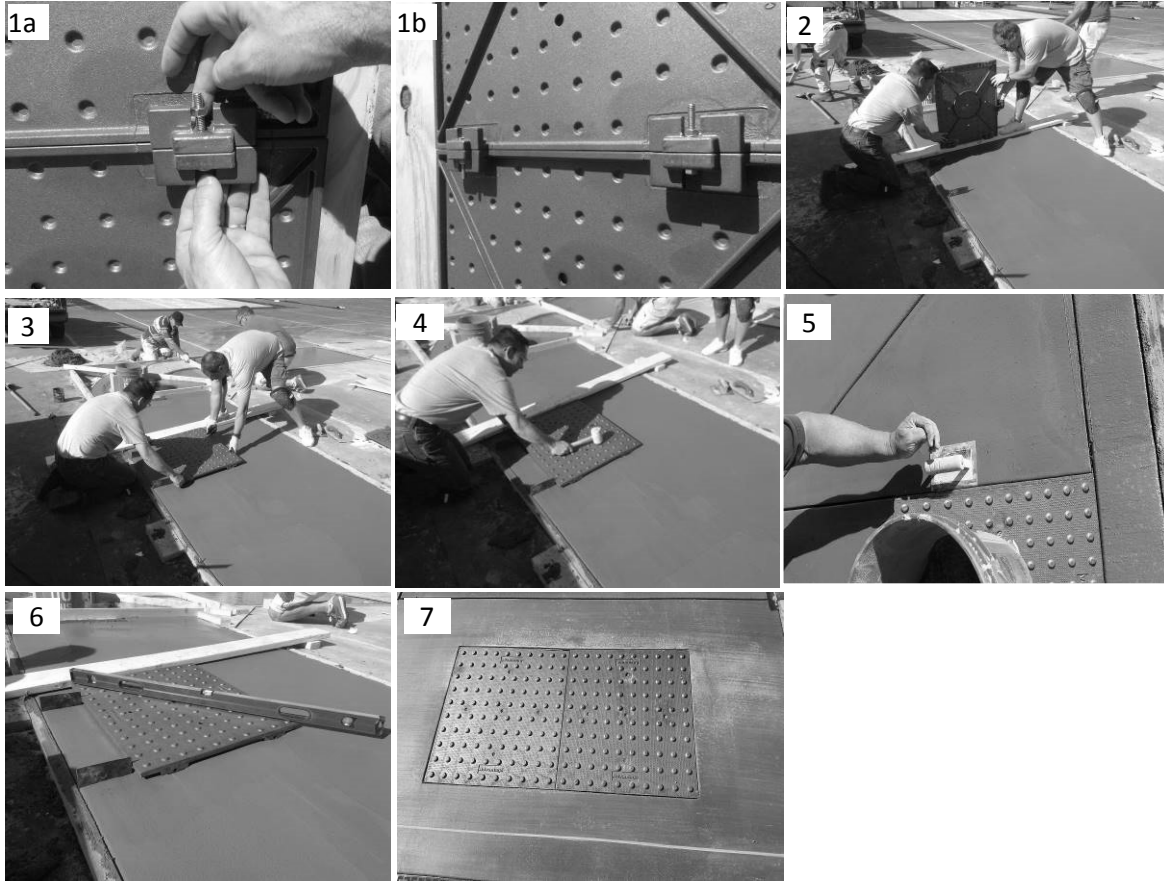

1. Connect multiple tiles with 3/8" x 1-3/4" bolts (figure 1a and 1b)
2. Maintaining a 4-7 slump range, pour and float the concrete and prepare for tile installation.
3. Without removing any concrete, place the tile on the curb ramp 6"-8" from the curb line.
4. Tamp the tile in grid pattern across the top face, embedding the tile into the concrete using a rubber mallet or vibrate into place using a vibrating mechanism fixed with a soft base such as wood.
5. Create an edge around the perimeter of the tile using a 3/8" radius edging tool then float the concrete around the tile's perimeter using a steel trowel.
6. Using a smart level make sure ramp and tile are in compliance with ADA requirements and in accordance with contract documents.
7. Apply a broom-finish to the curb ramp and ensure face of tile is clean and free of any concrete debris.

Please call 1-844-697-2920 with any additional questions regarding the installation.



325 Corporate Drive, Elgin, IL 60123 USA T: 1-844-697-2920 F: 1-833-652-1547
<https://new.advantagetactile.com>

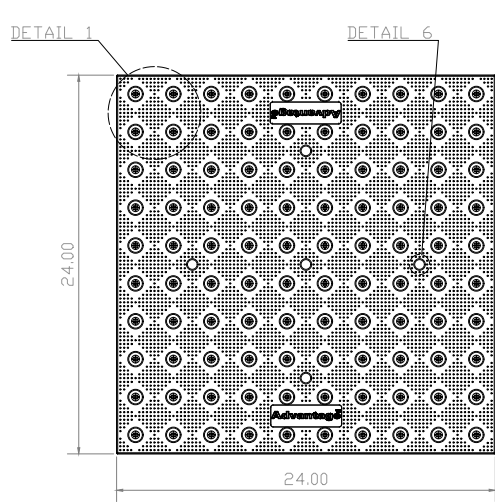

TOP PLAN VIEW

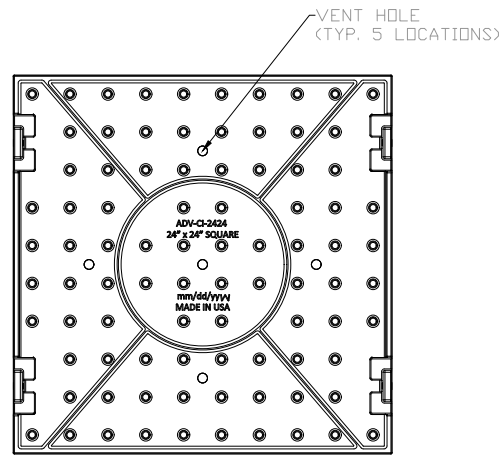

BOTTOM PLAN VIEW

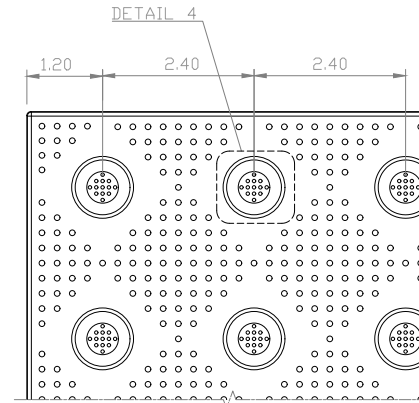

DETAIL 1

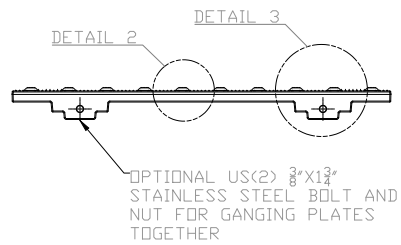

ELEVATION VIEW 1

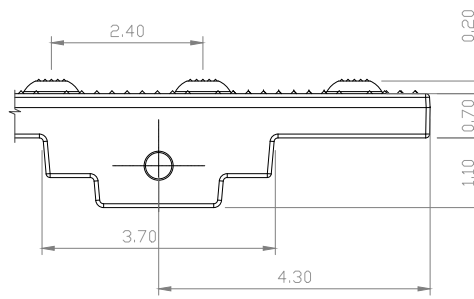

DETAIL 3

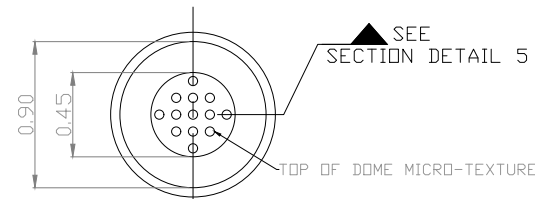

DETAIL 4 (TYPICAL DOME PLAN)

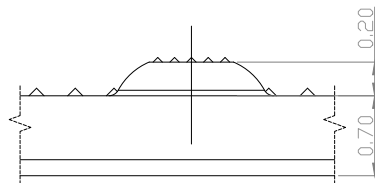

DETAIL 2 (TYPICAL DOME)

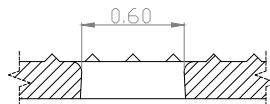

DETAIL 6

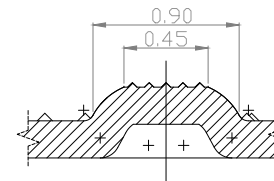

DETAIL 5 (TYPICAL DOME SECTION)

www.advantagetactile.com

Advantage
Tactile Systems

SureWorx

MATERIAL LIST

ITEM	DESCRIPTION	PART NO.	QTY
1	24X24 CAST IRON TWSI PLATE	ADV-CI-2424	1
2			
3			
4			
5			

REFERENCE DRAWINGS

DWG. NO.	DESCRIPTION

ESTIMATED WEIGHT: 37 LBS
COMPLIES WITH: CSA B651
ISO 23599 & AODA

No.	DATE	REVISION	APPR.

SCALE: N.T.S.

DESIGNED BY	K.S.	DATE
DRAWN BY	M.T.	DATE 07/15/2024
CHECKED BY	DD	DATE

PROJECT MANAGER	
TRADE	TWSI
PART NO.	ADV-CI-2424
MATERIAL	GREY CAST IRON/ASTM A48 CLASS 35B.
SUBJECT	

TACTILE TILE
DETECTABLE WARNING
SURFACE SYSTEM

PROJECT
**ADVANTAGE CAST IRON
TACTILE WALKING SURFACE
INDICATOR PLATE
24"X24"**

DRAWING NO.	SHT. NO.	REV. NO.
ADV-CI-USA TILES	0	01

Alvarado, Erik

From: Alvarado, Erik
Sent: Wednesday, July 23, 2025 9:14 AM
To: Matt Shearer
Cc: Guay, John
Subject: 109159570, 1501 PIKE PL, SUUMP0000469-A001, DONH-COA-01692, Brass Inlay Hooves

Hi Matt,

I know we talked over the phone about this but wanted to document this via email, which I will print for the historic district.

After talking with the pike place market foundation, they mentioned their contractor doesn't have much experience with removing and reinstalling the brass inlays. Because there isn't a long history of removing/reinstalling, To avoid any complications during construction, PSE has decided to install new hooves that will have the same placement and engraving as the existing ones. We will photograph the existing brass inlays prior to removal and reset in the same location during construction of the new ramp. There are 11 brass inlays impacted, and the pike place market foundation let us know it typically takes 2 weeks for the hooves to get engraved.



V/R,
Erik Alvarado, PMP
Project Manager