

MAY 2025

# *Bakery Remodel*

## CONTENTS

Intent

Overview

Palette

Remodel Elements





## *Our intent*

Knowing that our refrigerated display cases were failing and looking around there were other things to repair, we decided to take the time to refresh the retail bakery space.

It has been important to continually honor our French roots and balance the history of over 40 years in Pike Place. Our choices in layout and materials hopefully reflect this well.



# Overview of Remodel Elements

**1 CASES |** New cases with lower profile and remote refrigeration

**2 CABINETRY |** Updates to emphasize ‘scratch bakery’ and accommodate the new cases

**3 COUNTERTOPS |** Update with similar material because of wear and tear

**4 RAMP |** For improved ADA accessibility and customer experience

**5 SEATING |** Front window seating remains unchanged with additional ADA seating and a new bench

**6 RETAIL FLOOR |** Current floor is no longer made. Replacing with concrete tile that brings a French essence and durability

**7 PAINT & WALLS |** Lightening up the space with a creamy shade as well as removing worn wainscoting

**8 LIGHTING |** Powder coat existing historic lights to maintain original lighting design



# Previous Layout

NORTH ^

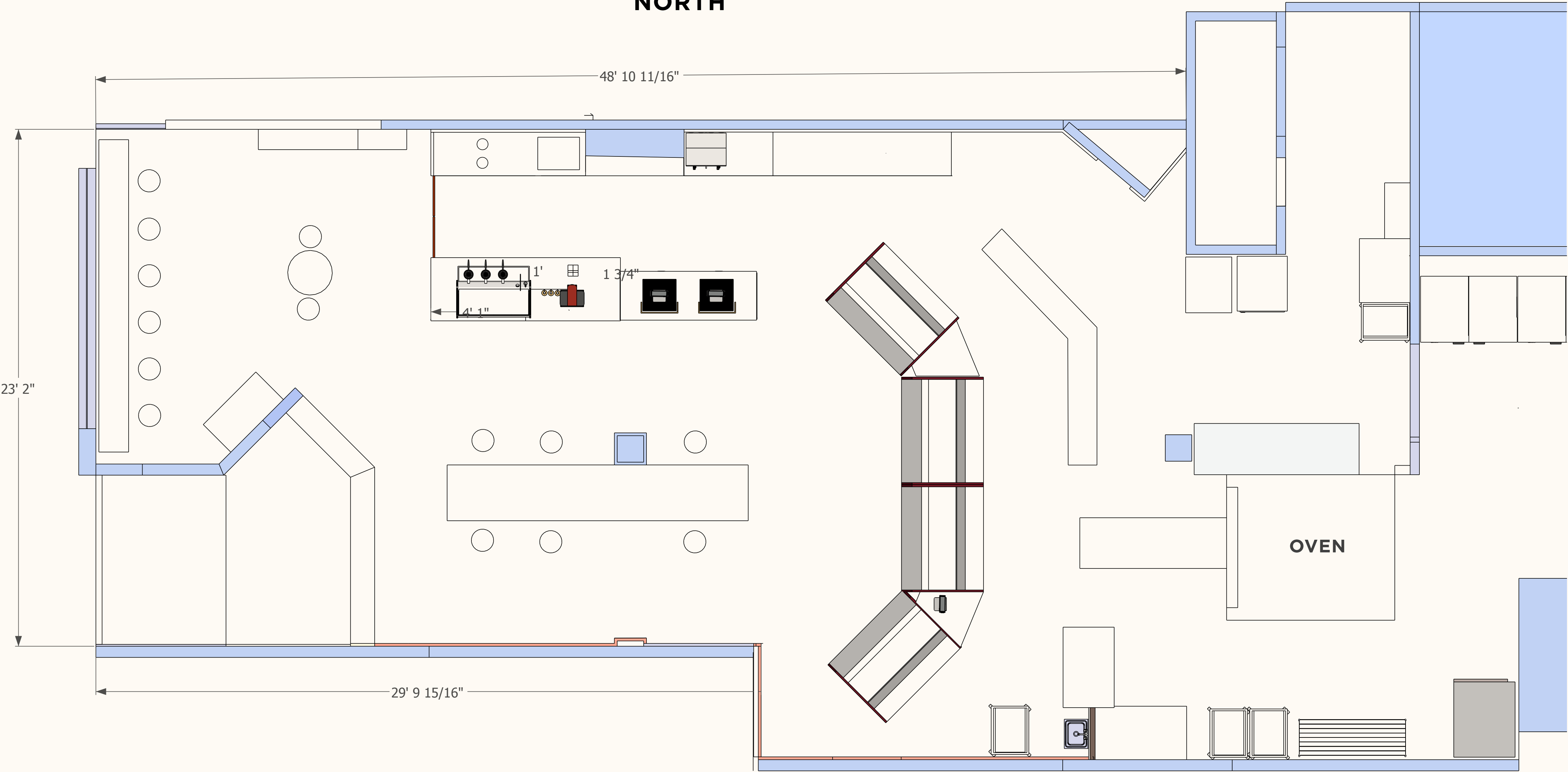

# New Layout

NORTH ^

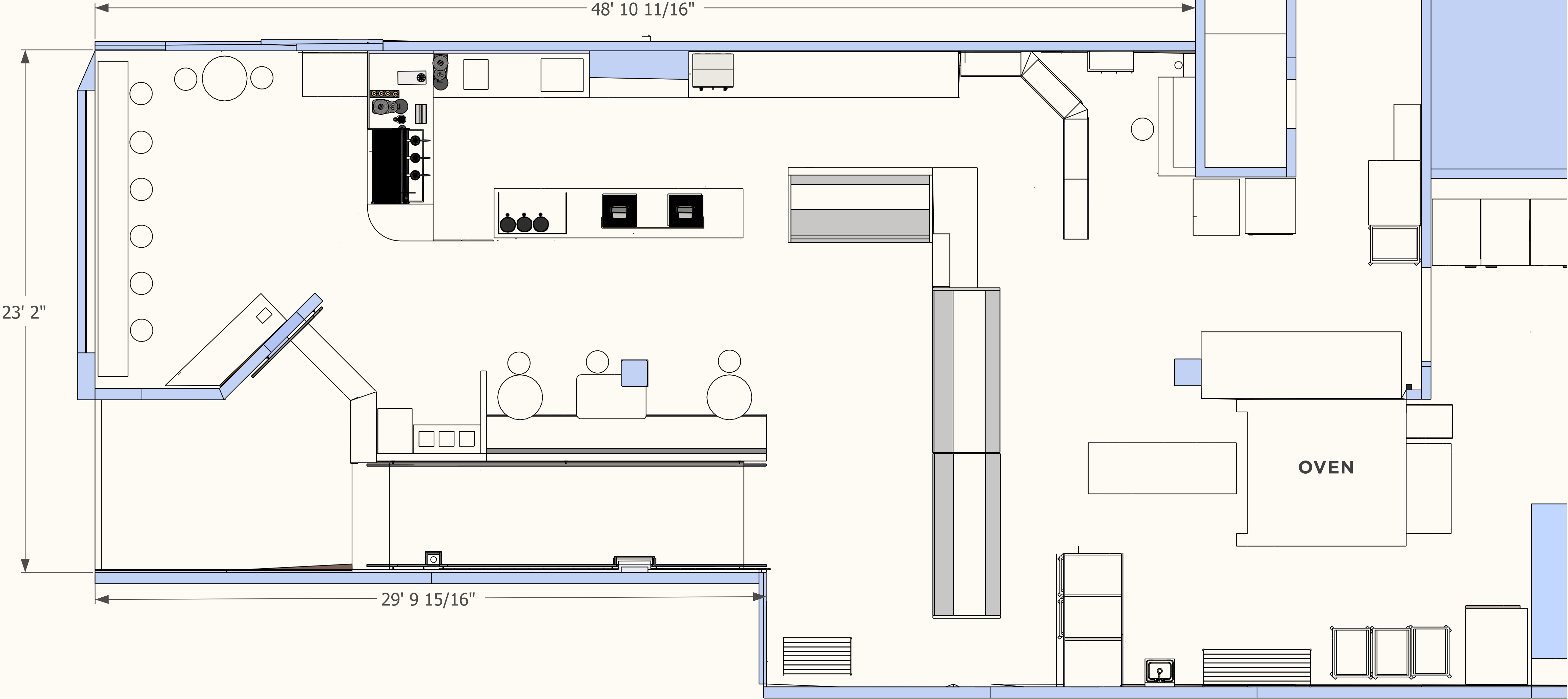

LE PANIER

1902 PIKE PLACE

BAKERY REMODEL

MAY 2025



# Overview of Remodel Elements

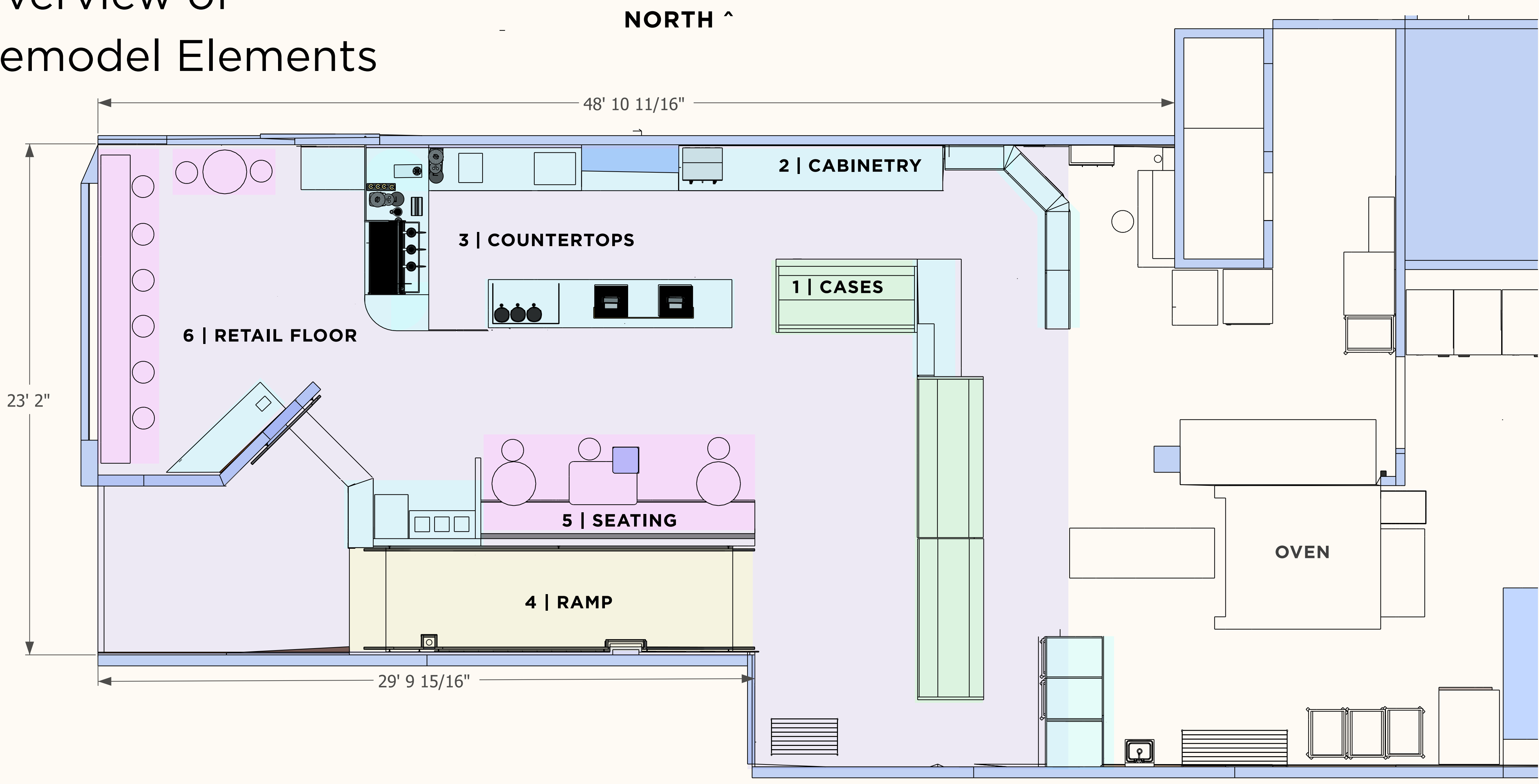

LE PANIER

1902 PIKE PLACE

BAKERY REMODEL

MAY 2025





PALETTE INSPIRATION

*Very French*

While feeling connected  
to our PNW practicality.

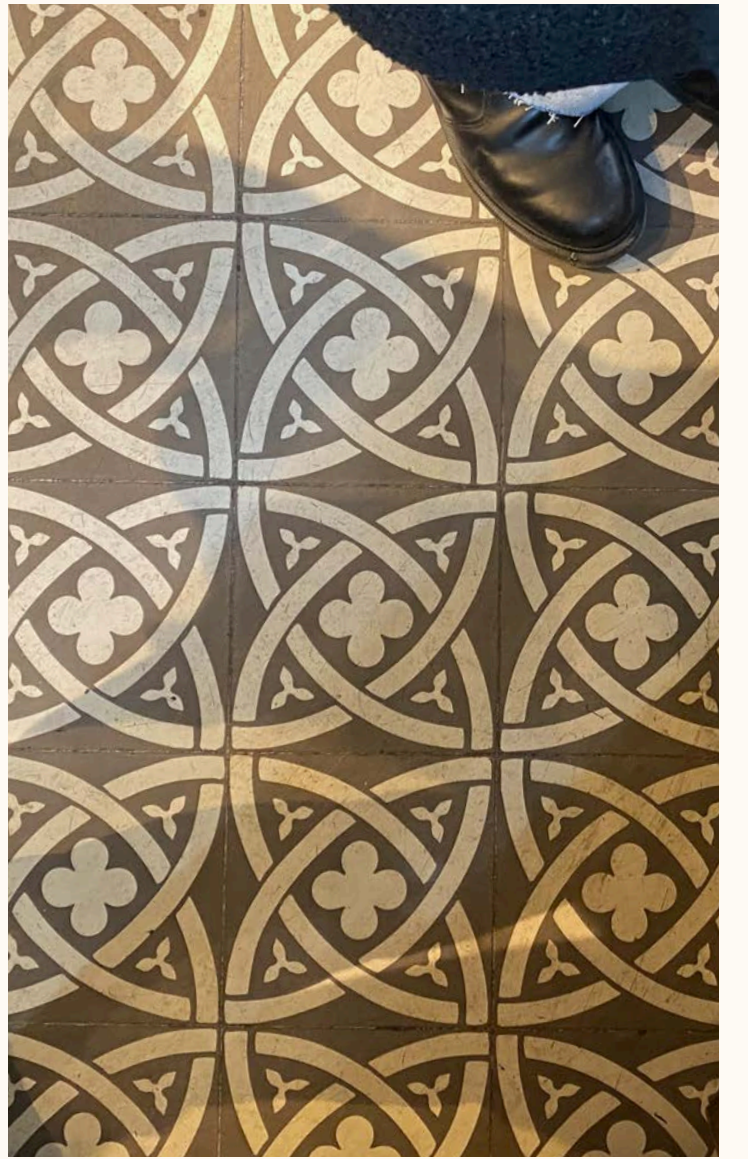

LE PANIER

1902 PIKE PLACE

BAKERY REMODEL

MAY 2025



LE PANIER

Material Palette

Keeping the warmth of the bakery, we chose to bring that out with more wood tones that are reminiscent of France and the Pacific Northwest. Using creams and browns adds to that warmth as well, letting the food be the main attraction.

MATERIALS

Keeping with our use of marble, wood, stainless steel, classic deep red and hints of black.

**3.4.2 Interior Finishes** (d) Interior finishes should not attempt to imitate any other material. For example, laminates in colors or patterns not replicating other materials are acceptable; those mimicking wood or stone are not acceptable.





# 1 | *New Cases*

Cases needed replacement as previous refrigerated cases were failing.

## UPDATE INCLUDES

- Criocabin brand with remote refrigeration
- Made in Italy for a guaranteed European feel
- More prominent display of pastry
- Lower case profile allows for better customer interaction
- 3 cases (2 refrigerated) instead of 4 (2 refrigerated)
- Wood panels with glass & stainless accents



**BEECH WITH CUSTOM  
STAIN 'NUTELLA'**

CRIOCABIN BRAND CASES



*Before: 3-shelf case blocked customer interaction*

*After: 2-shelf opens up the space*

**3.4.3 Displays** (a) The display of goods themselves should be the dominant element with minimization of shelving, cases, and other display supports. The use of excessive decoration, signage or artificial effects is discouraged.





*Before: Pastry case with bread wall as a backdrop but refrigeration was failing*



*After: Jewelry-case inspired, new pastry case displays patisserie at one level with bread in the background*

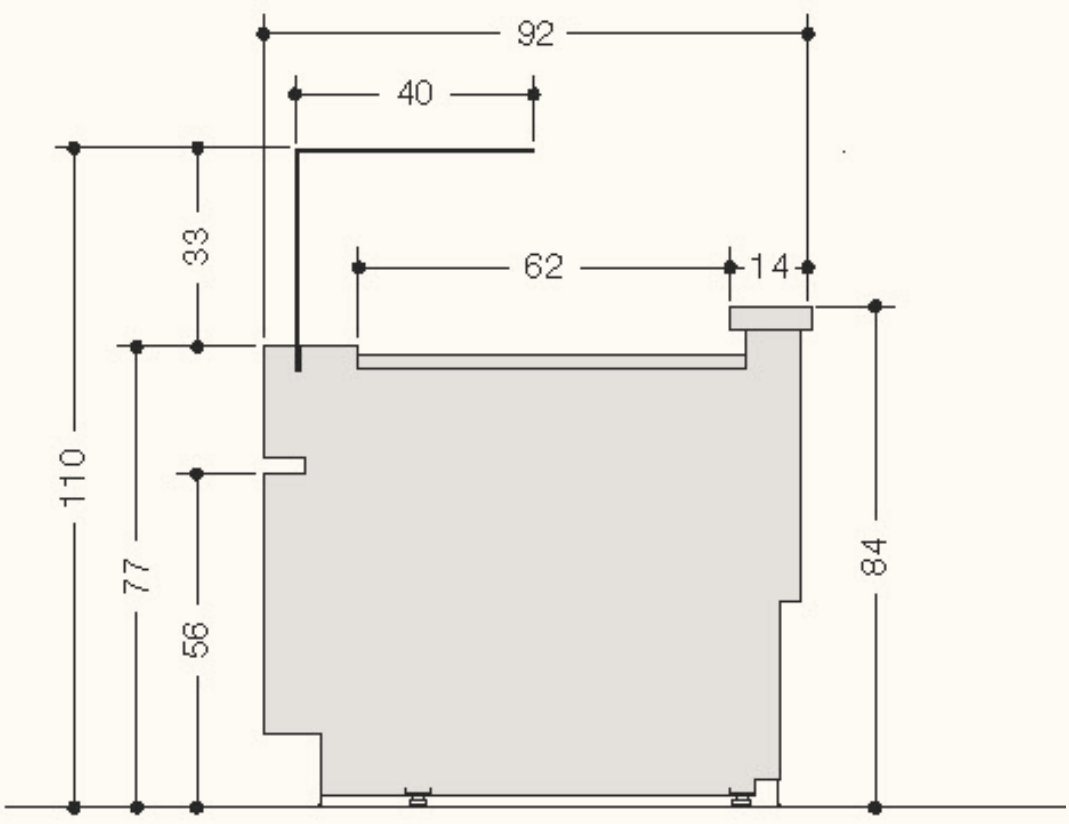

ES 350

**PASTRY CASE**

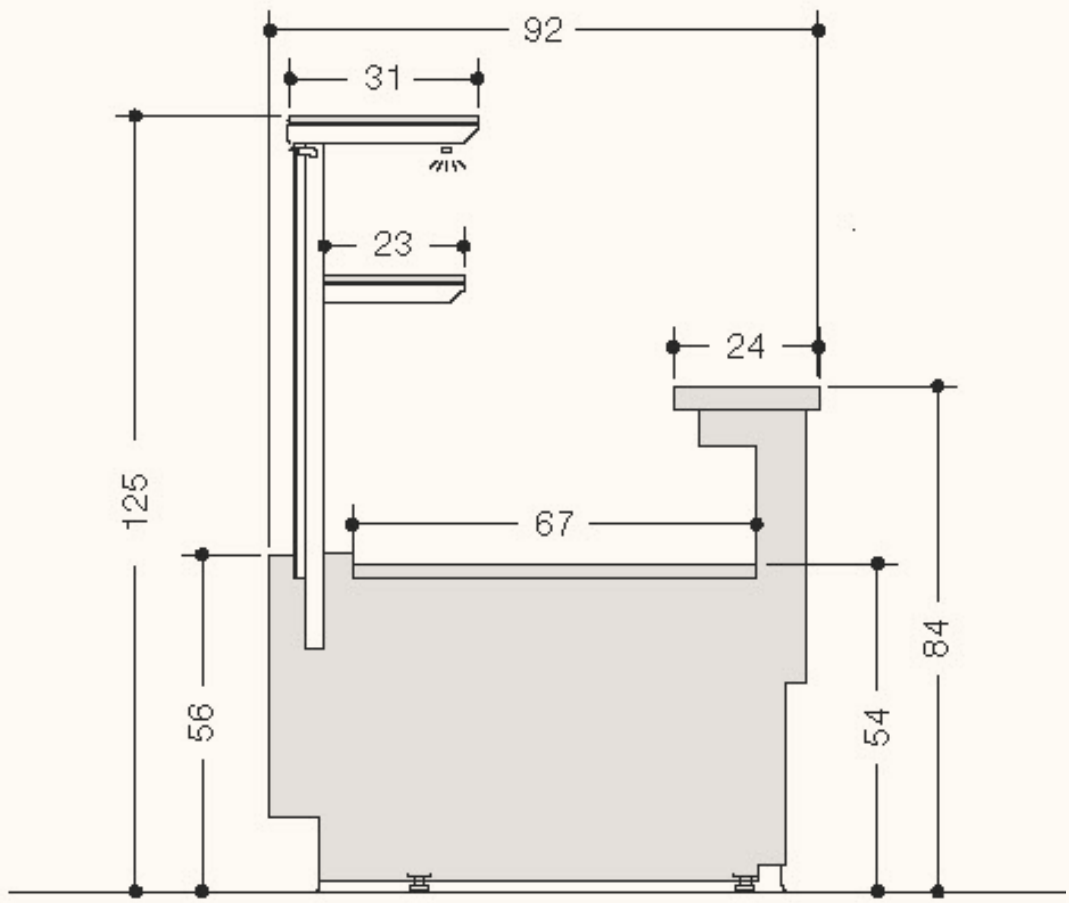

ES 200

**CROISSANT & SANDWICH / TARTES**



## 2 | *Cabinetry*

Cabinetry updates to accommodate new cases, improve employee workflow, open up the view to our production area and show more freshly baked goods on racks.

### UPDATE INCLUDES

- Beech wood stained 'Nutella' balances a French feel while feeling familiar
- Fluting on cabinetry reminiscent of wainscoting but easier to maintain



**BEECH WITH CUSTOM  
STAIN 'NUTELLA'**

PRODUCED BY ARCHITECTURAL CABINETS | ARLINGTON, WA



*Before: Red tones with simple shaker lines.  
Significant repairs needed in various places*

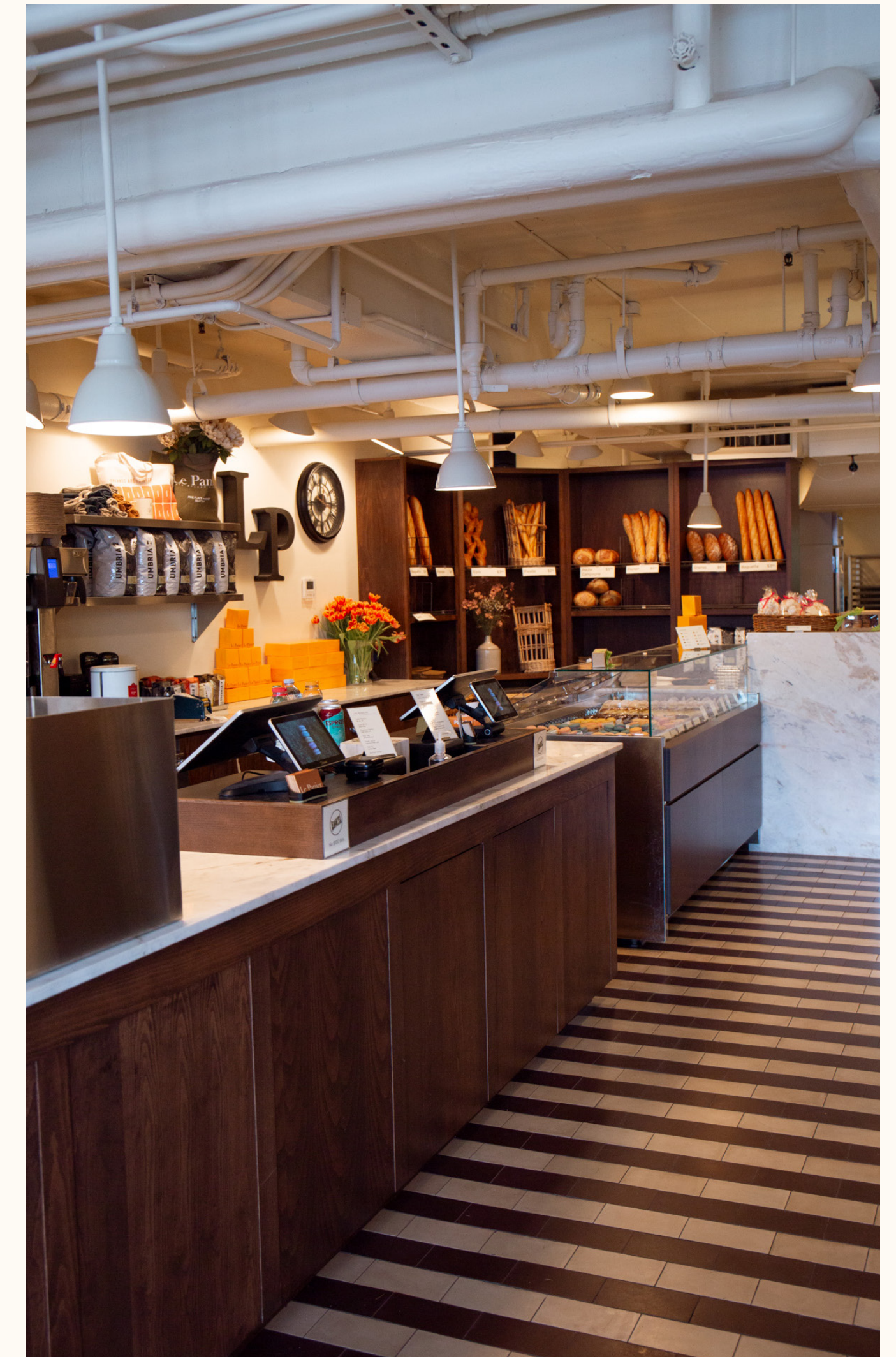

*After: Using warm browns and keeping simplicity  
of line and coordinating with case fronts*





*Before: Floating bread wall served as backdrop for pastry case but blocked view into production area*



*After: Shifting the bread wall over opened up view into production area (see next slide)*

## 2 | CABINETRY

# Bread Wall

- Opens up view to production area to emphasize ‘scratch-bakery’ (see images on next slide)
- Made of solid wood for easier maintenance, matching the new cabinetry
- Proportions are same as previous bread wall
- Reuse of original metal bread racks



**BEECH WITH CUSTOM STAIN ‘NUTELLA’**





*Before: Bread wall blocks view to production area, only oven is visible*

**LE PANIER**



*After: Oven and view into the production area allows customers to see into the action*

**1902 PIKE PLACE**

**BAKERY REMODEL**

**MAY 2025**





*Before: Built-in tray slots with a rolling cart  
hiding visible hand sink*



*After: Full racks roll into updated built-in*

## 2 | CABINETRY

# Croissant Rack Slots

- Showing more behind the scenes, we designed this cabinet to accommodate full racks of croissant which saves time for both bakers and sales staff during our busy season
- Pre-existing aluminum rolling racks roll right in to the cabinetry
- We moved the previous hand sink just behind this wall
- Added packaging storage for easier access



**BEECH WITH CUSTOM  
STAIN 'NUTELLA'**





*Before: POS had just over 12" of space for customer plates, boxes, bags etc.*



*After: Expanded customer counter makes ringing up large orders much easier*

## 2 | CABINETRY

# Point of Sale

- Similar layout, material use and function as the previous cabinet
- Slightly expanded customer counter
- Increased functionality when serving freshly brewed coffee
- Tip jar hole/drawer prevents theft



**BEECH WITH CUSTOM STAIN 'NUTELLA'**





*Before: Employees turned away from customer to get drip coffee and often bumped working barista*



*After: Employee moves parallel with customer and serves drip coffee without disturbing barista*





*Before: Great functionality, we knew we wanted to keep*



*After: New drawer fronts to match new stain, reusing same handles*

## 2 | CABINETRY

# Drawers

- Keep drawers but replace drawer fronts and make repairs where needed
- Reuse of previous drawer handles



**BEECH WITH CUSTOM STAIN 'NUTELLA'**





*Before: Espresso machine is customers final stop but with full view into sink and bus bins*



*After: Nicer view for our customers while waiting for their coffee*

## 2 | CABINETRY

# Espresso Bar

- New placement shifted to account for pastry display and new cases
- French-inspired fluting is reminiscent of wainscoting
- Curved bar allows for better customer traffic flow
- Barista working area is more efficient
- Improved view from the street (vs. straight into dishwasher / sink)
- New hand sink added to follow Health Department Guidelines



**BEECH WITH CUSTOM STAIN 'NUTELLA'**





*Before: Stairs at both entrance and exit had railings etc. but proved to be a chaotic*



*After: Beautiful entry and a smooth transition to handrails for ramp*

## 2 | CABINETRY

# Entry Cabinet

- To create a more gracious entrance
- To accommodate both the new ramp railing and relocated bus station wall surround
- Adds a chance for seasonal delight with fresh flowers and the daily newspapers.
- Use of marble and wood creates cohesion



**CALACATTA MARBLE  
CAPIXABA 2 CM  
POLISHED**

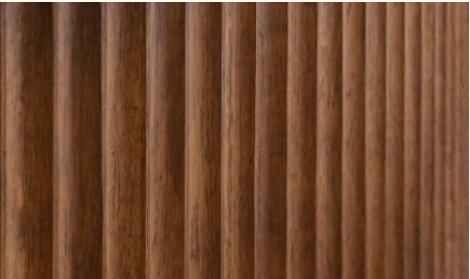

**FLUTING TO MATCH  
ESPRESSO BAR**





*Before: Customers would often not know where to drop dishes and garbage*



*After: New spot makes it visible as customers leave with dish drop and waste more obvious*

## 2 | CABINETRY

# Waste Station

- New location for easy dish drop for customers on their way out
- Baguette tile surround for easy cleaning
- New stainless bin with clear labels



**1X6 GLOSSY COCONUT  
STRAIGHT JOINT HAND CRAFTED  
ARTCRAFTED LINE FROM DAL TILE**





*Before: Created a traffic jam at times and not entirely obvious*



*After: Easy access to grab water while waiting for coffee*

**2 | CABINETRY**

# Self-Service Water

- Improved placement for easier access by all customers
- Minimal cabinet pulls



**BEECH WITH CUSTOM STAIN 'NUTELLA'**



**BARRINGTON CABINET EDGE PULL 4" OIL RUBBED BRONZE REJUVENATION**





*Before: Not in the normal pathway of customers grabbing coffee to go, they had to backtrack a bit*



*After: Easy stop on the way out the door for lids, cream etc. or on their way to seating areas*

## 2 | CABINETRY

# Condiment bar

- More central placement for easy access after picking up coffee or baked goods
- Central between each seating area



**BEECH WITH CUSTOM STAIN 'NUTELLA'**



**BARRINGTON CABINET EDGE PULL 4" OIL RUBBED BRONZE REJUVENATION**



# 3 | Countertops

## UPDATE INCLUDES

Keeping our material use of stainless and marble for our countertops.

## Stainless Steel

- Similar to previous, the use of stainless steel at espresso area is vital
- 16 gauge
- We chose to extend the use to the dish sink as well for durability



16 GAUGE  
STAINLESS STEEL

PRODUCED BY BALLARD SHEET METAL | BALLARD, WA



*Before: Espresso bar had stainless steel but dish area was marble which was not durable enough for this use*

LE PANIER

1902 PIKE PLACE

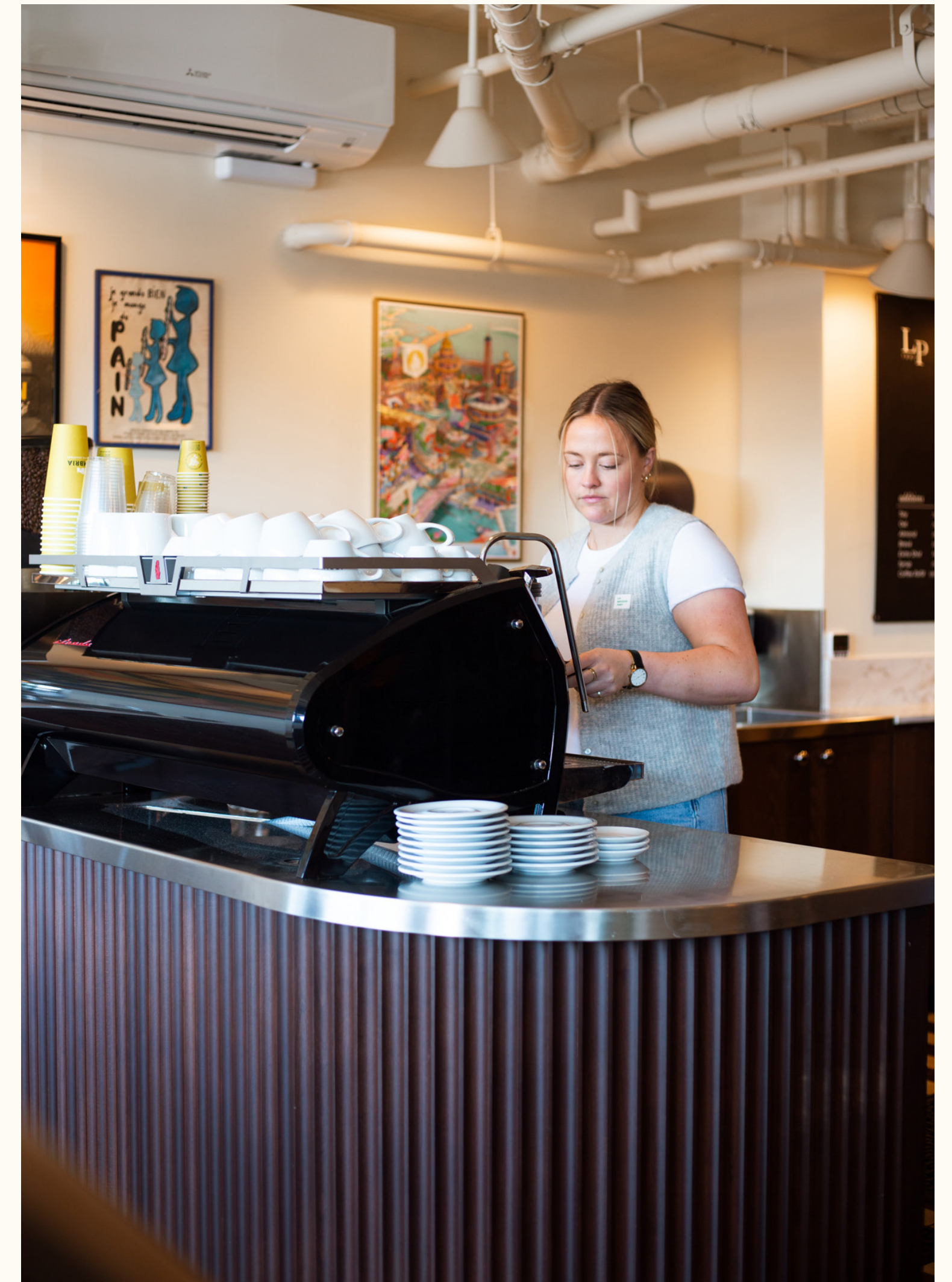

*After: Stainless extended to dish area for easy cleanup and longevity*

BAKERY REMODEL

MAY 2025





*Before: Multiple types of marble ranging from clay red to light brown with white streaks*



*After: Warm yet bright feeling marble*

### 3 | COUNTERTOPS

## Marble

- Creamy with hints of brown and warm tones, replaced previous marble because of significant wear and tear
- Use of marble keeps the French feel
- New accents added at front entry as well as a new waterfall design element between the two display cases



**CALACATTA MARBLE  
CAPIXABA 2 CM  
POLISHED**

INSTALL BY THE HAUS GRANITE CO. | ARLINGTON, WA



## 4 | *Ramp & Railings*

Not many people knew we were ADA accessible through our back door. We wanted to make it easier for those who can't maneuver stairs.

Upon completion we found a surprise result. People now have time to look as they come down the ramp and not just "be in line." The welcome and view for our customer is significantly better.

*Dimensions and railings follow Commercial Ramp Code (see next slide).*

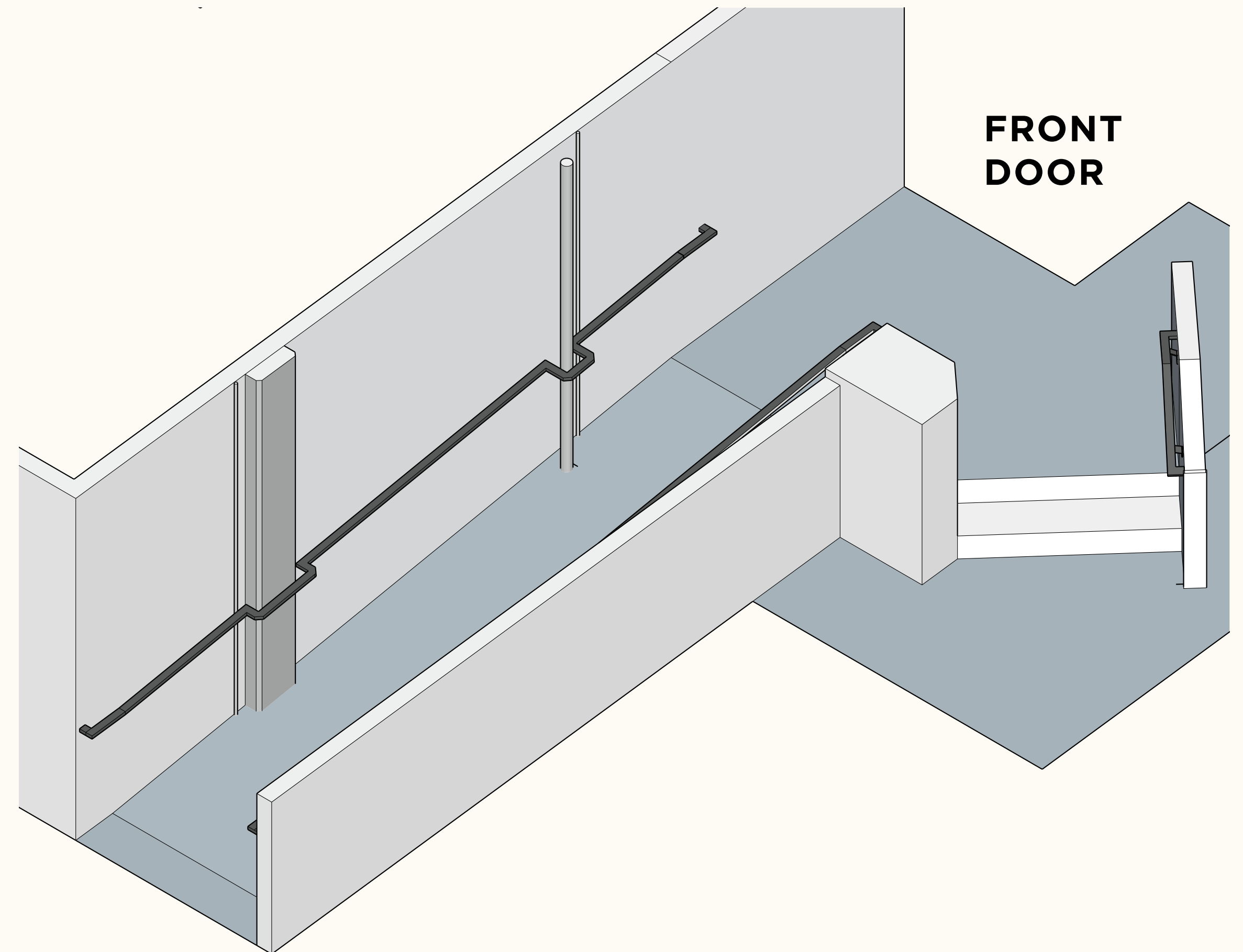



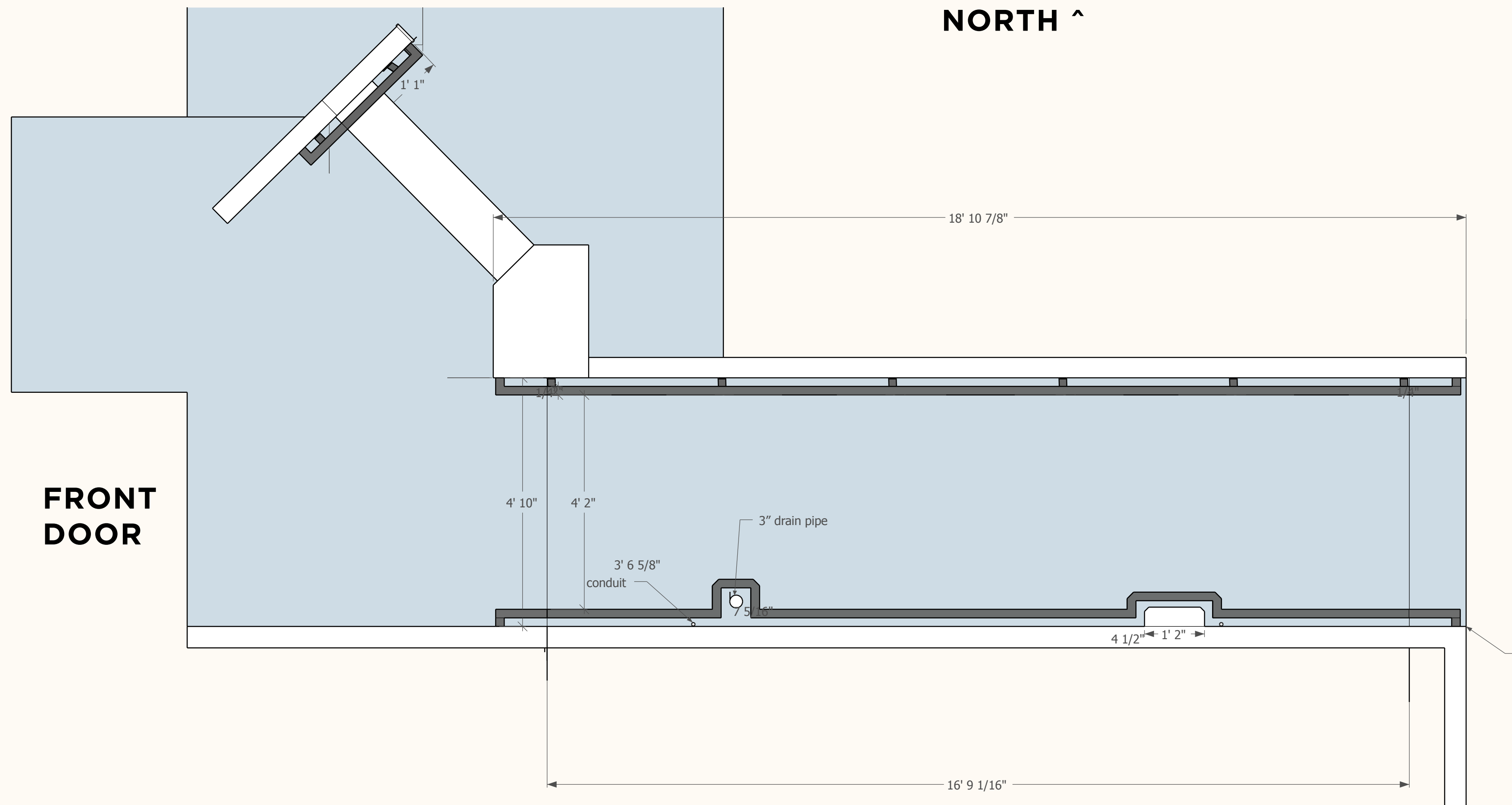

## RAMP DIMENSIONS

- **Wall to Wall:** 4' 10" (58")  
*Code requires: 48" min*
- **Between Railings:** 4' 2" (50")
- **Railing Width:** 2"  
*Code Requires: 1 1/4" - 2"*
- **Slope:** 7.2% (Rise: 1' 2 5/8"  
Run: 16' 9 1/16")  
*Code requires: 8.5% slope max*
- **Landing:** 80+ inches of level floor available  
*Code requires: 60"*

Followed ADA Guidelines here: [www.access-board.gov/ada/guides/chapter-4-ramps-and-curb-ramps/#handrails](http://www.access-board.gov/ada/guides/chapter-4-ramps-and-curb-ramps/#handrails)

Other resources: [app.leg.wa.gov/WAC/default.aspx?cite=246-359-520&pdf=true](http://app.leg.wa.gov/WAC/default.aspx?cite=246-359-520&pdf=true)

[sbcc.wa.gov/sites/default/files/2019-12/18\\_07ibc\\_ansi.pdf](http://sbcc.wa.gov/sites/default/files/2019-12/18_07ibc_ansi.pdf)



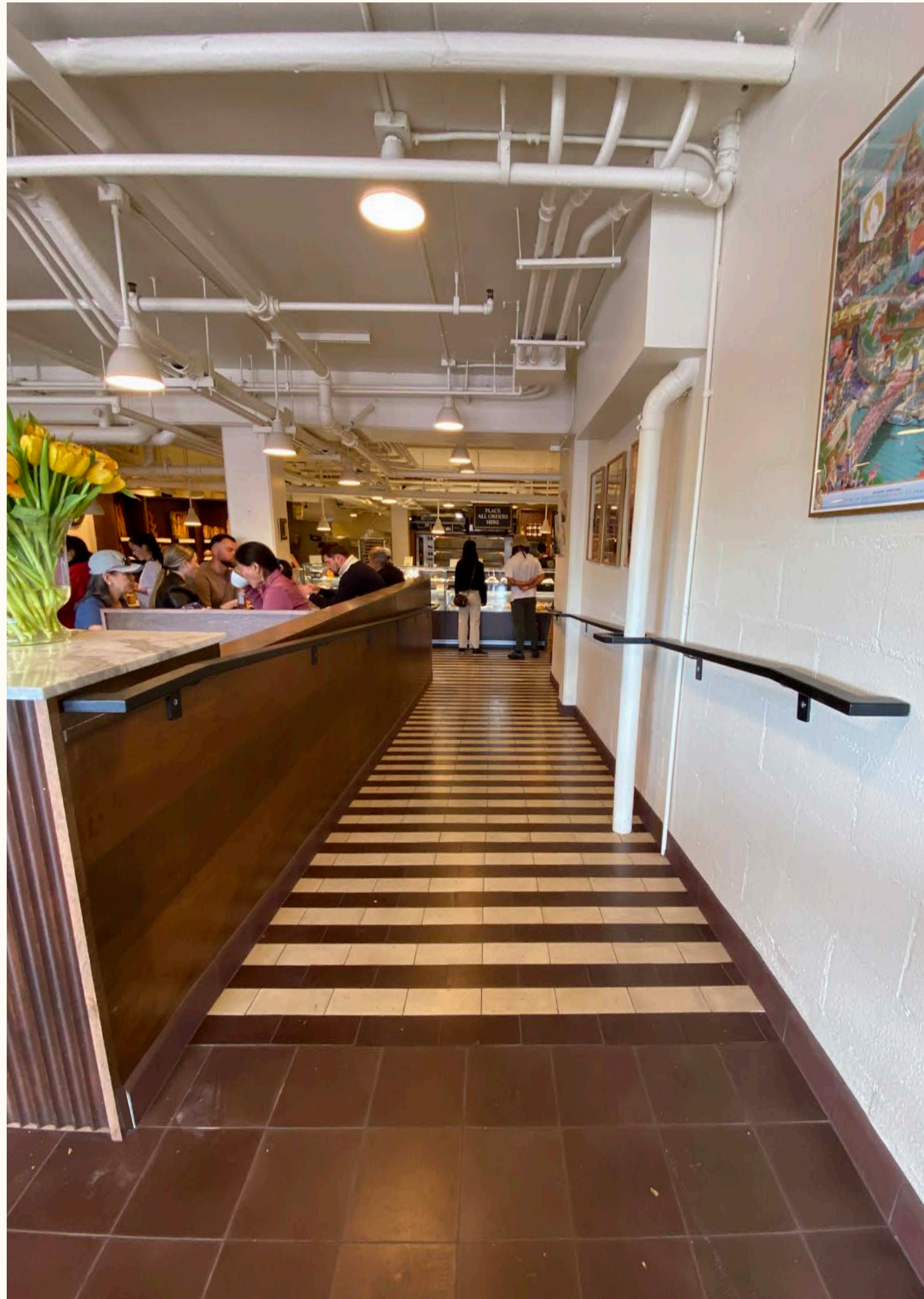

*Railing lines both edges of the ramp*



*Close-up of railing end turning into wall*

## RAILING DIMENSIONS

- **Railing Width: 2"**  
*Code Requires: 1 1/4" - 2"*
- *All ends turn 90° to end in wall.*
- **Railing Distance from Wall: 2"**  
*Code Requires: 1 1/2" min*



# 5 | *Customer Seating*

With the addition of the ramp, we needed a new solution for our center seating area. We opted for a bench seat, as well as new ADA seating while leaving the front window seating as is.

## UPDATE INCLUDES

- Same amount of seats (approx. 15+)
- New French marble tables with copper edges made in Nantes, FR
- New bench seating made using previous table top as the seat
- ADA seating added
- Front window seating remains the same

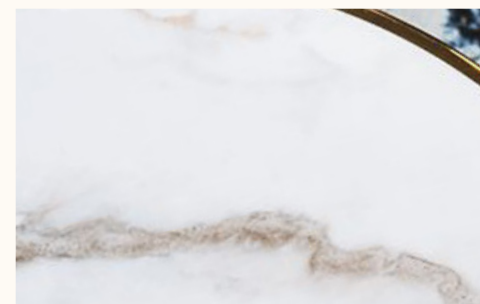

**MARBLE TABLES WITH COPPER  
EDGE & BLACK BASE  
ARDAMEZ**

TABLES MADE BY ARDAMEZ | NANTES, FR



*Before: Wood topped tables with black steel bases*

LE PANIER

1902 PIKE PLACE



*After: Marble topped tables, copper accent with black steel bases add to French feel*

BAKERY REMODEL

MAY 2025





*Before: Long wood table provided flexible seating for customers*



*After: Bench seating keeps flexibility and is a new customer favorite*

LE PANIER

1902 PIKE PLACE

## 5 | CUSTOMER SEATING

### Bench

- Creates a divider between ramp and seating
- Re-purposed table top as bench seat
- With bar-height seating, we added a foot-rest on the bench for comfort
- See dimensions on following page
- Flexible sit/stand option so groups can use the area and bench as they like
- Bolt-down marble tables
- Round Table: 23.6" D x 27.95" H



**MODEL 102 OIL RUBBED BRONZE BAR BRACKET**



**BEECH WITH CUSTOM STAIN 'NUTELLA'**

FOOT RAILING BY ESP METAL PRODUCTS & CRAFTS | BOHEMIA, NY

BAKERY REMODEL

MAY 2025



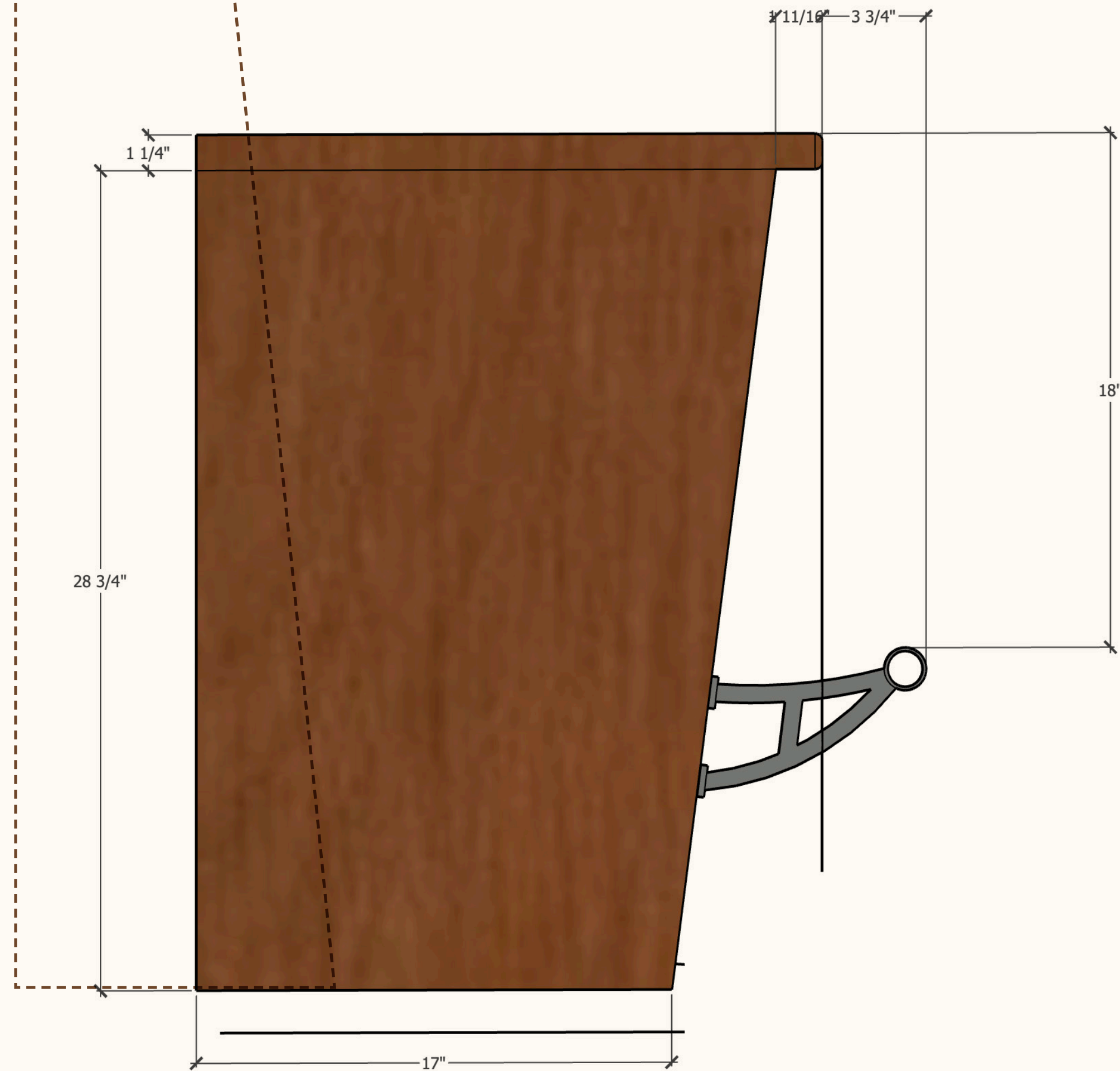

## 5 | CUSTOMER SEATING

### Bench, cont.

- Foot rest is 18" below seat, 8" from lower bench wall and runs full length of the bench (about 12')

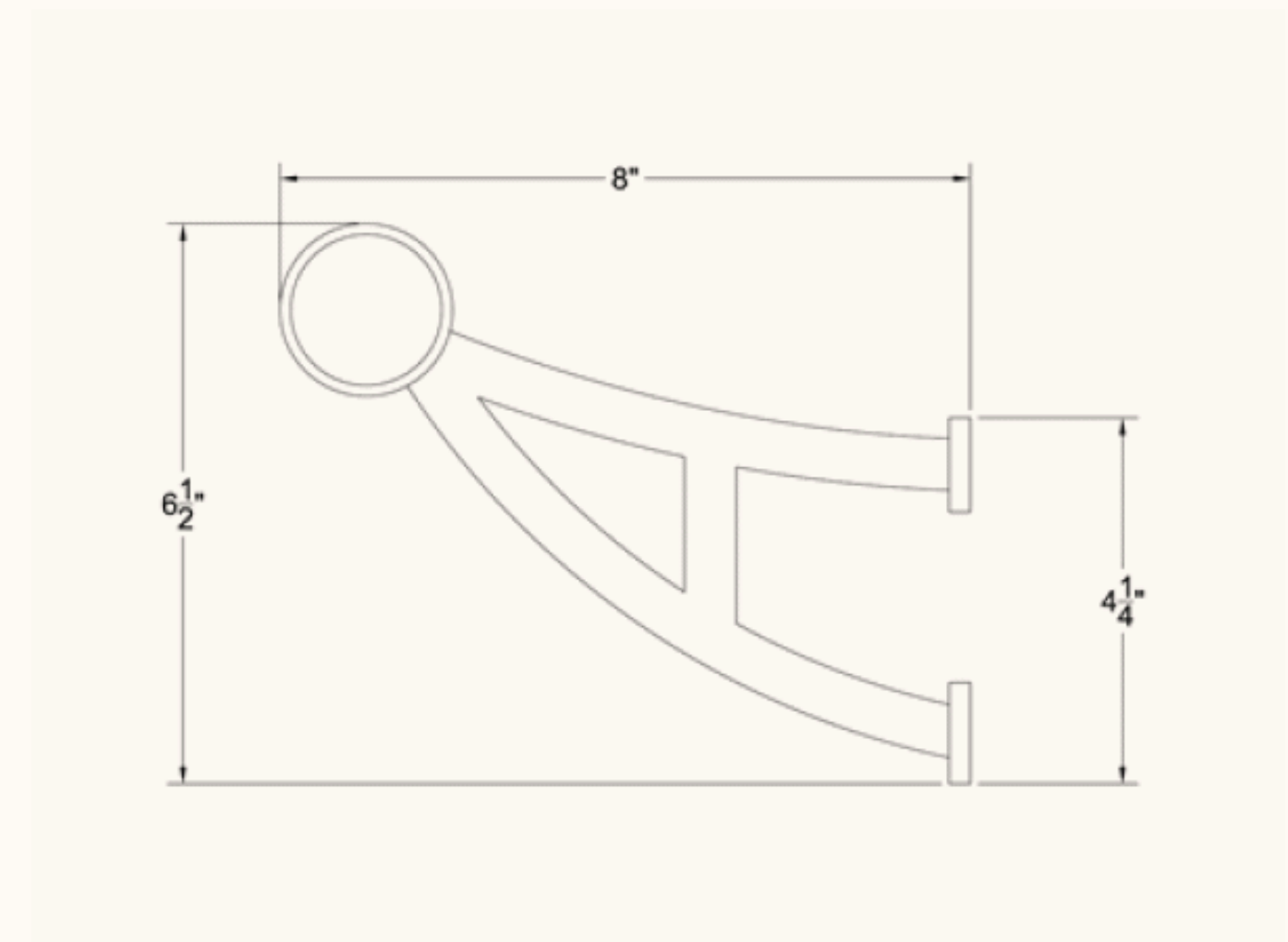





## 5 | CUSTOMER SEATING

### ADA Seating

- New table and move-able chairs for ADA seating where we didn't have any before
- Table: 23.6" D x 27.9" H
- About 5% of seating is ADA (15+ seats total, 2+ of those seats are ADA)
- Classic Thonet bentwood chairs

*After: With the addition of the ramp, we felt it was important to provide ADA seating as well*

TABLES MADE BY ARDAMEZ | NANTES, FR





*Before: Window seating a customer favorite*



*After: Window seating remains a customer favorite*

## 5 | CUSTOMER SEATING

### Front Window

- Remains the same with original wood top and metal base
- Fleur de lis accent remains facing the street





# 6 | *Retail Floor*

The original floor is no longer produced and was worn through to concrete below in some spots. We opted to seal the old asbestos tile (VAT) with a membrane and apply striped concrete tile, inspired by our original floors and French awnings. This update only applies to retail area floor.

## UPDATE INCLUDES

- Cement Tile in Beige and Cinnamon
- Original VAT tile remains in production area and we are using the updated VCT to patch
- New stair tread schluter with non-slip grip built in as additional safety feature on the stairs (see next slide)



BEIGE + CINNAMON 4X8  
CEMENT TILE LILI TILE



CINNAMON 8X8  
CEMENT TILE LILI TILE

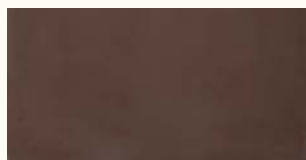

CINNAMON 4X8 BULL NOSE  
CEMENT TILE LILI TILE

INSTALLED BY NW STONECRAFT, INC.



*Before: Significant wear and tear throughout the retail area*

**3.4.2 Interior Finishes** c) Floor coverings should be utilitarian and easily cleaned. For example, wood, ceramic tile, linoleum, vinyl, concrete and asphalt composition materials are acceptable.

**3.2.11** Floors in public areas should have continuity of material and color.





*Before: Stripes created visual interest on the floor.  
Non-slip tape used on steps*



*After: Concrete tile continues look and feel of stripes  
while maintaining market standard for real materials*



*After: Stair schluter with non-slip grip. Coir mats  
remain the same*



# 7 | *Paint & Walls*

Aiming for a light and bright yet warm interior, we went for cream walls while keeping our classic deep red. We decided to remove the wainscoting for practical reasons.

## UPDATE INCLUDES

- Cream walls to keep warmth
- Using classic deep red at the front windows - extending it from the doors
- Wainscoting removed due to upkeep & the need for rodent prevention barriers



OC-33 OPALINE  
BENJAMIN MOORE  
MATCH TO SW

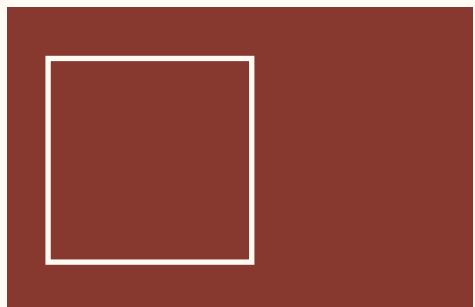

LP ORIGINAL  
CUSTOM MATCH  
SHERWIN WILLIAMS



6727 TALIPOT PALM  
SHERWIN WILLIAMS

PAINTED BY PSPC, LLC | MILL CREEK, WA



*Before: Apricot walls with worn wainscoting*

**3.4.2 Interior Finishes** (a) Ceilings and walls should be light in color



*After: Cream colored walls with accent of deep red for extra warmth and character*





*Before: Door in need of painting*



*After: Fresh coat of Talipot Palm on exterior,  
LP red on door interior (back doors not pictured)*

## 7 | PAINT & WALLS

### Doors

We also repainted front doors and rear hallway door with market specified green and our classic deep red.

- Deep Red: LP Original
- Green: Market-specified Sherwin Williams 6727 Talipot Palm



**6727 TALIPOT PALM  
SHERWIN WILLIAMS**

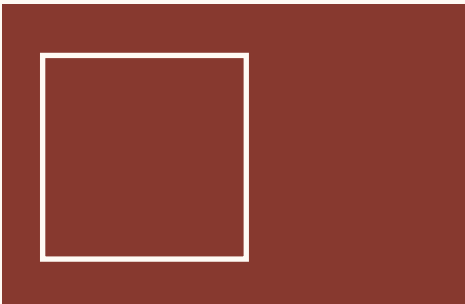

**LP ORIGINAL  
CUSTOM MATCH  
SHERWIN WILLIAMS**



# 8 | *Lighting*

## UPDATE INCLUDES

- Classic original shades used - keeping with historic use also seen throughout the market
- We had them cleaned up and powder coated for durability
- Updated bulbs from fluorescent to warm LED's with similar warmth of Incandescent bulbs
- New bulbs are: 2700K | 1100 Lumens

**3.5 Lighting | 3.5.1** Incandescent lighting has been traditionally used in the Market, and reinforces the historically warm qualities of the buildings. (...) New lighting designs should approximate the warmth and quality of historical lighting in the Market.



*Before: Original light shades with fluorescent light bulbs*

LE PANIER

1902 PIKE PLACE



*After: Repainted light shades with Incandescent-feel LED bulbs*

BAKERY REMODEL

MAY 2025



APRIL 2025

*A before & after*



BEFORE



LE PANIER

1902 PIKE PLACE

BAKERY REMODEL

MAY 2025



AFTER



LE PANIER



1902 PIKE PLACE

BAKERY REMODEL



MAY 2025



COMING SOON

*Still in the works*



## GALLERY WALL

(Inspiration photo above) We are planning to display our original French bakery posters and antique French artworks as well as art by Teri Capp for even more of the ‘French feel.’



*Thank you*