

DRAFT Residential Small Lot (RSL) Proposed Tree Requirement

26% Canopy Coverage

1 point per 750 ft² of lot size

Shown here

5,000 ft² lot

Average of 6.7 points needed to achieve 26% canopy coverage

Assumes Medium-Large trees in the ROW

Includes 1,250 ft² of ROW in 26% coverage calculation

ROW trees do not count toward point score

1 point	2 points	3 points	4 points	1 point per inch of trunk diameter 6" or more	N/A
Small 8-15' canopy spread*	Small-Medium 16-20' canopy spread*	Medium-Large 21-25' canopy spread*	Large 26-30' canopy spread*	Preserved Existing Assumes 7" diameter trunk	Street Tree Assumes Medium-Large*
10.5' shown	18' shown	23' shown	28' shown	28' shown	23' shown

*Assumed canopy spread at 25 years

Tandem Housing

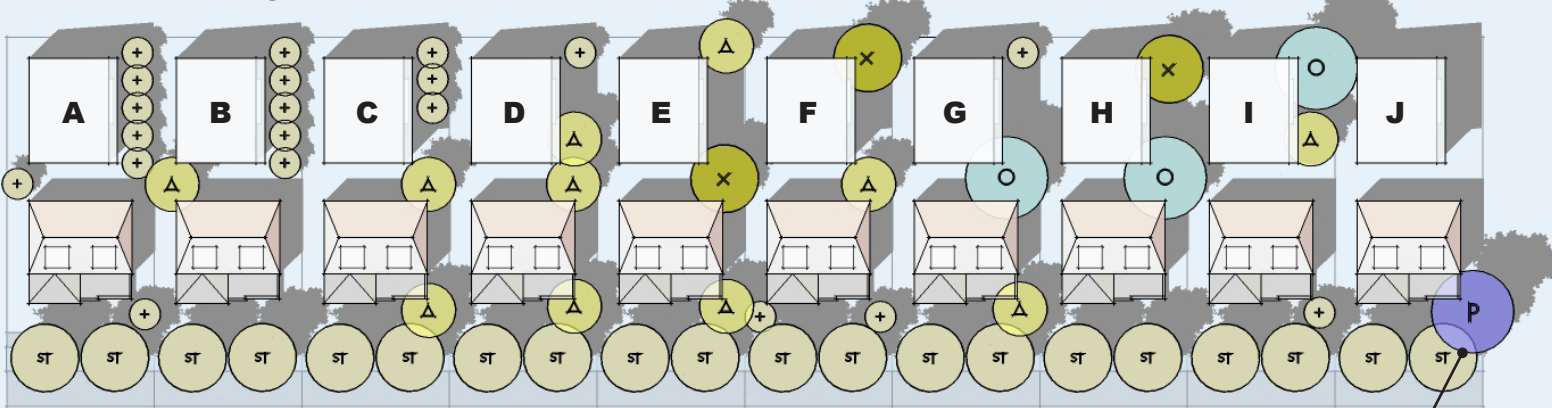

Note that preserving one existing tree with 7" diameter or more satisfies entire point requirement, as shown here

Stacked Flats

