

IMPROVING OUR COMMUNITIES with Natural Drainage Systems (NDS) and Pedestrian Improvements

What are Natural Drainage Systems?

When it rains in the Delridge and Westwood neighborhoods, pollution from our streets runs into Longfellow Creek untreated. This is not healthy for the creek or for people. **The good news is: there is something we can do.**

Natural Drainage Systems consist of shallow depressions built in the roadway shoulder (the space between the street edge and the property line) and are filled with deep-rooted plants and spongy soils that temporarily hold and clean polluted stormwater from streets. These features capture and clean pollutants before they can reach Longfellow Creek.



Seattle Public Utilities (SPU) is planning to build natural drainage systems in your neighborhood in 2021. We are partnering with Seattle Department of Transportation (SDOT), Office of Arts & Culture 1% for the arts, and King County Flood Control District.



Community benefits

Natural Drainage Systems offer multiple benefits to local neighborhoods and ecosystems, including:

- Increased landscaping
- Lower risk of flooding
- Creation of habitat along our streets
- Healthier creek ecosystems
- Traffic calming
- More street trees
- Pedestrian improvements



Seattle Public Utilities

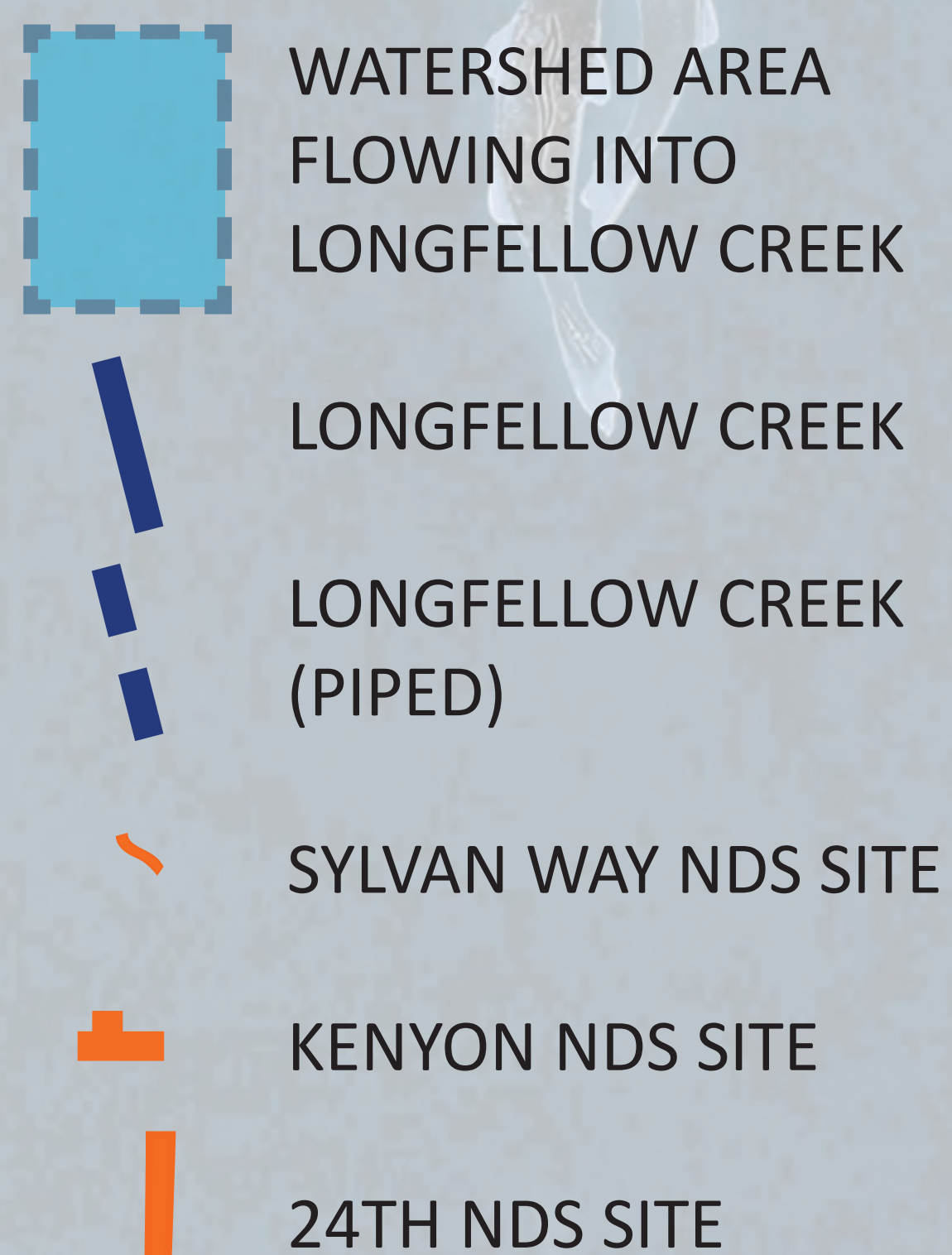

N

WHERE WE ARE NOW

...and where we're going

We are working to finalize the design for the **Longfellow Creek NDS project**. Construction on this multisite project is scheduled to begin in mid-2021 and go through 2022.

See below for estimated construction timeline for each project site.

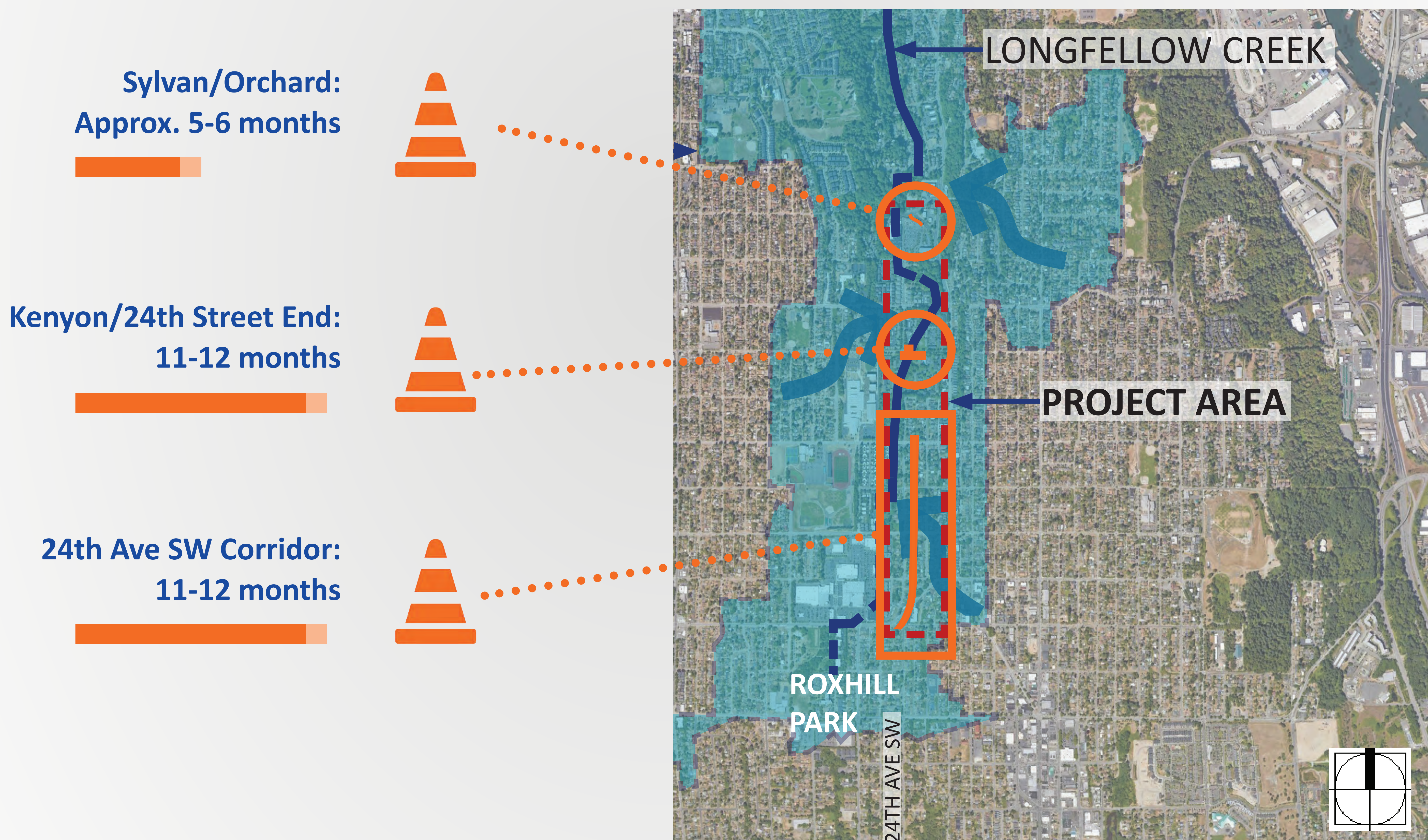

In general, when work is occurring near your home you can expect construction noise, dirt/dust, and vibrations as well as increased construction traffic and materials/equipment staged in the right-of-way. We will share more information about anticipated start date for work on this site, construction schedule, and anticipated construction impacts once we have a contractor onboard.

WHAT TO EXPECT

How a typical NDS planting installation **changes over time**



BEFORE



NEWLY PLANTED

~1 year



GROWING

~5 years



MATURE



City of Seattle

The Levy to
MOVE SEATTLE

 **KING COUNTY
FLOOD CONTROL
DISTRICT**

DECEMBER 2020
LATE DESIGN PHASE

LONGFELLOW CREEK PATH

Potential NDS and Pathway Improvements SW Kenyon St and 24th Ave SW

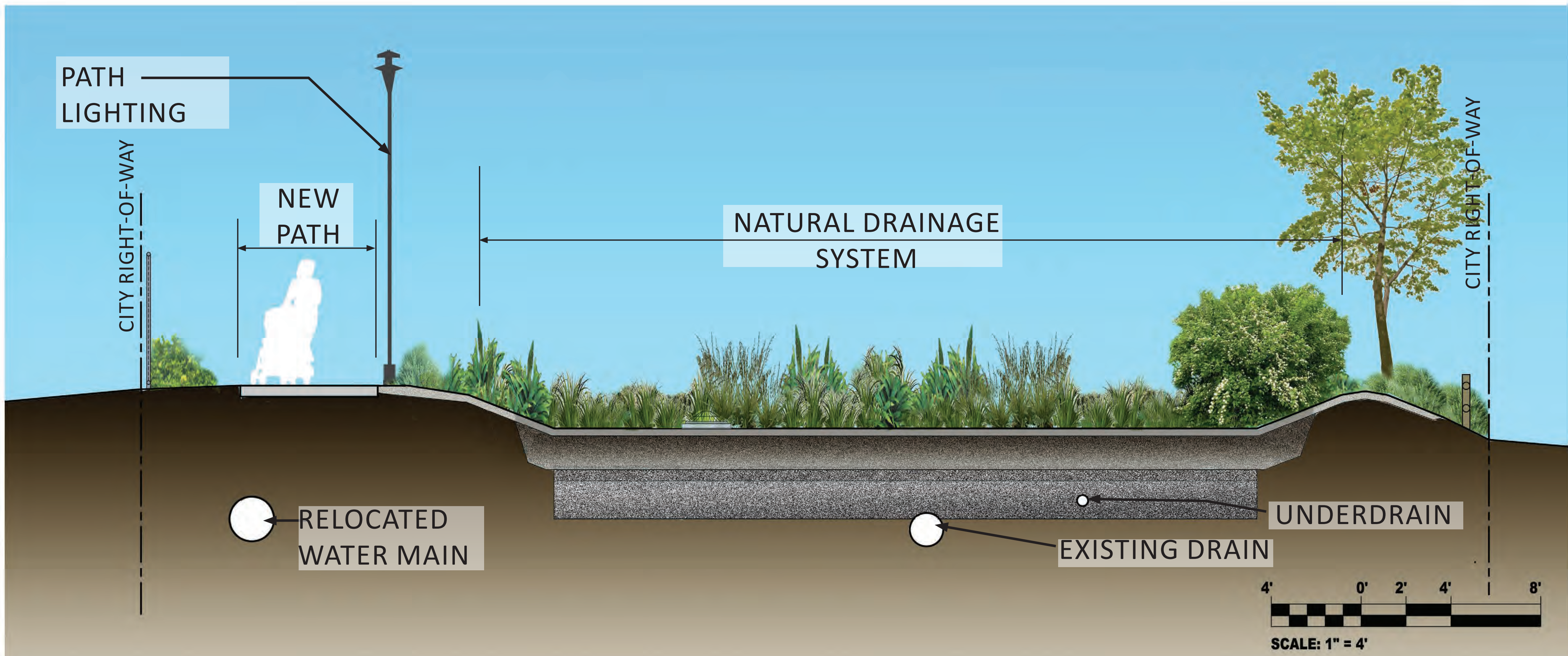

KEY

- | | | | | |
|-------------------------------|---------------------------------|---------------------|--------------------------------|----------|
| NEW SIDEWALK, IMPROVED PATH | BOARDWALK | PEDESTRIAN LIGHTING | NEW SHRUB PLANTING AREA | NEW TREE |
| NATURAL DRAINAGE SYSTEM (NDS) | PLANTING STRIP/LAWN RESTORATION | EXISTING SIDEWALK | NEW WOODEN POST AND RAIL FENCE | |

LONGFELLOW CREEK PATH

VIEW LOOKING WEST



VIEW LOOKING EAST



City of Seattle



**KING COUNTY
FLOOD CONTROL
DISTRICT**

**DECEMBER 2020
LATE DESIGN PHASE**

BOARDWALK DESIGN

for East side of 24th Ave SW & SW Kenyon St

SPU and SDOT are considering safety and environmental impacts when designing the boardwalk on the east side of the 24th & Kenyon site.

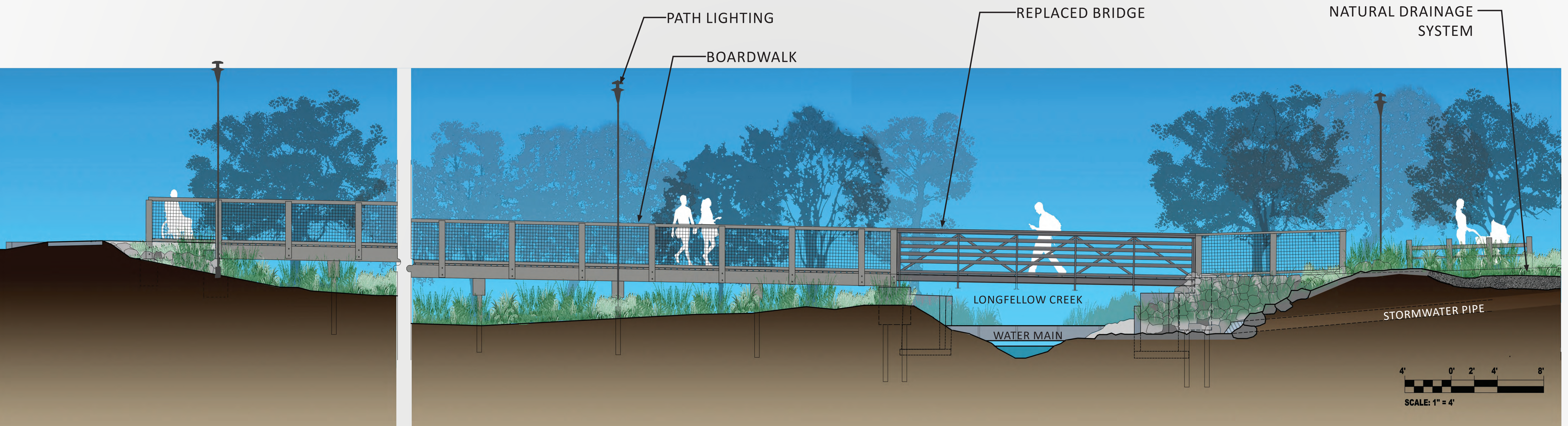

PROPOSED VIEW

ART CONCEPTS

for 24th Ave SW & SW Kenyon St

The artist's goals are to make this place interesting for the community to visit and for the art to offer something unexpected, thought-provoking, and perhaps a little magical.

This site is where life forces are nourished by the creek, where neighbors can connect with each other while they pass through, and where community can experience the natural world and its often unseen processes.

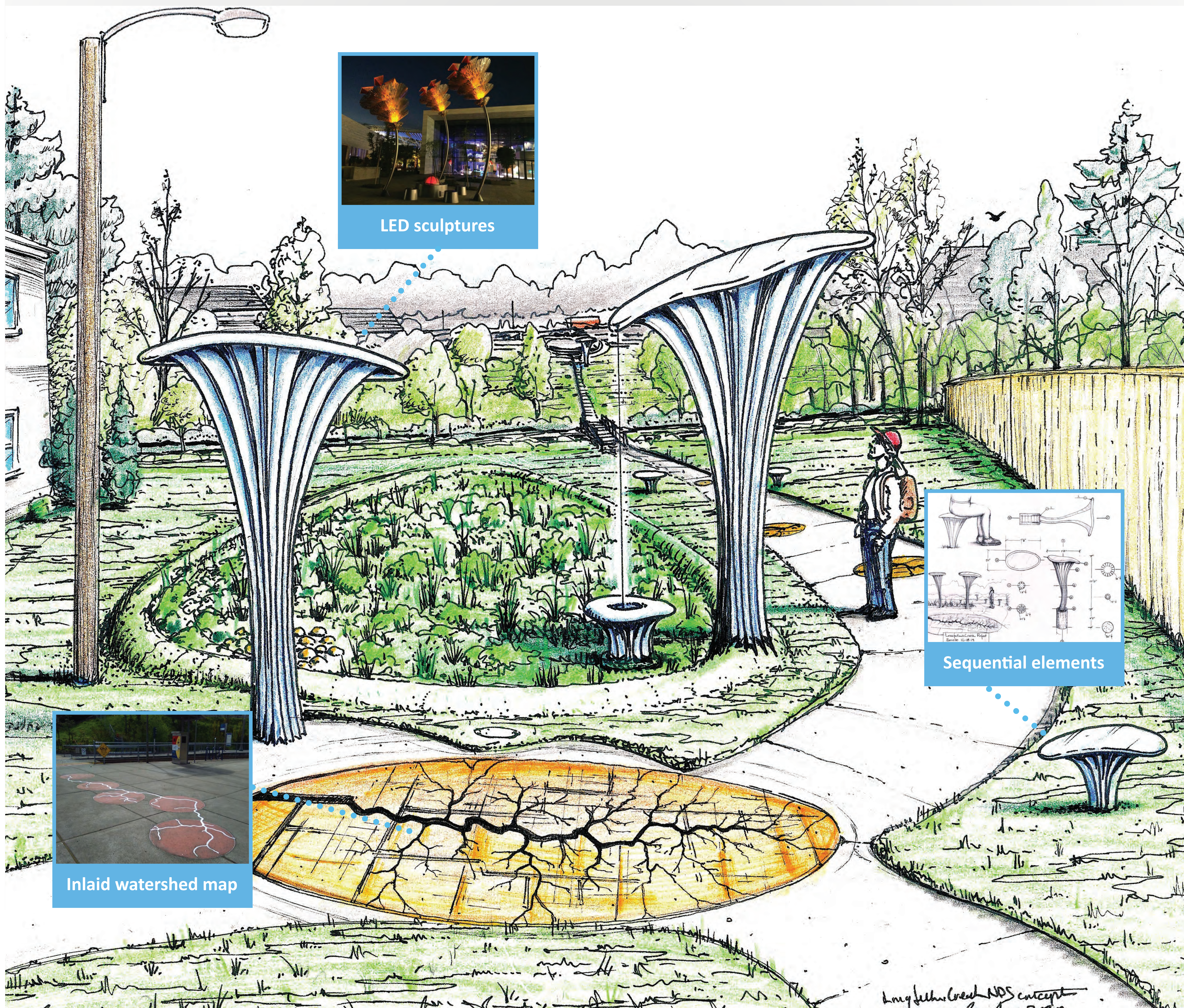

City of Seattle



**DECEMBER 2020
LATE DESIGN PHASE**