

# PLAY STREETS | 第二選項: 部份街區

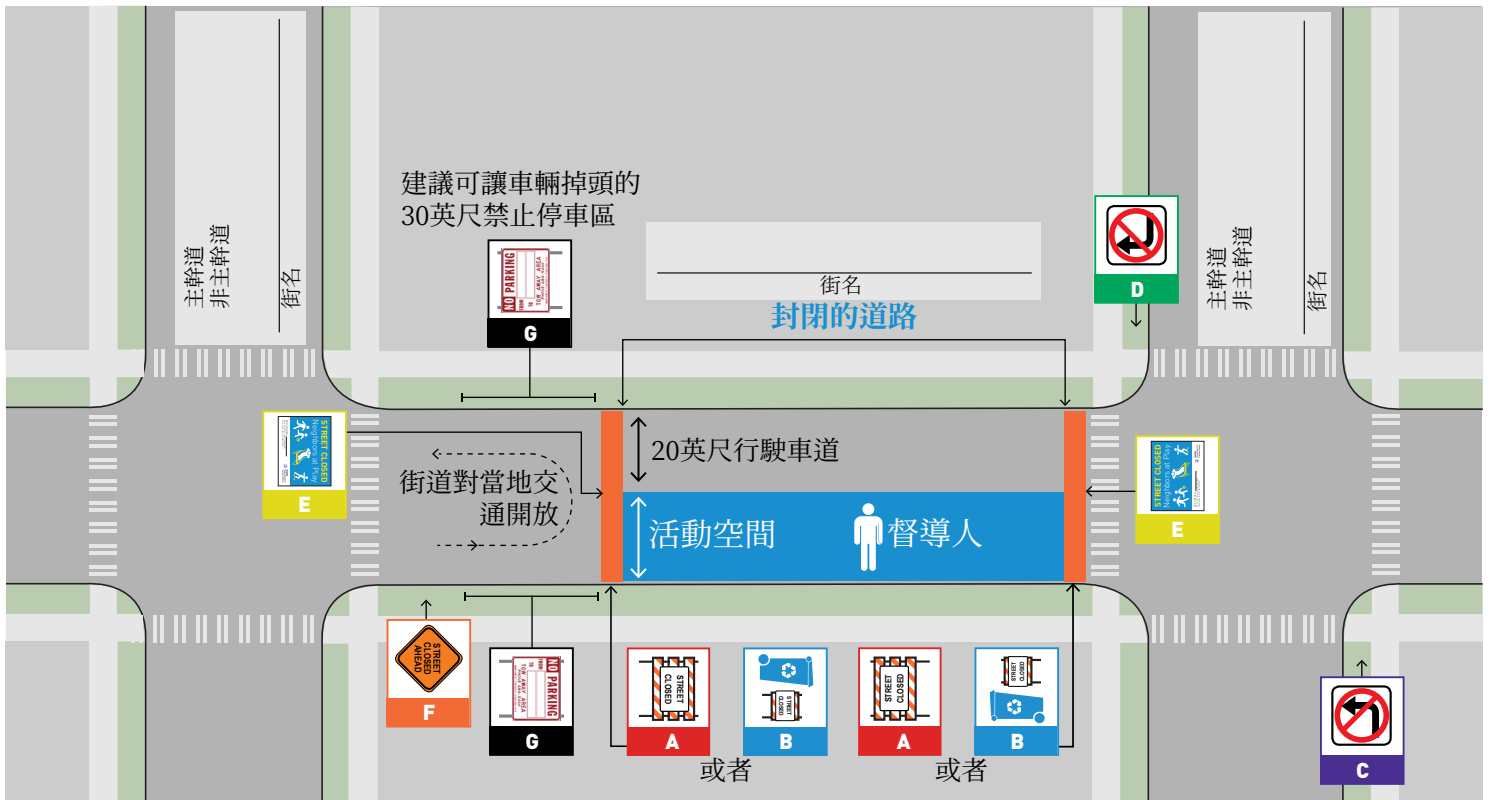

### 主幹道交叉路口的必要交通管制

4 ft min.  
可變寬度

5 ft min.

STREET CLOSED  
R11-2  
3 ft x 2 ft

Type III Barricade

**A**

Diagram showing a Type III Barricade with a minimum height of 5 feet and a minimum width of 4 feet. It is used at main road intersections. A "STREET CLOSED" sign (R11-2, 3 ft x 2 ft) is placed to the right of the barricade.

### 非主幹道交叉路口的必要交通管制

2 ft min.

3 ft min.

STREET CLOSED  
R11-2  
3 ft x 2 ft

Type II Barricade

**B**

Diagram showing a Type II Barricade with a minimum height of 3 feet and a minimum width of 2 feet. It is used at non-main road intersections. A "STREET CLOSED" sign (R11-2, 3 ft x 2 ft) is placed to the right of the barricade.

### 無左/右轉標誌

必須用於幫助引導主幹道交叉路口的交通

R3 - 2  
2 ft x 2 ft

R3 - 1  
2 ft x 2 ft

**C** **D**

Diagram showing two signs: "NO LEFT TURN" (R3-2, 2 ft x 2 ft) and "NO RIGHT TURN" (R3-1, 2 ft x 2 ft). They are used to help guide traffic at main road intersections.

### 資訊類標誌

必須放置在街區兩端街道中心的中間

STREET CLOSED

W20 - 3  
30 in - 36 in

**E**

Diagram showing an information sign for "STREET CLOSED" (W20-3, 30 in - 36 in). It includes fields for "From" and "To" dates, "Street Name", and "Phone Number". It is placed in the center of the street at both ends of the closed section.

### 封路前的標誌

主幹道交叉路口的必要交通管制

W20 - 3  
30 in - 36 in

**F**

Diagram showing a "STREET CLOSED AHEAD" sign (W20-3, 30 in - 36 in). It is used to warn of a street closure ahead at a main road intersection.

### 禁止停車標誌

主幹道交叉路口的必要交通管制

R7 - T39  
3 ft x 2 ft

**G**

Diagram showing a "NO PARKING" sign (R7-T39, 3 ft x 2 ft). It includes fields for "FROM" and "TO" dates and "TOW AWAY AREA" information. It is used for necessary traffic control at main road intersections.