

PLAY STREET PROGRAM

EVENT SET-UP REQUIREMENTS

TYPES OF BARRICADES

Barricades are required at both ends of your play street. You have two options:



For Neighborhood Street Intersections:

Use personal trash bins or furniture that are at least 3 feet tall

OR

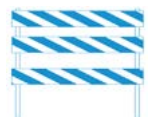

For Arterial Street Intersections:

Rent Type-3 barricades from local providers.

BARRICADE PLACEMENT

Barricades must meet these placement requirements:

- At both ends of the block
- Maximum of 5 feet between each barricade
- Link barricades together with banners, rope, streamers, etc

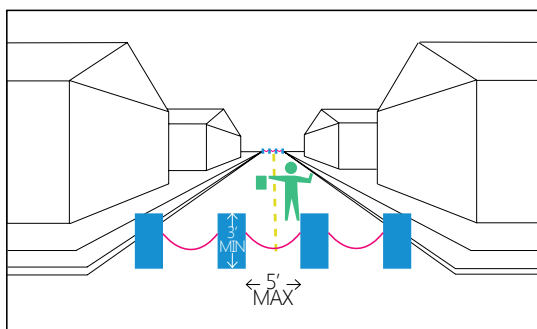

Arterial St.

required: signage
required: Type-3 barricades (on arterial)

required: supervisor at barricade

Any Ave.

required: supervisor at barricade

required: barricades
required: signage

Neighborhood St.

SUPERVISOR

Adult supervision is required for the duration of each play street. At least one adult must remain near each end of the play street so that they can answer questions. These supervisors will be responsible for moving barricades to allow local vehicle access.

SIGNAGE

Signs must be placed at both ends of the block you use for your play street. You may either create your own or use free SDOT-created signs. These can be picked up at the SDOT Street Use counter (700 5th Ave, 23rd Floor).



NO PARKING SIGNS (OPTIONAL)

If you choose to restrict parking for your event, you can arrange to have temporary no parking signs erected 72 hours in advance of your play street. You can rent these signs at your own expense from a barricade company; SDOT will **not** provide this service. No Parking Zone validation can be completed here:



<http://web6.seattle.gov/sdot/nopark/>

To prepare for your play street event, you are required to do the following:

- ✓ Find or rent appropriate barricades
- ✓ Place barricades and signs using placement standards on both ends of block
- ✓ Supervise both ends of the block throughout the entirety of the play street event

More information can be found in the Play Street Handbook at <http://www.seattle.gov/transportation/projects-and-programs/programs/public-space-management-programs/play-streets>

SPECIAL CONDITIONS

If you are hosting a play street event and do not want to occupy your street's entire length from intersection to intersection, you are allowed to shorten it. You are still required to barricade and supervise the two boundaries of the play street area, even when one side is mid-block rather than at an intersection. You are required to place signage at the intersections on either end of the block, even when the whole street is not being used as a play street. This will warn drivers of the play street further down the block, as shown in the example diagrams below.

- ✓ **BARRICADES**
placed on either end of *play street boundary*
- ✓ **SUPERVISOR**
an adult stationed on either end of *play street boundary*
- ✓ **SIGNAGE**
two signs ("play street" & "road closed to thru traffic") placed at *each intersection*

EXAMPLE 1: LONG BLOCKS

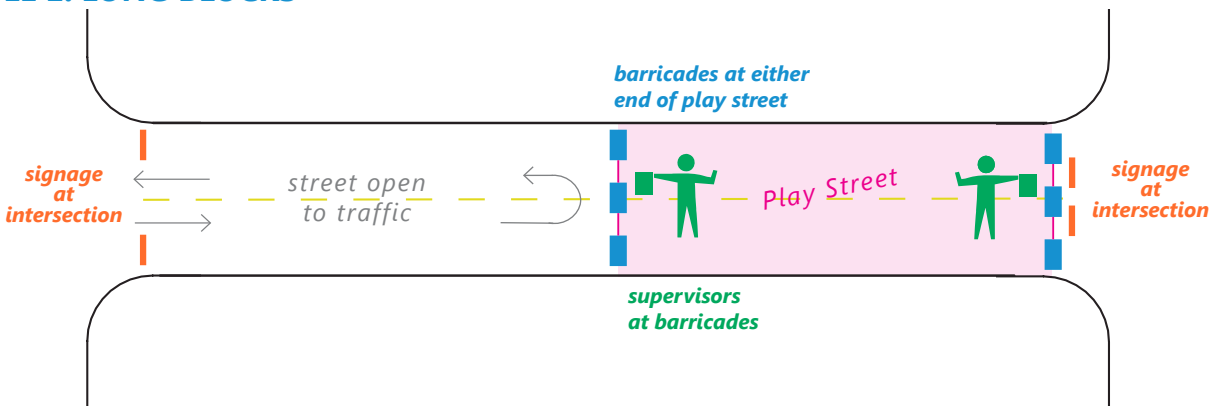

EXAMPLE 2: IRREGULAR BLOCKS

