



East Link Extension: Rainier Station
30% Design Progress

December 5, 2013

Today's agenda

- Introduction, *Cynthia Padilla, ST*
 - *East Link Overview*
 - *Station Location and Context*
 - *Preliminary Engineering Scheme*
- Station Design Progress, *David Hewitt, HEWITT*
- Next Steps
- Questions and Comments



East Link Overview

Alignment and Schedule



Link light rail system

- 16 miles of light rail with 13 stations currently in service
- ST2 Plan funded extensions to Overlake, South King County, and Lynnwood
- East Link: 14 miles with 10 stations proposed
- 50+ mile system

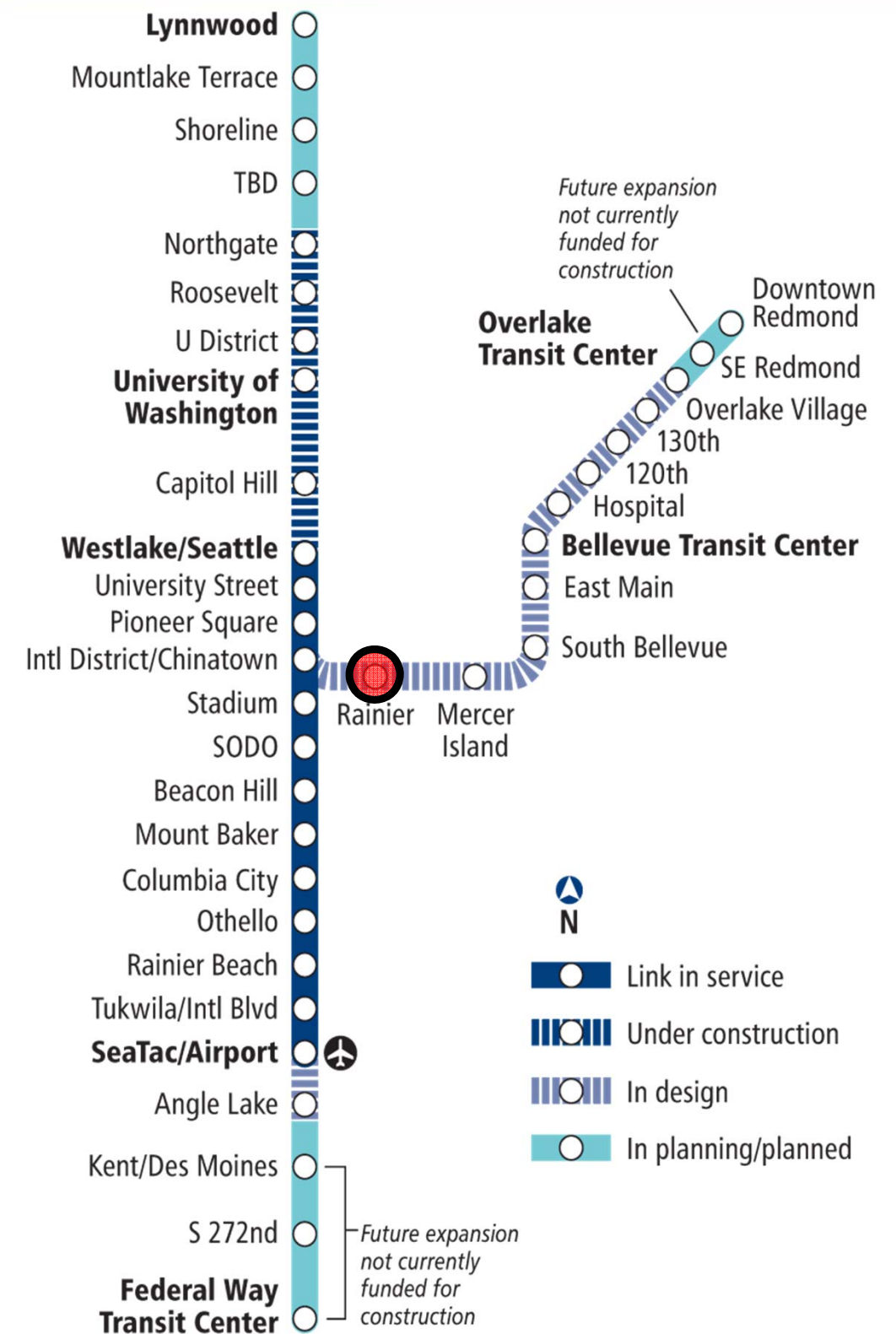

East Link timeline

2006-2011

Planning and
environmental
review

2011-2015

Final design
(we are here)

2015-2022

Construction

Targeted 2022

Testing &
pre-operations

Targeted 2023

East Link
in service





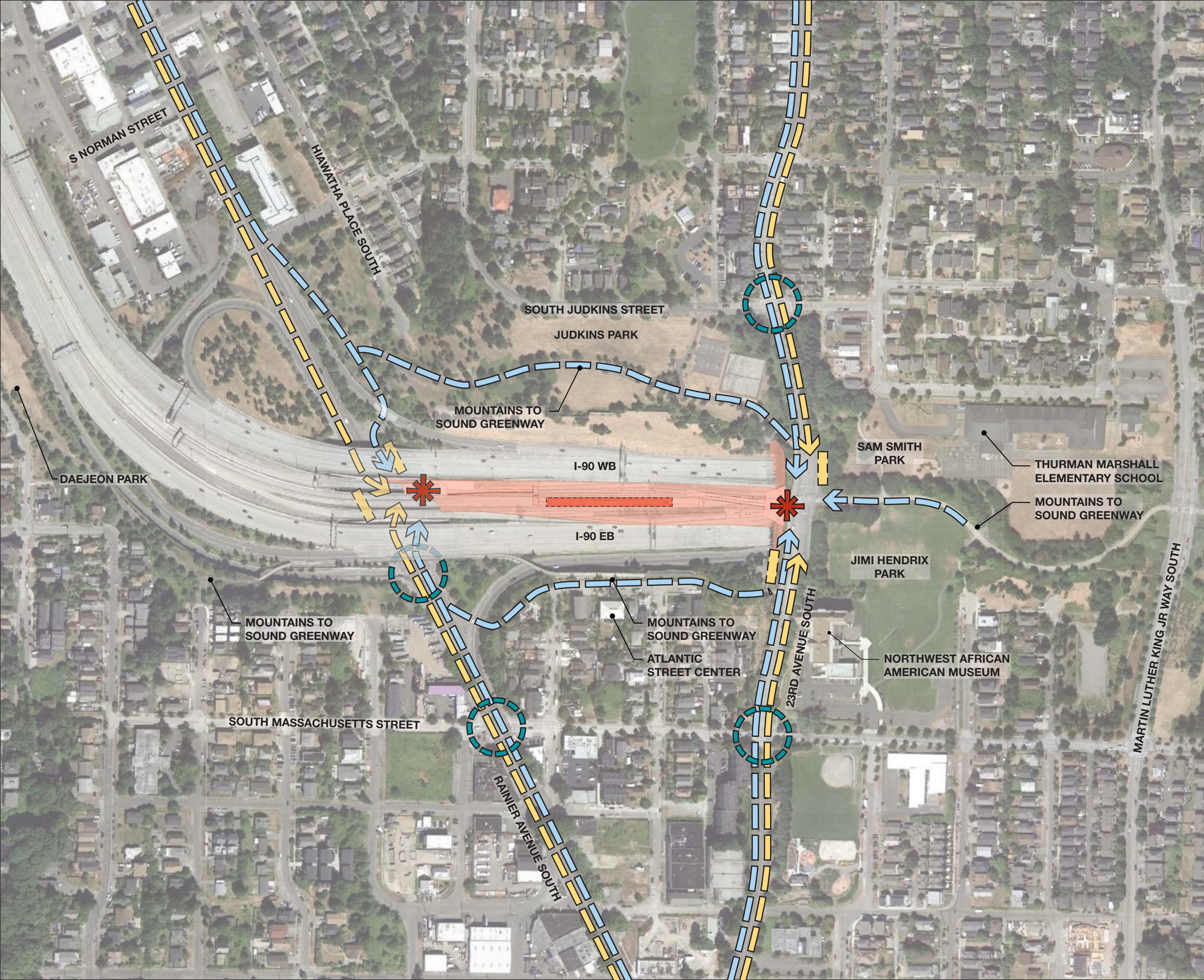

Existing Conditions

Site Location and Context





LEGEND

-  Pedestrian/ Bicycle Route
-  Bus Route
-  Bus Stop
-  Major Intersection
-  Station Entrance
-  Project Extent
-  Station Platform



1

LOOKING WEST FROM SAM SMITH PARK

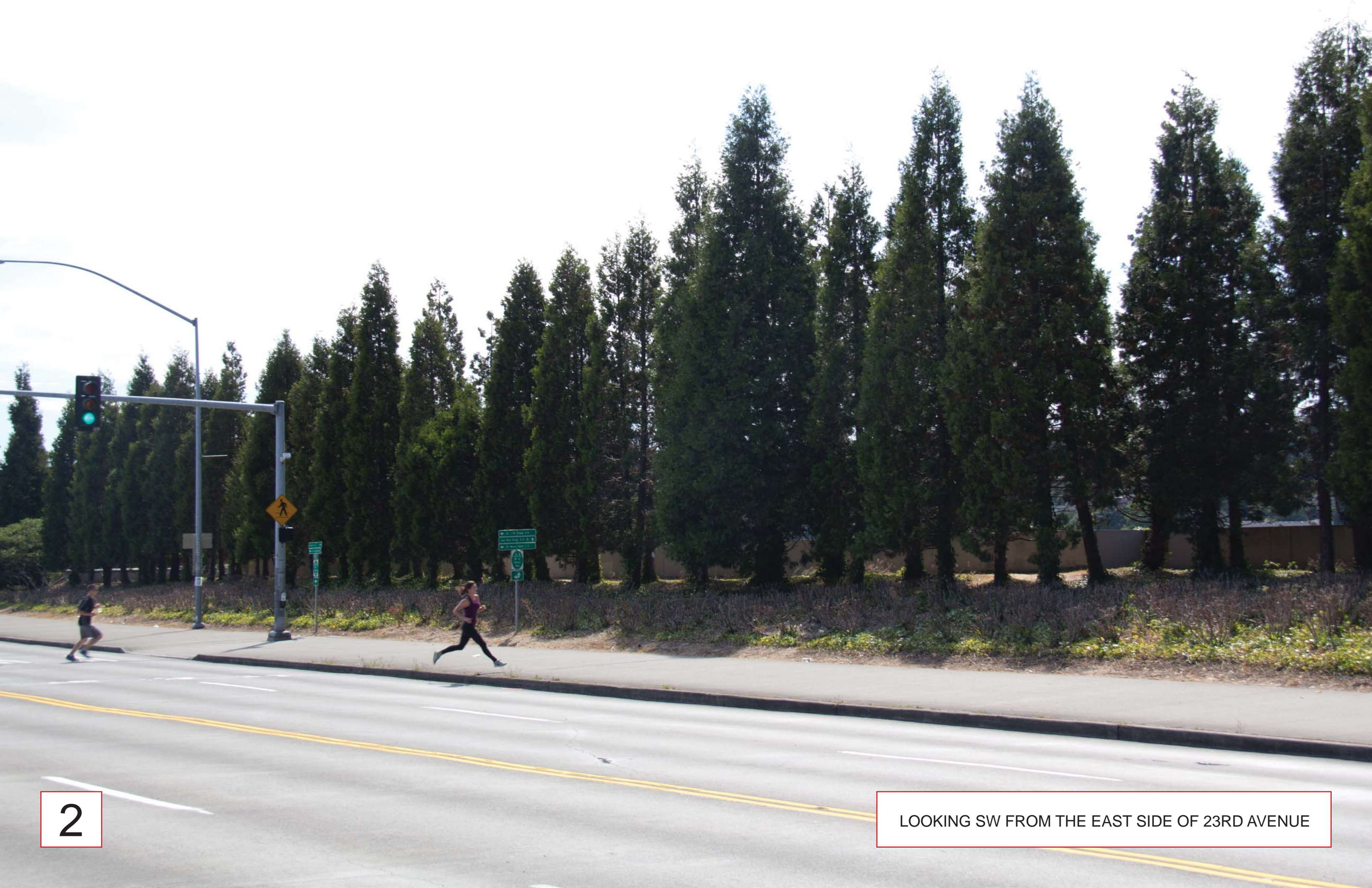

2

LOOKING SW FROM THE EAST SIDE OF 23RD AVENUE



3

LOOKING NW FROM THE EAST SIDE OF 23RD AVENUE



4

LOOKING EAST FROM WEST SIDE OF 23RD AVENUE

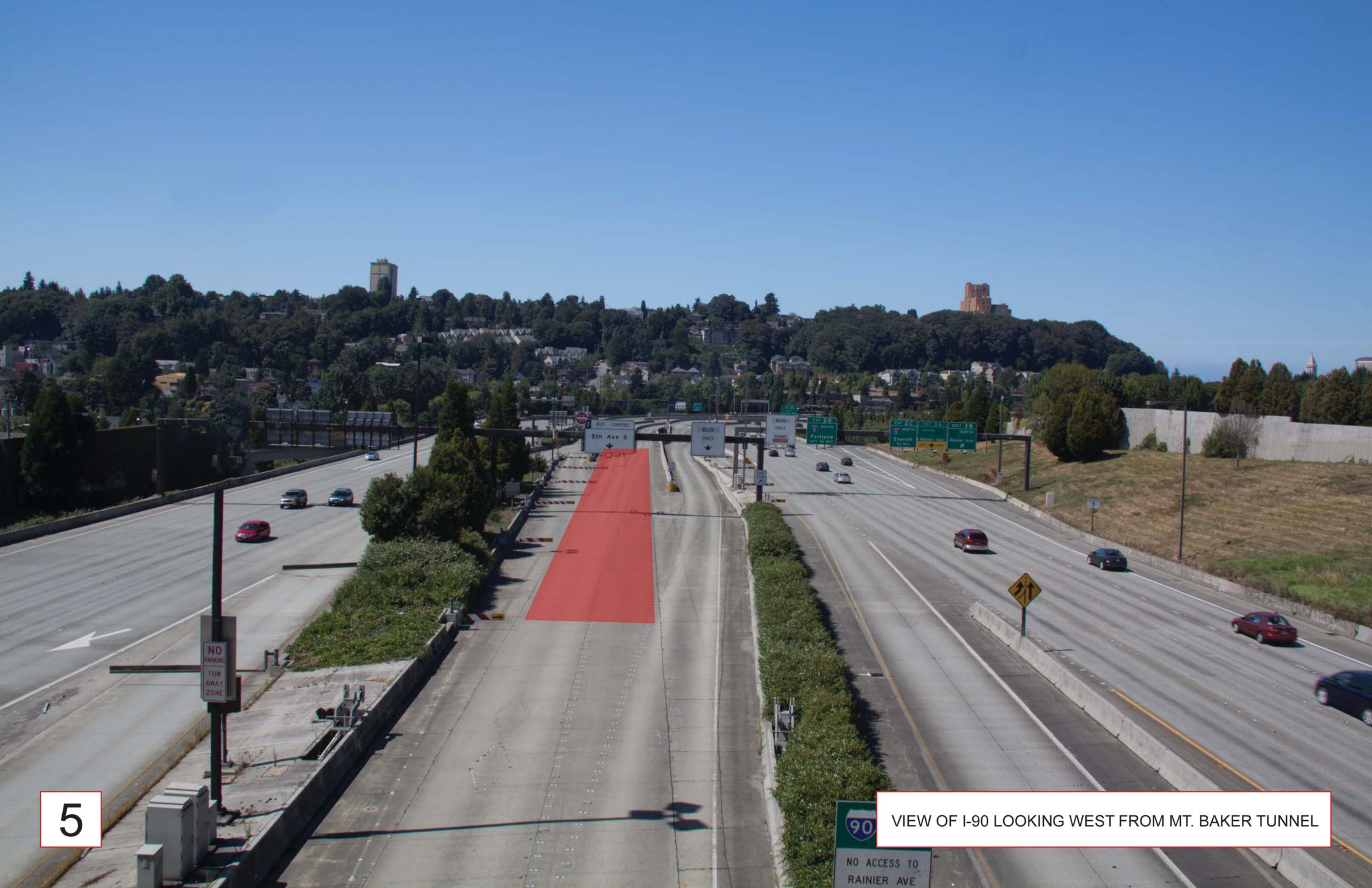

5

VIEW OF I-90 LOOKING WEST FROM MT. BAKER TUNNEL



12

LOOKING WEST UNDER WB FLYER STOP ON THE EAST
SIDE OF RAINIER AVENUE



WB I-90

CENTER ROADWAY



11

EXISTING RAMPS AND STAIR SYSTEM LEADING UP TO WB FLYER STOP LOOKING SOUTH



8

WB FLYER STOP FROM ACCESS RAMP BELOW LOOKING WEST



9

WB FLYER STOP FROM EXPRESS LANES LOOKING WEST



RAINIER STATION

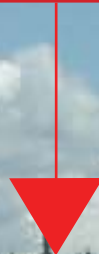

7

LOOKING EAST FROM WB FLYER STOP

Preliminary Engineering

Rainier Station - Previous Scheme



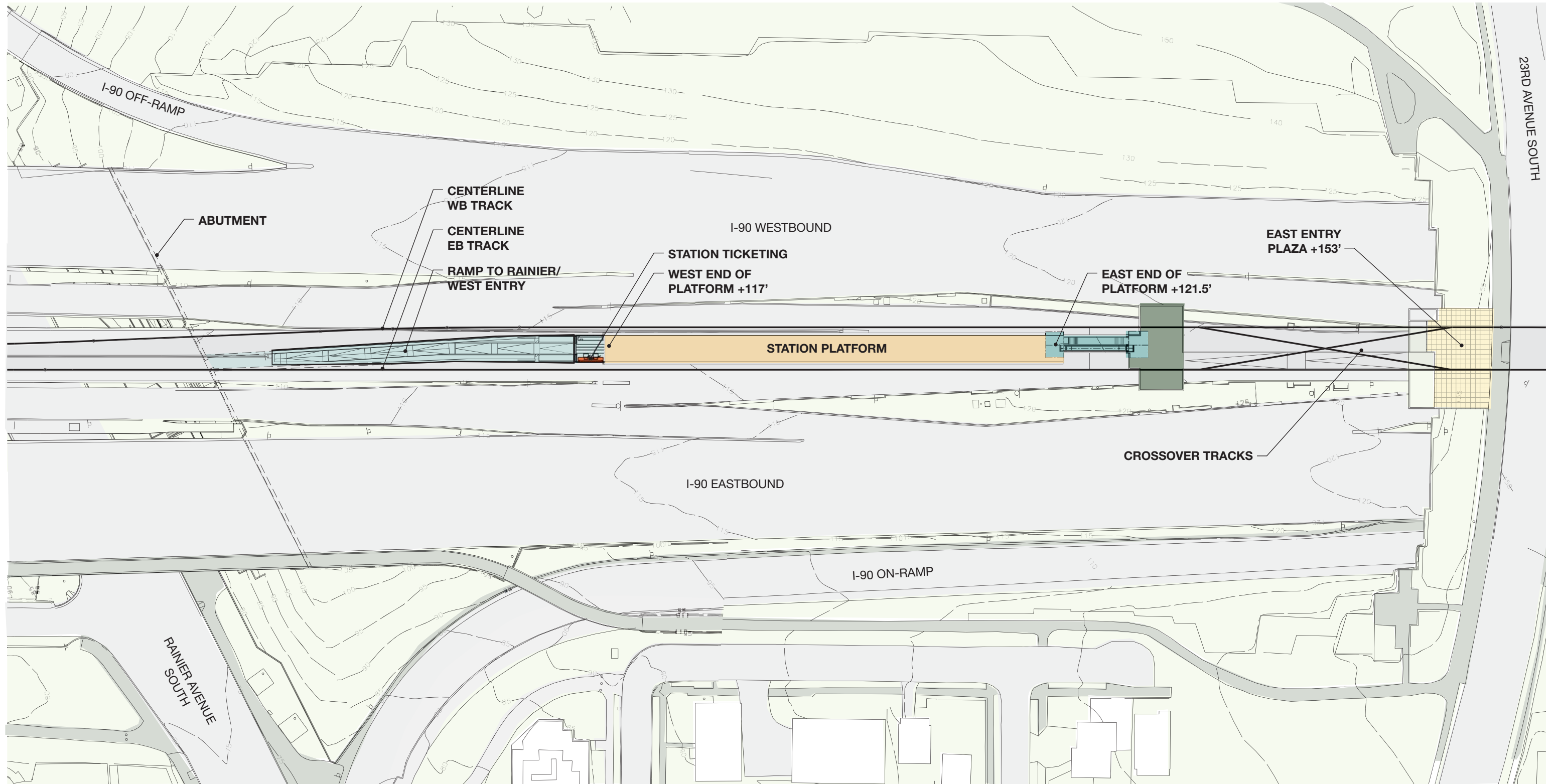

- Platform
- Plaza
- Vertical Circulation
- Ticketing/Information
- Ancillary Area



PE – Site Plan



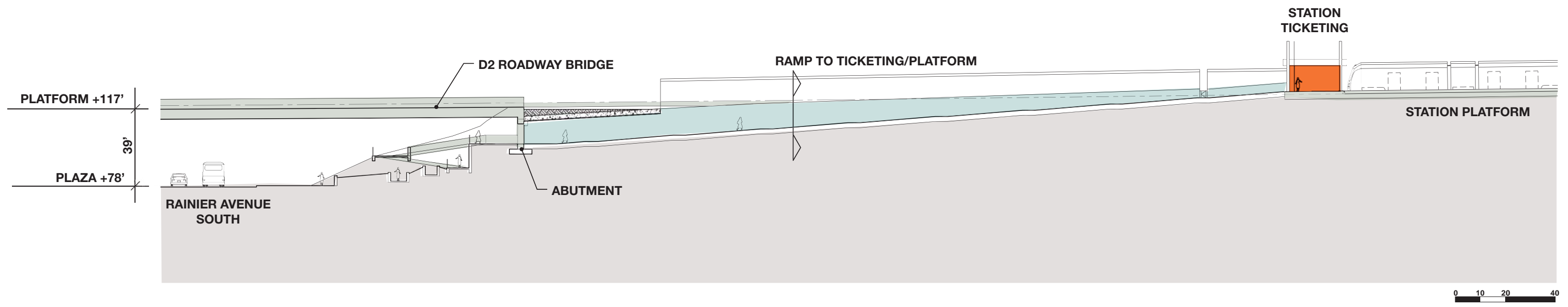
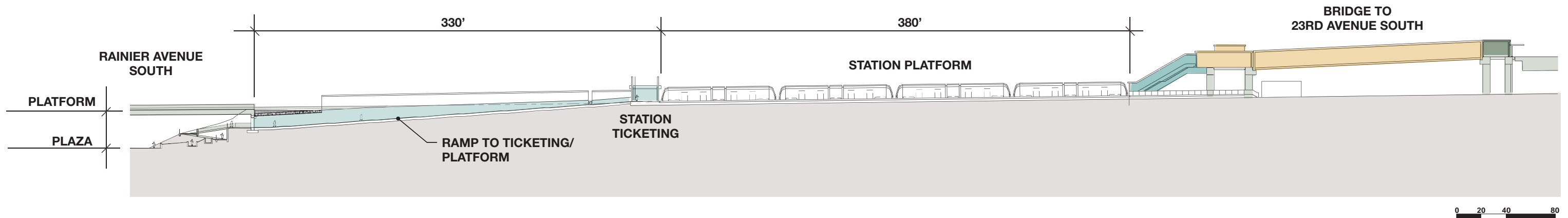

- Platform
- Plaza
- Vertical Circulation
- Ticketing/Information
- Ancillary Area

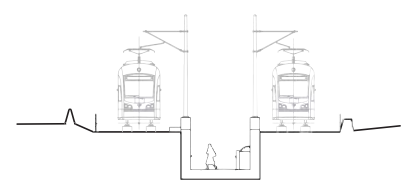

PE – Sections



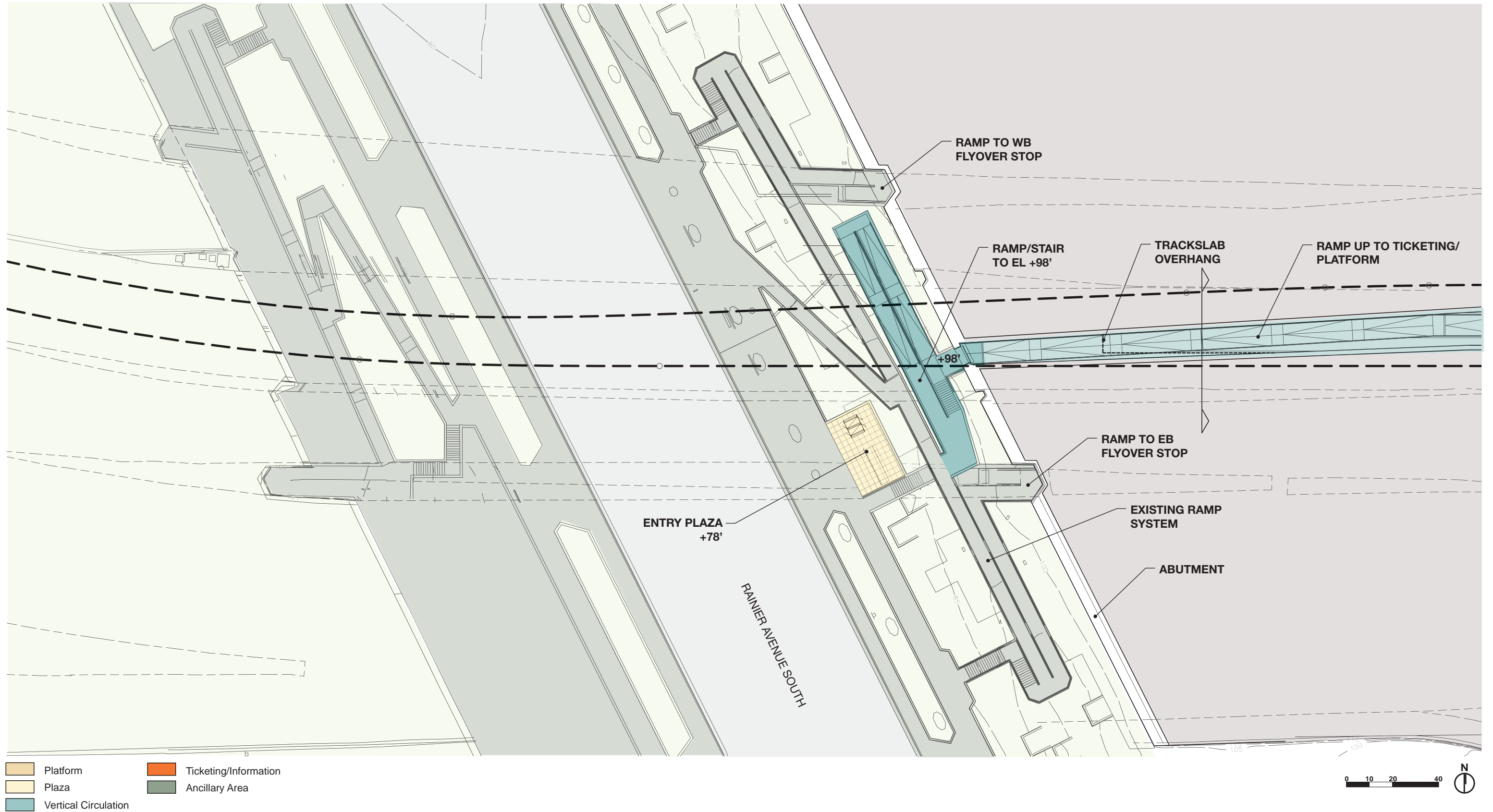

PE – Street Level

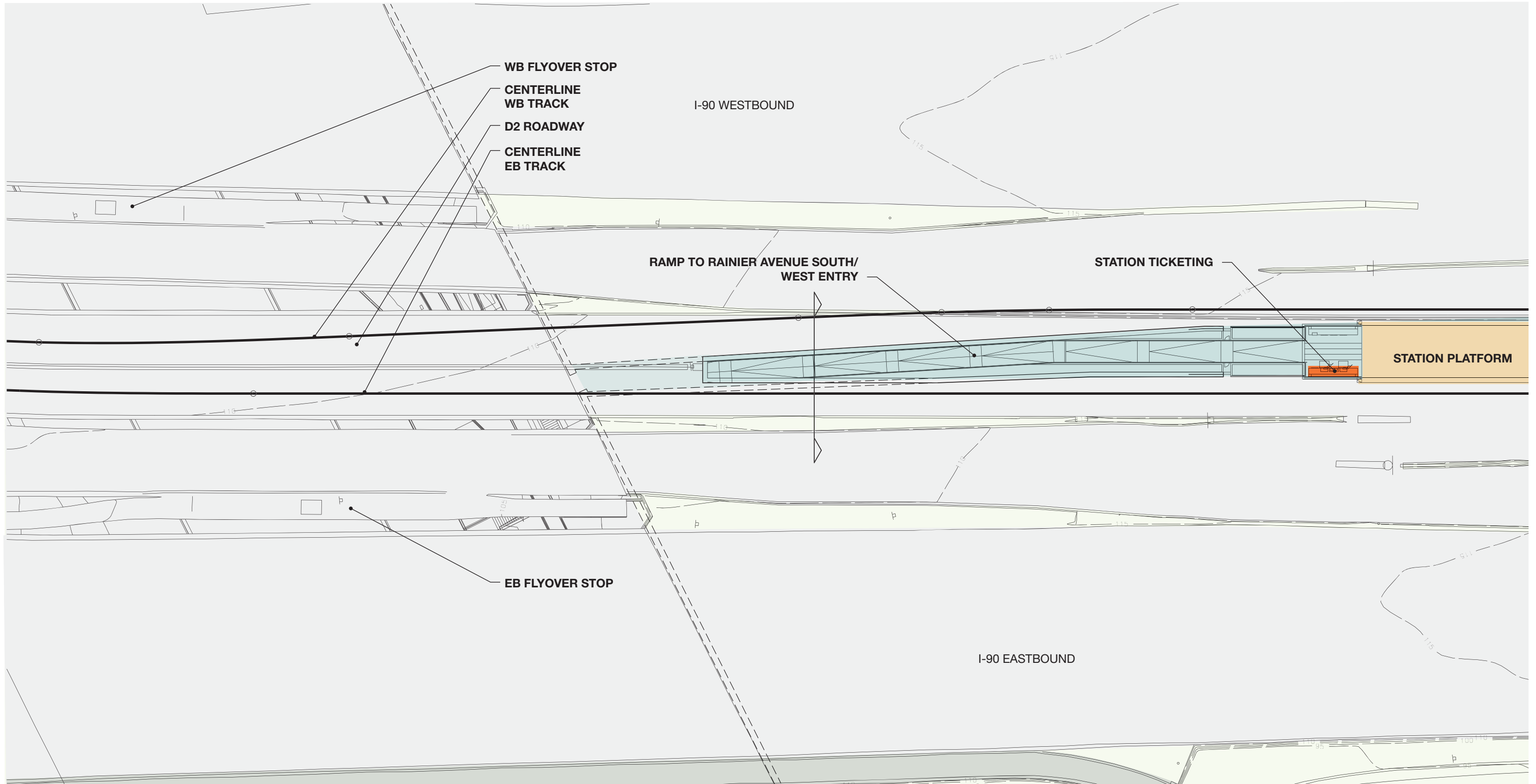

- Platform
- Plaza
- Vertical Circulation
- Ticketing/Information
- Ancillary Area



PE – Platform Level





Station Design Overview

Rainier Station – 30% Design Progress

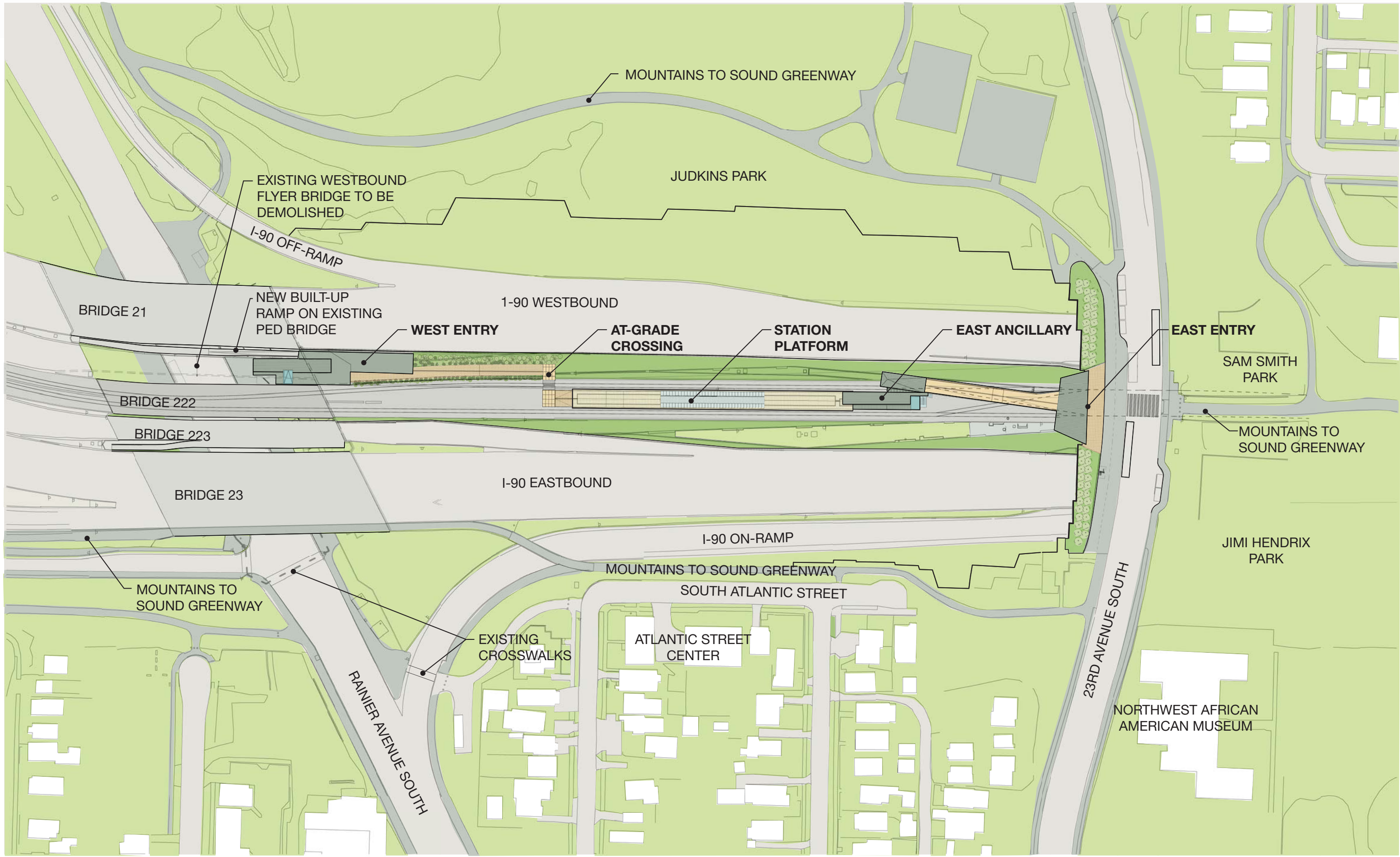

Station Site Plan



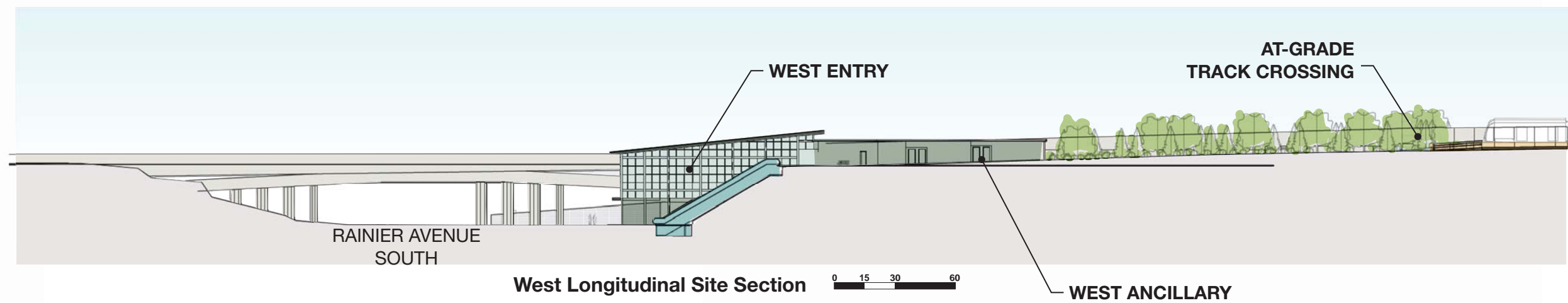
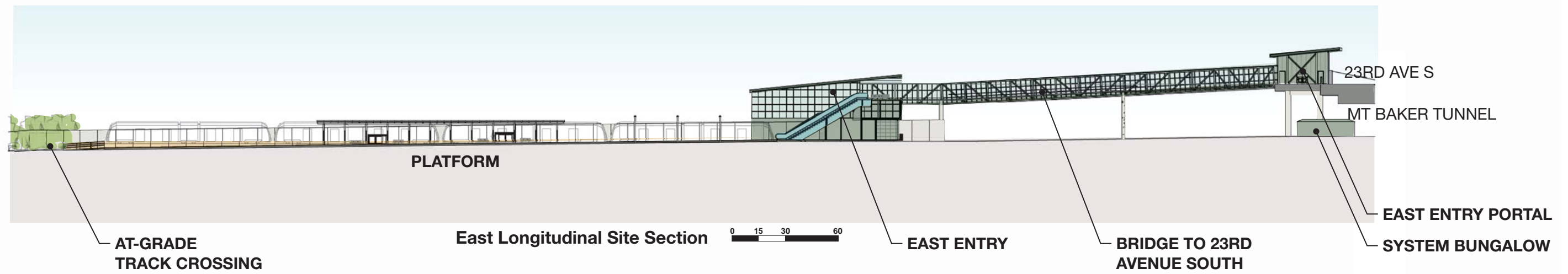
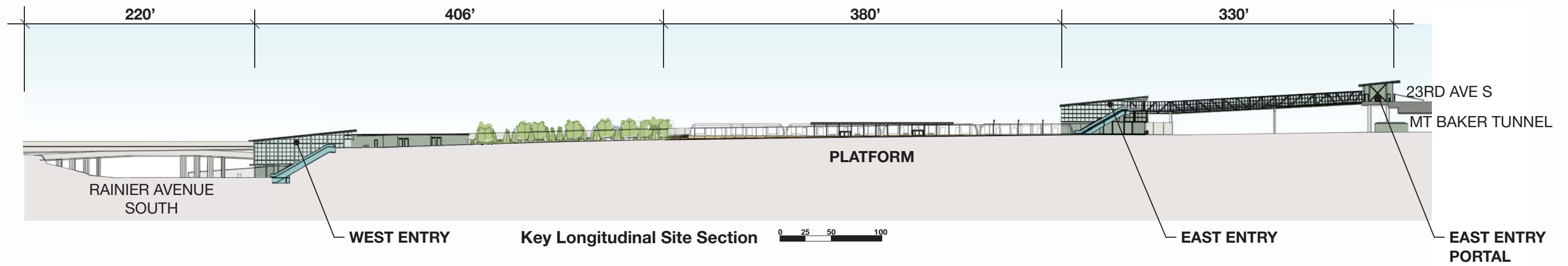

Longitudinal Sections

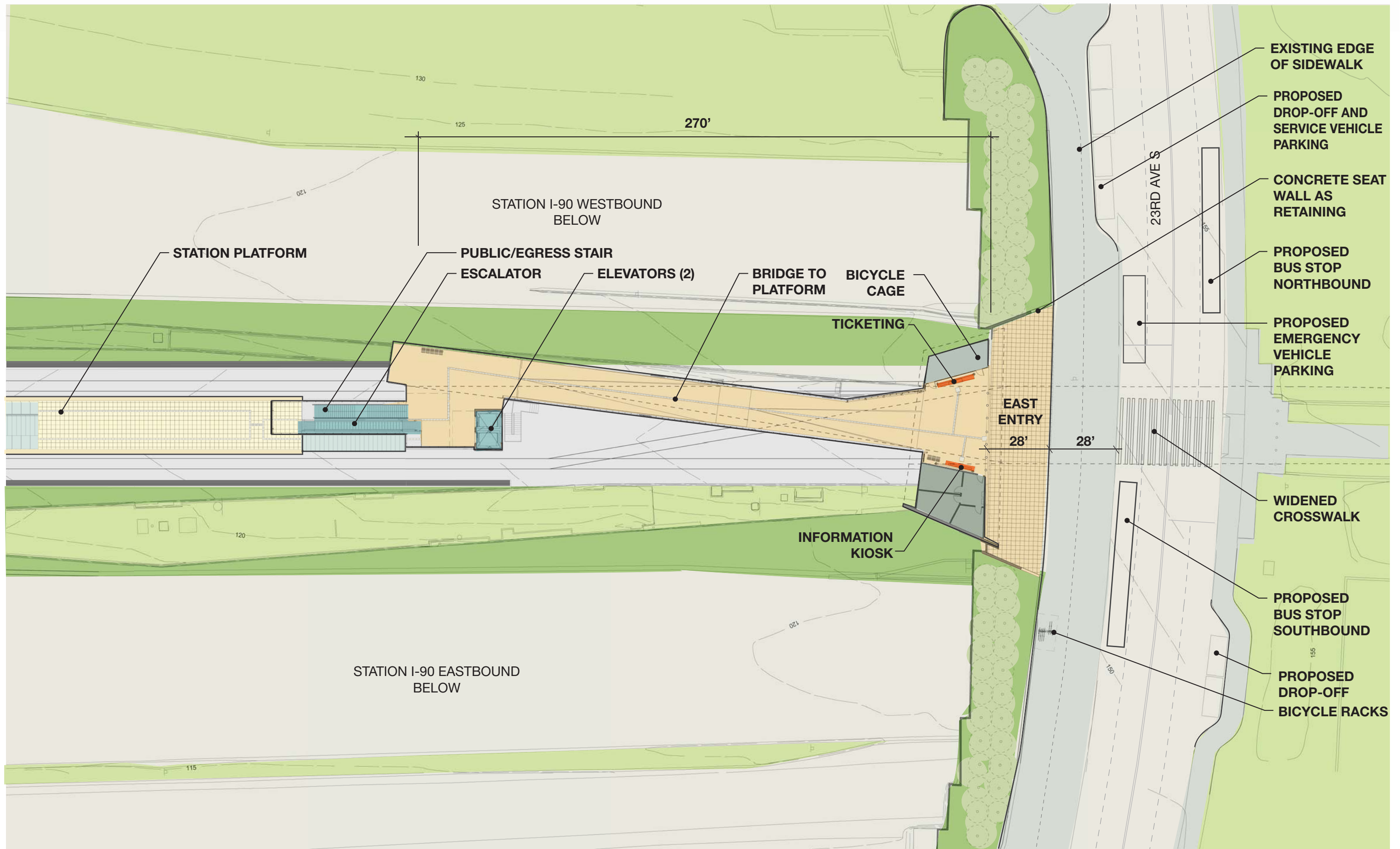

East Entry Overall Plans





Existing Conditions of East Entry from Sam Smith Park



Perspective 1: East Entry from Sam Smith Park

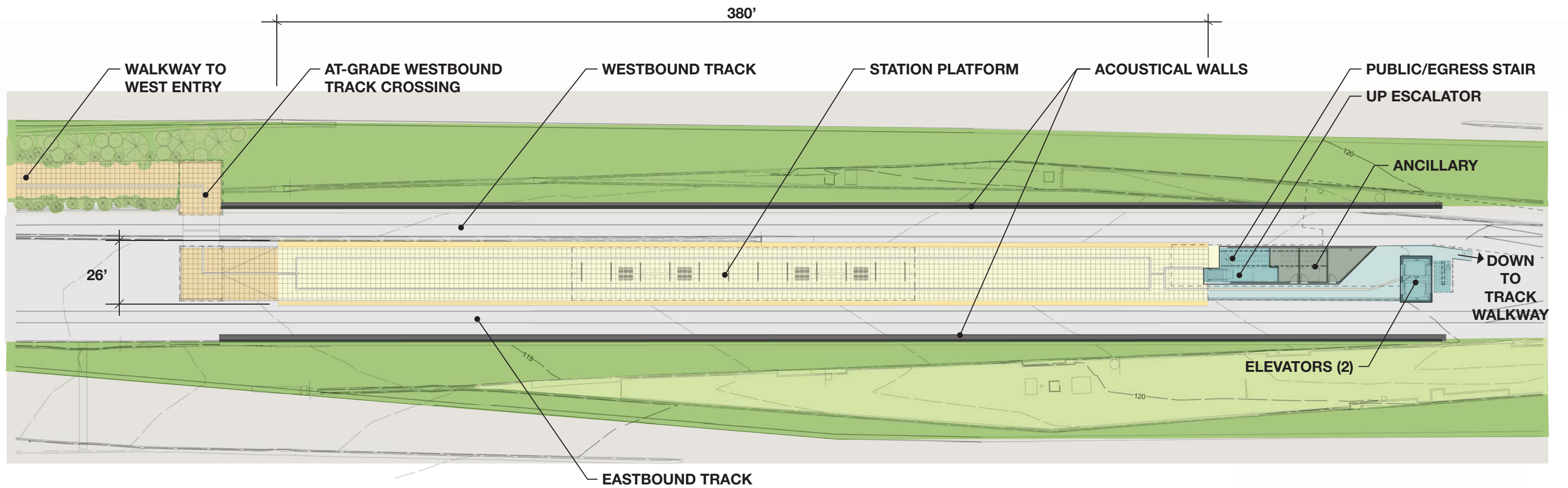

East Entry Plan





Perspective 2: East Entry from Platform



Perspective 3: Platform Canopy from Platform End West

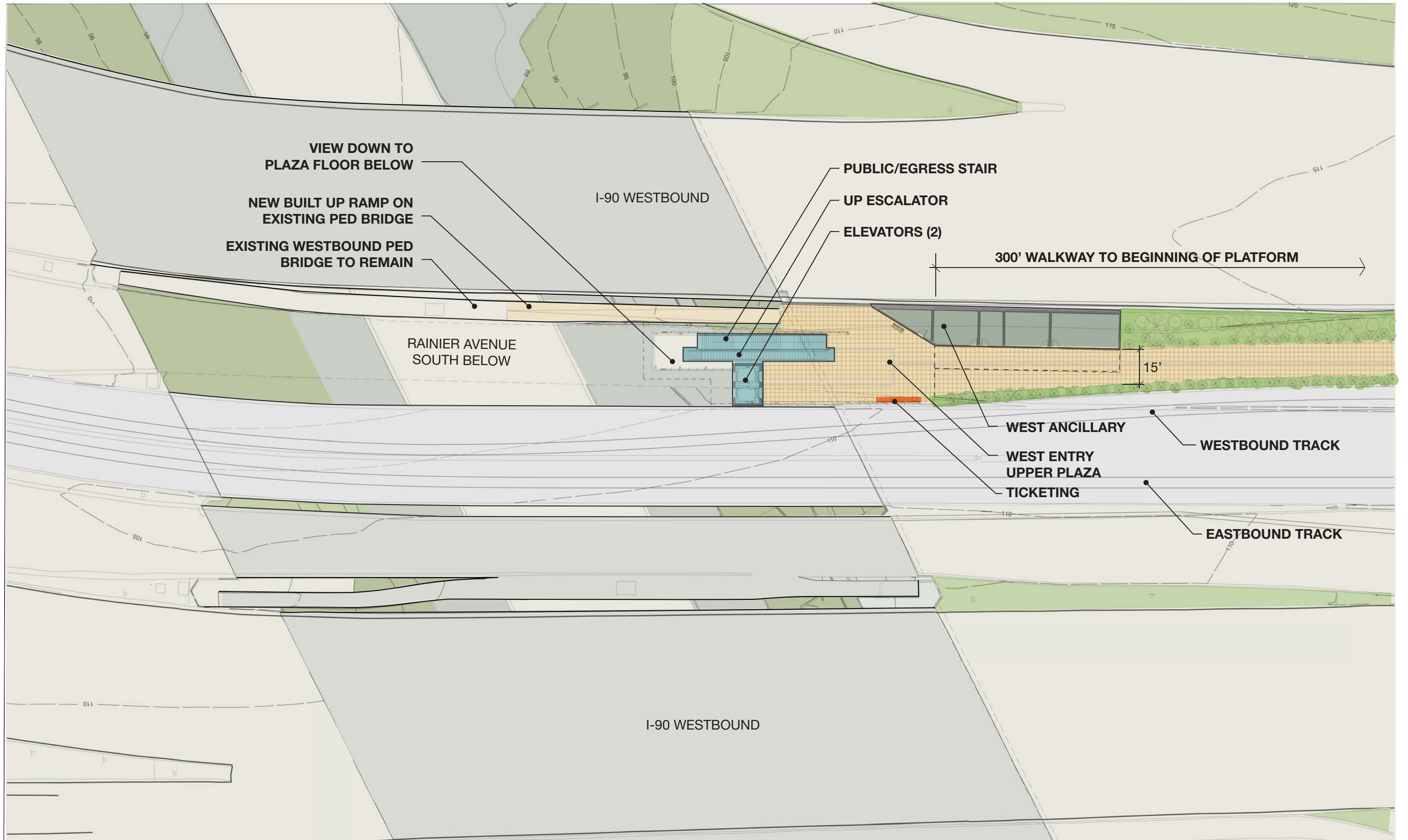

West Entry Upper Plaza Plan



Existing Conditions of I-90 from Mount Baker Tunnel



Perspective 4: West Entry from Track Crossing



Perspective 5: West Entry from Upper Plaza

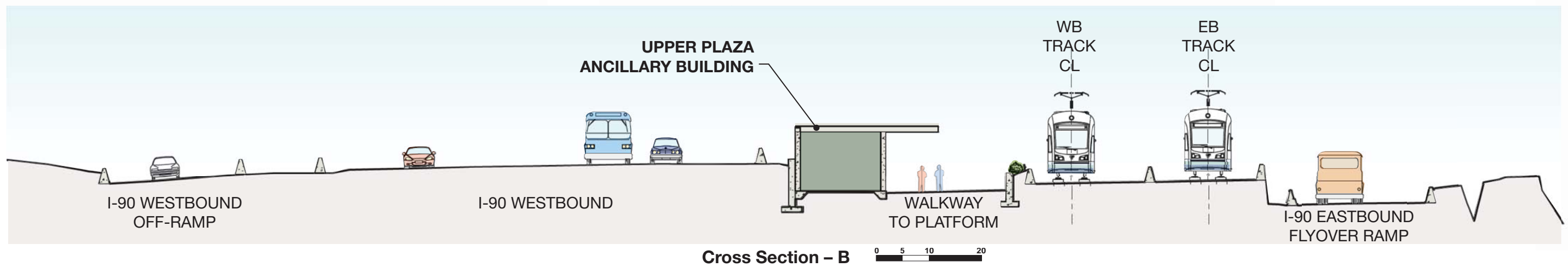
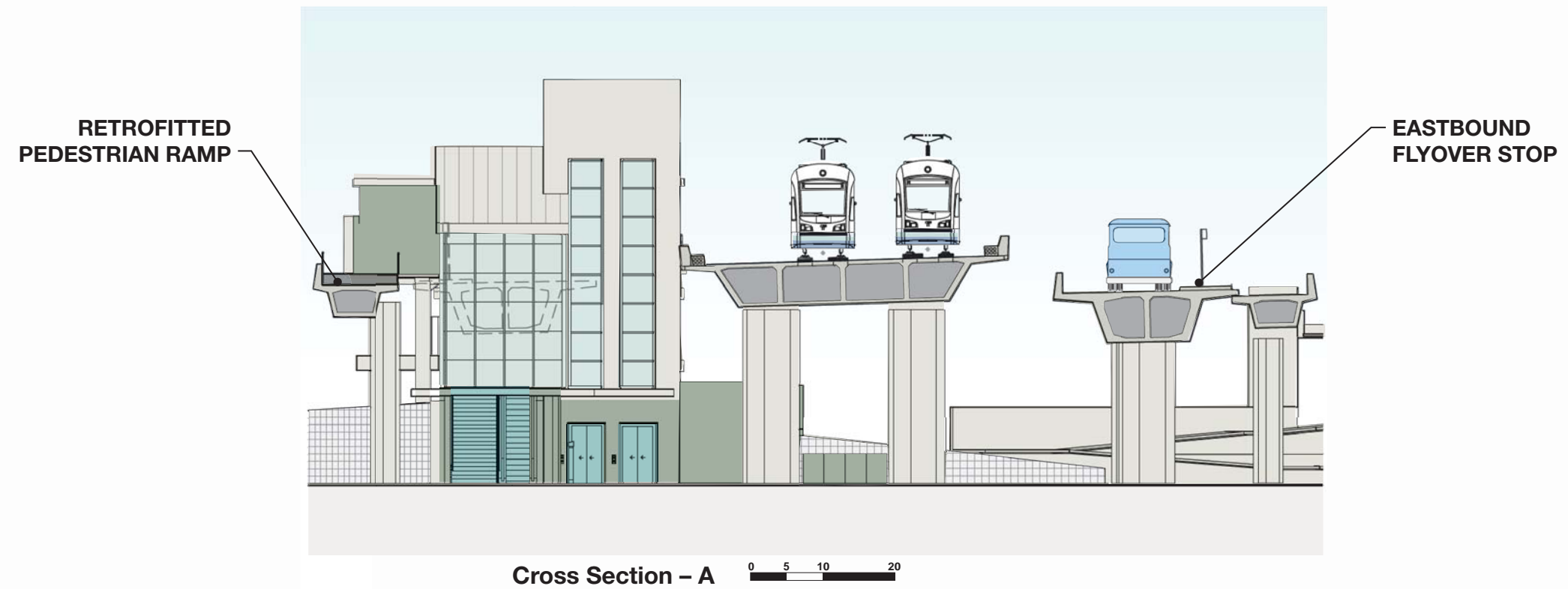
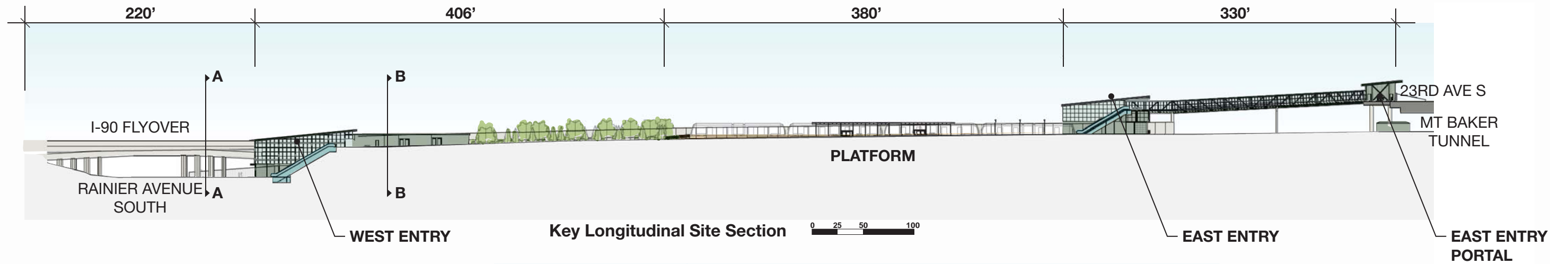

Station Site Section/Cross Sections



West Entry Lower Plaza Plan



West Entry Lower Plaza Plan Alternate Pathways



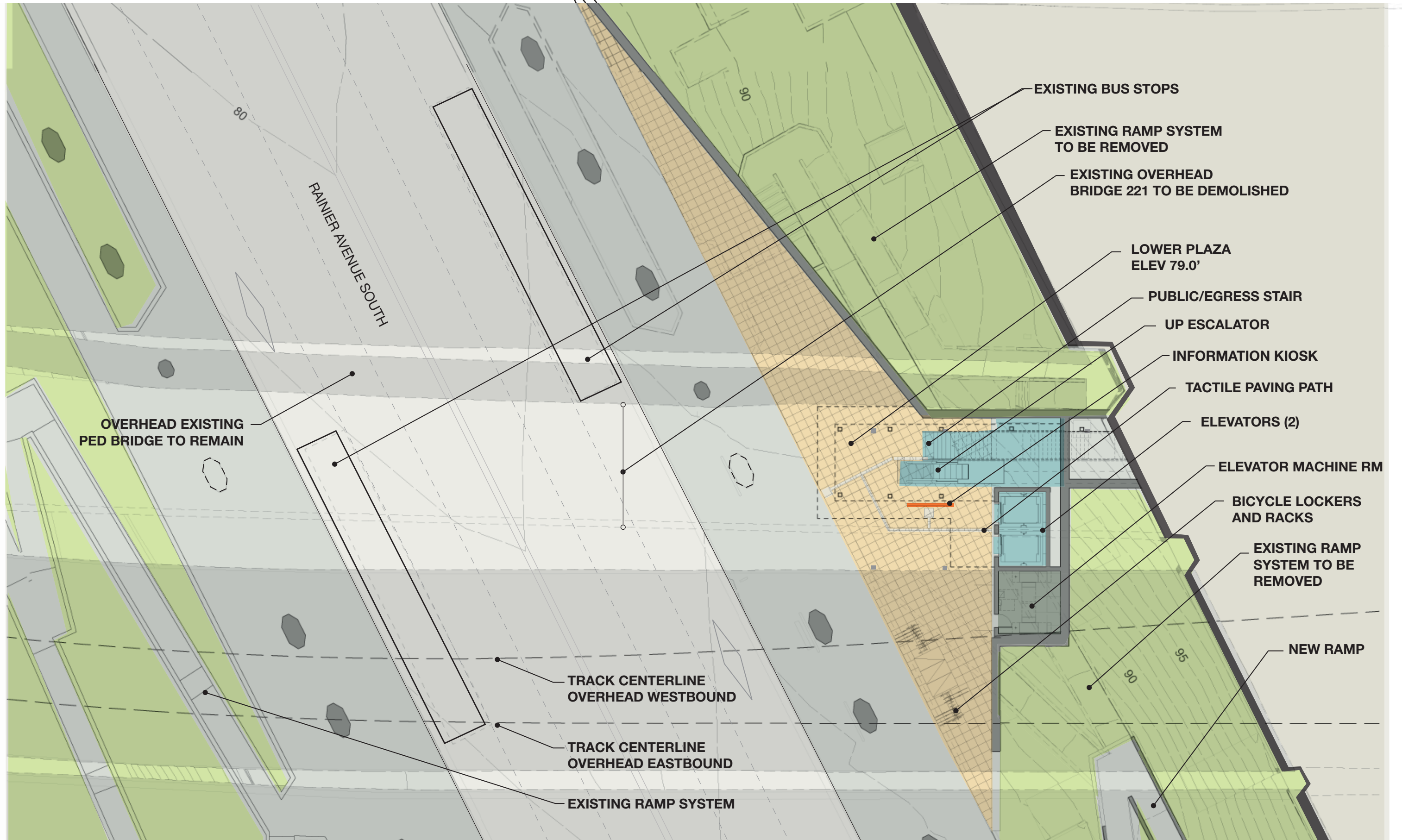

West Entry Lower Plaza Plan





Existing Conditions of West Entry from Rainier Avenue South



Perspective 6: West Entry from Rainier Avenue South