

EXCESS PROPERTY NOTICE

Building at 620 Aurora Ave N, PMA 4186

October 16, 2017

TO: City of Seattle Departments and Other Public Agencies
FROM: Daniel Bretzke, Department of Finance and Administrative Services
SUBJECT: Excess property at 620 Aurora Ave N

The Seattle Department of Transportation has identified a parcel that is excess to the needs of the Department. In accordance with City of Seattle property disposition policies, this notice informs other City Departments and public agencies of this property's availability.

Since the early 1970's, a number of parcels were purchased for road improvements in the South Lake Union Neighborhood. Excess property not needed for roadway purposes is sold to partially fund other transportation projects. SDOT is obligated to receive fair market value for this property. More information about this property can be found at <http://www.seattle.gov/real-estate-services/property-reuse-and-disposition-overview/pma-4186>.

The following map shows the property that is subject to this notice.

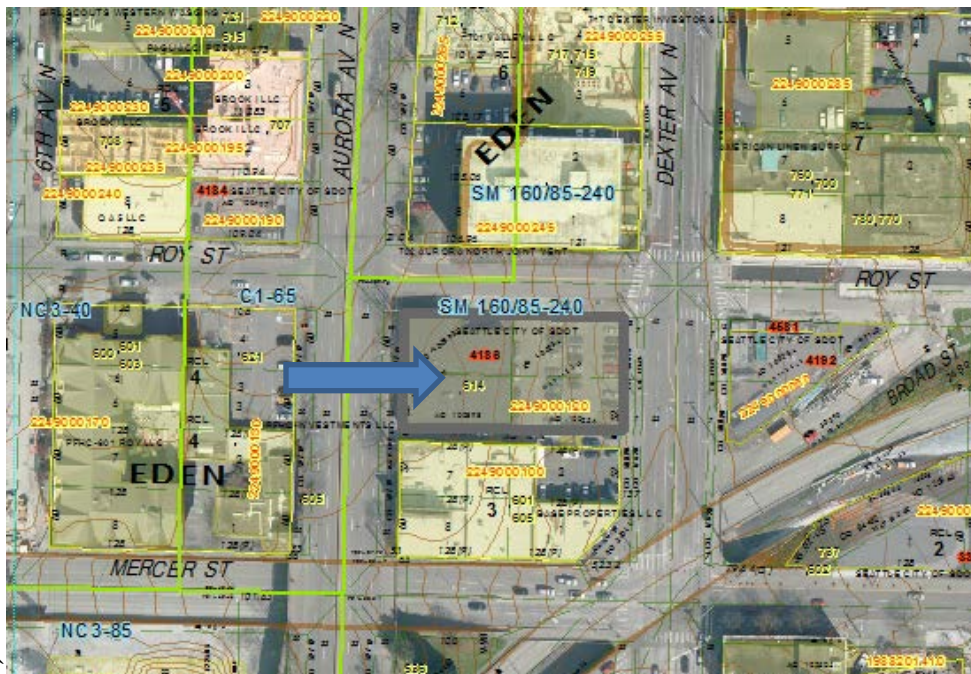

FAS manages the evaluation process for the reuse or disposal of City property. This is in accordance with City Council policies adopted under Resolution 29799 and amended by Resolution 30862.

All departments and agencies are requested to return the Excess Property Response Form. In particular, please identify if your department has existing facilities, utilities, or property rights that affect the property. Please complete the Excess Property Proposed Use Form if your Department or agency is interested in acquiring the property for :

- Short term use (less than two years)
- Permanent easements or covenants that will run with the land
- Potential City uses
- Other public agency use

For questions regarding the City's excess property disposition process please contact Daniel Bretzke at 206-733-9882 or at daniel.bretzke@seattle.gov Please provide your comments and completed forms by November 17 2017 to the following:

Daniel Bretzke
Daniel.bretzke@seattle.gov

Inter office mail
Daniel Bretzke
Mail Stop SMT -50-01

US Mail
Daniel Bretzke
City of Seattle - FAS
P.O. Box 94689
Seattle, Washington, 98124-4689

**CITY OF SEATTLE
EXCESS PROPERTY RESPONSE FORM**

- Seattle Public Utilities**
- Seattle Department of Transportation**
- Seattle Office of Housing**
- Seattle City Light**
- Seattle Parks and Recreation**
- Seattle Department of Neighborhoods**
- Seattle Department of Planning and Development**
- Seattle Office of Economic Development**
- _____

_____ We have no interest in the property

_____ We are interested in acquiring PMA 4186 or jurisdiction over it. A completed **Excess Property Proposed Use Form** is attached to this response.

_____ We have facilities on PMA 4186 or access rights through or across the property as described below (add additional sheets as necessary):

_____ We need facilities on PMA 4186 or access rights through or across the property as described below (add additional sheets as necessary)

_____ We have identified the following plans, policies, objectives, limitations or other factors as found in adopted or proposed City plans and policies that may affect the Reuse or Disposition of the property (add additional sheets as necessary):

Reviewer

Department

Date

EXCESS PROPERTY PROPOSED USE FORM

_____ (department/agency) wants to acquire
property rights over all or a portion of:
PMA 4186

PROPOSED USE: Describe the proposed use for the property, including information on potential improvements, users, tenure, impact on neighborhood such as parking, traffic volumes. (Attach additional pages as necessary).

EST. IMPLEMENTATION DATE: _____ **EST. COST :** _____
EXPECTED TERM OF USE: _____ **FUND SOURCE(S):**

Are funds appropriated? YES NO If no, when will funds be appropriated? _____

BENEFITS TO THE CITY OF SEATTLE FROM THIS PROPOSAL:

SUPPORTING POLICIES. List the adopted plans and policies (itemize specific sections in major documents) which support, or are implemented by, this proposed use.

CONTACT PERSON: _____ **PHONE:** _____

_____ **DATE :** _____

DIRECTOR OR DESIGNEE