

ARCHIVES GAZETTE

City of Seattle
Seattle Municipal Archives

Number 70 Winter 2019

Office of the City Clerk
Legislative Department



Seattle at 150

In mid-October, we were thrilled to receive the first copies of *Seattle at 150*, our new book commemorating Seattle's sesquicentennial, produced in cooperation with our partners at HistoryLink. The book showcases the work and life of the city since it was incorporated on December 2, 1869.

The official celebrations kicked off with a *Seattle at 150* book launch for City employees on October 17th in the SMT Gallery. Hosted by the Office of the City Clerk and SMA, and with honored guest Mayor Durkan, the event offered a chance for attendees to see the *Seattle at 150* gallery exhibit, visit with archivists and fellow city workers, and pick up #Seattle150 swag such as coasters,



City Clerk Monica Simmons unpacks the first copy of *Seattle at 150*.



SMA archivists hand out free books to City of Seattle employees at the *Seattle at 150* book launch.

The festivities continued on October 24th with a Seattle History Trivia Night co-hosted by SMA and Councilmember Abel Pacheco at the Fremont Dock and Grill. After two rounds of competitive trivia, the winning teams each took home their own copies of *Seattle at 150* and gift bags of #Seattle150 goodies.

The game's afoot at Seattle History Trivia Night at the Fremont Dock. Photo by Brian Callanan.



To mark 150 years to the day since Seattle was incorporated in 1869, SMA held a special anniversary celebration on December 2nd with cupcakes and #Seattle150 swag in the main lobby at City Hall.



December 2: 150 years to the day!

The following week, a special ceremony commemorating the sesquicentennial was held on Monday,

December 9 and hosted by Mayor Jenny Durkan, City Council President Bruce Harrell and Washington Secretary of State Kim Wyman. On display at the event were Seattle's original Articles of



The original Articles of Incorporation, on temporary loan for the December 9 event from the Secretary of State and the Washington State Archives.

Incorporation, signed by then-Governor of Washington Territory Alvan Flanders, courtesy of the Washington State Archives in Olympia where the articles are kept. It was a thrill to see them!

The *Seattle at 150* book is now available at your favorite bookstore! Be sure to check out the online version on our Digital Collections site, [here](#).

Archives Fair at City Hall

SMA celebrated Archives Month with an Archives Fair at City Hall on October 30th. Honoring this year's theme of "Celebrate Washington's Heritage" set by the Washington State Archives Month Committee, the Archives Fair brought together 19 different local archives, representing a wide diversity of collections documenting and celebrating the rich heritage of our region.

In addition to SMA, the following organizations participated in the Archives Fair: Seattle Public Library, King County Archives, UW Special Collections, UW Labor Archives, Providence Archives, Seattle Public Schools Archives, Washington State Archives Puget Sound Regional Branch, National Archives at Seattle,

(Archives Fair, cont'd)

Black Heritage Society of Washington State, Seattle Genealogical Society, Lakeside School Archives, Museum of History and Industry, Living Computer Museum + Labs Archives, Museum of Flight Archives, Washington State Jewish Historical Society Archives, Puget Sound Navy Museum, UW Ethnomusicology/Media Archives, and KRAB Archives.



Visitors chat with archivists at the Archives Fair. Photo by Ryan Donaldson.

The variety of organizations represented drew a steady stream of visitors during the 4-hour fair. UW Professor Jeffrey Shulman's talk on "The Power of Archives" discussed his research into the Central District's rich heritage and current challenges, and highlighted how archival records are invaluable for providing access to history and putting current events into a larger context.

Seattle at 150 in London

On a recent vacation to London, Reference Archivist Jeanie Fisher took the opportunity to deliver copies of the new *Seattle at 150* book to the British Museum and the London Metropolitan Archives. The donations were in gratitude for the inspiration SMA received from both institutions.

City Archivist Anne Frantilla first had the idea for *Seattle at 150* after seeing the British Museum's book *A History of the World in 100 Objects*. Soon after launching our own book project, SMA staff discovered the London Metropolitan Archives' book *London: 1000 Years*, which also featured objects from the archives to illustrate stories of city life and work. Both books inspired us as we thought about how to commemorate Seattle's milestone birthday, and we were excited to share *Seattle at 150* with them!



Seattle at 150 delivered to the British Museum (above) and to the London Metropolitan Archives (left).

Recently Processed Photos

Recently cataloged at SMA are a series of photos taken during the Great Depression showing activities at relief depot locations in Seattle. These offices provided Seattle residents who were in need with provisions such as food, clothing, and other supplies. The photos all date from 1931 and are included in a report by the Mayor's Commission for Improved Employment, filed with the City Clerk's Office in January 1932. See more of the photos on our [Digital Collections site](#).



Northeast Relief Depot, located at 1304 E. 45th. [Item 193917](#), Clerk File Photographs (Series 1802-0P). SMA.

Men loading supplies at the relief depot at 12th and Yesler. [Item 193917](#), Clerk File Photographs (Series 1802-0P). SMA.



51 years ago: Smoking Santa

December's [Find of the Month](#) featured a letter sent to Mayor Dorm Braman from a concerned citizen in December 1968:

"Dear Sir, The construction of the large image of Santa Claus in the downtown mall was a thoughtful and nice idea, it brings to note the Christmas spirit, but why the pipe in the upraised hand? Has anyone ever seen Santa Claus pictured smoking?"

Many have spoken of the poor taste shown in view of the well known health damage and dangerous results from smoking...Why not order the pipe down, leaving a friendly gesture."

The mayor often wrote rather caustic replies to citizen letters, but in this case he was fairly restrained. He noted that "it is rather common for Santa to be shown in this position," but that in any case, "the installation is the work of the Central Association of Seattle, and the responsibility for the design and construction was entirely theirs."

Newly Processed Collections

Recently processed in the Archives are records from the Department of Neighborhood's P-Patch Program ([Series 5751-10](#)), covering the years 1975-2009. This collection includes records documenting the program as a whole, including strategic planning, funding, data about participants, and coordination with the Parks Department, City Light, and the Seattle Housing Authority. There are also files on prospective sites in specific neighborhoods, as well as on the management of individual gardens.

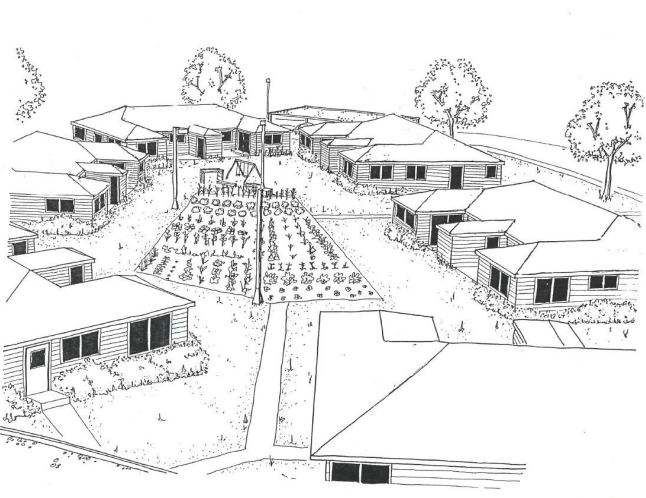

Site plan for Seattle Housing Authority Community Garden, circa 1990.
P-Patch Program Records (Series 5751-10), Box 1, Folder 11, SMA.

Seattle's P-Patch program has been around since 1973, when part of the old Picardo family farm was acquired for a community garden. The Department of Neighborhoods now manages dozens of these gardens throughout the city. Other P-Patch records held by SMA include P-Patch Surveys ([Series 5751-09](#)) with surveys completed by gardeners as part of their 2001 applications for garden space in community p-patches, and P-Patch Newsletters from 1984-1996 in Human Services Department Publications ([Series 3600-03](#)).

Also newly processed are the Woodland Park Zoological Society Board Minutes ([Series 8604-01](#)), comprising 5 cubic feet and spanning the years 1986-2008. The minutes encompass a time of change and transition for the zoo, when the Society took over management of the zoo through a contract with the city. This period also saw further development of the



Woodland Park Zoo marketing flyer, 2002.
Woodland Park Zoological Society Board Minutes (Series 8604-01),
Box 6, Folder 1, SMA.

zoo's 1976 long-range plan, including building the Asian Elephant Forest exhibit, Tropical Rain Forest exhibit, Education Center, Zoo Store, Animal Health Complex, Northern Trail exhibit and Trail of Vines exhibit.



Photo of Woodland Park Zoo Board of Directors, 1994.
Woodland Park Zoological Society Board Minutes (Series 8604-01),
Box 2 Folder 9, SMA.

The minutes illustrate a pivot towards an approach that is more aware of animal needs and committed to conservation and education. Topics discussed include fundraising goals and projections; board elections; financial reports; annual plans; educational outreach; marketing; event planning, and updates on the current happenings among the animals and exhibits at the zoo. There are also discussions concerning managing the shifting powers of the Society as well as its changing relationship to the city government, local community, and the zoo itself.

For most meetings, supplementary material is also present, including reports from committees, presentations, memos, and marketing materials.

Interns & Volunteers

Our volunteers have been keeping busy this fall. Siri Alderson and Carla Ginnis have continued working on cataloging maps, documents, and photos. Annalise Nicholson and Staci Crouch have been scanning General Files in addition to processing textual collections. Mike Cardinal is working on older Planning Commission records as well as neighborhood survey photos, and Kelli Yakabu continues with our zoo photographs. Andrew Wagster has been updating finding aids and indexing court cases, and Jen Zook continues her work with our Seattle Channel videos.

Work-study students Harper Cottingham and Haley Beedle have been scanning records and processing collections in addition to their day-to-day work pulling and re-shelving records for customers and helping to keep us running. We appreciate everyone's hard work over the past few months!

YouTube and Flickr News

A popular photo recently posted to SMA's [Flickr](#) site is this view of downtown Seattle taken from Beacon Hill during the construction of I-5.



[Item 43394](#), Engineering Department Photographic Negatives (Series 2613-07), SMA.

Among the more popular videos recently added to SMA's [YouTube](#) channel are those showing phases one and two of the construction of the Freeway Park and Garage, 1974-75. Footage includes meetings, construction site work, landscaping, and includes both close-up and aerial shots of the project.



Still from *Freeway Park and Garage [1st Phase], 1974-1975*.

[Item 424](#), Engineering Dept. Motion Picture Film (Series 2613-09), SMA.

Seattle Municipal Archives

600 Fourth Avenue, Floor 3,
PO Box 94728
Seattle, WA 98124-4728
206 233-7807 archives@seattle.gov
www.seattle.gov/CityArchives

SMA in the News

In early November, City Archivist Anne Frantilla visited the studios of King 5 New Day Northwest to talk about *Seattle at 150*. See the full interview [here!](#)



SMA's Anne Frantilla and New Day Northwest host Margaret Larson.

SMA was also featured in one of a new series of videos produced by Seattle Channel's CityStream, marking Seattle's sesquicentennial with stories exploring the City's past and present. Also highlighted in the series is an interview with Cecile Hansen, Chairwoman of the Duwamish Tribe; a story exploring the changing Central District; a visit to Seattle's oldest family-owned farm, and more. Check out the full series of videos on the [CityStream website](#).

49 Years Ago: Central Waterfront Park Design



Drawing of Central Waterfront Park Design, 1970.

[Item 76067](#), Forward Thrust Photographs (Series 5804-04), SMA.

Upcoming Events

- April 22-25 [Northwest Archivists Meeting](#), San Francisco, CA
- January 15 History Café: [Legacy of Exclusion in the NW](#), MOHAI
- January 27 [AKCHO Annual Meeting](#), 10:30am-1pm, Museum of Flight