

# ROXHILL SKATESPOT

Design and review process



# First Schematics – Presented at SPAC 9/12/11



# Comments received at SPAC meeting

- Seattle does not have a street plaza skatepark
- Provide a more true street plaza
- If the snake run is kept it should include more street features and banks
- Eliminate snake run if necessary
- Resolve dead end at lower level, provide quarter pipe or bank.
- Provide storage space

# Revised Schematic shown at 2<sup>nd</sup> public meeting 10/12/11



## ROXHILL SKATESPOT

2850 SW Roxbury St. Seattle, Washington 98106

Conceptual Design Rendering

10. 11. 2011



californiaskateparks.com



# Revised Schematic shown at 2<sup>nd</sup> public meeting 10/12/11 – Used as Comment Sheet

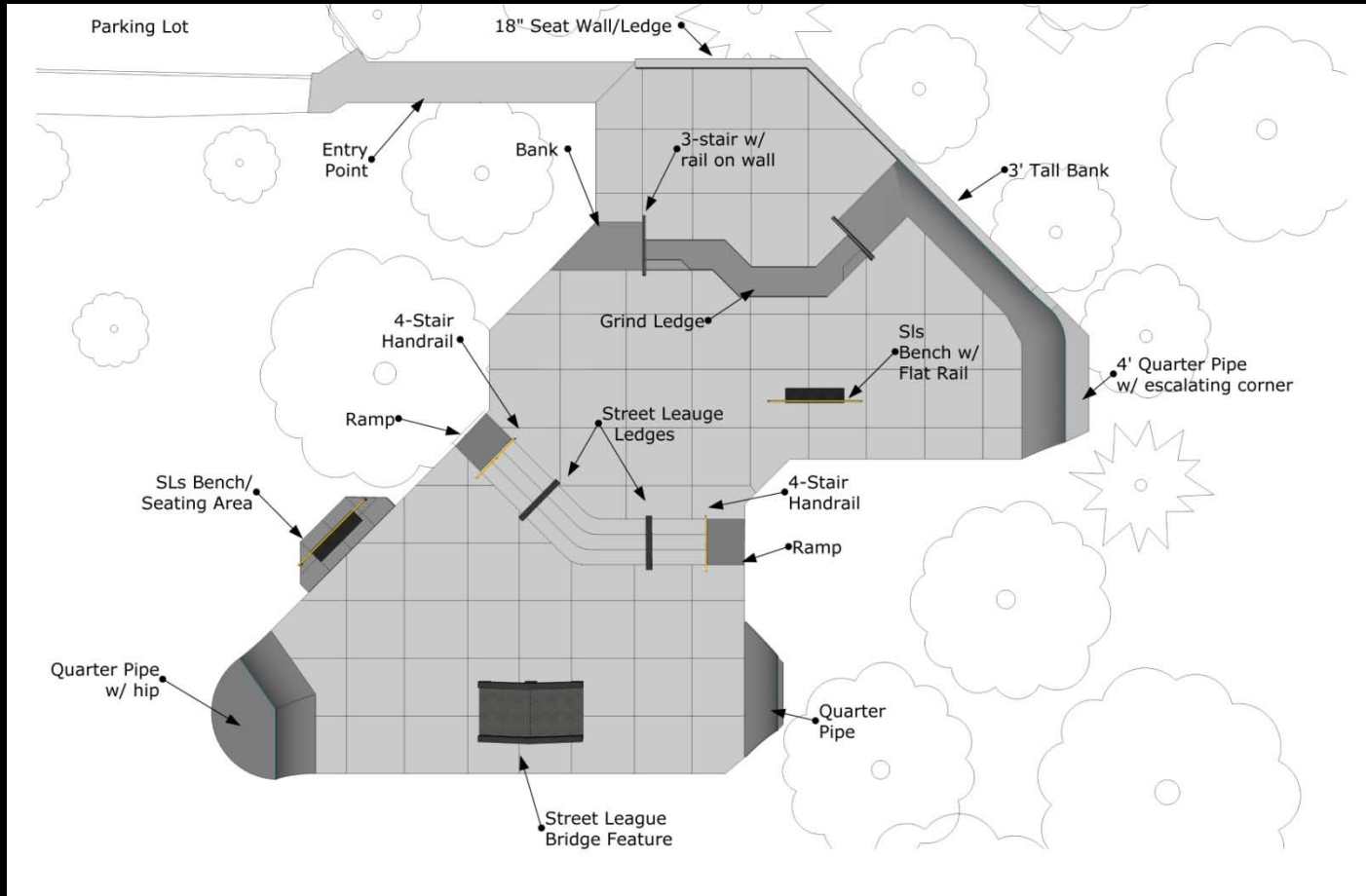

ROXHILL PARK SKATE SPOT  
CITY OF SEATTLE, WASHINGTON

CONCEPTUAL  
MASTER PLAN



# Revised Master Plan Shown at 2<sup>nd</sup> public meeting



# Prioritized comments collected at 2<sup>nd</sup> public meeting

- Street/plaza style was well received
- There needs to be a way to skate to the top of the site
- Provide a hip or pump bump to provide momentum to return back to upper level
- The design should incorporate some unique features to distinguish it from other sites
- Reduce collision hazards with traffic from other features
- Change height of mirrored features to reduce redundancy and add beginner vs. advanced features

# Design alteration after 2<sup>nd</sup> public meeting, prior to comment collection.

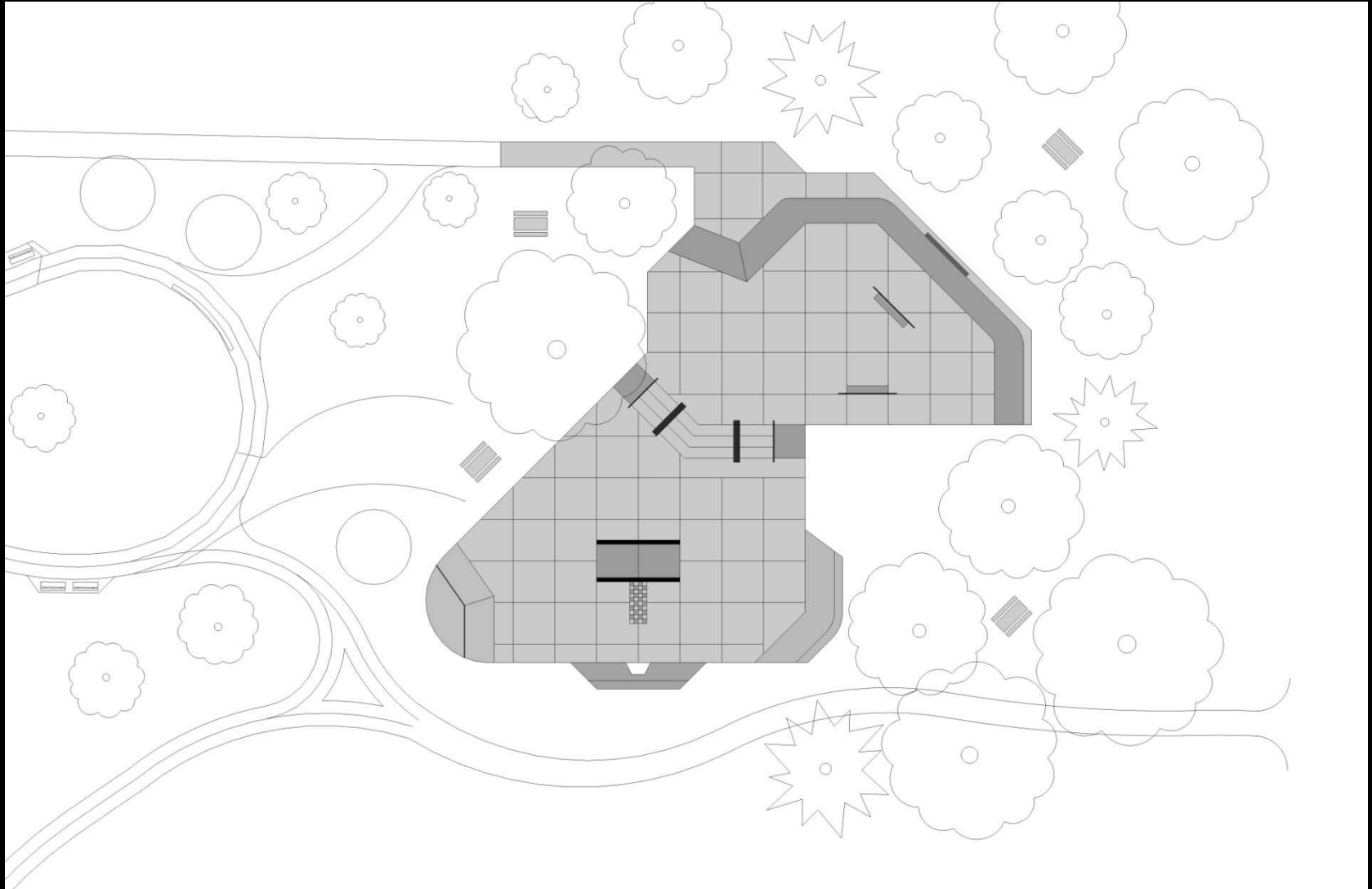

# Design modification options posted to web following 2<sup>nd</sup> public meeting

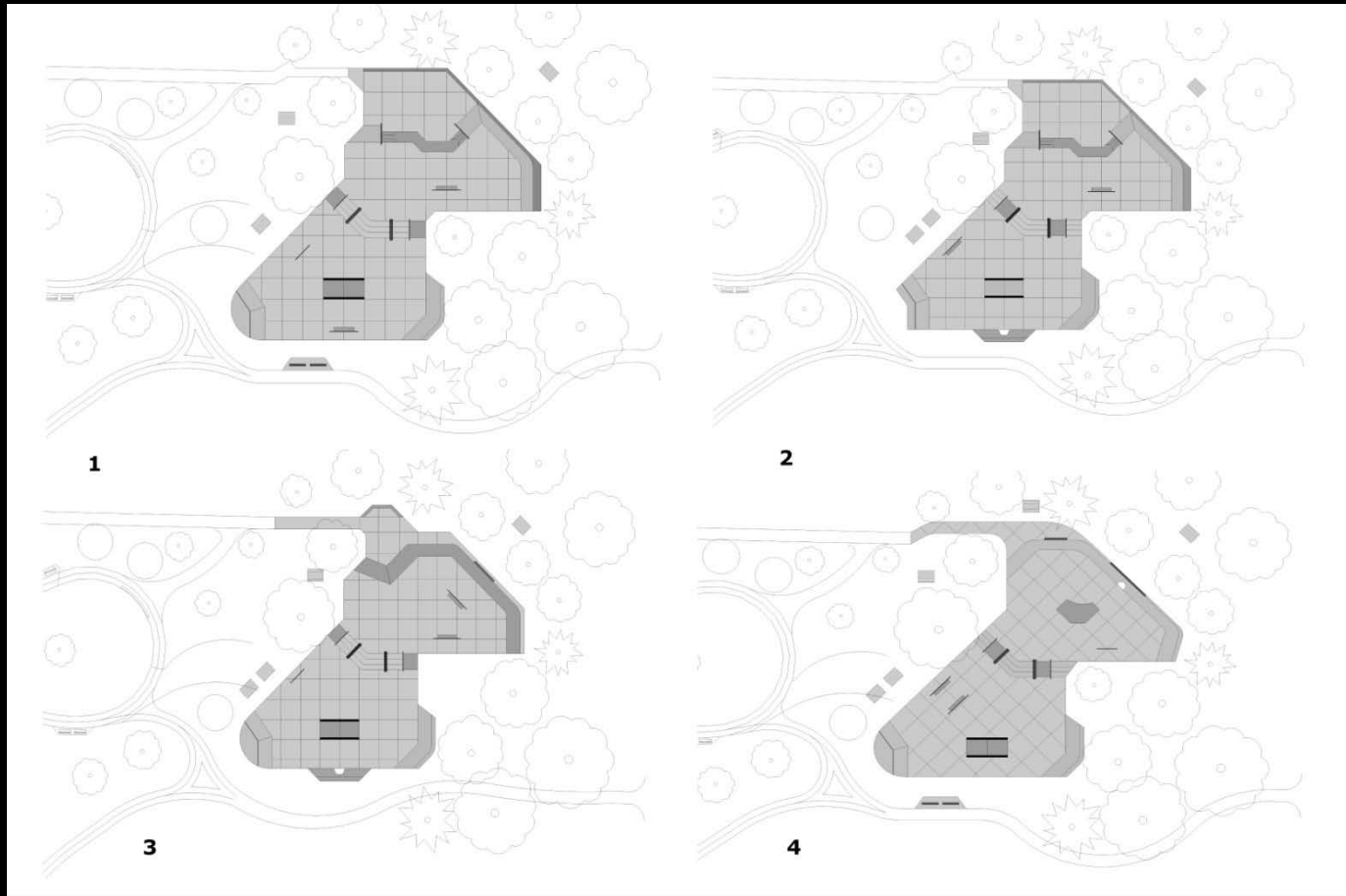

ROXHILL PARK SKATE SPOT  
CITY OF SEATTLE, WASHINGTON

ALTERNATIVE  
CONCEPTS 1-4



# Prioritized comments received via email after the 2<sup>nd</sup> public meeting

- Provide the ability to skate down and up the site (flow)
- Provide something custom and unique in the design
- Reduce bottlenecks and collision hazards between features
- Keep the site a street style skatepark including various rails and stairs
- Work with the landscape better, snaketrail with street features and banks
- Provide gathering spaces

Revised design concepts  
incorporating highest priorities  
expressed in community feedback.

Review at meeting #3

11-14-11

# Plan A



## Park Features

- A. Entry Path
- B. Seat Wall/Ledge
- C. Planter
- D. Ramp
- E. Bank w/ Euro Gap
- F. Slappy Bank
- G. SLs Ledge
- H. Bank
- I. 4-Stair w/ SLs Hubba Ledges
- J. 4-Stair w/ Handrail
- K. Bank-to-Curb w/ Gap
- L. SLs Ledge
- M. Flip Bank
- N. SLs Bridge
- O. 3-Stair
- P. Handicap Ramp w/ Handrails
- Q. Bank

## ROXHILL SKATESPOT

2850 SW Roxbury St. Seattle, Washington 98106

conceptual site plan A

11. 14. 2011



californiaskateparks.com



# Plan B



## Park Features

- A. Entry Path
- B. Seat Wall/Ledge
- C. Planter
- D. Ramp
- E. 2-Stair w/ Rail
- F. Slappy Bank
- G. 2-Stair w/ Ramp
- H. 3-Stair w/ Pier 7 Block
- I. Bank-to-Curb w/ Gap
- J. Flip Bank
- K. SLs Ledge
- L. SLs Bridge
- M. 4-5Tair w/ SLs Hubba Ledges
- N. 4-Stair w/ Handrail

## ROXHILL SKATESPOT

2850 SW Roxbury St. Seattle, Washington 98106

conceptual site plan B

11. 14. 2011



californiaskateparks.com



SAFE SPOT  
SKATE SPOT

# Plan C



## Park Features

- A. Entry Path
- B. Seat Wall/Ledge
- C. Ramp
- D. 5-Stair w/ Handrail
- E. Bank-to-Curb Over Ledge
- F. 2-Stair w/ Ramp
- G. Planter
- H. SLs Bench
- I. Banked Hip
- J. 4-Stair w/ SLs Hubba
- K. 3-Stair Handicap Rail



**ROXHILL SKATESPOT**

2850 SW Roxbury St. Seattle, Washington 98106

conceptual site plan C

11. 14. 2011



californiaskateparks.com

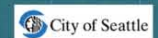

# Plan D

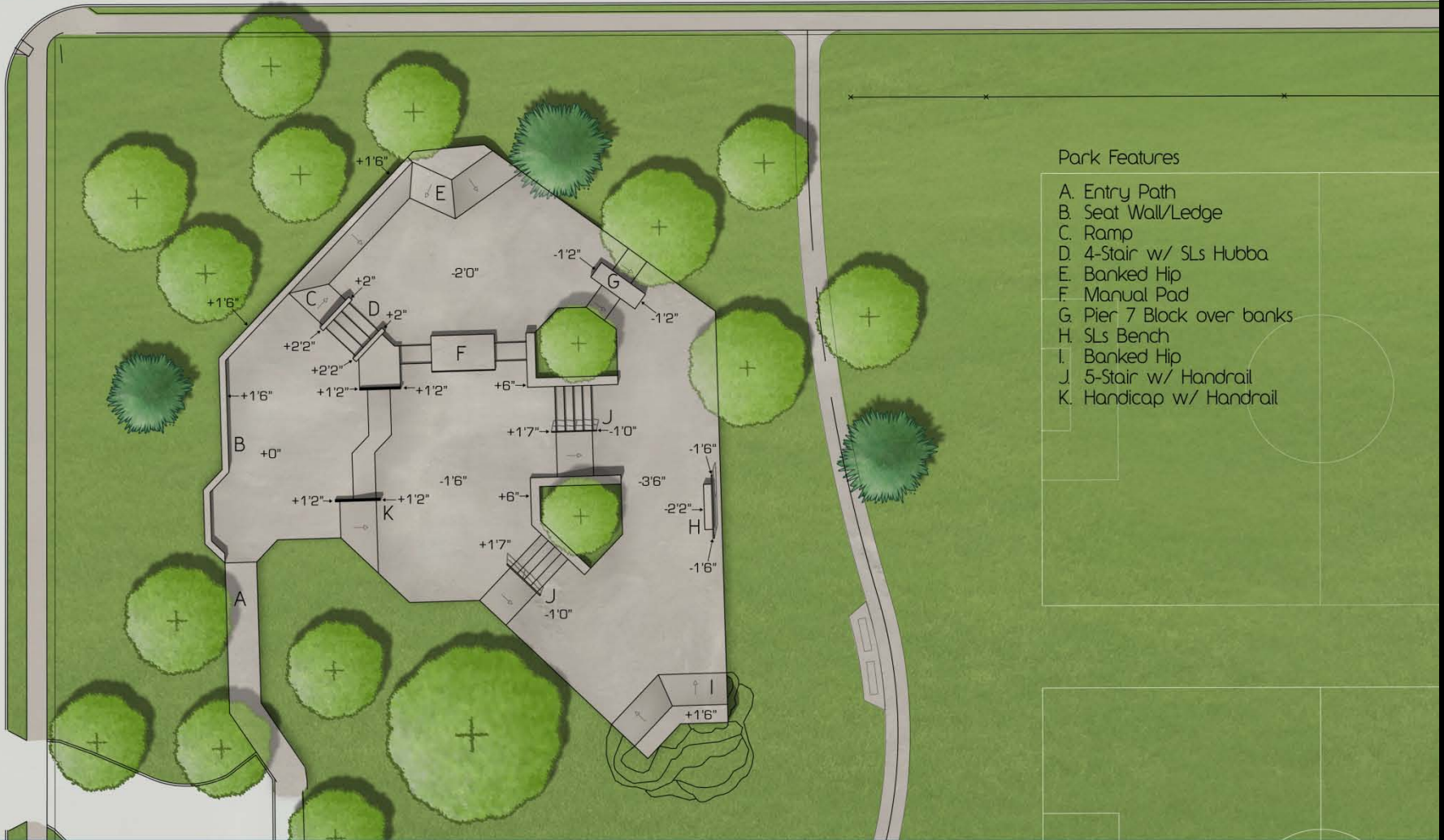

## Park Features

- A. Entry Path
- B. Seat Wall/Ledge
- C. Ramp
- D. 4-Stair w/ SLs Hubba
- E. Banked Hip
- F. Manual Pad
- G. Pier 7 Block over banks
- H. SLs Bench
- I. Banked Hip
- J. 5-Stair w/ Handrail
- K. Handicap w/ Handrail

## ROXHILL SKATESPOT

2850 SW Roxbury St. Seattle, Washington 98106

conceptual site plan D

11. 14. 2011



californiaskateparks.com

