

- Small trees, evergreen / deciduous mix
 - Interplant to reinforce seasonal interest
- MG***
- Acer Ginnala
 - Magnolia grandiflora
 - Malus imperialis
 - Malus sibirica
 - Nyssa sylvatica
 - Ostrya virginica
 - Pinus contorta
 - Pinus strobus
 - Pinus x Kuznetzi
 - Pinus x Sargentii
 - Pinus x yedoensis
 - Prunus Calleryana
 - Sortus alnifolia
 - Sortus Arta

- Heat-tolerant, seasonal interest
 - Foundation plants, south wall
- M**
- Arbutus Unedo
 - Chitalpa tashkentensis
 - Elaeagnus angustifolia
 - Eucalyptus pauciflora
 - Eucryphia x tymanensis
 - Lagerstremia indica

- Large shade tree, moist soil
 - New planting, frame walkway
- G***
- Acer x Freemanii Autumn Blaze®
 - Betula Jacquemontii
 - Betula nigra 'Heritage'
 - Fraxinus pennsylvanica
 - Liquidambar styraciflua
 - Nyssa sylvatica
 - Quercus shumardii

- Small tree, seasonal interest
 - Row of trees marking entry
- R**
- Cornus Kousa
 - Magnolia x Loebneri 'Merrill'
 - Malus spp. (refer to matrix)
 - Sortus Arta

- Water tolerant, focal point
 - Shore specimen replacement
- SP / G***
- Atlantibus altissima
 - Quailpa speciosa
 - Fraxinus oxy-carpa
 - Paulownia tomentosa
 - Populus alba

- Grand shade tree
 - Replace existing trees
- R**
- Fraxinus pennsylvanica
 - Quercus pedunculata
 - Tilia x euclyptora
 - Ulmus parvifolia 'Dynasty'

- Evergreen and deciduous mix with seasonal interest
 - Infill and replace existing grouping
- MG**
- Acer x Freemanii Autumn Blaze®
 - Acer saccharinum 'Legacy'
 - Cedrus deodara
 - Caragans x Lavalleyi
 - Cupressus arizonica var. glabra
 - Koeleria paniculata
 - Laburnum x Watereri
 - Picea omorika
 - Picea orientalis
 - Prunus 'Kuznetzi'
 - Prunus Sargentii
 - Prunus x yedoensis
 - Pyrus Calleryana
 - Sortus alnifolia
 - Sortus Arta
 - Tsuga Merriamiana

- Evergreen screen planting
 - Replace existing with mixed species
- M***
- Arbutus Unedo
 - Eucryphia x tymanensis
 - Myrica allagani
 - Rhus glabra
 - Taxus baccata 'Paucigala'
 - Tsuga Merriamiana

- Small trees with seasonal interest
 - Define entry, replace existing
- G***
- Cercis canadensis
 - Cornus Kousa
 - Cataegus Phacopyrum
 - Koeleria paniculata
 - Ostrya virginica
 - Pinus x yedoensis
 - Sortus alnifolia
 - Sortus Arta

- Large shade trees for beach
 - Interplant, informal spacing
- SP / G***
- Malus sibirica
 - Parrotia persica
 - Populus spp. (refer to matrix)
 - Quercus shumardii
 - Salix x sepulchralis 'Chrysocoma'
 - Taxodium distichum

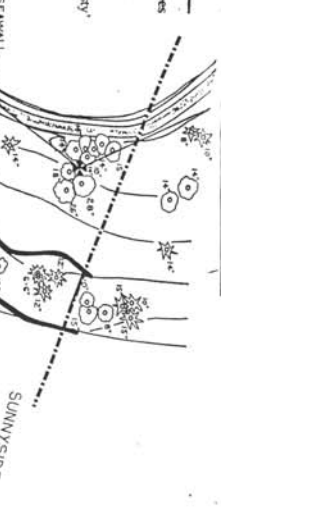
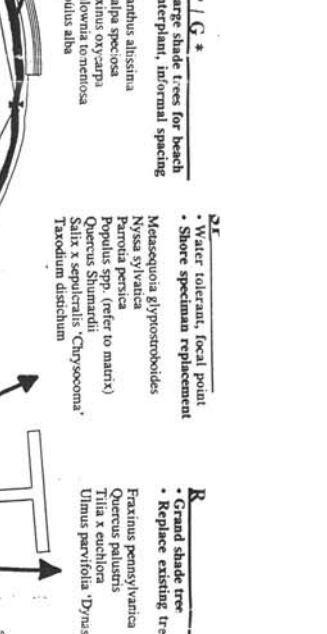
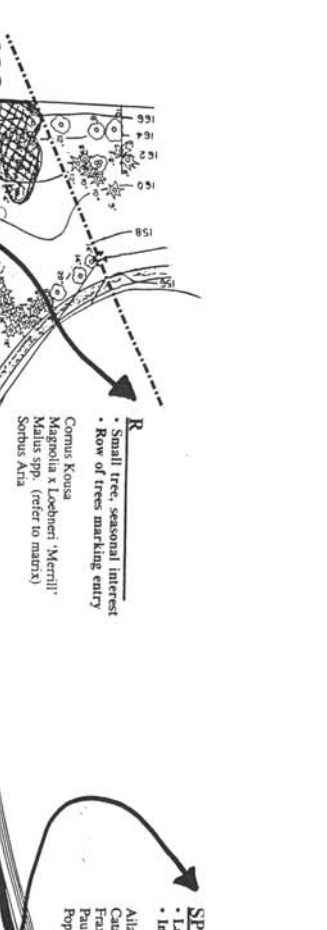
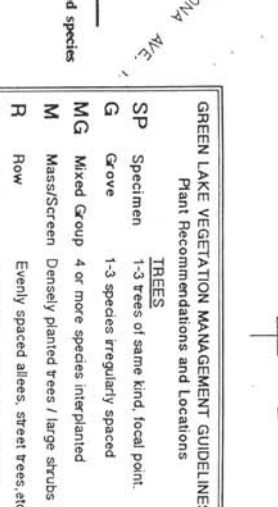
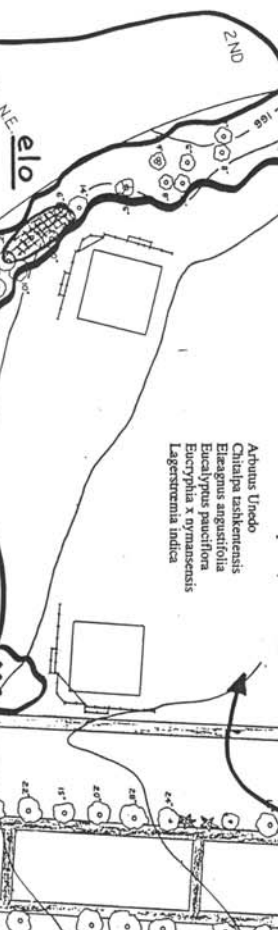

GREEN LAKE VEGETATION MANAGEMENT GUIDELINES

Plant Recommendations and Locations

TREES

SP Specimen 1-3 trees of same kind, focal point.

G Grove 1-3 species regularly spaced

MG Mixed Group 4 or more species interplanted

M Mass/Screen Densely planted trees / large shrubs

R Row Evenly spaced allees, street trees, etc.

***** Priority Most important planting additions.

UNDERSTORY

NOTE: Use Understory Matrix for species selection

c seasonal color m mass / screen s full sun

d dry-site n native sh shade

e evergreen o ornamental w wet-site

l low plants p pollution tolerant wi wildlife

GREEN LAKE PARK
Community Center

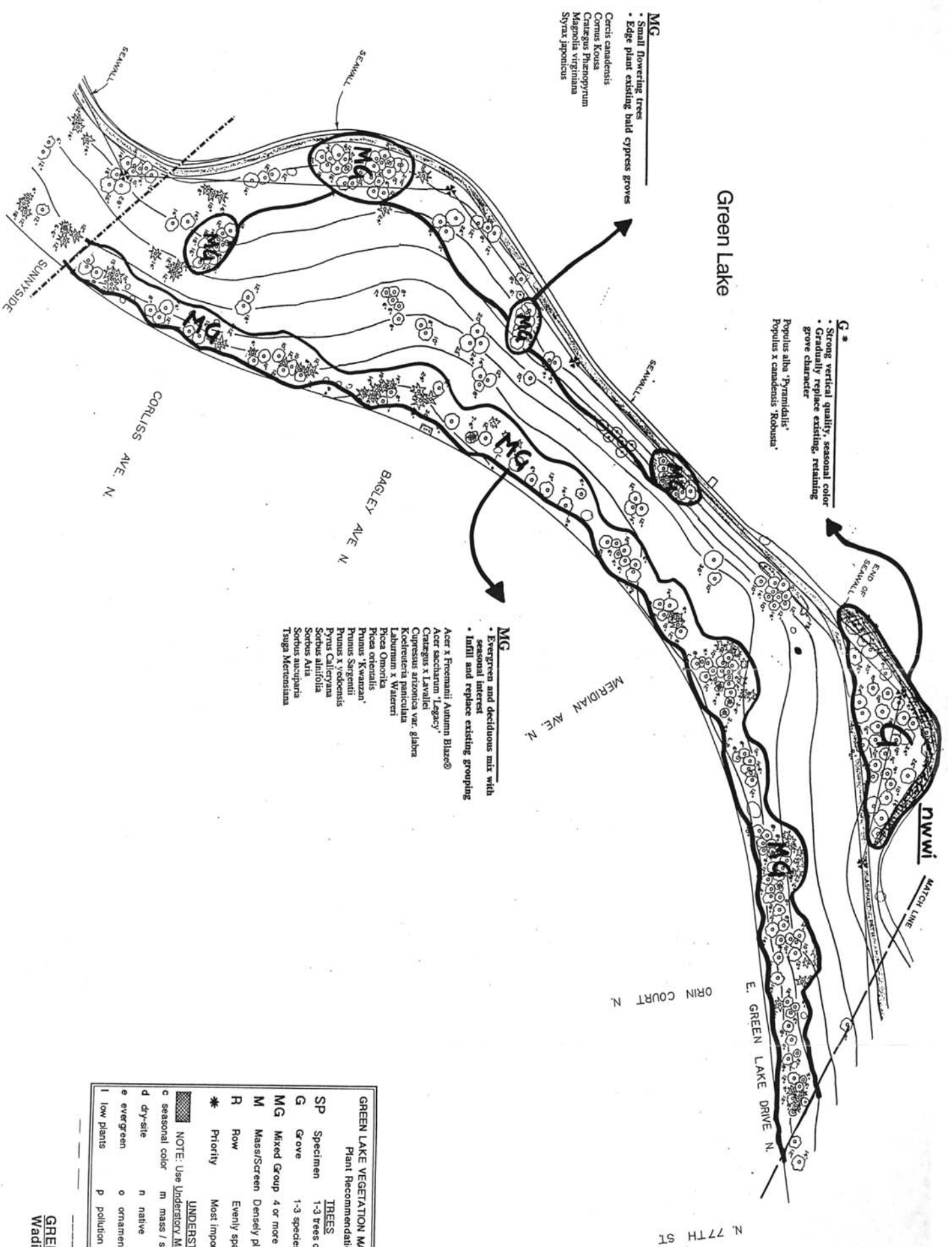

GREEN LAKE VEGETATION MANAGEMENT GUIDELINES
 Plant Recommendations and Locations

SP	Specimen	I TREES
G	Grove	1-3 trees of same kind, focal point.
MG	Mixed Group	1-3 species irregularly spaced
M	Mass/Screen	4 or more species interplanted
R	Row	Densely planted trees / large shrubs
*	Priority	Evenly spaced allees, street trees, etc.
		Most important planting additions.

UNDERSTORY	
c	seasonal color
d	dry-site
e	evergreen
l	low plants
m	mass / screen
n	native
o	ornamental
p	pollution tolerant
s	full sun
sh	shade
w	wet-site
wi	wildlife

NOTE: Use Understory Matrix for species selection

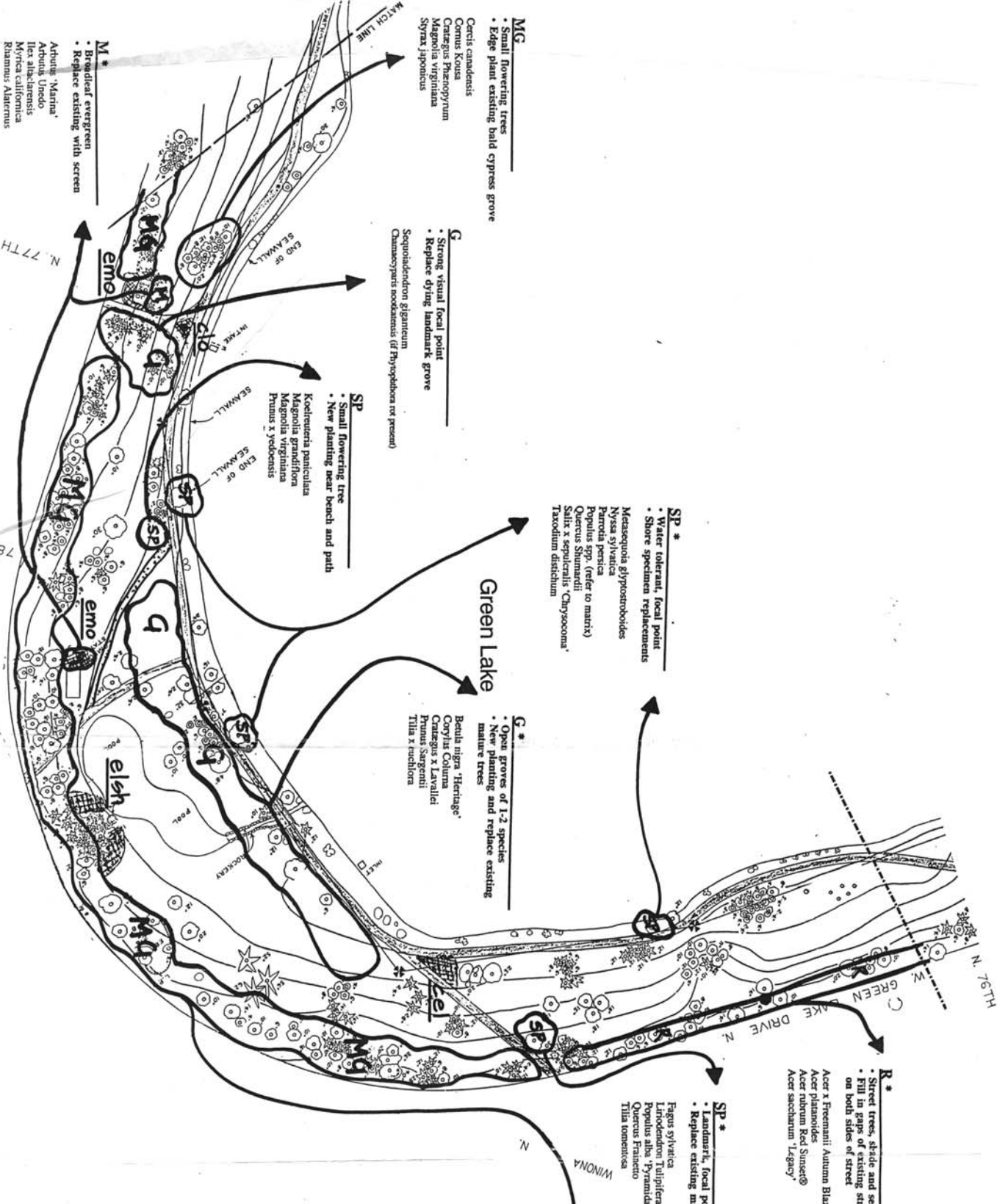

- MG**
- Small flowering trees
 - Edge plant existing bald cypress grove

Cercis canadensis
Cornus Kousa
Crataegus Pinnatifida
Magnolia virginiana
Syrinx japonicus

- G**
- Strong visual focal point
 - Replace dying landmark grove

Sequoia gigantea
Chamaecyparis nootkatensis (if *Phytosphaera* or present)

- SP**
- Small flowering tree
 - New planting near bench and path

Koeleria paniculata
Magnolia grandiflora
Magnolia virginiana
Prunus x yedoensis

- SP ***
- Water tolerant, focal point
 - Shore specimen replacements

Metasequoia glyptostroboides
Myrica sylvatica
Parrotia persica
Populus spp. (refer to matrix)
Quercus shumardii
Salix x sepulcralis 'Chrysocoma'
Taxodium distichum

Green Lake

- G***
- Open groves of 1-2 species
 - New planting and replace existing mature trees

Betula nigra 'Heritage'
Corylus Colurna
Crataegus x Lavallei
Prunus Sargentii
Tilia x euchlora

- R***
- Street trees, shade and seasonal color
 - Fill in gaps of existing street trees on both sides of street

Acer x Freemanii Autumn Blaze®
Acer platanoides
Acer rubrum Red Sunset®
Acer saccharum 'Legacy'

- SP ***
- Landmark, focal point
 - Replace existing mature specimen

Fagus sylvatica
Liriodendron Tulipifera
Populus alba 'Pyramidalis'
Quercus Franconia
Tilia tomentosa

- MG**
- Evergreen and deciduous mix with seasonal interest
 - Infill and replace existing grouping

Acer x Freemanii Autumn Blaze®
Acer saccharum 'Legacy'
Crataegus x Lavallei
Cupressus arizonica var. *glabra*
Koeleria paniculata
Laburnum x Waterii
Picea Omorika
Picea orientalis
Prunus 'Kawanaz'
Prunus Sargentii
Prunus x yedoensis
Pyrus Calleryana
Sorbus altilifolia
Sorbus Aria
Tsuga Mertensiana

GREEN LAKE VEGETATION MANAGEMENT GUIDELINES
 Plant Recommendations and Locations

TREES	
SP	Specimen
G	Grove
MG	Mixed Group
M	Mass/Screen
R	Row
*	Priority

NOTE: Use Understory Matrix for species selection

seasonal color	m	mass / screen	s	full sun
d	dry-site	n	native	sh shade
e	evergreen	o	ornamental	w wet-site
l	low plants	p	pollution tolerant	wi wildlife

UNDERSTORY
 Most important planting additions.

GREEN LAKE PARK
 Wading Pool - West

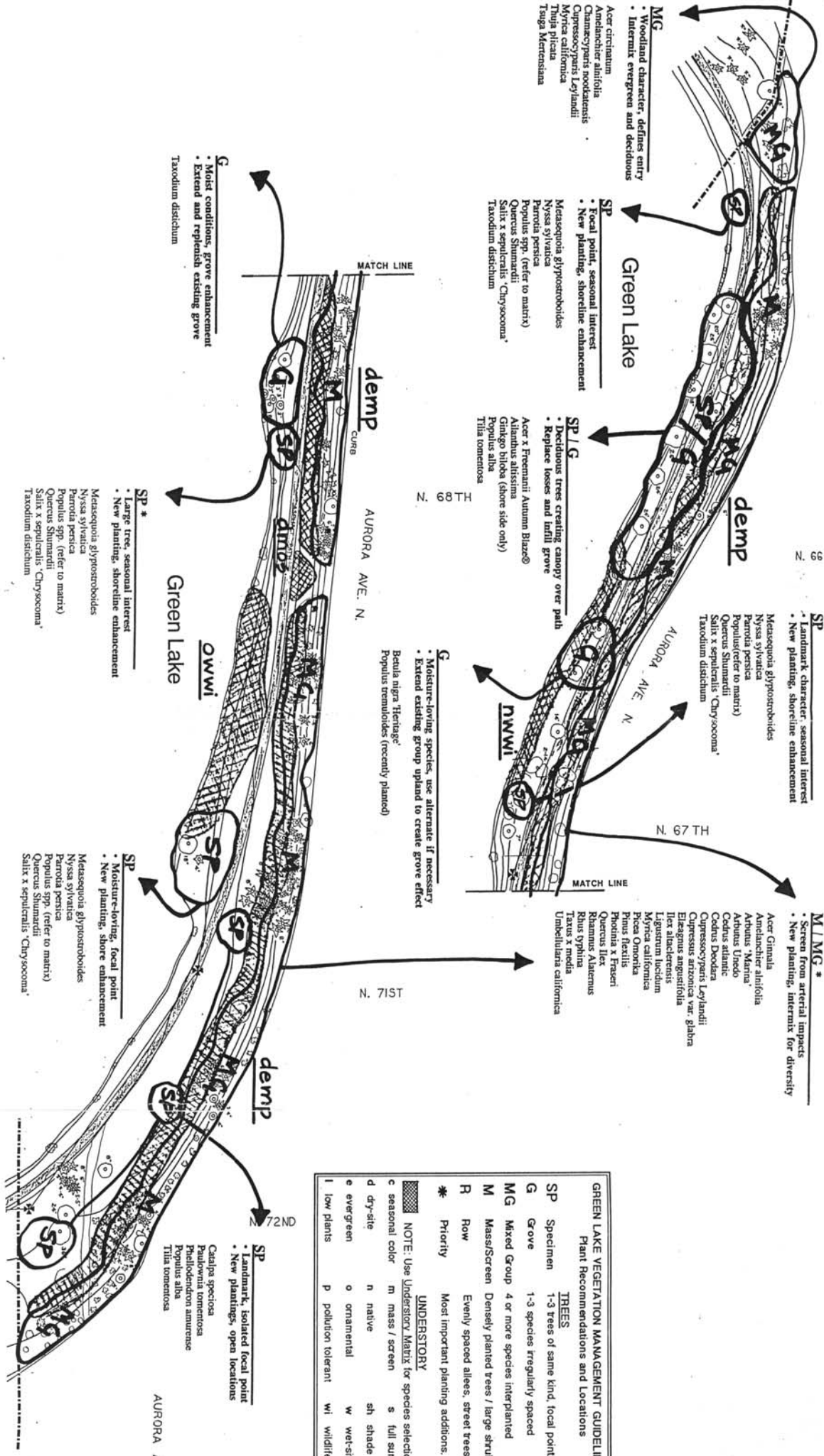

- MG**
- Woodland character, defines entry
 - Intermix evergreen and deciduous

- Green Lake**

- SP / G**
- Deciduous trees creating canopy over path
 - Replace losses and infill grove

- SP**
- Landmark character, seasonal interest
 - New planting, shoreline enhancement

- M/LMG ***
- Screen from arterial impacts
 - New planting, intermix for diversity

- Acer crinitatum**
Amenoclether alatifolia
Cammeocyparis nookatanensis
Caryocarpus Leylandii
Myrica californica
Tilia plicata
Tsuga heterostriata

- SP**
- Focal point, seasonal interest
 - New planting, shoreline enhancement
- Metasequoia glyptostroboides**
Nyssa sylvatica
Parrotia persica
Populus spp. (refer to matrix)
Quercus shumardii
Salix x sepulcralis 'Chrysoocoma'
Taxodium distichum

- SP / G**
- Deciduous trees creating canopy over path
 - Replace losses and infill grove
- Acer x Freemanii Autumn Blaze®**
Allanhus altissima
Ginkgo biloba (dwarf side only)
Populus alba
Tilia tomentosa

- SP**
- Landmark character, seasonal interest
 - New planting, shoreline enhancement
- Metasequoia glyptostroboides**
Nyssa sylvatica
Parrotia persica
Populus (refer to matrix)
Quercus shumardii
Salix x sepulcralis 'Chrysoocoma'
Taxodium distichum

- M/LMG ***
- Screen from arterial impacts
 - New planting, intermix for diversity
- Acer Ginnala**
Amenoclether alatifolia
Alnus incana
Alnus sibirica
Abies balsamea
Cedrus libani
Cedrus deodora
Caryocarpus Leylandii
Elaeagnus angustifolia
Ilex alba
Ligustrum lucidum
Myrica californica
Picea Omorika
Pinus flexilis
Phodinus x Fraseri
Quercus flex
Rhamnus Alaternus
Rhus typhina
Taxus x media
Umbellularia californica

- G**
- Moist conditions, grove enhancement
 - Extend and replenish existing grove
- Taxodium distichum**

- demp**

- SP / G**
- Deciduous trees creating canopy over path
 - Replace losses and infill grove
- Acer x Freemanii Autumn Blaze®**
Allanhus altissima
Ginkgo biloba (dwarf side only)
Populus alba
Tilia tomentosa

- G**
- Moisture-loving species, use alternate if necessary
 - Extend existing group upland to create grove effect
- Betula nigra 'Heritage'**
Populus tremuloides (recently planted)

- M/LMG ***
- Screen from arterial impacts
 - New planting, intermix for diversity
- Acer Ginnala**
Amenoclether alatifolia
Alnus incana
Alnus sibirica
Abies balsamea
Cedrus libani
Cedrus deodora
Caryocarpus Leylandii
Elaeagnus angustifolia
Ilex alba
Ligustrum lucidum
Myrica californica
Picea Omorika
Pinus flexilis
Phodinus x Fraseri
Quercus flex
Rhamnus Alaternus
Rhus typhina
Taxus x media
Umbellularia californica

- SP**
- Landmark, isolated focal point
 - New plantings, open locations
- Catalpa speciosa**
Paulownia tomentosa
Philadelphus amurensis
Populus alba
Tilia tomentosa

- SP**
- Large tree, seasonal interest
 - New planting, shoreline enhancement
- Metasequoia glyptostroboides**
Nyssa sylvatica
Parrotia persica
Populus spp. (refer to matrix)
Quercus shumardii
Salix x sepulcralis 'Chrysoocoma'
Taxodium distichum

GREEN LAKE VEGETATION MANAGEMENT GUIDELINES
 Plant Recommendations and Locations

Code	Tree Type	Planting Recommendation	Location
SP	Specimen	1-3 trees of same kind, focal point.	sh shade
G	Grove	1-3 species irregularly spaced	sh shade
MG	Mixed Group	4 or more species interplanted	sh shade
M	Mass/Screen	Densely planted trees / large shrubs	sh shade
R	Row	Evenly spaced allees, street trees, etc.	sh shade
*	Priority	Most important planting additions.	sh shade

UNDERSTORY

NOTE: Use Understory Matrix for species selection

Code	Plant Type	Planting Recommendation	Location
c	seasonal color	m mass / screen	s full sun
d	dry-site	n native	sh shade
e	evergreen	o ornamental	w wet-site
l	low plants	p pollution tolerant	wi wildlife

GREEN LAKE PARK
Aurora Strip

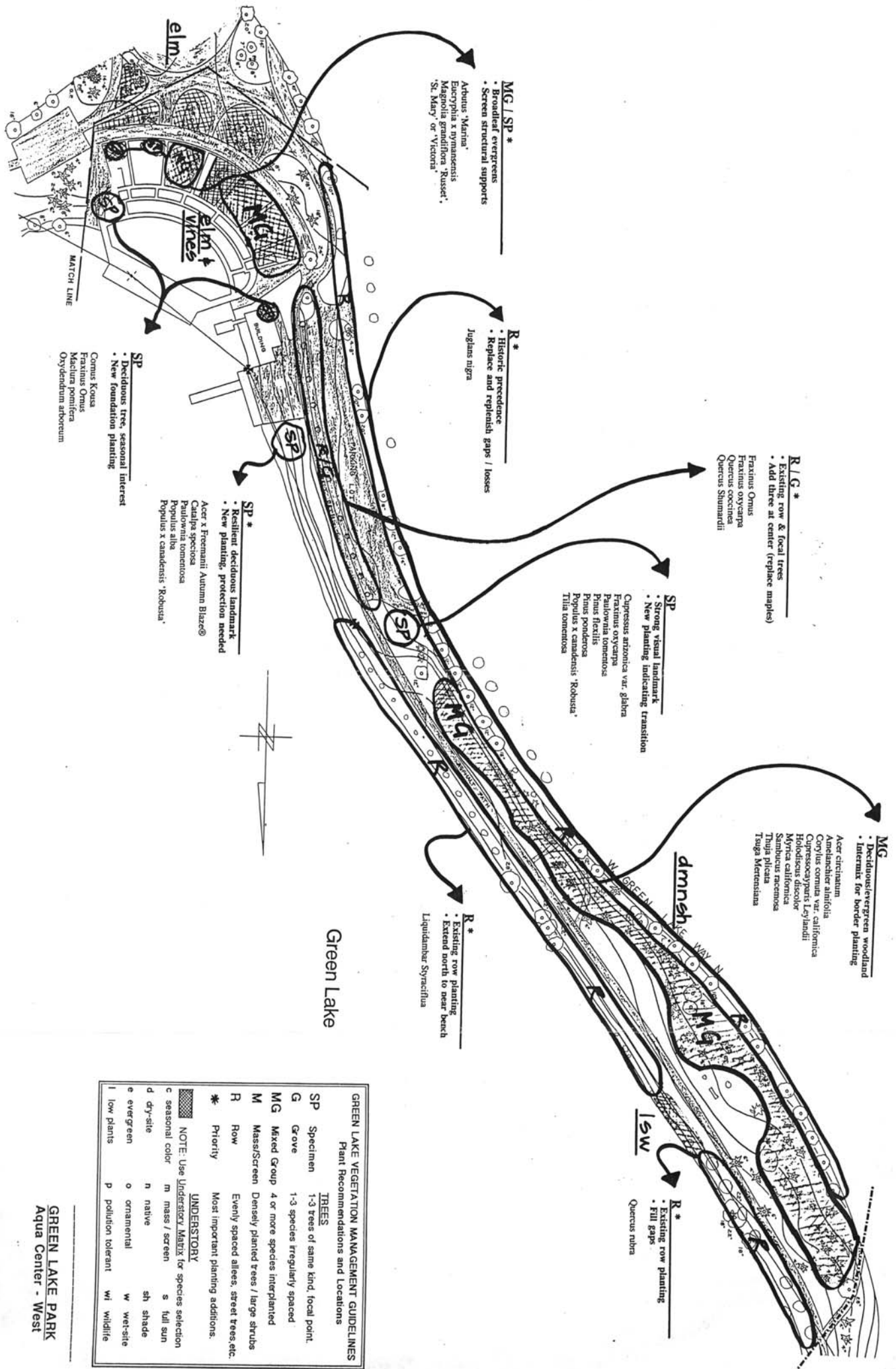

MG / SP *

- Broadleaf evergreens
- Screen structural supports

Arbutus 'Marina'
Eucalyptia x myrsinensis
Magnolia grandiflora 'Russel',
'St. Mary' or 'Victoria'

R *

- Historic precedence
- Replace and replenish gaps / losses

Juglans nigra

R/G *

- Existing row & focal trees
- Add three at center (replace maples)

Fraxinus Ornus
Fraxinus oycarpa
Quercus coccinea
Quercus shumardii

SP

- Strong visual landmark
- New planting indicating transition

Cupressus arizonica var. glabra
Fraxinus oycarpa
Palafoxia tomentosa
Pinus flexilis
Pinus ponderosa
Populus x canadensis 'Robusta'
Tilia domencosa

MG

- Deciduous/evergreen woodland
- Intermix for border planting

Acer circinnatum
Amsanchler alnifolia
Corylus cornua var. californica
Holochoseypars Laylandii
Myrica californica
Sambucus racemosa
Thuja nlica
Tuga Metensisana

R *

- Existing row planting
- Extend north to near bench

Liquidambar Syraciflua

R *

- Existing row planting
- Fill gaps

Quercus rubra

SP

- Deciduous tree, seasonal interest
- New foundation planting

Cornus Kousa
Fraxinus Ornus
Maclura pomifera
Oxydendrum arboresum

SP *

- Resilient deciduous landmark
- New planting, protection needed

Acer x Freemanii Autumn Blaze®
Catalpa speciosa
Palafoxia tomentosa
Populus alba
Populus x canadensis 'Robusta'

Green Lake

GREEN LAKE VEGETATION MANAGEMENT GUIDELINES
Plant Recommendations and Locations

TREES	
SP	Specimen 1-3 trees of same kind, focal point.
G	Grove 1-3 species irregularly spaced.
MG	Mixed Group 4 or more species interplanted.
M	Mass/Screen Densely planted trees / large shrubs.
R	Row Evenly spaced allees, street trees, etc.
*	Priority Most important planting additions.

UNDERSTORY

NOTE: Use Understory Matrix for species selection

Seasonal color	m	mass / screen	s	full sun	
d	dry-site	n	native	sh	shade
e	evergreen	o	ornamental	w	wet-site
l	low plants	p	pollution tolerant	wi	wildlife

GREEN LAKE PARK
Aqua Center - West

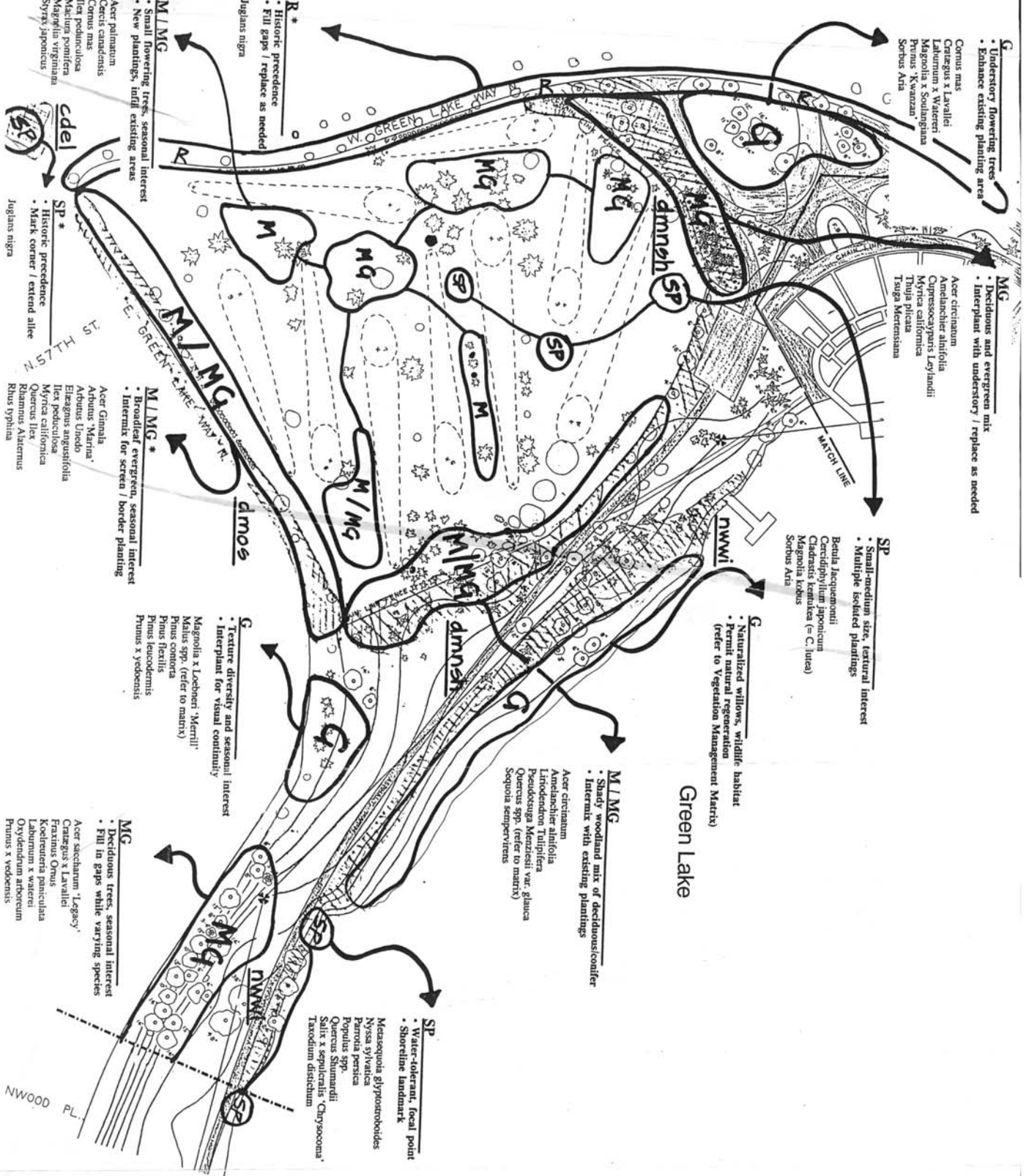

- G**
- Understory flowering trees
 - Enhance existing planting area
- MG**
- Deciduous and evergreen mix
 - Interplant with understory / replace as needed

- SP**
- Small-medium size, textural interest
 - Multiple isolated plantings

- G**
- Naturalized willows, wildlife habitat
 - Permit natural regeneration (refer to Vegetation Management Matrix)

- M/MG**
- Shady woodland mix of deciduous/conifer
 - Intermix with existing plantings

- SP**
- Water-tolerant, focal point
 - Shoreline landmark

- SP**
- Water-tolerant, focal point
 - Shoreline landmark

- M/MG**
- Broadleaf evergreen, seasonal interest
 - Intermix for screens / border planting

- G**
- Texture diversity and seasonal interest
 - Interplant for visual continuity

- MG**
- Deciduous trees, seasonal interest
 - Fill in gaps while varying species

- M/MG**
- Small flowering trees, seasonal interest
 - New plantings, infill existing areas

- SP**
- Historic precedence
 - Mark corner / extend allee

- G**
- Historic precedence
 - Kill gaps / replace as needed

- MG**
- Historic precedence
 - Mark corner / extend allee

GREEN LAKE VEGETATION MANAGEMENT GUIDELINES
Plant Recommendations and Locations

Code	Tree Type	Planting Recommendation	Location
SP	Specimen	1-3 trees of same kind, focal point.	
G	Grove	1-3 species irregularly spaced	
MG	Mixed Group	4 or more species interplanted	
M	Mass/Screen	Densely planted trees / large shrubs	
R	Row	Evenly spaced allees, street trees, etc.	
*	Priority	Most important planting additions.	

UNDERSTORY

NOTE: Use Understory Matrix for species selection

Code	Understory Matrix	Species Selection
c	seasonal color	m mass / screen
d	dry-site	n native
e	evergreen	o ornamental
l	low plants	p pollution tolerant
		w wet-site
		sh shade
		wi wildlife

GREEN LAKE PARK
Aqua Center - East

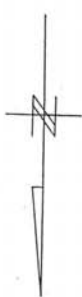
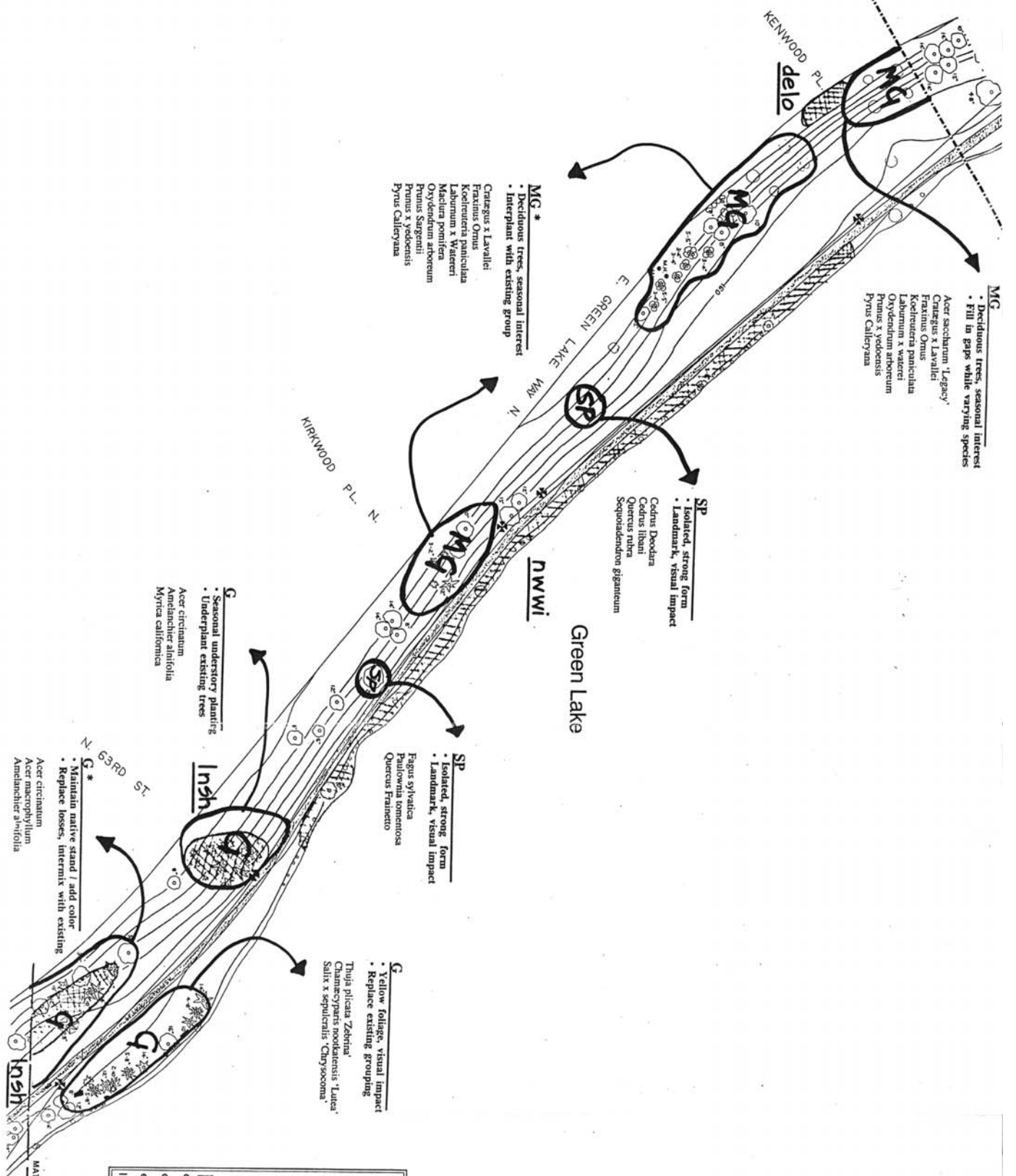

GREEN LAKE VEGETATION MANAGEMENT GUIDELINES
Plant Recommendations and Locations

Code	Plant Recommendation	Location
SP	Specimen	1-3 trees of same kind, focal point.
G	Grove	1-3 species regularly spaced
MG	Mixed Group	4 or more species interplanted
M	Mass/Screen	Densely planted trees / large shrubs
R	Row	Evenly spaced allees, street trees, etc.
*	Priority	Most important planting additions.

UNDERSTORY

NOTE: Use Understory Matrix for species selection

Code	Understory Matrix	Species Selection
c	seasonal color	m mass / screen
d	dry-site	n native
e	evergreen	o ornamental
l	low plants	p pollution tolerant
		w wet-site
		wi wildlife

GREEN LAKE PARK
Southeast Shore - West

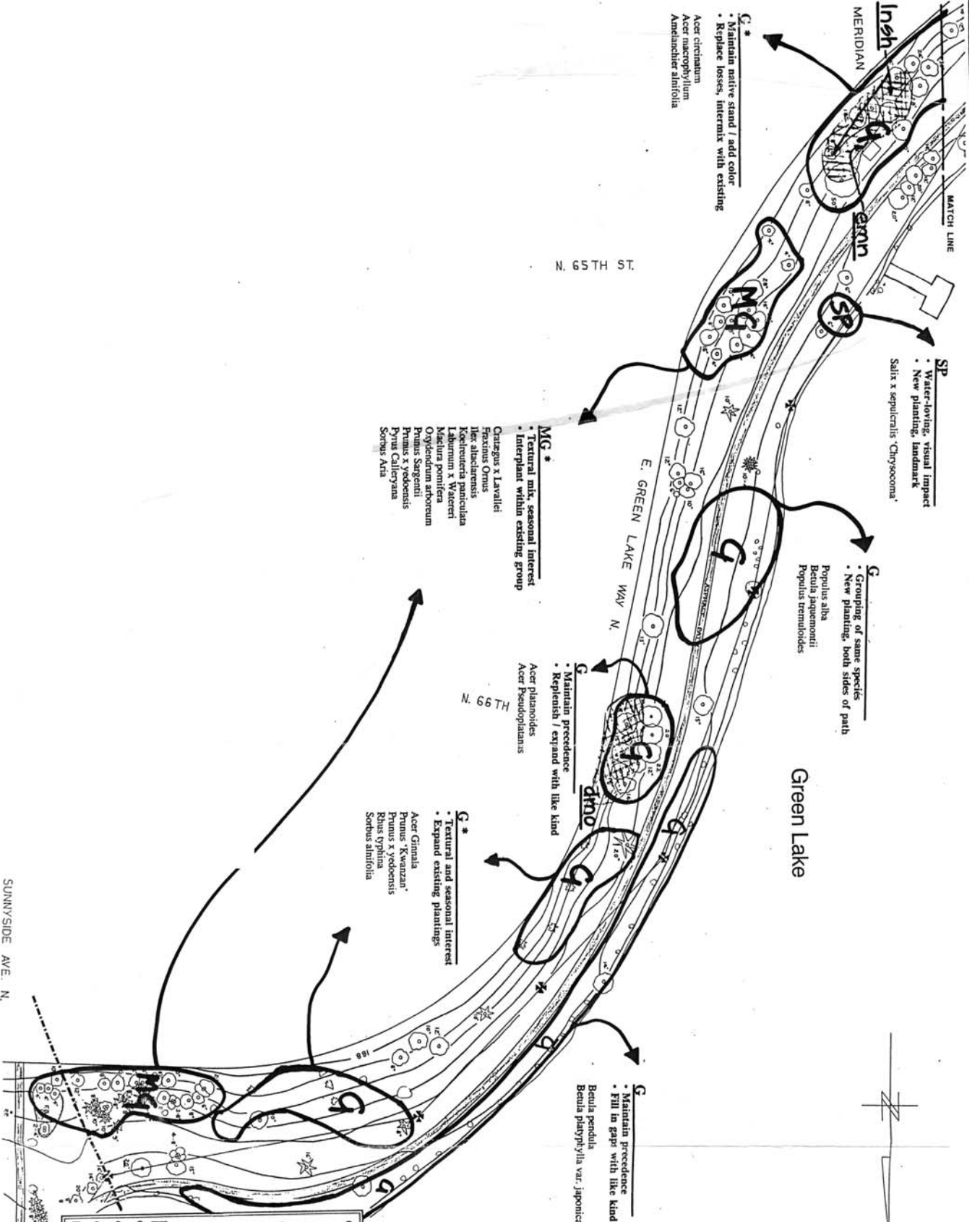

- G***
- Maintain native stand / add color
 - Replace losses, intermix with existing
- Acer circinnatum
Acer macrophyllum
Amelanchier alnifolia

- SP**
- Water-loving, visual impact
 - New planting, landmark
- Salix x sepulcralis 'Chrysoocoma'

- G**
- Grouping of same species
 - New planting, both sides of path
- Populus alba
Betula jaquemonii
Populus tremuloides

- MG***
- Textural mix, seasonal interest
 - Interplant within existing group
- Castanus x Lavallei
Fraxinus Ornus
Ilex albicarinata
Koeleria paniculata
Lilaburnum x Valenci
Mastura pomifera
Oxydendrum arboresum
Prunus Sargentii
Prunus x yedoensis
Pyrus Calleryana
Sorbus Aria

- G**
- Maintain precedence
 - Replenish / expand with like kind
- Acer platanoides
Acer Pseudoplatanus

- G***
- Textural and seasonal interest
 - Expand existing plantings
- Acer Ginnala
Prunus 'Kawanazai'
Prunus x yedoensis
Rhus typhina
Sorbus alnifolia

- G**
- Maintain precedence
 - Fill in gaps with like kind
- Betula pendula
Betula platyphylla var. japonica

GREEN LAKE VEGETATION MANAGEMENT GUIDELINES
Plant Recommendations and Locations

TREES	
SP	Specimen 1-3 trees of same kind, focal point.
G	Grove 1-3 species irregularly spaced
MG	Mixed Group 4 or more species interplanted
M	Mass/Screen Densely planted trees / large shrubs
R	Row Evenly spaced allees, street trees, etc.
*	Priority Most important planting additions.

UNDERSTORY					
NOTE: Use Understory Matrix for species selection					
c	seasonal color	m	mass / screen	s	full sun
d	dry-site	n	native	sh	shade
e	evergreen	o	ornamental	w	wet-site
l	low plants	p	pollution tolerant	wi	wildlife

SUNNYSIDE AVE. N.

GREEN LAKE PARK
Southeast Shore - East