



**DESIGN GUIDANCE
STREAMLINED DESIGN REVIEW**

Project Number: 3023453
Address: 5515 35th Avenue NE
Applicant: Elizabeth Maher, Architect
Date of Report: Wednesday, February 14, 2018
DPD Staff Present: Wayne Farrens

SITE & VICINITY

Site Zone: Neighborhood Commercial 1 (NC1-40)

Nearby Zones: The surrounding zoning is primarily single-family residential (SF5000). Neighborhood Commercial (NC1-40, NC1-30, and NC2P-40) and multifamily residential (LR1) zoning run along NE 55th Street, just south of the subject property.

Lot Description: The subject lot is 4,760 square feet in size and slopes up approximately five feet from 35th Avenue NE.

Current Development: The subject property is currently developed with a 1,270 square-foot single-family residence.

Surrounding Development and Neighborhood Character:

The subject property is located in the Bryant neighborhood within a small commercial cluster anchored along NE 55th Street. The adjacent property to the south is developed as a surface parking lot; the adjacent property to the north is developed with a one-story-with-attic single-family residence. The surrounding development consists primarily of single-family detached residences of varying architectural style. Most of the surrounding development is two stories in height; however, the block's topography raises many of the buildings up away from the street, increasing the perceived scale of development.

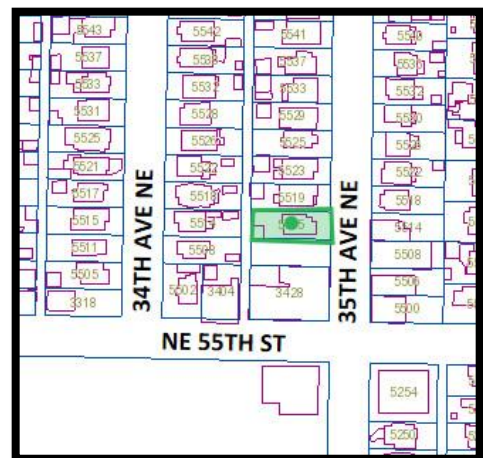

Access: The existing residence has pedestrian access from 35th Avenue NE and vehicular access from the alley at the rear of the property.

Environmentally Critical Areas:

The subject property is not located within an Environmentally Critical Area.

PROJECT DESCRIPTION

The applicant proposes to demolish the existing single-family residence and construct a four-story mixed-use building with 10 dwelling units above a 1,040 square-foot commercial space. The proposal provides four off-street parking spaces with access taken from the alley at the rear of the property.

PUBLIC COMMENT

The public comment period for the project closed on December 27, 2017. SDCI received a total of 17 comments regarding the proposal. The majority of comments received relate to parking and traffic concerns. Others commented on the scale of the building, impacts to private views, and changes to the existing landscaping.

All public comments submitted in writing for this project can be viewed using the following link and entering the project number: <http://web6.seattle.gov/dpd/edms/>

The purpose of the streamlined design review process is for SDCI to receive comments from the public, identify concerns about the site and design concept, identify applicable citywide and neighborhood design guidelines of highest priority to the site and explore conceptual design and siting alternatives. Concerns with off-street parking are addressed under the City’s zoning code and are not part of this review.

PRIORITIES & SDCI STAFF RECOMMENDATIONS

After visiting the site, considering the analysis of the site and context provided by the proponents, and hearing public comment, the Design Review Planner provided the following siting and design guidance. The Planner identified the Citywide Design Guidelines of highest priority for this project.

1. Building Scale:

- a. The project site is located on a zone transition from NC-1 to SF5000 (north and west of the subject property). Although the neighboring NC-zoned parcels are currently underdeveloped, the proposed four-story height is appropriate when located at or near the southern property line. However, the transition at the northern property line to single-family zoning requires a design that is sensitive to the change in scale. The following design guidance addresses this change in scale:

- i. Provide a five-foot landscape buffer along the northern property line, including new trees, to provide screening and to soften the transition to smaller scale development. (CS2-D, DC4-D, PL3-B-1)
- ii. Where possible, shift the building closer to the southern property line to provide a more generous side setback from the property to the north. (CS1-B-2, CS2-D-3,4,5)
- iii. Use an open stair instead of a stair penthouse to provide access to the roof deck, thereby reducing the height of the structure. (CS1-B-2, CS2-D-4)

2. Architectural Concept and Materials:

- a. Although higher density on surrounding properties is possible, the development pattern currently consists primarily of two-story structures. The architectural concept should reflect this existing pattern. Consider extending the ground floor qualities, including materials and zero south-side setback, to the second floor, creating two distinct volumes that relate to the scale and patterns found in the vicinity. (CS2-B-2, CS3-A-1, CS3-A-4)
- b. The proposed building will be the tallest structure on the subject block and is also located on a zone transition to single-family zoning. For these reasons, the building should attempt to minimize its perceived height. The use of brick and lap siding is appropriate, but the use of metal siding, and its vertical installation, draws extra attention to the height. Consider how material choices can further diminish the building's perceived height. (DC2-A-2, DC2-C-3)
- c. Use a canopy and other architectural features to better emphasize the residential entry. (PL3-A)
- d. The modulation and fenestration on the southern façade provide visual interest and reduce the perceived mass as viewed from NE 55th Street. Maintain these features as much as possible while responding to other design guidance. (DC2-A, DC2-B, DC2-C-1)
- e. The roof projection provides a strong building termination and is appropriately scaled. Maintain this feature and provide soffit details. (DC2-B-1)

3. Open Space and Landscaping:

- a. The retention of the large fir tree, as proposed, helps to soften the zone transition and is encouraged. Consider how this positive feature can be further emphasized. (CS1-D-1, CS2-D-2, DC4-D)
- b. The courtyard entry should feel intimate and welcoming. Use of landscaping, lighting, pavement, and secondary structures (trellises, seating, etc) can contribute to the quality of this space. Provide renderings of the courtyard. (PL3-A, DC3-B-4, DC4-D)
- c. Consider how future development on the adjacent property to the south may impact the quality of the proposed second-floor private amenity areas. Relocate and/or redesign to maximize the quality of these spaces throughout the lifetime of the building. (DC3-B-1,2, DC3-C-2)

- d. Provide pavement details for the pedestrian pathway. Choose materials that contribute to the courtyard setting such as brick or stone. (DC4-D-2)

4. Wayfinding:

- a. Use secondary architectural features (such as lighting, detailing, or paving) to provide a clear path to the residential entry. (PL2-D)
- b. Show business and address signage. (DC4-B)

DESIGN REVIEW GUIDELINES

The priority design guidelines identified as Priority Guidelines are summarized below, while all guidelines remain applicable. For the full text please visit the [Design Review website](#).

CONTEXT & SITE

CS1 Natural Systems and Site Features: Use natural systems/features of the site and its surroundings as a starting point for project design.

CS1-A Energy Use

CS1-A-1. Energy Choices: At the earliest phase of project development, examine how energy choices may influence building form, siting, and orientation, and factor in the findings when making siting and design decisions.

CS1-B Sunlight and Natural Ventilation

CS1-B-1. Sun and Wind: Take advantage of solar exposure and natural ventilation. Use local wind patterns and solar gain to reduce the need for mechanical ventilation and heating where possible.

CS1-B-2. Daylight and Shading: Maximize daylight for interior and exterior spaces and minimize shading on adjacent sites through the placement and/or design of structures on site.

CS1-B-3. Managing Solar Gain: Manage direct sunlight falling on south and west facing facades through shading devices and existing or newly planted trees.

CS1-C Topography

CS1-C-1. Land Form: Use natural topography and desirable landforms to inform project design.

CS1-C-2. Elevation Changes: Use the existing site topography when locating structures and open spaces on the site.

CS1-D Plants and Habitat

CS1-D-1. On-Site Features: Incorporate on-site natural habitats and landscape elements into project design and connect those features to existing networks of open spaces and natural habitats wherever possible. Consider relocating significant trees and vegetation if retention is not feasible.

CS1-D-2. Off-Site Features: Provide opportunities through design to connect to off-site habitats such as riparian corridors or existing urban forest corridors. Promote continuous habitat, where possible, and increase interconnected corridors of urban forest and habitat where possible.

CS1-E Water

CS1-E-1. Natural Water Features: If the site includes any natural water features, consider ways to incorporate them into project design, where feasible

CS1-E-2. Adding Interest with Project Drainage: Use project drainage systems as opportunities to add interest to the site through water-related design elements.

CS2 Urban Pattern and Form: Strengthen the most desirable forms, characteristics, and patterns of the streets, block faces, and open spaces in the surrounding area.

CS2-A Location in the City and Neighborhood

CS2-A-1. Sense of Place: Emphasize attributes that give a distinctive sense of place. Design the building and open spaces to enhance areas where a strong identity already exists, and create a sense of place where the physical context is less established.

CS2-A-2. Architectural Presence: Evaluate the degree of visibility or architectural presence that is appropriate or desired given the context, and design accordingly.

CS2-B Adjacent Sites, Streets, and Open Spaces

CS2-B-1. Site Characteristics: Allow characteristics of sites to inform the design, especially where the street grid and topography create unusually shaped lots that can add distinction to the building massing.

CS2-B-2. Connection to the Street: Identify opportunities for the project to make a strong connection to the street and public realm.

CS2-B-3. Character of Open Space: Contribute to the character and proportion of surrounding open spaces.

CS2-C Relationship to the Block

CS2-C-1. Corner Sites: Corner sites can serve as gateways or focal points; both require careful detailing at the first three floors due to their high visibility from two or more streets and long distances.

CS2-C-2. Mid-Block Sites: Look to the uses and scales of adjacent buildings for clues about how to design a mid-block building. Continue a strong street-edge and respond to datum lines of adjacent buildings at the first three floors.

CS2-C-3. Full Block Sites: Break up long facades of full-block buildings to avoid a monolithic presence. Provide detail and human scale at street-level, and include repeating elements to add variety and rhythm to the façade and overall building design.

CS2-D Height, Bulk, and Scale

CS2-D-1. Existing Development and Zoning: Review the height, bulk, and scale of neighboring buildings as well as the scale of development anticipated by zoning for the area to determine an appropriate complement and/or transition.

CS2-D-2. Existing Site Features: Use changes in topography, site shape, and vegetation or structures to help make a successful fit with adjacent properties.

CS2-D-3. Zone Transitions: For projects located at the edge of different zones, provide an appropriate transition or complement to the adjacent zone(s). Projects should create a step in perceived height, bulk and scale between the anticipated development potential of the adjacent zone and the proposed development.

CS2-D-4. Massing Choices: Strive for a successful transition between zones where a project abuts a less intense zone.

CS2-D-5. Respect for Adjacent Sites: Respect adjacent properties with design and site planning to minimize disrupting the privacy of residents in adjacent buildings.

CS3 Architectural Context and Character: Contribute to the architectural character of the neighborhood.

CS3-A Emphasizing Positive Neighborhood Attributes

CS3-A-1. Fitting Old and New Together: Create compatibility between new projects, and existing architectural context, including historic and modern designs, through building articulation, scale and proportion, roof forms, detailing, fenestration, and/or the use of complementary materials.

CS3-A-2. Contemporary Design: Explore how contemporary designs can contribute to the development of attractive new forms and architectural styles; as expressed through use of new materials or other means.

CS3-A-3. Established Neighborhoods: In existing neighborhoods with a well-defined architectural character, site and design new structures to complement or be compatible with the architectural style and siting patterns of neighborhood buildings.

CS3-A-4. Evolving Neighborhoods: In neighborhoods where architectural character is evolving or otherwise in transition, explore ways for new development to establish a positive and desirable context for others to build upon in the future.

CS3-B Local History and Culture

CS3-B-1. Placemaking: Explore the history of the site and neighborhood as a potential placemaking opportunity. Look for historical and cultural significance, using neighborhood groups and archives as resources.

CS3-B-2. Historical/Cultural References: Reuse existing structures on the site where feasible as a means of incorporating historical or cultural elements into the new project.

PUBLIC LIFE

PL1 Connectivity: Complement and contribute to the network of open spaces around the site and the connections among them.

PL1-A Network of Open Spaces

PL1-A-1. Enhancing Open Space: Design the building and open spaces to positively contribute to a broader network of open spaces throughout the neighborhood.

PL1-A-2. Adding to Public Life: Seek opportunities to foster human interaction through an increase in the size and quality of project-related open space available for public life.

PL1-B Walkways and Connections

PL1-B-1. Pedestrian Infrastructure: Connect on-site pedestrian walkways with existing public and private pedestrian infrastructure, thereby supporting pedestrian connections within and outside the project.

PL1-B-2. Pedestrian Volumes: Provide ample space for pedestrian flow and circulation, particularly in areas where there is already heavy pedestrian traffic or where the project is expected to add or attract pedestrians to the area.

PL1-B-3. Pedestrian Amenities: Opportunities for creating lively, pedestrian oriented open spaces to enliven the area and attract interest and interaction with the site and building should be considered.

PL1-C Outdoor Uses and Activities

PL1-C-1. Selecting Activity Areas: Concentrate activity areas in places with sunny exposure, views across spaces, and in direct line with pedestrian routes.

PL1-C-2. Informal Community Uses: In addition to places for walking and sitting, consider including space for informal community use such as performances, farmer’s markets, kiosks and community bulletin boards, cafes, or street vending.

PL1-C-3. Year-Round Activity: Where possible, include features in open spaces for activities beyond daylight hours and throughout the seasons of the year, especially in neighborhood centers where active open space will contribute vibrancy, economic health, and public safety.

PL2 Walkability: Create a safe and comfortable walking environment that is easy to navigate and well-connected to existing pedestrian walkways and features.

PL2-A Accessibility

PL2-A-1. Access for All: Provide access for people of all abilities in a manner that is fully integrated into the project design. Design entries and other primary access points such that all visitors can be greeted and welcomed through the front door.

PL2-A-2. Access Challenges: Add features to assist pedestrians in navigating sloped sites, long blocks, or other challenges.

PL2-B Safety and Security

PL2-B-1. Eyes on the Street: Create a safe environment by providing lines of sight and encouraging natural surveillance.

PL2-B-2. Lighting for Safety: Provide lighting at sufficient lumen intensities and scales, including pathway illumination, pedestrian and entry lighting, and/or security lights.

PL2-B-3. Street-Level Transparency: Ensure transparency of street-level uses (for uses such as nonresidential uses or residential lobbies), where appropriate, by keeping views open into spaces behind walls or plantings, at corners, or along narrow passageways.

PL2-C Weather Protection

PL2-C-1. Locations and Coverage: Overhead weather protection is encouraged and should be located at or near uses that generate pedestrian activity such as entries, retail uses, and transit stops.

PL2-C-2. Design Integration: Integrate weather protection, gutters and downspouts into the design of the structure as a whole, and ensure that it also relates well to neighboring buildings in design, coverage, or other features.

PL2-C-3. People-Friendly Spaces: Create an artful and people-friendly space beneath building.

PL2-D Wayfinding

PL2-D-1. Design as Wayfinding: Use design features as a means of wayfinding wherever possible.

PL3 Street-Level Interaction: Encourage human interaction and activity at the street-level with clear connections to building entries and edges.

PL3-A Entries

PL3-A-1. Design Objectives: Design primary entries to be obvious, identifiable, and distinctive with clear lines of sight and lobbies visually connected to the street.

PL3-A-2. Common Entries: Multi-story residential buildings need to provide privacy and security for residents but also be welcoming and identifiable to visitors.

PL3-A-3. Individual Entries: Ground-related housing should be scaled and detailed appropriately to provide for a more intimate type of entry.

PL3-A-4. Ensemble of Elements: Design the entry as a collection of coordinated elements including the door(s), overhead features, ground surface, landscaping, lighting, and other features.

PL3-B Residential Edges

PL3-B-1. Security and Privacy: Provide security and privacy for residential buildings through the use of a buffer or semi-private space between the development and the street or neighboring buildings.

PL3-B-2. Ground-level Residential: Privacy and security issues are particularly important in buildings with ground-level housing, both at entries and where windows are located overlooking the street.

PL3-B-3. Buildings with Live/Work Uses: Maintain active and transparent facades in the design of live/work residences. Design the first floor so it can be adapted to other commercial use as needed in the future.

PL3-B-4. Interaction: Provide opportunities for interaction among residents and neighbors.

PL3-C Retail Edges

PL3-C-1. Porous Edge: Engage passersby with opportunities to interact visually with the building interior using glazing and transparency. Create multiple entries where possible and make a physical and visual connection between people on the sidewalk and retail activities in the building.

PL3-C-2. Visibility: Maximize visibility into the building interior and merchandise displays. Consider fully operational glazed wall-sized doors that can be completely opened to the street, increased height in lobbies, and/or special lighting for displays.

PL3-C-3. Ancillary Activities: Allow space for activities such as sidewalk vending, seating, and restaurant dining to occur. Consider setting structures back from the street or incorporating space in the project design into which retail uses can extend.

PL4 Active Transportation: Incorporate design features that facilitate active forms of transportation such as walking, bicycling, and use of transit.

PL4-A Entry Locations and Relationships

PL4-A-1. Serving all Modes of Travel: Provide safe and convenient access points for all modes of travel.

PL4-A-2. Connections to All Modes: Site the primary entry in a location that logically relates to building uses and clearly connects all major points of access.

PL4-B Planning Ahead for Bicyclists

PL4-B-1. Early Planning: Consider existing and future bicycle traffic to and through the site early in the process so that access and connections are integrated into the project along with other modes of travel.

PL4-B-2. Bike Facilities: Facilities such as bike racks and storage, bike share stations, shower facilities and lockers for bicyclists should be located to maximize convenience, security, and safety.

PL4-B-3. Bike Connections: Facilitate connections to bicycle trails and infrastructure around and beyond the project.

PL4-C Planning Ahead For Transit

PL4-C-1. Influence on Project Design: Identify how a transit stop (planned or built) adjacent to or near the site may influence project design, provide opportunities for placemaking.

PL4-C-2. On-site Transit Stops: If a transit stop is located onsite, design project-related pedestrian improvements and amenities so that they complement any amenities provided for transit riders.

PL4-C-3. Transit Connections: Where no transit stops are on or adjacent to the site, identify where the nearest transit stops and pedestrian routes are and include design features and connections within the project design as appropriate.

DESIGN CONCEPT

DC1 Project Uses and Activities: Optimize the arrangement of uses and activities on site.

DC1-A Arrangement of Interior Uses

DC1-A-1. Visibility: Locate uses and services frequently used by the public in visible or prominent areas, such as at entries or along the street front.

DC1-A-2. Gathering Places: Maximize the use of any interior or exterior gathering spaces.

DC1-A-3. Flexibility: Build in flexibility so the building can adapt over time to evolving needs, such as the ability to change residential space to commercial space as needed.

DC1-A-4. Views and Connections: Locate interior uses and activities to take advantage of views and physical connections to exterior spaces and uses.

DC1-B Vehicular Access and Circulation

DC1-B-1. Access Location and Design: Choose locations for vehicular access, service uses, and delivery areas that minimize conflict between vehicles and non-motorists wherever possible. Emphasize use of the sidewalk for pedestrians, and create safe and attractive conditions for pedestrians, bicyclists, and drivers.

DC1-B-2. Facilities for Alternative Transportation: Locate facilities for alternative transportation in prominent locations that are convenient and readily accessible to expected users.

DC1-C Parking and Service Uses

DC1-C-1. Below-Grade Parking: Locate parking below grade wherever possible. Where a surface parking lot is the only alternative, locate the parking in rear or side yards, or on lower or less visible portions of the site.

DC1-C-2. Visual Impacts: Reduce the visual impacts of parking lots, parking structures, entrances, and related signs and equipment as much as possible.

DC1-C-3. Multiple Uses: Design parking areas to serve multiple uses such as children’s play space, outdoor gathering areas, sports courts, woonerf, or common space in multifamily projects.

DC1-C-4. Service Uses: Locate and design service entries, loading docks, and trash receptacles away from pedestrian areas or to a less visible portion of the site to reduce possible impacts of these facilities on building aesthetics and pedestrian circulation.

DC2 Architectural Concept: Develop an architectural concept that will result in a unified and functional design that fits well on the site and within its surroundings.

DC2-A Massing

DC2-A-1. Site Characteristics and Uses: Arrange the mass of the building taking into consideration the characteristics of the site and the proposed uses of the building and its open space.

DC2-A-2. Reducing Perceived Mass: Use secondary architectural elements to reduce the perceived mass of larger projects.

DC2-B Architectural and Facade Composition

DC2-B-1. Façade Composition: Design all building facades—including alleys and visible roofs— considering the composition and architectural expression of the building as a whole. Ensure that all facades are attractive and well-proportioned.

DC2-B-2. Blank Walls: Avoid large blank walls along visible façades wherever possible. Where expanses of blank walls, retaining walls, or garage facades are unavoidable, include uses or design treatments at the street level that have human scale and are designed for pedestrians.

DC2-C Secondary Architectural Features

DC2-C-1. Visual Depth and Interest: Add depth to facades where appropriate by incorporating balconies, canopies, awnings, decks, or other secondary elements into the façade design. Add detailing at the street level in order to create interest for the pedestrian and encourage active street life and window shopping (in retail areas).

DC2-C-2. Dual Purpose Elements: Consider architectural features that can be dual purpose— adding depth, texture, and scale as well as serving other project functions.

DC2-C-3. Fit With Neighboring Buildings: Use design elements to achieve a successful fit between a building and its neighbors.

DC2-D Scale and Texture

DC2-D-1. Human Scale: Incorporate architectural features, elements, and details that are of human scale into the building facades, entries, retaining walls, courtyards, and exterior spaces in a manner that is consistent with the overall architectural concept

DC2-D-2. Texture: Design the character of the building, as expressed in the form, scale, and materials, to strive for a fine-grained scale, or “texture,” particularly at the street level and other areas where pedestrians predominate.

DC2-E Form and Function

DC2-E-1. Legibility and Flexibility: Strive for a balance between building use legibility and flexibility. Design buildings such that their primary functions and uses can be readily determined from the exterior, making the building easy to access and understand. At the

same time, design flexibility into the building so that it may remain useful over time even as specific programmatic needs evolve.

DC3 Open Space Concept: Integrate open space design with the building design so that they complement each other.

DC3-A Building-Open Space Relationship

DC3-A-1. Interior/Exterior Fit: Develop an open space concept in conjunction with the architectural concept to ensure that interior and exterior spaces relate well to each other and support the functions of the development.

DC3-B Open Space Uses and Activities

DC3-B-1. Meeting User Needs: Plan the size, uses, activities, and features of each open space to meet the needs of expected users, ensuring each space has a purpose and function.

DC3-B-2. Matching Uses to Conditions: Respond to changing environmental conditions such as seasonal and daily light and weather shifts through open space design and/or programming of open space activities.

DC3-B-3. Connections to Other Open Space: Site and design project-related open spaces to connect with, or enhance, the uses and activities of other nearby public open space where appropriate.

DC3-B-4. Multifamily Open Space: Design common and private open spaces in multifamily projects for use by all residents to encourage physical activity and social interaction.

DC3-C Design

DC3-C-1. Reinforce Existing Open Space: Where a strong open space concept exists in the neighborhood, reinforce existing character and patterns of street tree planting, buffers or treatment of topographic changes. Where no strong patterns exist, initiate a strong open space concept that other projects can build upon in the future.

DC3-C-2. Amenities/Features: Create attractive outdoor spaces suited to the uses envisioned for the project.

DC3-C-3. Support Natural Areas: Create an open space design that retains and enhances onsite natural areas and connects to natural areas that may exist off-site and may provide habitat for wildlife.

DC4 Exterior Elements and Finishes: Use appropriate and high quality elements and finishes for the building and its open spaces.

DC4-A Exterior Elements and Finishes

DC4-A-1. Exterior Finish Materials: Building exteriors should be constructed of durable and maintainable materials that are attractive even when viewed up close. Materials that have texture, pattern, or lend themselves to a high quality of detailing are encouraged.

DC4-A-2. Climate Appropriateness: Select durable and attractive materials that will age well in Seattle's climate, taking special care to detail corners, edges, and transitions.

DC4-B Signage

DC4-B-1. Scale and Character: Add interest to the streetscape with exterior signs and attachments that are appropriate in scale and character to the project and its environs.

DC4-B-2. Coordination with Project Design: Develop a signage plan within the context of architectural and open space concepts, and coordinate the details with façade design, lighting, and other project features to complement the project as a whole, in addition to the surrounding context.

DC4-C Lighting

DC4-C-1. Functions: Use lighting both to increase site safety in all locations used by pedestrians and to highlight architectural or landscape details and features such as entries, signs, canopies, plantings, and art.

DC4-C-2. Avoiding Glare: Design project lighting based upon the uses on and off site, taking care to provide illumination to serve building needs while avoiding off-site night glare and light pollution.

DC4-D Trees, Landscape, and Hardscape Materials

DC4-D-1. Choice of Plant Materials: Reinforce the overall architectural and open space design concepts through the selection of landscape materials.

DC4-D-2. Hardscape Materials: Use exterior courtyards, plazas, and other hard surfaced areas as an opportunity to add color, texture, and/or pattern and enliven public areas through the use of distinctive and durable paving materials. Use permeable materials wherever possible.

DC4-D-3. Long Range Planning: Select plants that upon maturity will be of appropriate size, scale, and shape to contribute to the site as intended.

DC4-D-4. Place Making: Create a landscape design that helps define spaces with significant elements such as trees.

DC4-E Project Assembly and Lifespan

DC4-E-1. Deconstruction: When possible, design the project so that it may be deconstructed at the end of its useful lifetime, with connections and assembly techniques that will allow reuse of materials.

DEVELOPMENT STANDARD ADJUSTMENTS

Design Review Staff’s recommendation on the requested adjustment(s) will be based upon the adjustment’s potential to help the project better meet these design guideline priorities and achieve a better overall design than could be achieved without the adjustment(s).

At the time of Design Guidance, the following adjustments were requested:

- 1. Reduction of 15’-0” Residential Setback Above 13’-0” (SMC 23.47A.014.B2):** The Code requires a 15-foot setback above 13 feet in height where a Neighborhood Commercial lot abuts a single-family lot.

The applicant proposes a 12-foot setback from the northern property line. A side setback ranging from three feet to seven-and-a-half feet is proposed along the southern property line, where none is required.

DPD staff indicated that the proposed south side setback improves the quality of the design as it will allow for modulation and glazing along the prominent southern façade. DPD staff is aware that pushing the building to the southern property line would eliminate these features, resulting in a large blank wall that would be highly visible until surrounding development intensifies. However, as currently proposed, the requested adjustment is not justified as the project does not adequately address the transition to single-family zoning. The design guidance provided in this report will help achieve a more successful zone transition. For these reasons, DPD staff is supportive of the requested adjustment contingent upon the design guidance contained in this report being followed.

- 2. Encroachment into the 15' Triangular Setback at the Street (SMC 23.47A.014B):** The Code requires a 15-foot triangular setback where a Neighborhood Commercial lot abuts a Single Family lot.

The applicant proposes to project approximately two feet into this required setback at the roof level only (approximately 46 feet above sidewalk level).

DPD staff indicated that the slight roof projection into the triangular setback contributes positively to the design and keeps with the intent of the code requirement as the setback area beneath the roof remains clear. Furthermore, as noted above, the project provides a side setback ranging from three to seven-and-a-half feet along the southern property line where none is required. This allows for modulation and glazing along the prominent southern façade that would not be possible if the building were pushed to the southern property line. For these reasons, DPD staff is supportive of the requested adjustment.

STAFF DIRECTION

At the conclusion of the Design Guidance, the DPD Staff recommended the project should move forward to building permit application in response to the Design Guidance provided.

1. Please be aware that this report is an assessment on how the project is meeting the intent of the Design Guidelines. This review does not include a full zoning review. Zoning review will occur when the MUP plans and/or building permit is submitted. If needed and where applicable, SDR adjustments may be requested in response to zoning corrections.
2. If applicable, please prepare your Master Use Permit for SEPA review with a thorough zoning analysis listing the 23.45 and SMC 23.54 code section criteria, showing both required and proposed information (include page number where you graphically show compliance). You may want to review Tip 201 (<http://web1.seattle.gov/dpd/cams/CamList.aspx>) and may also want to review the MUP information here: <http://www.seattle.gov/dpd/permits/permittypes/mupoverview/default.htm>

3. Along with your building permit application, please include a narrative response to the guidance provided in this report. This response should be submitted both as a separate document and included in the plans.
4. All requested adjustments must be clearly documented in the building permit plans.
5. Provide color elevations and additional perspective renderings in the building permit plans.