

Thomas Street Green Street
Background Presentation and Discussion
March, 2010

Context - SLU Urban Design Framework

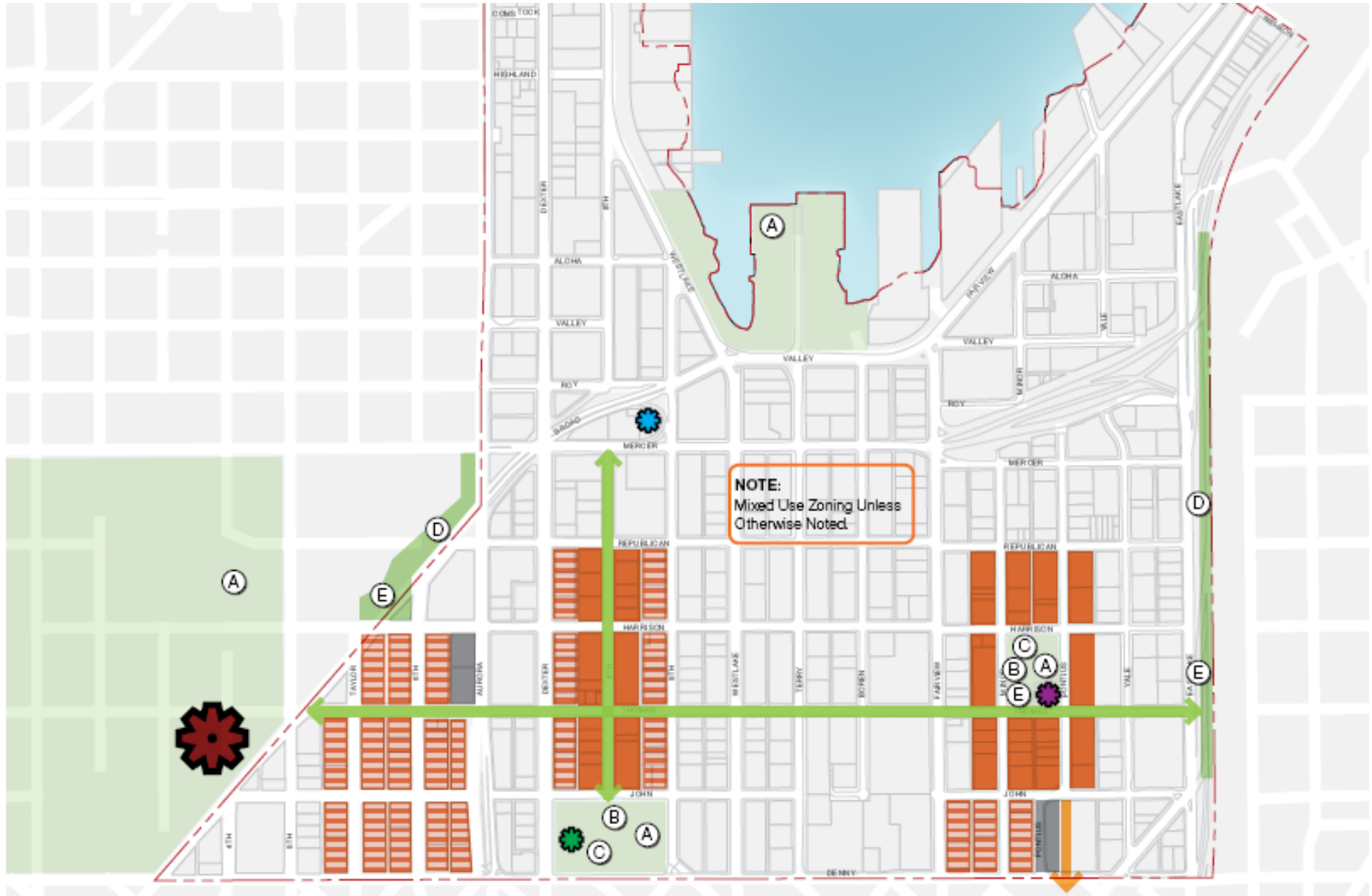

Context - Uptown Design Guidelines



Context - Aurora Avenue and the North Portal



Context – Community Based Uptown Loop Concept

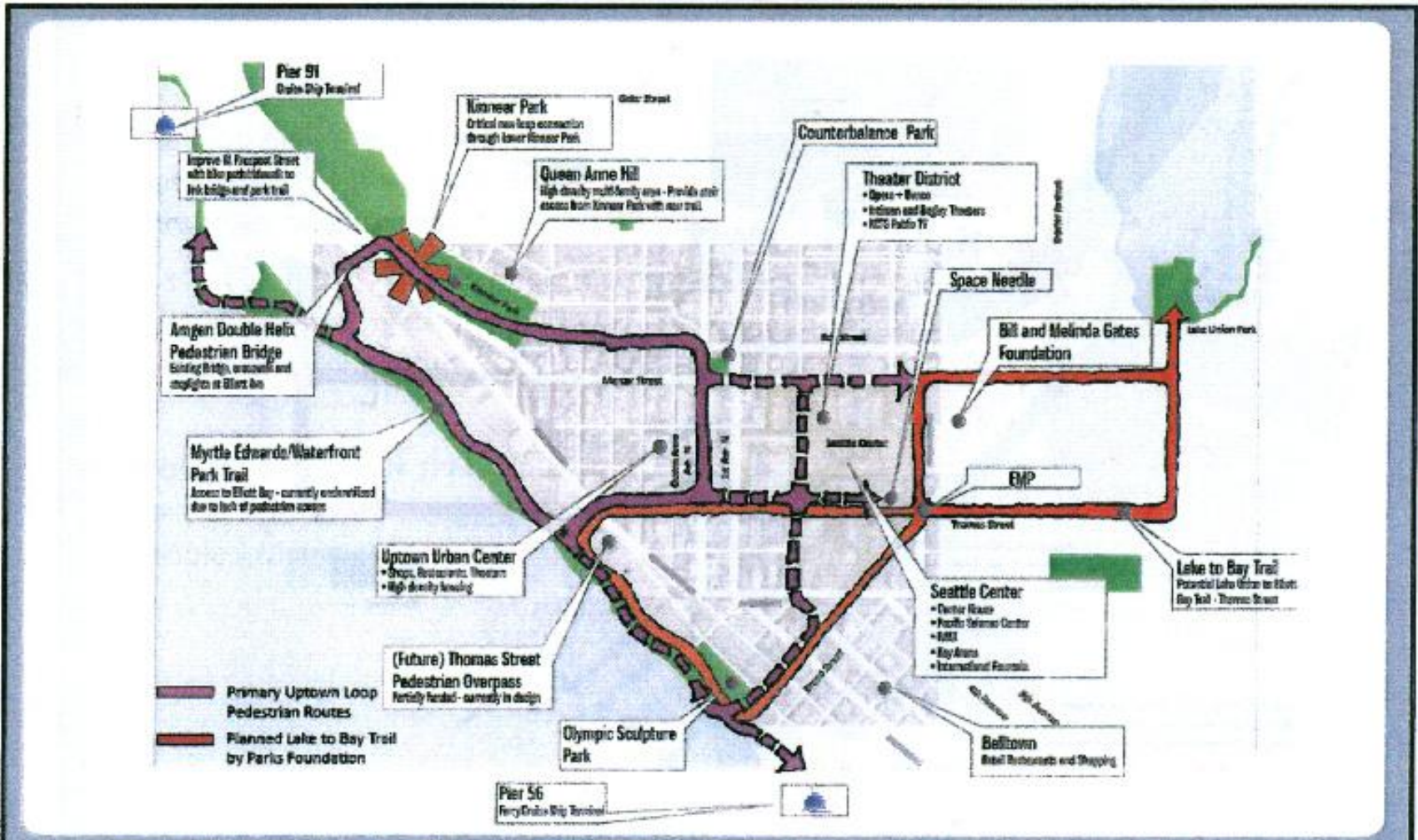

PRIMARY PEDESTRIAN ROUTES



Context – Community Based Lake to Bay Loop Concept

*(This map is a draft idea,
and is only one possibility
for the Loop.)*



Project Outcome

Streetscape Concept Plan

Right of Way Improvements Manual

SEATTLE.GOV City Services Departments Staff Directory About Seattle.gov City Contacts

SEARCH: Go
 Seattle.gov This Department

SEATTLE RIGHT-OF-WAY IMPROVEMENTS MANUAL SDOT HOME

HOME SEARCH TIPS REVISIONS JOIN EMAIL LIST GLOSSARY LINKS CONTACT US FAQS DISCLAIMER

Latest Online Manual

Shortcuts to Design Criteria

LATEST ONLINE MANUAL

Search Entire Manual

Detailed Table of Contents

- Chapter 1: Introduction
- Chapter 2: Procedures, Permitting Process and Approvals for Right-of-Way Improvements
- Chapter 3: Right-of-Way Improvement Requirements
- Chapter 4: Design Criteria
- Chapter 5: Construction and Maintenance
- Chapter 6: Streetscape Design Guidelines

Report ROWIM content errors and/or website problems

- > Guides Private Development
- > Informs Public Capital Investments

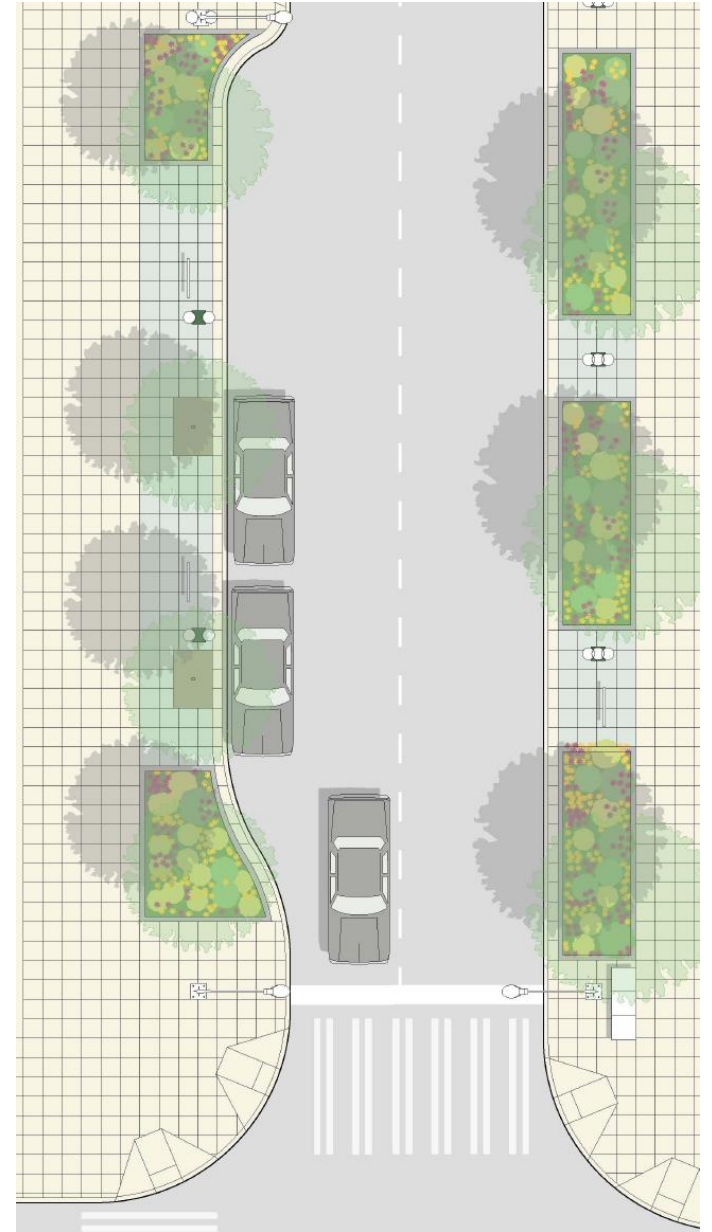

Background – Citywide Green Street Program



Green Streets - Pedestrian focus.

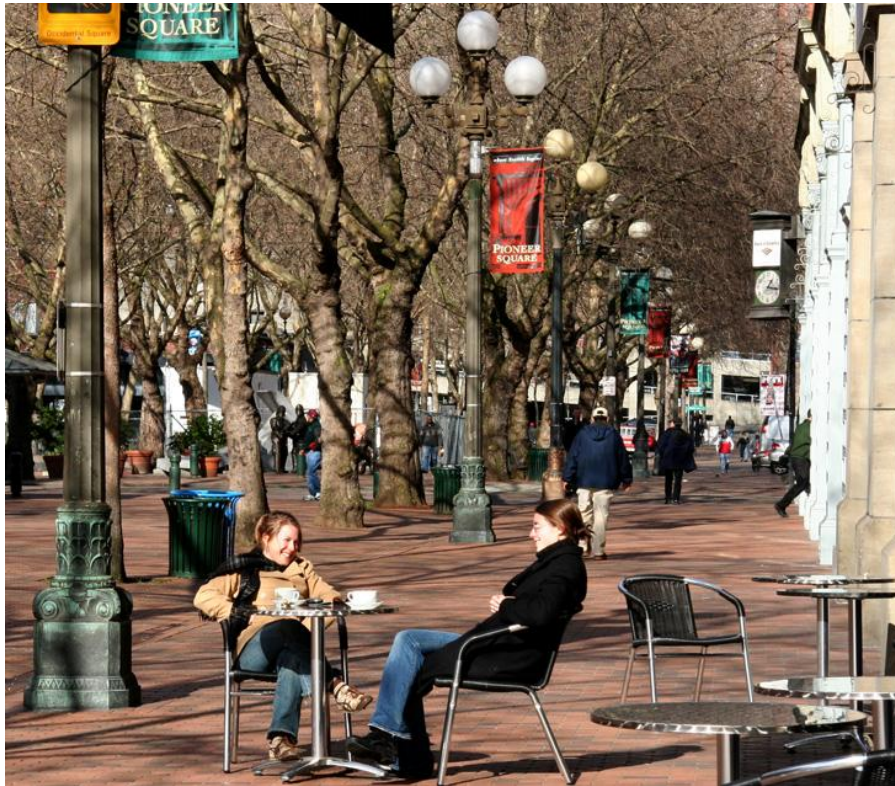

Green Streets - Abundant landscaping and amenities.



Green Streets - Unique features and art.

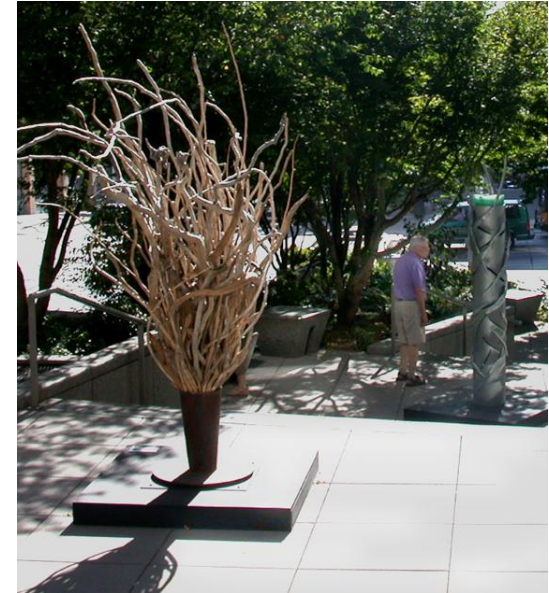

Green Streets - Sustainable elements.



Green Streets - Enhance open space.



Existing Conditions- Green Street Fabric



Existing Conditions- Green Street Fabric



Existing Conditions – Green Street Fabric

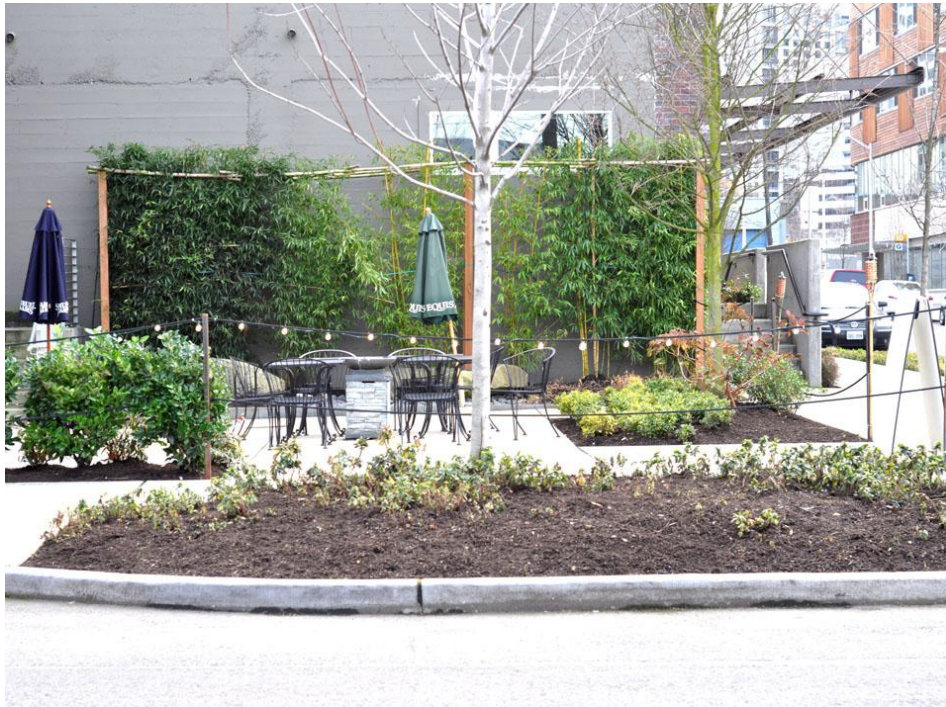

Existing Conditions – Green Street Fabric



Existing Conditions – Green Street Fabric



Existing Conditions – Green Street Fabric

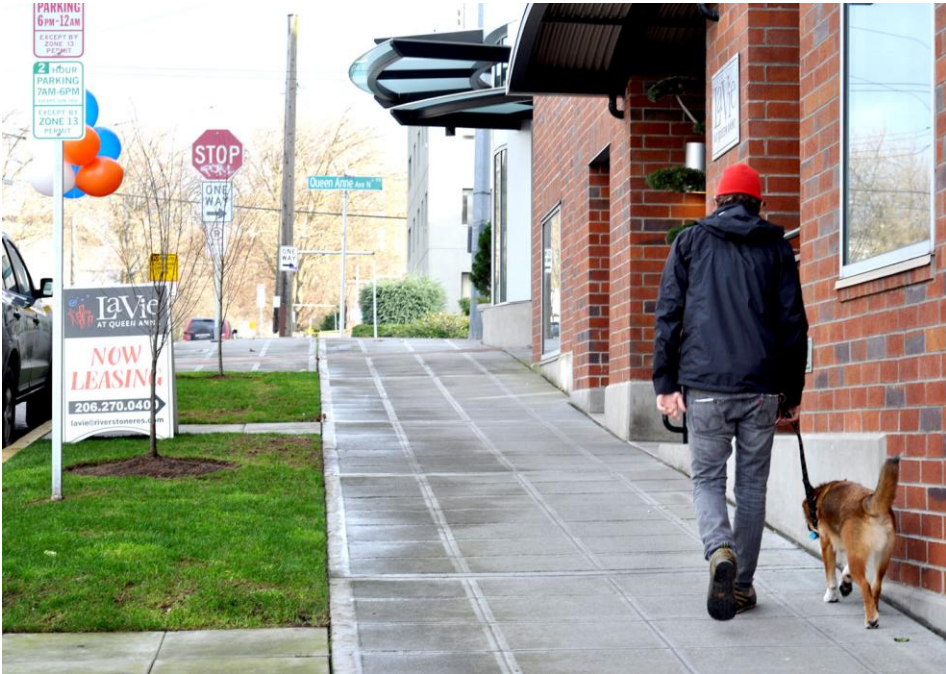

Existing Conditions – Green Street Fabric



Existing Conditions- Areas for Improvement

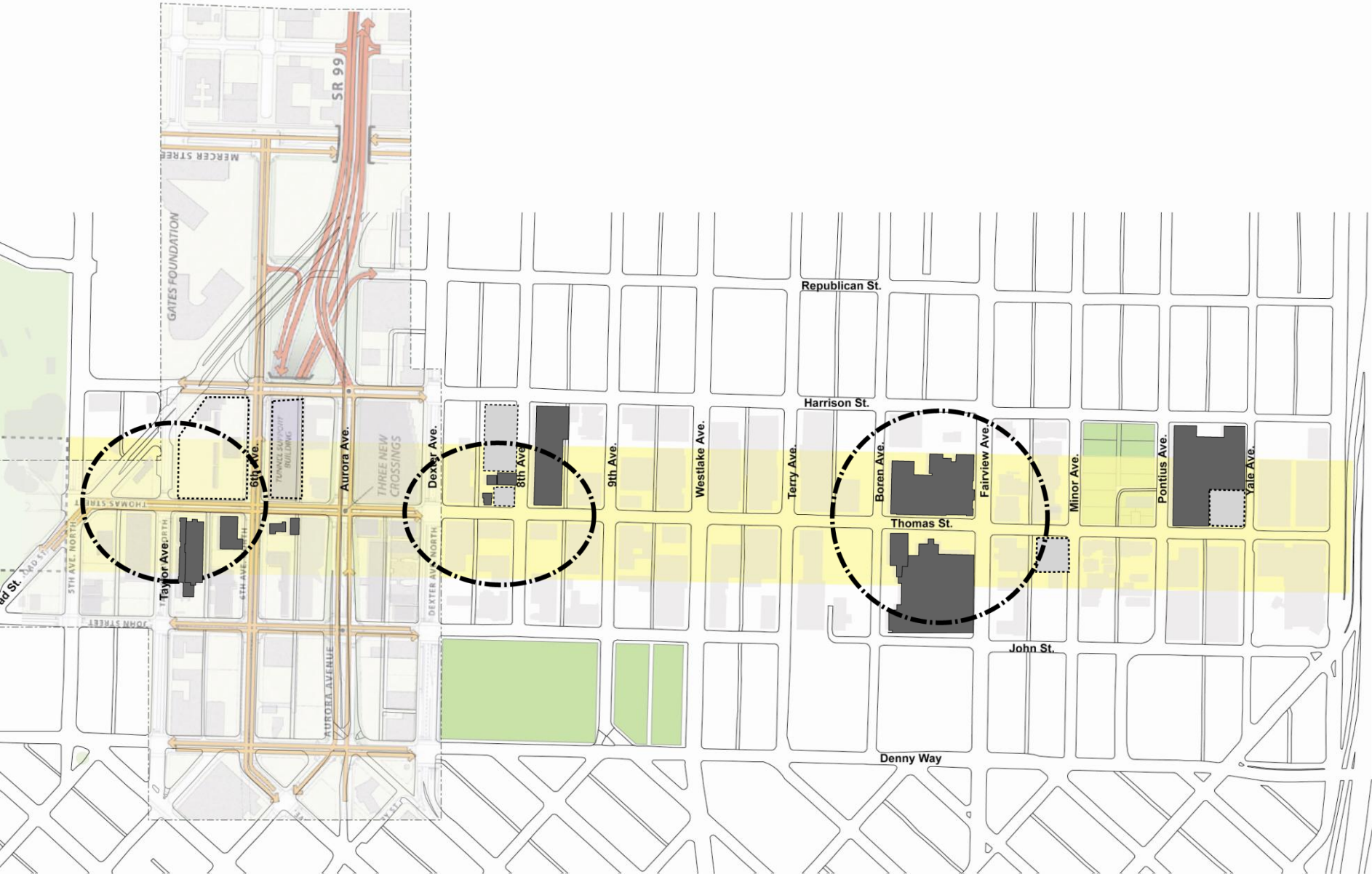

Existing Conditions – Green Street Fabric



Existing Conditions – Areas for Improvement



Existing Conditions – Areas for Improvement



Existing Conditions- Areas for Improvement



Existing Conditions – Areas for Improvement



North Portal – Adjustments at Broad Street

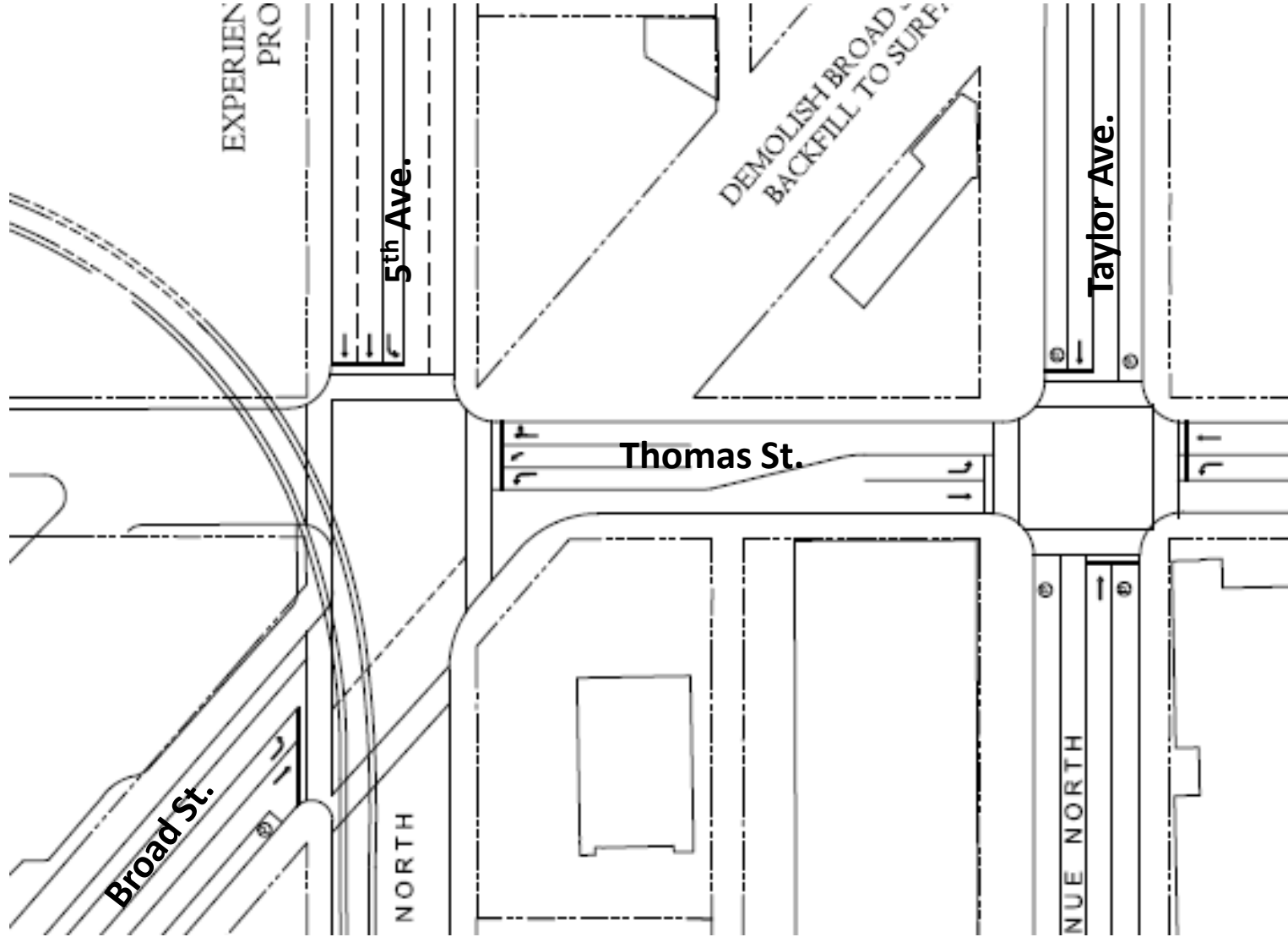

North Portal – Thomas St. Travel Lane Implications

Existing: 66' Right of Way, 42' – 44' Curb to Curb Width

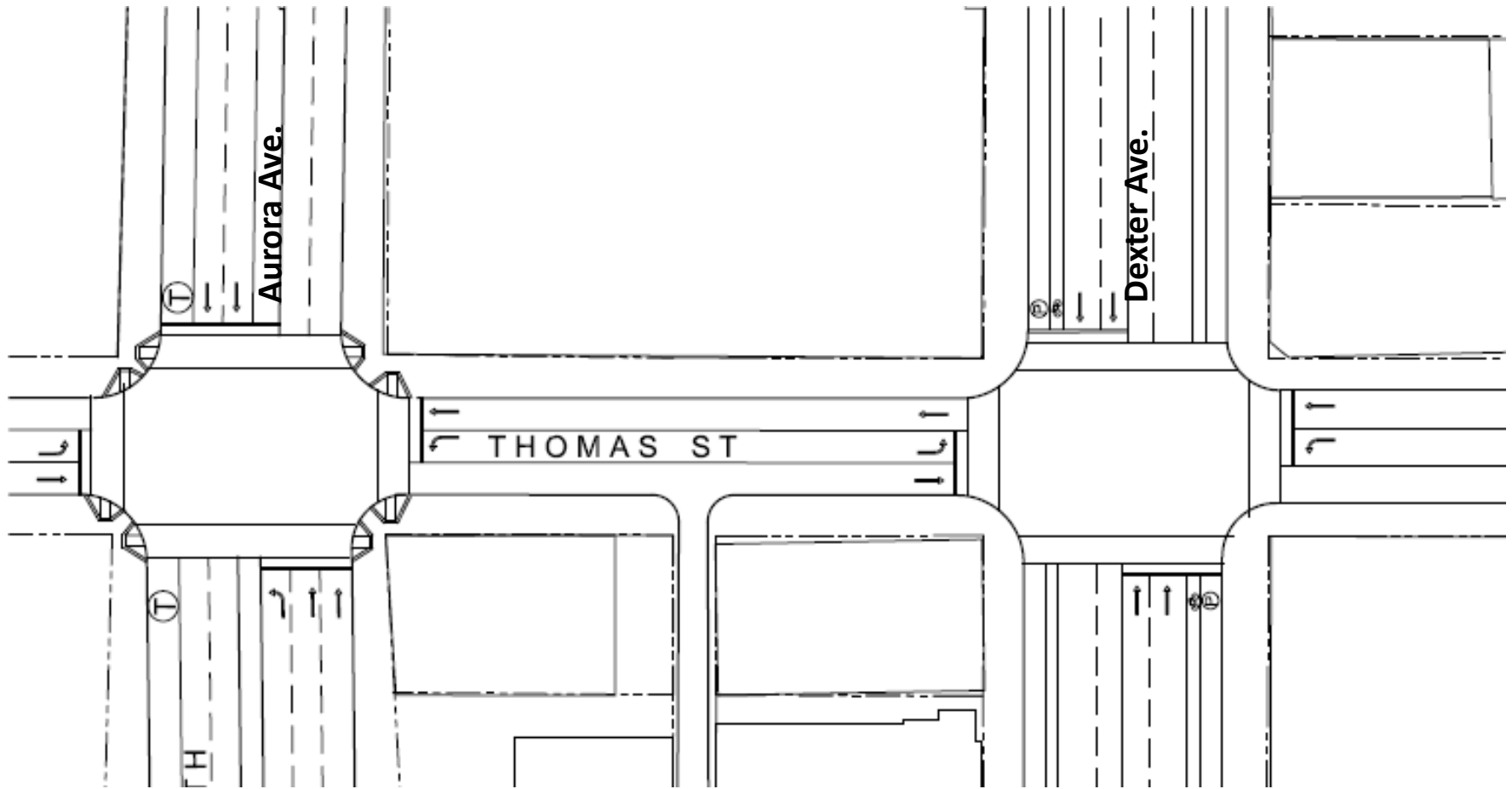

Working Schedule

Jan.

Feb.

Mar.

Apr.

May

Jun.

Jul.

Aug.

Base maps. Traffic info. Utility info. etc.



Briefings at groups' regular meetings when possible.



Revisit groups and individuals as necessary.

Initial concept plan & section illustrations, images. Range of options.

Mid / Late April

Rough draft concept plan. Key design concept and intent.

June

Final draft concept plan. Document format. Mid / Late summer.

Distribute for public and agency reviews. Begin DR adoption proces.

- > Discussion**
- > Questions**
- > Observations**
- > Suggestions**