

Alaskan Way Viaduct & Seawall Replacement Program



Seattle Design Commission
May 5, 2011

Urban Design Guidelines

Alaskan Way Viaduct & Seawall Replacement Program

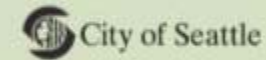
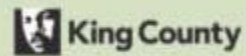
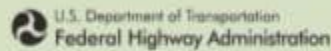

PORTAL AREA DESIGN GUIDELINES

SR 99 BORED TUNNEL ALTERNATIVE

SUBMITTED TO: WASHINGTON STATE DEPARTMENT OF TRANSPORTATION AND CITY OF SEATTLE
PREPARED BY: ROMA DESIGN GROUP IN ASSOCIATION WITH NBBJ

JUNE 18, 2010

Urban Design Guidelines

- WSDOT, SDOT, ROMA Design and NBBJ developed guidelines in 2009 and 2010 with the Seattle Design Commission.
- Provide a framework and a unified vision to guide implementation over multiple project design and construction contracts.
- Include goals, objectives and guiding principles.
- Respond to City of Seattle initiatives and neighborhood planning efforts.



Urban Design Goals

1. Provide for the safety and comfort of pedestrians, bicyclists, transit, freight and other vehicles.
2. Reinforce the sense of place and give structure and orientation to the urban experience.
3. Contribute positively to the fabric of the city and the unique qualities of adjacent neighborhoods.
4. Contribute to the sustainability of the urban environment.

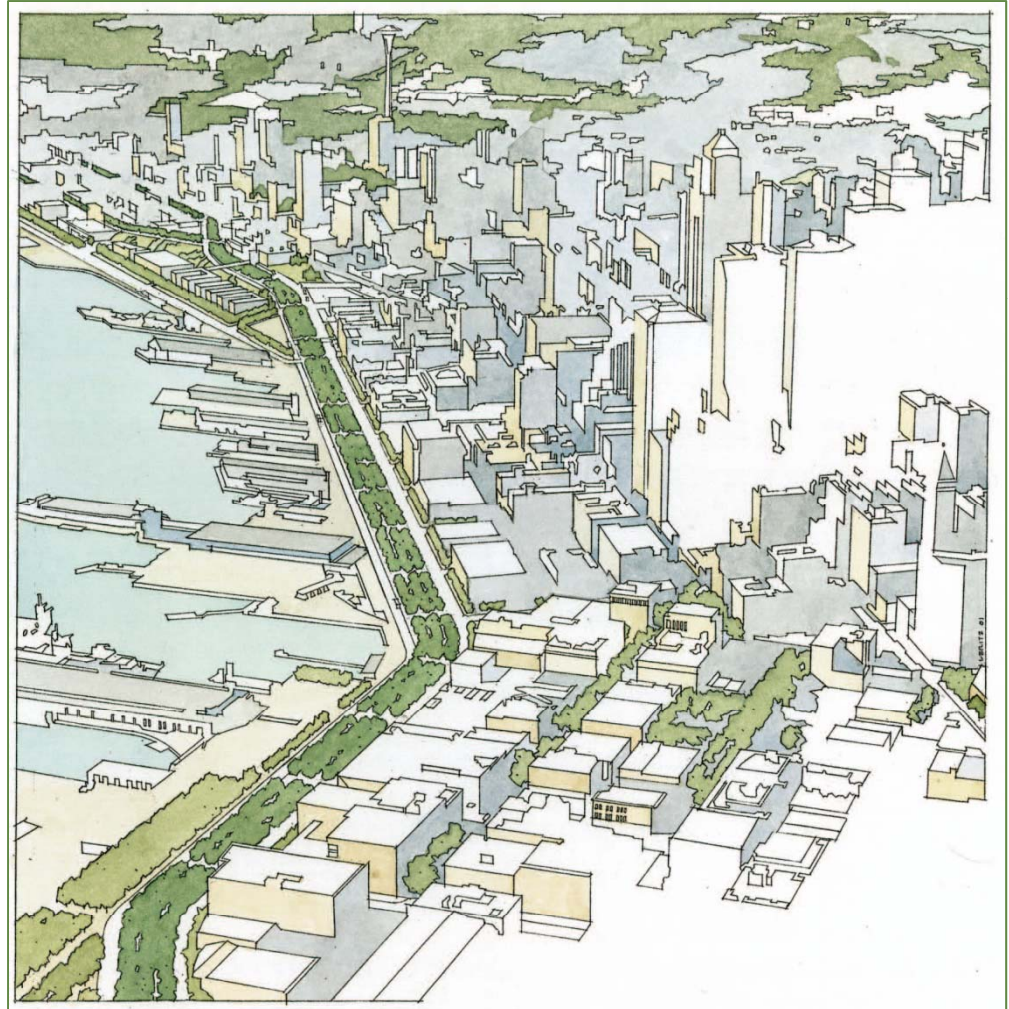

Alaskan Way Viaduct & Seawall Replacement Program



Alaskan Way Viaduct & Seawall Replacement Program



Alaskan Way Viaduct & Seawall Replacement Program



Overview of South Portal Area

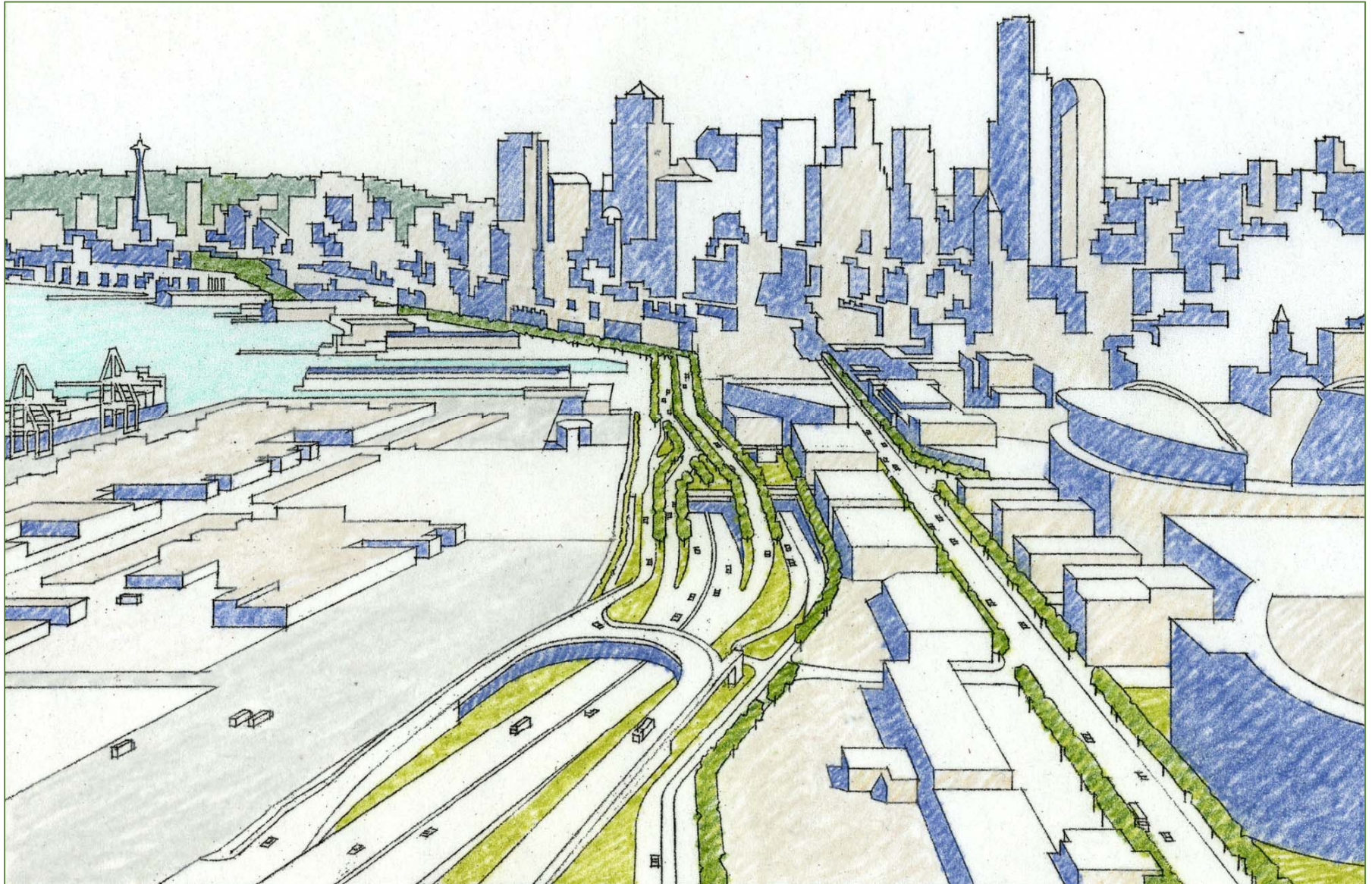

Bicycle and Pedestrian Access

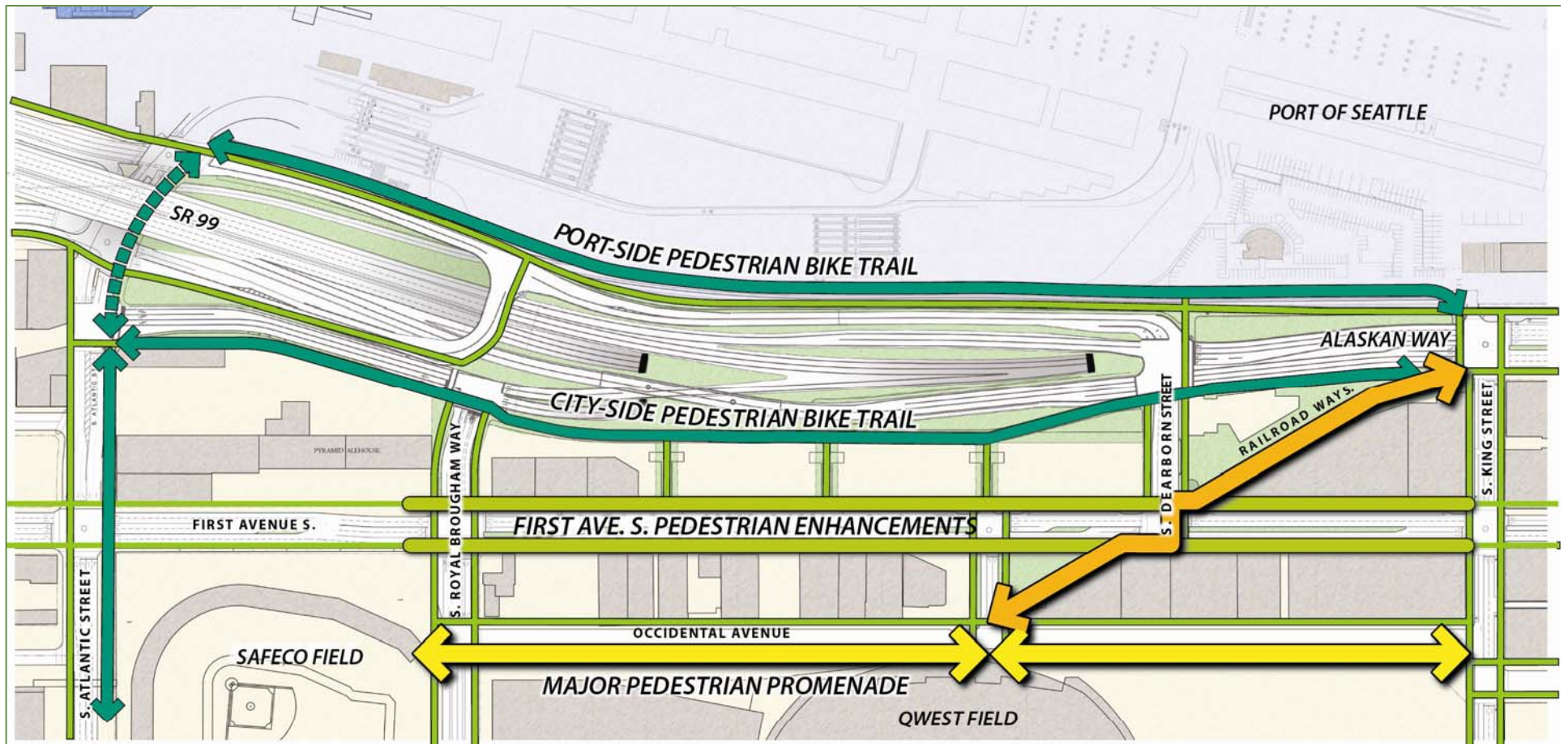

Opportunity Areas

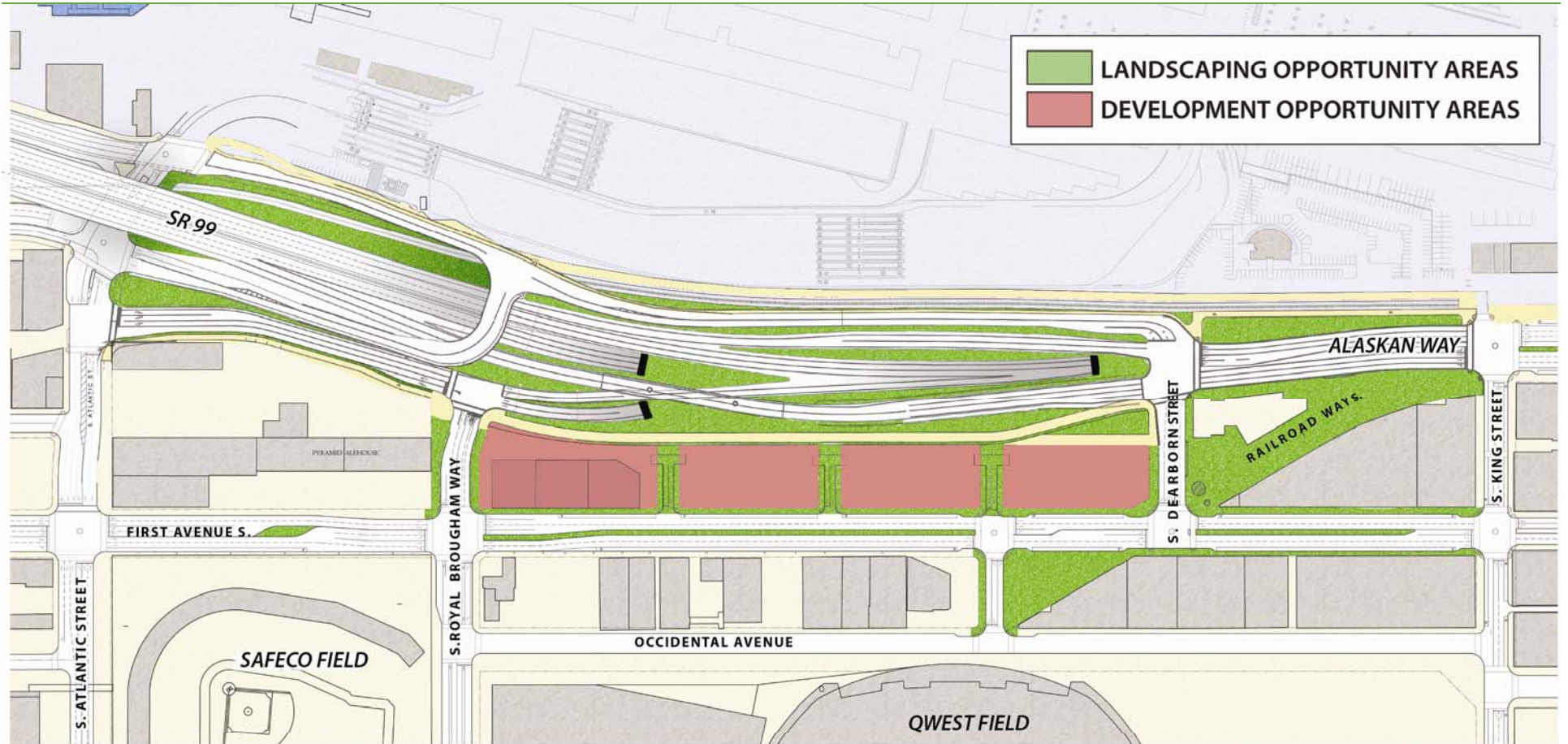

New Waterfront Connection

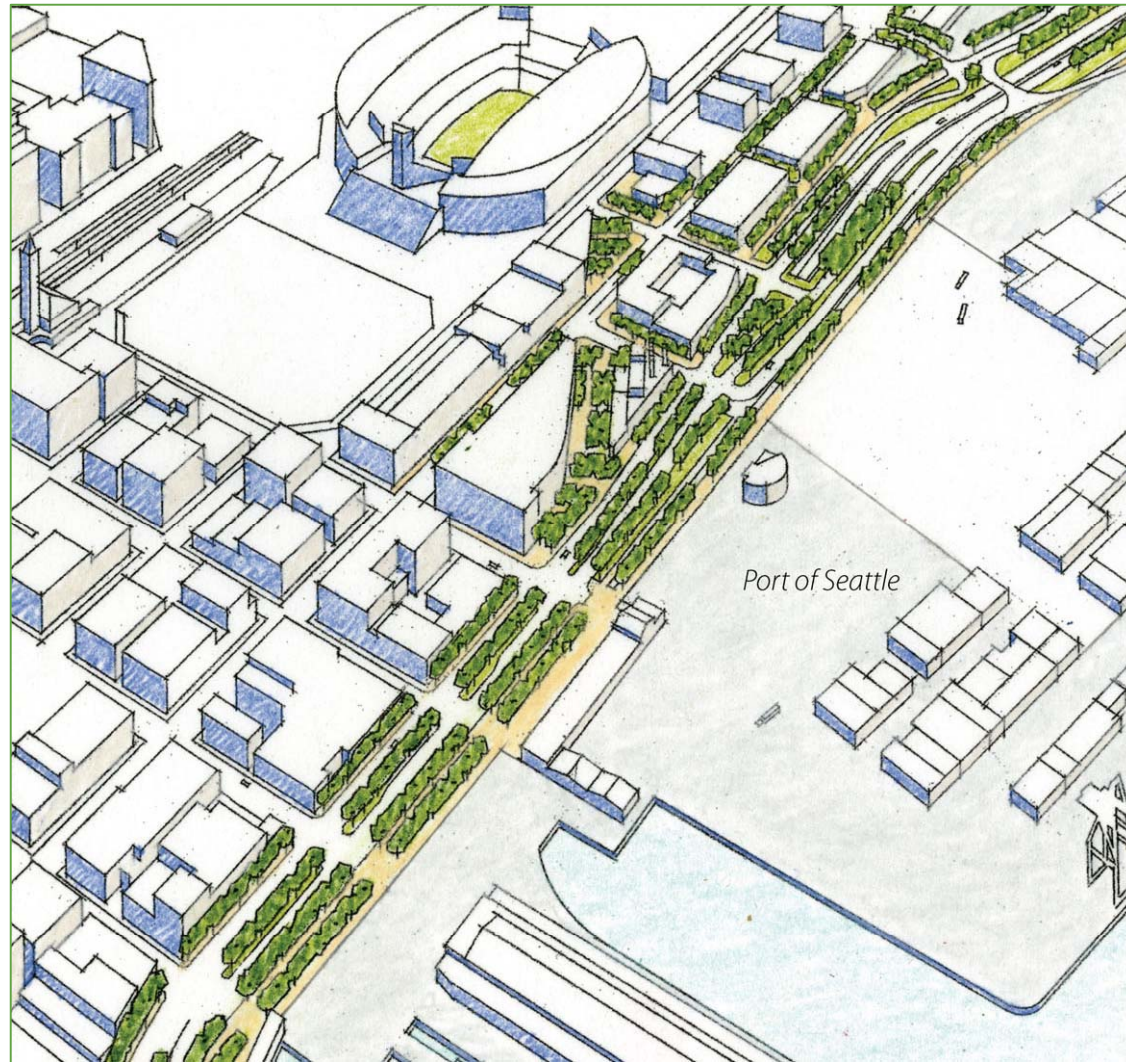

Railroad Way S. Concepts



Railroad Way S.

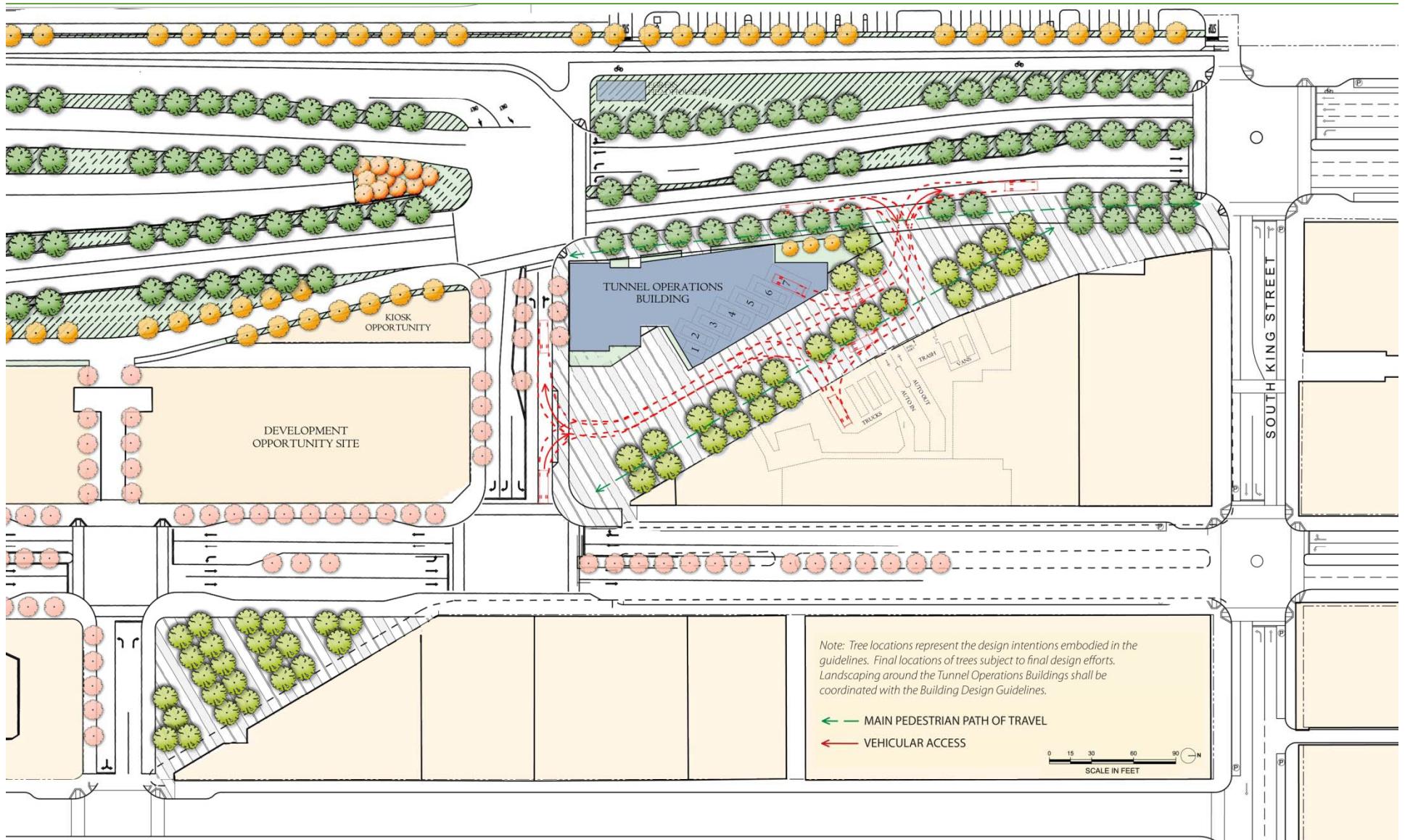

Design Influences

Nighborhood context / design influences

- Pioneer Square
- Stadiums / SODO
- Industrial / Port of Seattle
- Central waterfront

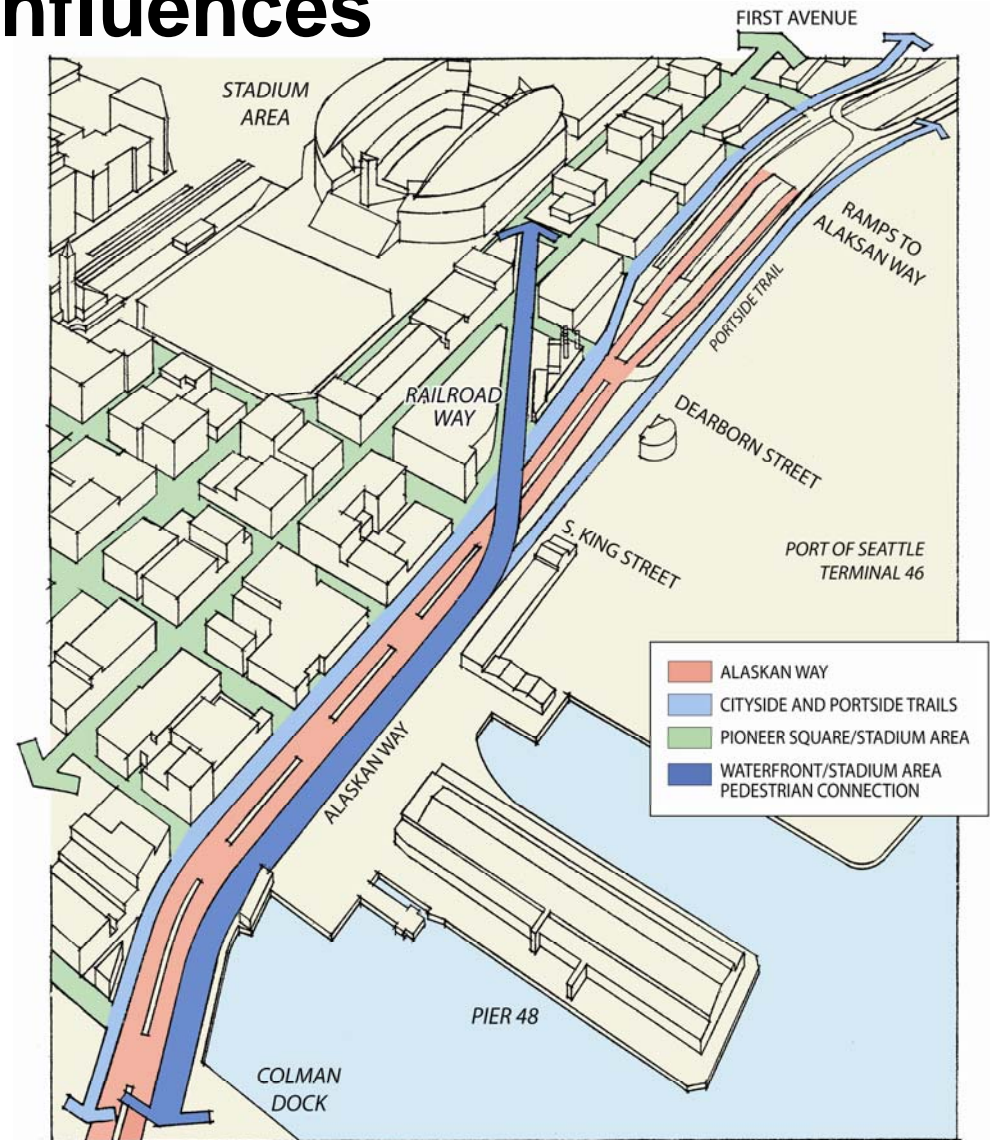

South Portal Landscape Concept

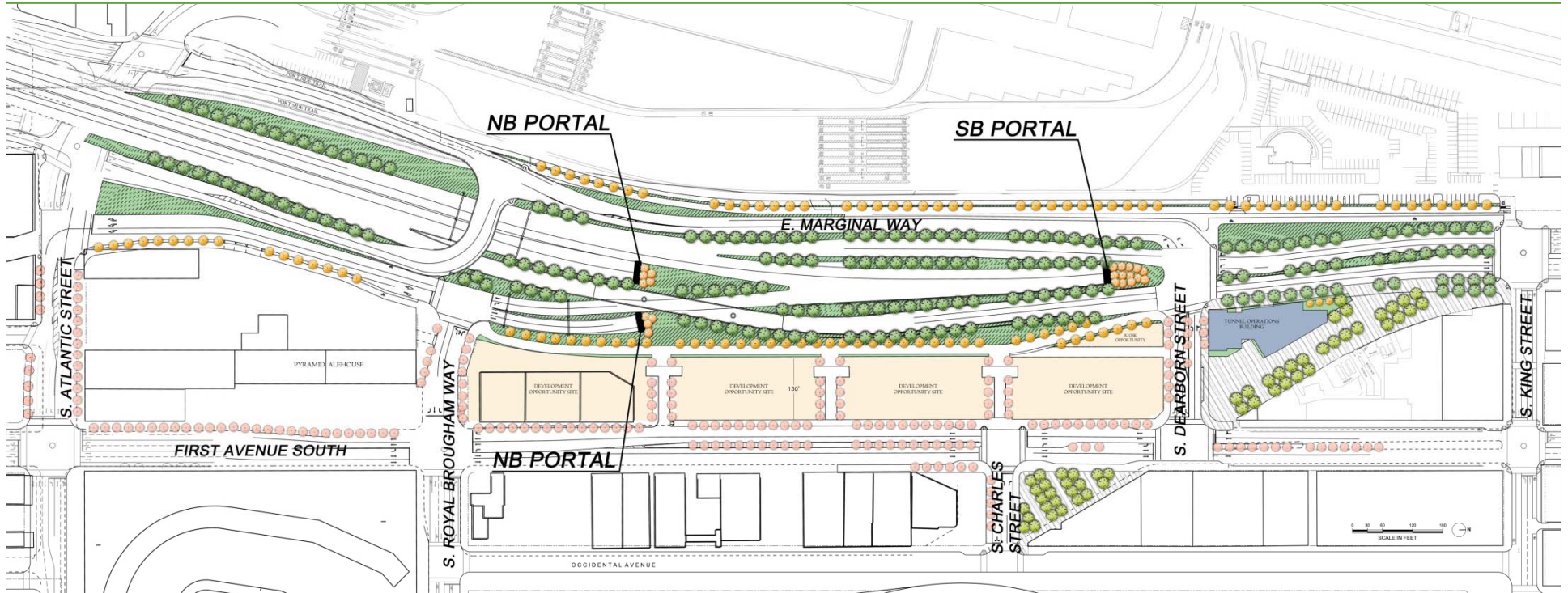

Portal Area Context

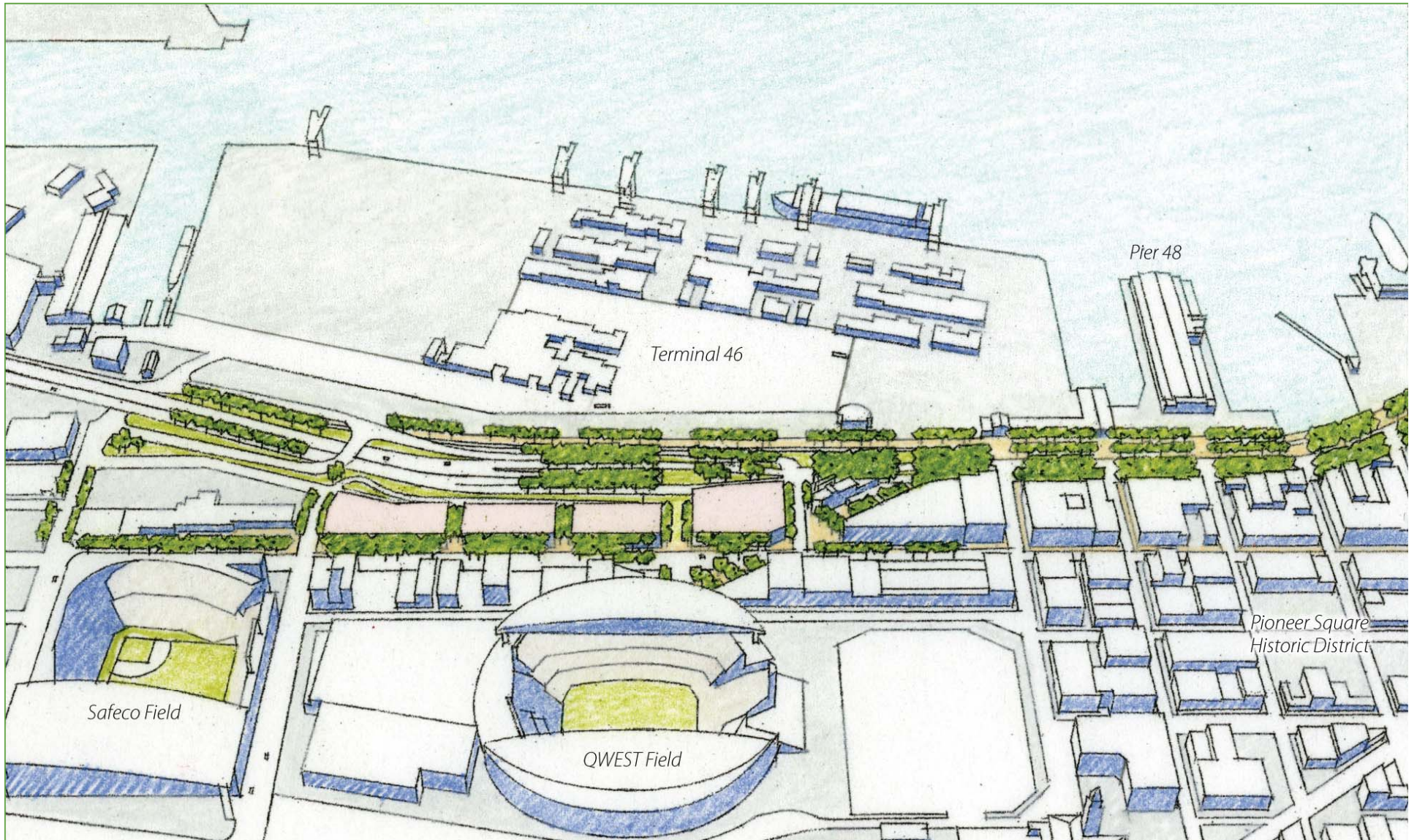

S. Atlantic Street Overcrossing



Entrance to Tunnel and City Street Grid



Implementing Design Guidelines

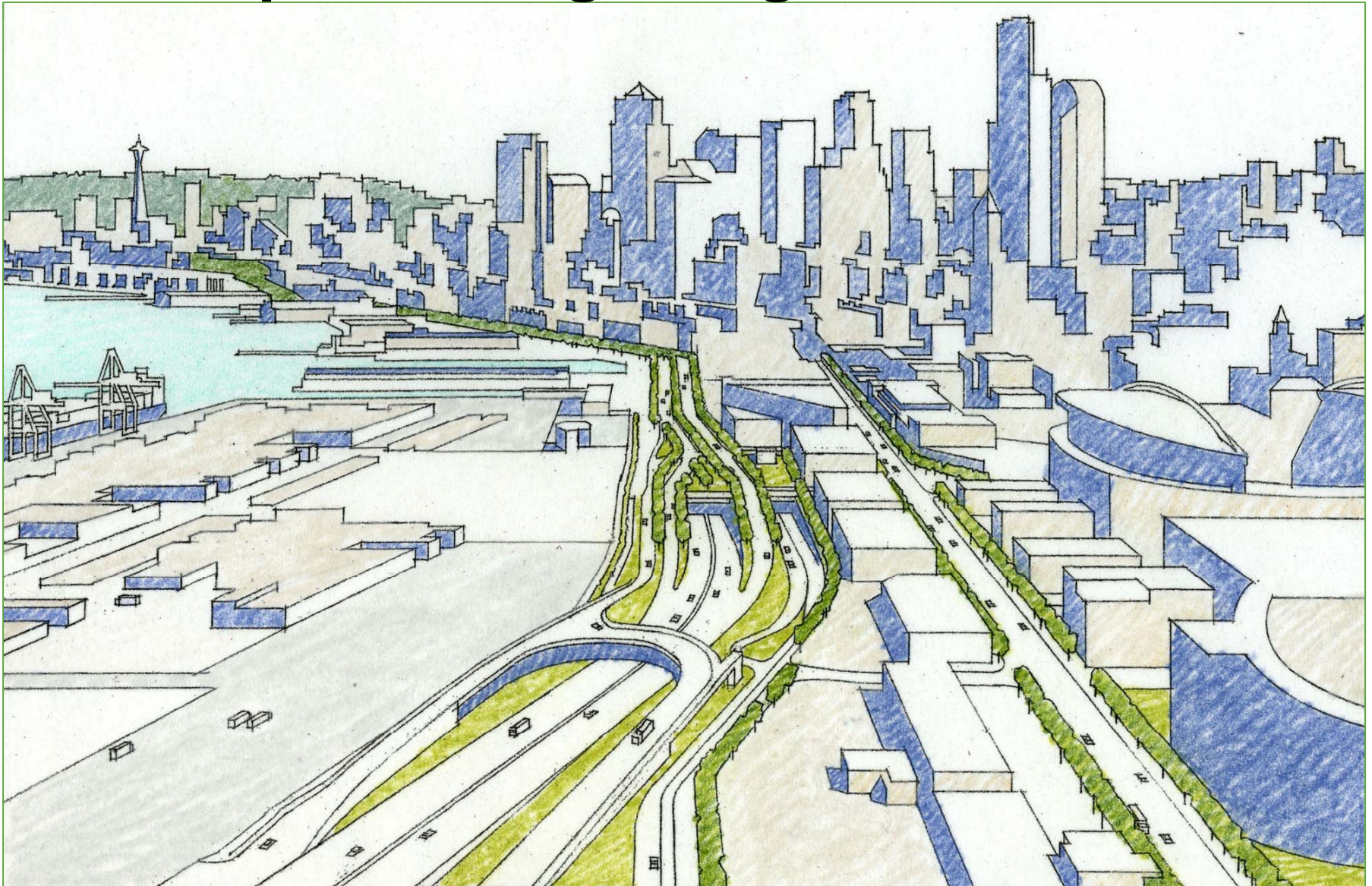

Future Meetings and Topics

Summer 2011

- North and south portal area urban design elements
- Urban design elements for the north and south operations buildings

Fall 2011 through 2013

- Follow up presentations

Alaskan Way Viaduct and Seawall Replacement Program



Website:

www.alaskanwayviaduct.org

E-mail:

viaduct@wsdot.wa.gov

Hotline:

1-888-AWV-LINE