

SEATTLE URBAN FORESTRY COMMISSION

Weston Brinkley (Position #3 – University), Chair • Sarah Rehder (Position #4 – Hydrologist), Vice-chair
Julia Michalak (Position #1 – Wildlife Biologist) • Elby Jones (Position #2 – Urban Ecologist - ISA)
Stuart Niven (Position #5 – Arborist – ISA) • Michael Walton (Position #6 – Landscape Architect – ISA)
Joshua Morris (Position #7 – NGO) • Blake Voorhees (Position # 9 – Realtor)
Neeiyati Johnson (Position #10 – Get Engaged) • Whit Bouton (Position #11 – Environmental Justice - ISA)
Jessica Jones (Position # 12 – Public Health) • Shari Selch (Position # 13 – Community/Neighborhood)

The Urban Forestry Commission was established to advise the Mayor and City Council concerning the establishment of policy and regulations governing the protection, management, and conservation of trees and vegetation in the City of Seattle

Meeting notes

September 9, 2020, 3:00 p.m. – 5:00 p.m.

Via Webex call

(206) 207-1700

Meeting number: 146 364 8734

Meeting password: 1234

In-person attendance is currently prohibited per the Washington Governor's Proclamation 20-28. Meeting participation is limited to access by joining the meeting through a computer or telephone conference line.

Attending

Commissioners

Sarah Rehder - Vice-Chair

Whit Bouton

Elby Jones

Jessica Jones

Julia Michalak

Josh Morris

Stuart Niven

Shari Selch

Michael Walton

Staff

Sandra Pinto de Bader - OSE

Guests

Joey Hulbert - WSU

Public

None

Absent- Excused

Weston Brinkley – Chair

Neeiyati Johnson

Blake Voorhees

NOTE: Meeting notes are not exhaustive. For more details, listen to the digital recording of the meeting at: <http://www.seattle.gov/urbanforestrycommission/meetingdocs.htm>

Call to order: Sarah called the meeting to order and did roll call.

Public comment: None.

Forest Health Watch project – Joey Hulbert (Washington State University)

Joey is working on a community science project around forest health with funding from the US Department of Agriculture. He is building this effort on experience from a similar project in South Africa. He is planning on using different public engagement methods including:

- Online reports
- Extension services
- Youth hikes
- Diagnostics
- Workshops, and
- Lab visits

Existing tools he will be using include:

- iNaturalist
- The Nature Conservancy/US Forest Service Healthy Trees, Healthy Cities app
- NASA Globe Observer – Trees
- TreeSnap

The project priorities include tracking:

- Western Red Cedar decline
- Big Leaf maple decline
- Swordfern die-off
- Madrone leaf blight
- Riparian Alder dieback, and
- Eastern Hemlock decline

More information can be found at <https://PPO.Puyallup.wsu.edu/>

Other tree health issues include:

- Araucaria sp. decline
- Sooty bark disease of maple

Joey is seeking partners to help shape the program and join the effort in the following roles:

- Core group membership
- Advisory committee
- Partner in programming implementation
- Partner in securing more support, and
- Community scientist

Potential partners include:

- Washington State University Extension
- US Forest Service
- Washington State Department of Natural Resources
- The Nature Conservancy
- Seattle Audubon Society
- City of Seattle (Seattle Parks and Recreation, Seattle Public Utilities, etc.)

Existing volunteer groups include:

- Seattle Tree Ambassadors
- Green Seattle Partnership Forest Stewards

- Other Seattle Parks and Recreation volunteers
- Seattle Audubon Society “Friends of Urban Trees”
- The Nature conservancy volunteers
- Washington State University master gardeners and 4H groups

Joey and the UFC discussed potential partnering opportunities. For more details on the discussion please listen to the meeting recording at:

<http://www.seattle.gov/urbanforestrycommission/meetingdocs.htm>

Director’s Rule 11-2020 – Landscaping Standards and Green Factor – discussion and vote

The group discussed the revised draft letter. For discussion details please listen to the meeting’s digital recording [here](#).

ACTION: A motion to approve the Draft Director’s Rule 11-2020 letter of recommendation as amended was made, seconded, and approved.

Draft Thank you letter to Earl Eutsler – Washington DC

The group discussed and adopted this letter.

ACTION: A motion to approve the Draft Director’s Rule 11-2020 letter of recommendation as amended was made, seconded, and approved.

Draft Thank you letter to SDOT RE: pest readiness

The group discussed and adopted this letter.

ACTION: A motion to approve the Draft Director’s Rule 11-2020 letter of recommendation as amended was made, seconded, and approved.

Draft thank you letter to iSeaTree Team: Move to next meeting

Adoption of August 5 and August 12 meeting notes: Move to next meeting.

Public comment: none

Adjourn: Sarah adjourned the meeting.

Public input:

(see next page and posted notes)

From: David Moehring <dmoehring@consultant.com>
Sent: Wednesday, August 26, 2020 10:19 PM
To: PRC <PRC@seattle.gov>; McGarry, Deborah <Deborah.McGarry@seattle.gov>
Cc: Pinto de Bader, Sandra <Sandra.Pinto_de_Bader@Seattle.gov>; seattle-tree-ordinance-working-grouplists riseup. net <seattle-tree-ordinance-working-group@lists.riseup.net>; Strauss, Dan <Dan.Strauss@seattle.gov>; Pedersen, Alex <Alex.Pedersen@seattle.gov>; An, Noah <Noah.An@seattle.gov>; Thaler, Toby <Toby.Thaler@seattle.gov>
Subject: Kudos Deborah McGarry, Seattle Arborist on project at 11340, 11342, 11344, 11346, 11348 23RD AVE NE 3028516-LU et al.

CAUTION: External Email

Thank you to Seattle **Arborist Deborah McGarry** for continue to enforce the Seattle Tree Ordinances and Directors Rule on many projects, including notably at **11340 to 11348 23RD AVE NE** (recent comment below) from SDCI project 3028516-LU / 3026308-LU / et al.

David Moehring
 TreePAC Board Member
dmoehring@consultant.com

If only these 49 trees on this site could sing in a pitch recognized by the human ear...

TREE INVENTORY SEPTEMBER 2017
 BY: Zsafia Pasztor 425-210-5541
 zs.pasztor2011@gmail.com

Tree#	Size "	Scientific name	Common name	Tree#	Size "	Scientific name	Common name
1	7	Magnolia liliflora	Saucer Magnolia	26	26	Thuja plicata	Western Red Cedar
2	6	Magnolia liliflora	Saucer Magnolia	27	28	Thuja plicata	Western Red Cedar
3	13.6	Cercidiphyllum japonicum	Katsura	28	10	Prunus laurocerasus	English Laurel
4	44.7	Cedrus deodara	Deodar Cedrus	29	12	Malus sp.	Apple
5	15	Pseudotsuga menziesii	Douglas Fir	30	17	Prunus laurocerasus	English Laurel
6	21	Pseudotsuga menziesii	Douglas Fir	31	28	Pseudotsuga menziesii	Douglas Fir
7	28	Thuja plicata	Western Red Cedar	32	29	Pinus monticola	Western White Pine
8	28	Pseudotsuga menziesii	Douglas Fir	33	10.5	Alnus oregona	Red Alder
9	40	Pseudotsuga menziesii	Douglas Fir	34	14	Alnus oregona	Red Alder
10	11	Thuja plicata	Western Red Cedar	35	21	Pseudotsuga menziesii	Douglas Fir
11	14	Calocedrus decurrens	Incense Cedar	36	42	Thuja plicata	Western Red Cedar
12	24	Thuja plicata	Western Red Cedar	37	26	Thuja plicata	Western Red Cedar
13	36	Thuja plicata	Western Red Cedar	38	27	Thuja plicata	Western Red Cedar
14	26	Pinus monticola	Western White Pine	39	24	Pseudotsuga menziesii	Douglas Fir
15	21	Chamaecyparis lawsoniana	Lawson Cypress	40	24	Tsuga heterophylla	Western Hemlock
16	71	Thuja plicata	Western Red Cedar	41	28	Thuja plicata	Western Red Cedar
17	31	Pinus monticola	Western White Pine	42	24	Pseudotsuga menziesii	Douglas Fir
18	33	Thuja plicata	Western Red Cedar	43	28	Pseudotsuga menziesii	Douglas Fir
19	10	Cornus kousa	Kousa Dogwood	44	28	Pseudotsuga menziesii	Douglas Fir
20	26	Pseudotsuga menziesii	Douglas Fir	45	30	Pseudotsuga menziesii	Douglas Fir
21	26	Thuja plicata	Western Red Cedar	46	10	Ilex aquifolium	English Holly
22	8	Cornus kousa	Kousa Dogwood	47	14	Ficus sp.	Fig
23	19	Thuja plicata	Western Red Cedar	48	8	Acer macrophyllum	Big Leaf Maple
24	28	Thuja plicata	Western Red Cedar	49	16	Aesculus hippocastanum	Horse Chestnut
25	11	Thuja plicata	Western Red Cedar				

EXISTING HOUSE #2301

VICTORY HEIGHTS ADD. VOL. 24/22

=====

Re: Project #6761539-CN
Correction Notice #2
Review Type TREE
Date August 13, 2020

Project Address 11348 23RD AVE NE
SEATTLE, WA 98125
Contact Phone (206) 459-2364

Contact Email JULIE@LEDOUXCONSTRUCTION.COM Address Seattle Department of Construction and SDCI Reviewer Deborah McGarry Inspections
Email deborah.mcgarry@seattle.gov
Owner BRUCE WALLACE P.O. Box 34019
Seattle, WA 98124-4019

"Dear Ms. LeDoux,
It appears that an updated arborist report is the correction response for my previous correction letter, but not all questions were addressed. There are additional outstanding questions regarding trees in the 8/3/2020 Zoning Correction Letter. This letter will refer to questions from the zoning correction letter and brings up several new concerns. As noted in the Zoning Correction, please provide a narrative response to each Correction item listed below. As there are multiple concerns with trees on this site and the submitted documentation, there may be additional corrections in future review cycles. Thank you.
Deborah McGarry"

=====
=====

SDCI document links

Existing site plan showing very large trees on lot proposed to be divided and developed:

[Approved Plan Set - Land Use](#) 1279 KB 07/25/18 [3030102-LU](#) Master Use Permit

Photos and correction comments:

Site Photos	72 MB	12/04/19	005829-19PA	Building & Land Use Pre-Application
Application	630 KB	10/31/19	005829-19PA	Building & Land Use Pre-Application
Correction Letter-Zoning-Cycle2	533 KB	08/03/20	6761539-CN	Construction Permit
Correction Letter-Zoning-Cycle1	512 KB	03/06/20	6761539-CN	Construction Permit
Correction Letter	436 KB	07/21/20	6761539-CN	Construction Permit
Correction Letter-Tree-Cycle2	386 KB	08/13/20	6761539-CN	Construction Permit

Many who care:

Public Comment	89 KB	09/18/17	3028516-LU	Master Use Permit
Public Comment	35 KB	09/18/17	3028516-LU	Master Use Permit

Public Comment	13 KB	09/18/17	3028516-LU	Master Use Permit
Public Comment	12 KB	09/18/17	3028516-LU	Master Use Permit
Public Comment	15 KB	09/18/17	3028516-LU	Master Use Permit
Public Comment	13 KB	09/18/17	3028516-LU	Master Use Permit
Public Comment	14 KB	09/19/17	3028516-LU	Master Use Permit
Public Comment	13 KB	09/19/17	3028516-LU	Master Use Permit
Public Comment	1962 KB	09/19/17	3028516-LU	Master Use Permit
Public Comment	13 KB	09/19/17	3028516-LU	Master Use Permit
Public Comment	14 KB	09/19/17	3028516-LU	Master Use Permit
Public Comment	37 KB	09/19/17	3028516-LU	Master Use Permit
Public Comment	38 KB	09/19/17	3028516-LU	Master Use Permit
Public Comment	13 KB	09/19/17	3028516-LU	Master Use Permit
Public Comment	12 KB	09/19/17	3028516-LU	Master Use Permit
Public Comment	37 KB	09/19/17	3028516-LU	Master Use Permit
Public Comment	14 KB	09/19/17	3028516-LU	Master Use Permit
Public Comment	19 MB	09/19/17	3028516-LU	Master Use Permit
Public Comment	13 KB	09/19/17	3028516-LU	Master Use Permit
Public Comment	57 KB	09/19/17	3028516-LU	Master Use Permit
Public Comment	45 KB	08/28/17	3028516-LU	Master Use Permit
Public Comment	28 KB	08/28/17	3028516-LU	Master Use Permit
Public Comment	47 KB	08/30/17	3028516-LU	Master Use Permit
Public Comment	36 KB	09/05/17	3028516-LU	Master Use Permit
Public Comment	33 KB	09/05/17	3028516-LU	Master Use Permit
Public Comment	117 KB	09/05/17	3028516-LU	Master Use Permit
Public Comment	2 MB	09/05/17	3028516-LU	Master Use Permit
Public Comment	19 KB	09/05/17	3028516-LU	Master Use Permit
Public Comment	38 KB	09/06/17	3028516-LU	Master Use Permit
Public Comment	40 KB	09/11/17	3028516-LU	Master Use Permit
Public Comment	159 KB	09/12/17	3028516-LU	Master Use Permit
Public Comment	4 MB	09/14/17	3028516-LU	Master Use Permit
Public Comment	117 KB	09/14/17	3028516-LU	Master Use Permit
Public Comment	43 KB	09/14/17	3028516-LU	Master Use Permit
Public Comment	12 KB	09/20/17	3028516-LU	Master Use Permit
Public Comment	12 KB	09/20/17	3028516-LU	Master Use Permit
Public Comment	12 KB	09/20/17	3028516-LU	Master Use Permit

Public Comment	34 KB	09/20/17	3028516-LU	Master Use Permit
Public Comment	13 KB	09/20/17	3028516-LU	Master Use Permit
Public Comment	13 KB	09/20/17	3028516-LU	Master Use Permit
Public Comment	12 KB	09/20/17	3028516-LU	Master Use Permit
Public Comment	12 KB	09/20/17	3028516-LU	Master Use Permit
Public Comment	12 KB	09/20/17	3028516-LU	Master Use Permit
Public Comment	12 KB	09/20/17	3028516-LU	Master Use Permit
Public Comment	12 KB	09/20/17	3028516-LU	Master Use Permit
Public Comment	36 KB	09/20/17	3028516-LU	Master Use Permit
Public Comment	13 KB	09/20/17	3028516-LU	Master Use Permit
Public Comment	12 KB	09/20/17	3028516-LU	Master Use Permit
Public Comment	35 KB	09/20/17	3028516-LU	Master Use Permit
Public Comment	12 KB	09/20/17	3028516-LU	Master Use Permit
Public Comment	12 KB	09/20/17	3028516-LU	Master Use Permit
Public Comment	12 KB	09/20/17	3028516-LU	Master Use Permit
Public Comment	36 KB	09/20/17	3028516-LU	Master Use Permit
Public Comment	12 KB	09/20/17	3028516-LU	Master Use Permit
Public Comment	35 KB	09/20/17	3028516-LU	Master Use Permit
Public Comment	36 KB	09/20/17	3028516-LU	Master Use Permit
Public Comment	56 KB	09/20/17	3028516-LU	Master Use Permit
Public Comment	55 KB	09/20/17	3028516-LU	Master Use Permit
Public Comment	53 KB	09/26/17	3028516-LU	Master Use Permit
Public Comment	333 KB	09/01/17	3028516-LU	Master Use Permit
Public Comment	51 KB	09/01/17	3028516-LU	Master Use Permit
Public Comment	51 KB	09/01/17	3028516-LU	Master Use Permit
Public Comment: Songer 09/06/2018	47 KB	09/07/18	3028516-LU	Master Use Permit

From: Stuart Niven <panorarbor@gmail.com>

Sent: Friday, September 4, 2020 8:31 AM

To: David Moehring <dmoehring@consultant.com>

Cc: PRC <PRC@seattle.gov>; McGarry, Deborah <Deborah.McGarry@seattle.gov>; Pinto de Bader, Sandra <Sandra.Pinto_de_Bader@Seattle.gov>; seattle-tree-ordinance-working-grouplists riseup. net <seattle-tree-ordinance-working-group@lists.riseup.net>; Strauss, Dan <Dan.Strauss@seattle.gov>; Pedersen, Alex <Alex.Pedersen@seattle.gov>; An, Noah <Noah.An@seattle.gov>; Thaler, Toby <Toby.Thaler@seattle.gov>

Subject: Re: Kudos Deborah McGarry, Seattle Arborist on project at 11340, 11342, 11344, 11346, 11348 23RD AVE NE 3028516-LU et al.

CAUTION: External Email

Thank you Deb for your attention to detail on this project which if permitted without consideration for the retention of trees, will result in another monumental loss of healthy, large trees in Seattle. This neighbourhood, like many, has already lost hundreds of healthy and large trees, including native conifers which were the home for nesting and visiting birds, including merlins and other birds of prey. The ecological impact is disastrous and humans are suffering too. WE must work together to save trees and not continue to allow uncontrolled 'development' of Seattle to destroy the future of human and all other life that tries to live here. We all suffer as a relatively small number of people benefit, in the short term.

Thank you and kind regards,

Stuart Niven, BA (Hons)

PanorArborist

www.panorarbor.com

[ISA Certified Arborist PN-7245A & Tree Risk Assessment Qualification \(TRAQ\)](#)

[Arborist on Seattle Audubon Society Conservation Committee](#)

[Arborist on Seattle's Urban Forestry Commission](#)

[Board Member of TreePAC](#)

[WA Lic# PANORL*852P1](#) (Click to link to WA L&I's Verify a Contractor Page)

On Wed, Aug 26, 2020 at 10:19 PM David Moehring <dmoehring@consultant.com> wrote:

Thank you to Seattle **Arborist Deborah McGarry** for continue to enforce the Seattle Tree Ordinances and Directors Rule on many projects, including notably at **11340 to 11348 23RD AVE NE** (recent comment below) from SDCI project 3028516-LU / 3026308-LU / et al.

David Moehring

TreePAC Board Member

dmoehring@consultant.com

If only these 49 trees on this site could sing in a pitch recognized by the human ear...

TREE INVENTORY SEPTEMBER 2017
 BY: Zsafia Pasztor 425-210-5541
 zs.pasztor2011@gmail.com

Tree#	Size "	Scientific name	Common name	Tree#	Size "	Scientific name	Common name
1	7	Magnolia liliflora	Saucer Magnolia	26	26	Thuja plicata	Western Red Cedar
2	6	Magnolia liliflora	Saucer Magnolia	27	28	Thuja plicata	Western Red Cedar
3	13.6	Cercidiphyllum japonicum	Katsura	28	10	Prunus laurocerasus	English Laurel
4	44.7	Cedrus deodara	Deodar Cedrus	29	12	Malus sp.	Apple
5	15	Pseudotsuga menziesii	Douglas Fir	30	17	Prunus laurocerasus	English Laurel
6	21	Pseudotsuga menziesii	Douglas Fir	31	28	Pseudotsuga menziesii	Douglas Fir
7	28	Thuja plicata	Western Red Cedar	32	29	Pinus monticola	Western White Pine
8	28	Pseudotsuga menziesii	Douglas Fir	33	10.5	Alnus oregona	Red Alder
9	40	Pseudotsuga menziesii	Douglas Fir	34	14	Alnus oregona	Red Alder
10	11	Thuja plicata	Western Red Cedar	35	21	Pseudotsuga menziesii	Douglas Fir
11	14	Calocedrus decurrens	Incense Cedar	36	42	Thuja plicata	Western Red Cedar
12	24	Thuja plicata	Western Red Cedar	37	26	Thuja plicata	Western Red Cedar
13	36	Thuja plicata	Western Red Cedar	38	27	Thuja plicata	Western Red Cedar
14	26	Pinus monticola	Western White Pine	39	24	Pseudotsuga menziesii	Douglas Fir
15	21	Chamaecyparis lawsoniana	Lawson Cypress	40	24	Tsuga heterophylla	Western Hemlock
16	71	Thuja plicata	Western Red Cedar	41	28	Thuja plicata	Western Red Cedar
17	31	Pinus monticola	Western White Pine	42	24	Pseudotsuga menziesii	Douglas Fir
18	33	Thuja plicata	Western Red Cedar	43	28	Pseudotsuga menziesii	Douglas Fir
19	10	Cornus kousa	Kousa Dogwood	44	28	Pseudotsuga menziesii	Douglas Fir
20	26	Pseudotsuga menziesii	Douglas Fir	45	30	Pseudotsuga menziesii	Douglas Fir
21	26	Thuja plicata	Western Red Cedar	46	10	Ilex aquifolium	English Holly
22	8	Cornus kousa	Kousa Dogwood	47	14	Ficus sp.	Fig
23	19	Thuja plicata	Western Red Cedar	48	8	Acer macrophyllum	Big Leaf Maple
24	28	Thuja plicata	Western Red Cedar	49	16	Aesculus hippocastanum	Horse Chestnut
25	11	Thuja plicata	Western Red Cedar				

EXISTING
 HOUSE
 #2301

VICTORY HEIGHTS ADD.
 VOL. 24/22

=====
 Re: Project #6761539-CN
 Correction Notice #2
 Review Type TREE
 Date August 13, 2020

Project Address 11348 23RD AVE NE
 SEATTLE, WA 98125
 Contact Phone (206) 459-2364

Contact Email JULIE@LEDOUXCONSTRUCTION.COM Address Seattle Department of Construction and
 SDCI Reviewer Deborah McGarry Inspections
 Email deborah.mcgarry@seattle.gov
 Owner BRUCE WALLACE P.O. Box 34019
 Seattle, WA 98124-4019

"Dear Ms. LeDoux,
 It appears that an updated arborist report is the correction response for my previous correction letter,
 but not all questions were addressed. There are additional outstanding questions regarding trees in
 the 8/3/2020 Zoning Correction Letter. This letter will refer to questions from the zoning correction
 letter and brings up several new concerns. As noted in the Zoning Correction, please provide a
 narrative response to each Correction item listed below. As there are multiple concerns with trees on
 this site and the submitted documentation, there may be additional corrections in future review cycles.
 Thank you.
 Deborah McGarry"

=====
 =====

SDCI document links

Existing site plan showing very large trees on lot proposed to be divided and developed:

[Approved Plan Set - Land Use](#) 1279 KB 07/25/18 [3030102-LU](#) Master Use Permit

Photos and correction comments:

Site Photos	72 MB	12/04/19	005829-19PA	Building & Land Use Pre-Application
Application	630 KB	10/31/19	005829-19PA	Building & Land Use Pre-Application
Correction Letter-Zoning-Cycle2	533 KB	08/03/20	6761539-CN	Construction Permit
Correction Letter-Zoning-Cycle1	512 KB	03/06/20	6761539-CN	Construction Permit
Correction Letter	436 KB	07/21/20	6761539-CN	Construction Permit
Correction Letter-Tree-Cycle2	386 KB	08/13/20	6761539-CN	Construction Permit

Many who care:

Public Comment	89 KB	09/18/17	3028516-LU	Master Use Permit
Public Comment	35 KB	09/18/17	3028516-LU	Master Use Permit
Public Comment	13 KB	09/18/17	3028516-LU	Master Use Permit
Public Comment	12 KB	09/18/17	3028516-LU	Master Use Permit
Public Comment	15 KB	09/18/17	3028516-LU	Master Use Permit
Public Comment	13 KB	09/18/17	3028516-LU	Master Use Permit
Public Comment	14 KB	09/19/17	3028516-LU	Master Use Permit
Public Comment	13 KB	09/19/17	3028516-LU	Master Use Permit
Public Comment	1962 KB	09/19/17	3028516-LU	Master Use Permit
Public Comment	13 KB	09/19/17	3028516-LU	Master Use Permit
Public Comment	14 KB	09/19/17	3028516-LU	Master Use Permit
Public Comment	37 KB	09/19/17	3028516-LU	Master Use Permit
Public Comment	38 KB	09/19/17	3028516-LU	Master Use Permit
Public Comment	13 KB	09/19/17	3028516-LU	Master Use Permit
Public Comment	12 KB	09/19/17	3028516-LU	Master Use Permit
Public Comment	37 KB	09/19/17	3028516-LU	Master Use Permit
Public Comment	14 KB	09/19/17	3028516-LU	Master Use Permit
Public Comment	19 MB	09/19/17	3028516-LU	Master Use Permit
Public Comment	13 KB	09/19/17	3028516-LU	Master Use Permit
Public Comment	57 KB	09/19/17	3028516-LU	Master Use Permit
Public Comment	45 KB	08/28/17	3028516-LU	Master Use Permit

Public Comment	28 KB	08/28/17	3028516-LU	Master Use Permit
Public Comment	47 KB	08/30/17	3028516-LU	Master Use Permit
Public Comment	36 KB	09/05/17	3028516-LU	Master Use Permit
Public Comment	33 KB	09/05/17	3028516-LU	Master Use Permit
Public Comment	117 KB	09/05/17	3028516-LU	Master Use Permit
Public Comment	2 MB	09/05/17	3028516-LU	Master Use Permit
Public Comment	19 KB	09/05/17	3028516-LU	Master Use Permit
Public Comment	38 KB	09/06/17	3028516-LU	Master Use Permit
Public Comment	40 KB	09/11/17	3028516-LU	Master Use Permit
Public Comment	159 KB	09/12/17	3028516-LU	Master Use Permit
Public Comment	4 MB	09/14/17	3028516-LU	Master Use Permit
Public Comment	117 KB	09/14/17	3028516-LU	Master Use Permit
Public Comment	43 KB	09/14/17	3028516-LU	Master Use Permit
Public Comment	12 KB	09/20/17	3028516-LU	Master Use Permit
Public Comment	12 KB	09/20/17	3028516-LU	Master Use Permit
Public Comment	12 KB	09/20/17	3028516-LU	Master Use Permit
Public Comment	34 KB	09/20/17	3028516-LU	Master Use Permit
Public Comment	13 KB	09/20/17	3028516-LU	Master Use Permit
Public Comment	13 KB	09/20/17	3028516-LU	Master Use Permit
Public Comment	12 KB	09/20/17	3028516-LU	Master Use Permit
Public Comment	12 KB	09/20/17	3028516-LU	Master Use Permit
Public Comment	12 KB	09/20/17	3028516-LU	Master Use Permit
Public Comment	12 KB	09/20/17	3028516-LU	Master Use Permit
Public Comment	12 KB	09/20/17	3028516-LU	Master Use Permit
Public Comment	12 KB	09/20/17	3028516-LU	Master Use Permit
Public Comment	12 KB	09/20/17	3028516-LU	Master Use Permit
Public Comment	36 KB	09/20/17	3028516-LU	Master Use Permit
Public Comment	13 KB	09/20/17	3028516-LU	Master Use Permit
Public Comment	12 KB	09/20/17	3028516-LU	Master Use Permit
Public Comment	35 KB	09/20/17	3028516-LU	Master Use Permit
Public Comment	12 KB	09/20/17	3028516-LU	Master Use Permit
Public Comment	12 KB	09/20/17	3028516-LU	Master Use Permit
Public Comment	12 KB	09/20/17	3028516-LU	Master Use Permit
Public Comment	12 KB	09/20/17	3028516-LU	Master Use Permit
Public Comment	36 KB	09/20/17	3028516-LU	Master Use Permit
Public Comment	12 KB	09/20/17	3028516-LU	Master Use Permit
Public Comment	35 KB	09/20/17	3028516-LU	Master Use Permit
Public Comment	36 KB	09/20/17	3028516-LU	Master Use Permit

Public Comment	56 KB	09/20/17	3028516-LU	Master Use Permit
Public Comment	55 KB	09/20/17	3028516-LU	Master Use Permit
Public Comment	53 KB	09/26/17	3028516-LU	Master Use Permit
Public Comment	333 KB	09/01/17	3028516-LU	Master Use Permit
Public Comment	51 KB	09/01/17	3028516-LU	Master Use Permit
Public Comment	51 KB	09/01/17	3028516-LU	Master Use Permit
Public Comment: Songer 09/06/2018	47 KB	09/07/18	3028516-LU	Master Use Permit

From: David Moehring <dmoehring@consultant.com>

Sent: Friday, September 4, 2020 5:20 PM

To: seattle-tree-ordinance-working-grouplists.riseup.net <seattle-tree-ordinance-working-group@lists.riseup.net>

Cc: Pinto de Bader, Sandra <Sandra.Pinto_de_Bader@Seattle.gov>

Subject: Sign Up to Speak that the Comp. Growth Plan also consider trees on Private Property (7:30am signup on Sept 9)

Importance: High

Sensitivity: Confidential

CAUTION: External Email

Dear friends for Seattle's Tree Canopy and Environmental Equity:

Please take a brief moment first thing on **Wednesday, Sept 9** to ask that the [Comprehensive Growth Plan](#) also **include private property trees** in addition to [just street trees](#). By far, most street trees are privately owned, and as such, there exists a significant street tree deficit in Southeast Seattle.



Also of concern are recent developments around Kubota Gardens that are clear-cutting urban forests and displacing affordable housing (as conveyed by L. Hall and M. Batayola on Sept 3 during the [Seward Park Audubon presentation](#).)



Given there is no possible way identified for the City of Seattle to achieve its **30% tree canopy cover goal by 2037** at the present rate of tree decline both from streets** and decline from private property. As such, the existing Comp Plan ignores the vitality of Seattle's Urban Forest of Seattle and the city's canopy cover goals.



Ask that the **reverse the Seattle staff decision that the Comp Plan does not need to consider trees on private property.** The attached pdf is what we proposed two years in a row... but is being denied by City Staff who do not believe we may have BOTH more density AND increased tree canopy. The proposal, as you may see, includes data that substantiates that tree canopy loss continues in Seattle.



HOW TO SIGN UP 7:30 am WEDNESDAY:

See attached notice and below to ask the City Council request Seattle **Comprehensive Growth Plan also consider trees on Private Property** at the Land Use and Neighborhoods Committee – Public Hearing – 9/9/20,

David Moehring
312-965-0634

**decline in street trees from public records in Oct 2019 (thank you Bernice!)

Analyzed spreadsheet with over 17,000 rows, separating it into years

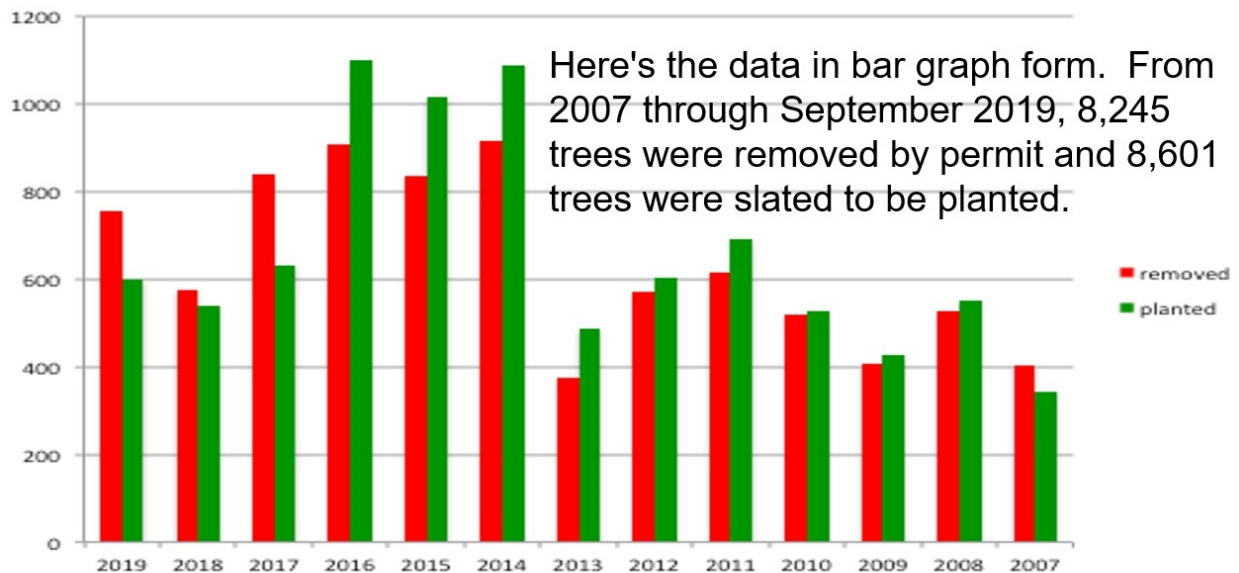

Seattle Street Trees Removed and Planted from 2019 to 2007 records request (tbv)

*** Lack of Street Trees within Environmental Equity and Social Justice areas of Southeast Seattle

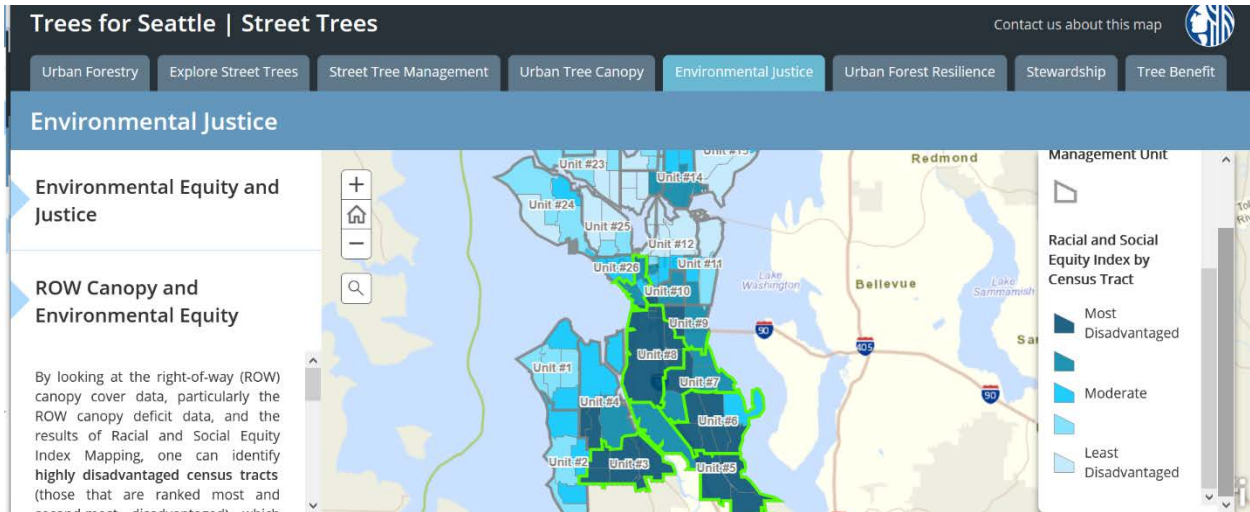

=====

Meeting Location: <http://www.seattle.gov/council/committees/land-use-and-neighborhoods>

Remote Meeting. Call 253-215-8782; Meeting ID: 586 416 9164; or Seattle Channel online.

Committee Website:

This meeting also constitutes a meeting of the City Council, provided that the meeting shall be conducted as a committee meeting under the Council Rules and Procedures, and Council action shall be limited to committee business. In-person attendance is currently prohibited per Washington State Governor's Proclamation No. 20-28.9 through October 1, 2020.

Meeting participation is limited to access by telephone conference line and Seattle Channel online.

Register online to speak during the Public Comment period at the 9:30 a.m Land Use and Neighborhoods Committee meeting at

<http://www.seattle.gov/council/committees/public-comment>.

Online registration to speak at the Land Use and Neighborhoods Committee meeting will begin **two hours before the 9:30 a.m. meeting start time**, and registration will end at the conclusion of the Public Comment period during the meeting.

Speakers must be registered in order to be recognized by the Chair. Submit written comments to all Councilmember Strauss at Dan.Strauss@seattle.gov Sign-up to provide Public Comment at the meeting at <http://www.seattle.gov/council/committees/public-comment>

Watch live streaming video of the meeting at
<http://www.seattle.gov/council/watch-council-live>

Listen to the meeting by calling the Council Chamber Listen Line at 253-215-8782

Meeting ID: **586 416 9164**

One Tap Mobile No. US: [+12532158782,,5864169164#](tel:+12532158782,5864169164)

Sent: Friday, September 04, 2020 at 4:05 PM

From: "Seattle City Council" <councilagenda@seattle.gov>

Subject: Land Use and Neighborhoods Committee – Public Hearing – 9/9/20

[View this email in your browser](#)



SEATTLE CITY COUNCIL

Land Use and Neighborhoods Committee

Agenda - Public Hearing

September 9, 2020

9:30 AM

Members:

[Dan Strauss](#), Chair

Teresa Mosqueda, Vice-Chair

Debora Juarez, Member

Andrew J. Lewis, Member

Alex Pedersen, Member
M. Lorena González, Alternate

Location: Remote Meeting. Call 253-215-8782; Meeting ID: 586 416 9164; or Seattle Channel online.

Committee Website: <http://www.seattle.gov/council/committees/land-use-and-neighborhoods>

This meeting also constitutes a meeting of the City Council, provided that the meeting shall be conducted as a committee meeting under the Council Rules and Procedures, and Council action shall be limited to committee business.

[Read the Agenda](#)

In-person attendance is currently prohibited per Washington State Governor's Proclamation No. 20-28.9 through October 1, 2020. Meeting participation is limited to access by telephone conference line and Seattle Channel online.

Register online to speak during the Public Comment period at the 9:30 a.m Land Use and Neighborhoods Committee meeting at <http://www.seattle.gov/council/committees/public-comment>.

Online registration to speak at the Land Use and Neighborhoods Committee meeting will begin two hours before the 9:30 a.m. meeting start time, and registration will end at the conclusion of the Public Comment period during the meeting. Speakers must be registered in order to be recognized by the Chair.

Submit written comments to all Councilmember Strauss at

Dan.Strauss@seattle.gov

Sign-up to provide Public Comment at the meeting at

<http://www.seattle.gov/council/committees/public-comment>

Watch live streaming video of the meeting at

<http://www.seattle.gov/council/watch-council-live>

Listen to the meeting by calling the Council Chamber Listen Line at 253-215-8782 Meeting ID: 586 416 9164

One Tap Mobile No. US: +12532158782,,5864169164#

A. Call To Order

B. Approval of the Agenda

C. Public Comment
(10 minutes)

D. Items of Business

1. CB 119838

AN ORDINANCE relating to land use and zoning; amending the Seattle Comprehensive Plan to incorporate changes proposed as part of the 2019-2020 Comprehensive Plan annual amendment process.

Attachments:

Att 1 - West Seattle Future Land Use Map Amendments

Att 2 - Delridge Neighborhood Plan Amendments

Supporting Documents:

Summary and Fiscal Note

Director's Report

Central Staff Memo

Presentation (9/9/20)

Briefing, Discussion, and Public Hearing

Presenters: Vanessa Murdock, Executive Director, Seattle Planning Commission; Jim Holmes and Michael Hubner, Office of Planning and Community Development; Eric McConaghy and Lish Whitson, Council Central Staff

Register online to speak at the Public Hearing during the Land Use and Neighborhoods Committee meeting will begin two hours before the 9:30 a.m. meeting at <http://www.seattle.gov/council/committees/public-comment>.

Online registration to speak at the Public Hearing during the Land Use and Neighborhoods Committee meeting will begin two hours before the 9:30 a.m. meeting start time, and registration will end at the conclusion of the Public Hearing during the meeting. Speakers must be registered in order to be recognized by the Chair. If you are unable to attend the remote meeting, please submit written comments to Councilmember Strauss at Dan.Strauss@seattle.gov by September 8, 2020.

2. 2020 - 2021 Comprehensive Plan Annual Docket Setting Resolution

Supporting Documents:

Central Staff Memo

Presentation (9/9/20)

Briefing, Discussion, and Public Hearing

Presenters: Vanessa Murdock, Executive Director, Seattle Planning Commission; Jim Holmes and Michael Hubner, Office of Planning and Community Development; Eric McConaghy and Lish Whitson, Council Central Staff

Register online to speak at the Public Hearing during the Land Use and Neighborhoods Committee meeting will begin two hours before the 9:30 a.m. meeting at <http://www.seattle.gov/council/committees/public-comment>.

Online registration to speak at the Public Hearing during the Land Use and Neighborhoods Committee meeting will begin two hours before the 9:30 a.m. meeting start time, and registration will end at the conclusion of the Public Hearing during the meeting. Speakers must be registered in order to be recognized by the Chair. If you are unable to attend the remote meeting, please submit written comments to Councilmember Strauss at Dan.Strauss@seattle.gov by September 8, 2020.

3. CB 119827

AN ORDINANCE relating to land use and zoning; amending Chapter 23.32 of the Seattle Municipal Code at page 208 of the Official Land Use Map to rezone land in the Rainier Beach neighborhood.

Attachments:

Att 1 – Rezone Map – S. Cloverdale St. Area

Att 2 – Rezone Map – S. Rose St. Area

Supporting Documents:

Summary and Fiscal Note

Director’s Report

Central Staff Memo

Presentation (8/12/20)

OPCD Memo (8/28/20)

Discussion and Possible Vote (15 minutes)

Presenters: Geoffrey Wentlandt, Office of Planning and Community Development; Yolanda Ho, Council Central Staff

4. CB 119877

AN ORDINANCE relating to land use review decision and meeting procedures; temporarily modifying and suspending procedures in Titles 23 and 25 of the Seattle Municipal Code and amending Chapters 23.41, 23.49, 23.66, 23.79, 25.12, 25.16, 25.20, 25.21, 25.22, 25.24, and 25.30 of the Seattle Municipal Code.

Supporting Documents:

Summary and Fiscal Note

Director's Report

SDCI & DON Update on Virtual Meetings (7/22/20)

Presentation

Briefing and Discussion (20 minutes)

Presenters: Mike Podowski and Lisa Rutzick, Seattle Department of Construction and Inspections; Sara Belz, Sarah Sadt, and Maureen Sheehan, Department of Neighborhoods; Ketil Freeman, Council Central Staff

5. Interim Floodplain Regulations

Supporting Documents:

SDCI Memo (7/8/20)

Council Bill 119832 Ordinance 126113

On July 20, 2020 City Council passed Council Bill 119832, Ordinance 126113, relating to floodplains; adopting interim regulations consistent with the Federal Emergency Management Agency (FEMA) regulations; adopting updated National Flood Insurance Rate Maps to allow individuals to continue to obtain flood insurance through FEMA's Flood Insurance Program; and amending Chapter 25.06 and Section 25.09.030 of the Seattle Municipal Code. State law requires the City Council to hold a public hearing within 90 days of adopting these changes.

Briefing and Public Hearing

Presenter: Maggie Glowacki, Seattle Department of Construction and Inspections; Ketil Freeman, Council Central Staff

Register online to speak at the Public Hearing during the Land Use and Neighborhoods Committee meeting will begin two hours before the 9:30 a.m.

meeting at <http://www.seattle.gov/council/committees/public-comment>.

Online registration to speak at the Public Hearing during the Land Use and Neighborhoods Committee meeting will begin two hours before the 9:30 a.m. meeting start time, and registration will end at the conclusion of the Public Hearing during the meeting. Speakers must be registered in order to be recognized by the Chair. If you are unable to attend the remote meeting, please submit written comments to Councilmember Strauss at Dan.Strauss@seattle.gov by September 8, 2020.

E. Adjournment

City Hall is ADA compliant. For accessibility information and for accommodation requests, please call 206-684-8888 (TTY Relay 7-1-1), email CouncilAgenda@Seattle.gov, or visit <http://seattle.gov/cityclerk/accommodations>



Copyright © 2020 Seattle City Council, All rights reserved.

You signed up to receive agenda updates from the Seattle City Council.

Our mailing address is:

Seattle City Council

PO Box 34025
Seattle, WA 98124

[Add us to your address book](#)

Want to change how you receive these emails?
You can [update your preferences](#) or [unsubscribe from this list](#)



From: Drew Foerster <dhf2@uw.edu>
Sent: Monday, September 7, 2020 7:04 AM
To: Pinto de Bader, Sandra <Sandra.Pinto_de_Bader@Seattle.gov>
Subject: Please adopt, with amendments, SDCI's Director's Rule 13-2020

CAUTION: External Email

Sandra Pinto de Bader,

Please adopt, with the amendments recommended by the Seattle Urban Forestry Commission, SDCI's Director's Rule 13-2020 (Designation of Exceptional and Significant Trees, Tree Protection, Retention, and Tree Removal during land division, including tree service provider requirements).

Seattle must move forward now, without the delay urged by some, in adopting this updated Director's Rule with the amendments proposed below. This process of increasing protection for our urban forest was first proposed by the Seattle City Council 11 years ago and is long overdue.

The following updates as proposed in the draft Director's Rule are great steps forward:

- Reducing the upper threshold on exceptional trees to 24 inches in diameter at standard height (DSH) from 30 inches
- Designating trees 6 inches DSH and larger as protected trees, starting in the platting and

short platting process

- Requiring Tree Care Providers to register with the City as the Seattle Dept. of

Transportation already requires

- Continuing protection of tree groves as exceptional trees, even if a tree is removed from the grove
- Making clear that all exceptional trees removed during development must be replaced per SMC 25.11.090
- Tightening tree removal requirements for exceptional trees as hazard trees

The following changes to the draft Director's Rule are needed:

- Change Subject Title to remove words "land division" and replace with "Development"
- PURPOSE AND BACKGROUND. add "SMC 23 requires that all trees 6 inches DSH and larger must be indicated on all site plans throughout the platting and sub-platting process, and that projects must be designed to maximize the retention of existing trees. This requirement continues throughout any subsequent development on all lots in all zones in the city."
- SECTION 1. Reduce the number of trees and sizes required to be a tree grove. Kirkland, Woodinville, and Duvall all define a tree grove as "a group of 3 or more significant trees with overlapping or touching crowns." Include street trees in groves.
- Add "Significant trees may become exceptional as they grow in size. They are future replacements in the urban forest for exceptional trees when they die. Development projects must be designed to maximize the retention of both exceptional and significant trees to maintain a diversity of tree species and ages."
- Add "All replacement trees regardless of size are protected trees and can't be removed."
- SECTION 2. Change the heading to "TREE PROTECTION". Remove references to "Exceptional Trees" only and change to "Trees". e.g., change "Exceptional Tree Protection Areas" to "Tree Protection Areas".
- SECTION 4. Add "The Director shall have the authority to allow replacement trees on both public and private property to meet the goals and objectives of race and social justice under Seattle's Equity and Environment Initiative."
- Under SMC 25.11.090 the Director has the authority to require "one or more trees" to be planted as replacement trees for removed exceptional trees during development. The number of trees required should increase with the size of the tree removed, with a goal to achieve

equivalent canopy area and volume in 25 years. Any in-lieu fee must also rise as the size of the removed tree increases. The city can not wait 80 years to replace an 80-year-old western red cedar tree and expect to maintain its canopy goals as large exceptional trees are removed during development.

- SECTION 5. SEPA requirements under SMC 25.05.675 N are for protecting special habitats and need to be considered at the beginning of the development process. The language of this SEPA code section should be included in the Director's Rule to be certain that the code is complied with.
- SECTION 6. SDCI should adopt SDOT's registration process and requirements to assist Tree Care Providers in complying with city code and regulations. Reduce the number of citations that will remove a Tree Care Provider from being registered with the city to no more than 2 per year. Require annual registration same as Seattle business licenses require. Require that Tree Care Provider companies have a WA State contractor's license to ensure they have workers' compensation. Require they have a certificate of insurance that lists the city as an additional insured so the city cannot be sued. Require that all jobs either have a certified arborist on the work site or that they have visited the site and officially sign off on the specific work being done.

Thank you for protecting our urban forest.

Drew Foerster

dhf2@uw.edu

3218 34th Ave w

Seattle, Washington 98199

From: Stuart Jones <info@email.actionnetwork.org>
Sent: Monday, September 7, 2020 1:44 PM
To: Pinto de Bader, Sandra <Sandra.Pinto_de_Bader@Seattle.gov>
Subject: Please Update Seattle's Tree Ordinance

CAUTION: External Email

Sandra Pinto de Bader,

Seattle's trees and urban forest are vital to keeping our city healthy and livable. Trees and the urban forest comprise a vital green infrastructure. Trees reduce air pollution, storm water runoff and climate impacts like heat island effects, while providing essential habitat for birds and other wildlife. They are important for the physical and mental health of our residents.

Seattle's rapid growth and an outdated tree ordinance are reducing these beneficial effects as trees are removed and not replaced. It is urgent to act now to stop this continued loss of trees, particularly large mature trees and tree groves. It is important to promote environmental equity as trees are replaced.

Please update Seattle's Tree Protection Ordinance as recommended in the latest draft by the Seattle Urban Forestry Commission.

Here are the key provisions that need to be in the updated tree ordinance:

1. Expand the existing Tree Removal and Replacement Permit Program, including 2-week public notice and posting on-site, as used by the Seattle Department of Transportation (SDOT) – to cover all Significant Trees (6" and larger diameter at breast height (DBH)) on private property in all land use zones, both during development and outside development.
2. Require the replacement of all Significant Trees removed with trees that in 25 years will reach equivalent canopy volume – either on site or pay a replacement fee into a City Tree Replacement and Preservation Fund. Allow the Fund to also accept fines, donations, grants and set up easements.
3. Retain current protections for Exceptional Trees and reduce the upper threshold for Exceptional Trees to 24" DBH, protect tree groves and prohibit Significant Trees being removed on undeveloped lots.
4. Allow removal of no more than 2 Significant non-Exceptional Trees in 3 years per lot outside development
5. Establish one citywide database for applying for Tree Removal and Replacement Permits and to track changes in the tree canopy.
6. Post online all permit requests and permit approvals for public viewing.
7. Expand SDOT's existing tree service provider's registration and certification to register all

Tree Service Providers (arborists) working on trees in Seattle.

8. Provide adequate funding in the budget to implement and enforce the updated ordinance.

Stuart Jones

stuart.jones08@gmail.com

403 Belmont Ave E

Seattle, Washington 98102

From: June BlueSpruce <jbluespruce@gmail.com>

Sent: Monday, September 7, 2020 1:59 PM

To: LEG_CouncilMembers <council@seattle.gov>; Sawant, Kshama <Kshama.Sawant@seattle.gov>; Juarez, Debora <Debora.Juarez@seattle.gov>; Gonzalez, Lorena <Lorena.Gonzalez@seattle.gov>; Mosqueda, Teresa <Teresa.Mosqueda@seattle.gov>; Morales, Tammy <Tammy.Morales@seattle.gov>; Pedersen, Alex <Alex.Pedersen@seattle.gov>; Lewis, Andrew <Andrew.Lewis@seattle.gov>; Herbold, Lisa <Lisa.Herbold@seattle.gov>; Strauss, Dan <Dan.Strauss@seattle.gov>; Durkan, Jenny <Jenny.Durkan@seattle.gov>; Torgelson, Nathan <Nathan.Torgelson@seattle.gov>; Podowski, Mike <Mike.Podowski@seattle.gov>; Emery, Chanda <Chanda.Emery@Seattle.gov>

Cc: Pinto de Bader, Sandra <Sandra.Pinto_de_Bader@Seattle.gov>; Manson, Joseph <Joseph.Manson@audubon.org>; Woody Wheeler <woody.wheeler@gmail.com>; David Moehring <dmoehring@consultant.com>; Maria Batayola <mbjumpstart@msn.com>; Lia H <liayaranon@gmail.com>; Deb Heiden <nature-grl@live.com>; Silvernail, Devin <Devin.Silvernail@seattle.gov>

Subject: Please protect Seattle's urban forest NOW

CAUTION: External Email

Dear Mayor Durkan, members of the Seattle City Council, and leaders and staff of Seattle Department of Construction and Inspections:

Last Thursday night, the Seward Park Audubon Center presented a panel on Seattle's tree canopy - its current status; the serious threats it faces; the impacts of environmental racism on health, the economy, and community displacement; and what citizens of Seattle can do to protect trees. I encourage you and your staff to watch the video [here](#). You will recognize several of us from City Council and committee hearings. On the panel, we were able to tell the story of Seattle's trees much more completely than we can in 1-2 minute testimony at meetings.

I urge you to act now to protect Seattle's urban forest. As you know, the tree protection ordinance we have in place was passed as an interim measure 11 years ago. It was inadequate then; it's more so now. Last fall, you passed a resolution committing to a process to develop, study the implementation of, and get public feedback on an updated ordinance based on a draft written a year ago by the Urban Forestry Commission. Unfortunately, the COVID pandemic has slowed this process down, and I am advised that it's unlikely that a stronger ordinance will be passed this year. Meanwhile, the loss of trees to development continues at a frantic pace.

I urge you to:

- Place an immediate, temporary moratorium on removal of any tree that is 24" or greater DBH, any other tree that is designated as exceptional at a smaller size, and any tree grove. to remain in force until stronger tree protection is fully in place.
- Ensure that the SDCI's proposed Director's Rule 13-2020 is edited according to feedback given during the comment period and implemented as soon as possible.
- During the current budget season, ensure that adequate funding is allocated to enforce stronger tree protection regulations (in the new Director's Rule and in any anticipated strengthened tree ordinance) for 2021, including more arborists for SDCI. I know that Seattle faces a budget shortfall from the COVID epidemic. But allowing trees to be cut through non-enforcement of protection regulations is incredibly short-sighted. It will cost far more to replace trees and deal with the negative environmental consequences of their loss than to protect them in the first place.
- Ensure that the process to develop, get community input on, and pass a stronger tree protection ordinance is accelerated. The trees can't wait.

Thank you.

Sincerely yours,

June BlueSpruce
5008 44th Ave. S. (District 2)
Seattle, WA 98118
206-579-1203

--

*"Possibilities are not hopes for the future. They are realities in the present."
Dr. Gabor Mate, Sounds True Healing Trauma Summit, June 4, 2018*

From: Christine Vensand <info@email.actionnetwork.org>

Sent: Monday, September 7, 2020 3:30 PM

To: Pinto de Bader, Sandra <Sandra.Pinto_de_Bader@Seattle.gov>

Subject: Keep Seattle Livable!

CAUTION: External Email

Sandra Pinto de Bader,

Seattle's trees and urban forest are vital to keeping our city healthy and livable. Trees and the urban forest comprise a vital green infrastructure. Trees reduce air pollution, storm water runoff and climate impacts like heat island effects, while providing essential habitat for birds and other wildlife. They are important for the physical and mental health of our residents.

Seattle's rapid growth and an outdated tree ordinance are reducing these beneficial effects as trees are removed and not replaced. It is urgent to act now to stop this continued loss of trees, particularly large mature trees and tree groves. It is important to promote environmental equity as trees are replaced.

Please update Seattle's Tree Protection Ordinance as recommended in the latest draft by the Seattle Urban Forestry Commission.

Here are the key provisions that need to be in the updated tree ordinance:

1. Expand the existing Tree Removal and Replacement Permit Program, including 2-week public notice and posting on-site, as used by the Seattle Department of Transportation (SDOT) – to cover all Significant Trees (6" and larger diameter at breast height (DBH)) on private property in all land use zones, both during development and outside development.
2. Require the replacement of all Significant Trees removed with trees that in 25 years will reach equivalent canopy volume – either on site or pay a replacement fee into a City Tree Replacement and Preservation Fund. Allow the Fund to also accept fines, donations, grants and set up easements.
3. Retain current protections for Exceptional Trees and reduce the upper threshold for Exceptional Trees to 24" DBH, protect tree groves and prohibit Significant Trees being removed on undeveloped lots.
4. Allow removal of no more than 2 Significant non-Exceptional Trees in 3 years per lot outside development
5. Establish one citywide database for applying for Tree Removal and Replacement Permits

and to track changes in the tree canopy.

6. Post online all permit requests and permit approvals for public viewing.
7. Expand SDOT's existing tree service provider's registration and certification to register all Tree Service Providers (arborists) working on trees in Seattle.
8. Provide adequate funding in the budget to implement and enforce the updated ordinance.

I am new to Seattle as of this summer. One of the things that I have loved about visiting this city and now living here, is the marvelous amount of beautiful trees. It makes me feel peaceful and joyful to drive down streets with lots of trees especially those streets with an arching tree canopy. Hopefully, I will be in a position to buy a home here at some point in the future. I am purposely going to seek out streets that have a good tree cover because to me that's what makes it feel like Seattle. We should be doing everything we can to preserve the trees for all the reasons listed above.

Christine Vensand

cvensand@hotmail.com

3500 25th Ave W #323

Seattle, Washington 98199

From: David Moehring <info@email.actionnetwork.org>
Sent: Tuesday, September 8, 2020 6:12 AM
To: Pinto de Bader, Sandra <Sandra.Pinto_de_Bader@Seattle.gov>
Subject: Please Update Seattle's Tree Ordinance

CAUTION: External Email

Sandra Pinto de Bader,

Last Thursday night, the Seward Park Audubon Center presented a panel on Seattle's tree canopy - its current status; the serious threats it faces; the impacts of environmental racism on health, the economy, and community displacement; and what citizens of Seattle can do to

protect trees. I encourage you and your staff to watch the video. The 3rd and 4th Segments call out our city's recent examples of social and racial injustice relative to the urban forest tree canopy. The 5th segment notes what the City should do including the abbreviated efforts of SDCI with proposed improved Director Rule for Exceptional Trees:

<https://youtu.be/Ki8tsN01pcs>

(Segment 2 provides locations from City data collected where the tree canopy is inequitably low and declining.)

I urge you to act now to protect Seattle's urban forest. As you know, the tree protection ordinance we have in place was passed as an interim measure 11 years ago. It was inadequate then; it's more so now. Last fall, you passed a resolution committing to a process to develop, study the implementation of, and get public feedback on an updated ordinance based on a draft written a year ago by the Urban Forestry Commission. Unfortunately, the COVID pandemic has slowed this process down, and I am advised that it's unlikely that a stronger ordinance will be passed this year. Meanwhile, the loss of trees to development continues at a frantic pace.

I urge you to:

Place an immediate, temporary moratorium on removal of any tree that is 24" or greater DBH, any other tree that is designated as exceptional at a smaller size, and any tree grove. to remain in force until stronger tree protection is fully in place.

Ensure that the SDCI's proposed Director's Rule 13-2020 is edited according to feedback given during the comment period and implemented as soon as possible.

During the current budget season, ensure that adequate funding is allocated to enforce stronger tree protection regulations (in the new Director's Rule and in any anticipated strengthened tree ordinance) for 2021, including more arborists for SDCI. I know that Seattle faces a budget shortfall from the COVID epidemic. But allowing trees to be cut through non-enforcement of protection regulations is incredibly short-sighted. It will cost far more to replace trees and deal with the negative environmental consequences of their loss than to protect them in the first place.

Ensure that the process to develop, get community input on, and pass a stronger tree

protection ordinance is accelerated. The trees can't wait.

Thank you!

David Moehring

moehringconsultant@gmail.com

3444B 23rd Ave W

Seattle, Washington 98199

From: Cynthia Rose <info@email.actionnetwork.org>
Sent: Tuesday, September 8, 2020 11:20 PM
To: Pinto de Bader, Sandra <Sandra.Pinto_de_Bader@Seattle.gov>
Subject: Protect Seattle's Urban Forest

CAUTION: External Email

Sandra Pinto de Bader,

Please update Seattle's Tree Protection Ordinance as recommended in the latest draft by the Seattle Urban Forestry Commission.

Here are the key provisions that need to be in the updated tree ordinance:

1. Expand the existing Tree Removal and Replacement Permit Program, including 2-week public notice and posting on-site, as used by the Seattle Department of Transportation (SDOT) – to cover all Significant Trees (6" and larger diameter at breast height (DBH)) on private property in all land use zones, both during development and outside development.
2. Require the replacement of all Significant Trees removed with trees that in 25 years will reach equivalent canopy volume – either on site or pay a replacement fee into a City Tree Replacement and Preservation Fund. Allow the Fund to also accept fines, donations, grants and set up easements.
3. Retain current protections for Exceptional Trees and reduce the upper threshold for

Exceptional Trees to 24" DBH, protect tree groves and prohibit Significant Trees being removed on undeveloped lots.

4. Allow removal of no more than 2 Significant non-Exceptional Trees in 3 years per lot outside development
5. Establish one citywide database for applying for Tree Removal and Replacement Permits and to track changes in the tree canopy.
6. Post online all permit requests and permit approvals for public viewing.
7. Expand SDOT's existing tree service provider's registration and certification to register all Tree Service Providers (arborists) working on trees in Seattle.
8. Provide adequate funding in the budget to implement and enforce the updated ordinance.

Also, it is important that the Comprehensive Growth Plan also include private property trees in addition to just street trees. By far, most street trees are privately owned, and as such, there exists a significant street tree deficit in Southeast Seattle.

Please reverse the Seattle staff decision that the Comp Plan does not need to consider trees on private property.

Sincerely yours,

Cynthia Rose

Cynthia Rose

crose1453@gmail.com

11557 23rd Ave NE

Seattle Washington 98125, Washington 98125

From: David Moehring <dmoehring@consultant.com>

Sent: Tuesday, September 8, 2020 11:58 PM

To: PRC <PRC@seattle.gov>

Cc: Pederson, Art <Art.Pederson@seattle.gov>; Pinto de Bader, Sandra <Sandra.Pinto_de_Bader@Seattle.gov>

Subject: 6 back yard townhouses behind 4 rowhouses at 9205 and 9209 14TH AVE NW - trees large removed and at risk

Dear PRC,

Thank you for allowing comment on both **9209 14TH AVE NW** (Project: 3036845-EG) and **9205 14th Ave NW** (#3036643-EG).

This is one SEPA **functionally-related development** with many mature trees at risk due to the lack of design constructability considerations. Please refer to the attached preferred site plan of 10 market-rate (not affordable) homes on a 10,880 sq ft parent lot owned by David and Gerlick Nugent (per King County record).

There is not enough space provided for retention of existing trees just because the proposal is **seeking 10 verses the allowed 8 units**. By the way, the plans show trees with driplines pruned back and ignoring the critical root zone which does not also follow the edge of the branch pruning. A city arborist should see this site.



Should design review comments from the public consider whether 10 rowhouses with townhouses is **code compliant**?

"**No**", we will be told. I'm sure that the City staff will be noting that zoning code issues are outside the scope of design review, correct?



But recommending **design code departures** are within the scope of design review... "**yes**", we will be told. The last several pages list at least four (4) design departures. **

In other words, do not comment about code issues but design departures from the code will be considered. With this somewhat jaded process one could essentially propose a 50-story tower on this site and the public would not be allowed to comment that the design might be nice but it is incorrect for the properties zoning.

To demonstrate the problem: the **design submission states**:

We are proposing ten (10) new ground-related dwelling units on a LR1 site in the Crown Hill neighborhood of Seattle. The 10,898 sf lot will be divided

into two sites: One 3,270 sf site fronting on 14th Ave NW, and one 7,628 sf site to the west that will be accessed via the smaller site.



So... even though the new LR1(M) zoning allows up to 1 dwelling for every 1300 sq ft of land area, this proposal going in for design review is seeking 1 dwelling for every 1,090 sq ft of land area. Instead of the code allowed eight (8) dwellings; this LR1 site will be burdened with two additional dwellings or ten (10) dwellings so that the developer's investors may capitalize on an additional 20% revenue gain.

Why does the Department of Construction allow this circumvention of Seattle's zoning code?

Moreover, why are the Rowhouse Development Rules that do not allow rowhouses between the street and other primary dwellings on the same property? Legally, it was not even two buildable lots. King County states the parent lot to be comprised of the south 20 feet of one-half of lot 8, and one-half of lot 9 (S 20 FT OF E 1/2 OF 8 & E 1/2 OF 9). Two half-lots do not make two full lots.

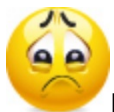

None of the 3 options presented show 8 dwellings and none of the three options **are code complying**. So please ask the design proposal to remove the phase "*Code Complying*" in the the drawing SITE PLAN - OPTION 1.

from the proposal:

[Design Review EDG Proposal - Draft](#) 14 MB 09/02/20 [3036643-EG](#) Early Design Guidance

Project Description:

Administrative Design Review for 3, 3-story, townhouse buildings (6-units total). Parking for 6 vehicles proposed. To be **considered with 3036643-EG** for shared access.

Summary:

Housing for Seattle: **yes!**

Circumvention of code requirements and design standards: **never!**

Space for excavation around the existing trees to remain.

Stand up for Seattle's code intent and send this back to the drawing board.

Thank you!

David Moehring
TreePAC

=====

** Design departures copied and pasted here for your reference:

CS2.C.2 – Relationship to block - mid-block site: The adjacent Queen Mary rowhouses have proposed a side facade of slightly more than 28' in length (which is our proposed facade length limit). Matching this facade length allows us to maintain consistency along this block face and at the internal interface points on these sites.

CS1.D.1 – On site features: The notch at rowhouse 1 has definite area impacts that translate all the way down to rowhouse 4 by nature of the fact that we have a very limited site. If the geometry of all four townhomes were to be consistent (**eg, removal of the tree**), it would be much easier to comply the facade length limitation. We feel that retaining this tree is important, and we are asking for a small amount of flexibility to allow for this.

DC2.A.2 – Reduce Perceived Massing: Instead of compacting the form in the east west direction to meet a facade length requirement, we can stretch the form east/west and create a bump-out at the upper two levels. This move provides better articulation and actually lightens the visual mass of the building.

PL3.A.1.D – Individual entries: The additional facade length will provide an overhang at the upper level that helps to define and scale down the rowhouse entry on the street-facing facade of the dwelling.

=====

IN THE KNOW?

- 1862400096 **ISOLA REAL ESTATE VII LLC** 9202 MARY AVE NW SEATTLE 98117
- 1862400100 **ISOLA REAL ESTATE VII LLC** 9203 14TH AVE NW SEATTLE 98117
- 1862400095 NISKANEN JANNA+ANDREW 9210 MARY AVE NW SEATTLE 98117
- 3626039397 **SEATTLE CITY OF DPR** 9200 14TH AVE NW SEATTLE 98117
- **1862400090 NUGENT DAVID+GERLICK B 9205 14TH AVE NW SEATTLE 98117**
- 1862400473 ELLINGSEN ERIK C & MCCAIN L 9048 B MARY AVE NW SEATTLE 98117
- 3626039053 SMALL FACES CHILD DEVELOP 9490 14TH AVE NW SEATTLE 98117
- 1862400465 HURLEY DANA+THOMLINSON MATT 9048 A MARY AVE NW SEATTLE 98117
- 1862400410 CLASSICAL PROPERTIES LLC 9075 HOLMAN RD NW SEATTLE 98117

- 1862400461 BOYCE-HAAS PROPERTIES LLC 9069 HOLMAN RD NW SEATTLE 98117
- 1862400070 SCHWALBE DANIEL F 9234 MARY AVE NW SEATTLE 98117
- 1862400072 SHASHA BENJAMIN & DANIELA 9231 14TH AVE NW SEATTLE 98117
- 1862400065 HUBER MICHAEL R+DANIELLE E 9239 14TH AVE NW SEATTLE 98117
- 1862400087 KARCZ THOMAS 9214 MARY AV SEATTLE E NW
- 0323000000 9056 MARY AVE NW 98117
- 1862400085 LEE GLEN W 9221 14TH AVE NW SEATTLE 98117
- 1862400086 KAPIL BHUVNESH+NEHA NEHA 9222 MARY AVE NW SEATTLE 98117
- 1862400081 MCMILLEN KENNETH R 9223 14TH AVE NW SEATTLE 98117
- 1862400073 SMITH MICHAEL J+EMILY A 9230 MARY AVE NW SEATTLE 98117
- 1862400080 WILLIAMS MARY P 9224 MARY AVE NW SEATTLE 98117

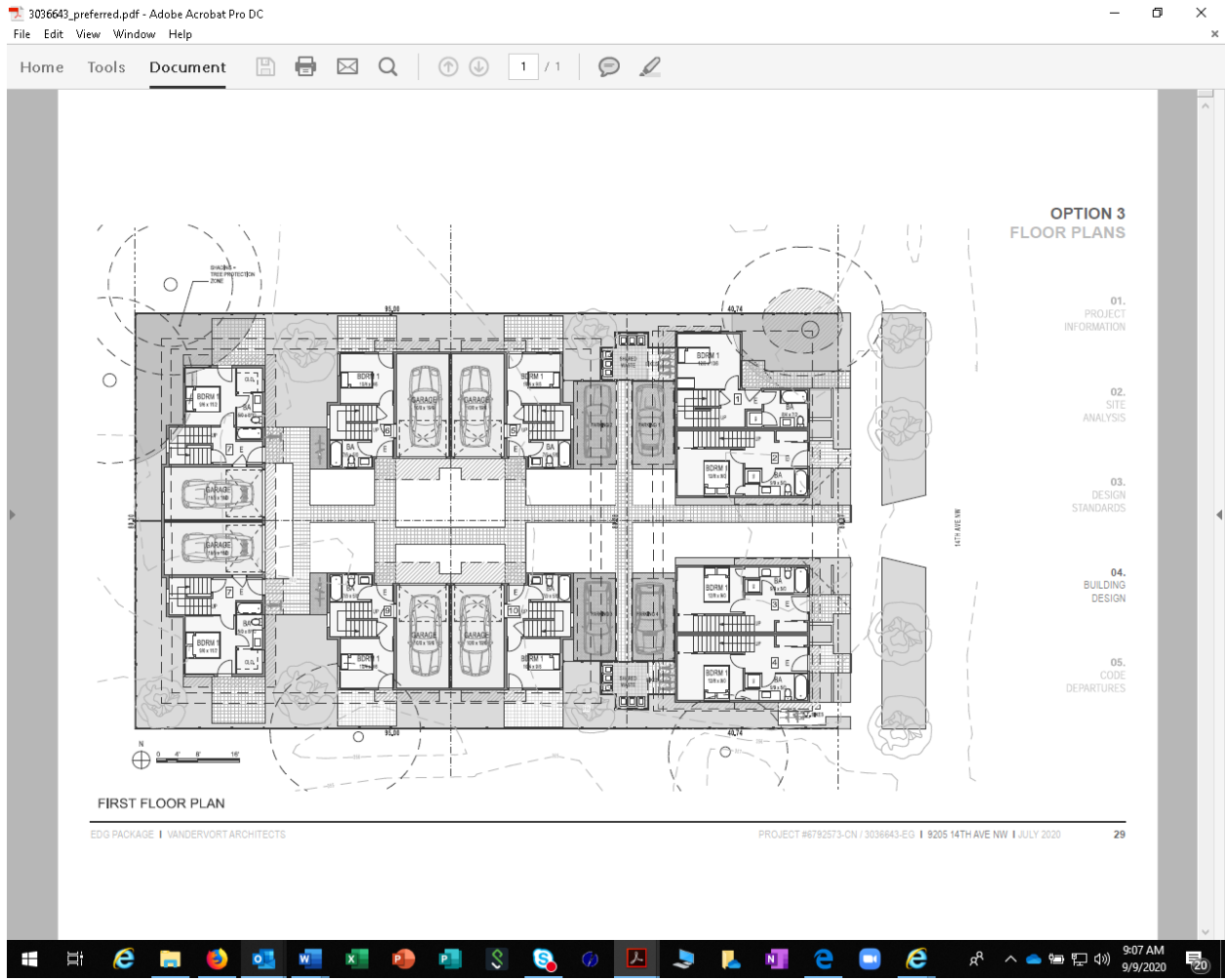

From: Bernice Maslan <info@email.actionnetwork.org>
Sent: Wednesday, September 9, 2020 1:04 AM
To: Pinto de Bader, Sandra <Sandra.Pinto_de_Bader@Seattle.gov>
Subject: Impt to include privately owned trees in Comprehensive Growth Plan

Sandra Pinto de Bader,

In this season of Covid, when people are spending huge amounts of time at home, it is especially important to protect non-City trees also. Two-thirds of Seattle's trees are on private land and are very vulnerable to developers. Growth and tree maintenance can co-exist! We need to protect our trees and urban forest which are vital to keeping our city healthy and livable. Trees and the urban forest comprise a vital green infrastructure. Trees reduce air pollution, storm water runoff and climate impacts like heat island effects, while providing essential habitat for birds and other wildlife. They are important for the physical and mental health of our residents.

Seattle's rapid growth and an outdated tree ordinance are reducing these beneficial effects as trees are removed and not replaced. It is urgent to act now to stop this continued loss of trees, particularly large mature trees and tree groves. It is important to promote environmental equity as trees are replaced.

Please update Seattle's Tree Protection Ordinance as recommended in the latest draft by the Seattle Urban Forestry Commission and fund enforcement.

Here are the key provisions that need to be in the updated tree ordinance:

1. Expand the existing Tree Removal and Replacement Permit Program, including 2-week public notice and posting on-site, as used by the Seattle Department of Transportation (SDOT) – to cover all Significant Trees (6" and larger diameter at breast height (DBH)) on private property in all land use zones, both during development and outside development.
2. Require the replacement of all Significant Trees removed with trees that in 25 years will reach equivalent canopy volume – either on site or pay a replacement fee into a City Tree Replacement and Preservation Fund. Allow the Fund to also accept fines, donations, grants and set up easements.
3. Retain current protections for Exceptional Trees and reduce the upper threshold for Exceptional Trees to 24" DBH, protect tree groves and prohibit Significant Trees being removed on undeveloped lots.

4. Allow removal of no more than 2 Significant non-Exceptional Trees in 3 years per lot outside development
5. Establish one citywide database for applying for Tree Removal and Replacement Permits and to track changes in the tree canopy.
6. Post online all permit requests and permit approvals for public viewing.
7. Expand SDOT's existing tree service provider's registration and certification to register all Tree Service Providers (arborists) working on trees in Seattle.
8. Provide adequate funding in the budget to implement and enforce the updated ordinance.

Bernice Maslan

bmaslan@yahoo.com

9705 1st Ave NW

Seattle, Washington 98117

From: Annie Thoe <info@email.actionnetwork.org>
Sent: Wednesday, September 9, 2020 8:34 AM
To: Pinto de Bader, Sandra <Sandra.Pinto_de_Bader@Seattle.gov>
Subject: Adding Private Trees to Comprehensive Growth Plan

CAUTION: External Email

Sandra Pinto de Bader,

Please make sure that the Comprehensive Growth Plan includes private property trees IN ADDITION to just street trees. By far, MOST street trees are privately owned, and as such, there exists a significant street tree deficit in Southeast Seattle.

The recent developments around Kubota Gardens are clear-cutting essential urban forests and displacing affordable housing (as conveyed by L. Hall and M. Batayola on Sept 3 during the Seward Park Audubon presentation.)

Given there is no possible way identified for the City of Seattle to achieve its 30% tree canopy cover goal by 2037 at the present rate of tree decline both from streets** and decline from private property. As such, the existing Comp Plan ignores the vitality of Seattle's Urban Forest of Seattle and the city's canopy cover goals.

I urge you to reverse the Seattle staff decision that the Comp Plan does not need to consider trees on private property. City Staff do not believe we may have BOTH more density AND increased tree canopy. There is data that substantiates that tree canopy loss continues in Seattle.

Please update Seattle's Tree Protection Ordinance as recommended in the latest draft by the Seattle Urban Forestry Commission.

Here are the key provisions that need to be in the updated tree ordinance:

1. Expand the existing Tree Removal and Replacement Permit Program, including 2-week public notice and posting on-site, as used by the Seattle Department of Transportation (SDOT) – to cover all Significant Trees (6" and larger diameter at breast height (DBH)) on private property in all land use zones, both during development and outside development.
2. Require the replacement of all Significant Trees removed with trees that in 25 years will reach equivalent canopy volume – either on site or pay a replacement fee into a City Tree Replacement and Preservation Fund. Allow the Fund to also accept fines, donations, grants and set up easements.
3. Retain current protections for Exceptional Trees and reduce the upper threshold for Exceptional Trees to 24" DBH, protect tree groves and prohibit Significant Trees being removed on undeveloped lots.
4. Allow removal of no more than 2 Significant non-Exceptional Trees in 3 years per lot outside development
5. Establish one citywide database for applying for Tree Removal and Replacement Permits and to track changes in the tree canopy.
6. Post online all permit requests and permit approvals for public viewing.
7. Expand SDOT's existing tree service provider's registration and certification to register all Tree Service Providers (arborists) working on trees in Seattle.
8. Provide adequate funding in the budget to implement and enforce the updated ordinance.

Thank you so much for stewarding our land and preserving our health and habitat.

Respectfully,
Annie Thoe

Annie Thoe
anniethoe@gmail.com
2201 NE 120th St
Seattle, Washington 98125

From: Lindsay Gorang <info@email.actionnetwork.org>
Sent: Wednesday, September 9, 2020 9:43 AM
To: Pinto de Bader, Sandra <Sandra.Pinto_de_Bader@Seattle.gov>
Subject: Please adopt, with amendments, SDCI's Director's Rule 13-2020

CAUTION: External Email

Sandra Pinto de Bader,

Please adopt, with the amendments recommended by the Seattle Urban Forestry Commission, SDCI's Director's Rule 13-2020 (Designation of Exceptional and Significant Trees, Tree Protection, Retention, and Tree Removal during land division, including tree service provider requirements).

Seattle must move forward now, without the delay urged by some, in adopting this updated Director's Rule with the amendments proposed below. This process of increasing protection for our urban forest was first proposed by the Seattle City Council 11 years ago and is long overdue.

The following updates as proposed in the draft Director's Rule are great steps forward:

- *****Reducing the upper threshold on exceptional trees to 24 inches in diameter at standard height (DSH) from 30 inches (Most of all, I hope this is adopted!)
- Designating trees 6 inches DSH and larger as protected trees, starting in the platting and

short platting process

- Requiring Tree Care Providers to register with the City as the Seattle Dept. of

Transportation already requires

- Continuing protection of tree groves as exceptional trees, even if a tree is removed from the grove
- Making clear that all exceptional trees removed during development must be replaced per SMC 25.11.090
- Tightening tree removal requirements for exceptional trees as hazard trees

The following changes to the draft Director's Rule are needed:

- Change Subject Title to remove words "land division" and replace with "Development"
- PURPOSE AND BACKGROUND. add "SMC 23 requires that all trees 6 inches DSH and larger must be indicated on all site plans throughout the platting and sub-platting process, and that projects must be designed to maximize the retention of existing trees. This requirement continues throughout any subsequent development on all lots in all zones in the city."
- SECTION 1. Reduce the number of trees and sizes required to be a tree grove. Kirkland, Woodinville, and Duvall all define a tree grove as "a group of 3 or more significant trees with overlapping or touching crowns." Include street trees in groves.
- Add "Significant trees may become exceptional as they grow in size. They are future replacements in the urban forest for exceptional trees when they die. Development projects must be designed to maximize the retention of both exceptional and significant trees to maintain a diversity of tree species and ages."
- Add "All replacement trees regardless of size are protected trees and can't be removed."
- SECTION 2. Change the heading to "TREE PROTECTION". Remove references to "Exceptional Trees" only and change to "Trees". e.g., change "Exceptional Tree Protection Areas" to "Tree Protection Areas".
- SECTION 4. Add "The Director shall have the authority to allow replacement trees on both public and private property to meet the goals and objectives of race and social justice under Seattle's Equity and Environment Initiative."
- Under SMC 25.11.090 the Director has the authority to require "one or more trees" to be planted as replacement trees for removed exceptional trees during development. The number of trees required should increase with the size of the tree removed, with a goal to achieve

equivalent canopy area and volume in 25 years. Any in-lieu fee must also rise as the size of the removed tree increases. The city can not wait 80 years to replace an 80-year-old western red cedar tree and expect to maintain its canopy goals as large exceptional trees are removed during development.

- SECTION 5. SEPA requirements under SMC 25.05.675 N are for protecting special habitats and need to be considered at the beginning of the development process. The language of this SEPA code section should be included in the Director's Rule to be certain that the code is complied with.
- SECTION 6. SDCI should adopt SDOT's registration process and requirements to assist Tree Care Providers in complying with city code and regulations. Reduce the number of citations that will remove a Tree Care Provider from being registered with the city to no more than 2 per year. Require annual registration same as Seattle business licenses require. Require that Tree Care Provider companies have a WA State contractor's license to ensure they have workers' compensation. Require they have a certificate of insurance that lists the city as an additional insured so the city cannot be sued. Require that all jobs either have a certified arborist on the work site or that they have visited the site and officially sign off on the specific work being done.

Thank you for protecting our urban forest.

Lindsay Gorang

lindsaygorang@gmail.com

3710 NW 65th St

Seattle, Washington 98117

From: Rebecca Watson <rebecca.watson@gmail.com>

Sent: Wednesday, September 9, 2020 9:56 AM

To: LEG_CouncilMembers <council@seattle.gov>; Durkan, Jenny <Jenny.Durkan@seattle.gov>

Cc: Pinto de Bader, Sandra <Sandra.Pinto_de_Bader@Seattle.gov>

Subject: Please Preserve the Tree Canopy - Adopt the Tree Ordinance Now

CAUTION: External Email

9 September 2020

Dear Mayor Durkan, Seattle City Council members, Seattle Department of Construction and Inspections staff:

As I write to you from my home in West Seattle, wildfires are burning throughout Washington State. It's hot. The air quality is unhealthy. Why I mention this is this morning I am thinking about trees, and the incredible amount of work they do each and every day on our behalf - from cleaning the air, to providing shade, buffering noise and reducing pollution caused by water run-off. Not to mention the documented emotional and physical benefits they provide for us all. I note this, but realize I am privileged to live in an area where there are numbers of trees - in parks and greenspace, street trees and in household lots. What I worry about is the many in our community living in areas where tree canopy is wholly inadequate - where air quality is worse, flooding and landslides occur, and heat is extreme. And with each walk I take, I see more and more smaller houses being replaced by very large single family residences that leave inadequate space for trees and greenspace. Affordable housing is necessary but this is not affordable housing. In these situations, it is clear, different choices could be made to preserve tree canopy that takes years and years to establish.

Although I do appreciate that this has been an unprecedented time with the COVID-19 pandemic and all of it's societal impacts, the calls for equity and social justice and police accountability, the need for affordable housing, the need to address the mental illness and homelessness crisis - what better time for a small but important action from the Mayor and City council. A small ray of hope. I realize the incredible scrutiny, and challenges for county and city governments facing budget shortfalls and having to make very hard decisions. But we need to do something now to mitigate the continuing impacts of the climate crisis. I support the Urban Forest Commissions (your experts) proposed tree ordinance and any/all revisions they suggest, and ask that you take the next step and adopt it now. The trees can't wait.

Thank you.

Rebecca Watson
rebecca.watson@gmail.com

From: Siegelbaum, Heidi
Sent: Wednesday, September 9, 2020 8:41 AM
To: Dan.Strauss@seattle.gov
Cc: Seattle City Council <councilagenda@seattle.gov>
Subject: Protecting trees as public health infrastructure

Dear Council member Strauss and Council members:

With this letter we request that you include full protection for ALL trees, including those on private property, during your deliberations on the Comprehensive Plan. If you are paying attention to:

- Climate change
- Stormwater (that nice little CSO project cost the city billions so you should pay attention to the role of trees in attenuating stormwater)
- Air quality and public health
- That thing called quality of life and community
- Livability in your quest to create density; density should not mean crappy, ugly, hot and gray living conditions and design.....
- Tree Canopy Goals and the Urban Forest Management Plan

Then your response should be to protect ALL trees regardless of location. This includes private property.

You have been---with SDCI- --totally complicit in ruining the city and rather than using your smart selves, your innovative thinking, some research (do you have staff that can help you?) you just give in to the outsized influence of developers and fail to ask them to comply with the law, enforce it yourselves (via SDCI) or to change laws to permit greater height to protect large trees during development/redevelopment. What are you doing?????

You must reverse your decision and use evidence- not influence—to make your decision. We can have both density and trees with DESIGN and taking a few more minutes to properly design properties. Do the smart thing- do the right thing. You can be heroes or a diminished decision maker susceptible to untoward pressure.

Heidi Siegelbaum

From: David Moehring <dmoehring@consultant.com>

Sent: Friday, September 11, 2020 9:56 PM

To: Lewis, Andrew <Andrew.Lewis@seattle.gov>; Durkan, Jenny <Jenny.Durkan@seattle.gov>; Mosqueda, Teresa <Teresa.Mosqueda@seattle.gov>; Gonzalez, Lorena <Lorena.Gonzalez@seattle.gov>; Pedersen, Alex <Alex.Pedersen@seattle.gov>; Juarez, Debora <Debora.Juarez@seattle.gov>; Strauss, Dan <Dan.Strauss@seattle.gov>

Cc: Sawant, Kshama <Kshama.Sawant@seattle.gov>; Morales, Tammy <Tammy.Morales@seattle.gov>; Herbold, Lisa <Lisa.Herbold@seattle.gov>; Torgelson, Nathan <Nathan.Torgelson@seattle.gov>; Podowski, Mike <Mike.Podowski@seattle.gov>; Emery, Chanda <Chanda.Emery@Seattle.gov>; Pinto de Bader, Sandra <Sandra.Pinto_de_Bader@Seattle.gov>; Manson, Joseph <Joseph.Manson@audubon.org>; Woody Wheeler <woody.wheeler@gmail.com>; Maria Batayola <mbjumpstart@msn.com>; Lia H <liayaranon@gmail.com>; Deb Heiden <nature-grl@live.com>;

Silvernail, Devin <Devin.Silvernail@seattle.gov>; June BlueSpruce <jbluespruce@gmail.com>; LEG_CouncilMembers <council@seattle.gov>; Magnolia Community Council <magnoliacomunityclub@gmail.com>; An, Noah <Noah.An@seattle.gov>; Dawson, Parker <Parker.Dawson@seattle.gov>; Thaler, Toby <Toby.Thaler@seattle.gov>; DOT_SeattleTrees <Seattle.Trees@seattle.gov>; McGarry, Deborah <Deborah.McGarry@seattle.gov>; Pederson, Art <Art.Pederson@seattle.gov>; cjschell@uw.edu; lambert.mrm@gmail.com; cleowe@uw.edu

Subject: recapitulation of 'Please protect Seattle's urban forest!'

Importance: High

CAUTION: External Email

Thank you, June BlueSpruce!

Many of us may have missed hearing from our Mayor and City Council representatives that a *lack of tree canopy (*) is a social injustice matter for too many within the Emerald City of Seattle.*



The recent [UW article](#) (attached pdf) recapitulates the [video](#) that June notes below presented last week by six panelists for the Seward Park Audubon Society. From the article:

"The paper cites other studies that have found *racism* and other **inequalities** are *reducing biodiversity*, increasing *urban heat island effects* and **augmenting impacts of climate crises** across the United States.

"For example, several studies the authors included found fewer trees in *low-income and racially minoritized neighborhoods* in major cities across the U.S. Less tree cover means hotter temperatures and fewer plant and animal species. Additionally, these areas tend to be closer to industrial waste or dumping sites than wealthier, predominantly white areas — a reality that was put in place intentionally through policies like redlining, the authors explain.

"Fewer trees, over decades, has led to pockets of neighborhoods that are hotter, more polluted, and have more disease-carrying pests such as rodents and mosquitoes that can survive in harsh environments. These **ecological differences inevitably affect human health and well-being**, the authors said." August 13, 2020, '*Systemic racism has consequences for all life in cities*', by [Michelle Ma](#)



Our leadership's future discussions about **growth in Seattle** should not only focus on more housing, but also retaining and allow space for planting more large trees! **Increasing tree canopy** in Seattle's disadvantaged neighborhoods **AND more housing** must be embodied within our city's ordinances and Comprehensive Growth Plan. Despite all of the past resolutions and Executive Orders, it's still just a flinting idea in Seattle.

 **NEXT UP:** Journalist M. Baskin interviews UW's K. Wolf for what needs to be done.



Image: More proof in urban planning with a equitable balance of tree canopy and density that works for all, including public and private housing:

"Recent Boston study tests healthy living strategies in public housing" ([July 2018 article](#))

For our trees  that do so much for us,

David Moehring AIA NCARB
[TreePAC](#) Board Member
Magnolia TreeKeepers
[Don't Clearcut Seattle](#)

NOTE to Seattle's trend for 'Green-Washing':

(*) " Tree canopy " must be considered in terms of medium and large trees that are naturally able to shade ground and building surfaces, sequester carbon and storm water, and filter air particles. Seattle's other mimicry 'Green Factor' elements such as considering ground-cover, mulch, permeable

pavers, and low bushes are not replacements to the benefits of trees that actually provide healthy environments.

Green New Deal fails to even mention the word "Tree"???

Another example of "Green-washing" is the "Green New Deal", [Seattle's resolution](#) totally ignores trees within its 18 pages and fails to acknowledge the evidence of the significance of our tree canopy. Two-thirds of [Seattle's Tree canopy](#) is within privately owned land, and Seattle's 250,000 street right-of-way trees are not enough to sustain our environment.



Sent: Monday, September 07, 2020 at 1:58 PM

From: "June BlueSpruce" <jbluespruce@gmail.com>

To: council@seattle.gov, kshama.sawant@seattle.gov, debora.juarez@seattle.gov, lorena.gonzalez@seattle.gov, teresa.mosqueda@seattle.gov, "Councilmember Tammy J. Morales" <tammy.morales@seattle.gov>, "Alex.Pedersen@seattle.gov" <alex.pedersen@seattle.gov>, "Councilmember Andrew J. Lewis" <andrew.lewis@seattle.gov>, "Lisa.Herbold@seattle.gov" <lisa.herbold@seattle.gov>, "dan.strauss@seattle.gov" <dan.strauss@seattle.gov>, jenny.durkan@seattle.gov, nathan.torgelson@seattle.gov, mike.podowski@seattle.gov, Chanda.emery@seattle.gov

Cc: "Pinto de Bader, Sandra" <Sandra.Pinto_de_Bader@seattle.gov>, "Manson, Joseph" <Joseph.Manson@audubon.org>, "Woody Wheeler" <woody.wheeler@gmail.com>, "David Moehring" <dmoehring@consultant.com>, "Maria Batayola" <mbjumpstart@msn.com>, "Lia H" <liayaronon@gmail.com>, "Deb Heiden" <nature-grl@live.com>, "Silvernail, Devin" <devin.silvernail@seattle.gov>

Subject: Please protect Seattle's urban forest NOW

Dear Mayor Durkan, members of the Seattle City Council, and leaders and staff of Seattle Department of Construction and Inspections:

Last Thursday night, the Seward Park Audubon Center presented a panel on Seattle's tree canopy - its current status; the serious threats it faces; the impacts of environmental racism on health, the economy, and community displacement; and what citizens of Seattle can do to protect trees. I encourage you and your staff to watch the video [here](#). You will recognize several of us from City Council and committee hearings. On the panel, we were able to tell the story of Seattle's trees much more completely than we can in 1-2 minute testimony at meetings.

I urge you to act now to protect Seattle's urban forest. As you know, the tree protection ordinance we have in place was passed as an interim measure 11 years ago. It was inadequate then; it's more so now. Last fall, you passed a resolution committing to a process to develop, study the implementation of, and get public feedback on an updated ordinance based on a draft written a year ago by the Urban Forestry Commission. Unfortunately, the COVID pandemic has slowed this process down, and I am advised that it's unlikely that a stronger ordinance will be passed this year. Meanwhile, the loss of trees to development continues at a frantic pace.

I urge you to:

- Place an immediate, temporary moratorium on removal of any tree that is 24" or greater DBH, any other tree that is designated as exceptional at a smaller size, and any tree grove. to remain in force until stronger tree protection is fully in place.
- Ensure that the SDCI's proposed Director's Rule 13-2020 is edited according to feedback given during the comment period and implemented as soon as possible.

- During the current budget season, ensure that adequate funding is allocated to enforce stronger tree protection regulations (in the new Director's Rule and in any anticipated strengthened tree ordinance) for 2021, including more arborists for SDCI. I know that Seattle faces a budget shortfall from the COVID epidemic. But allowing trees to be cut through non-enforcement of protection regulations is incredibly short-sighted. It will cost far more to replace trees and deal with the negative environmental consequences of their loss than to protect them in the first place.
- Ensure that the process to develop, get community input on, and pass a stronger tree protection ordinance is accelerated. The trees can't wait.

Thank you.

Sincerely yours,

June BlueSpruce
5008 44th Ave. S. (District 2)
Seattle, WA 98118
206-579-1203

Right now growth is a single item of focus. Here is a link to the 2.5-minute **Exceptional Queen Anne Tulip Tree** video on YouTube: <https://youtu.be/nyHzfHVYtDE>
