

DATE	REVISIONS
	MADE CHECKS, REV'D

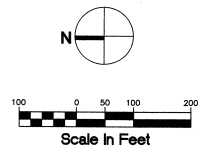

PLEASE CALL
 3 Working Days
 BEFORE YOU DIG
 1-800-424-5555

LEGEND

- DEEP VEGETATED RETENTION SWALE
- SHALLOW GRASSLINED RETENTION SWALE
- GRASSLINED CONVEYANCE SWALE
- POROUS CEMENT CONCRETE ROAD PAVEMENT
- POROUS CEMENT CONCRETE SIDEWALK PAVEMENT
- SW JUNEAU STREET SWALE
- 32ND AVE SW SWALE
- NATURAL DRAINAGE SYSTEM SEGMENT # FROM SHEET 23a OF PLAN

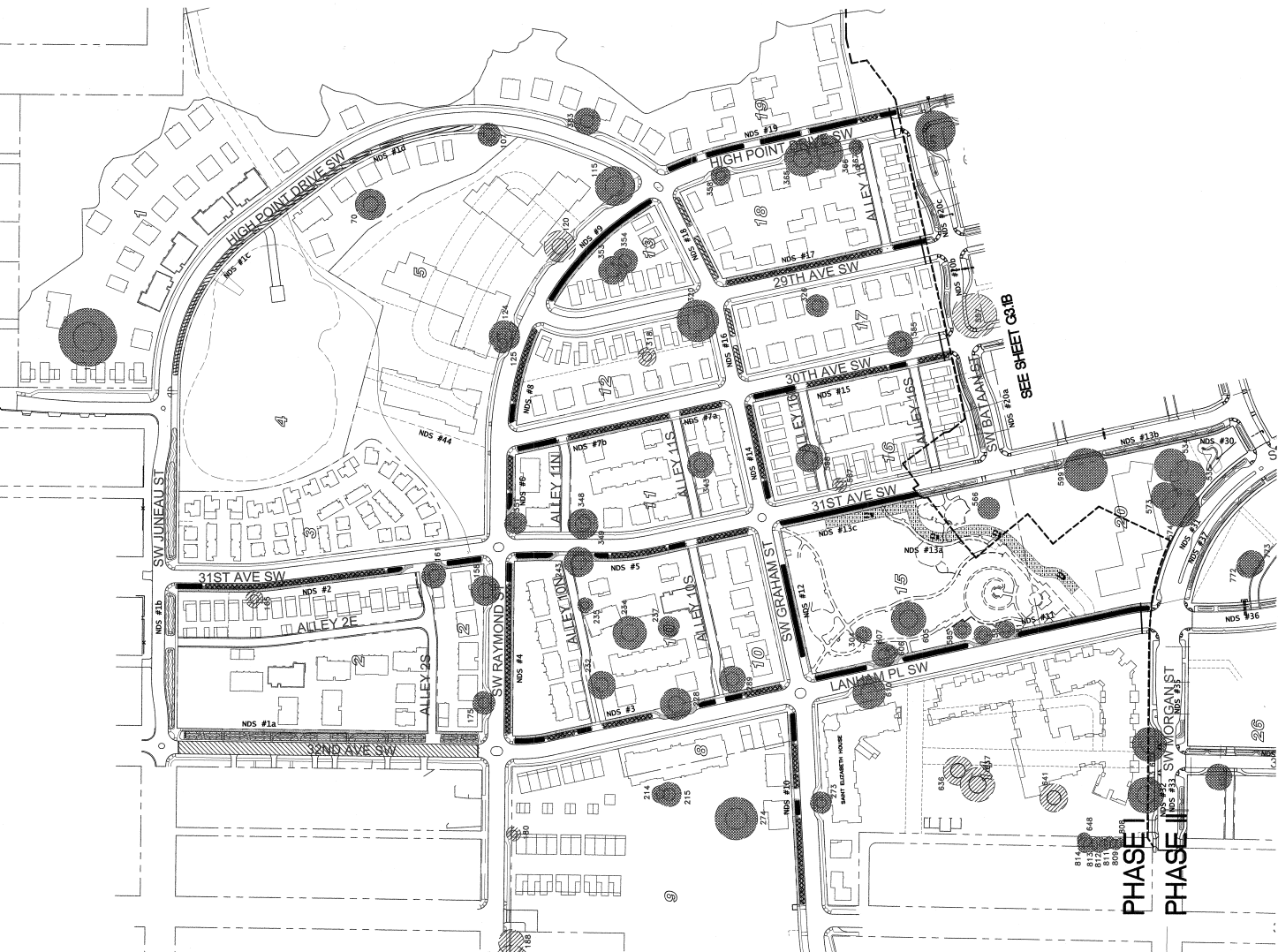

MITHUN
 Architectural Designers/Planners

DESIGN COMPANY
Seattle Housing Authority



VERTICAL DATUM FOR HIGH POINT PROJECT IS COS DATUM. SEE SHEET G1.4

REVIEWED BY SPU/WATER ENGINEERING CHECKED 1/6/06 REVIEWED BY SPU/DRAINAGE CHECKED 1/6/06 APPROVED BY SDOT STREET IMPROVEMENT PERMITTING CHECKED 4/3/06	NAME OR INITIALS AND DATE DESIGNED JGS CHECKED TGS DRAWN JZ JR CHECKED FEBRUARY 17, 2006 DESIGN REVIEW	INITIALS AND DATE REVIEWED 3-30-06 PLAN REVIEW ANALYST PLAN REVIEW SEC. MGR RECEIVED REVISED AS-BUILT CHECKED 3/16/06
-----------------------------------------------------------------------------------------------------------------------------------------------------------------------	-----------------------------------------------------------------------------------------------------------------------	-----------------------------------------------------------------------------------------------------------------------------------------



City of Seattle
Seattle Department of Transportation

3000 SW GRAHAM ST. PH 1 DPD PERMIT NO. 737141, PH 2 DPD PROJECT NO. 6076853
 HIGH POINT REVITALIZATION

**HIGH POINT DRIVE SW et al
 WM, PSS, PSD, C/W, CONC. CURB, PAVING, ETC.
 NDS System Map for Phase I**

SDOT PROJECT NOS.
 T03-1748 & T05-2615
 VAULT PLAN NO.
 7777-5585
 SHEET G31A OF