

23rd Ave/24th Ave Phase 3

SHEET INDEX

SHT NO.	SHEET DESCRIPTION	WORK ORDER #
1	VICINITY MAP, SIGN DETAIL, SHEET INDEX	FOR REFERENCE ONLY
2-10	SIGNS AND MARKINGS	650475
2-10	TEMPORARY SIGNS	650477

VICINITY MAP

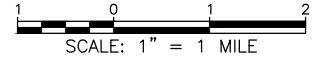

THE EXISTING FEATURES SHOWN IN THIS DRAWING SET DO NOT REPRESENT SURVEYED, COMPREHENSIVELY RESEARCHED, OR INDEPENDENTLY VERIFIED INFORMATION. THE CITY OF SEATTLE DISCLAIMS ANY WARRANTY OF ANY KIND, INCLUDING WARRANTY OF MERCHANTABILITY OR WARRANTY FOR FITNESS OF USE FOR A PARTICULAR PURPOSE, EXPRESSED OR IMPLIED.

**SIGNS AND MARKINGS
VICINITY MAP**

APPROVED FOR ADVERTISING
NANCY LOCKE
DEPARTMENT OF FINANCE & ADMINISTRATIVE SERVICES
SEATTLE, WASHINGTON 20

BY: _____
PURCHASING & CONTRACTING SERVICES DIRECTOR

INITIALS AND DATE		INITIALS AND DATE	
DESIGNED ARV 10/20/2017	REVIEWED:	DES.	CONST.
CHECKED	SDOT	PROJ. MGR.	
DRAWN	RECEIVED		
CHECKED	REVISED AS BUILT		

ALL WORK SHALL BE DONE IN ACCORDANCE WITH THE CITY OF SEATTLE STANDARD PLANS AND SPECIFICATIONS AND OTHER DOCUMENTS CALLED FOR IN SECTION 0-02.3 OF THE PROJECT MANUAL.

City of Seattle
**Seattle Department
of Transportation**

ORDINANCE NO. APPROVED
FUND:
SCALE: INSPECTOR'S BOOK

**23RD AVE/24TH AVE
PHASE 3**

ACTIVITY NO. TRC0417-S0100
Vault Plan No.
SHEET 1 OF 11

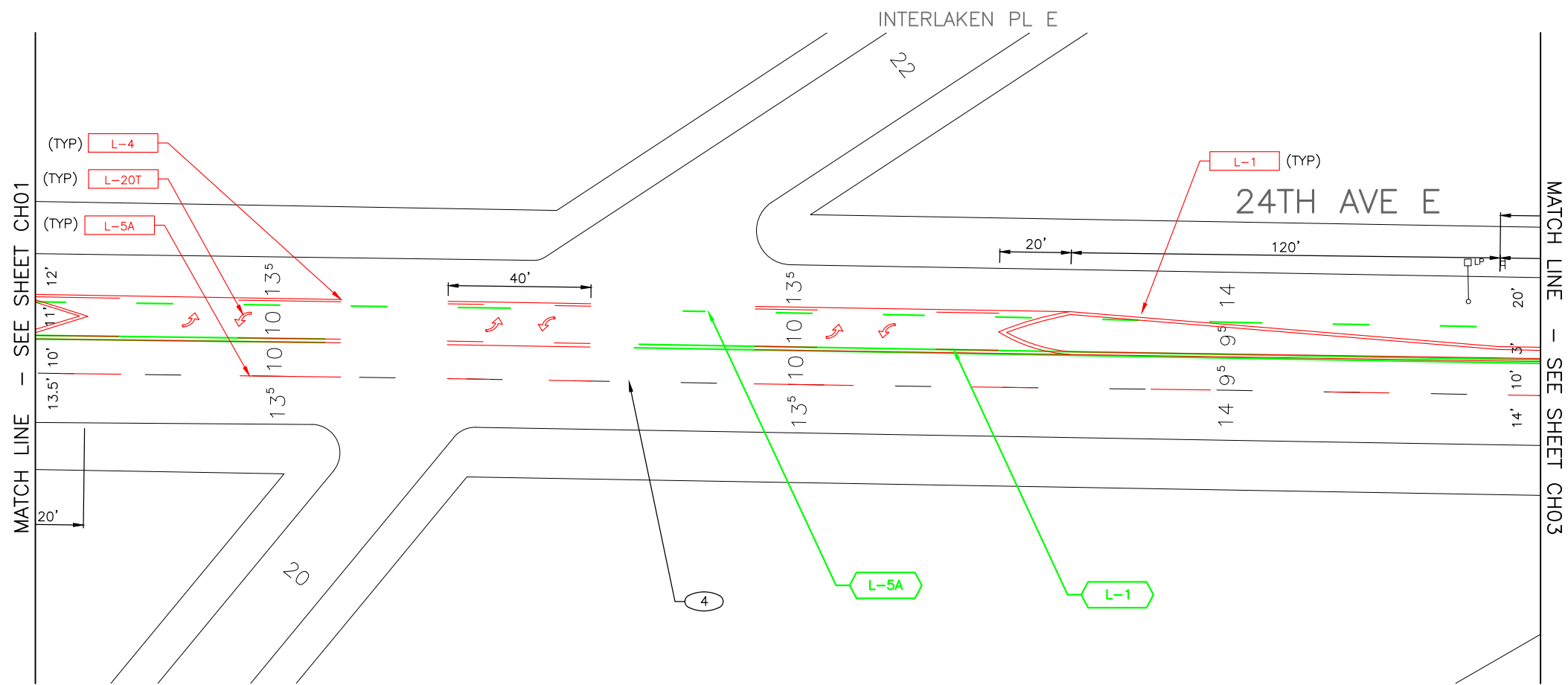
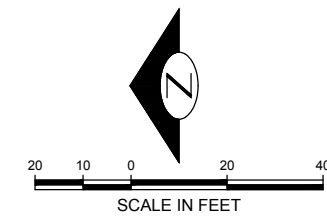

CHANNELIZATION LEGEND

- L-1 DOUBLE YELLOW CENTER LINE
- L-2A 8" SOLID YELLOW LINE (BARRIER AREA)
- L-4 YELLOW TWO WAY LEFT TURN LINE
- L-5A DASHED 4" WHITE LANE LINE
- L-8T THERMOPLASTIC WHITE 8" CROSSWALK
- L-8AT THERMOPLASTIC WHITE 16" STOP LINE
- L-8BT THERMOPLASTIC WHITE 24" STOP LINE
- L-20T THERMOPLASTIC LEFT ARROW
- L-22T THERMOPLASTIC THROUGH ARROW

SIGNING LEGEND

- TS-10 10' SIGN POST
- W4-2L LEFT LANE MERGE SYMBOL
- W9-1L LEFT LANE ENDS

CONSTRUCTION LEGEND:

- INSTALL
- REMOVE
- RELOCATE/REMAIN
- ⊕ EXISTING SIGN
- ⊓ NEW SIGN

CONSTRUCTION NOTES:

- ① MATCH TO EXISTING CENTERLINE AT THIS POINT
- ② MAINTAIN EXISTING ALIGNMENT THROUGH CURVE
- ③ MAINTAIN AND REPAINT EXISTING C-CURB
- ④ REINSTALL LANE LINE

NOTES:

- 1. LANE MARKERS SHALL BE INSTALLED WITH ALL PAINT LINES PER STD 710
- 2. MAINTAIN CENTER TURN LANE THOUGH INTERSECTIONS ONLY AS SHOWN IN PLANS

CH 02

APPROVED FOR ADVERTISING
 NANCY LOCKE
 DEPARTMENT OF FINANCE & ADMINISTRATIVE SERVICES
 SEATTLE, WASHINGTON 20
 BY:
 PURCHASING & CONTRACTING SERVICES DIRECTOR

INITIALS AND DATE		INITIALS AND DATE	
DESIGNED . ARV . 10/20/2017	CHECKED	REVIEWED:	CONST.
DRAWN	CHECKED	SDOT	PROJ. MGR.
ALL WORK SHALL BE DONE IN ACCORDANCE WITH THE CITY OF SEATTLE STANDARD PLANS AND SPECIFICATIONS AND OTHER DOCUMENTS CALLED FOR IN SECTION D-02.3 OF THE PROJECT MANUAL.		RECEIVED	
		REVISED AS BUILT	

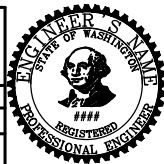

City of Seattle
Seattle Department of Transportation
 ORDINANCE NO. APPROVED
 FUND:
 SCALE: INSPECTOR'S BOOK

**23RD AVE/24TH AVE
 PHASE 3**

ACTIVITY NO.
 TRC0417-S0100
 VAULT PLAN NO.
 SHEET 3 OF 11

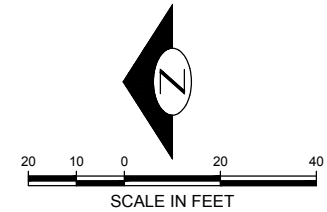
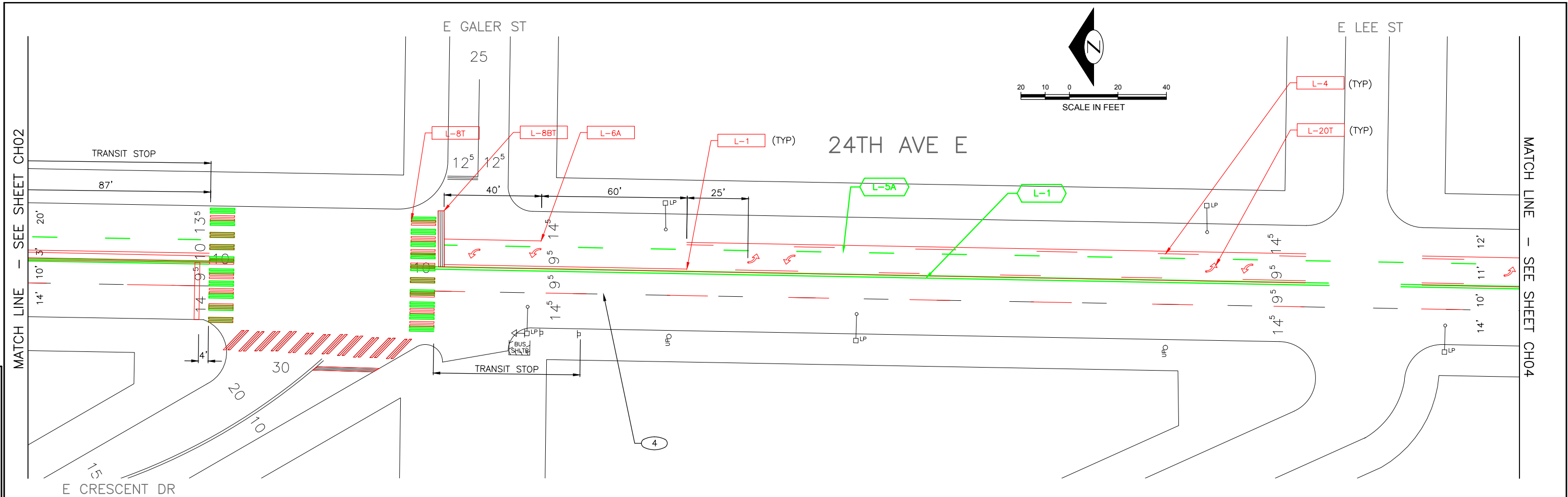

CHANNELIZATION LEGEND

- L-1 DOUBLE YELLOW CENTER LINE
- L-2A 8" SOLID YELLOW LINE (BARRIER AREA)
- L-4 YELLOW TWO WAY LEFT TURN LINE
- L-5A DASHED 4" WHITE LANE LINE
- L-8T THERMOPLASTIC WHITE 8" CROSSWALK
- L-8AT THERMOPLASTIC WHITE 16" STOP LINE
- L-8BT THERMOPLASTIC WHITE 24" STOP LINE
- L-20T THERMOPLASTIC LEFT ARROW
- L-22T THERMOPLASTIC THROUGH ARROW

SIGNING LEGEND

- TS-10 10' SIGN POST
- W4-2L LEFT LANE MERGE SYMBOL
- W9-1L LEFT LANE ENDS

CONSTRUCTION LEGEND:

- INSTALL
- REMOVE
- RELOCATE/REMAIN
- EXISTING SIGN
- NEW SIGN

CONSTRUCTION NOTES:

- ① MATCH TO EXISTING CENTERLINE AT THIS POINT
- ② MAINTAIN EXISTING ALIGNMENT THROUGH CURVE
- ③ MAINTAIN AND REPAINT EXISTING C-CURB
- ④ REINSTALL LANE LINE

NOTES:

- 1. LANE MARKERS SHALL BE INSTALLED WITH ALL PAINT LINES PER STD 710
- 2. MAINTAIN CENTER TURN LANE THOUGH INTERSECTIONS ONLY AS SHOWN IN PLANS

<p>APPROVED FOR ADVERTISING NANCY LOCKE DEPARTMENT OF FINANCE & ADMINISTRATIVE SERVICES SEATTLE, WASHINGTON 20</p> <p>BY: _____ PURCHASING & CONTRACTING SERVICES DIRECTOR</p>	<table border="1" style="width: 100%; border-collapse: collapse;"> <tr> <th colspan="2">INITIALS AND DATE</th> </tr> <tr> <td>DESIGNED . ARV . 10/20/2017</td> <td>REVIEWED:</td> </tr> <tr> <td>CHECKED</td> <td>DES. CONST.</td> </tr> <tr> <td>DRAWN</td> <td>SDOT PROJ. MGR.</td> </tr> <tr> <td>CHECKED</td> <td>RECEIVED</td> </tr> <tr> <td></td> <td>REVISED AS BUILT</td> </tr> </table>	INITIALS AND DATE		DESIGNED . ARV . 10/20/2017	REVIEWED:	CHECKED	DES. CONST.	DRAWN	SDOT PROJ. MGR.	CHECKED	RECEIVED		REVISED AS BUILT	<p>City of Seattle Seattle Department of Transportation</p> <p>ORDINANCE NO. APPROVED</p> <p>FUND:</p> <p>SCALE: INSPECTOR'S BOOK</p>	<p>CH 03</p> <p>23RD AVE/24TH AVE PHASE 3</p>	<p>ACTIVITY NO. TRC0417-S0100</p> <p>VAULT PLAN NO.</p> <p>SHEET 4 OF 11</p>
INITIALS AND DATE																
DESIGNED . ARV . 10/20/2017	REVIEWED:															
CHECKED	DES. CONST.															
DRAWN	SDOT PROJ. MGR.															
CHECKED	RECEIVED															
	REVISED AS BUILT															

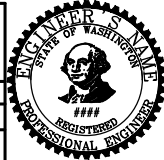

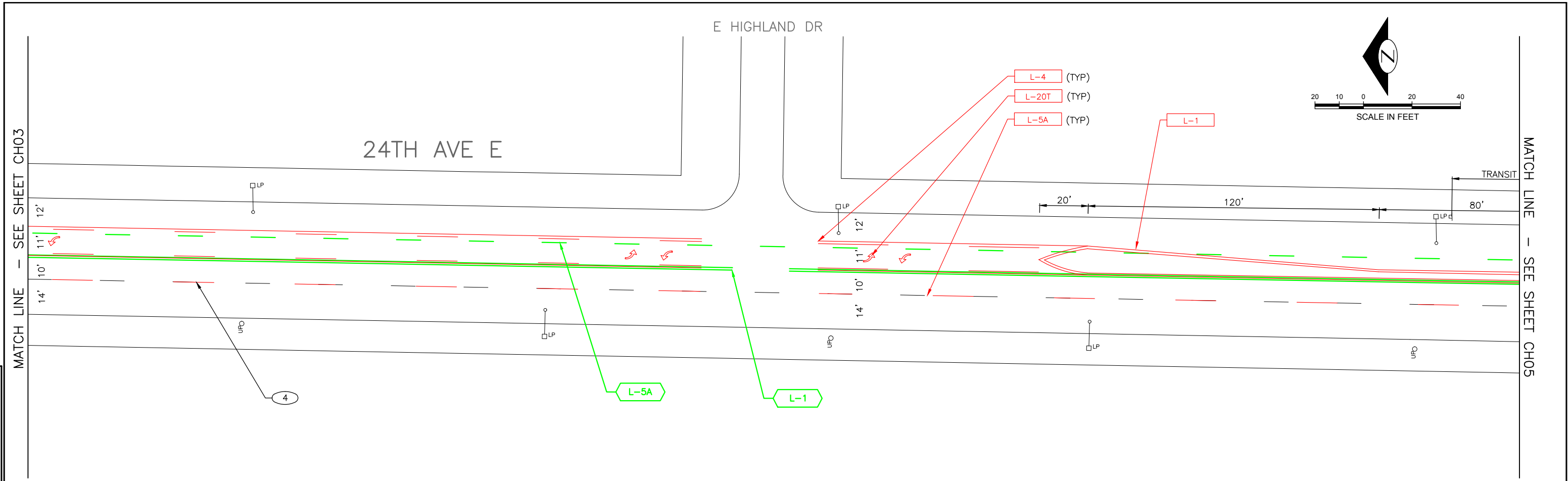

CHANNELIZATION LEGEND

- L-1 DOUBLE YELLOW CENTER LINE
- L-2A 8" SOLID YELLOW LINE (BARRIER AREA)
- L-4 YELLOW TWO WAY LEFT TURN LINE
- L-5A DASHED 4" WHITE LANE LINE
- L-8T THERMOPLASTIC WHITE 8" CROSSWALK
- L-8AT THERMOPLASTIC WHITE 16" STOP LINE
- L-8BT THERMOPLASTIC WHITE 24" STOP LINE
- L-20T THERMOPLASTIC LEFT ARROW
- L-22T THERMOPLASTIC THROUGH ARROW

SIGNING LEGEND

- TS-10 10' SIGN POST
- W4-2L LEFT LANE MERGE SYMBOL
- W9-1L LEFT LANE ENDS

CONSTRUCTION LEGEND:

- INSTALL
- REMOVE
- RELOCATE/REMAIN
- EXISTING SIGN
- NEW SIGN

CONSTRUCTION NOTES:

- ① MATCH TO EXISTING CENTERLINE AT THIS POINT
- ② MAINTAIN EXISTING ALIGNMENT THROUGH CURVE
- ③ MAINTAIN AND REPAINT EXISTING C-CURB
- ④ REINSTALL LANE LINE

NOTES:

- 1. LANE MARKERS SHALL BE INSTALLED WITH ALL PAINT LINES PER STD 710
- 2. MAINTAIN CENTER TURN LANE THOUGH INTERSECTIONS ONLY AS SHOWN IN PLANS

<p>APPROVED FOR ADVERTISING NANCY LOCKE DEPARTMENT OF FINANCE & ADMINISTRATIVE SERVICES SEATTLE, WASHINGTON 20</p> <p>BY: PURCHASING & CONTRACTING SERVICES DIRECTOR</p>	<table border="1" style="width: 100%; border-collapse: collapse;"> <tr> <th colspan="2">INITIALS AND DATE</th> <th colspan="2">INITIALS AND DATE</th> </tr> <tr> <td>DESIGNED . ARV . 10/20/2017</td> <td>CHECKED</td> <td>REVIEWED: DES.</td> <td>CONST.</td> </tr> <tr> <td>DRAWN</td> <td>CHECKED</td> <td>SDOT</td> <td>PROJ. MGR.</td> </tr> <tr> <td colspan="2">REVISAS</td> <td colspan="2">REVISAS</td> </tr> </table>	INITIALS AND DATE		INITIALS AND DATE		DESIGNED . ARV . 10/20/2017	CHECKED	REVIEWED: DES.	CONST.	DRAWN	CHECKED	SDOT	PROJ. MGR.	REVISAS		REVISAS		<p style="text-align: center;">City of Seattle Seattle Department of Transportation</p> <p>ORDINANCE NO. APPROVED</p> <p>FUND:</p> <p>SCALE: INSPECTOR'S BOOK</p>	<p>CH 04</p> <p>23RD AVE/24TH AVE PHASE 3</p>	<p>ACTIVITY NO. TRC0417-S0100</p> <p>VAULT PLAN NO.</p> <p>SHEET 5 OF 11</p>
INITIALS AND DATE		INITIALS AND DATE																		
DESIGNED . ARV . 10/20/2017	CHECKED	REVIEWED: DES.	CONST.																	
DRAWN	CHECKED	SDOT	PROJ. MGR.																	
REVISAS		REVISAS																		

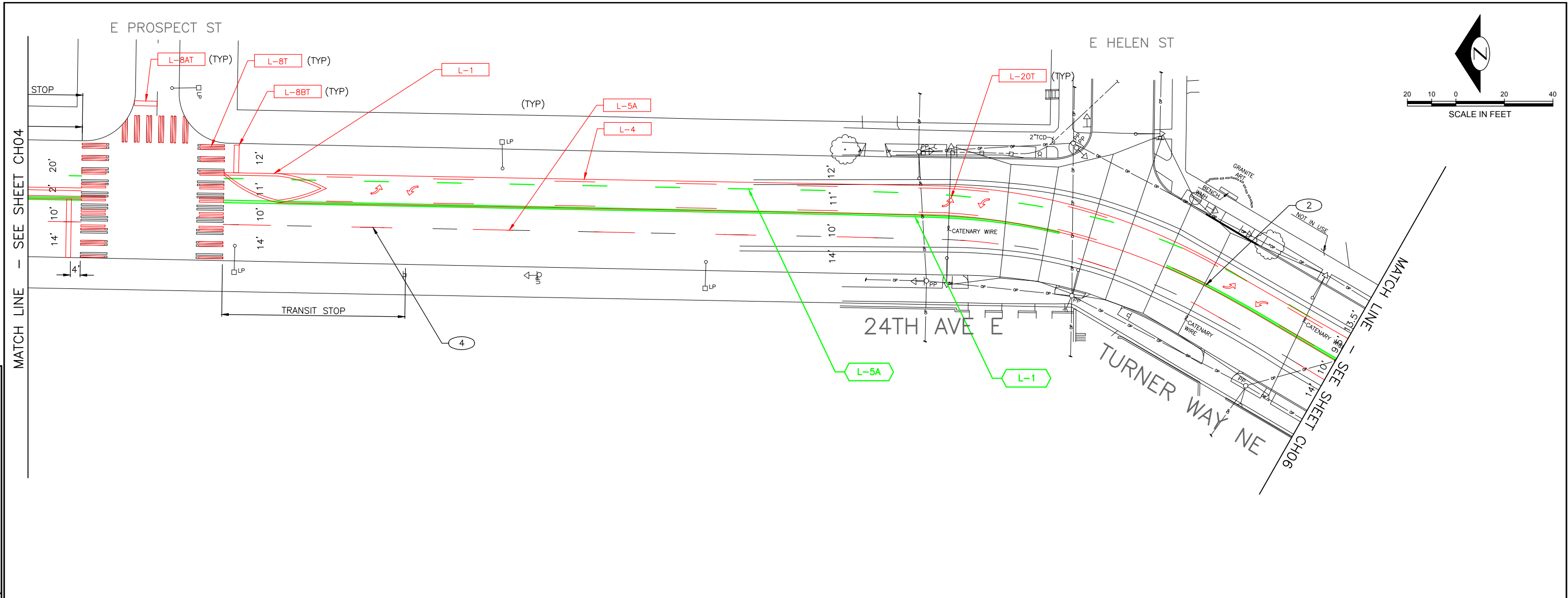

CHANNELIZATION LEGEND

- L-1 DOUBLE YELLOW CENTER LINE
- L-2A 8" SOLID YELLOW LINE (BARRIER AREA)
- L-4 YELLOW TWO WAY LEFT TURN LINE
- L-5A DASHED 4" WHITE LANE LINE
- L-8T THERMOPLASTIC WHITE 8" CROSSWALK
- L-8AT THERMOPLASTIC WHITE 16" STOP LINE
- L-8BT THERMOPLASTIC WHITE 24" STOP LINE
- L-20T THERMOPLASTIC LEFT ARROW
- L-22T THERMOPLASTIC THROUGH ARROW

SIGNING LEGEND

- TS-10 10' SIGN POST
- W4-2L LEFT LANE MERGE SYMBOL
- W9-1L LEFT LANE ENDS

CONSTRUCTION LEGEND:

- INSTALL
- REMOVE
- RELOCATE/REMAIN
- EXISTING SIGN
- NEW SIGN

CONSTRUCTION NOTES:

- ① MATCH TO EXISTING CENTERLINE AT THIS POINT
- ② MAINTAIN EXISTING ALIGNMENT THROUGH CURVE
- ③ MAINTAIN AND REPAINT EXISTING C-CURB
- ④ REINSTALL LANE LINE

NOTES:

- 1. LANE MARKERS SHALL BE INSTALLED WITH ALL PAINT LINES PER STD 710
- 2. MAINTAIN CENTER TURN LANE THROUGH INTERSECTIONS ONLY AS SHOWN IN PLANS

APPROVED FOR ADVERTISING
NANCY LOCKE
 DEPARTMENT OF FINANCE & ADMINISTRATIVE SERVICES
 SEATTLE, WASHINGTON 20
 BY: _____
 PURCHASING & CONTRACTING SERVICES DIRECTOR

INITIALS AND DATE
 DESIGNED . ARV . 10/20/2017
 CHECKED
 DRAWN
 CHECKED
 REVISIONS AS BUILT

INITIALS AND DATE
 REVIEWED:
 DES. CONST.
 SDOT PROJ. MGR.
 RECEIVED
 REVISED AS BUILT
 ALL WORK SHALL BE DONE IN ACCORDANCE WITH THE CITY OF SEATTLE STANDARD PLANS AND SPECIFICATIONS AND OTHER DOCUMENTS CALLED FOR IN SECTION D-02.3 OF THE PROJECT MANUAL.

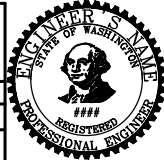

City of Seattle
Seattle Department of Transportation
 ORDINANCE NO. APPROVED
 FUND:
 SCALE: INSPECTOR'S BOOK

CH 05
23RD AVE/24TH AVE
PHASE 3

ACTIVITY NO.
 TRC0417-S0100
 VAULT PLAN NO.
 SHEET 6 OF 11

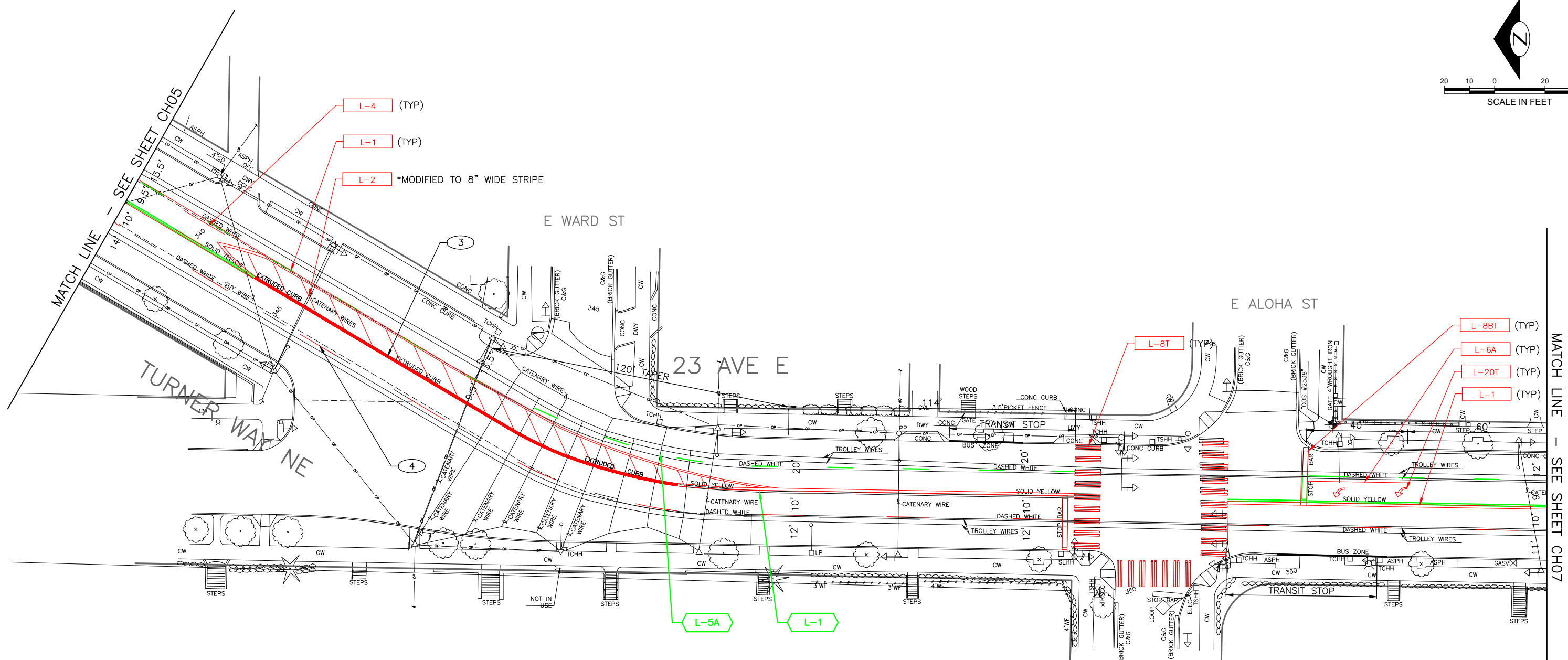
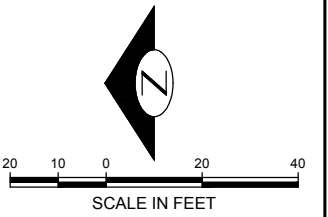

CHANNELIZATION LEGEND

- L-1 DOUBLE YELLOW CENTER LINE
- L-2A 8" SOLID YELLOW LINE (BARRIER AREA)
- L-4 YELLOW TWO WAY LEFT TURN LINE
- L-5A DASHED 4" WHITE LANE LINE
- L-8T THERMOPLASTIC WHITE 8" CROSSWALK
- L-8AT THERMOPLASTIC WHITE 16" STOP LINE
- L-8BT THERMOPLASTIC WHITE 24" STOP LINE
- L-20T THERMOPLASTIC LEFT ARROW
- L-22T THERMOPLASTIC THROUGH ARROW

SIGNING LEGEND

- TS-10 10' SIGN POST
- W4-2L LEFT LANE MERGE SYMBOL
- W9-1L LEFT LANE ENDS

CONSTRUCTION LEGEND:

- INSTALL
- REMOVE
- RELOCATE/REMAIN
- EXISTING SIGN
- NEW SIGN

CONSTRUCTION NOTES:

- ① MATCH TO EXISTING CENTERLINE AT THIS POINT
- ② MAINTAIN EXISTING ALIGNMENT THROUGH CURVE
- ③ MAINTAIN AND REPAINT EXISTING C-CURB
- ④ REINSTALL LANE LINE

NOTES:

- 1. LANE MARKERS SHALL BE INSTALLED WITH ALL PAINT LINES PER STD 710
- 2. MAINTAIN CENTER TURN LANE THROUGH INTERSECTIONS ONLY AS SHOWN IN PLANS

APPROVED FOR ADVERTISING
NANCY LOCKE
 DEPARTMENT OF FINANCE & ADMINISTRATIVE SERVICES
 SEATTLE, WASHINGTON 20

BY: _____
 PURCHASING & CONTRACTING SERVICES DIRECTOR

INITIALS AND DATE DESIGNED . ARV . 10/20/2017 CHECKED DRAWN CHECKED	INITIALS AND DATE REVIEWED: CONST. DES. PROJ. MGR. RECEIVED REVISED AS BUILT
ALL WORK SHALL BE DONE IN ACCORDANCE WITH THE CITY OF SEATTLE STANDARD PLANS AND SPECIFICATIONS AND OTHER DOCUMENTS CALLED FOR IN SECTION D-02.3 OF THE PROJECT MANUAL.	

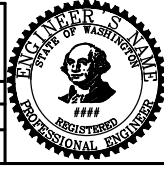

City of Seattle
Seattle Department of Transportation

ORDINANCE NO. APPROVED
 FUND:
 SCALE: INSPECTOR'S BOOK

CH 06

**23RD AVE/24TH AVE
 PHASE 3**

ACTIVITY NO.
 TRC0417-S0100

VAULT PLAN NO.

SHEET 7 OF 11

SEE SHEET CH06

MATCH LINE - SEE SHEET CH08

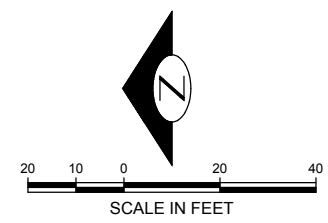
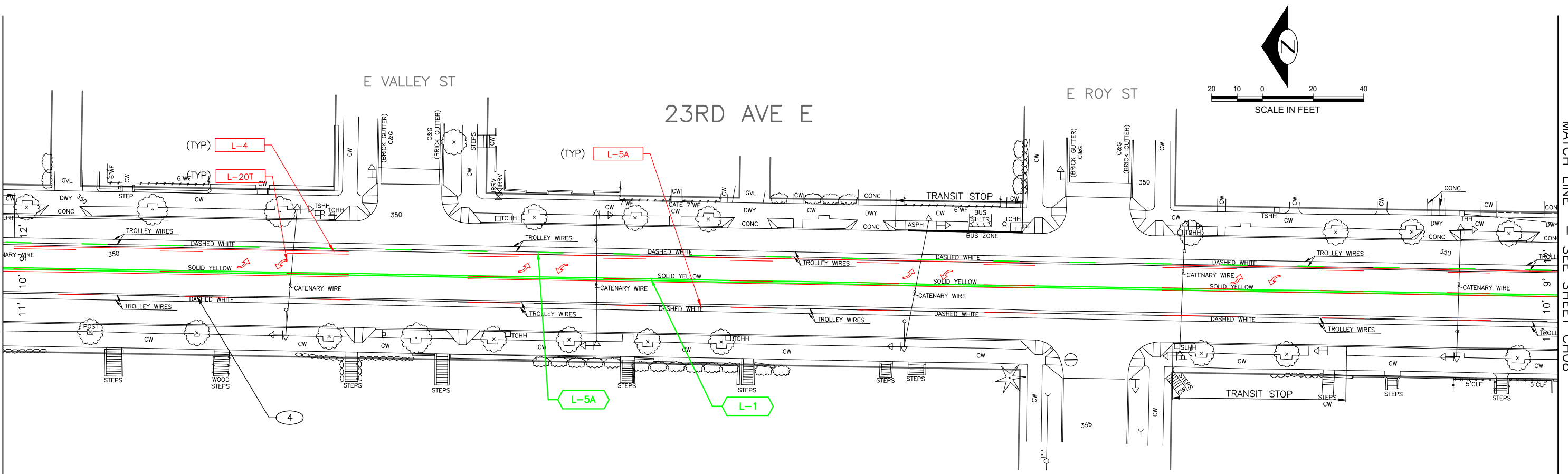

CHANNELIZATION LEGEND

L-1	DOUBLE YELLOW CENTER LINE
L-2A	8" SOLID YELLOW LINE (BARRIER AREA)
L-4	YELLOW TWO WAY LEFT TURN LINE
L-5A	DASHED 4" WHITE LANE LINE
L-8T	THERMOPLASTIC WHITE 8" CROSSWALK
L-8AT	THERMOPLASTIC WHITE 16" STOP LINE
L-8BT	THERMOPLASTIC WHITE 24" STOP LINE
L-20T	THERMOPLASTIC LEFT ARROW
L-22T	THERMOPLASTIC THROUGH ARROW

SIGNING LEGEND

TS-10	10' SIGN POST
W4-2L	LEFT LANE MERGE SYMBOL
W9-1L	LEFT LANE ENDS

CONSTRUCTION LEGEND:

	INSTALL
	REMOVE
	RELOCATE/REMAIN
	EXISTING SIGN
	NEW SIGN

CONSTRUCTION NOTES:

①	MATCH TO EXISTING CENTERLINE AT THIS POINT
②	MAINTAIN EXISTING ALIGNMENT THROUGH CURVE
③	MAINTAIN AND REPAINT EXISTING C-CURB
④	REINSTALL LANE LINE

- NOTES:**
- LANE MARKERS SHALL BE INSTALLED WITH ALL PAINT LINES PER STD 710
 - MAINTAIN CENTER TURN LANE THROUGH INTERSECTIONS ONLY AS SHOWN IN PLANS

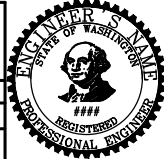
<p>APPROVED FOR ADVERTISING NANCY LOCKE DEPARTMENT OF FINANCE & ADMINISTRATIVE SERVICES SEATTLE, WASHINGTON 20</p> <p>BY: _____ PURCHASING & CONTRACTING SERVICES DIRECTOR</p>	<p>INITIALS AND DATE</p> <p>DESIGNED . ARV . 10/20/2017</p> <p>CHECKED</p> <p>DRAWN</p> <p>CHECKED</p>	<p>INITIALS AND DATE</p> <p>REVIEWED: CONST.</p> <p>DES. SDOT PROJ. MGR.</p> <p>RECEIVED</p> <p>REVISED AS BUILT</p>	<p></p> <p>City of Seattle Seattle Department of Transportation</p> <p>ORDINANCE NO. APPROVED</p> <p>FUND:</p> <p>SCALE: INSPECTOR'S BOOK</p>	<p>CH 07</p> <p>23RD AVE/24TH AVE</p> <p>PHASE 3</p>	<p>ACTIVITY NO. TRC0417-S0100</p> <p>VAULT PLAN NO.</p> <p>SHEET 8 OF 11</p>
--	--	--	---	---	--

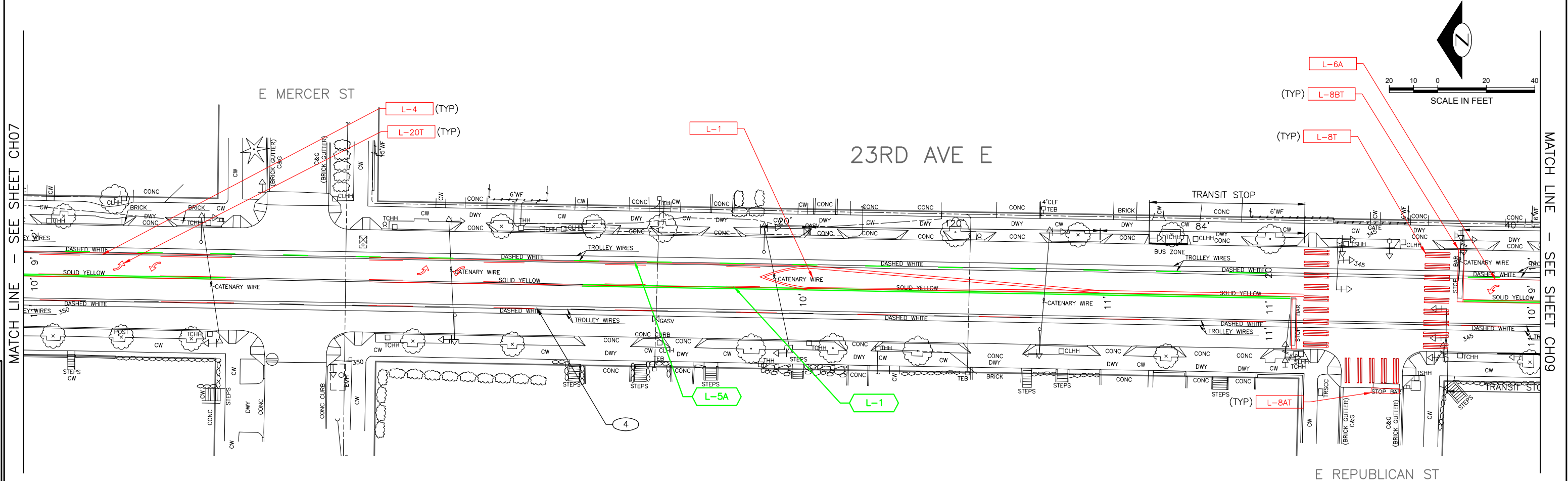

CHANNELIZATION LEGEND

- L-1 DOUBLE YELLOW CENTER LINE
- L-2A 8" SOLID YELLOW LINE (BARRIER AREA)
- L-4 YELLOW TWO WAY LEFT TURN LINE
- L-5A DASHED 4" WHITE LANE LINE
- L-8T THERMOPLASTIC WHITE 8" CROSSWALK
- L-8AT THERMOPLASTIC WHITE 16" STOP LINE
- L-8BT THERMOPLASTIC WHITE 24" STOP LINE
- L-20T THERMOPLASTIC LEFT ARROW
- L-22T THERMOPLASTIC THROUGH ARROW

SIGNING LEGEND

- TS-10 10' SIGN POST
- W4-2L LEFT LANE MERGE SYMBOL
- W9-1L LEFT LANE ENDS

CONSTRUCTION LEGEND:

- INSTALL
- REMOVE
- RELOCATE/REMAIN
- EXISTING SIGN
- NEW SIGN

CONSTRUCTION NOTES:

- ① MATCH TO EXISTING CENTERLINE AT THIS POINT
- ② MAINTAIN EXISTING ALIGNMENT THROUGH CURVE
- ③ MAINTAIN AND REPAINT EXISTING C-CURB
- ④ REINSTALL LANE LINE

NOTES:

- 1. LANE MARKERS SHALL BE INSTALLED WITH ALL PAINT LINES PER STD 710
- 2. MAINTAIN CENTER TURN LANE THROUGH INTERSECTIONS ONLY AS SHOWN IN PLANS

MATCH LINE - SEE SHEET CH07

MATCH LINE - SEE SHEET CH09

APPROVED FOR ADVERTISING
NANCY LOCKE
 DEPARTMENT OF FINANCE & ADMINISTRATIVE SERVICES
 SEATTLE, WASHINGTON 20

BY:
 PURCHASING & CONTRACTING SERVICES DIRECTOR

INITIALS AND DATE

DESIGNED . ARV . 10/20/2017

CHECKED

DRAWN

CHECKED

REVISOR'S NAME
 REGISTERED PROFESSIONAL ENGINEER

INITIALS AND DATE

REVIEWED:

DES. CONST.

SDOT PROJ. MGR.

RECEIVED

REVISED AS BUILT

ALL WORK SHALL BE DONE IN ACCORDANCE WITH THE CITY OF SEATTLE STANDARD PLANS AND SPECIFICATIONS AND OTHER DOCUMENTS CALLED FOR IN SECTION D-02.3 OF THE PROJECT MANUAL.

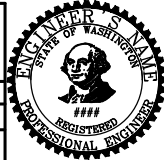

City of Seattle
Seattle Department of Transportation

ORDINANCE NO. APPROVED

FUND:

SCALE: INSPECTOR'S BOOK

CH 08

**23RD AVE/24TH AVE
 PHASE 3**

ACTIVITY NO.
 TRC0417-S0100

VAULT PLAN NO.

SHEET 9 OF 11

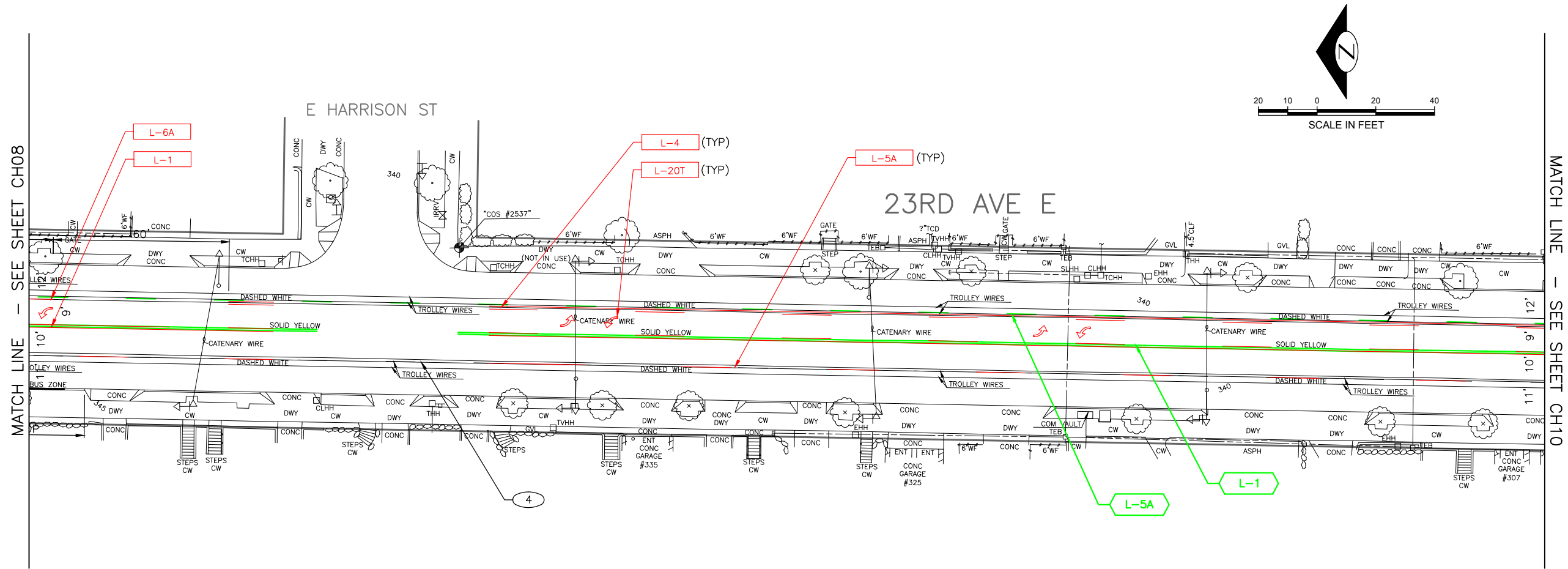

CHANNELIZATION LEGEND

- L-1 DOUBLE YELLOW CENTER LINE
- L-2A 8" SOLID YELLOW LINE (BARRIER AREA)
- L-4 YELLOW TWO WAY LEFT TURN LINE
- L-5A DASHED 4" WHITE LANE LINE
- L-8T THERMOPLASTIC WHITE 8" CROSSWALK
- L-8AT THERMOPLASTIC WHITE 16" STOP LINE
- L-8BT THERMOPLASTIC WHITE 24" STOP LINE
- L-20T THERMOPLASTIC LEFT ARROW
- L-22T THERMOPLASTIC THROUGH ARROW

SIGNING LEGEND

- TS-10 10' SIGN POST
- W4-2L LEFT LANE MERGE SYMBOL
- W9-1L LEFT LANE ENDS

CONSTRUCTION LEGEND:

- INSTALL
- REMOVE
- RELOCATE/REMAIN
- EXISTING SIGN
- NEW SIGN

CONSTRUCTION NOTES:

- ① MATCH TO EXISTING CENTERLINE AT THIS POINT
- ② MAINTAIN EXISTING ALIGNMENT THROUGH CURVE
- ③ MAINTAIN AND REPAINT EXISTING C-CURB
- ④ REINSTALL LANE LINE

NOTES:

- 1. LANE MARKERS SHALL BE INSTALLED WITH ALL PAINT LINES PER STD 710
- 2. MAINTAIN CENTER TURN LANE THOUGH INTERSECTIONS ONLY AS SHOWN IN PLANS

<p>APPROVED FOR ADVERTISING NANCY LOCKE DEPARTMENT OF FINANCE & ADMINISTRATIVE SERVICES SEATTLE, WASHINGTON 20</p> <p>BY: _____ PURCHASING & CONTRACTING SERVICES DIRECTOR</p>	<p>INITIALS AND DATE</p> <p>DESIGNED . . . ARV . 10/20/2017 . . .</p> <p>CHECKED</p> <p>DRAWN</p> <p>CHECKED</p> <p>ALL WORK SHALL BE DONE IN ACCORDANCE WITH THE CITY OF SEATTLE STANDARD PLANS AND SPECIFICATIONS AND OTHER DOCUMENTS CALLED FOR IN SECTION D-02.3 OF THE PROJECT MANUAL.</p>	<p>INITIALS AND DATE</p> <p>REVIEWED:</p> <p>DES. CONST.</p> <p>SDOT PROJ. MGR.</p> <p>RECEIVED</p> <p>REVISED AS BUILT</p>	<p>City of Seattle Seattle Department of Transportation</p> <p>ORDINANCE NO. APPROVED</p> <p>FUND:</p> <p>SCALE: INSPECTOR'S BOOK</p>	<p>CH 09</p> <p>23RD AVE/24TH AVE PHASE 3</p>	<p>ACTIVITY NO. TRC0417-S0100</p> <p>VAULT PLAN NO.</p> <p>SHEET 10 OF 11</p>
--	---	---	--	---	---

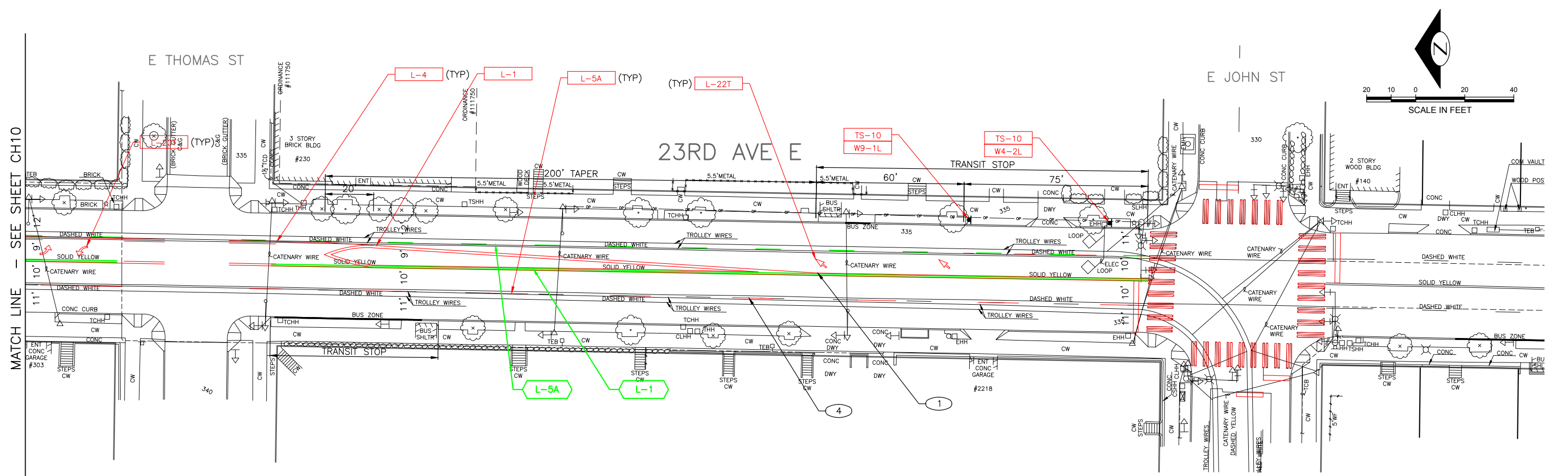

CHANNELIZATION LEGEND

L-1	DOUBLE YELLOW CENTER LINE
L-2A	8" SOLID YELLOW LINE (BARRIER AREA)
L-4	YELLOW TWO WAY LEFT TURN LINE
L-5A	DASHED 4" WHITE LANE LINE
L-8T	THERMOPLASTIC WHITE 8" CROSSWALK
L-8AT	THERMOPLASTIC WHITE 16" STOP LINE
L-8BT	THERMOPLASTIC WHITE 24" STOP LINE
L-20T	THERMOPLASTIC LEFT ARROW
L-22T	THERMOPLASTIC THROUGH ARROW

SIGNING LEGEND

TS-10	10' SIGN POST
W4-2L	LEFT LANE MERGE SYMBOL
W9-1L	LEFT LANE ENDS

CONSTRUCTION LEGEND:

	INSTALL
	REMOVE
	RELOCATE/REMAIN
	EXISTING SIGN
	NEW SIGN

CONSTRUCTION NOTES:

①	MATCH TO EXISTING CENTERLINE AT THIS POINT
②	MAINTAIN EXISTING ALIGNMENT THROUGH CURVE
③	MAINTAIN AND REPAINT EXISTING C-CURB
④	REINSTALL LANE LINE

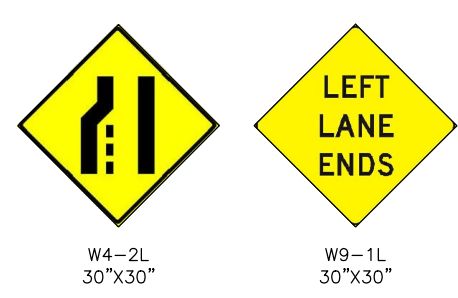

- NOTES:**
- LANE MARKERS SHALL BE INSTALLED WITH ALL PAINT LINES PER STD 710
 - MAINTAIN CENTER TURN LANE THOUGH INTERSECTIONS ONLY AS SHOWN IN PLANS

APPROVED FOR ADVERTISING
NANCY LOCKE
 DEPARTMENT OF FINANCE & ADMINISTRATIVE SERVICES
 SEATTLE, WASHINGTON 20

INITIALS AND DATE		INITIALS AND DATE	
DESIGNED ARV . 10/20/2017	CHECKED	REVIEWED:	DES. CONST.
DRAWN		RECEIVED	
CHECKED		REVISED AS BUILT	

ALL WORK SHALL BE DONE IN ACCORDANCE WITH THE CITY OF SEATTLE STANDARD PLANS AND SPECIFICATIONS AND OTHER DOCUMENTS CALLED FOR IN SECTION D-02.3 OF THE PROJECT MANUAL.



City of Seattle
Seattle Department of Transportation
 ORDINANCE NO. APPROVED
 FUND:
 SCALE: INSPECTOR'S BOOK

**23RD AVE/24TH AVE
 PHASE 3**

CH 10
 ACTIVITY NO.
 TRC0417-S0100
 VAULT PLAN NO.
 SHEET 11 OF 11