

“Today, all animals and habitats are inextricably influenced by our decisions and actions and the resulting changes to the environment.”

-Woodland Park Zoo Strategic Plan,
2018-2022



MORE THAN JUST ANIMALS

“We have set out an ambitious vision for a sustainable future by... providing **extraordinary experiences** at the zoo, in the community, and in the virtual world that **connect people with wildlife**, and by **fostering a broad social movement for wildlife conservation.**”

- Woodland Park Zoo Strategic Plan, 2018-2022

TREE KANGAROO FOREST PROJECT

WOODLAND PARK ZOO

SEATTLE DESIGN COMMISSION

MAY 5, 2022

LMN + CLR + WM

LAND ACKNOWLEDGMENT

These are the lands of the Tribal signatories of the Treaty of Point Elliott (1855), whose stewardship for the waters, plants, land and animal relatives in the Northwest has continued since time immemorial. Woodland Park Zoo acknowledges this stewardship, the sovereign rights of the Tribal signatories, and our responsibility to join with these Tribes to inspire and advance the restoration of relationships between humans and the living world around us.

*gʷəʔ dibəʔ, ti dʷixʷ ʔaciʔtalbixʷ, tiʔəʔ dəxʷʔubətəb ʔə ti tudʷixʷʔsčəʔ ti tliʔi ʔal bəkəltiu (1855).
sgʷaʔčəʔ swatixʷtədčəʔ. ləcutiʔdub ʔə ti dʷixʷ ʔaciʔtalbixʷ tulʔal tudiʔ tudʷixʷ pədtəb ti
swatixʷtəd ʔi ti swətixʷtəd, ti qʷuʔ ʔi ti ʃʷəlč, ti tatačulbixʷ ʔi ti titčulbixʷ. suxʷtəb ʔə ti
Woodland Park Zoo tiʔəʔ cədiʔ ləcustiʔdxʷ ʔə ti dʷixʷ ʔaciʔtalbixʷ ʔi ti sgʷaʔs ʃəʔʔəčəbs
dxʷʔal cʔʷaqid. huy, ʔuyayus ti Woodland Park Zoo ʔəsqʷuʔ ʔə ti dʷixʷ ʔaciʔtalbixʷ dxʷʔal kʷi
ʔubəshəliʔtʰs ti swatixʷtəd ʔi ti bəkʷ ʔucəʔdalb ʔal ti swatixʷtəd, ʔal ti qʷuʔ ʔi ti ʃʷəlč, ʔal ti
ʃqulgʷədxʷ. ti Woodland Park Zoo gʷəl ʔabyid ti tatačulbixʷ ʔi ti titčulbixʷ ʔə kʷi shəliʔ. ʔəsʔaʔtub
ʔə ti Woodland Park Zoo gʷəpaʔcutəs kʷi bəkʷ gʷat dxʷʔal kʷi skʷaxʷads tiʔəʔ qič syayus.*

AGENDA

Opportunity

Engagement

Approach

Concept

LMN Architect

CLR Zoo Designer

WALKER MACY Landscape Architect

AWARE INSTITUTE Animal Welfare Scientist

TAHOMA PEAKS Indigenous Education

ZOO ADVISORS Community Engagement

MAYFLY Civil Engineer

PAE MEP Engineer

LUND OPSAHL Structural Engineer

OPPORTUNITY



How can guests more fully experience the depth of animal care in the zoo of the future?



What participatory experiences could inspire the zoo of the future?



**What is the role of technology
in the zoo of the future?**

**How do guests
experience
sustainability in the
zoo of the future?**



How can we connect the entire guest experience,



...connect to the PNW,



...and connect to the world?

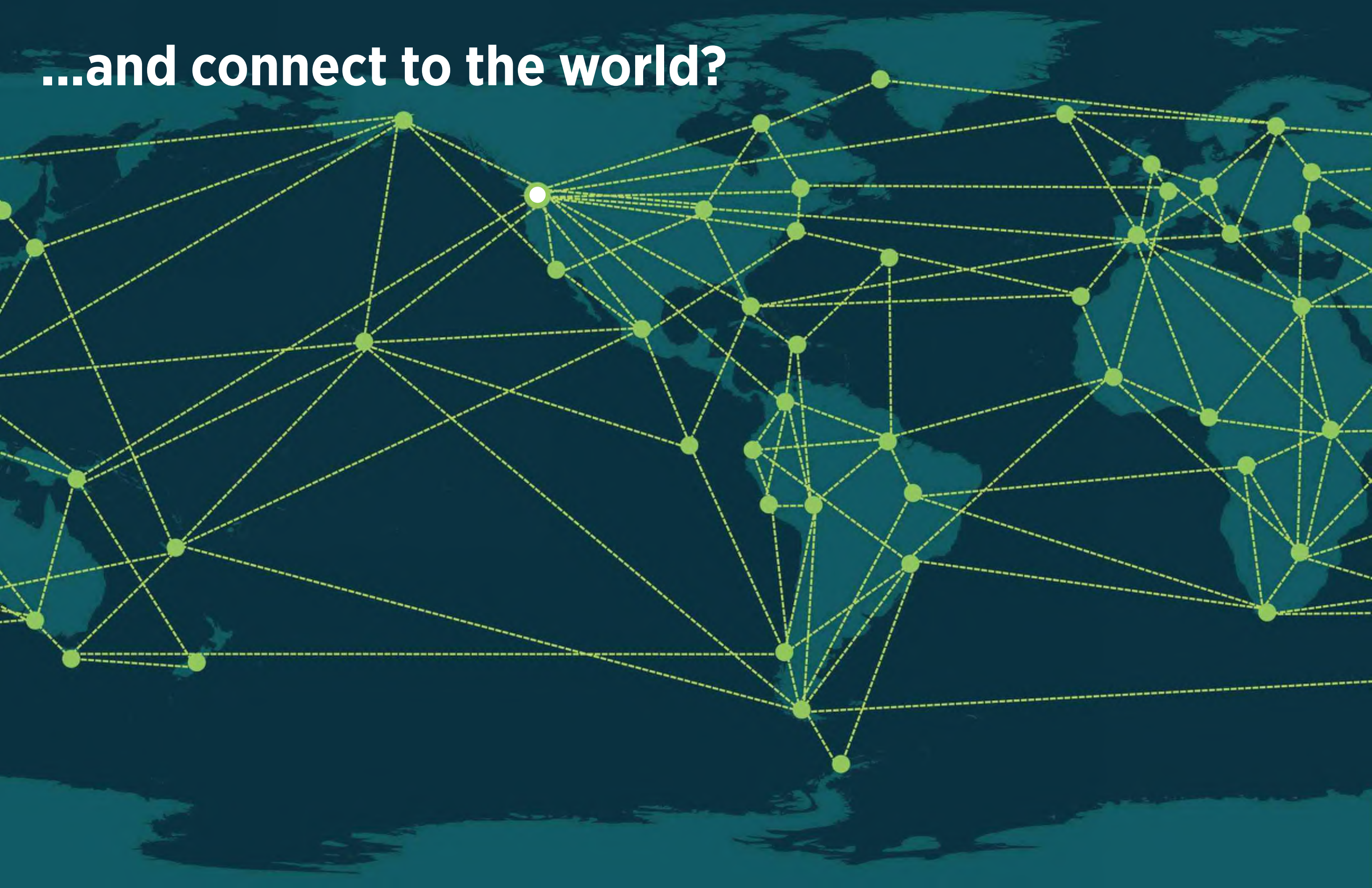



How can guests experience the power of community-led conservation solutions?

How can we inspire community-led conservation in the PNW?



How can we leverage this site...

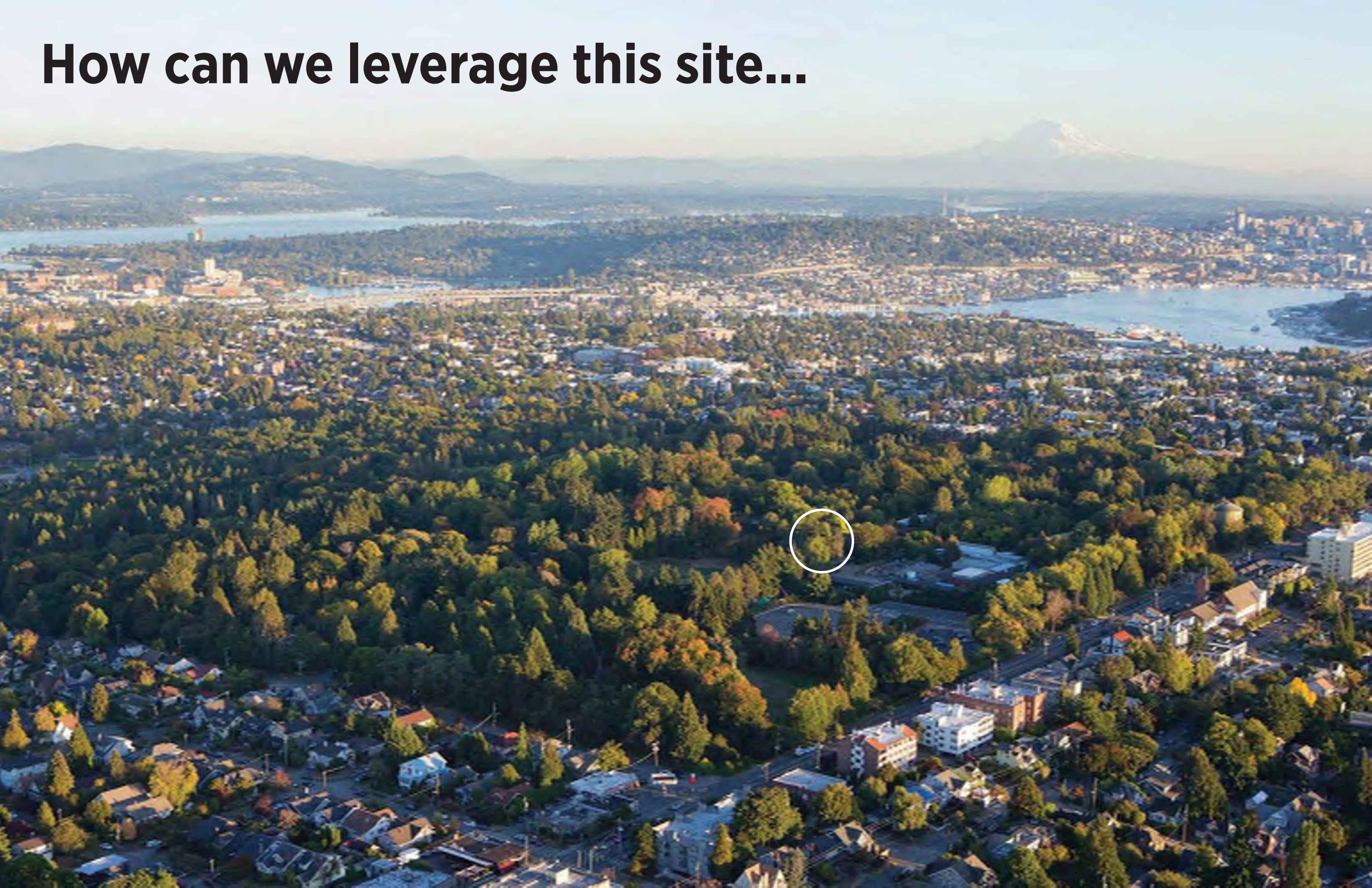

...at the center of this important greenspace,

GREENLAKE

N. 59TH ST.

PHINNEY AVE N



HWY 99

N. 50TH ST.

...adjacent to the primary entry and circulation?

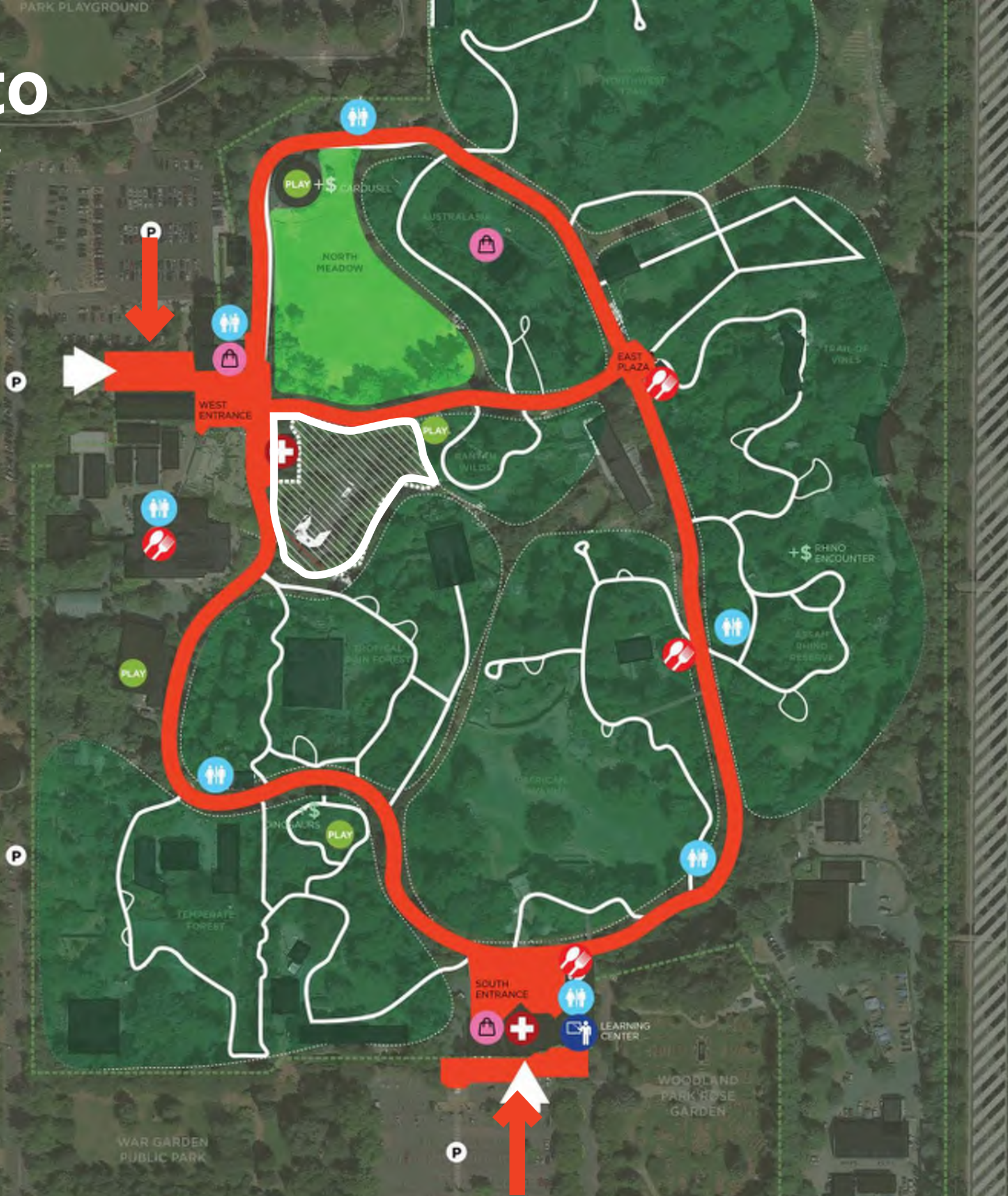

WOODLAND PARK

PHINNEY AVE N

AURORA AVE N

How can we complement existing amenities...

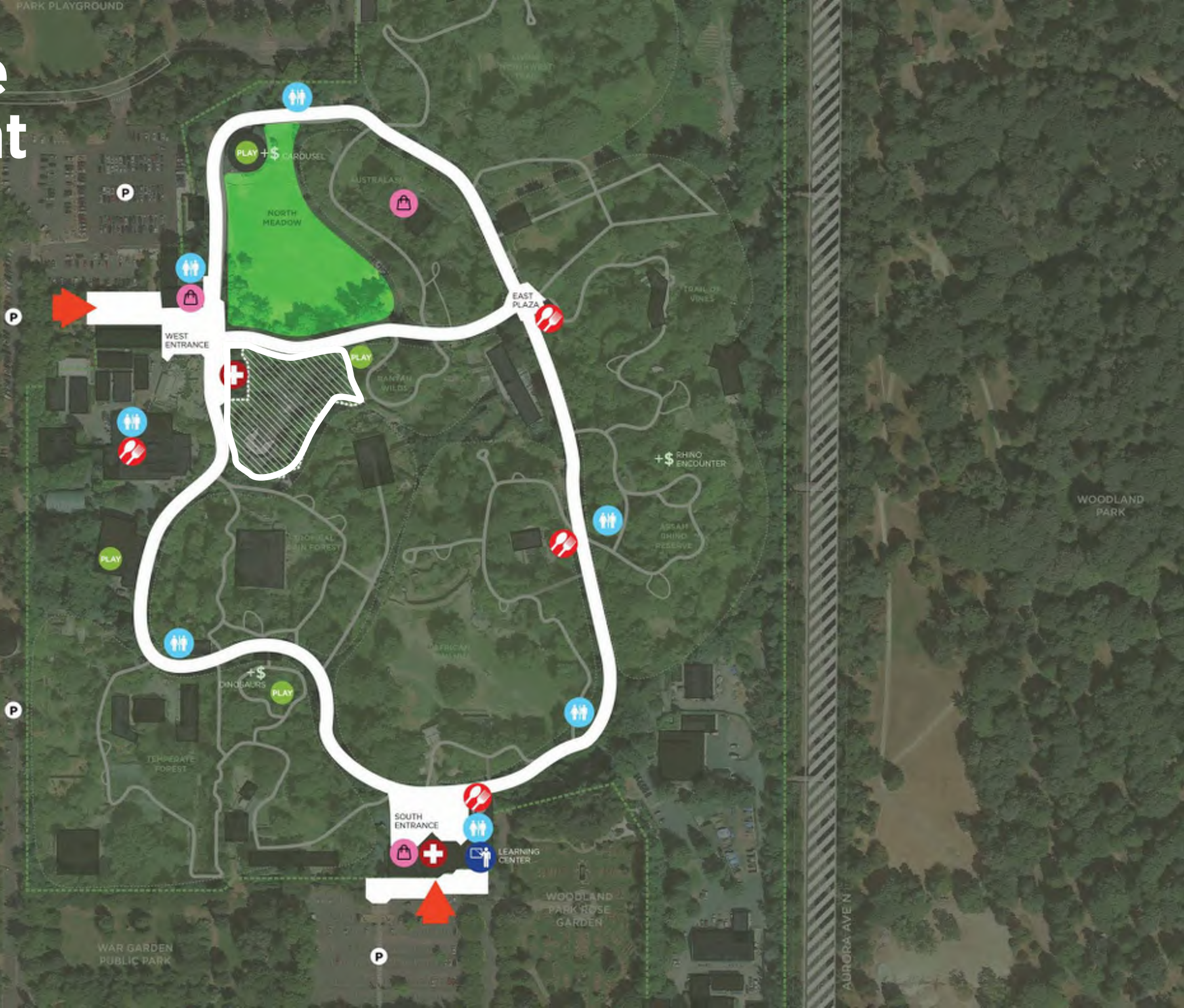

...to reframe the entire zoo experience?

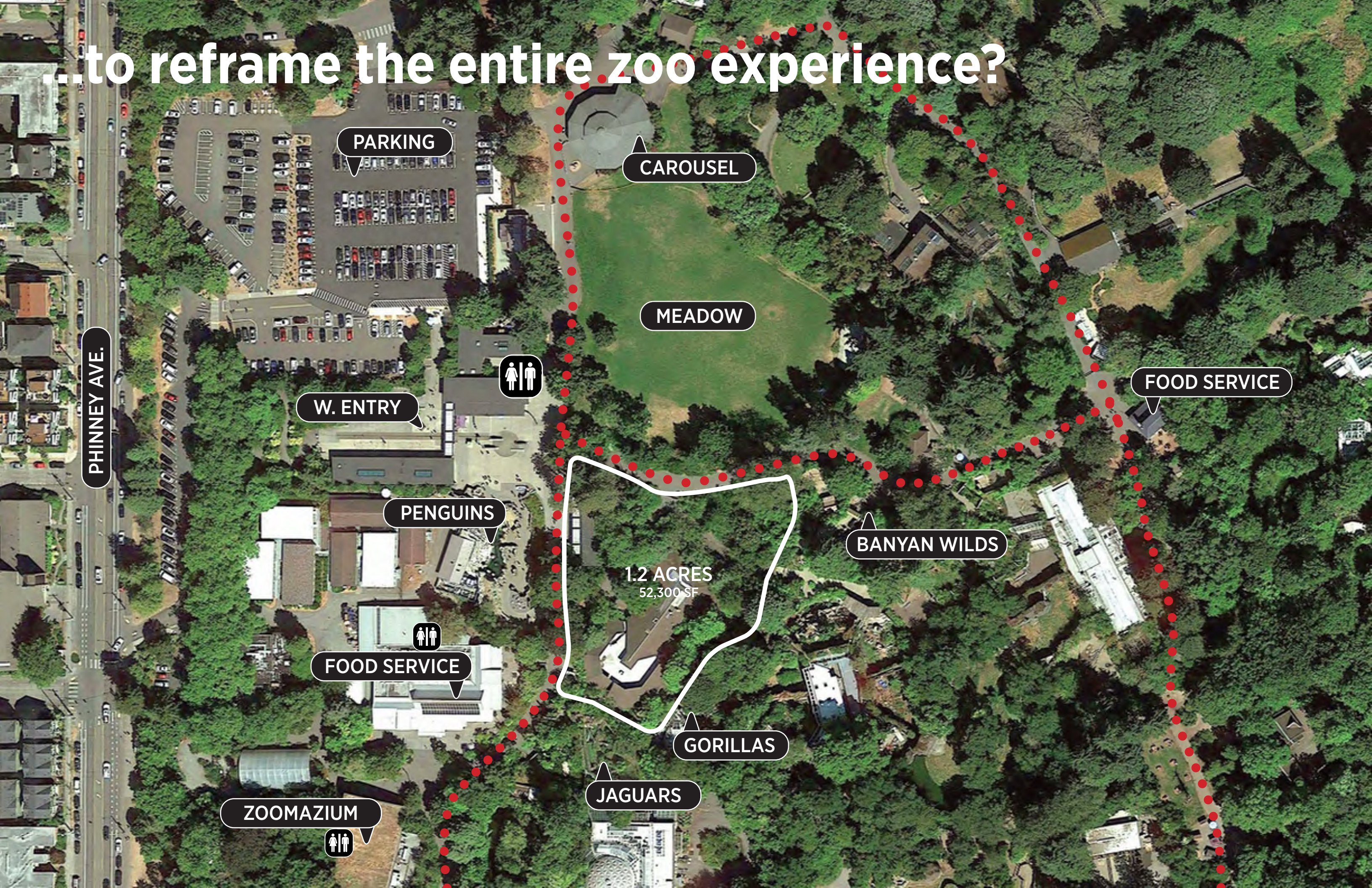

PARKING

CAROUSEL

MEADOW

W. ENTRY

FOOD SERVICE

PENGUINS

BANYAN WILDS

1.2 ACRES
52,300 SF

FOOD SERVICE

GORILLAS

JAGUARS

ZOOMAZIUM

How can we use the site's exceptional trees...



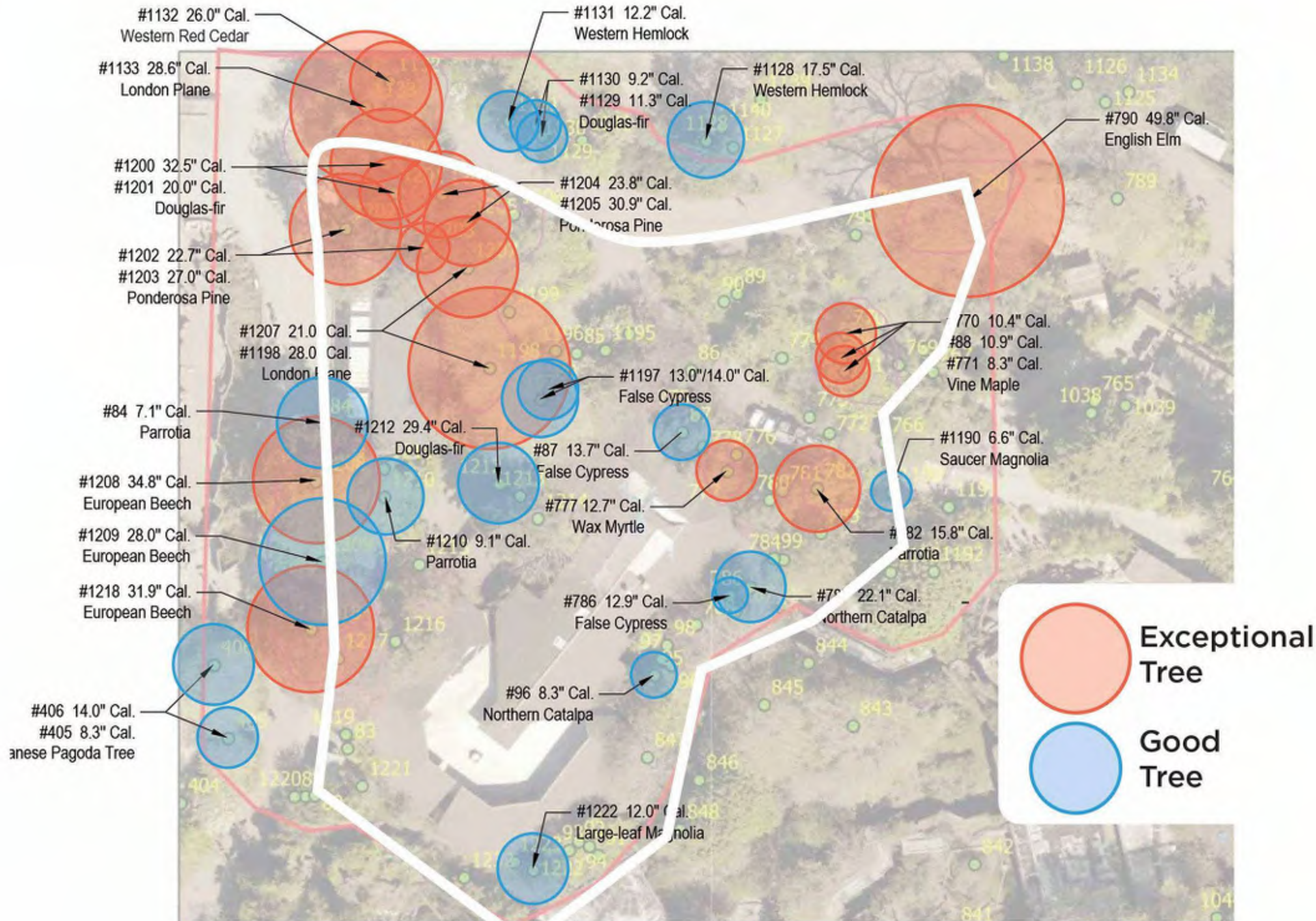

... to leverage our PNW identity with forests?

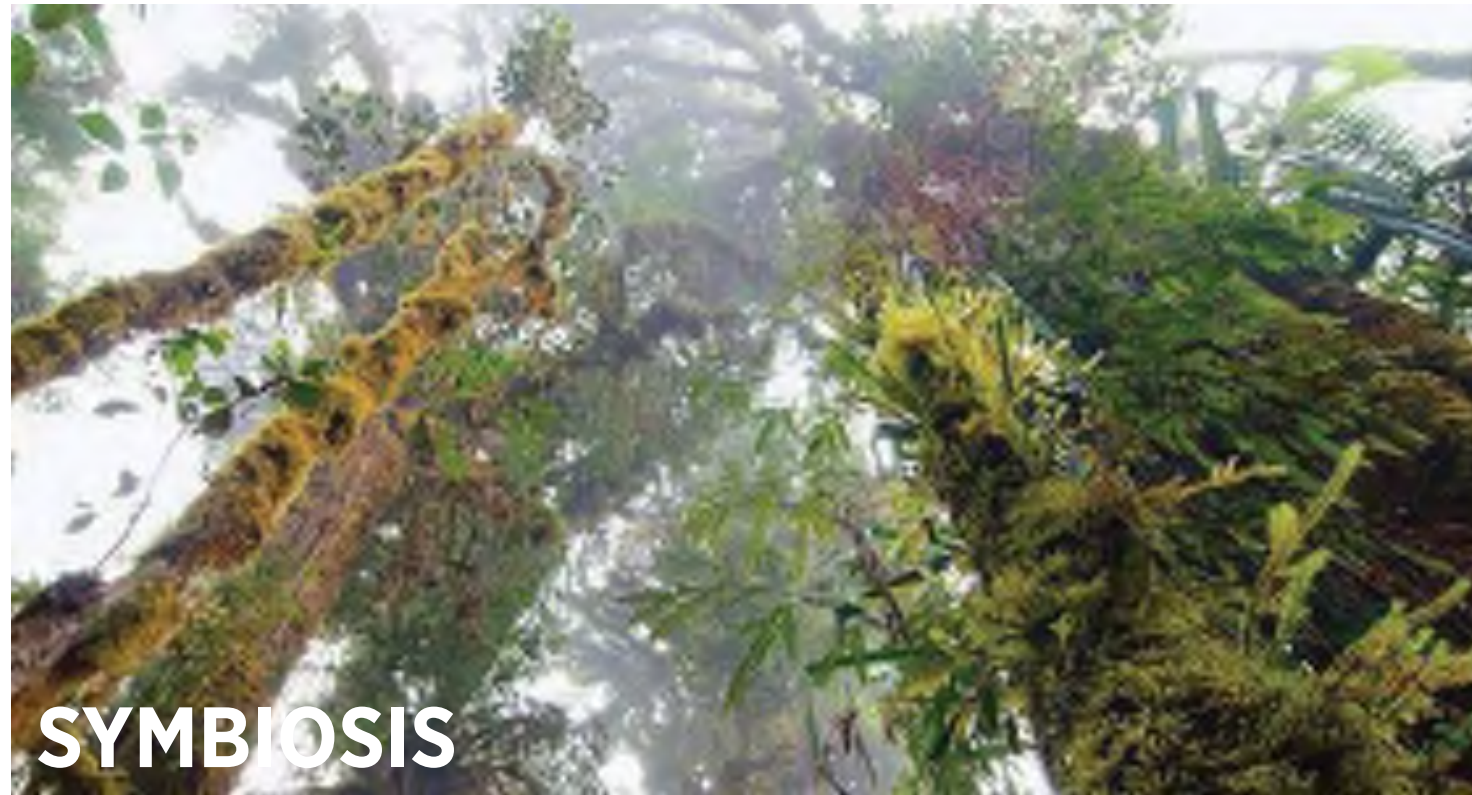



CULTURE



ECONOMIC RESOURCE



MANAGEMENT



CLIMATE CHANGE MITIGATION

ENGAGEMENT

INTERNAL ENGAGEMENT

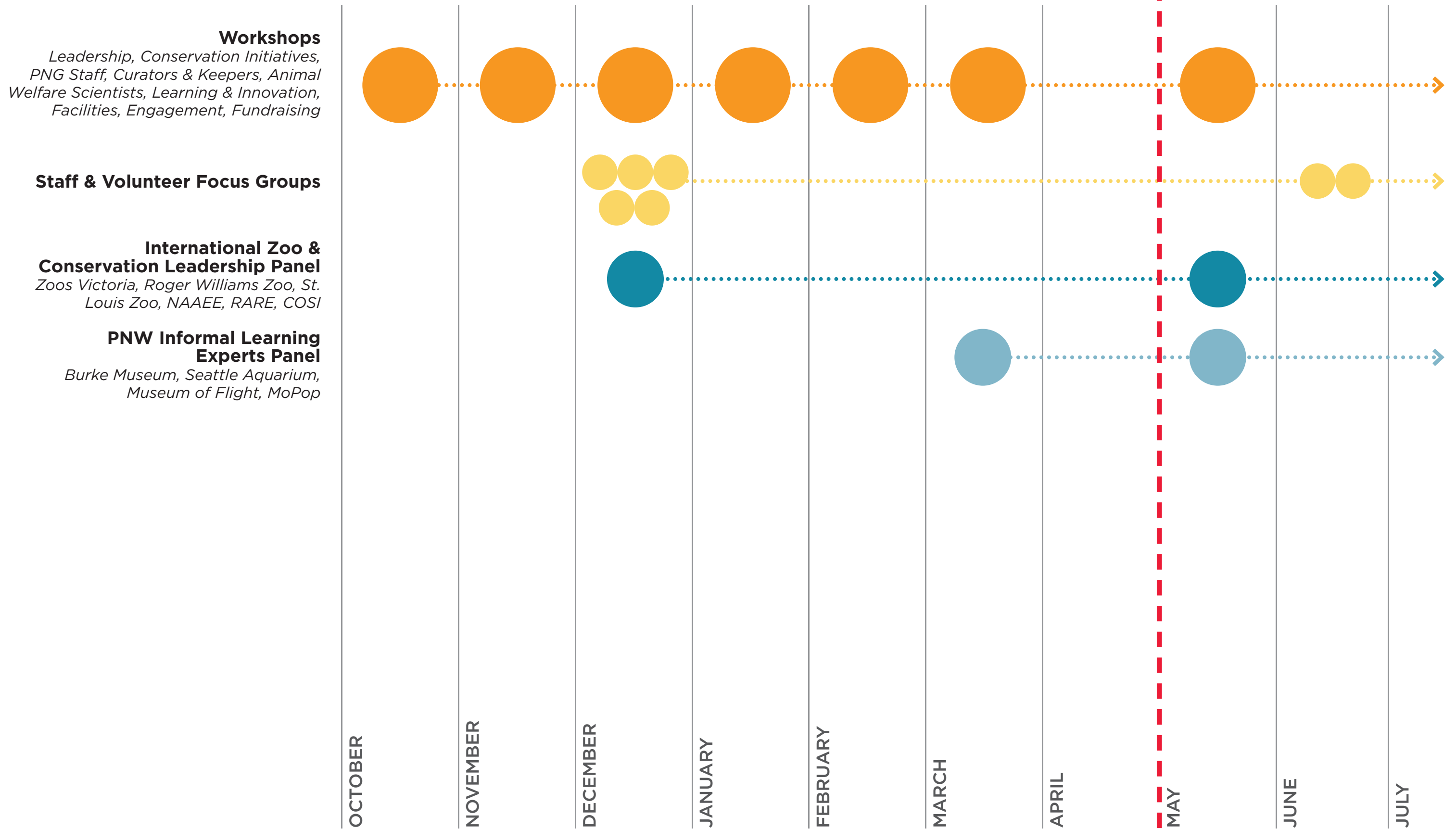

Internal Priorities

*Use
technology
thoughtfully*

*Interactive,
multi-sensory
vs. reading &
observation*

*Model
sustainability in
the built
project*

*Conservation
solutions are
the focus not
animals*

*Do not water
down climate
change*

*Give animals
agency*

*Short and
long-term
flexibility*

*Encourage
natural
behaviors*

*Welcoming
to all*

Individual

*Move beyond
empathy to
agency
& action*

*Blur the
boundaries
between human
& animal space*

*Mixed
species
habitats*

Community

*Empower local
communities to
define their
conservation
challenges &
solutions*

*Transparency:
Back-of-house
to the front*

Policy

*Climate &
conservation
justice*

GUEST DEMOGRAPHICS

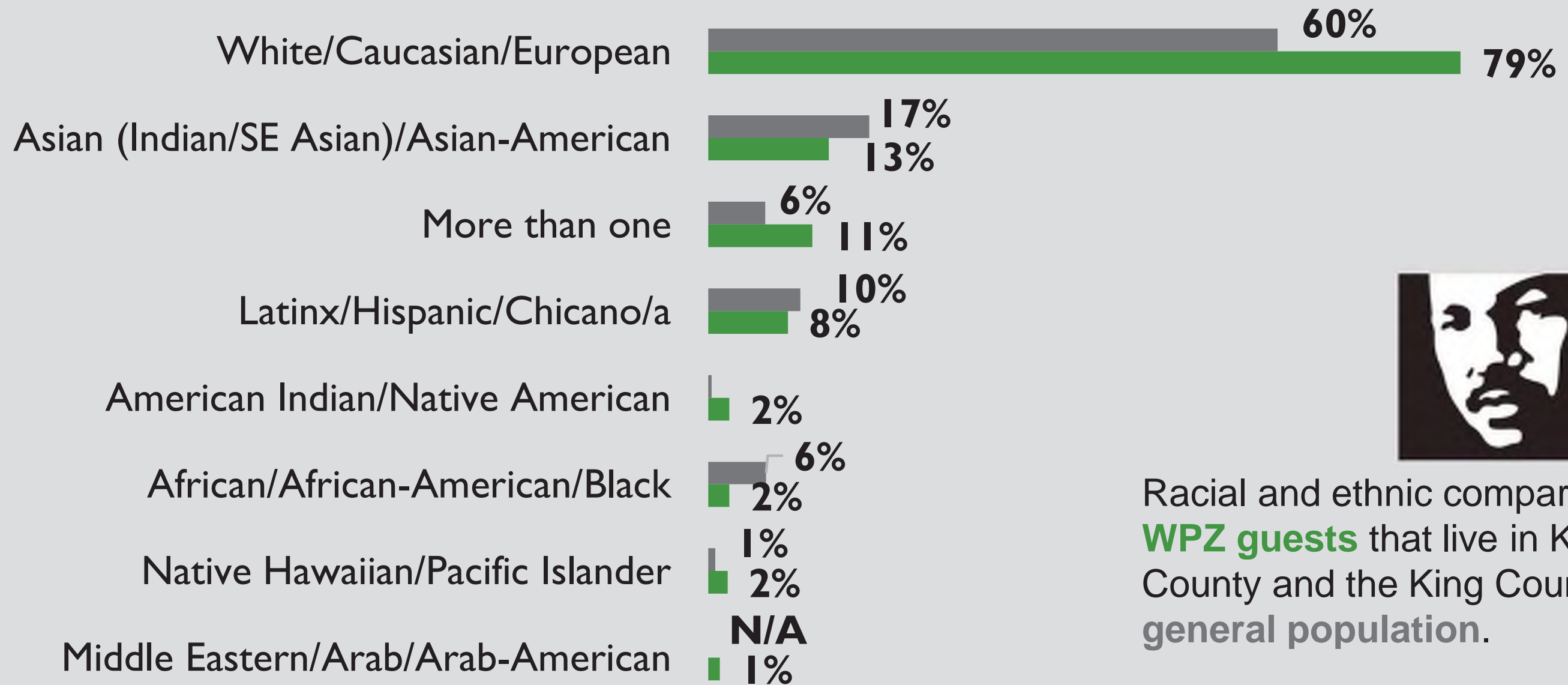

Racial and ethnic comparison of **WPZ guests** that live in King County and the King County general population.

GUEST DEMOGRAPHICS



Income comparison of **WPZ** guests that live in **King County** (n=204) and the King County **general population**.

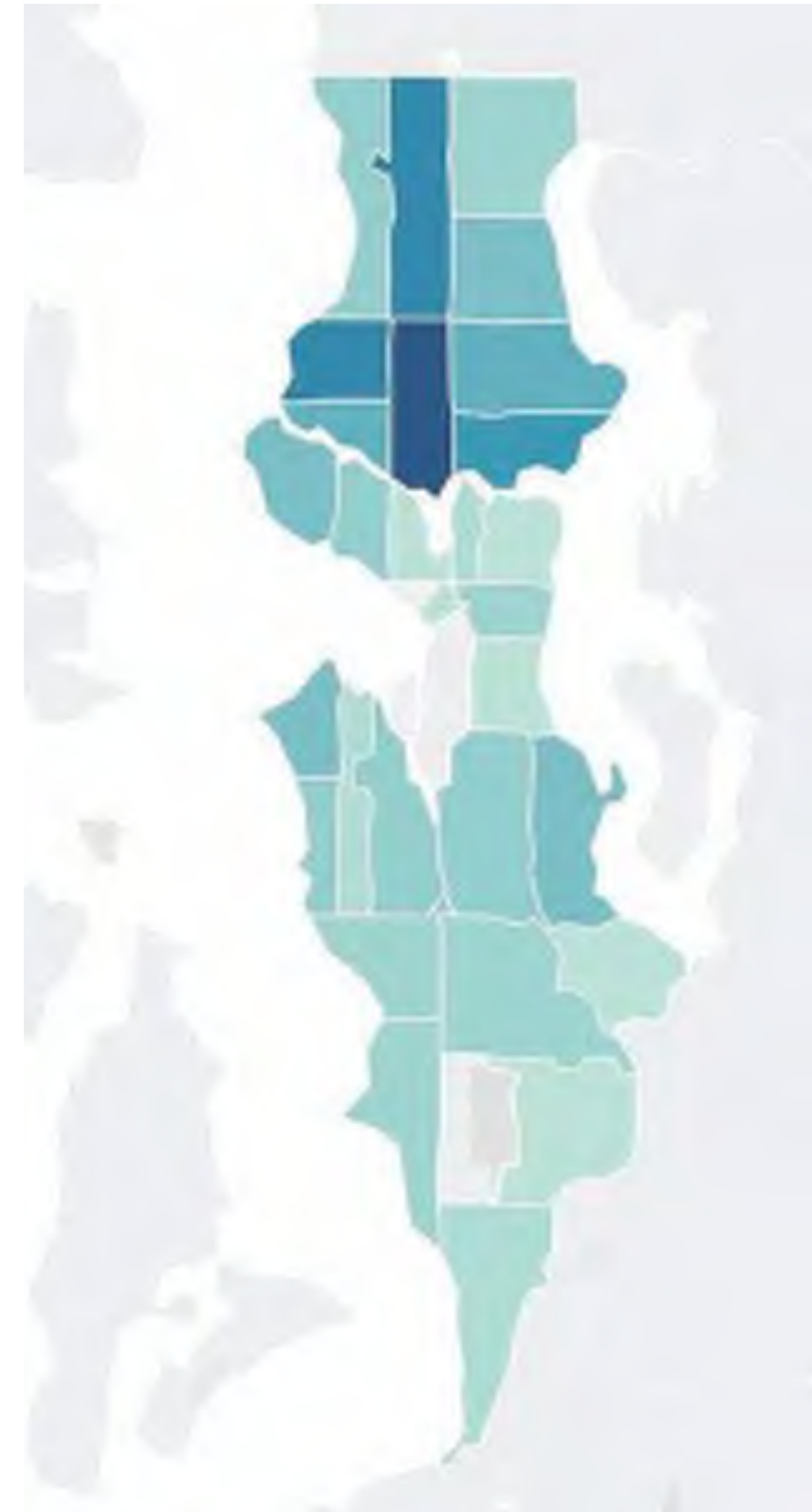
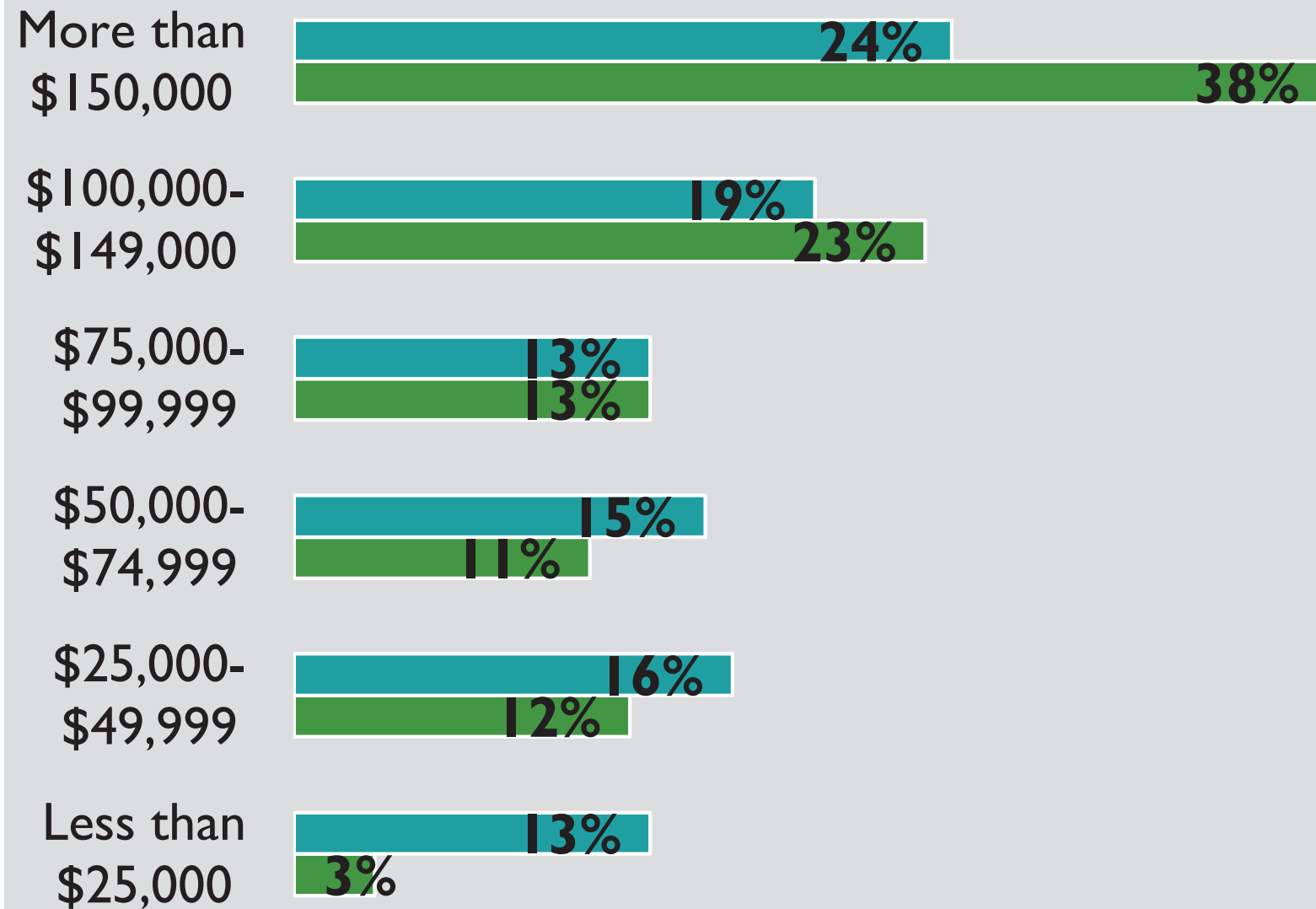

GUEST DEMOGRAPHICS



10% of groups identified as having someone with a disability in their group



Physical Disability

n=20

Intellectual Disability

n=15

Self-Describe

n=11

Sensory Disability

n=11

8 respondents checked 2 or more boxes.

WOODLAND PARK ZOO ACCESS PROGRAMS

Community Access Program (CAP)

Provides 100,000 free tickets to human service organizations serving low-income and/or at-risk children and adults or other demonstrated under-resourced groups.

\$5 Discover Ticket

A deeply discounted ticket for foster and kinship families or recipients of EBT/Washington Quest, P-EBT or WIC assistance.

\$35 Explorer Membership

A deeply discounted membership for foster and kinship families or recipients of EBT/Washington Quest, P-EBT or WIC assistance. Unlimited admission for one year for 2 adults and up to 6 children. Explorer memberships increased by 384% from 2020-2021.

Empathy Collaborative

In partnership with Antioch University Seattle, this program aims to recognize and rectify the ways that diverse communities in the Seattle region have been historically underserved by the zoo. The program uses a co-design framework to build authentic, long-term, reciprocal relationships between the zoo and South Seattle neighborhoods.

Guest Inclusion Program

The zoo partners with disability organizations in the community to provide expert guidance to create a welcoming environment that promotes accessibility and inclusion, and offers meaningful learning experiences for guests with disabilities to engage with conservation.

FULL ENGAGEMENT

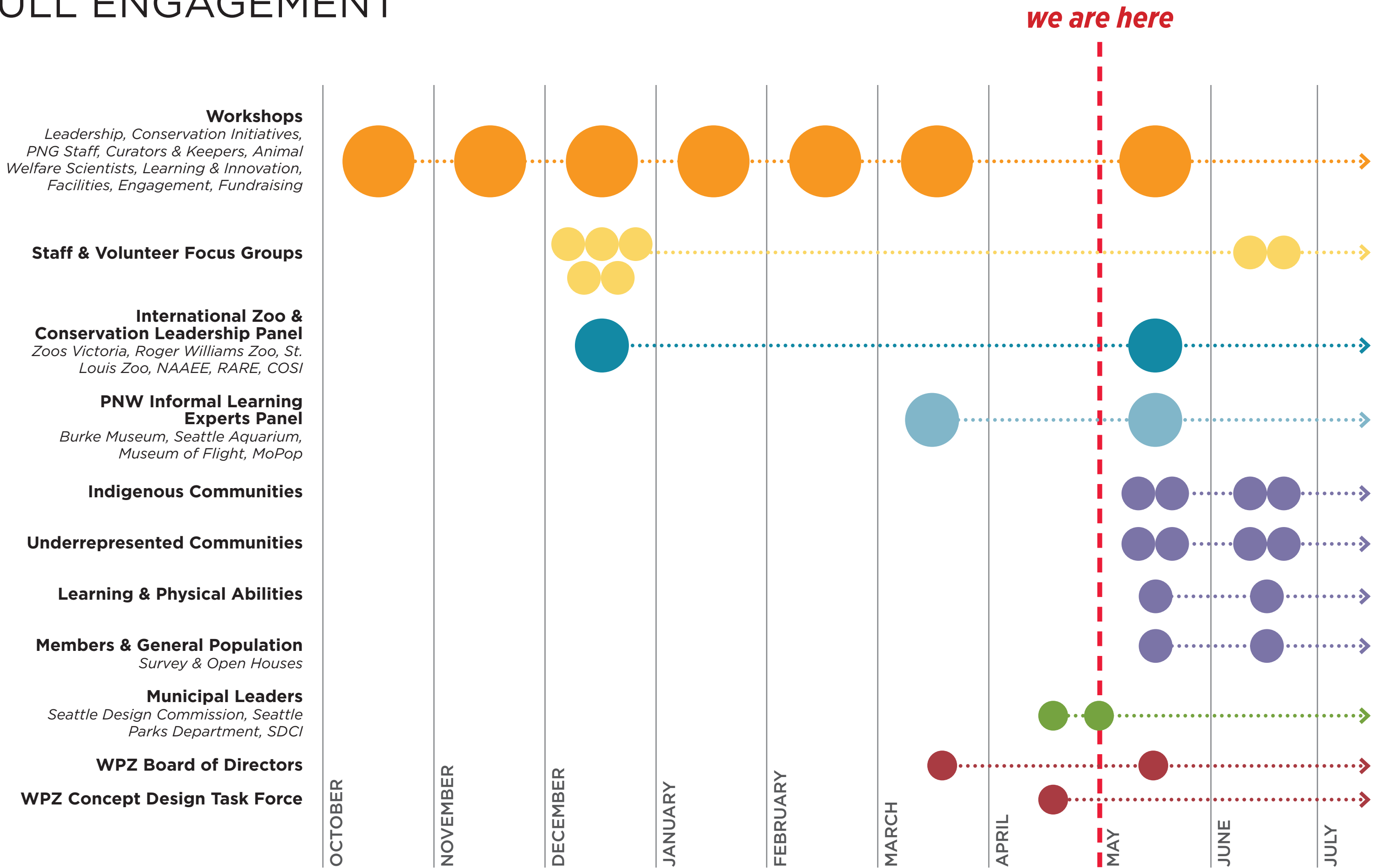

APPROACH

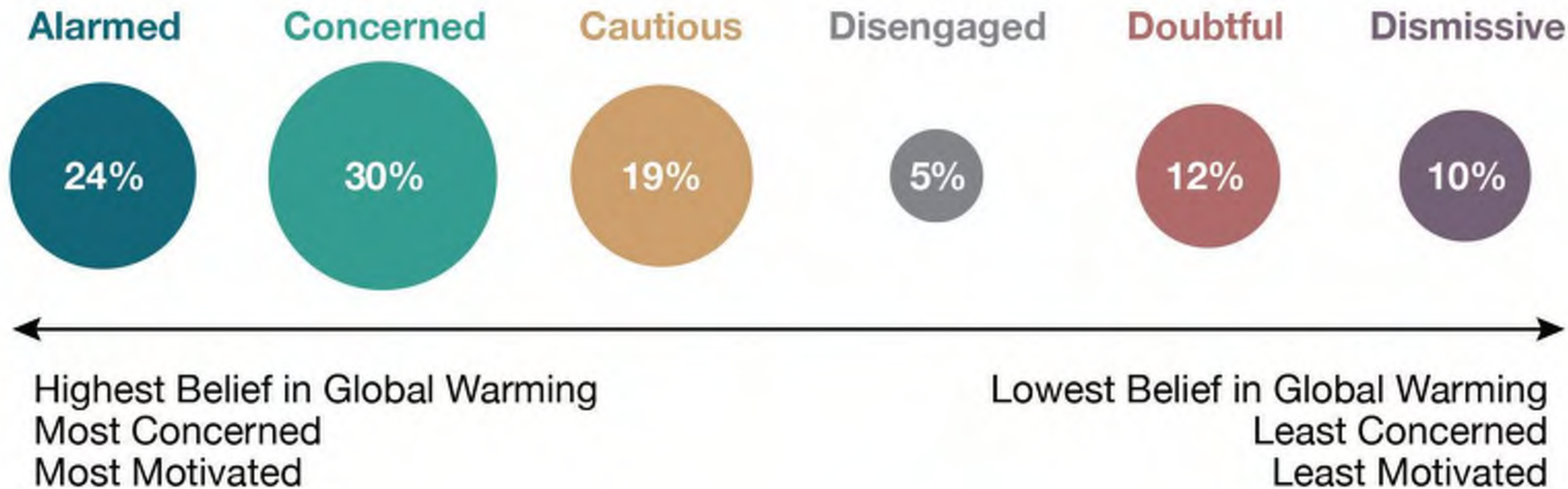

June 2017– March 2021
(Total cases = 8,322)



A group of diverse young children, including boys and girls of various ethnicities, are standing in a line on a playground. They are looking towards the camera with various expressions of uncertainty and concern. The children are dressed in casual clothing, including hoodies, t-shirts, and dresses. The background shows other children and adults, suggesting a busy outdoor setting. The text is overlaid in the center of the image.

**I don't know what to do.
I'm not convinced that my actions really make a difference.**

WPZ THEORY OF CHANGE

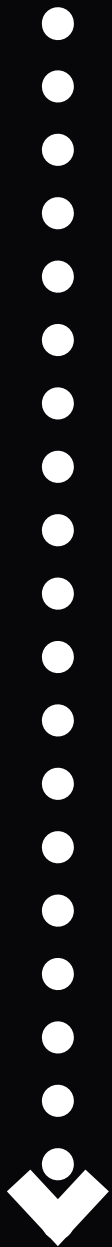

CARE

I feel empathy for the animals, habitats and humans affected by our choices.

INSPIRE

Proven solutions give me hope.

EMPOWER

My individual and collective actions make a difference.

WPZ THEORY OF CHANGE

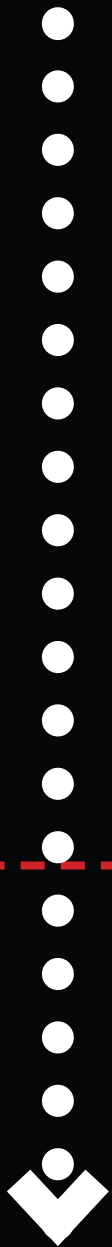

CARE

I feel empathy for the animals, habitats and humans affected by our choices.

INSPIRE

Proven solutions give me hope.

**WHERE ZOOS
TYPICALLY STOP**

EMPOWER

My individual and collective actions make a difference.



Tool:
ANIMALS



**Tool:
FORESTS**



Tool:

CONSERVATION SUCCESS CASE STUDIES

WPZ'S TREE KANGAROO CONSERVATION PROGRAM, PAPUA NEW GUINEA

Primary Project Metric

Activate impactful conservation action.

Project Theme

People, animals, and forests are interconnected communities.

Project Principles

- **Deepen personal connections to forests and their animal communities**
- **Demonstrate the impacts of forests on climate change**
- **Enable guests to practice the full range of conservation actions: individual, community & policy**
- **Facilitate participation and exploration** (vs. observation and explanation)
- **Provide transparent and exceptional animal care and welfare**
- **Be a model of sustainability**
- **Prioritize short-term flexibility and long-term adaptability**

- **Climb a tree** and experience the biodiversity in the canopy
- Touch and feel the bark of a large, living tree
- Explore the **fungi networks** within the forest floor
- Interact with the people who protect our forest communities (live, virtual, or pre-recorded)
- Be a YUS Ranger and **track the movement of wild PNG tree kangaroos** in real time
- Feel the ever-changing sights, **humidity, smells, and sounds** of PNG's cloud forest community (plant, animal, human)
- **Be an animal welfare scientist** and check the health of the animals through a **care dashboard**
- Experience forest regeneration (decay, nurse logs)
- Measure nature's embodied carbon (ex. sonic hammers for trees)
- Enter the **microscopic worlds** hidden within soil and water
- Measure water when it rains and follow its path to reuse
- Guest group rest and hang-out
- Conservation and Keeper Chats
- Interact with the **local people who protect our global forest** communities (live, virtual, or pre-recorded)
- Conversation with a **WPZ keeper**, volunteer or conservation expert
- **Contemplation**
- Guest conservation speakers
- Public convening events (**town halls**, policy events)
- Attend a local community-led conservation conversation to define local priorities
- Find out other ways to participate in forest conservation action (ex. live schedule of **legislative events**, rallies)
- Partner/industry conservation events
- Conversation with a **WPZ conservation expert**
- Assist in the making of conservation innovations (ex. scent dispenser)

activity-based programming

- Engage with **local citizen science opportunities**
- Sign up for and attend citizen scientist trainings
- Witness collaborative WPZ and partner meetings
- Attend a small **community-led conservation session**
- Witness large scale conservation industry events taking place
- **Make something to:**
 - **Take home**
 - Be displayed at WPZ
 - Send to partner groups (ex. thank you card to PNG forest ranger)
 - **Send to local/national leaders**
- Plant something
- Make **music**
- Make a new recipe (ex. plant-based meat, conservation vanilla)
- **Write a letter** to a local or national leader
 - Make a yard sign to show support for conservation policy
 - Make a sign to take or send to an advocacy rally
- Experience the impacts your **consumer choices** have on conservation efforts
- Meet the featured product's entrepreneur/farmer/land owner who's protecting our forests with your help!
- Purchase & **drink a cup of coffee**
- Cup and taste coffee
- Experience the **growing, picking, drying and milling** processes
- Sort and roast your own beans
- Experience getting coffee to market: games
- Other global/local products (ex. honey, vanilla, paper)
- Honey: Beehives/tastings/other experiences
- Vanilla: plants/tastings/other experiences
- Take home a **conservation shopping guide** (ex. groceries)
- And many more...

CARE EXPERIENCES



HOPE

Experience the people-powered solutions that are protecting our forest communities



INTERACT

Understand the depth of care and the relationships between keepers and animals

INSPIRE EXPERIENCES

EXPLORE

Gain new perspectives & knowledge about conservation through interactive experiences



RESEARCH
Get involved in the science of conservation work



EMPOWER EXPERIENCES



MAKE
Develop and share
conservation ideas



CHOOSE
Experience how your
consumer choices impact
conservation efforts

EMPOWER EXPERIENCES



EXCHANGE

Dialogue with others about conservation



Forest Guardians #1: Matschie's Tree Kangaroo



Forest Guardians #2 Example: Rhino Hornbill



Forest Guardians #3 Example: Red Panda

PROGRAM SCENARIO - CONVERSATIONS CENTER

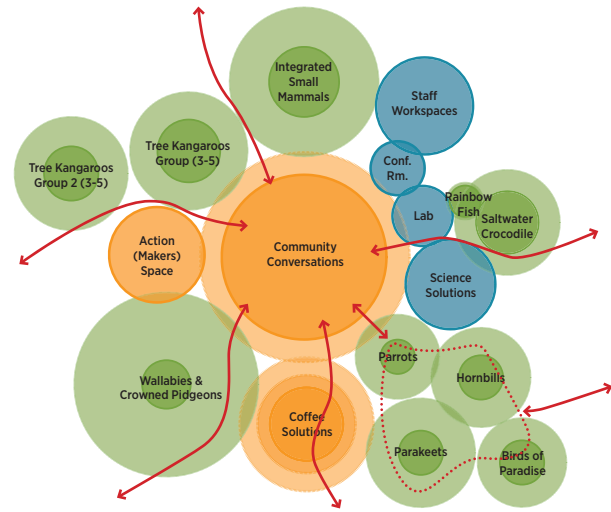

PROGRAM SCENARIO - COFFEE & SCIENCE CONNECTORS

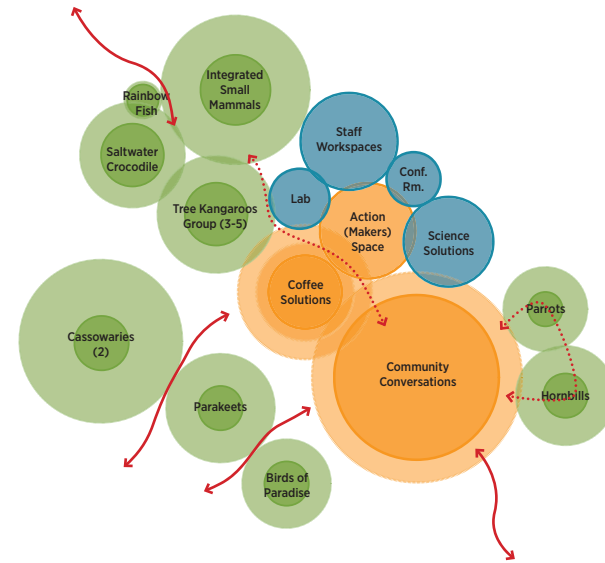

PROGRAM SCENARIO - CONVERSATION ENTRY / ANIMAL RING

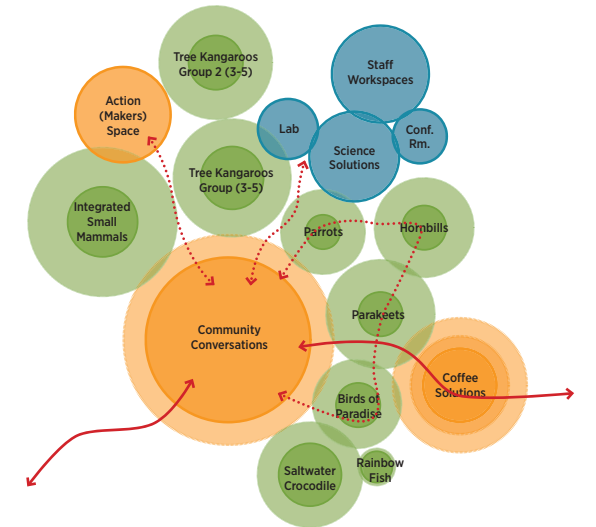

PROGRAM SCENARIO - LINEAR

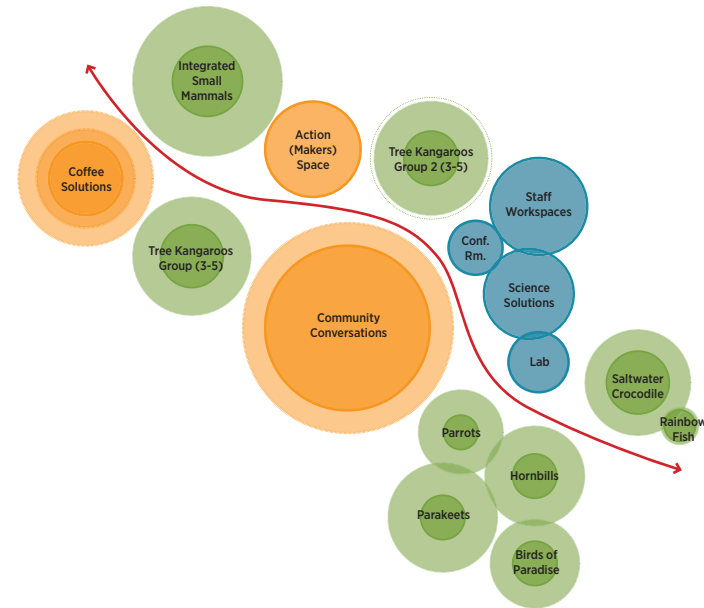

PROGRAM SCENARIO - ACTION SURROUNDED / WEIGHTED

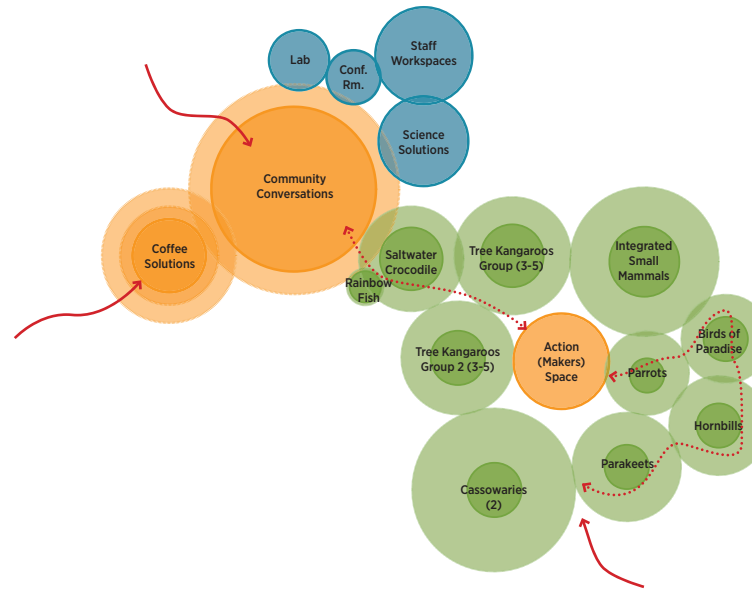

PROGRAM SCENARIO - MERGE

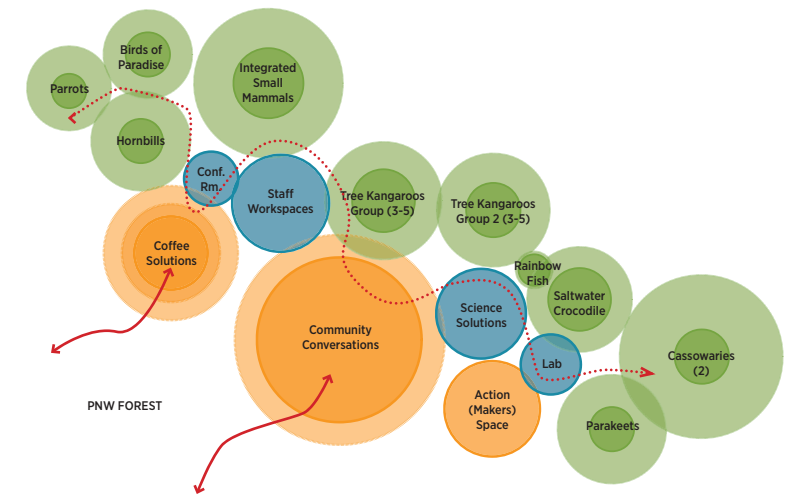

EXPERIENCE ORGANIZATION

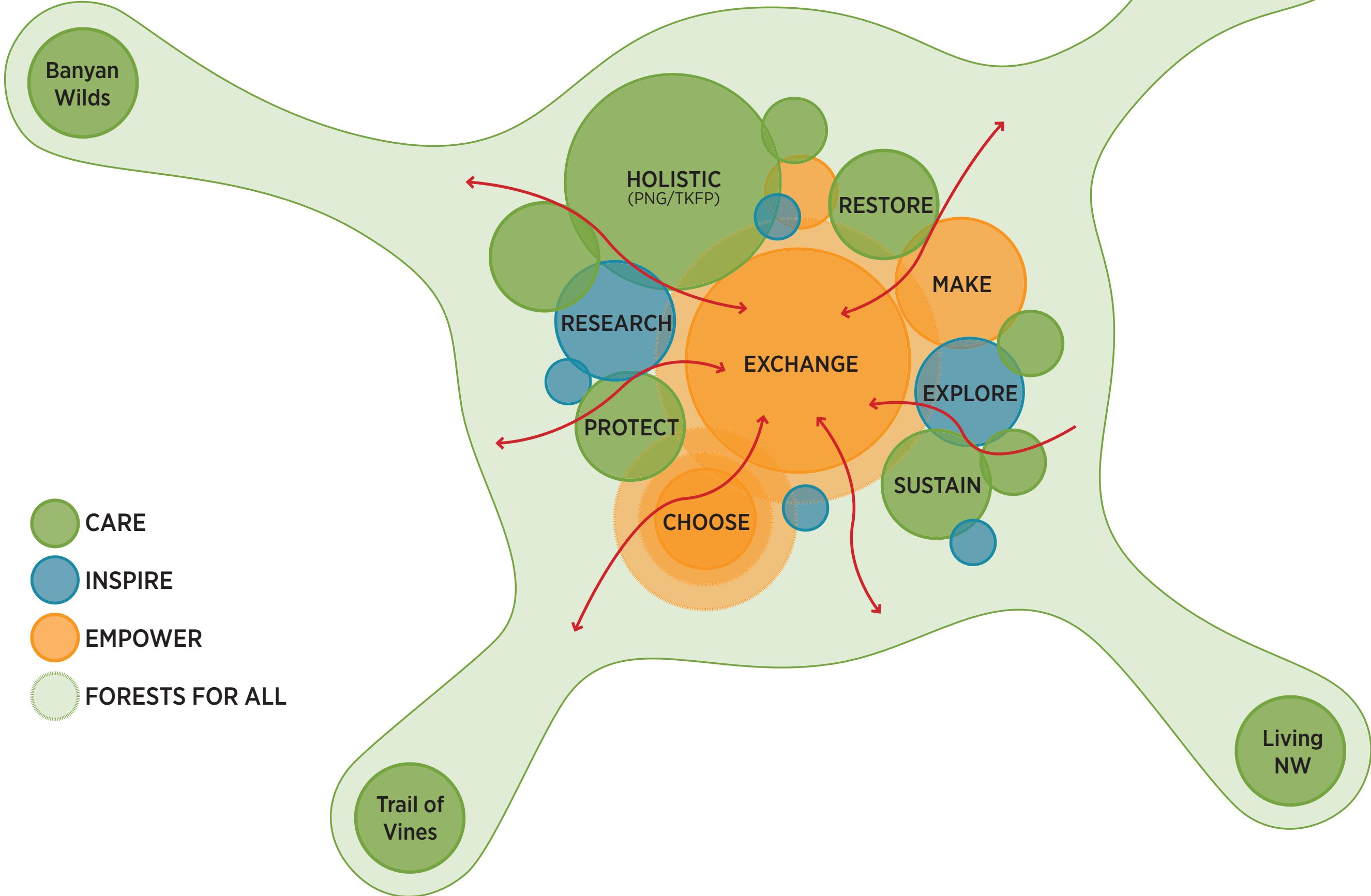

CONCEPT











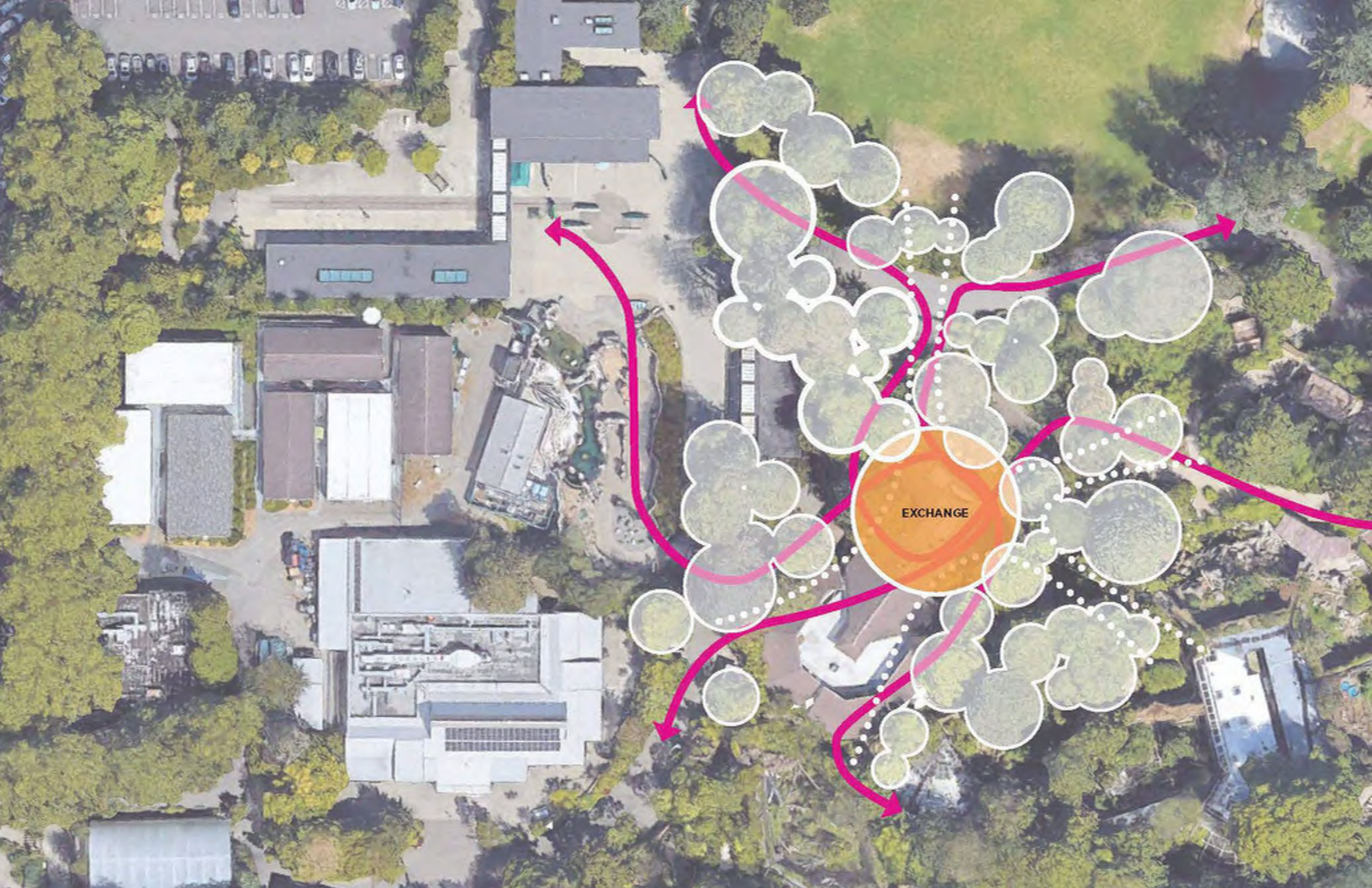

EXCHANGE



CHOOSE

RESEARCH

EXCHANGE

EXPLORE

MAKE

DESIGN CONCEPT

Protect existing trees

Canopy roof

Multiple site linkages

Exchange at center

3-dimensional guest and animal movement





Center for Wildlife Conservation

West Entry Plaza
Q4C West

West Plaza

Penguin Exhibit

Visitor Viewing Area

Constructed Wetlands

Jaguar Viewing

Jaguar House

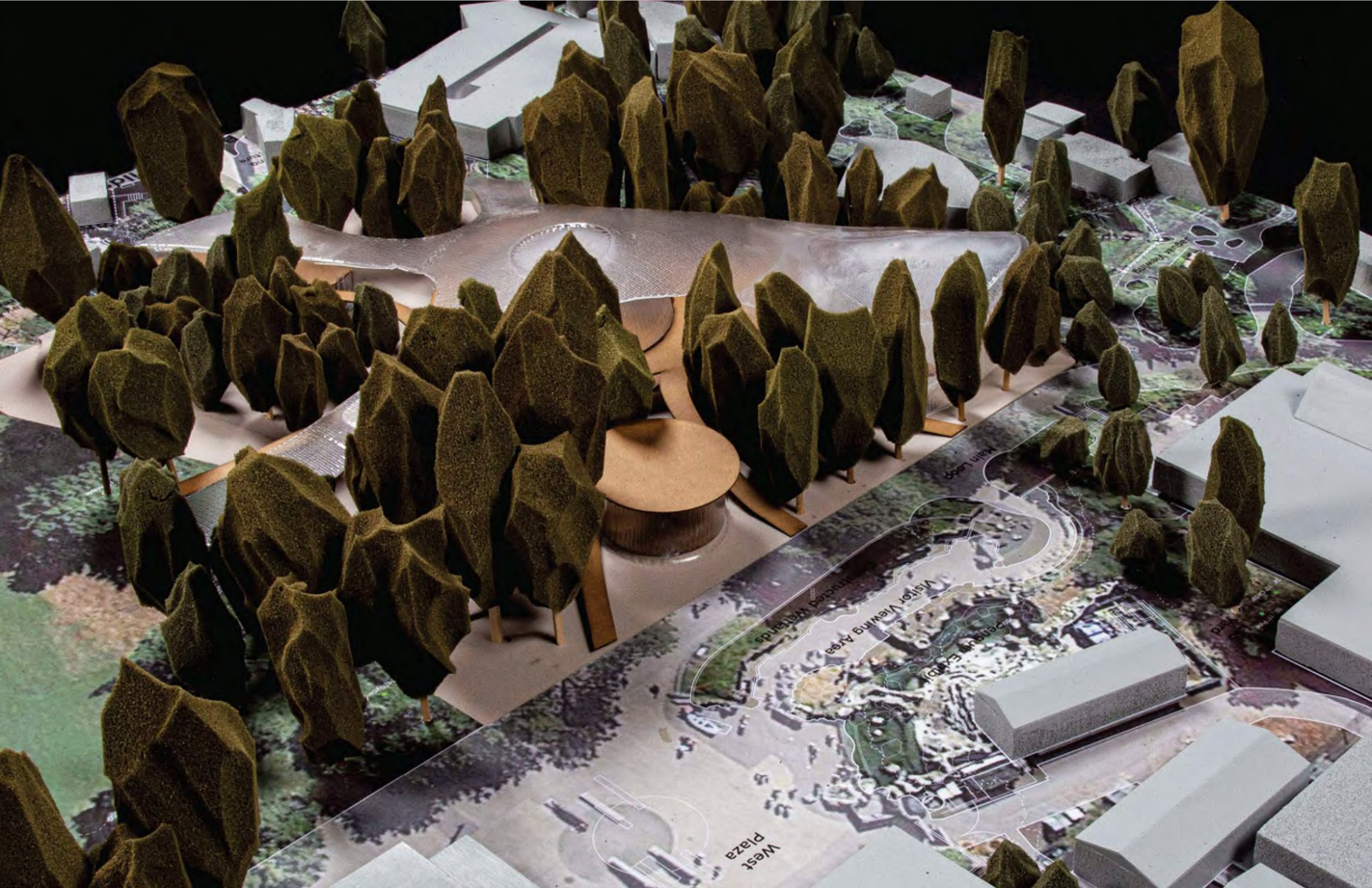



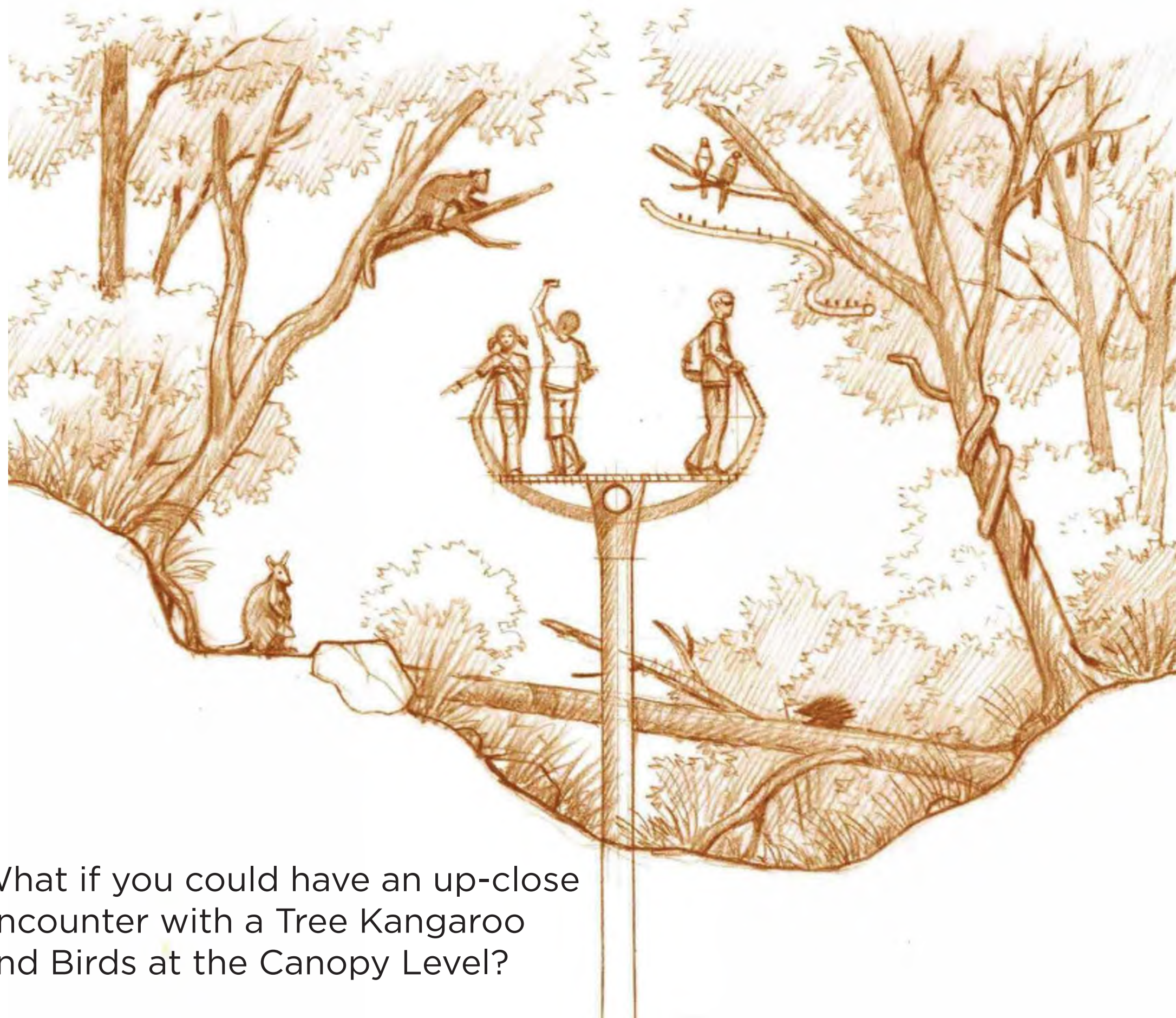

What if you could have an up-close encounter with a Tree Kangaroo and Birds at the Canopy Level?



Immersive forest floor experiences and micro-habitat exploration zones. Utilize the existing grove and reforest the site.

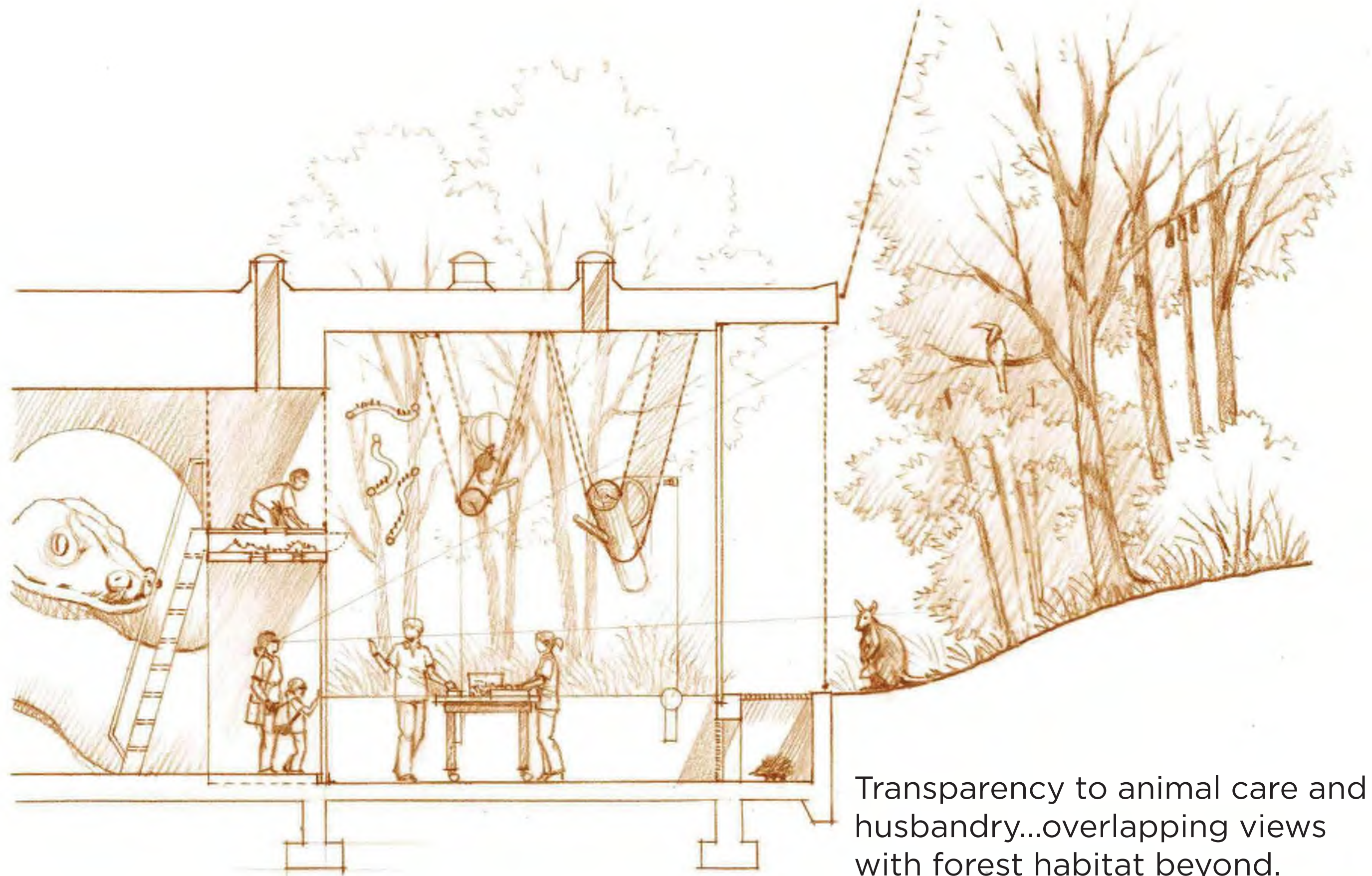

A maker space engaging with animal care and activity stations

Transparency to animal care and husbandry...overlapping views with forest habitat beyond. Located where animals naturally spend time.

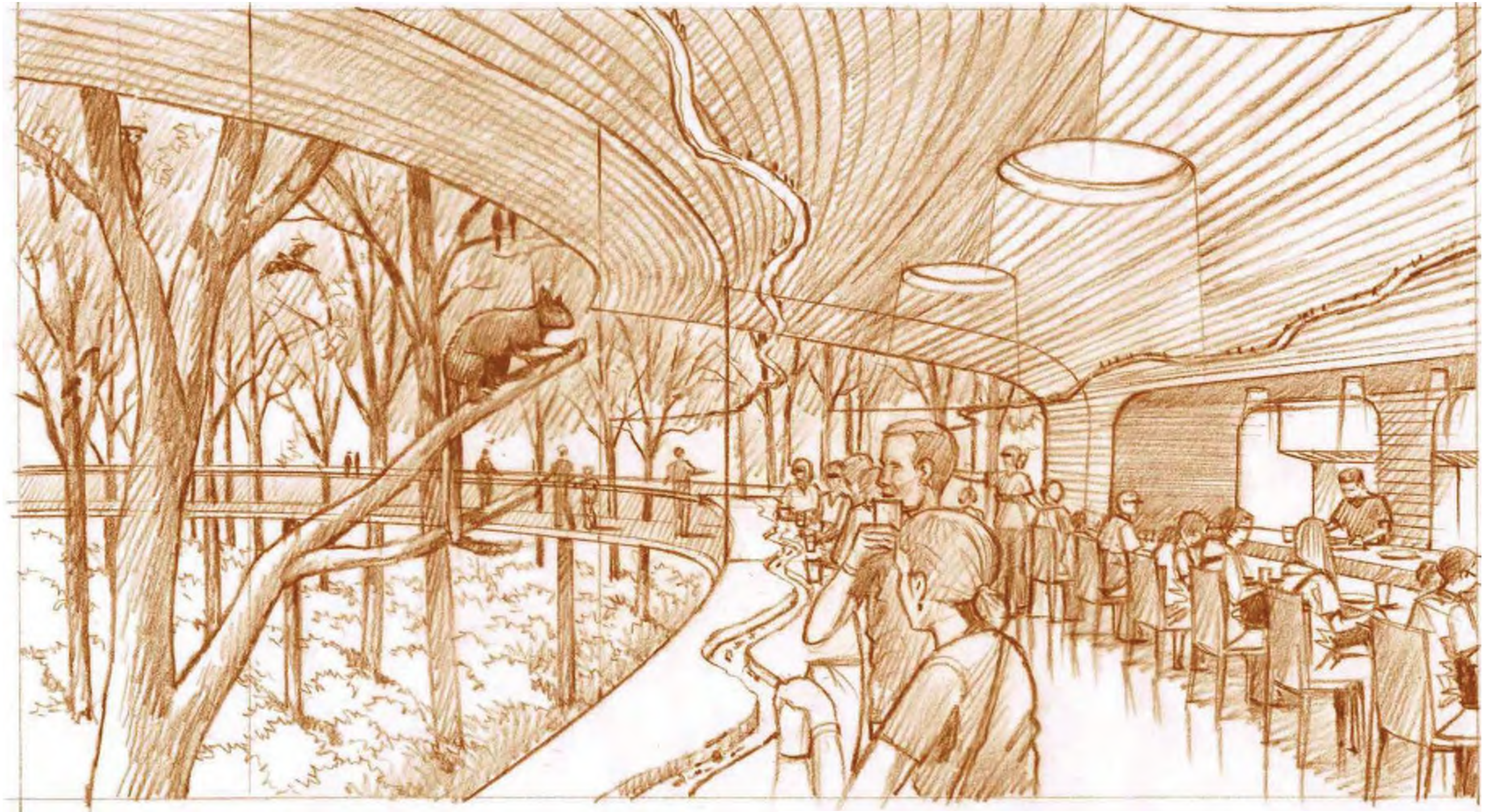

A weaving of forest, habitats, and commerce
in an engaging participatory setting



Being in a community gathering space
with habitat theater beyond



Creating a layered experience that is woven into the existing trees

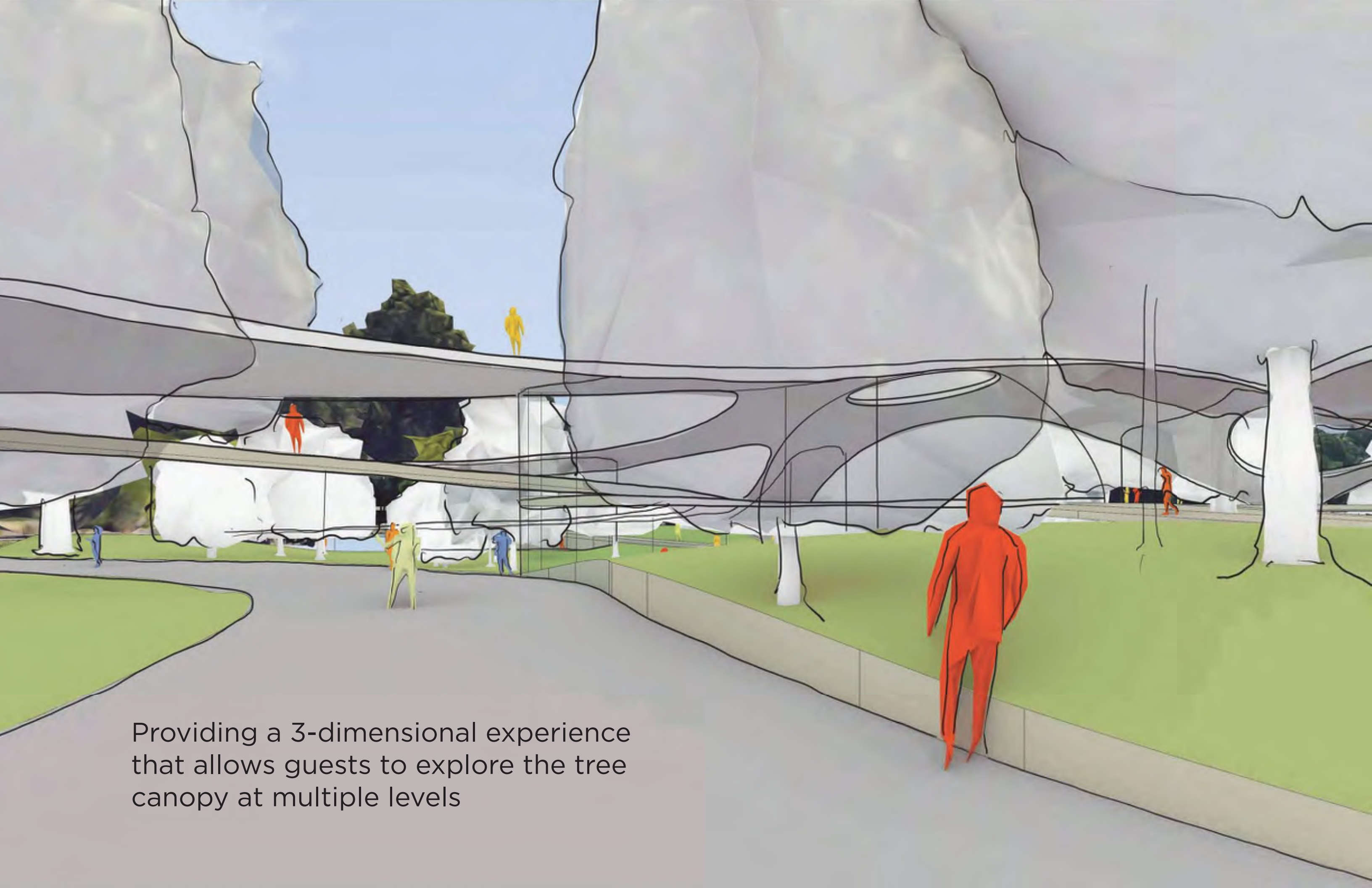

Providing a 3-dimensional experience that allows guests to explore the tree canopy at multiple levels



Exploring the site from multiple pathways that each offer different perspectives

**Five years after this experience opens,
what has been its impact?**



