

Expanded Site Plan:
Excerpt from NW Rooms upper Breezeway Design
Improvements stamped drawing set

SPECIAL DISTRICT AND LANDMARK REVIEW
This page: Approved
By Erin Doherty 10/12/20

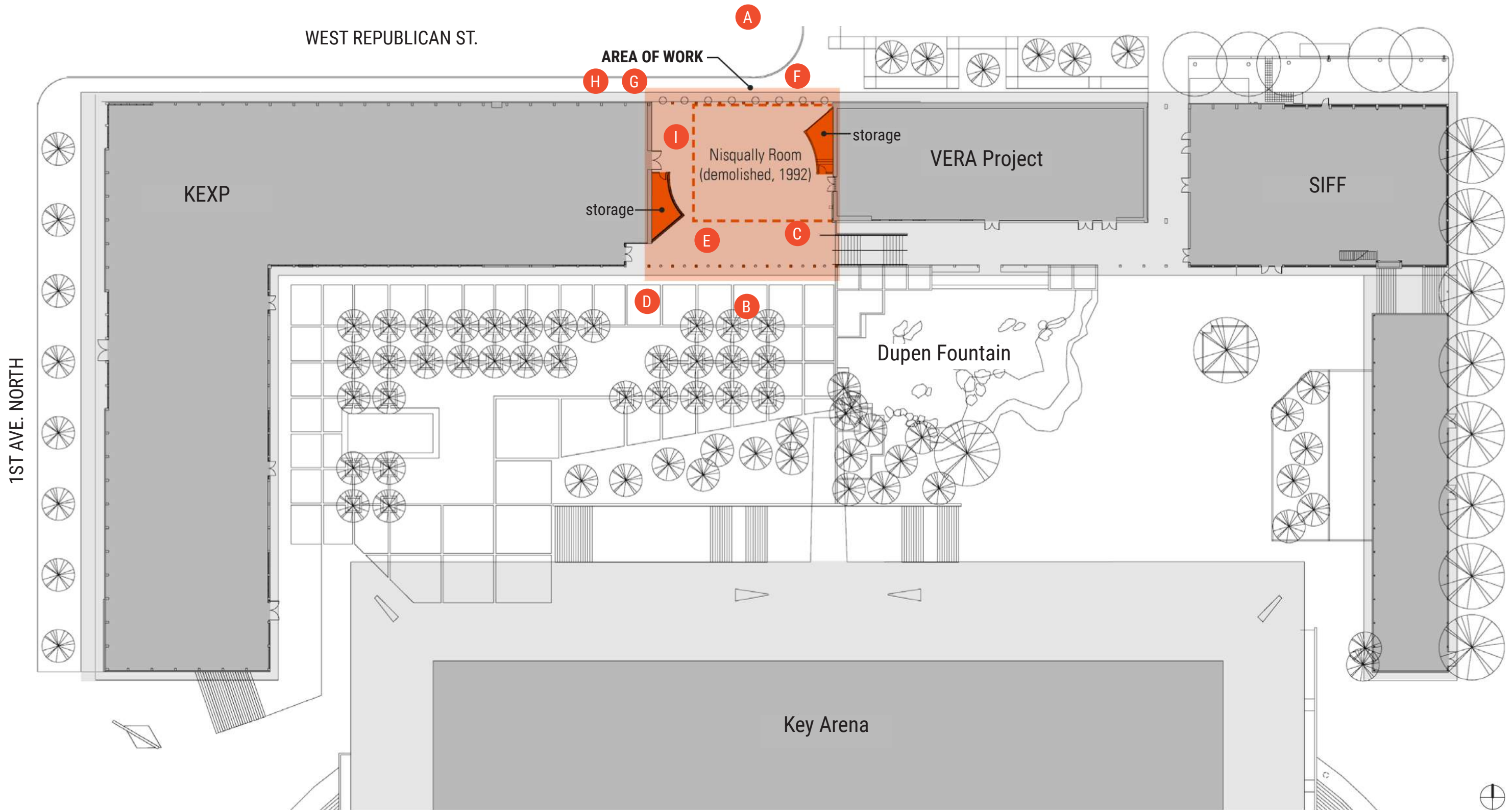

SEATTLE CENTER NORTHWEST ROOMS - BREEZEWAY UPGRADE / ALTERATION



305 HARRISON STREET
 SEATTLE, WA 98109-4695
 TEL. (206) 684-7117
 FAX. (206) 386-9091
 WWW.SEATTLECENTER.COM

APPROVED BY SEATTLE CENTER

Chief Capital Project Coordinator _____
 Date _____

PROJECT _____

SEATTLE CENTER NORTHWEST ROOMS
 BREEZEWAY UPGRADE

CONSULTANT _____



REVISIONS

NO.	DATE	DESCRIPTION
1	1/9/2020	95% SD
2	2/6/2020	100% SD
3	4/1/2020	50% DD
4	8/13/2020	PERMIT SET
5	8/24/2020	DRAFT 2 PERMIT SET

APPROVALS

DESIGNED: _____

DRAWN: _____

CHECKED: _____

APPROVED: _____

SCALE: _____

SHEET TITLE

SITE PLAN

SHEET NUMBER

A100

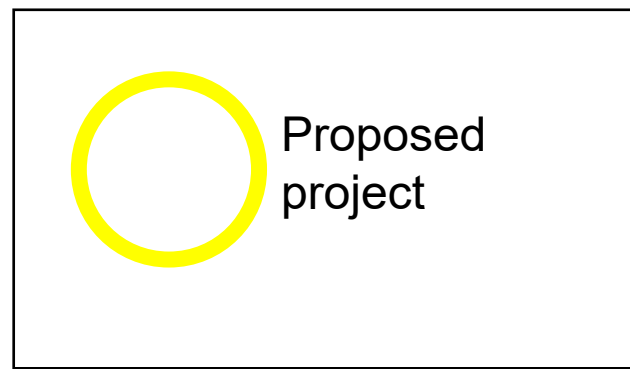

PLAN LEGEND

- PROPERTY LINE
- (E) WALL TO REMAIN
- (E) BUILDINGS TO REMAIN
- AREA OF UPGRADE - ALTERATION WORK
- TO BE DEMOLISHED

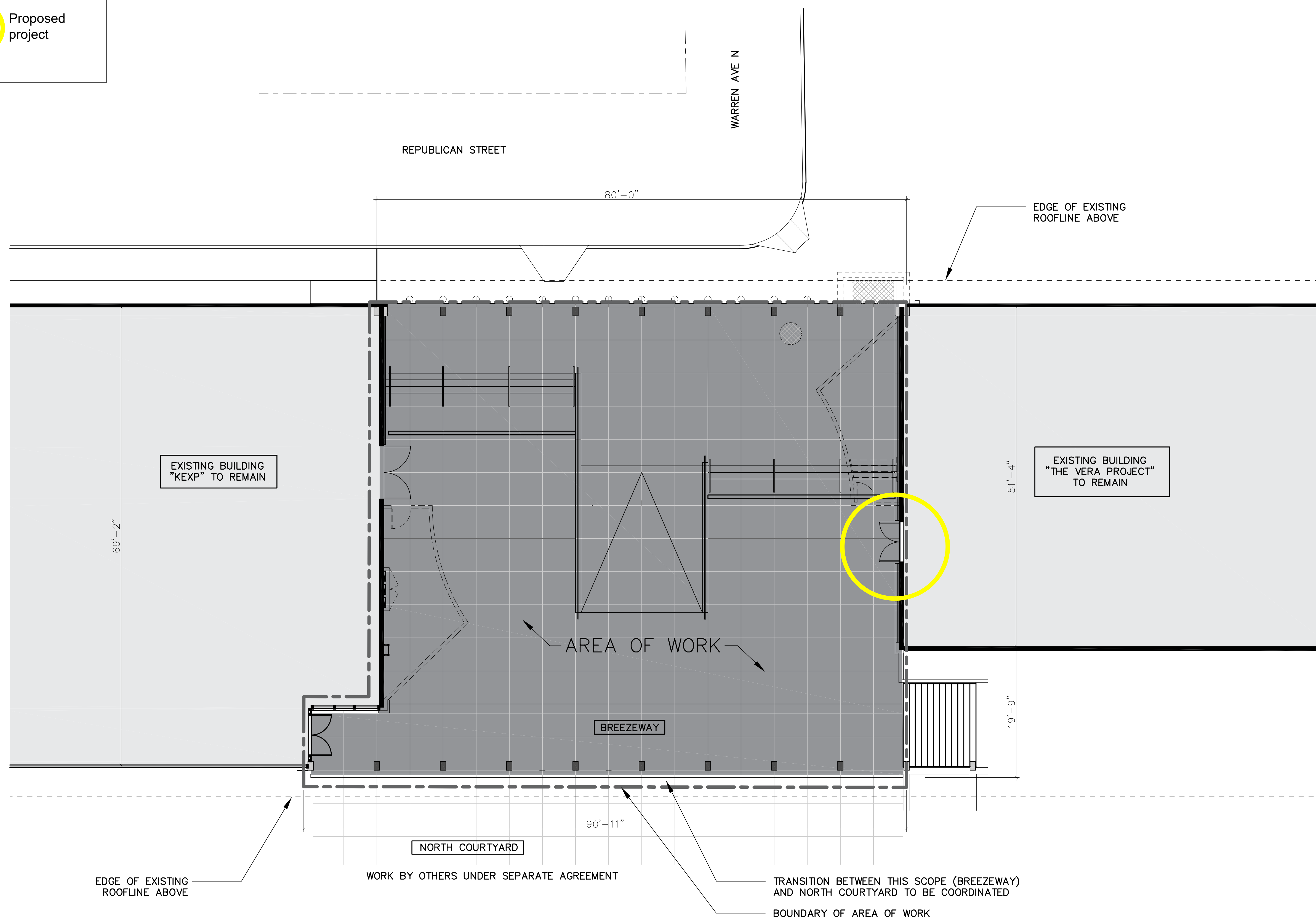

① **SITE PLAN**
 SCALE: 1/8" = 1'-0"

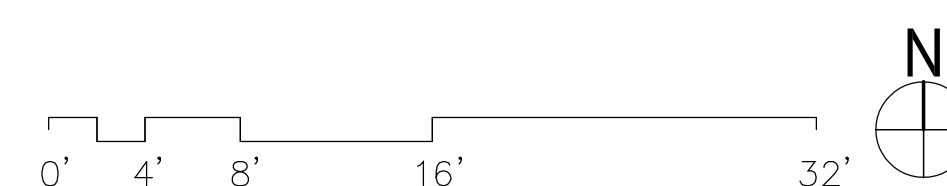

DCI
 STAMP

VERA BREEZEWAY SIGNAGE



A | PREVIOUSLY EXISTING SIGN



B | PREVIOUSLY EXISTING SIGN

VERA BREEZEWAY SIGNAGE - ALTERNATIVES CONSIDERED



C | 3M WRAP (CONTINUOUS ADHESIVE SHEET)



D



E | ADHESIVE CUT VINYL



F

VERA BREEZEWAY SIGNAGE - PREFERRED OPTION



G | ADHESIVE CUT VINYL



H

| ADHESIVE CUT VINYL LOGO APPLIED DIRECTLY TO WALL PANEL SURFACE. WHEN REMOVED PROPERLY WITH APPLIED HEAT, THE RISK OF PAINT DAMAGE IS LOW.

VERA BREEZEWAY DOORS



I | EXISTING



J | PROPOSED - WHITE CUT VINYL ON GLASS (INTERIOR) TO ALLOW FOR INCREASED VISIBILITY