



**Seattle  
Public  
Utilities**



**King County**

## Ship Canal Water Quality Project

### Ballard Conveyance Design Contract Info Session

**Richard Fernandez**

**Ship Canal Water Quality Project  
Project Manager**

**Eset Alemu**

**Ship Canal Water Quality Project  
Project Engineer**

**Katia Garcia**

**Environmental Justice and Service Equity  
WMBE Manager**

**November 2, 2018**





**Seattle  
Public  
Utilities**



**King County**

## **Ship Canal Water Quality Project**

# **Agenda**

- **Welcome**
- **Ship Canal Water Quality Project Overview**
- **WMBE Inclusion**
- **Ballard Conveyance Overview**
- **Key Project Risks**
- **Design Contract Tasks**
- **Questions**
- **Networking**

# Questions

- 1. What interests you about the Ship Canal Water Quality Project and Ballard Conveyance?**
- 2. What do you hope to get from and give to the project?**

# **Ship Canal Water Quality Project Overview**

# Ship Canal Water Quality Program

Keeps over **80 million** gallons of combined sewage overflow out of the Ship Canal, Salmon Bay, and Lake Union each year



Seattle  
Public  
Utilities



King County



# SCWQP Locations

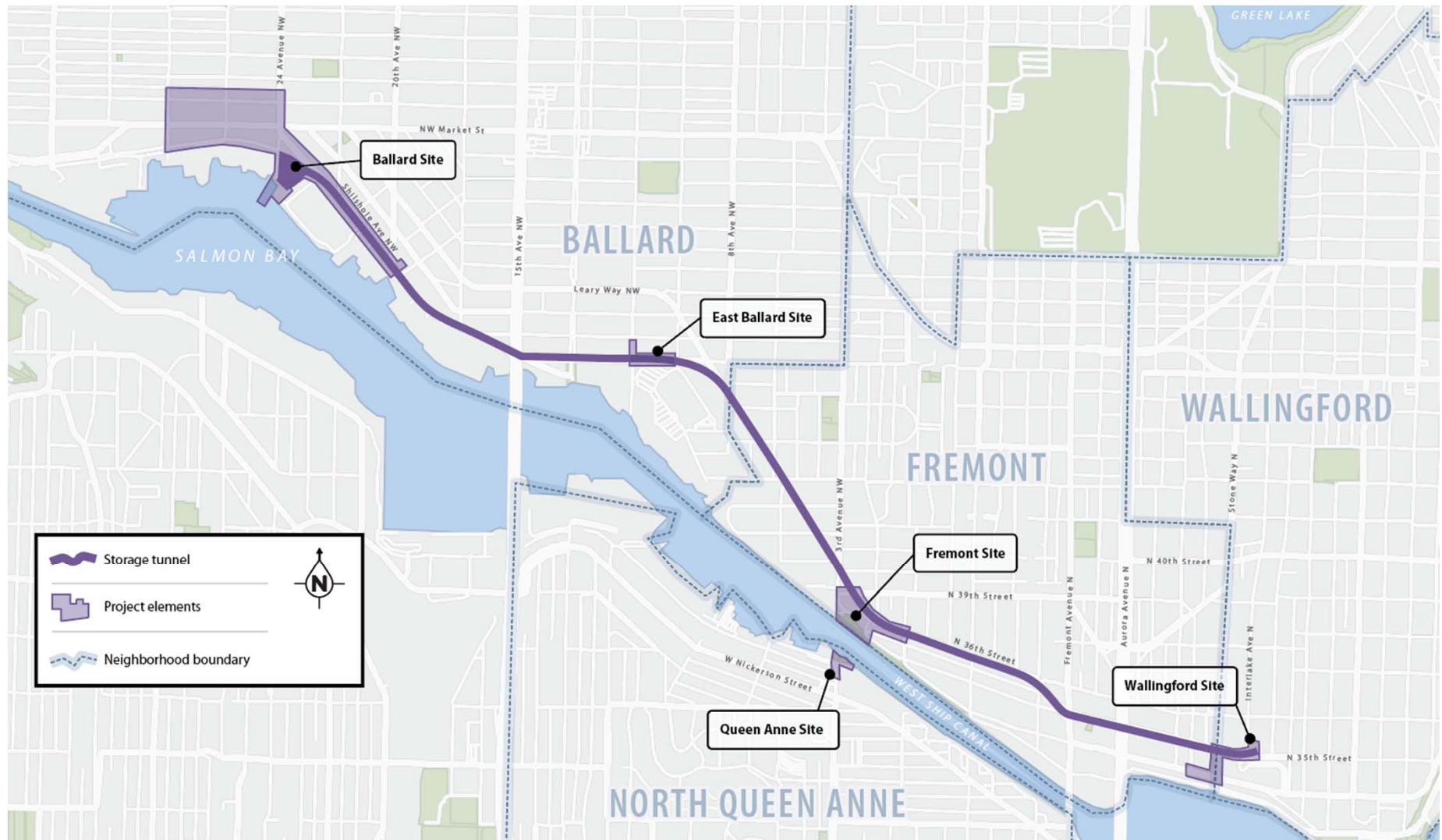



Seattle  
Public  
Utilities



King County

## Ship Canal Water Quality Project

# SCWQP Schedule

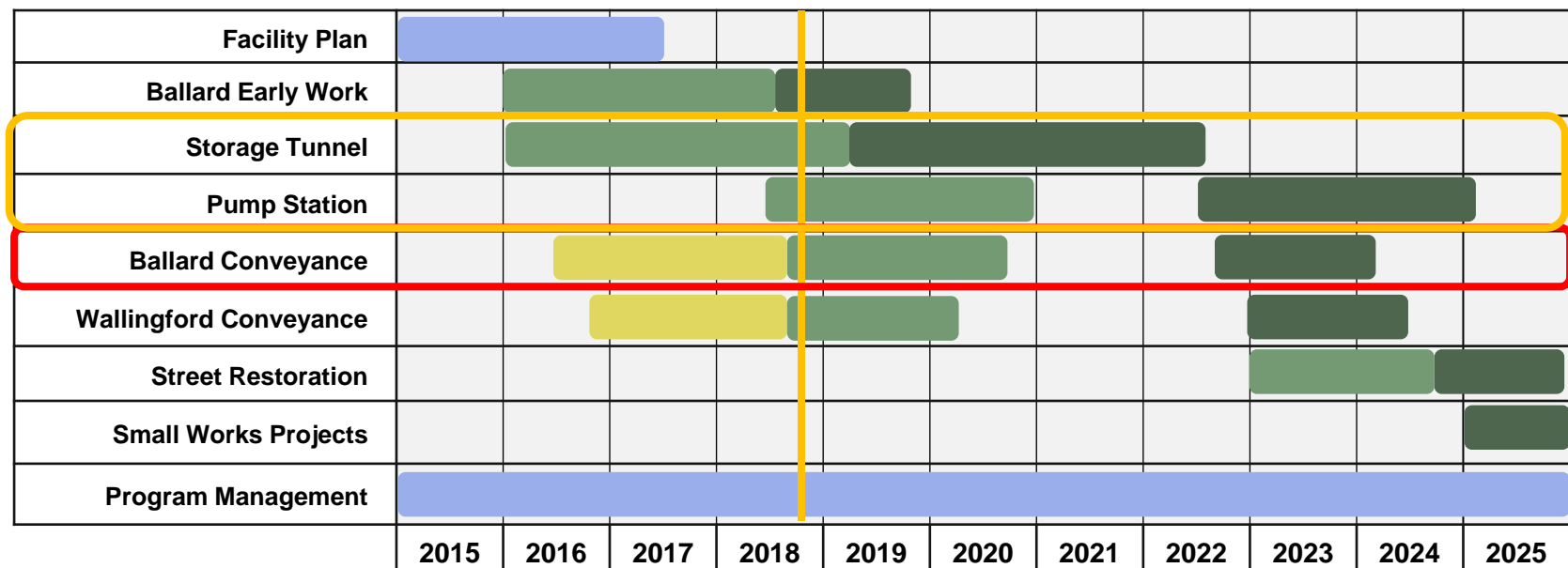

Planning and Management



Options Analysis



Design



Construction





**Seattle  
Public  
Utilities**



**King County**

**Ship Canal Water Quality Project**

# Consent Decree Milestones

Deadline	Description
March 31, 2020	Draft Plans and Specifications
December 31, 2020	Final Plans and Specifications
December 31, 2024	Construction Complete
December 31, 2025	Operational





**Seattle  
Public  
Utilities**



**King County**

**Ship Canal Water Quality Project**

## **SCWQP Costs**

**Total Ship Canal Project Cost = \$570M at 70% confidence**

Project is within the Adopted Budget and approved by Council

Ballard Conveyance Project is within the \$570M

# **WMBE Inclusion**

# WMBE Inclusion

- Race & Social Justice Initiative and Contracting Equity
- Tools & Opportunities:
  - WMBE Inclusion Plan
  - Online Business Directory
  - Outreach Events
- Reporting & Accountability:
  - B2GNow
  - Prompt Payment

# WMBE Consultant Inclusion Plan

- Aspirational WMBE Goals
- Core Work vs. Non-core Work
- Past Performance
- Inclusion Strategies
  - Partnering
  - Mentoring



City of Seattle

WMBE Inclusion Plan – Consultant Contracts  
(SMC CH.20.42)

Contract Number and Title	
Consultant Name	
Consultant Contact Info.	(Name, Phone, e-mail) <input type="text"/> <input type="text"/> <input type="text"/>
Original Submittal Date	
Revision Version Number	
Revision Version Date	

You may add pages or separate pages into a more readable format.

The Seattle Municipal Code (SMC) and the Mayor's Executive Order direct inclusion of women and minority firms in City contracting. This form must be completed in full as part of your solicitation response. Failure to submit the form may result in rejection of your solicitation as non-responsive and your firm rejected from consideration. The information must be consistent with team assignments elsewhere in your solicitation response. During negotiations before contract execution, the City may negotiate scope and teaming; a revised WMBE Inclusion Plan is likely appropriate and becomes the contractually binding version. Carefully read all instructions embedded and on the back of this form. In any event, this form is required for all consultant contracts above \$305,000. If you are responding to a Request for Proposal or a Request for Qualifications above \$305,000 in value, this form will be required with your submittal. If you are working directly with the department and it is not through a formal solicitation process, you will still have a deadline for submittal before the contract is awarded.

## 1. Aspirational WMBE Goals

In the box below, state the aspirational WMBE goals you intend to achieve for this contract including all phases and amendments. While the goals are aspirational, good faith efforts to develop and achieve goals are mandatory. Goals developed in good faith are considered attainable with good faith efforts. A contract amendment may require revisiting this WMBE Inclusion Plan to consider changes that may affect WMBE utilization (see Instructions). WMBE primes can include self-performance in goals below. Do not provide a range. If you identify Core Work commitments on page 2, this percentage must be no less than the Core Work commitments.

Estimated percentage of the total contract value to Women Owned firms (Firms that are Women Owned and Minority Owned are denoted in the MBE category line below)	<input type="text"/> %
Estimated percentage of the total contract value to Minority Owned firms	<input type="text"/> %
Overall Contract Aspirational WMBE Goal	<input type="text"/> %



Seattle  
Public  
Utilities



King County

## Ship Canal Water Quality Project

# WMBE Consultant Inclusion Plan

- Aspirational Goals
- Core Work vs. Non-core Work
- Partnering/Inclusion Strategies
- Mentoring

 City of Seattle  
WMBE Inclusion Plan – Consultant Contracts  
(SMC CH. 29.42)

Contract Number and Title	
Consultant Name	
Consultant Contact Info.	(Name, Phone, e-mail) <input type="text"/> <input type="text"/> <input type="text"/>
Original Submittal Date	
Revision Version Number	
Revision Version Date	

You may add pages or separate pages into a more readable format.  
The Seattle Municipal Code (SMC) and the Mayor's Executive Order direct inclusion of women and minority firms in City contracting. This form must be completed in full as part of your solicitation response. Failure to submit the form may result in rejection of your solicitation as non-responsive and your firm rejected from consideration. The information must be consistent with team assignments elsewhere in your solicitation response. During negotiations before contract execution, the City may negotiate scope and teaming; a revised WMBE Inclusion Plan is likely appropriate and becomes the contractually binding version. Carefully read all instructions embedded and on the back of this form. In any event, this form is required for all consultant contracts above \$305,000. If you are responding to a Request for Proposal or a Request for Qualifications above \$305,000 in value, this form will be required with your submittal. If you are working directly with the department and it is not through a formal solicitation process, you will still have a deadline for submittal before the contract is awarded.

**1. Aspirational WMBE Goals**  
In the box below, state the aspirational WMBE goals you intend to achieve for this contract including all phases and amendments. While the goals are aspirational, good faith efforts to develop and achieve goals are mandatory. Goals developed in good faith are considered attainable with good faith efforts. A contract amendment may require revisiting this WMBE Inclusion Plan to consider changes that may affect WMBE utilization (see Instructions). WMBE primes can include self performance in goals below. Do not provide a range. If you identify Core Work commitments on page 2, this percentage must be no less than the Core Work commitments.

Estimated percentage of the total contract value to Women Owned firms (Firms that are Women Owned and Minority Owned are denoted in the MBE category line below)	<input type="text"/> %
Estimated percentage of the total contract value to Minority Owned firms	<input type="text"/> %
Overall Contract Aspirational WMBE Goal	<input type="text"/> %

# **Ballard Conveyance Overview**



# Ballard Conveyance Project

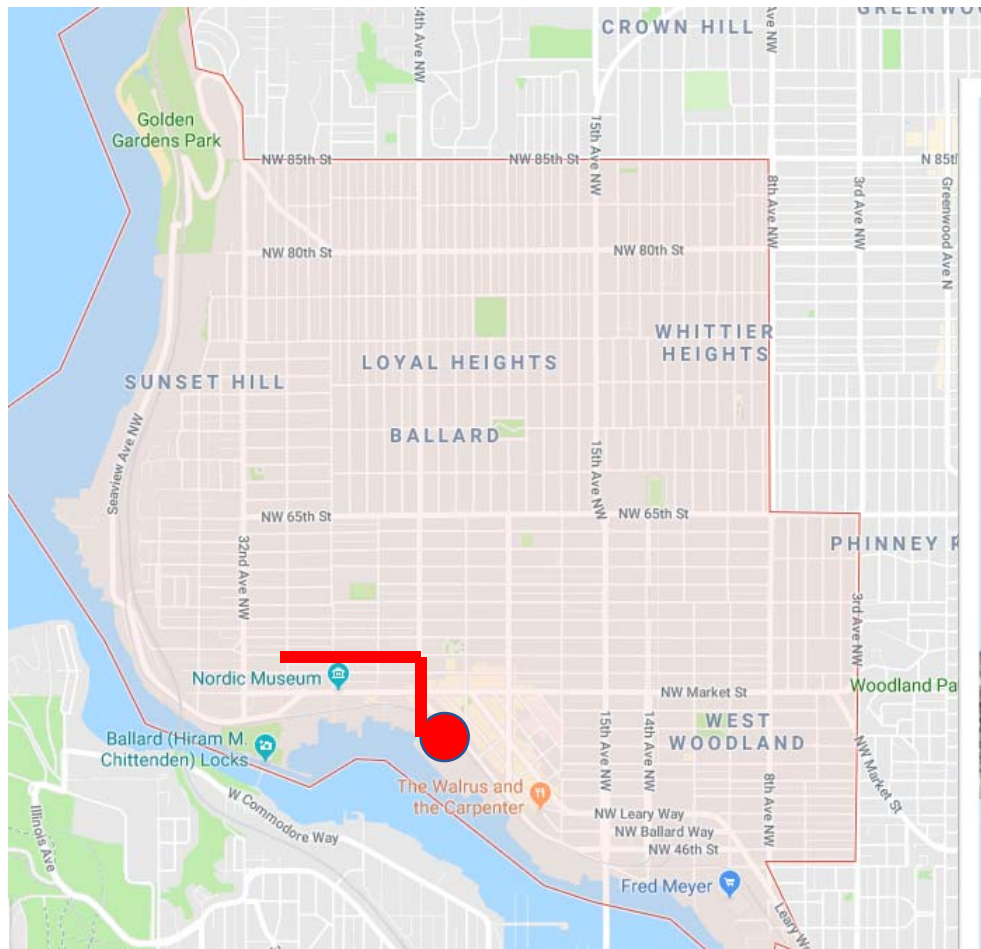

## CONVEYANCE SYSTEMS FOR

- BASIN 152
- BASIN 150/151

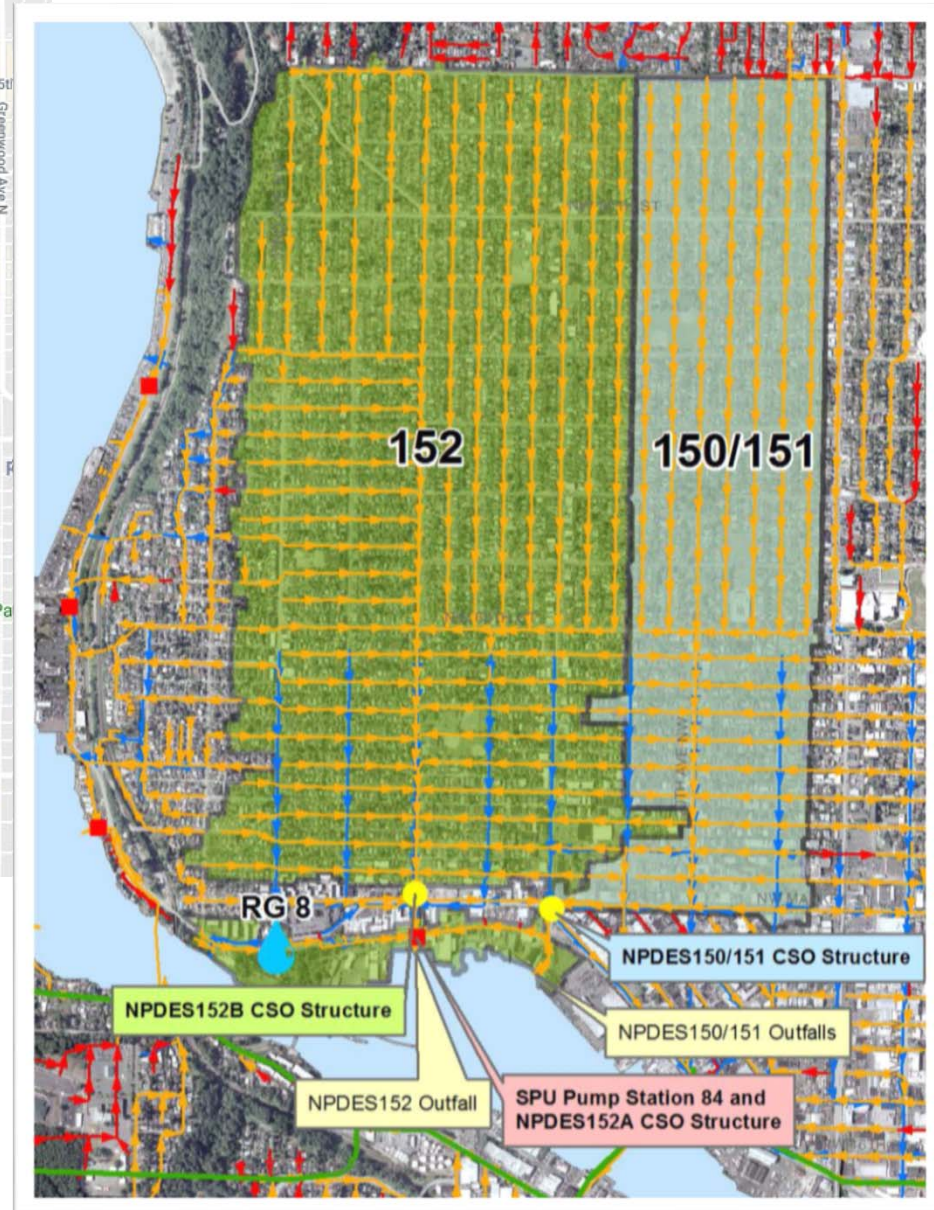



# Ballard Conveyance Project

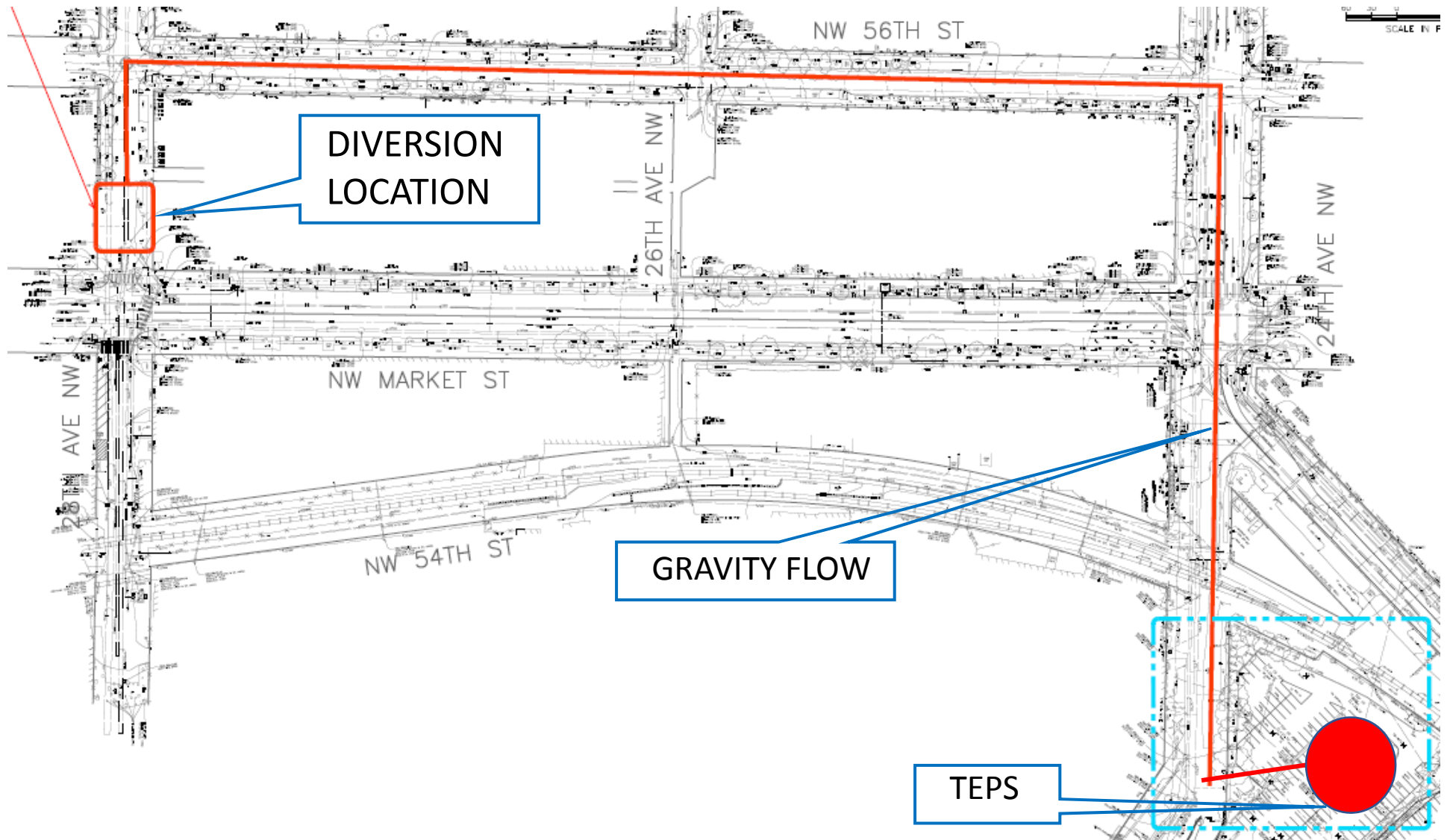

# Ballard Conveyance Project

## CONVEYANCE SYSTEM CHARACTERISTICS

- Peak Flows – 130MGD
- Structures
  - Diversion structure
  - Gate Vault
  - Maintenance Holes
- Trenchless pipe installation

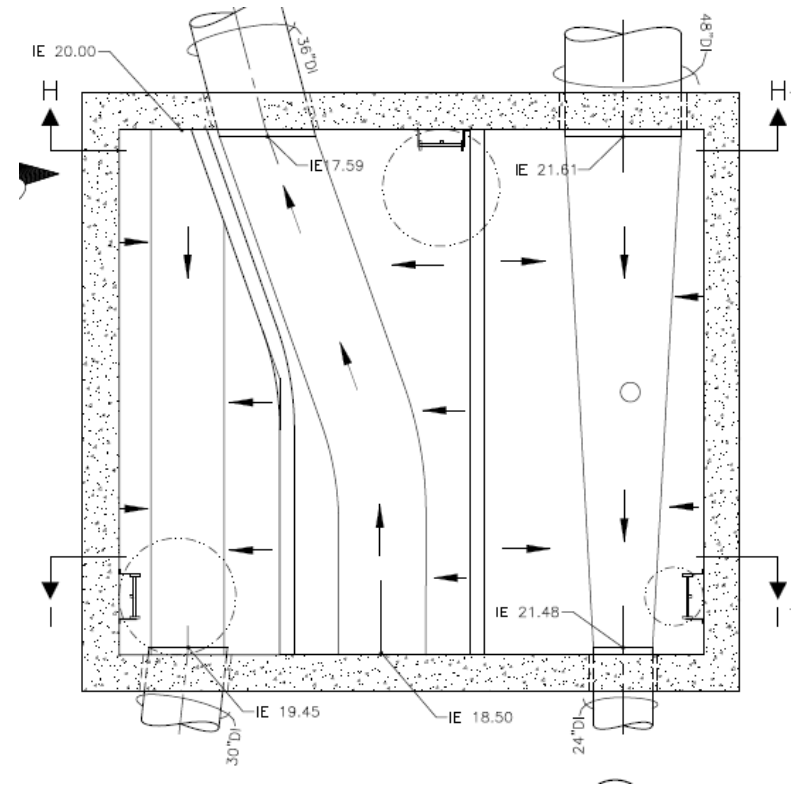

# Ballard Conveyance Project

## UPSTREAM END

- Residential (NW 56<sup>th</sup> St + 28<sup>th</sup> Ave NW)





# Ballard Conveyance Project

## PROJECT AREA

- Residential (NW 56<sup>th</sup> St)





# Ballard Conveyance Project

## PROJECT AREA

- Commercial / High Traffic zone (24<sup>th</sup> Ave NW)

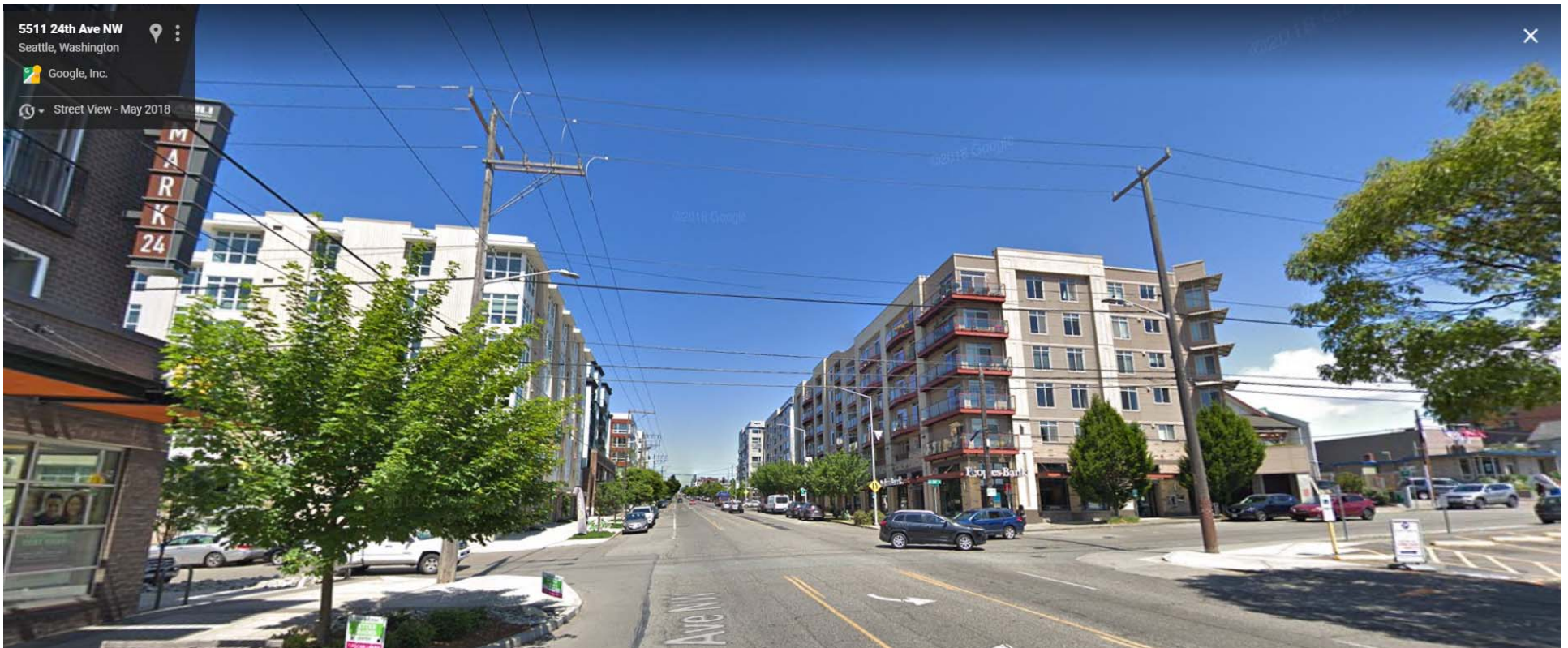

# Ballard Conveyance Project





# Ballard Conveyance Project





# Key Project Risks

1. Constructability at NW 56<sup>th</sup> and 24<sup>th</sup> Ave NW
2. Meeting consent decree milestones
3. Unplanned interventions
4. Subsurface conditions
5. Utility Coordination

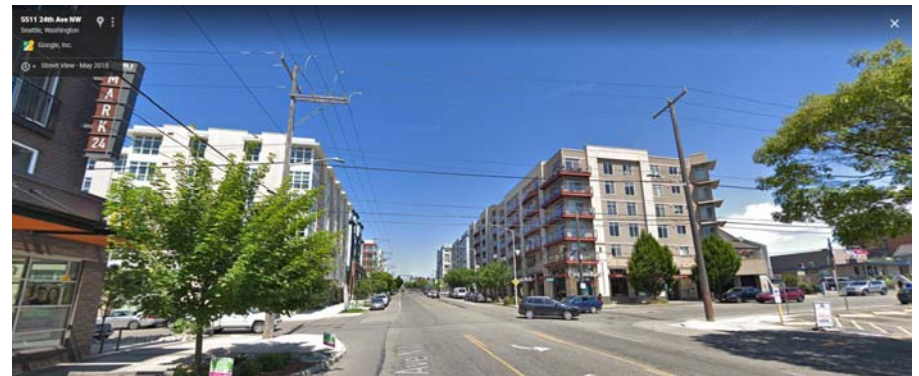

# Ballard Conveyance Schedule

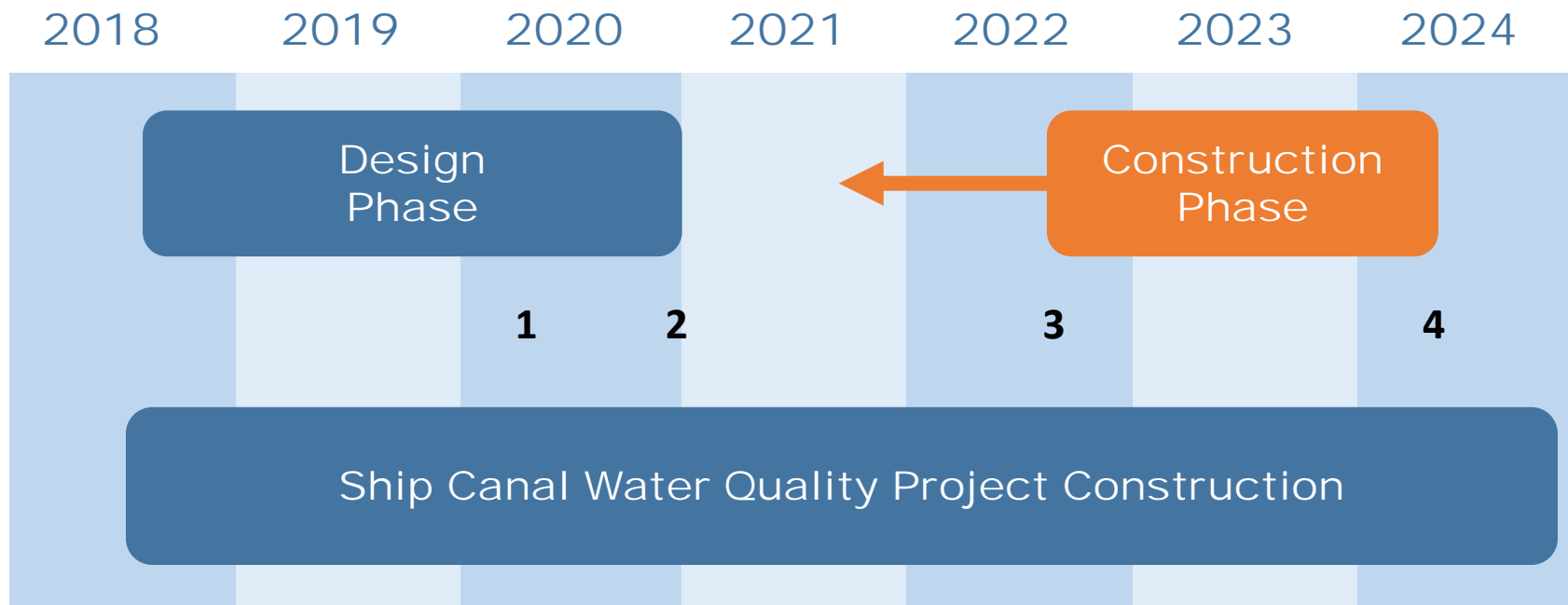

1. **03/31/20** Submit Draft Plans and Specs (90%) to Ecology
2. **12/31/20** Submit Final Plans and Specs (100%) to Ecology
3. **09/2022** Storage Tunnel Demob from West Shaft Site
4. **04/2024** Construction Complete

# **Design & Engineering Services Contract**

# Major Deliverables

- Project Management and Quality Control
- Geotechnical Investigation, Reports, and TMs
- Basis of Design
- Value Engineering Study Participation
- 30, 60, 90, 100% Design Submittals
- Construction Cost Estimates
- Final Contract Documents (revised 100% deliverables for bidding purposes)
- Operations and Maintenance Plan
- Bid Support
- Permit Support
- Public Outreach Support
- Engineering Services During Construction (Planned Amendment)

# Task 1: Project Management

- Develop a Project Management Plan
- Develop a Quality Management Plan
- Prepare Monthly Progress Reports
- Communications with SPU
- Track and control schedule and budget
- Manage the Consulting Team



# Pre-Design Tasks

**Task 2:** Review Background Information and Existing Site Conditions

**Task 3:** Geotechnical Investigation and Reports

- Site Exploration Plan
- Geotechnical Investigation
- Geotechnical Data Report, Interpretive Technical Memoranda, and Baseline Report

**Task 4:** Initial Basis of Design





# Design Tasks<sup>1</sup>

**Task 5:** 30% Design

**Task 6:** Value Engineering

**Task 7:** 60% Design

**Task 8:** 90% Design<sup>2</sup>

**Task 9:** 100% Design<sup>3</sup>

**Task 10:** Final Contract Documents

**Task 16:** Physical Modeling

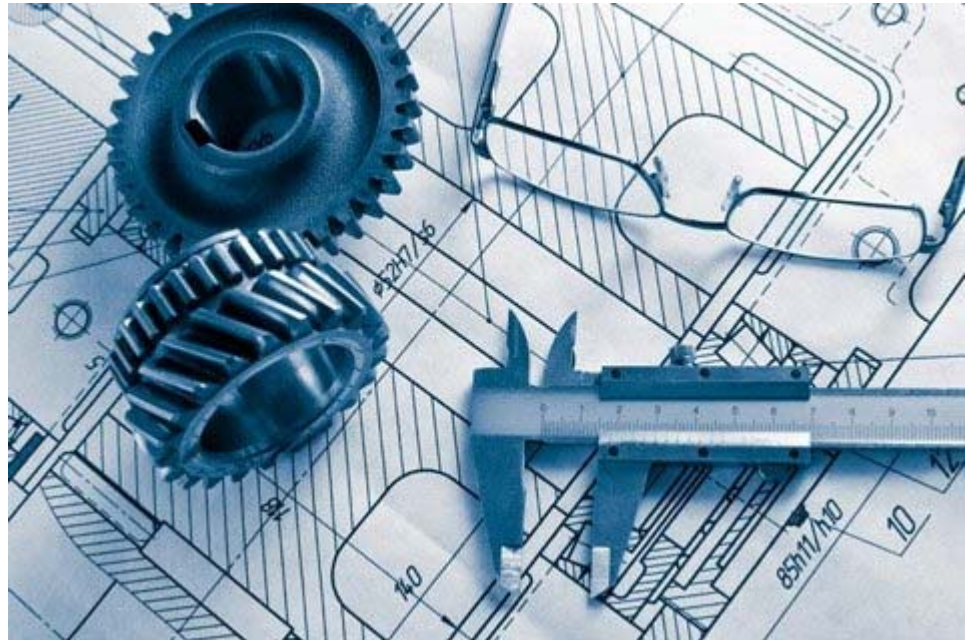

1 - All design tasks to conform to SPU's Design Standards and Guidelines available at <https://www.seattle.gov/util/Engineering/DSG/>

2 - Submit to Ecology Draft Plans and Specifications by 3/31/2020

3 - Submit to Ecology Final Plans and Specifications by 12/31/2020



# Support Tasks

**Task 11:** Bid Support

**Task 12:** Permit Support

**Task 13:** Public Outreach  
Support

**Task 15:** Utility Coordination

**Task 17:** Wallingford  
Conveyance Design Support



# Operations and Maintenance

## **Task 14:** O&M Plan

- O&M Workshop
- Rolled into SCWQP O&M Manual



# Procurement Schedule

<b>Task</b>	<b>Date</b>
<b>RFP Release/Advertisement</b>	11/19/2018
<b>Deadline for Questions</b>	12/6/2018
<b>Sealed Proposals Due to SPU</b>	12/18/2018
<b>Announcement of Selected Proposal</b>	1/30/2019
<b>Anticipated Contract Execution</b>	4/12/2019

**Questions?**