



Construction at 15th Ave E/E Harrison starts Friday, January 24

WORK AT 15TH AVE E AND E HARRISON ST

As soon as Friday, January 24, we will install accessible curb ramps, new curb bulbs, new raised crosswalks, and a new Rapid Flashing Beacon at this intersection. To complete this work safely and efficiently, E Harrison St will have temporary closures on the west side of the intersection (see map at right). Once we have completed work on the west side, we will transition to the east side of the intersection. Pedestrian access to businesses will be maintained at all times.

Thank you in advance for your patience during this work!

WATER MAIN REPLACEMENT WORK

This intersection will also undergo a water main replacement to provide a more resilient drinking water system. We will be working with Seattle Public Utilities (SPU) to complete this installation.

To complete this work, water outages must occur and will be coordinated by SPU with affected residents, businesses, and property owners in advance. For questions and more information, please **contact SPU at 206-386-1800**.

CONSTRUCTION SCHEDULE

Construction is anticipated to start as soon as late-January and last approximately 12 weeks. Work will occur Monday – Friday, 7 AM – 5 PM with **weekend work over two weekends: Saturday, February 1 – Sunday, February 2 and Saturday, February 7 – Sunday, February 8**. This schedule is weather dependent and subject to change.

WHAT'S NEXT

Once work at 15th Ave E/E Harrison St is complete, we will begin work at 15th Ave E/E Republican St. Please check the project webpage for updates and more details.

WHAT TO EXPECT

We will minimize construction impacts as much as possible. During construction, please expect:

- Weekday work hours of 7 AM – 5 PM, Monday through Friday. Weekend work hours 8 AM – 10 PM.
- Noise, vibrations, dust during work hours
- Temporary closure to through traffic of E Harrison St and 15th Ave E (see below)
- Signs and flaggers to direct people around the work zone, including temporary detours
- “No Parking” signs placed in work area 72 hours in advance of work starting
- Equipment and materials in the work area

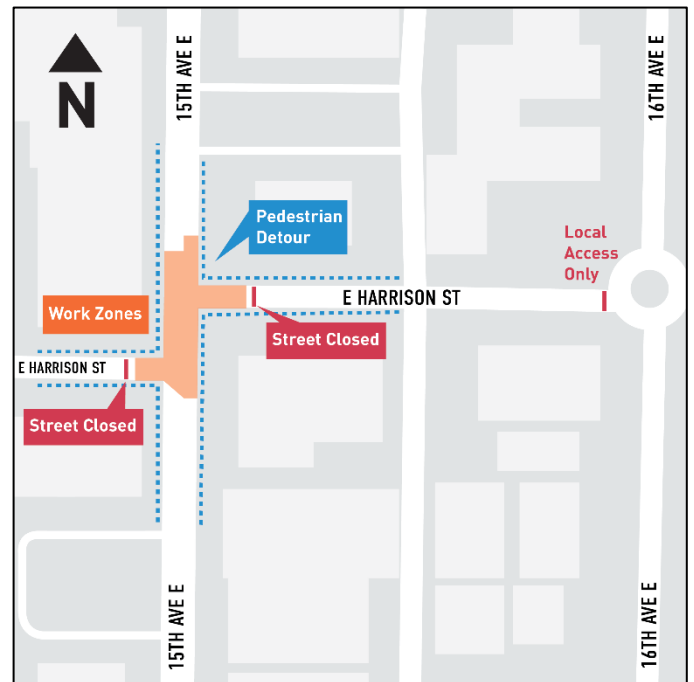

Map of work area including anticipated temporary detours and road closures.

If you need this information translated, please call 206-615-0786.

Si usted necesita esta información traducida al español por favor llame al 206-615-0786.

PROJECT CONTACT

(206) 257-2243 | LowellMeanySRTS@seattle.gov
www.seattle.gov/transportation/Lowell-Meany



Seattle Department of Transportation

