

WELCOME

Community drop-in session from 6:30 to 8:00 PM

Through our outreach, we've heard support for adding predictability and making it easier to walk around the intersection of 15th Ave S and S Columbian Way.

We've also heard concern about restricting the left turn at S Oregon St to go north without providing an alternative.

Tonight, we'll share project information and gather feedback on a revised project concept that we hope meets your needs.

Thanks for meeting with us.

TRANSPORTATION PLAN RECOMMENDATIONS FOR THE NEIGHBORHOOD

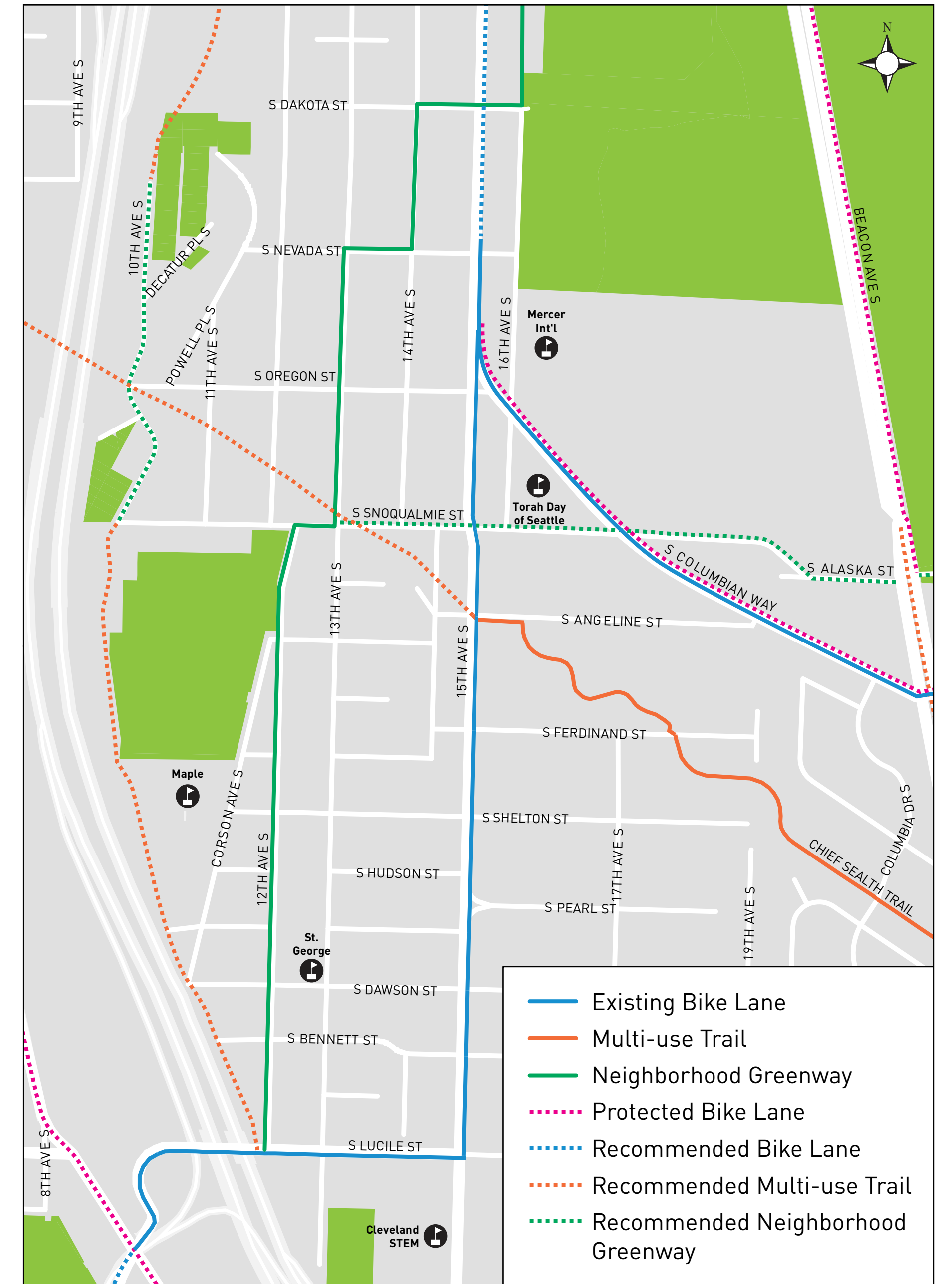
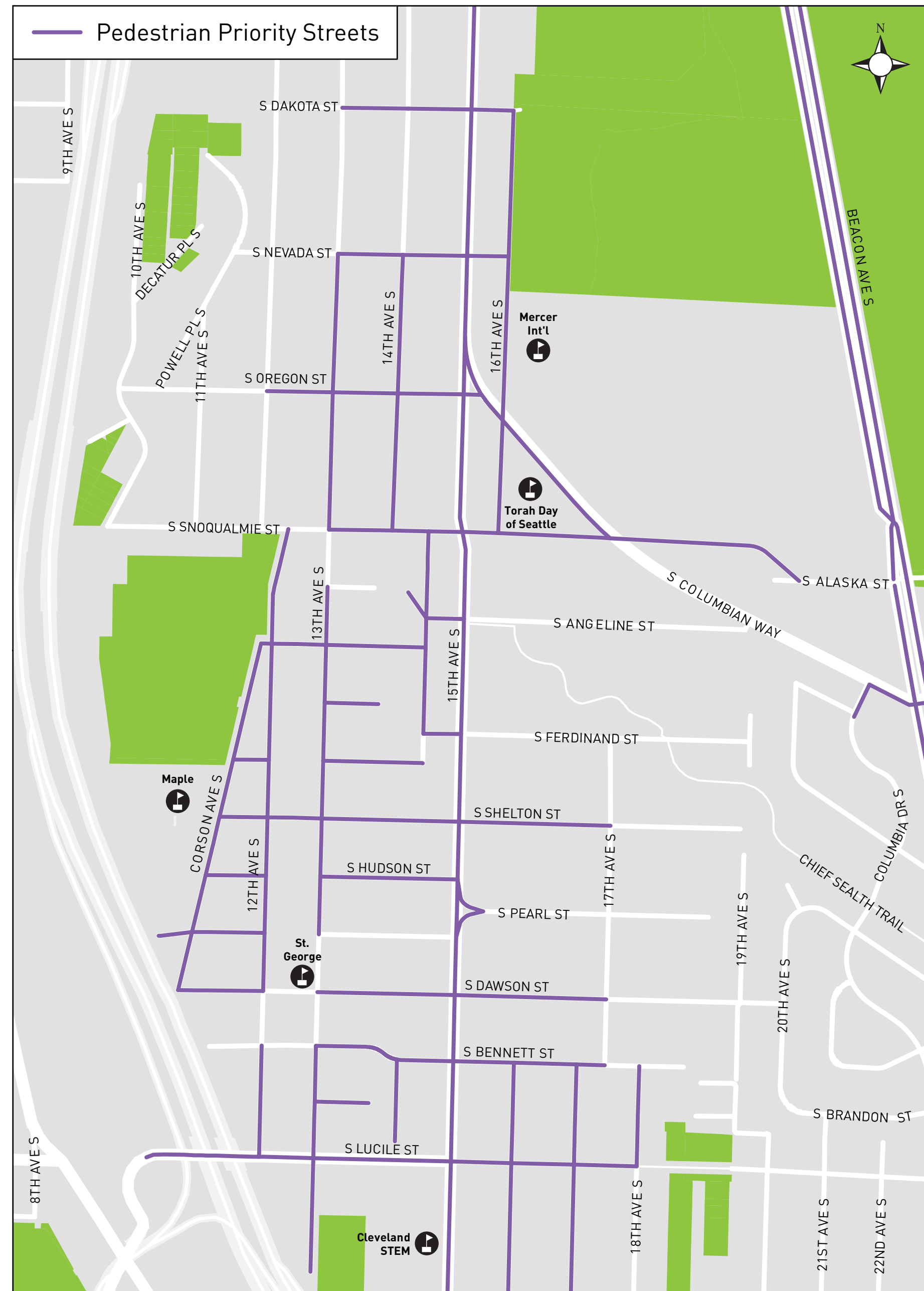

CURRENT PROJECT CONCEPT

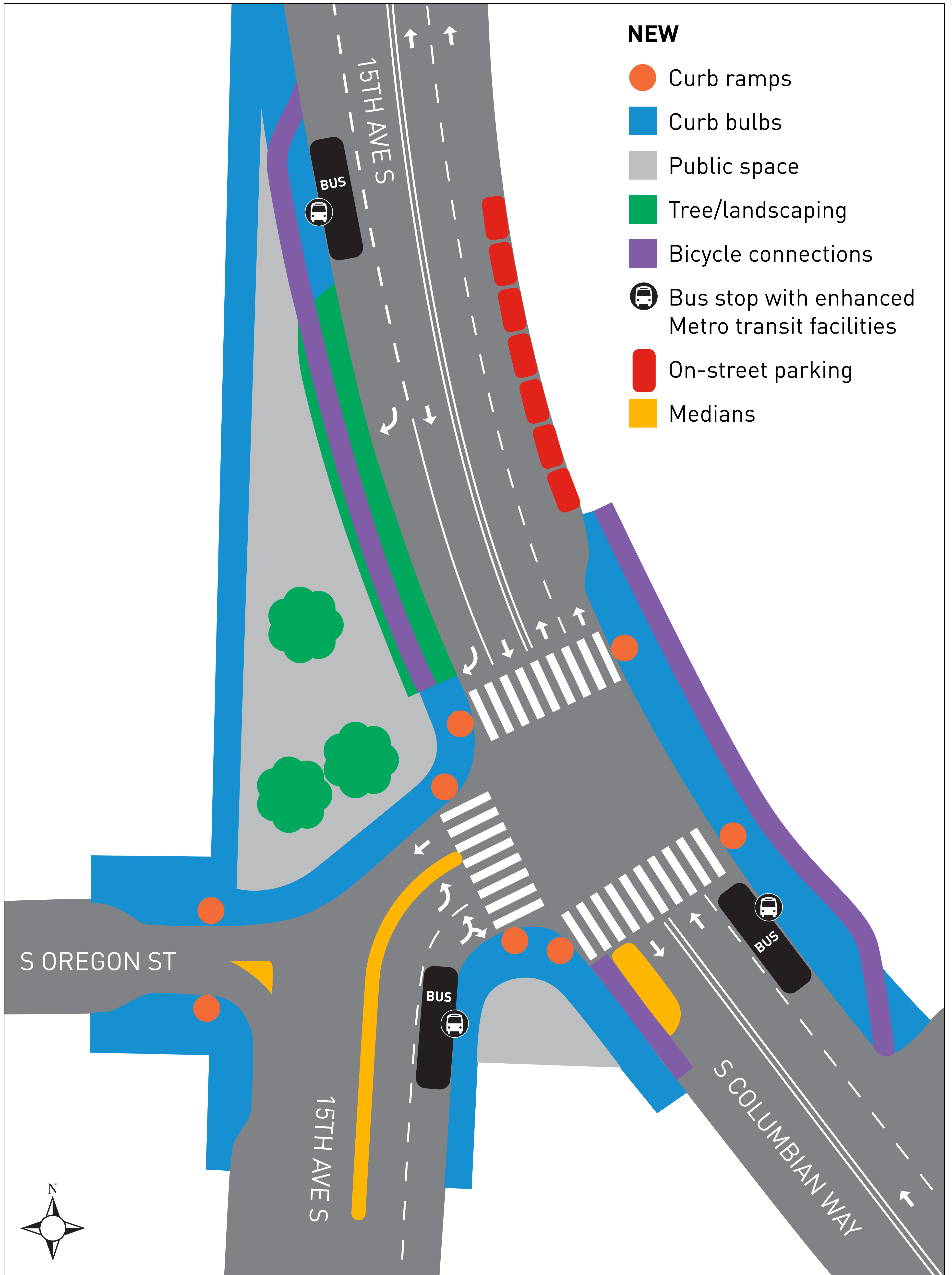

CONCEPTS CONSIDERED BUT NOT SELECTED

Concept A

- Increased delay at S Columbian Way, a major truck street
- Pedestrian safety compromised due to vehicle conflicts at crosswalks

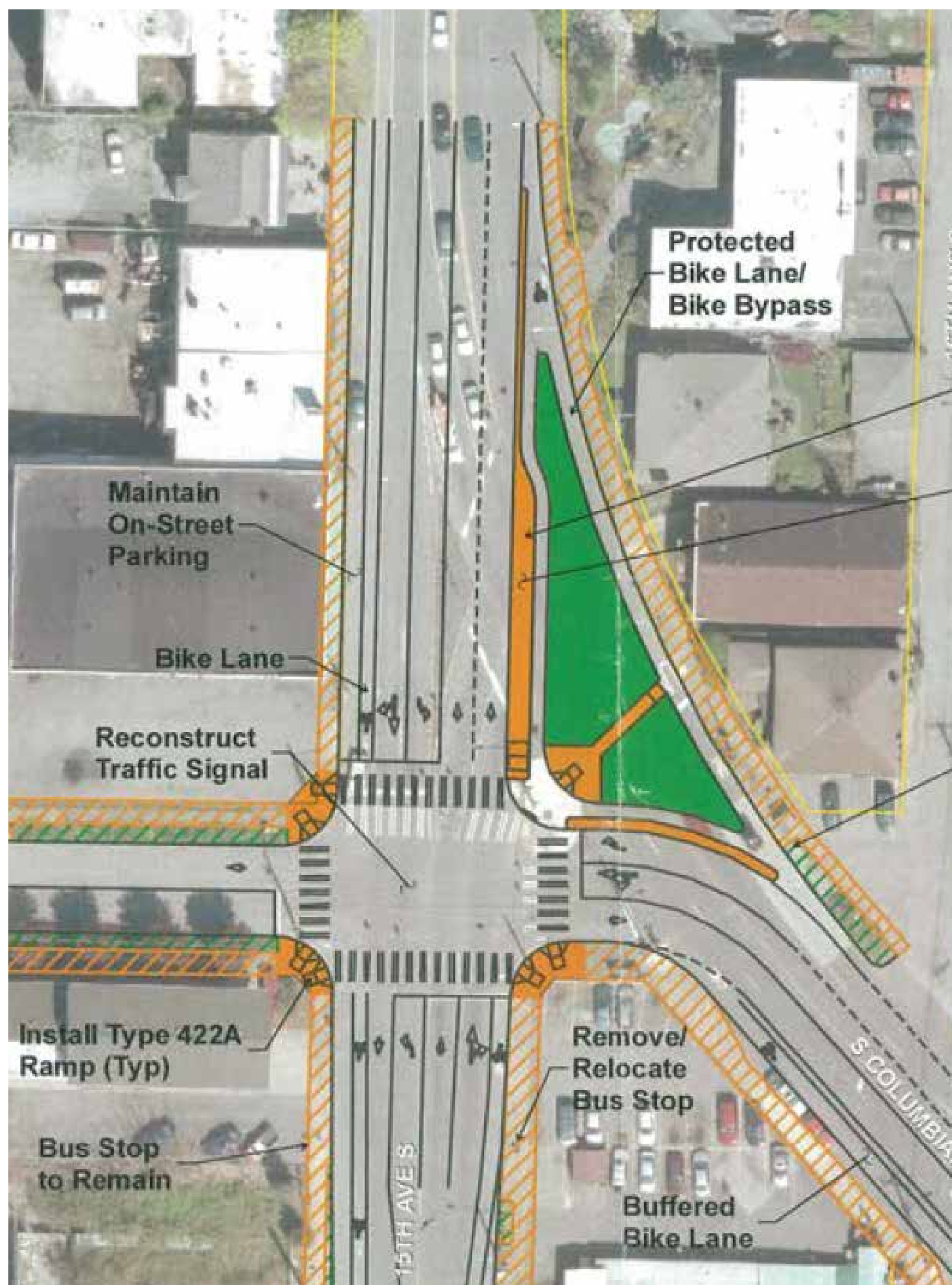

Concept B

- Increased delay for all streets
- Complicates movements of people driving, walking, and biking

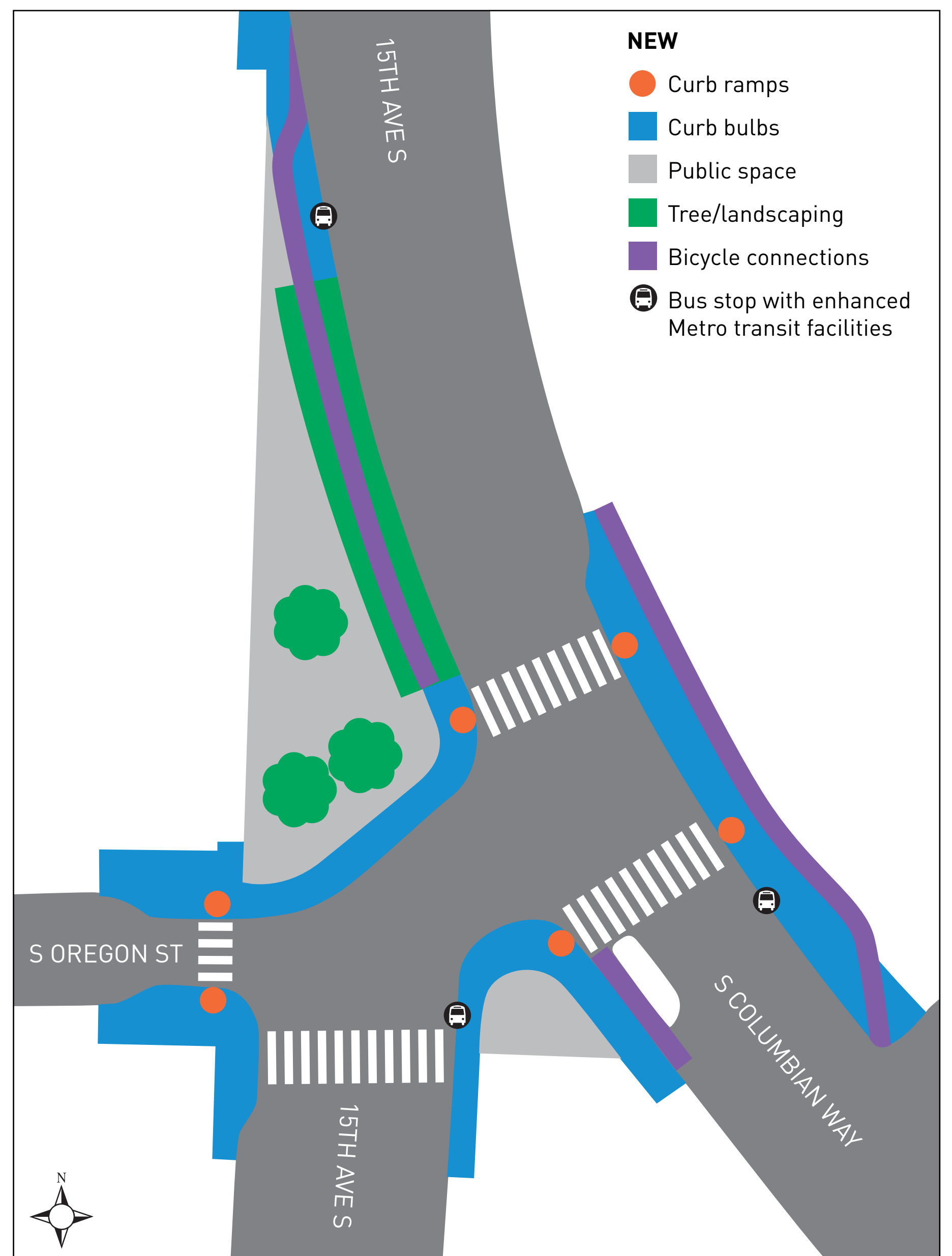

REVISED PROJECT CONCEPT FOR DISCUSSION

Consider installing an all-way stop at S Snoqualmie St and 15th Ave S. Benefits include:

- Protected left turns to go north on 15 Ave S
- Easier neighborhood access from Columbian Way (northbound left at S Snoqualmie St) across 15th Ave S

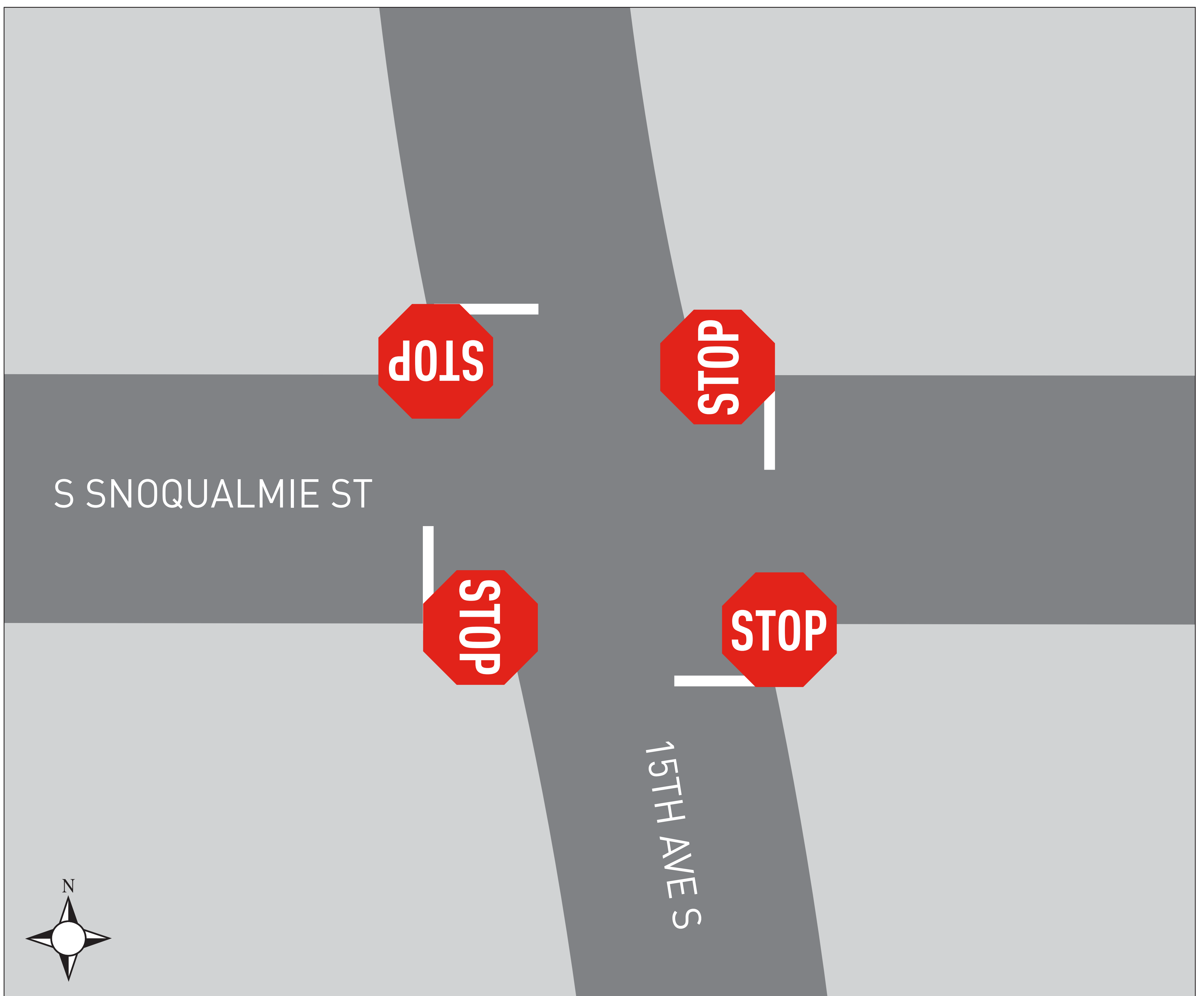

NEIGHBORHOOD PLAZA POSSIBILITIES

A new plaza creates opportunities not possible in the park, such as street vending; and offers a casual gathering space for neighborhood celebrations.

What would you like included?



WHAT'S HAPPENING IN YOUR NEIGHBORHOOD?

Here's what traffic data shows.

Nearby collision history (2012-2016)

