



## 2018 SBC Code Interpretation

The following interpretation, policy or code alternate is intended to provide guidance to staff for consistency of review and is subject to change without notice. Application of this interpretation, policy or code alternate to specific projects may vary.

### Code Issue:

Fire walls are required to extend not less than 18 inches beyond the exterior surface of the exterior wall. Three exceptions are given to allow termination within the exterior wall assembly, however requirements for exceptions 2 and 3 are not clearly identified. How does SDCI enforce each of these exceptions?

### Interpretation:

The prescribed exterior wall protection method must extend a minimum of 4 feet horizontally at each side of the fire wall termination. Openings within this 4-foot distance shall be protected by opening protectives having a fire-protection rating of not less than  $\frac{3}{4}$  hour.

- **Exception 1 - Fire Rated Construction**  
No SDCI interpretation for this exception.

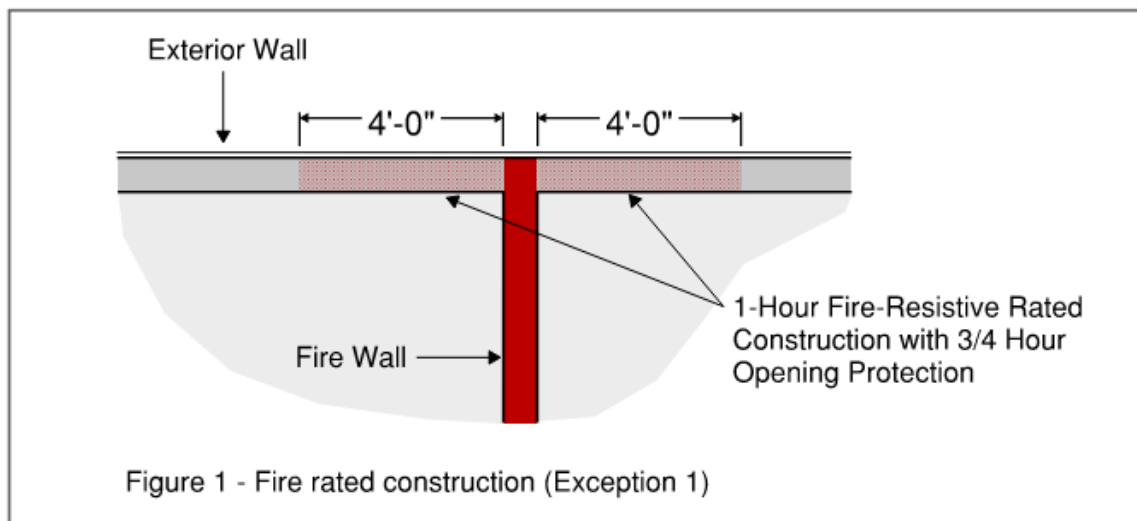



- **Exception 2 - Noncombustible Finish Materials**

Interpretation: Openings located within 4' of the fire wall must be ¾ hour protected.

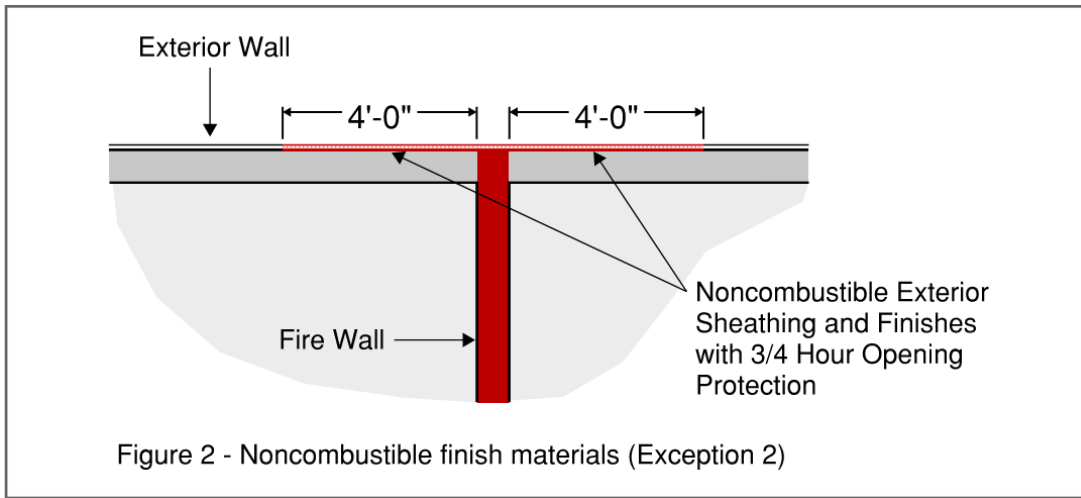

- **Exception 3 - Noncombustible Sheathing and Sprinklers**

Interpretation: Non-combustible sheathing must extend 4' on each side of the fire wall. Openings located within 4' of the fire wall must be ¾ hour protected

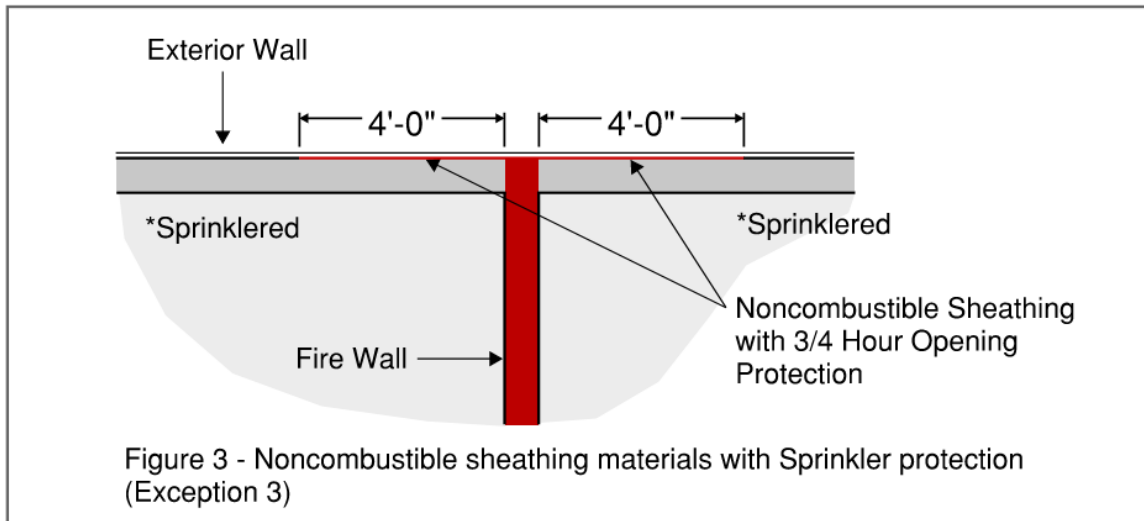

**Note:** 706.5 applies to fire walls intersecting exterior walls where the angle between the exterior walls is greater than or equal to 180 degrees. See 706.5.1 for fire walls terminating at exterior walls forming an angle less than 180 degrees, such as at an inside corner.

For questions about whether this code solution applies to your project:

- If you have submitted a permit application, contact the Building Code plan reviewer assigned to your application
- If you have not submitted an application, send us a question through the SDCI website <http://www.seattle.gov/dpd/toolsresources/sendusaquestion/default.htm> or in person at the Applicant Services Center. Visit the Applicant Services Center website for more information about hours and location <http://www.seattle.gov/dpd/aboutus/whoware/applicantservicescenter/default.htm>