

- 6' WIDE TRAIL
- CRUSHED GRAVEL
- MAINTENANCE STAGING AREA
- BOTANIC COLLECTION
- ONE-WAY ALLEY AT EXISTING DRIVEWAY
- OUTDOOR CLASSROOM

- COMMUNITY GATEWAY
- S JUDKINS ST HILLCLIMB
- TIMBER STAIRS AT GRADE/ STAIR STRUCTURE AT STEEPEST SLOPE
- GATHERING AREA
- OVERLOOK W/ SEAT WALL
- SERPENTINE PATH (CRUSHED GRAVEL)
- HABITAT OR NATIVE PLANT COLLECTIONS

## Lewis Park Natural Area

Seattle, Washington

Final Concept Plan

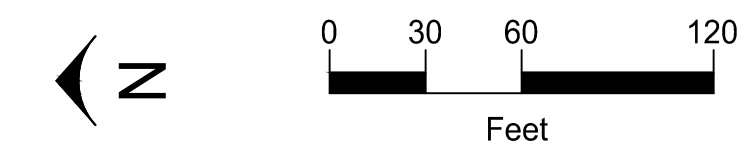

March 2013



911 Western Avenue  
Suite 405  
Seattle, WA 98104  
(206) 588-1502

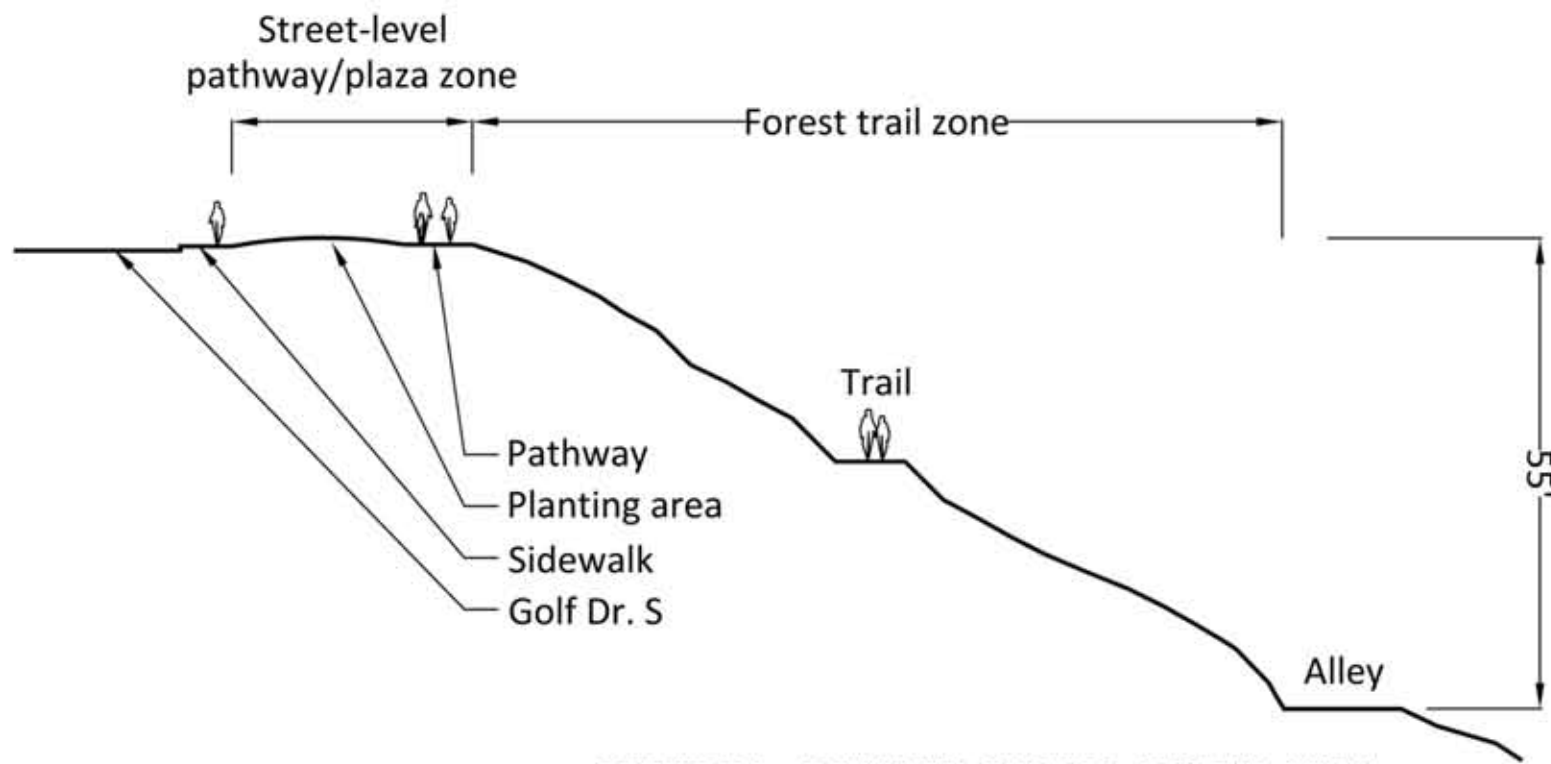

SECTION A - BETWEEN GOLF DR. S & THE ALLEY

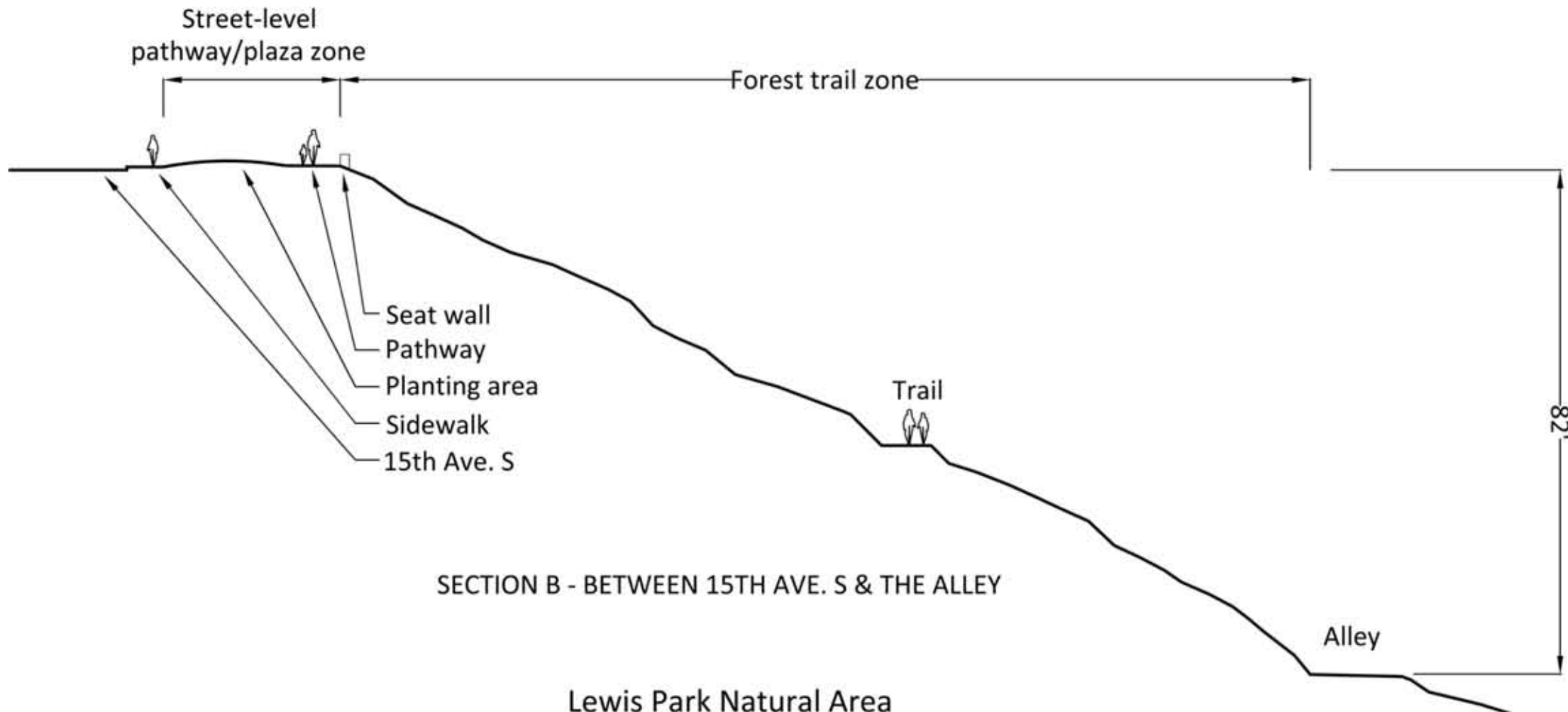

SECTION B - BETWEEN 15TH AVE. S & THE ALLEY

Lewis Park Natural Area  
 CONCEPTUAL ALTERNATIVE  
 Sections through hillside - looking north

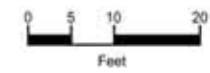

Restoration plantings  
- existing deciduous  
trees underplanted  
with native conifers

Restoration plantings - low  
native shrubs to allow for  
clear lines of site into park

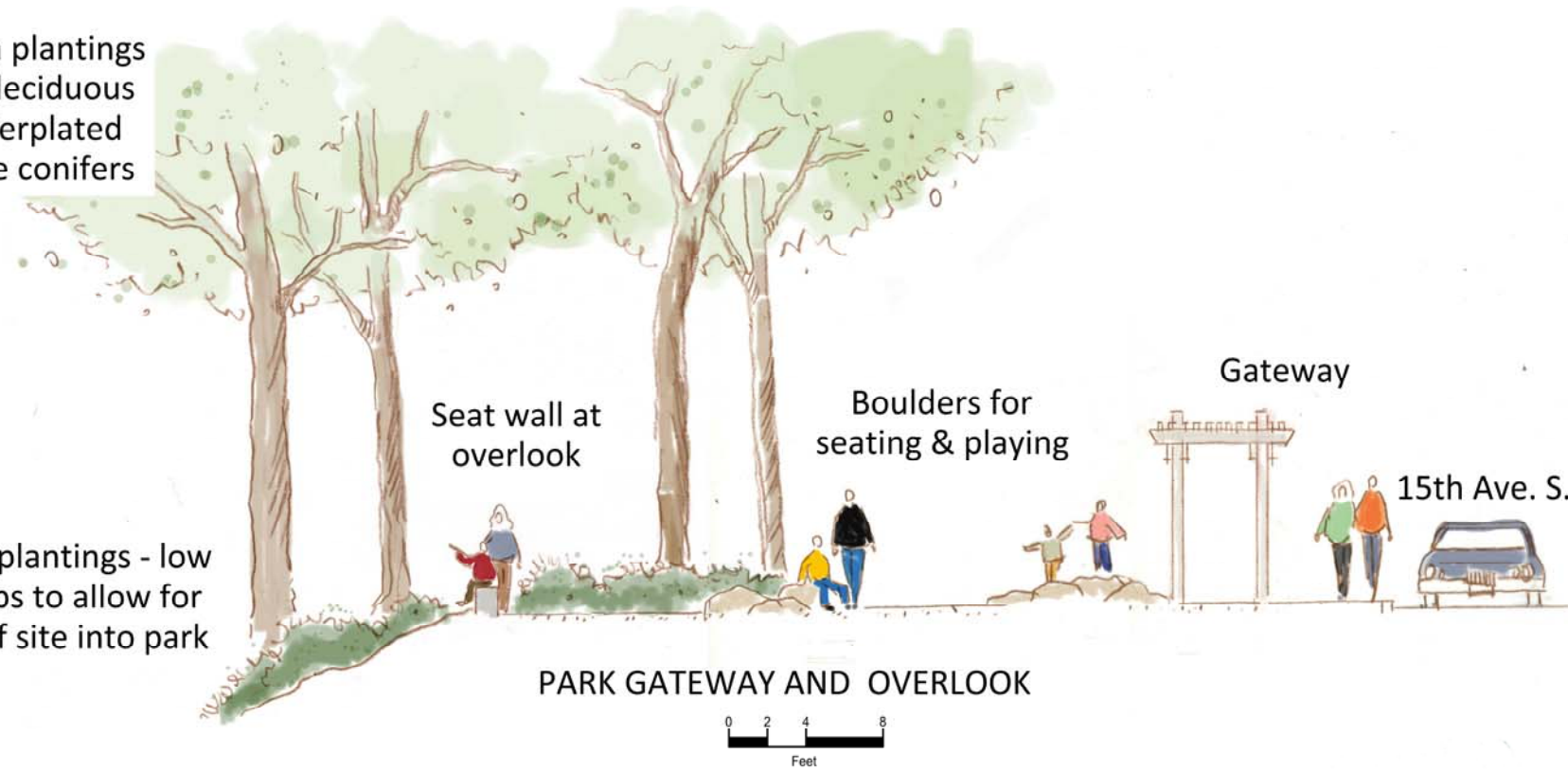

PARK GATEWAY AND OVERLOOK

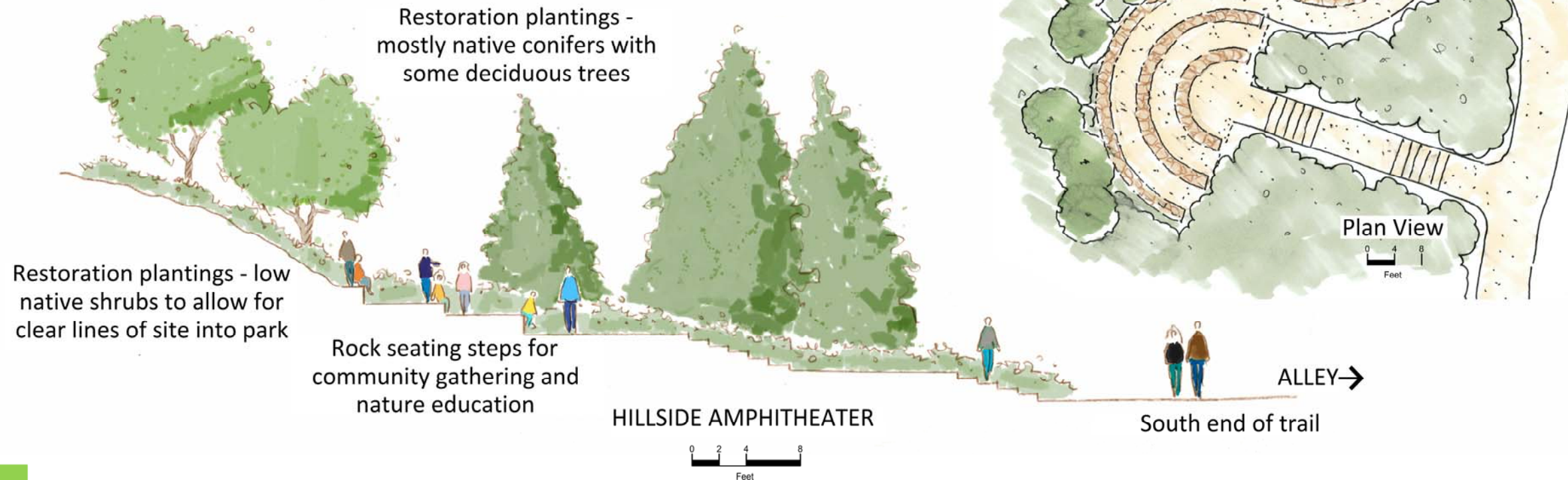

Restoration plantings -  
mostly native conifers with  
some deciduous trees

Restoration plantings - low  
native shrubs to allow for  
clear lines of site into park

Rock seating steps for  
community gathering and  
nature education

HILLSIDE AMPHITHEATER



Plan View  
0 4 8  
Feet

ALLEY →

South end of trail

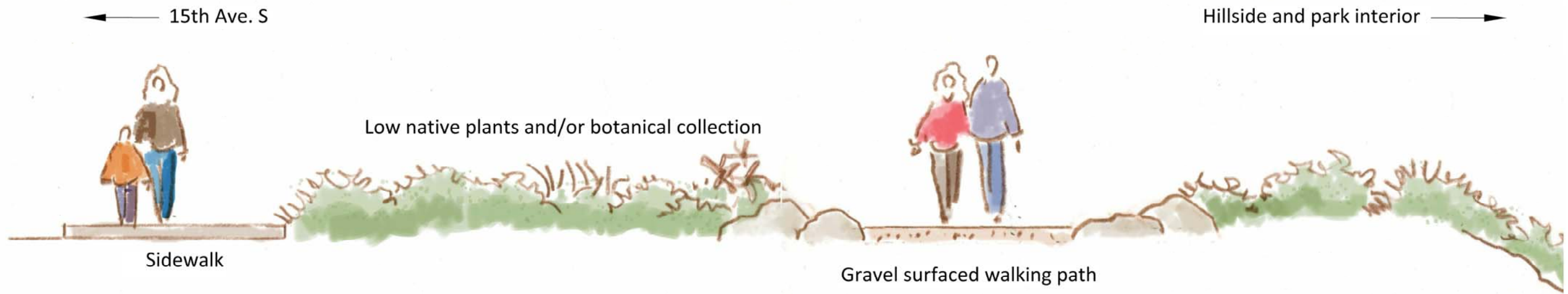

**Lewis Park Natural Area**  
 Typical section along 15th Ave. S and Golf Dr. S  
 Gravel path through planting area



911 Western Avenue  
 Suite 405  
 Seattle, WA 98104  
 (206) 588-1502

