

**>>>>CAUTION - CALL 811<<<<  
UTILITY NOTIFICATION CENTER  
BEFORE YOU DIG!  
WWW.CALL811.COM**

ALSO CONTRACT WITH A COMMERCIAL UNDERGROUND UTILITIES LOCATOR SERVICE TO IDENTIFY BELOW-GROUND INFRASTRUCTURE THAT MAY NOT BE LOCATED BY CALL 811 BEFORE-YOU-DIG.

**PLANT LEGEND**

SYM	BOTANICAL NAME	COMMON NAME	SIZE	QUANT	NOTES
⊙	ACER SACCHARUM 'BARRETT COLE'	APOLLO MAPLE	2" CAL	4	PRUNE BRANCHES AT 6'
⊙*	LAVANDULA ANGSTIFOLIA	ENGLISH LAVENDER	1 GAL	10	
⊙*	POLYSTICHUM MUNITUM	SWORD FERN	1 GAL	30	
⊙*	ROSMARINUS OFFICINALIS	ROSEMARY	2 GAL	5	
⊙*	SALVIA OFFICINALIS	GARDEN SAGE	1 GAL	5	
⊙*	THYMUS VULGARIS	COMMON THYME	1 GAL	12	
⊞	TURF GRASS				
⊞	MULCH BED - WOOD CHIP				

**PLANTING NOTES:**

- ALL LAWN AND PLANTING AREAS REQUIRE FULL SOIL PREPARATION ACCORDING TO CITY OF SEATTLE STANDARD PLAN NO. 142.
- LAWN AREAS THAT HAVE BEEN HEAVILY COMPACTED BY EQUIPMENT SHALL BE ROTOTILLED, FINE GRADED, RESEDED, FERTILIZED, AND ROLLED.
- SHRUB AREAS THAT HAVE BEEN IMPACTED DUE TO CONSTRUCTION SHALL BE ROTOTILLED, REPLANTED WITH THE SAME SPECIES AND SIZE PLANT, AND MULCHED.
- NEW TREES AND PLANTS DELIVERED TO THE SITE SHALL BE STORED IN A SECURE, SHADY AREA FOR INSPECTION. COORDINATE WITH SDOT URBAN FORESTRY AND PARKS (ENGINEER) FOR INSPECTION MINIMUM 48 HOURS PRIOR TO PLANTING. PLANT PER COS STANDARD PLAN 100A.
- PARKS (ENGINEER) TO FIELD VERIFY ALL PLANTING BED LAYOUTS.
- STAKE TREES FOR SDOT UF AND PARKS (ENGINEER) FIELD APPROVAL.
- UNDERGROUND UTILITIES SHALL BE LOCATED PRIOR TO START OF WORK.
- CONTRACTOR SHALL PLACE PLANT MATERIALS SO THEY DO NOT INTERFERE WITH IRRIGATION SYSTEM OR INHIBIT REQUIRED COVERAGE. PLANT LOCATIONS MAY BE ADJUSTED AS LONG AS DESIGN INTENT IS NOT COMPROMISED. IF A CONFLICT OCCURS, CONTRACTOR SHALL NOTIFY PARKS (ENGINEER) FOR APPROVAL OF ANY MAJOR MODIFICATIONS.
- CONTRACTOR SHALL GUARANTEE PLANT MATERIAL FOR A PERIOD OF ONE YEAR AFTER THE DATE OF PHYSICAL COMPLETION. CONTRACTOR SHALL REPLACE, AT HIS OWN EXPENSE, ANY PLANTS THAT ARE DEAD OR, AS DETERMINED BY THE PARKS (ENGINEER), ARE IN AN UNHEALTHY OR UNSIGHTLY CONDITION.

NO.	REVISION - AS BUILT	DATE
1		

REVIEWED: \_\_\_\_\_ DATE \_\_\_\_\_  
PARK ENGINEER

All work done in accordance with the City of Seattle Standard Plans and Specifications in effect on the date shown above, and supplemented by Special Provisions.

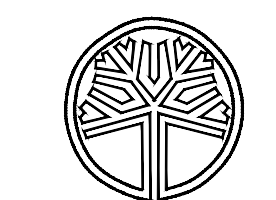

R. FRANK ROBINSON  
LICENSE NO. 505  
EXPIRES ON 06/26/2015



**SUMMIT SLOPE PARK**

**JOHN STREET ENHANCEMENT**

**PLANTING PLAN**

DESIGNED RFR	DATE MAY 2016
DRAWN RFR	SHEET 6 OF 8
CHECKED SH	
ORDINANCE NO. 123560	
CONTRACT NO. 1912	
SCALE 1"=10'	

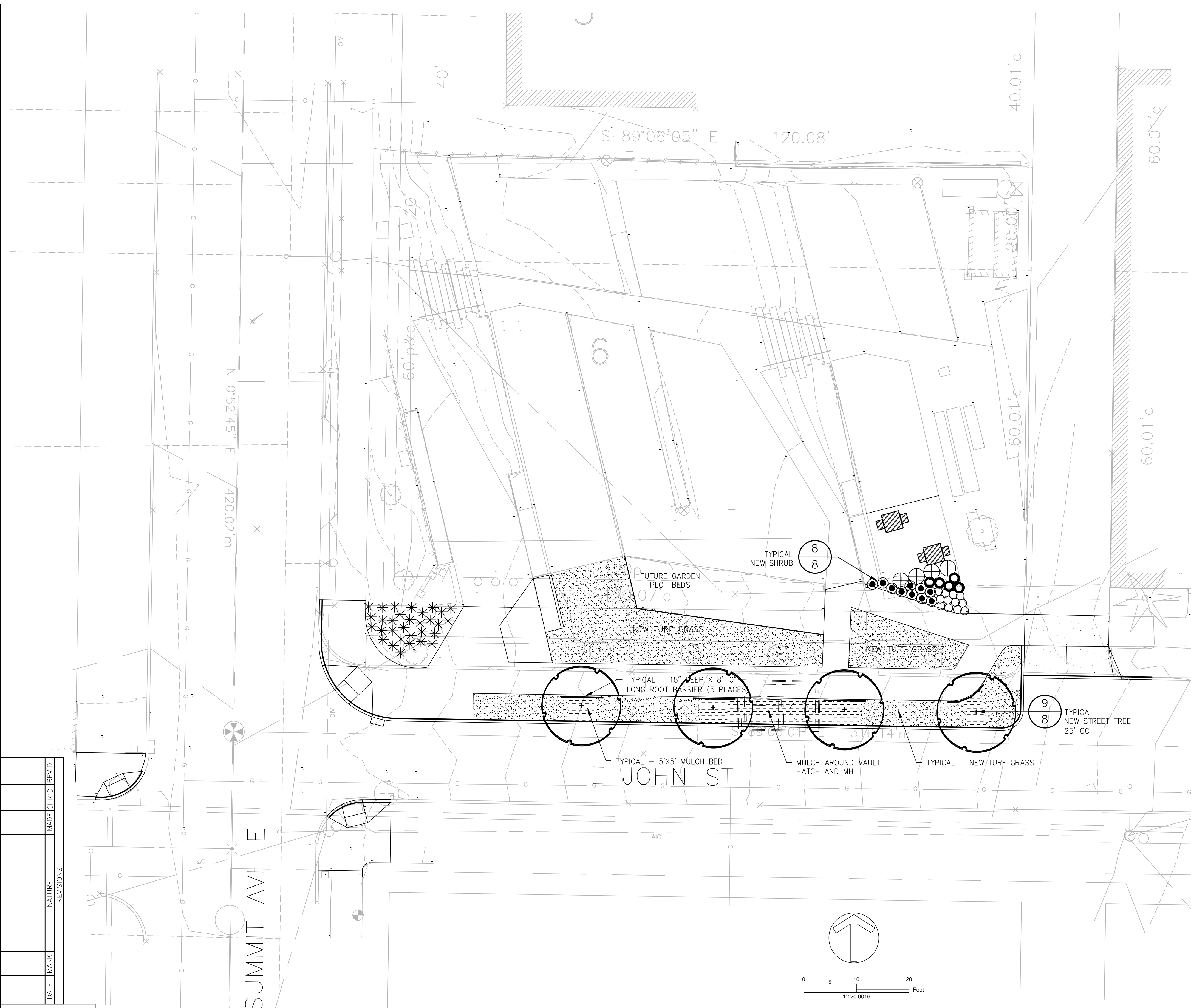

DATE	MARK	NATURE	REVISIONS	MADE	CHK'D	REV'D



REVIEWED BY SPU/WATER ENGINEERING	NAME OR INITIALS AND DATE	INITIALS AND DATE
DESIGNED _____ 20....	DESIGNED _____	REVIEWED: _____
CHECKED _____	CHECKED _____	PROJECT MANAGER
REVIEWED BY SPU/DRAINAGE	DRAWN _____	REVISED AS-BUILT _____
DESIGNED _____ 20....	CHECKED _____	
APPROVED BY SDOT STREET IMPROVEMENT PERMITTING	DESIGN REVIEW _____	
DESIGNED _____ 20....		

All work done in accordance with the City of Seattle Standard Plans and Specifications in effect on the date shown above, and supplemented by Special Provisions.

City of Seattle  
**Seattle Department of Transportation**

SCALE: H. V. INSPECTOR'S BOOK

SUMMIT SLOPE PARK

**200 SUMMIT AVE E  
JOHN STREET ENHANCEMENT  
PLANTING PLAN**

SDOT PROJECT NO. \_\_\_\_\_  
VAULT PLAN NO. 790-410  
VAULT SERIAL NO. 36723  
SHEET 6 OF 8