

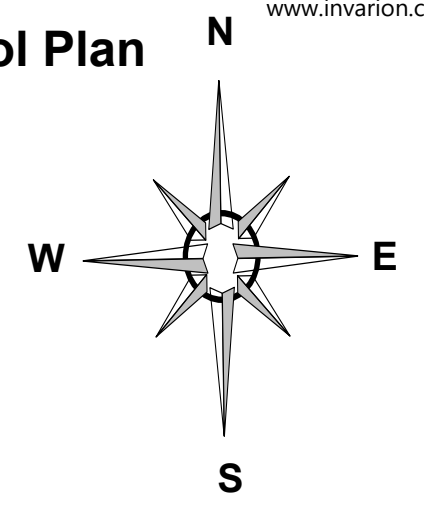

All Signs & Spacing to conform to the MUTCD & The City of Seattle Traffic Control Manual

Traffic Control Plan  
P#



### Pedestrian Detour for location 7 NE 51th St to 39th Ave NE

Shane Olson  
Sr. Estimator | Sr. Project Manager  
Office: 425-254-1820 ext. 407  
Cell: 206-255-3130  
Email: Shane@nwasphalt.com

**Legend**

- Work Area
- detour for peds (R)
- detour for peds
- Type III Barricade

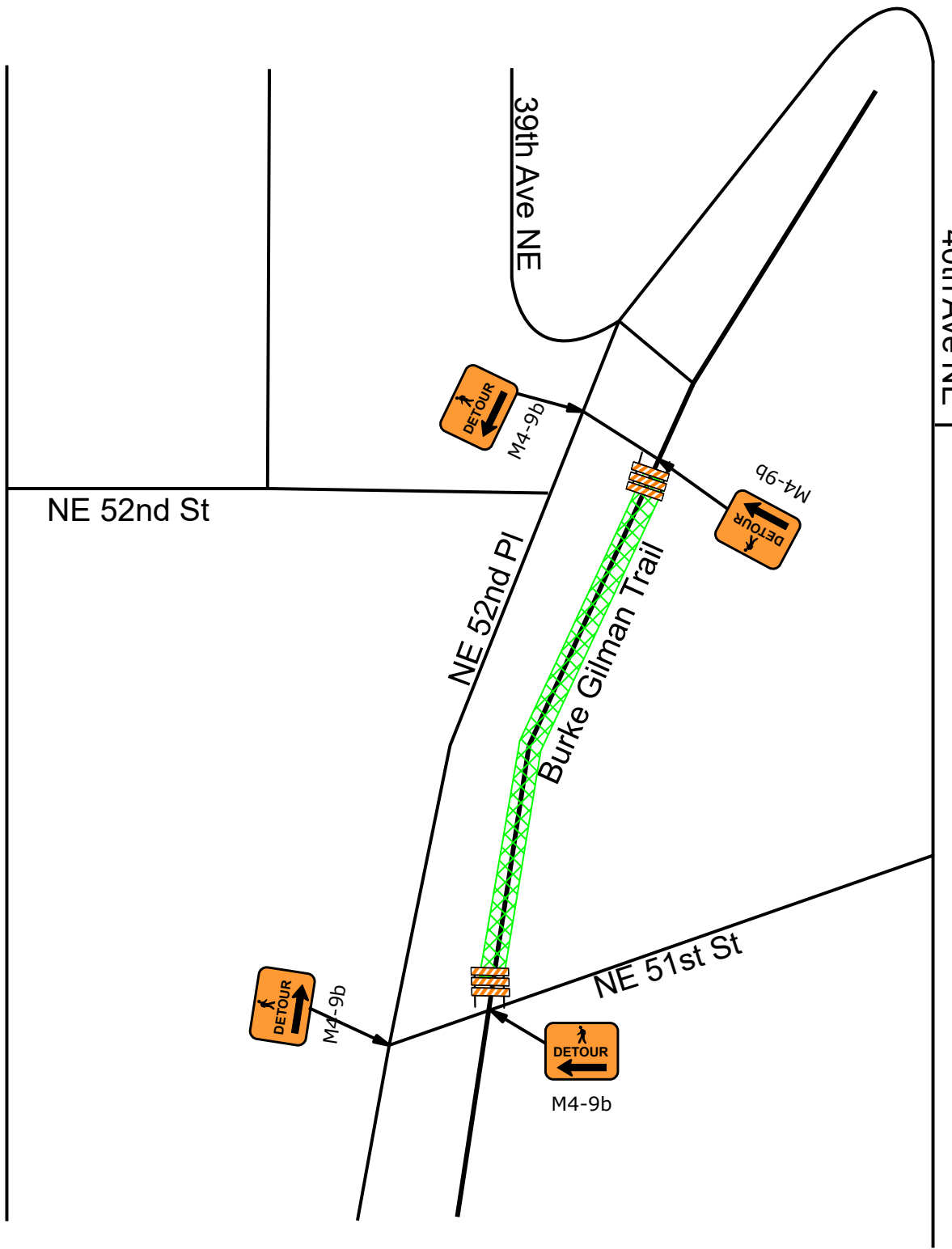

- GENERAL NOTES**
1. ALL SIGNS AND SPACING SHALL CONFORM TO THE CITY OF SEATTLE TRAFFIC CONTROL MANUAL FOR IN-STREET WORK.
  2. PRIORITY PASSAGE THROUGH WORK AREA FOR EMERGENCY VEHICLES SHALL BE PROVIDED AT ALL TIMES.
  3. ALERT METRO TRANSIT 5 DAYS IN ADVANCE (206-477-1150). Trolley (206) 477-1150 / Non Trolley (206) 477-114 WHEN BUS STOPS OR OVERHEAD TROLLEY LINES ARE PRESENT.
  4. PROTECTIVE VEHICLE RECOMMENDED-MAY BE A WORK VEHICLE.
  5. DEVICES SHOULD NOT ENCROACH INTO ADJACENT LANES.
  6. ALL SIGNS min. 30" X 30" B/O UNLESS OTHERWISE SPECIFIED.
  7. CHANNELIZATION DEVICES ARE 28" REFL. CONES. (see TABLE 1 for spacing distances).
  8. ALL SPACING MAY BE ADJUSTED TO ACCOMMODATE AT-GRADE INTERSECTIONS AND/OR DRIVEWAYS.
  9. NO IMPACT TO ADJACENT PROPERTY ACCESS.
  10. MAINTAIN 11' VEHICLE TRAVEL LANE WIDTHS
  11. MAINTAIN 4' SIDEWALK WIDTHS ( 8' in the downtown core) UNLESS OTHERWISE APPROVED VIA THIS TCP
  12. RESERVE CURB SPACE INCLUDING PAID PARKING W/SDOT TRAFFIC PERMITS @ (206) 684 5086

CLASS OF ROAD	WARNING SIGN SPACING IN FEET			TAPER LENGTH (L) IN FEET		CHANNELIZING DEVICE SPACING IN FEET (maximum)				WARNING SIGN MIN. SIZE IN INCHES
	A	B	C	LANE WIDTH		VEHICLE BARRICADES & DRUMS		OTHER**		
				10'	12'	TAPER (S)	TANGENT	TAPER (S)	TANGENT	
I	*			75	90	SPEED LIMIT	SPEED LIMIT X 2	15	30	30X30
II	150	150	75	150	200	SPEED LIMIT	SPEED LIMIT X 2	20	50	30X30
III	300	300	150	400	500	SPEED LIMIT	SPEED LIMIT X 2	30	80	48X48

**ROAD CLASS DEFINITIONS**  
**CLASS I - CENTRAL BUSINESS DISTRICT, UNIVERSITY DISTRICT**  
**CLASS II - ARTERIAL STREETS**  
**CLASS III - ALL PARTIALLY OR FULL CONTROLLED ACCESS ARTERIAL STREETS**  
 \* ADVANCED WARNING SIGNS IF FEASIBLE  
 \*\* VERTICAL BARRICADES, CONES, TUBULAR GUIDEPOSTS

TCP Designs  
 TCS # 542238  
 Phone: 206-573-2962  
 Trafficplandesigns@gmail.com  
 Date: 5/4/2019