



**Mike McGinn**  
Mayor

**Diane Sugimura**  
Director, DPD

**Marshall Foster**  
Planning Director, DPD

**Julie Bassuk**  
Chair

**Graham Black**

**Malika Kirkling**

**Laurel Kunkler**

**Tom Nelson**

**Julie Parrett**

**Osama Quotah**

**Norie Sato**

**Donald Vehige**

**Debbie Wick-Harris**

**Valerie Kinast**  
Coordinator

**Tom Iurino**  
Senior Staff



**Department of Planning  
and Development**  
700 5th Avenue, Suite 2000  
PO Box 34019  
Seattle, WA 98124-4019

**TEL** 206-615-1349  
**FAX** 206-233-7883

## APPROVED MINUTES OF THE MEETING

**May 19, 2011**

Convened 10:00 am  
Adjourned 3:30 pm

### Projects Reviewed

Fire Station 36  
Grange Insurance Association Skybridge  
Yesler Terrace Redevelopment

### Commissioners Present

Julie Bassuk, Chair  
Graham Black (excused from 10:30am-11:30am)  
Malika Kirkling (excused from 12:00pm-3:30pm)  
Tom Nelson (excused from 10:00am-11:00am)  
Julie Parrett  
Osama Quotah  
Norie Sato (excused from 10:00am-11:45am)

### Commissioners Excused

Laurel Kunkler  
Don Vehige

### Incoming Commissioners Present

Debbie Wick-Harris

### Staff Present

Valerie Kinast  
Tom Iurino



---

**May 19, 2011**

**Project: Fire Station 36**

**Phase:** Street Vacation

**Last Reviewed:** N/A

**Presenters:** Teresa Rodriguez, FAS  
Ray Johnston, Johnston Architects

**Attendees:** Beverly Barnett, SDOT  
Daniel Bretzke, FAS  
David Kunselman, FAS  
Hillary Hamilton, FAS  
Mark Tilbe, Murase Associates  
Michael H. Walsh, Fire Department

**Time:** 10:30am – 11:30am

---

## **Presentation**

The Department of Finance and Administrative Services presented its plans to renovate Fire Station 36, which include seismic upgrades and a small addition. To facilitate the addition, the department proposed a street vacation of the right-of-way surrounding Fire Station 36 and to incorporate this property into its site. The fire department has been using the property for decades; it is leftover from the development of the West Seattle Bridge. The department proposed a public benefit package of additional landscaping (400 square feet of planted area), including four possible locations for green “walls”, for both visual relief and ecological function.

## **ACTION**

The Design Commission thanked the design team for its presentation of the renovation of Fire Station 36 and its request for a street vacation.

The commission believed that vacating the right-of-way did not affect the area’s urban design. By a vote of 6-0, the commission approved the urban design merit portion of the street vacation.

By a vote of 5-0, the commission recommended SDOT approve the street vacation and the public benefit package which included station enhancements, an emergency response generator, an offset of greenhouse gas emissions, visual relief for drivers, an attenuation of ambient railroad and freeway noise, and four possible areas for green walls of planting. (See details attached.) The commission’s recommendation was contingent upon review of the final plan by the Design Commission chair. The commission made the following conditions:

- Explore a green roof for the fire station.
- Choose plant and tree species strategically; they should be able to withstand the site’s inhospitable conditions.
- Develop the design to enhance the views and public amenities surrounding the site.

# Proposed Public Benefit

- *Provide all station enhancements planned in the Fire Levy.*
- *Provide space for 72-hour emergency response generator.*
- *Offset greenhouse gas emissions of station operations.*
- *Provide visual relief for drivers.*
- *Attenuate some of the ambient railroad and freeway noise.*

# Potential Location of Green Walls

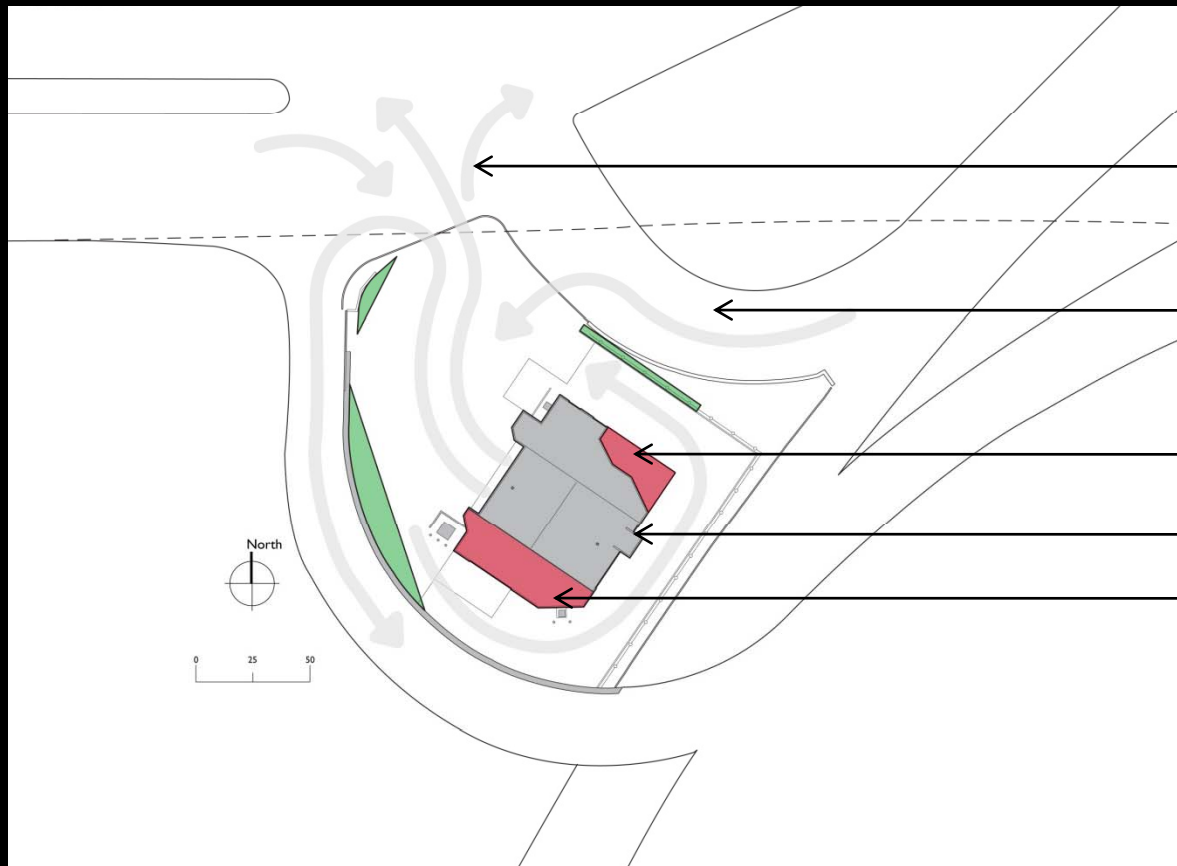

Truck mobilization paths

Freeway ramps

Proposed Addition

Existing Station

Existing area to be modified



Masterplan Planting and Green Wall Locations



# Types of Green walls



Hedge/Trees

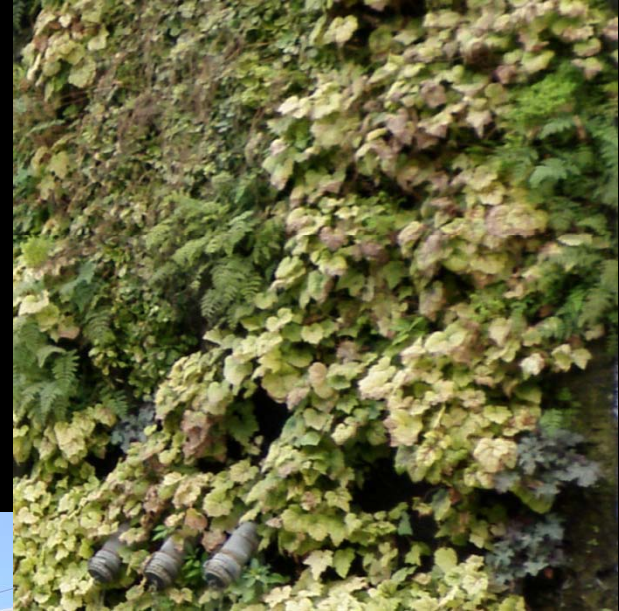

Fabric matrix



Vines and mesh



# Possible Location of Green Walls



Flanking off ramp to north



In the curve of the on ramp



At west hand rail near on ramp



At east chain link fence

# Conceptual Masterplan



Before



After

## Proposal:

1. Design a landscape master plan for the site.
2. In selected areas, commit to 400 s.f. of planted area with material height of to 8' or more.
3. Request flexibility due to operational design yet to be completed.
4. Review final design approach with DRC Chair.

If vacation is approved, design can start with confirmation of benefit in design development