

2016 MUNICIPAL ART PLAN CITY OF SEATTLE

September 2016
(Corrections October 2016)



OFFICE OF ARTS & CULTURE

SEATTLE

The mission of Seattle's Public Art Program is to engage artists in the civic dialogue, integrating artworks and the ideas of artists into a variety of public settings.

Table of Contents

Municipal Art Plan Highlights/Executive Summary	p. 3
Introduction/Process	p. 6
Projects Listed by Funding Departments	
Seattle City Light	p. 9
Seattle Public Utilities	p. 12
Department of Finance and Administrative Services	p. 23
Seattle Center	p. 26
Seattle Parks and Recreation	p. 28
Seattle Department of Transportation	p. 30
Special Projects	p. 45
Appendix	
2016 MAP Financial Summary	p. 46
2016 MAP Individual Project Funding	p. 49
Additional Financial Tables	p. 57

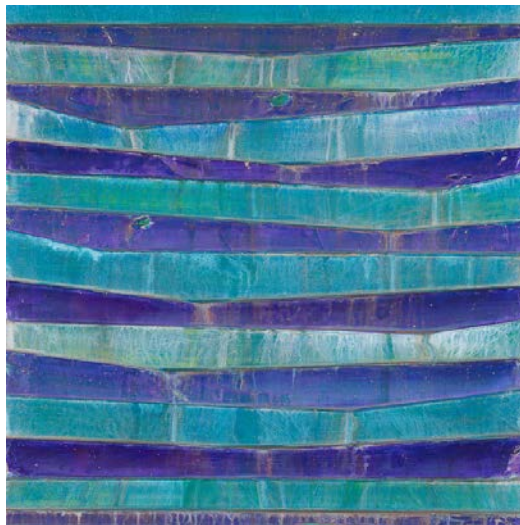

Juan Alonso-Rodriguez, *Mar*, SPU Cultural Perspectives Purchase, 2015,
Seattle Public Utilities 1% for Art funds

2016 Municipal Art Plan

Executive Summary/Highlights for 2016

The City of Seattle has been including artworks and the thinking of artists in the design of the city's public realm for over 40 years through funds generated by the Public Art Ordinance. Each year, the public art program collects 1% for Art dollars as revenue into its Municipal Art Fund and, with the assistance of city departments, the community and the Public Art Advisory Committee (PAAC), determines how to allocate those funds to public art projects. The Municipal Art Plan details those allocations, as well as describes ongoing projects in the Public Art Program.

Public art - because art that is encountered in public space (real or virtual) impacts the civic realm so directly - is particularly well positioned to be a catalyst in the city. We directly commission artists, supporting their work and the broader cultural community. Our projects range from the ephemeral to site-integrated design; from the collection of portable artworks to the building of infrastructure; from the training of artists to the activation of streetscapes.

In 2016, we will continue to offer and develop a range of artwork experiences and commission artists working in a variety of media and scales. In conjunction with the Seattle Arts Commission, the Office of Arts & Culture, and its programs, the Public Art Program will focus on the lens of equity, especially racial equity, to guide our activities and the projects we develop and launch. We will use tools to ensure that we are applying an equity lens in the evaluation and review of projects. The PAAC has a particular interest in focusing projects in communities, such as Delridge, Southeast Seattle, Lake City and Northgate, we will work with our collaborating departments to identify communities and project opportunities that engage a diverse range of people both as the creators of the art and as the audience. The goal is to ensure that the best and most appropriate artist is selected for each commission.

We continue to look for ways to increase access to participation for both artists and new and underserved audiences. The PAAC identified visual arts education, starting in elementary school, as key to developing artists as well as a means to introduce the public art field to young minds. In addition, showing that a career in public art "is a thing" to youth and various communities will assist in expanding the pool of potential artists. The PAAC is committed to help groups develop artists within their communities. We seek both innovative and streamlined ways to identify artists in order to bring public art to Seattle. We strive to include community participation and partnership in all phases of artwork development. We are also looking to expand the reach and role of public art; for example, investigate ways that art and activation can build community, support public safety, and promote a livable city. We want to train, identify and engage "makers" in the production of art, and the PAAC hopes to expand the program's nationally recognized highly successful Public Art Bootcamp. The city's commitment to inclusion and social justice will help inform the scoping of our upcoming work.

Training for emerging artists and a variety of temporary, activation and gallery projects will increase opportunities for artists who are newer to the public art field. We recognize as well that we can create an intermediate step for artists transitioning from temporary projects by developing "entry-level" permanent commissions. We will work with partner departments to find opportunities to reach out to immigrant and traditionally underserved populations. By offering tours, cellphone apps, talks, bicycle tours and other outreach activities, we reach out further to share access to artists and artworks with the public.

In 2016, we anticipate collecting close to \$4 million in 1% for Art revenue (again buoyed by Seawall and Drainage and Wastewater 1% for Art). Of this amount, we will allocate approximately \$3.3 million to the implementation of artwork (selection, artist fees, artwork costs and project management) and we will use 15%, or close to \$600,000, for general support of the office. These figures are subject to change, and these changes will be noted next year. This Municipal Art Plan also reflects changes made to 2015 funds, due to changes in capital departments' spending.

An overview by department of anticipated activity shows projects that reflect the interests of our city partners, whose capital budgets provide the 1% for Art funds, as well as the goals of the Public Art Advisory Committee (PAAC), the office's director and the city as a whole. Office of Arts & Culture staff works closely with city departments, communities and the Public Art Advisory Committee to craft opportunities for artists that will result in vibrant, thoughtful projects that will reinforce Seattle's standing as a uniquely creative city committed to racial and social equity. Some projects are written very broadly to serve as placeholders for opportunities that will be developed more fully in conversations with the PAAC and city staff. The staff will work with partner departments to craft opportunities that reflect the PAAC's interests. As needs and interests change, the MAP can be amended as needed (changes are tracked and then complied in the following year's MAP). Some projects listed in this document were launched in mid-to-late 2015 and are shown as MAP amendments; the MAP also shows projects that were started in the calendar year in advance of the MAP being finalized.

Seattle City Light projects cover a wide range of arts activities, from portable works purchases, site-specific artworks related to capital projects, temporary activation and installations that highlight the utility's energy conservation programs. Seattle Public Utilities continues to generate 1% for Art funds from its three primary lines of business, Drainage and Wastewater, Water and Solid Waste. The utilities are committed to the city's Race and Social Justice Initiative and environmental justice and are partnering to develop projects that encourage participation from a wide range of artists and community members. Some projects will explore opportunities for indigenous peoples; others will engage youth and immigrant communities. One project will pilot engaging the homeless population. The Drainage and Wastewater Artist-in-Residence has been looking for opportunities at one of the city's largest groups of long-range capital investments.

For general fund departments, where projects are often very closely tied to capital construction, we must adjust creatively to develop non-traditional models. With Finance and Administrative Services, we are finalizing our last two fire station projects, which, like the previous neighborhood stations feature sculptural artworks. The North Police Precinct presents an opportunity, should stakeholders show support, to develop an engagement project that bridges relationships between public safety and the community alongside a permanent installation.

We will reprise temporary projects at Seattle Center, and assist Parks with activation projects. We will continue work on projects downtown and in the Central Area with Seattle Parks and Recreation. We are strengthening existing relationships with city departments with our shared position in the Seattle Department of Transportation. The Move Seattle levy offers several opportunities for projects throughout Seattle's neighborhoods, while the Center City Artist-in-Residence will survey initiatives in downtown core and make recommendations to overlay a unifying approach to various design projects. The creation of green streets and greenways offer opportunities in outlying neighborhoods. We continue to develop both signature permanent commissions funded through the Elliott Bay Seawall rebuilding and promenade development through the Office of the Waterfront.

In all our endeavors, we collaborate with stakeholders, community, city staff, the Public Art Advisory Committee and Seattle Arts Commission. The Public Art Program is a resource both internally within the city and externally to the community. We will provide assistance with citywide initiatives that address growth, public safety and positive use of public space.

In addition to our core line of work, implementing the 1% ordinance, the Public Art Program continues to curate exhibitions, rotate portable works and maintain our collection. We are currently managing five galleries: Seattle Municipal Tower, Ethnic Heritage Art Gallery, Seattle Presents, Seattle City Hall and the Mayor's Office (accessible during meet-the-artist events). As the office looks to relocate to King Street Station, we will also look to opportunities to program public spaces at the historic facility.

Our program provides degrees of technical assistance to groups within and outside of the city. We are a resource for other city departments and actively participate in interdepartmental teams to shape the city's work in building infrastructure and active public spaces. As we move forward in 2016 and upcoming years, we will look to the Office's and the Seattle Arts' Commission's strategic and work plans to inform and shape our work.

2016 Municipal Art Plan

Introduction/Process

The Public Art Program of the Office of Arts & Culture seeks to enrich the lives of Seattle's residents by providing diverse public art experiences. The mission of the Public Art Program is to integrate artworks and the ideas of artists into a variety of public settings and displayed in spaces and places accessible to community members as they participate in the activity of the city and engage in public life. The program will develop artwork projects with the objective of expanding the experience of residents and visitors alike with art in its many expressions, contributing to a sense of place and the city's identity. The city will recognize the diversity of Seattle's communities and will seek to distribute its art opportunities and optimize creative placemaking throughout Seattle. The Municipal Art Plan seeks to provide increased opportunities for professional artists at all levels of development to put their work before the public, and to participate with community members when doing so. The program will partner with other city departments on major and neighborhood planning and activation initiatives, while continuing to track opportunities within the annual Capital Improvement Program process. With respect to the utility departments, the planning process will ensure that the artwork projects have sufficiently close "nexus" to the utilities' missions. Wherever possible, sites for artwork projects will be identified at the planning or early development stages in order that artwork projects can be effectively and economically integrated through planning and implementation concurrent with site development.

Municipal Art Plan

The Municipal Art Plan (MAP) describes the status of continuing public art projects and establishes budgets for new public art projects for the Public Art Program of the Office of Arts & Culture. The Seattle Municipal Code requires that one percent of eligible city capital improvement program funds from select city departments be placed in the Municipal Art Fund for the purchase and commissioning of artworks. The Office of Arts & Culture manages the fund and the program and prepares, adopts and amends the annual MAP. Funding sources for 1% for Art projects include voter-approved levies, eligible capital improvement project revenues, transferred construction funds and special funds such as grants. In late December 2005, a Washington State Court of Appeals ruling modified a 2004 lower court ruling on the use of Seattle City Light funds, and by extension Seattle Public Utilities funds, as related to participation in the 1% for Art program. Based on the Court of Appeals' ruling, both Seattle City Light and Seattle Public Utilities will continue to be mandated to participate in the 1% for Art Program, provided that the funds be spent on artwork projects that had a "sufficiently close nexus" to the mission and work of the utilities." The Office of Arts & Culture developed a policy that outlines appropriate applications of the utilities' 1% for Art funds.

Projects generated through the MAP also have the potential to leverage investment by other government entities, as well as private donors, foundations and community groups. In recent years, projects initiated by the Office of Arts & Culture have utilized non-1% for Art funds from city departments, Sound Transit, King County as well as private developers such as Triad Development.

The Public Art Program director and staff participate in city planning efforts and meet frequently with representatives from each of the city departments throughout the year to discuss capital improvement plans and how the Public Art Program can reinforce the city's work. Public art staff reviews Capital Improvement Plans with departmental staff to identify appropriate locations of

public art and prioritize projects that will meet the goals of the city and the department. Artworks are related to the capital improvement projects or the ongoing work of the department and are located in places that are publicly accessible, usually on city-owned property. Once the work with city departments is completed, funding allocations and recommendations are presented to the Public Art Advisory Committee (PAAC), a standing committee of the Seattle Arts Commission that gives advisory input to staff to fine tune final recommendations for the annual MAP. Following PAAC review, the plan goes to the full Arts Commission for consent approval. Throughout the year, changes to the City's Capital Improvement Program occur. These changes may alter the scope and budget of projects based on changes in funding and/or policy priorities. Furthermore, public art program goals and priorities may change over the course of the year, affecting the focus of some of the projects. Such adjustments to funding are identified and reflected in the MAP in the subsequent year.

Artist and Artwork Selection

The Office of Arts & Culture has established procedures for artist and artwork selection that closely mirror other City of Seattle contracting procedures. Most artist commissions and artwork purchases are conducted on a competitive RFQ basis. In practice, at least half of the funds are allocated to artists living in the Pacific Northwest. The competitive methods used for artist and artwork selections include open calls for artists, invitational calls, rosters, and modified direct selection of artists. Panels of qualified arts professionals, community members, design team members and city department representatives review the applications of all competitors and provide recommendations to staff.

Open calls for artists are requests for qualifications that are advertised regionally, nationally or internationally. Invitational calls solicit qualifications or proposals from artists with specific areas of focus who have been nominated by experts with knowledge in the pertinent area. Pre-qualified artist rosters are created through a publicly advertised competition and a subsequent review of qualifications. Direct selection of artist or artworks, a method which is used sparingly, is typically confined to purchases or commissions where a very specific type of art is purchased (e.g., a totem pole), a certain expertise is needed or project continuity may be required. At the conclusion of the artist-selection process, artists who are recommended by the selection panel can be awarded a contract or their artworks can be purchased upon the recommendation of the Public Art Advisory Committee. All final decisions are subject to approval of the director of the Office of Arts & Culture.

MAP Overview

The first table on page XX outlines the funding sources and appropriations for 2016. We start with the 1% for Art figures included in the proposed budget. Adjustments to revenue are made based on changes in the adopted budgets, true-ups for the prior year, etc. A list of MAP amendments is also included; these amendments do not affect revenue for 2016. This year, we will be assessing a 15% overhead and administrative charge on all incoming 1% for Art revenue. The balance of funds will be allocated to projects for artist fees and project management.

Revenues are collected in the spring of each year; we invoice based on adjustments to the proposed budget. However, we invoice the utilities quarterly; the 1% for Art dollars are based on actual expenditures.

The second table lists active and upcoming 2016 projects and shows prior years' allocations, allocation of 2016 1% for Art funds, reallocations of older funds, current project total and estimated total project cost. The funding table column descriptions are given below.

The body of the MAP describes all ongoing projects and new projects anticipated to begin this funding year and are grouped according to the funding source department. Each project lists the proposed selection method for the artist and geographical eligibility of applicants. If the project is underway, the commissioned artist is listed. Funding indicates LTD allocations, additional details are found in the second table. This year, we will start each section with new projects, followed by 2015 MAP amendment projects and then describe older ongoing projects.

Prior Allocations

This column shows all funding that has been allocated to the project prior to 2016 as noted on accounting's summary reports. This is not a life-to-date expenditure figure. Contingencies will be monitored on a project level. Any funds remaining after a project is concluded is reallocated to other projects.

2016 Allocations

The figures in these columns indicate the amount of 2016 1% for Art funds allocated to each project. When calculating allocations to Seattle Public Utilities' artwork projects, we reduce projected revenue by 25% to reflect an accomplishment rate of 75% of budget (for the utilities, we collect 1% for Art funds on actual expenditures, not on budgeted figures). Where applicable, the reallocation column indicates prior years' funds that have moved into a current project from other projects or unprogrammed funds.

Current Project Total

This column, which is not shown on all tables, shows current funding amount through 2016. It is anticipated that a few projects may continue to receive additional allocations in future years, in which case the estimated project total column (see below) will reflect projected total funding for the project. Project allocations include project management and administration; we calculate artist fees and artwork costs as approximately 75% of project total.

Estimated Project Total

This column shows the total anticipated funding for the project.

Other Activities

The Municipal Art Plan is intended to provide a description of public art projects that are supported with 1% for Art funds (and/or by separate memorandum of agreement with departments). However, there are additional activities that the Public Art Program performs that are funded with sources other than 1% for Art and which are not included in this document.

In addition to the projects described here, the Public Art Program manages the city's Portable Works collections, rotating, repairing and stewarding artworks that are displayed on the walls of city facilities. The program provides collection management services with funds received from the utilities and Finance General.

The Public Art Program also has an extensive conservation program to repair and restore damaged artworks and to provide ongoing maintenance and stewardship of both the permanent and portable artworks in the city's collections; this work historically has been funded by allocations from the Cumulative Reserve Subfund.

In addition, the Public Art Program provides technical assistance and advice to departments, communities and others on a range of issues and activities related to art in the public realm. We offer trainings, workshops and panels, host events to celebrate our work or create dialog, and provide support to activities that advance the field of public art.

2016 MAP Individual Project Descriptions

Seattle City Light

Seattle City Light, after several years of slow activity, has begun to reassert its role as a funder of innovative art projects in a way that recalls its support in the early years of the public art program. In conjunction with the construction of the new Denny Substation, several large artwork projects will be integrated into the facility and its site. In addition, we have been partnering on projects that bring attention to alternative sources of energy, namely, solar power.

The artwork projects to which 1% for Art funds are allocated must have a “sufficiently close nexus” to Seattle City Light’s primary mission and purpose.

Projected funds to be allocated: \$873, 483

We will be putting these funds into the Denny Substation Project, as the two permanent projects each have budgets in that range.

The artwork projects to which 1% for Art funds are allocated must have a “sufficiently close nexus” to Seattle City Light’s primary mission and purpose.

Ongoing Projects

Denny Substation (previously, North Downtown Facility)

South Lake Union

Phase 1: Temporary art events: *All Rise* - Complete

Meagan Atiyeh and Elizabeth Spavento, curators, Portland, OR

Before the future substation construction began, a curated series of installations, performances and presentations activated the site and brought attention to the location as a community asset. *All Rise* began with poetry and text-based art, continued with dance performances, a light installation and a variety of art experiences by regional artists and performers. This project was recognized in the Americans for the Arts 2016 Public Art Network Year in Review, in a unanimous decision by the jury.

Selection	Eligibility	Current Project Total	Estimated Project Total
Open Call	Washington and Oregon	\$355,932	\$355,932

\$500 from General Interest

Phase 2: Substation

Ned Kahn, Sebastapol, CA;
Lead Pencil Studio, Daniel Mihalyo and Annie Han,
 Seattle, WA

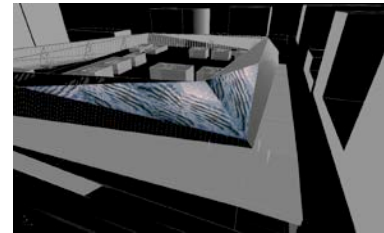

Ned Kahn

In conjunction with the building of the new facility designed by NBBJ, Ned Kahn will install *Switchwall*, a series of wind-activated switches and lights in the skin of the south-east corner of the substation. In addition, Lead Pencil Studio will create *Transforest*, three towers that communicate the natural beauty of the Pacific Northwest and the history of power generation and transmission.

Selection	Eligibility	Current Project Total	Estimated Project Total
Open Call	National	\$1,883,384	\$1,883,384

Georgetown Steam Plant Temporary Project

Artist TBD
 Georgetown

Several artists will be commissioned to create site-specific installations/performance or commissioned sound/music artwork related to the utility’s mission at Seattle City Light’s Georgetown Steam Plant facility. Due to timeframe of renovation of the Steam Plant, this project may be deferred and its funds reallocated.

Selection	Eligibility	Current Project Total	Estimated Project Total
Open Call	National	\$120,000	\$120,000

Seattle City Light Technical Training Center

Katy Stone, Seattle, WA
 South Park/Unincorporated King County

Katy Stone will work with Schact Aslani Architects to design a sited-artwork for this new training center. The capital project is on hold.

Selection	Eligibility	Current Project Total	Estimated Project Total
Roster	National	\$125,000	\$125,000

Seattle City Light T-117 Adjacent Streets

Kristin Tollefson, Seattle, WA
 South Park

Kristin Tollefson is working with the Port of Seattle to design a park along the Duwamish at Terminal 117. Seattle City Light is remediating an adjacent site, landscaping and creating new streetscape. The artist will design streetscape elements that highlight the utility’s work in environmental stewardship.

Selection	Eligibility	Current Project Total	Estimated Project Total
Direct Select	Northwest	\$60,000	\$60,000

Seattle City Light Awareness Project/Solar

Britta Johnson, Seattle, WA
Tivon Rice, Seattle, WA
SuttonBeresCuller Seattle, WA



SuttonBeresCuller

This project has engaged several artists to create projects in different media, for placement throughout the city, to bring awareness to renewable energy that Seattle City Light supports, in addition to conservation, renewable energy, restoration of salmon habitat. Each artist will use solar power in his/her artwork.

Selection	Eligibility	Current Project Total	Estimated Project Total
Open Call	Washington State	\$300,000	\$300,000

Multiple Funding Details

SCL 1% ^s	\$200,000
SCL Renewable Energy	<u>\$100,000</u>
Total	\$300,000

North Service Center Expansion

Scott Trimble
 Licton Springs

Scott Trimble is working with Seattle City Light crews and its salvage yard to create site-specific artwork at two sites at the North Service Center.

Selection	Eligibility	Current Project Total	Estimated Project Total
		\$120,000	\$120,000

Pollinator Pathway

Sarah Bergmann
 SE Seattle

This project is conducted in partnership with Seattle City Light. Artist Sarah Bergmann will work with Seattle City Light to develop criteria to create a Pollinator Pathway under Seattle City Light's transmission lines in South Seattle. The project will also investigate opportunities for community engagement. This project is funded with 1% for Art interest funds.

Selection	Eligibility	Current Project Total	Estimated Project Total
Direct	Seattle	\$50,000	\$50,000

Unprogrammed

2016 funds are placed here temporarily until projects are developed with Seattle City Light.

Selection	Eligibility	Current Project Total	Estimated Project Total
		\$68,588	n/a

Seattle Public Utilities

Seattle Public Utilities, primarily due to its work on Combined Sewer Outflows, provides much of 2016's 1% for Art funds. Its three lines of business, Water, Drainage and Wastewater, and Solid Waste, offer a range of opportunities for artists. One of the goals shared by SPU and Arts is a commitment to the city's Race and Social Justice Initiative, as well as providing opportunities for emerging and diverse artists. We hope to explore a new range of project types that expand the notion of public art while bringing awareness to the services, facilities and projects the utilities provide its ratepayers.

Seattle Public Utilities 1% for Arts funds come from three sources: Water, Drainage and Wastewater, and Solid Waste. The artwork projects to which the 1% for Art funds are allocated must have a "sufficiently close nexus" to Seattle Public Utilities' primary mission and purpose.

SPU continues to fund purchases of portable artworks, typically funded jointly by DWU and Water funds.

Drainage Fund

Drainage and Wastewater fund:

Projected funds to be allocated: \$417,311

There is a substantial amount of prior years' funding Drainage and Wastewater.

We will use some of these funds to support projects that are being developed out of the Artist-in-Residence's art plan. Many of the artworks will be related to the Ship Canal Water Quality project. There may be several pump stations that will be locations for artworks.

SPU is also interested in projects that capture and share stories of the community. One project that has been proposed is "Artists in Engagement Program: Stories of Water" working with SPU's SPU Environmental Justice and Service Equity division. The artist will work with community and community based organizations for up to three years, and will propose projects for other artists. The PAAC has suggested considering the use of stencils to disseminate messages regarding environmental drainage stewardship.

Drainage Fund 2015 Amendment Projects

Poetry on Buses: Your Body of Water

Jourdan Keith, Seattle, WA

This project uses funds reallocated from Engaging Community. Ideas from that project will also inform implementation projects from the Drainage Artist-in-Residence's art plan.

Poetry on Buses is an ongoing program of 4Culture and engages communities (including immigrant communities in their native language) to contribute poems for display on Metro Bus routes. The theme will focus on water.

The city is working in partnership with these two agencies, which each contribute \$100,000 (these funds do not pass through to the city). Community workshops provide an opportunity for SPU to disseminate information about its services. City funding will be restricted to those bus routes that serve SPU's service

area.

Poetry on Buses will be informed by the city's Race and Social Justice Initiative as implemented by SPU's Environmental and Social Justice staff.

Selection	Eligibility	Current Project Total	Estimated Project Total
Invitational	NW	\$100,000	\$330,000

Multiple Funding Details

DWU 1% ^s	\$100,000
Water 1%	\$ 30,000
4Culture	\$100,000
Sound Transit	<u>\$100,000</u>
Total	\$330,000

Drainage Fund, New Projects

12th and Elmgrove Park

Ben Zamora, Seattle, WA

South Park

S Riverside Drive and 7th Avenue S

Artist Ben Zamora will work with a landscape architect and the South Park community to develop a sited artwork on a small site owned by SPU along the Duwamish River

Selection	Eligibility	Current Project Total	Estimated Project Total
Emerging Artist Roster	Northwest	\$60,000	\$60,000

24th Avenue NW Pier (Ballard Conveyance Pier)

Christian French, Seattle, WA

Ballard

24th Avenue NW and Shilshole Avenue

Artist Christian French will create insets to be embedded onto the conveyance pier (which will eventually become a more public pier) that celebrate the many histories of the site. SPU will be building the conveyance pier during the construction of the Ship Canal Water Quality Project. (Drainage Artist in Residence Art Plan Project)

Selection	Eligibility	Current Project Total	Estimated Project Total
Emerging Artist Roster	Northwest	\$60,000	\$60,000

2016 Portable Works Purchase: Poetry on Buses

Artists TBD

This purchase complements the Poetry on Buses project. Artworks that respond to the theme of Poetry on Buses, *Your Body of Water*, will be purchased, and selected images may appear where poetry is displayed (buses, bus shelters for Rapid Ride stops). In addition, artworks may be displayed in city offices alongside selected poems.

Selection	Eligibility	Current Project Total	Estimated Project Total
Open Call	Northwest* (\$80,000	\$80,000

* Washington, Oregon, British Columbia, Montana, Idaho or Alaska.

Northwest Wonders: Portable Works Purchase

Artists TBD

This purchase will use a curated invitational selection process to add artworks to the collection that display a broad representation of northwest art.

Selection	Eligibility	Current Project Total	Estimated Project Total (all fund sources)
Invitational	Northwest* (\$150,000	\$150,000

* Washington, Oregon, British Columbia, Montana, Idaho or Alaska.

Safe Lots Engagement

Path with Art

Yankee Diner Site, Ballard

Seattle Public Utilities owns a property that, prior to being used for construction of the Ship Canal Water Quality Project, was offered to the Human Services Department to use as a Safe Lot for people who live in their vehicles to park in. In conjunction with several non-profit agencies, Path with Art, a non-profit organization that uses teaching artists to provide classes for the homeless, will engage the residents with different art activities three times a week for three weeks until the Safe Lot is closed.

Selection	Eligibility	Current Project Total	Estimated Project Total
Direct Select	Seattle	\$30,000	\$30,000

Artists in Engagement Program: Stories of Water

Artists TBD

A lead Artist in Engagement will work with the Environmental Justice and Social Equity division of SPU, and other curated artists in communities to develop projects that resonate with the participants and bring awareness to environmental issues that SPU is addressing. This project will be informed by the city's Race and Social Justice Initiative, and, along with Poetry on Buses, will absorb the goals of Engaging Community (see below).. (Drainage Artist in Residence Art Plan project)

Selection	Eligibility	Current Project Total	Estimated Project Total
TBD	TBD	\$240,000	\$240,000

Unprogrammed

These funds will be reserved for additional projects as they develop related to the drainage and wastewater fund. Projects may be added as 2016 Amendment projects.

Potential projects include: pumpstations and other sites along the Ship Canal Water Quality Channel, a project related to the first residents of Salmon Bay, Lake City Crossings. Some of these may be addressed by the Artist-in-Residence.

Selection	Eligibility	Current Project Total	Estimated Project Total
n/a	n/a	\$621,599	\$TBD

Drainage Fund, Ongoing Projects

South Park Drainage Project

Horatio Law, Portland OR
 South Park
 S Riverside Drive and 7th Avenue S



Horatio Law installed his sculpture South Park Vortex within the natural drainage facility managed by SPU at Marra Farms. The artist worked with community members to create the unique snowflake designs in the glass. The artwork enhances the work place for SPU employees and will provide insight into natural storm water drainage to other passersby in the vicinity. A second community engagement project that brought awareness to drainage issues by following the route of construction took on the form of a cocoon-shaped temporary sculpture on which were attached braids created by the community (*Crisalida*, above). The project will culminate in a community celebration with activities that bring awareness to hydrology and drainage issues.

Selection	Eligibility	Current Project Total	Estimated Project Total
Open Call	Northwest	\$250,000	\$250,000

Midvale

Artist TBD

One or several artists will be commissioned to create site-specific artworks. This project, or a replacement project if this site becomes unavailable, will be aimed at emerging artists.

Selection	Eligibility	Current Project Total	Estimated Project Total
Open Call	Pacific NW	\$150,000	\$150,000

Swale on Yale

Artist TBD

South Lake Union
 Yale Avenue N. between Thomas and Republican Streets

SPU installed a natural drainage system near new development on Yale Avenue North across from Cascade Park. This project has been in development for a number of years, and received reallocations from a completed SPU drainage project. No work on art occurred by the end of 2009 and these funds were reallocated to an existing drainage funded project. In 2011 SPU revived interest in an art project but no work has commenced. If this project proceeds, the artwork will provide interpretive information to enhance the viewer's understanding of SPU's mission and techniques for natural drainage. Funds may also be allocated elsewhere, or put towards temporary projects.

Selection	Eligibility	Current Project Total	Estimated Project Total
-----------	-------------	-----------------------	-------------------------

Open Call or roster	Northwest	\$200,000	\$200,000
---------------------	-----------	-----------	-----------

CSO/Southwest Projects 2013

North: **Matthew Geller**, Brooklyn, NY
 South: **Rebecca Cummins**, Seattle, WA, (at right, complete)
 Southwest Seattle



Rebecca Cummins installed viewers made of pipe valves that allow the visitors to survey the surroundings of the detention tank near Westwood Village. The site for Matthew Geller’s original proposal became unsuitable and a new site is being negotiated. Geller’s project will address the relationship between water flow and drainage..

For the time being, the two smaller scale rain garden projects listed in previous MAPs will be removed.

Selection	Eligibility	Current Project Total	Estimated Project Total
Open Call (N) Roster (S)	Northwest/National	\$400,000	\$400,000

North	\$250,000
South	\$150,000
Total	\$400,000

Urban Watershed Film
Artists TBD

We will work with SPU to scope an opportunity for filmmakers to address the urban watershed that SPU stewards. These funds may be reallocated to other projects in r 2016.

Selection	Eligibility	Current Project Total	Estimated Project Total
Open Call	Northwest/ Seattle	\$100,000	\$100,000

Engaging Community (funding reallocated to Poetry on Buses)
Artists TBD

The goals of this project, to work with SPU to develop projects that engage artists in underserved and immigrant communities and also bring awareness to issues of drainage and wastewater to those communities, will be absorbed into other projects such as Poetry on Buses and Artist in Engagement.

Selection	Eligibility	Current Project Total	Estimated Project Total
Open Call	Northwest/Seattle	\$0	\$0

SPU Development Services Floor

Artist TBD

This project will commission a semi-permanent large scale portable artwork for the entry area on the 27th floor of Seattle Municipal Tower. This artwork will be funded equally by Drainage and Wastewater and Water funds

Selection	Eligibility	Current Project Total	Estimated Project Total
TBD	TBD	\$35,000	\$70,000

Multiple Funding Details

DWU 1% ^s	\$35,000
Water 1%	<u>\$35,000</u>
Total	\$70,000

SPU Green Infrastructure & Waterways: Artist-in-Residence & Art Master Plan (Drainage Artist-in Residence)

Vaughn Bell, Seattle, WA

During a six-month residency, Vaughn Bell will develop an understanding of SPU's Drainage and Wastewater (DWW) work and develop an art master plan to guide future public art commissions integrated into SPU's DWW projects (e.g., combined sewer overflow prevention, pollutant reduction, water quality improvement).with a large focus on the Ship Canal Water Quality project. The artist will also be asked to address the Windermere CSO and may consider engaging youth at Sandpoint to develop a project. The initial commission for residency, master plan and implementation project is \$70,000. Additional funds may be added to this project for further implementation by the artist in residence and other artists. Much of the funding for this project comes from the Ship Canal Water Quality Project.

Most funds for implementation will be placed in the residency project for the time being.

Current Projects

Residency and Art Plan and some implementation	\$400,000
24 th Avenue NW Pier (Ship Canal Water Quality Project)	\$60,000
Artists in Engagement: Stories of Water	\$240,000

Potential Projects with suggested funding amounts include:

Artists in Basin: Delridge and Lake City	\$100,000
Ship Canal Water Quality Project Pump Houses	\$300,000
Ship Canal Water Quality Project Cultural History	\$250,000
Ship Canal Water Quality Project Temporary Projects	\$50,000

Selection	Eligibility	Current Project Total	Estimated Project Total (including implementation)
Open Call	Washington and Oregon	\$400,000	\$3,000,000 TBD

Water Fund,

Projected funds to be allocated: \$51,064

These funds and existing unprogrammed funds will be allocated to ongoing projects, such as Poetry on Buses and Cedar River Administration Building. In 2017 and 2018, there will be somewhat higher levels of funding and there is interest in creating a project related to the 23rd Avenue corridor improvements (Central Area Water Main). SPU is interested in highlighting the history of the community and its people of color.

Water Fund, 2015 Amendment Projects

Poetry on Buses: Your Body of Water

Jourdan Keith, Seattle, WA

This project uses funds reallocated from Engaging Community. Ideas from that project will also inform implementation projects from the Drainage Artist-in-Residence’s art plan.

Poetry on Buses is an ongoing program of 4Culture and engages communities (including immigrant communities in their native language) to contribute poems for display on Metro Bus routes. The theme will focus on water.

The city is working in partnership with these two agencies, which each contribute \$100,000 (these funds do not pass through to the city). Community workshops provide an opportunity for SPU to disseminate information about its services. City funding will be restricted to those bus routes that serve SPU’s service area.

Poetry on Buses will be informed by the city’s Race and Social Justice Initiative as implemented by SPU’s Environmental and Social Justice staff.

Selection	Eligibility	Current Project Total	Estimated Project Total
Invitational	NW	\$30,000	\$330,000

Multiple Funding Details

DWU 1% ^s	\$100,000
Water 1%	\$ 30,000
4Culture	\$100,000
Sound Transit	<u>\$100,000</u>
Total	\$330,000

Water Fund, Ongoing Projects

SPU Development Services Floor

This project will commission a semi-permanent large scale portable artwork for the entry area on the 27th floor of Seattle Municipal Tower. This artwork will be funded equally by Drainage and Wastewater and Water funds .

Artist TBD

Selection	Eligibility	Current Project Total	Estimated Project Total
TBD	TBD	\$35,000	\$70,000

Multiple Funding Details

DWU 1% ^s	\$35,000
Water 1%	<u>\$35,000</u>
Total	\$70,000

Cedar Falls Administration Building

Wayne Chabre, Walla Walla, WA
North Bend, WA

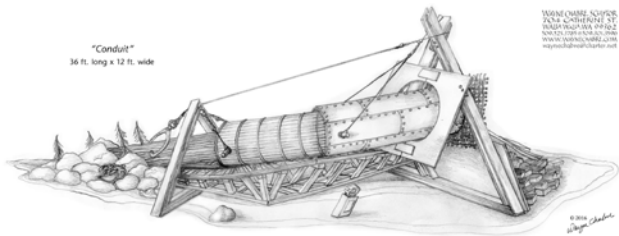

Wayne Chabre has been working with architects Shacht Aslani and staff at the Cedar River Watershed to create a site-specific exterior artwork for a new Cedar Falls Administration Building using natural materials found in the watershed. If applicable, this artist, or another one may be commissioned to design furniture for the facility (fabrication paid for by SPU). The artwork commission is \$75,000.

Selection	Eligibility	Current Project Total	Estimated Project Total
Open call	Washington State	\$100,000	\$100,000

Central Area Water Main

Artist TBD

This project will focus on water supply issues within the community in the Central Area along 23rd Avenue where water main work is occurring. Reallocated funds from Water outreach project, 2017 funds.

Selection	Eligibility	Current Project Total	Estimated Project Total
Open Call	Northwest	\$0	\$200,000

Cal Anderson Park Pump House Youth Engagement

Nathan Herth, Seattle, WA
Capitol Hill



A teaching artist, Nathan Herth, worked with youth in after-school programs located in a middle school and coordinated by Seattle Parks and Recreation staff to create a series of temporary “canvases” to be placed inside the niches of the pump house at Cal Anderson Park. One set of projects was installed for six months starting in spring of 2016; another set is slated for winter 2016. This project may be continued in the future after an assessment is made and funds are identified.

Selection	Eligibility	Current Project Total	Estimated Project Total
invitational	Washington State	\$55,000	\$55,000

Landsburg Park and Mentorship

Roger Fernandes, Ravensdale, WA

Mentorees: Al Charles, Sean Gallegher, Odin Lonning, John Mullen, Nahaan, Valerie Segrest

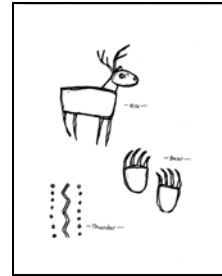

SPU’s Landsburg Facilities site includes a Water Operations and Treatment Facility, the Cedar River Sockeye Hatchery and Landsburg Park. While SPU undertakes its Facilities and Chlorination project in Ravensdale, WA, Roger Fernandes created petroglyph artworks to enliven the visitor experience at the park in Coast Salish style. The artwork will be slightly relocated, with the artist’s participation within the park per SPU’s request.

In 2014, we expanded this project to include a component where Fernandes has been mentoring six artists from local tribes.

Selection	Eligibility	Current Project Total	Estimated Project Total
Open Call	Regional	\$115,000	\$115,000

Urban Farming Residency

Nicole Kistler, Seattle, WA

Beacon Food Forest

Beacon Hill



This multi-department project included extensive research, an art plan for art at various city-wide urban farming locations and proposals for temporary art activation. Kistler will create a permanently-sited project at Beacon Food Forest. She will work with community members to include stories of urban gardening in the artwork.

Selection	Eligibility	Current Project Total	Estimated Project Total
Direct selection	Seattle	\$200,000	\$200,000

Multiple Funding Details

Parks	\$15,000
SPU	<u>\$185,000</u>
Total	\$200,000

Water Conservation Outreach Project/Engaging Community (Poetry on Buses)

Artists TBD

This project will be informed by the city’s Race and Social Justice Initiative. We will work with SPU to develop projects that engage artists in immigrant and underserved communities and also bring awareness to issues of water conservation to those communities. Some Funds in this project will be

reallocated to Poetry on Buses. Remaining funds may be used for other social engagement or youth education opportunities.

Selection	Eligibility	Current Project Total	Estimated Project Total
Open Call	Northwest/ Seattle	\$45,000	\$0TBD

Unprogrammed

Future Water funds will be allocated to Central Water Main projects.

Selection	Eligibility	Current Project Total	Estimated Project Total
		\$11,923	n/a

Solid Waste Fund,

Solid Waste Fund

Projected funds to be allocated: \$196,057

Some Solid Waste funds may be directed to the South Transfer Station Phase 2 project. Some prior funds will have to be directed towards a safety retrofit of the North Transfer Station project.

Solid Waste Fund, Ongoing Projects

South Recycling and Waste Disposal (Transfer) Station Phase II

Adam Kuby, Portland, OR
South Park

SPU will add a recycling center in South Park, Artist Adam Kuby will develop a permanent project for the publically accessible areas of the South Recycling and Disposal Station Rebuild Project site, located in the South Park neighborhood of Seattle.

Selection	Eligibility	Current Project Total	Estimated Project Total
Open Call	National	\$330,000	\$330,000

North and South Recycling and Waste Disposal (Transfer) Stations

Carol dePelecyn, Seattle, WA

Jean Shin, New York, NY

South Park and Wallingford



Jean Shin

SPU has rebuilt its South Transfer Station, where it will add a recycling center, and it will rebuild its North Transfer Stations. Carol dePelecyn created a permanent artwork for the South Transfer Station, an homage to the South Park bridge, parts of which were used in the two-part sculpture. She will create a temporary project for the new facility or a project at the recycling center. Jean Shin used rebar removed from the old north facility when it was demolished and created a sculpture that reflects the historic topography of the area. Additional work will occur at the North Transfer Station in 2016 to adjust Shin's artwork. Carol dePelecyn will create a film about the South Park Bridge to be shown in the facility's public viewing room.

North Transfer Station

Selection	Eligibility	Current Project Total	Estimated Project Total
Open Call	Northwest and California' National	\$641,256	\$641,256

South Transfer Station

Selection	Eligibility	Current Project Total	Estimated Project Total
Open Call	Northwest and California	\$520,662	\$520,662

Transfer Stations (including South Phase II) total

Selection	Eligibility	Current Project Total	Estimated Project Total
Open Call	National	\$1,369,918	TBD

Unprogrammed

These funds may be allocated to transfer stations as needed, or new projects developed as 2016 amendment projects.

Selection	Eligibility	Current Project Total	Estimated Project Total
		\$130,929	n/a

Department of Finance and Administrative Services

Since 2004, most of the work for the Department of Finance and Administrative Services has focused primarily on integrating art into the 2003 Fire Facilities and Emergency Response Levy projects, including Fire Station 10 replacement, Joint Training Facility and Neighborhood Fire Station projects. With nine neighborhood fire stations complete, one in design and one in fabrication, only one new station remains to be rebuilt. The North Police Precinct will create a new and different opportunity.

Ongoing Projects

Fire Facilities and Emergency Response Levy Program

In 2003, Seattle voters passed a \$167 million Fire Facilities and Emergency Response Levy that included a Joint Training Facility, a new command center, a number of new fire stations and improvements to existing stations. Council approved approximately \$60 million additional for the project in 2006.

Joint Training Facility

Roberto Rovira, Miami, FL

South Park

9401 Myers Way S

Before the Fire Facilities and Emergency Response Levy was approved, the city began work on a Joint Training Facility Project that has been partly funded by the levy. In 2003, the Office of Arts & Culture selected artist Roberto Rovira (originally of California) to participate on the design team for the Joint Training Facility, a major training facility for transportation workers, firefighters and utility workers on the site of an abandoned gravel pit in South Park. The facility, completed in 2007, minimizes impermeable surfaces, recaptures water and features a high level of sustainable design. Rovira is creating a site-integrated artwork that reflects the facility's sustainable design and honors the work of the trainees. The project was temporarily on hold; the artwork will be installed in 2016.

Selection	Eligibility	Current Project Total	Estimated Project Total
Invitational	Western United States	\$343,957	\$343,957

Neighborhood Fire Station Program

In 2005, the Office of Arts & Culture worked collaboratively with the Seattle Fire Department and the then Fleets & Facilities Department (DFAS) to develop a program to incorporate exterior artworks at new fire stations that would both speak to the fire fighters and engage the community. In 2006, the Office of Arts & Culture created, through selection, a pre-qualified Artist Roster for the Neighborhood Fire Station Program. The first seven commissioned artists were selected from the roster. Starting in 2009, all subsequent levy project artists have been selected through open calls. Initially, seven fire stations were identified as potential locations for the incorporation of artwork. With the addition of council approved funds, artwork will be placed at all "rebuild" (new) fire stations. Fire Station 10 was handled as a distinct project.

Citywide

- Fire Station 28, Rainier Beach, Wayne Chabre**, Pullman, WA, 2010
- Fire Station 30 Mt. Baker, Brian Goldbloom**, Amboy, WA, 2013
- Fire Station 35 Crown Hill, Kay Kirkpatrick**, Seattle, WA, 2010
- Fire Station 37 West Seattle High Point, Pete Beeman**, Portland, OR, 2010
- Fire Station 38 Ravenna/Bryant, Mel Katz**, Portland, OR, 2010
- Fire Station 39, Lake City, Steve Glassman**, San Jose, CA, 2009
- Fire Station 21 Greenwood, Perri Lynch**, Seattle, WA, 2011
- Fire Station 6 Central, Steven Gardner**, Seattle, WA, 2012
- Fire Station 9 Fremont, Peter Reiquam**, Seattle, WA 2013
- Fire Station 20 Queen Anne, Rob Ley**, Los Angeles, CA started 2014
- Fire Station 32 West Seattle Junction, Sean Orlando**, Oakland, CA, started 2012
- Fire Station 22 Roanoke, Oliver Hess**, Los Angeles, CA, started 2014

Selection	Eligibility	Current Project Total	Estimated Project Total
Roster and Open Call	Northwest and California	\$1,562,292,	\$1,562,292

Intended \$1,635,030 less admin and contingency over time

North Police Precinct

Nickolaus Hafermaas, Los Angeles, CA
Bitter Lake

Dues to changes in the design of the building, the artist has been asked to redesign his artwork. The construction project is awaiting funding. This commission may be divided into a permanent commission and another project that directly engages community.

Selection	Eligibility	Current Project Total	Estimated Project Total
Open Call	National	\$139,910	\$760,000 TBD

Civic Square Construction Fencing Project

Hebru Brantley, Chicago, IL
Hollis + Lana, (Conor Hollis and Amorette Lana) Denver, CO
Joseph Park and Claude Zervas, Seattle, WA

Downtown
4th Avenue and Cherry Street

The Office of Arts & Culture, in partnership with DFAS and Triad Development, embarked on a series of temporary projects to activate the construction fence around the Civic Square site. Two rounds of existing images from emerging artists were digitally transferred to large format for temporary display on the construction fence. In 2014, three artists, selected based on commissioned proposals, painted images directly on the construction fence. Triad Development provided funding for these projects, \$40,000 per year. Listed below are artists whose work appeared on panels on the fence. The artworks will remain until a decision is made about who will develop the site.

<p>Artists (selected 2010): Laura Castellanos, Seattle WA Anna Mia Davidson, Seattle WA John Fleming, Seattle WA Mark LaFalce, Seattle WA</p>	<p>Artists (selected 2012): Bo Choi, Seattle WA Susan Danielson, Seattle WA Jenny Filius, Seattle WA Macek Jozefowicz, Seattle WA</p>
--	--

Maria Meneses , Seattle WA Scott Schuldt , Seattle WA Kate Sweeney , Seattle WA Patrice Tullai , Seattle, WA	Jesse Link , Seattle WA Eddy Radar , Seattle WA Harry von Stark , Seattle WA
---	---

Selection	Eligibility	Current Project Total	Estimated Project Total
Open call and by invitation	Seattle	\$173,037*	TBD

* This represents the amount provided by Triad Development to date.

Seattle Center

We partner with Seattle Center in many ways. In 2014, 2015 and 2016, the Seattle Center transferred funds for temporary public art projects, managed through the office, intended to activate the campus.

Projected funds to be allocated: \$12,100

2016 funds will backfill for the KEXP mural project. We expect that in the future we will receive a small allocation from the city's contribution to the Opera House expansion (Mercer Arena). The desire is to celebrate the new rehearsal facility's opening with a series of three temporary installations.

New Projects

Seattle Opera/Mercer Arena

Artists TBD

Uptown

Mercer Street and 4th Avenue N

This project is a public/private partnership to renovate the Mercer Arena as rehearsal space and administrative offices for the Seattle Opera. Three successive temporary projects will activate the project from the opening celebration onwards.

Selection	Eligibility	Current Project Total	Estimated Project Total
Open call or rosterl	NW	\$0	\$35,000

Ongoing projects

KEXP New Home Project

Aramis Hamer, Seattle WA

Uptown

Republican Street and Queen Anne Avenue N



Artist Aramis Hamer painted a temporary mural on a freestanding wall on Republican Street to celebrate the new KEXP space in the Northwest Room. Additional funds will be added in 2016 and the Seattle Center will contribute funds as well.

Selection	Eligibility	Current Project Total	Estimated Project Total
Invitational	NW	\$17,100	\$35,000

McCaw Hall

This is not an active project but has some shortfall that we are replacing; funds are deposited in this project when feasible to close out.

Non-1% for Art Funds

Seattle Center Activations

2015 Katherine Abarbanel Alex Anderson J. Adam Brinson Eve Funderburgh Katherine Rhoads Timea Tihanyi Jennifer Zwick	2016 Loreen Matsushima Edward Key Laura Buchan Steven Markussen Suzanne Morlock and Glenn Messersmith Minh Carrico Terrell Lozada Satpreet Kahlon
--	--

Republican Street and Queen Anne Avenue N

Seven artists will create temporary artworks to be installed from summer through fall 2016 on the Seattle Center campus. These artists attended Public Art Bootcamp to be eligible for this project. Seattle Center provides most of the funding for these activation.

Selection	Eligibility	Current Project Total	Estimated Project Total
Rosters	NW	\$85,000	TBD

Multiple Funding Details

Seattle Center Programming funds	\$75,000
1% Interest	<u>\$10,000</u>
Total	\$85,000

McCaw Hall Prototype: Dreaming in Color

Uptown
 Mercer Street

Using General Department 1% for Art interest and in partnership with Seattle Center, this project will prototype an LED system and light programming to replace the existing system at McCaw Hall. The Seattle Center will provide funding as well.

Selection	Eligibility	Current Project Total	Estimated Project Total
Invitational	NW	\$20,000	\$TBD

Seattle Parks & Recreation

Projected funds to be allocated: \$101,480

With the expansion of scope of work for Yesler Neighborhood Park, 2015 project-specific supplemental funds and remaining 2008 Levy funds will be allocated to this park in a culturally diverse community. If applicable, participation in development of the 520 lid will be considered.

New Projects

Landbanked Sites

Artist TBD

There is interest in including art at a park in north Seattle (Lake City, Greenwood/Phinney) or Rainier Valley.

Selection	Eligibility	Current Project Total	Estimated Project Total
Open Call	Northwest	\$42,483	\$100,000

Smith Cove

Artist TBD

Interbay

This is a placeholder project, additional funds are projected for 2017.

Selection	Eligibility	Current Project Total	Estimated Project Total
TBD	TBD	\$4,675	\$4,675

Ernst Park

Jenny Heishman, Seattle, WA

Fremont

Seattle Parks and Recreation is renovating existing Ernst Park; the artist will be paid a design fee to reconfigure her artwork.

Selection	Eligibility	Current Project Total	Estimated Project Total
		\$10,000	\$10,000

Ongoing Projects

2008 Parks Levy Art Program

Funds in this program are reallocated to individual projects.

West Seattle Reservoir, David Boyer (with SPU)

Maple Leaf Reservoir, Patrick Marold (with SPU)

Highland Spray Park, Leo Saul Berk

Citywide

Selection	Eligibility	Current Project Total	Overall Project Total before allocation to individual projects
Open Call	Northwest	\$0	\$347,192

Yesler Neighborhood Park

Christine Bourdette

Central Area

1000 Yesler Way



Yesler Park, Seattle: Towers of Bubbles - water feature sculpture - preliminary design (in progress)

Christine Bourdette has worked with Parks staff and Site Workshop to integrate seating areas and water features into the overall design. 2008 Levy, project and pooled 1% Funds.

Selection	Eligibility	Current Project Total	Estimated Project Total
Open Call	Northwest	\$278,263	\$278,263

Multiple Funding Details

2008 Parks Levy	\$248,263
Reallocate from DPR Maple Leaf remaining funds	<u>\$ 30,000</u>
Total	\$278,263

Westlake and Lenora Park (previously 8th and Lenora Park)

Janet Zweig, Brooklyn, NY

Downtown

Janet Zweig will work with Site Workshop to develop a site-specific artwork on an urban triangular site. Funding from prior unprogrammed funds.

Selection	Eligibility	Current Project Total	Estimated Project Total
Open Call	National	\$100,000	\$100,000

Urban Farming Residency (Urban Agriculture)

Nicole Kistler, *Seattle, WA*

City-wide

This multi-department project included research, an art plan for art at various city-wide urban farming locations and proposals for temporary art activation. P-Patches on Parks properties or funded by the levy opportunity funds are considered potential locations. Additional funds from SPU are added for implementation of a project at Beacon Food Forest.

Selection	Eligibility	Current Project Total (Parks)	Estimated Project Total (all sources)
Direct select/Roster	Seattle	\$15,000	\$200,000

Multiple Funding Details

Parks 2008 Levy	\$15,000
SPU	\$185,000
Total	\$200,000

Golf Projects: New Master Plan

Artist TBD

Staff will work with Parks to determine scope and location of project. Some of these funds may augment the existing golf project. 2008 Levy funds.

Selection	Eligibility	Current Project Total	Estimated Project Total
TBD	TBD	\$43,100	TBD

Unprogrammed

The staff will work with Parks to identify appropriate projects or to reallocate to other existing projects.

Selection	Eligibility	Current Project Total	Estimated Project Total
		\$60,882	\$

Department of Transportation

The Elliott Bay Seawall and Central Waterfront projects have dominated the funding and focus for Seattle Department of Transportation, and now the Move Seattle Levy provides many other projects throughout the city for a range of opportunities for artists and communities alike.

The Office of Arts & Culture has prioritized the Central Waterfront redevelopment not only for the Public Art Program but for other areas of the office as well, such as cultural space development and communications and outreach. The office intends to help the city bring focus and attention to this important civic enterprise through activation and projects in advance of and during construction; eventually a number of public artworks will also accompany the finished development. The waterfront development serves not only the entire city but the region as well; the public art program will engage local tribal communities during the project.

Move Seattle will provide funds to support ongoing activities, such as Safe Routes to Schools and Art Interruptions. Some of the levy funding will enhance key mobility projects, while some of it will be pooled for art projects that can take place around the city. The levy has a nine-year lifespan and we have not yet received projections for the overall funding amount.

Projected funds to be allocated: \$ 2,306,886

Of these funds, \$200,000 (less 15% for administration and OH) will be allocated to the waterfront, and \$1.329,000 (less 15% for administration and OH) is generated from the Elliott Bay Seawall project and must be spent on the waterfront.

This leaves approximately \$778,000 (less 15% administration and OH), of which \$379,740 are Move Seattle levy funds.

Working with our SDOT Art and Enhancement project manager and SDOT’s leadership, the following projects have been identified as ones to which to consider directing remaining funds:

2015 MAP Amendment Projects

Fremont Bridge Writing Residency

Elissa Washuta, Seattle, WA
Fremont Bridge

A writer will spend the summer in a bridge tower at the Fremont Bridge, and then develop a literary artwork in response to the experience and the bridge.

Selection	Eligibility	Current Project Total	Estimated Project Total
Open Call	Washington	\$20,000	\$20,000

University Bridge Lighting Residency

Ian Campbell and Hayley Buckbee, Seattle WA

The artists will work in the fall and winter with SDOT to develop an artistic lighting treatment for the bridge; 2017 will be the 100th anniversary for the bridge. Implementation funds TBD.

Selection	Eligibility	Current Project Total	Estimated Project Total
Roster	National	\$25,000	\$TBD

Sidewalk Development Program SDOT Enhancements Project manager

Staff will develop treatments to replace sidewalk insets from a previous project.

Selection	Eligibility	Current Project Total	Estimated Project Total
n/a	n/a	\$15,000	\$TBD

New Projects

Art Interruptions 2016

Ruben David, Melissa Koch, Vikram Madan, Ulises Mariscal, Kemba N. Opio, Talia Silveri Wright, Junko Yamamoto
Rainier Beach

In 2016, Art Interruptions, an ongoing project will focus on a greenway running east-west through Rainier Valley. The artists were all participants in Public Art Bootcamp

Selection	Eligibility	Current Project Total	Estimated Project Total
Open Call	Seattle area	\$60,000	\$60,000

These are 2015 Pedestrian master plan funds.

Pedestrian Master Plan/Safe Routes to Schools

Artist TBD

TBD

SDOT is interested in a project that engages high school youth in creating video around the Safe Routes project. Additional projects may be considered, such as painting of stairs near schools.

Selection	Eligibility	Current Project Total	Estimated Project Total
TBD	Regional	\$30,000	\$TBD

Move Seattle Funds

Madison Bus Rapid Transit

Artist TBD

Central Area

This project will be developed along key nodes on Madison Street. The capital project will focus on downtown to approximately 19th Avenue E. The project will be sensitive to issues of concern related to changing demographics in this area.

Selection	Eligibility	Current Project Total	Estimated Project Total
Open Call	Regional	\$50,000	\$150,000

Move Seattle Funds

23rd Avenue Phase II

Artist TBD
Central Area

This project may continue the 23rd Avenue Phase I project, moving south to Jackson Street, or, if that project finds another funding source, may create a gateway in the Historic Central Area Arts & Culture District.

Selection	Eligibility	Current Project Total	Estimated Project Total
Open Call	National	\$75,884	TBD

Move Seattle Funds and project funds

Lander Street Overpass

SDOT Enhancements Project manager
SODO

SDOT has revived a project to build an overpass at Lander Street over the railroad crossing to increase mobility. Leadership would like to allocate project funds to King Street Station; staff will work with the design team to integrate some artist influenced design elements.

Selection	Eligibility	Current Project Total	Estimated Project Total
		\$10,000	TBD

Move Seattle Funds

King Street Station

Artist TBD
Pioneer Square

Funds from Lander Street overpass and other pooled funds will be allocated to a project at King Street Station. The historic landmarked train station, owned by SDOT, will be home to the Office of Arts & Culture and cultural and community center starting in 2017. There are opportunities for permanent art installations and/or infrastructure for rotating exhibitions on the plaza.

Selection	Eligibility	Current Project Total	Estimated Project Total
		\$40,000	TBD

Move Seattle (Lander Street) and pooled Funds

New Sidewalks

Artist TBD
Lake City

Enhancements for low cost new sidewalks.

Selection	Eligibility	Current Project Total	Estimated Project Total
Roster	Regional	\$10,000	TBD

Move Seattle Funds

Duwamish River Valley

Artist TBD

Georgetown and South Park

Potential new work in South Park and Georgetown related to drainage work performed by SPU.

Selection	Eligibility	Current Project Total	Estimated Project Total
TBD	TBD	TBD	TBD

Move Seattle Funds

Ongoing Projects

Northgate Pedestrian Bridge

Charles Sowers, San Francisco, CA

Northgate

The artist will work with the design team including LMN Architects to create integrated design. Additional funds may be added for artwork implementation. Initial contract is for \$30,000 for design.

Selection	Eligibility	Current Project Total	Estimated Project Total
Roster	National	\$34,000	\$TBD

Sound Transit North Link Bike and Pedestrian Improvement funds

Pedestrian Master Plan School Safety/Safe Routes to Schools/Madrona Tree

Julia Harrison, Seattle, WA

Sacajawea Elementary School

Morningside

The school community wanted to preserve a madrone tree that need to be removed from near the school site. The artist will create an artwork using the trunk of this madrone tree.. The artwork will be placed on SDOT property near the school.

Selection	Eligibility	Current Project Total	Estimated Project Total
Invitational/Roster	Northwest	\$52,000	\$52,000

These are Pedestrian Master Plan School Safety funds

**Pedestrian Master Plan/
Safe Routes to Schools/Beach Square**

Peter Reiquam, Seattle, WA
South Shore School/Rainier Beach High School



The artist developed a project that relates to a community engagement initiative offered by the Seattle Police Department that encourages youth to play Chess. This project follows a previous iteration with artworks by Joyce Hsu at Olympic Hills and Roxbury Elementary Schools, Aki Kurose Middle School

Selection	Eligibility	Current Project Total	Estimated Project Total
Roster	National	\$80,528	\$80,528

Westlake Cycle Track

Jennifer Dixon, Seattle, WA
Westlake Avenue N from Lake Union Park to West Crockett Street

The artist will work with SDOT to develop integrated and sculptural elements on the enhanced bicycle facility.

Selection	Eligibility	Current Project Total	Estimated Project Total
Roster	National	\$127,442	\$127,442

**SDOT Art Plan Implementation: Sidewalk Stamping
SDOT/Arts Staff**

Arts staff worked with SDOT to implement the SDOT Art Plan. The SDOT sidewalk stamping program incorporated artistic enhancements into the everyday work that SDOT does by creating a “library” of concrete stamps of various custom designs for SDOT to incorporate in routine sidewalk paving projects. Arts staff will continue to work with communities and SDOT staff to design the stamps or other small scale enhancements, the funding will be used to fabricate the stamps.

Selection	Eligibility	Current Project Total	Estimated Project Total
n/a	n/a	\$5,000	\$5,000

*Bridging the Gap

Mercer Street Corridor, West

Catherine Wagner, San Francisco, CA
South Lake Union

Catherine Wagner has worked with the project design team to develop permanent public art for the underpass at Mercer Street and at Aurora Avenue/Highway 99 and the adjacent approaches east and west of the underpass. The Mercer West project improves 16 blocks along Mercer Street. The desired

artistic approach treats the underpass as a singular architectural environment and transforms the experience of passing through the space for all modes of transit through the use of panels, paint and light to create a moiré effect. The project is expected to receive \$400K-\$600K. The construction project has provided some funds for delays and repairs.

Selection	Eligibility	Current Project Total	Estimated Project Total
Open Call	National	\$484,982	\$TBD

These are dedicated funds. Funds remaining in the Mercer Corridor East project will be allocated to this project, by agreement with SDOT.

Broadway Extension Study

Artist TBD

Capitol Hill

This project will study extending the streetcar line several blocks north.

Selection	Eligibility	Current Project Total	Estimated Project Total
Direct or roster	National	\$12,521	TBD

Third Avenue Improvements (Center City)

Artists

Downtown Seattle

The funds for this project will be allocated to the Center City Artist in Residence project.

Selection	Eligibility	Current Project Total	Estimated Project Total
Open call	Pacific NW	\$0	TBD

23 Avenue Improvements

Martha Jackson Jarvis, Washington, DC

Central Area

23rd and Union



Martha Jackson Jarvis

SDOT will be reconfiguring 23rd Avenue from Montlake through the Central Area to make the street more conducive to multi-modal transportation. Phase 1 will focus primarily on the central business core of the Central Area. Martha Jackson Jarvis will work with the community to develop artwork that focuses on the character and history of the area.

Selection	Eligibility	Current Project Total	Estimated Project Total
Open call	National	\$235,690	\$235,690

Includes 23rd Avenue project, 2014 Transit Corridor and \$56,000 2015 BTG funds

Fauntleroy SW Green Boulevard

Artist TBD
West Seattle

Potential for gateway or episodic project

Selection	Eligibility	Current Project Total	Estimated Project Total
Roster or open call	Pacific NW	\$100,000	TBD

These are project funds and Move Seattle funds.

High Capacity Eastlake

Artist TBD
Downtown Seattle

This project may remain a placeholder and the funds pooled elsewhere.

Selection	Eligibility	Current Project Total	Estimated Project Total
Open call	Pacific NW	\$20,400	TBD

These are project funds.

Center City Connector – Center City Artist in Residence

Susan Robb, Seattle WA
Downtown

Because much of the streetcar project will be designed by the urban design team, funds have been allocated toward an art plan to study several project(s) in the downtown core in general proximity to the streetcar alignment. These projects may relate to the Pike/Pine Renaissance Project, Third Avenue Activation or a streetcar facility at the north end. Implementation funds may be added. The artist may also look at private initiatives (Lake2Bay, Market to MoHAI, Convention Center streetscape).

Selection	Eligibility	Current Project Total	Estimated Project Total
Open Call	National	\$74,668	\$74,668

These are project funds and pooled funds from other projects.

Shoreline Street Ends

Sam Trout, Seattle, WA
Citywide



An artist/artist team will be hired to work with SDOT on designs of wayfinders/identifiers for various street-end park locations throughout the city.

Selection	Eligibility	Current Project Total	Estimated Project Total
Roster	Seattle	\$30,000	\$30,000

These are pooled funds (reallocated from prior years' unprogrammed funds).

2015 and 2016 Unprogrammed

Artists TBD

The staff will work with SDOT and the PAAC to identify appropriate projects or to reallocate to other existing projects. Older funds are allocated first

Selection	Eligibility	Current Project Total	Estimated Project Total
		\$202,664	

Unprogrammed Move Seattle

These are pooled dollars that will be allocated to projects that are partially or wholly funded by Move Seattle.

Selection	Eligibility	Current Project Total	Estimated Project Total
n/a	n/a	\$123,279	TBD

Elliott Bay Seawall and Central Waterfront

Alaskan Way Viaduct/Central Waterfront

This project was the original location where funds were placed for potential artwork activities related to the Central Waterfront Project. This project was listed in the 2008 MAP as Downtown Urban Design Artist-in-Residence; in the 2009 MAP as the Downtown Surface Improvements Artist Lead and in the 2011 MAP as the Central Waterfront Design Team Artist (Art Plan).

The funds remaining in the project will be used either as a general pool for staff time focusing on project development, outreach, temporary projects or for the Union Street/East West Connections project. New waterfront funds (starting in 2013) will be placed in the Central Waterfront project.

Selection	Eligibility	Current Project Total	Estimated Project Total
Open Call	National	\$313,916	\$313,916

Reallocation to projects in 2015

Starting balance	\$313,916
Central Waterfront East/West Connections Union Street	(\$60,000)
Central Waterfront Temporary Projects	(\$50,000)
Ending Balance	\$203,316

Central Waterfront Artwork

Activation of the central waterfront will take many forms; 1% for Art will support both permanent and temporary projects as well as different forms of engagement, such as lectures, residencies, conferences, etc. Many possibilities are outlined in the *Working Plan for Artwork on the Central Seattle Waterfront*, developed by an art planning team including Creative Time, Mark Dion, Tomato and Eric Fredericksen working with James Corner Field Operations. Arts funding will be used to activate and program spaces prior to and during construction. Artists will be selected to work with the design team for various projects and will be issued contracts through concept design until further information about funding is ascertained. Project totals included anticipated project management costs.

Selection	Eligibility	Current Project Total*	Estimated Project Total
Open Call, Invitational, Direct select	National/International/Regional/Seattle	\$1,022,616	\$3,516,875

The 1% for Art funding will be generated through many vehicles: bond, commercial parking tax, local improvement district, philanthropy. We may also consider leveraging private partners.

*This represents all funds placed in this project; funds will be reallocated out of this project into specific opportunities for the purposes of the MAP. Individual project funds are included in the project total above.

Reallocation to projects in 2015

Starting balance	\$351,700
2015 Funds	\$92,000
Central Waterfront Promenade Commission	(\$60,000)
Central Waterfront Play	(60,000)
Central Waterfront Tribal	(\$250,000)
Central Waterfront Lighting Design	
Central Waterfront Overlook walk	
Ending Balance	\$73,700

2016 Summer Activations

Fabiola Carranza, Vancouver, BC
 Nicole Kistler, Seattle, WA
 Jeffry Mitchell, Seattle, WA
 Heather and Ivan Morison, UK
 Martyne Sims and Marco Braunschweiler, Los Angeles

Five temporary projects will activate the waterfront in a project called “Waterfront Exchange”. Office of the Waterfront has contributed \$50,000.

Selection	Eligibility	Current Project Total	Estimated Project Total
Invitational	International	\$125,000	\$125,000

Multiple Funding Details

SDOT 1%	\$ 75,000
Office of the Waterfront	<u>\$ 50,000</u>
Total	\$125,000

Union Street/East-West Connections/Union Streets

Norie Sato, Seattle, WA

Norie Sato is working with Schemata, members of the Waterfront design team, to integrate artwork into the Union Street structure that will act as both a viewpoint and a hillclimb circulation to connect the upland areas to the waterfront. Artist’s fee and fabrication: \$200,000.

Selection	Eligibility	Current Project Total	Estimated Project Total
Open Call	National	\$80,000	\$230,000

These initial funds are 2015 project funds, pooled Seawall, Alaskan Way Viaduct and SDOT funds; the bond (below) will fund most of the project.

Multiple Funding Details

AWV/SDOT pooled funds	\$60,000
2015 Union Street	<u>\$20,000</u>
Central Waterfront	<u>\$150,000</u>
Total	\$230,000

Overlook Walk Underpass/Lighting Designer

Artist TBD

This project was originally intended to include an artist working with the lighting subconsultant to design special lighting vignettes at specific locations. For the time being, this will be a design-only opportunity for an artist to work with the design team on the underside of the Overlook Walk. Fee: \$20,000.

Selection	Eligibility	Current Project Total	Estimated Project Total
Limited invitational or direct	TBD	\$	\$25,000T BD

Waterfront Sited Commission

Oscar Tuazon, Los Angeles, CA

During the selection for the Seawall public piers project, the panel recommended that Tuazon receive a commission as well; the artist will work with the design team to develop a project for the Central Waterfront project. Initial funding will be set at \$25,000 for concept design.

Selection	Eligibility	Current Project Total	Estimated Project Total
Open Call	National/International	\$60,000	TBD

Play Area

Cedric Bomford, Vancouver, BC

The Central Waterfront will have several opportunities to integrate play areas throughout the site. Cedric Bomford will work with the design team on a space that will consider play for all ages. Initial funding will be set at \$25,000 for concept design. This project may occur on the Overlook Walk.

Selection	Eligibility	Current Project Total	Estimated Project Total
Open Call	International	\$60,000	TBD

Tribal Stories/Cultural Representation

Shaun Peterson, Milton, WA

Seattle’s Central Waterfront has a history that predates settlement. Shaun Peterson, an enrolled member of the Puyallup Tribe, has been selected as an artist who can meaningfully convey the culture of local tribal communities. He will develop three welcome figures for the promenade. Artist’s fee and fabrication \$250,000, initial contract in 2015: \$25,000.

Selection	Eligibility	Current Project Total	Estimated Project Total
Open Call	National/Canada	\$250,000	\$280,000

Temporary and Activation Projects

While construction of the new waterfront will not begin until the Alaskan Way Viaduct is removed, we envision arts activities and outreach to occur during the design and construction document phases of the Central Waterfront. Some of these projects will be temporary or digital artworks, others will be event-based to provide insight into the project by individuals in different disciplines. These activities will highlight the area as a Working Waterfront. (Older pooled funds)

Selection	Eligibility	Current Project Total	Estimated Project Total
Open Call	National/International	\$50,000	\$50,000

Pooled AWV funds.

Low Res

2014-2015

Photography (in order of participation)	Music	Poetry
Curator: Michelle Dunn Marsh	Curator: Eyvind Kang	Curator: Joshua Beckman
Eirik Johnson Alice Wheeler Canh Nguyen	Paul “Che oke ten” Wagner and Johnny Moses Tracy Armour Lori Goldston	Melanie Noel Christine Deavel Cedar Sigo

Low Res uses a model of asking arts professionals in different disciplines to act as curators to select three to six artists each to serve briefly “in residence” on the waterfront and create a project with a small digital footprint that will be collected and housed on an online archive. The projects may also be displayed or performed on the waterfront on a temporary basis. The first round of this project, which may recur twice a year, will include writing, music and photography. The photography project is intended to capture a range of “stories” of the waterfront.

Conference on Play

In March 2014, as part of Waterfront Week, that celebrated the 30% design milestone for the waterfront, the Public Art Program organized a conference on play. Featuring a keynote speaker and two panel sessions, scholars, designers and artists investigated the history and current state of play areas and play structures. This conference acted to inform the development of a call for artists for an artist-designed play area for the project. Participants included: Liane Lefavre, Gabriela Burkhalter, Alan Maskin, Nigel Prince, Rico Quirindongo, Trimpin and Judith Caldwell.

Selection	Eligibility	Current Project Total	Estimated Project Total
n/a	n/a	\$40,000	\$40,000

This was funded out of pooled AWV funds.

Photographer in Residence

Arts will manage the selection and work of a photographer who will document artistically but accurately the current condition of the waterfront and the changes as construction occurs. The Office of the Waterfront will contribute 50%.

Selection	Eligibility	Current Project Total	Estimated Project Total
Invitational	Regional	\$TBD	\$TBD

Multiple Funding Details

SDOT 1%	\$25,000
Office of the Waterfront	<u>\$ 25,000</u>
Total	\$50,000

Elliott Bay Seawall Project

Artists Laura Haddad and Tom Drugan developed the Elliott Bay Central Seawall Art Programming Plan as part of the Seawall design team. This art plan outlines a number of potential permanent and temporary projects related to the seawall rebuild. Three projects are in design.

Elliott Bay Seawall Bond including Public Piers

The \$290,000,000 bond measure includes \$50,000,000 for pier rebuild. Funds below are anticipated 1% for Art funds less 15% administrative overhead.

Selection	Eligibility	Current Project Total	Estimated Project Total
Open Call, invitational, direct	National/International	\$2,489,030	\$ 2,489,030 TBD

*This represents all funds placed in this project; funds will be reallocated out of this project into specific opportunities for the purposes of the MAP. Individual project funds are included in the project total above.

Multiple Funding Details

AWV/SDOT pooled funds	\$74,980
Elliott Bay Seawall Bond 1% prior	<u>\$139,400</u>
Elliott Bay Seawall Bond 1% 2015	\$1,145,000
Elliott Bay Seawall Bond 1% 2016	\$1,129,650
Total	\$2,489,030

Habitat Project

Buster Simpson, Seattle, WA

Buster Simpson will design one or more permanent outdoor artworks that reveal tidal and ecological conditions of the seawall, Elliott Bay and Puget Sound. Working closely with Seawall Project engineers, biologists, ecologists and designers, the artist will develop artwork that relates to the complex ecology of the site, both interpreting and expanding the ways in which the seawall performs concurrently as infrastructure and habitat. The vision for the project is that the artworks resulting from this commission are both catalysts for and a barometer of ecological function along the restored waterfront. Due to environmental and programmatic constraints, the project will occur along the promenade adjacent to the Seawall. Artist's fee and fabrication: \$345,000.

Habitat Project Initial Funding

Selection	Eligibility	Current Project Total	Estimated Project Total
Open Call	National	\$360,000	\$360,000

These initial funds are pooled Seawall, Alaskan Way Viaduct and SDOT funds; the bond (below) will fund most of the project.

Multiple Funding Details

AWV/SDOT pooled funds	\$74,980,
Elliott Bay Seawall Bond 1%	<u>\$25,0200*</u>
Total	\$360,000

Sound Project

Stephen Vitiello, Richmond, VA

Stephen Vitiello will design a sound-based artwork. He will work with the design team to find a site; the project is in the design phase. Artist's fee and fabrication: \$200,000. Artist's initial contract: \$20,000.

Selection	Eligibility	Current Project Total	Estimated Project Total
Open Call	National	\$200,000	\$215,000

Light Project

The original project in the 2014 MAP will not be realized..

Selection	Eligibility	Current Project Total	Estimated Project Total
Direct Selection	National		

Public Piers Project

Ann Hamilton, Columbus, OH

Ann Hamilton is working with the design team to select a location on one of two anticipated rebuilds of public piers (Union Street or Piers 62/63) to develop artwork. Artist's fee and fabrication \$1,000,000.

Selection	Eligibility	Current Project Total	Estimated Project Total
Open Call	National/International	\$500,000	\$1,150,000

Temporary and Activation Projects

Along with SDOT's Construction Experience that will activate the waterfront during Seawall construction, the office will fund and produce a number of activities that will either occur on or near the waterfront, will use the waterfront and seawall as subject matter, or will bring to light some aspect of the waterfront. Approximately \$100,000 will be allocated to these projects over the life of the construction project until the Promenade is complete.

Selection	Eligibility	Current Project Total	Estimated Project Total
Various	Seattle	\$75,000	\$100,000

Pier 62 Opening Temporary Project

Artists tbd

To commemorate the opening of Pier 62, a temporary project(s) will be commissioned.
\$50,000

Construction Experience: Storefronts Seattle

Multiple artists: \$5,000 (complete)

The Construction Experience contracted with Shunpike, an organization that manages Storefronts Seattle that places roster artists and artworks in vacant storefronts, to activate spaces in the general vicinity of the waterfront. The 1% for Art program intended to cover the fees for up to 28 artists for three years but only expended approximately \$5000 before the project was discontinued

Hillclimb Sound Project

Peter Bjordahl; to supplement DSA funding, \$5,000 (complete)

Downtown Activation: Buskers

Multiple artists: In and around the Seattle Waterfront: \$15,000 (complete)

Speakers' Series

The art plan for the waterfront called for individuals in a wide range of fields to speak on topics related to the waterfront; the subjects can inform the thinking of artists and the public art program. In 2013 Coll Thrush spoke at the Olympic Sculpture Park; he was introduced by Leonard Forsman, Chair of the Suquamish Tribe. Artists working on waterfront projects may also present their work; local tribes may be asked to tell their stories.

Selection	Eligibility	Current Project Total	Estimated Project Total
Direct	International	\$5,000	\$10,000

Special Projects

Ongoing

Public Art Workshops

Quarterly workshops for artists will be offered on a variety of topics. Many of these topics will be directed at developing artists' skills to render them better equipped to realize successful public art projects for the program. Other forms of outreach are captured here as well, including panels, talks, bicycle tours and exhibitions.

Selection	Eligibility	LTD Allocations	Balance
n/a	n/a	\$92,332	\$25,321

*This project is funded with General Fund 1% for Art interest income (see table in appendix).

Strategic Small Project funds

These funds support projects that meet the goals of the office's strategic plan. In 2016, the funds will be used to support purchases through the Ethnic Heritage gallery and other miscellaneous projects.

Selection	Eligibility	LTD Allocations	Balance
n/a	n/a	\$30,000	\$18,000

*This project is funded with General Fund 1% for Art interest income (see table in appendix).

Digital Outreach

These funds will support interns working to ensure that the collection is appropriately and accurately represented on digital platforms, such as STQRY and Public Art Archive. These apps and websites offer visibility to the collection and are provided as a public service.

Selection	Eligibility	Current Project Total	Estimated Project Total
n/a	n/a	\$10,000	TBD

*This project is funded with interest income (see table in appendix).

Multiple Funding Details

Seattle City Light	\$ 2,500
Seattle Public Utilities	\$ 2,500
General Funds	<u>\$ 5,000</u>
Total	\$ 10,000

Public Art Bootcamp

An intensive introduction to public art for emerging artists, this hands-on series will be offered annually. The coursework will be directed at developing artists' skills to render them better equipped to realize successful public art projects for the program. This project has been funded at \$30,000 per year through 2017.

Selection	Eligibility	LTD Allocations	Estimated Project Total
n/a	n/a	\$90,000	TBD

*This project is funded with multiple 1% for Art interest income (see table in appendix).

Multiple Funding Details

Seattle City Light	\$ 10,000
Seattle Public Utilities	\$ 30,000
General Funds	<u>\$ 50,000</u>
Total	\$ 90,000

Seattle Presents

The Office of Arts & Culture has been charged with activating a small retail space at the base of Seattle Municipal Tower. Rent is to be paid by Admissions tax; curators and artists are paid out by the Public Art Program.

Selection	Eligibility	LTD Allocations	Estimated Project Total
n/a	n/a	\$10,000	TBD

*This project is funded with General Fund 1% for Art interest income (see table in appendix).

South Park Gateway

Diane Hansen and Jennifer Wedderman, Tacoma, WA

Public Art Program staff will manage a gateway/identifier artwork project in South Park. These funds are King County Transportation funds that are transferred by agreement to the Office of Economic Development. The funds will remain at OED.

Selection	Eligibility	Current Project Total	Estimated Project Total
Open Call	Relationship to South Park	\$150,000	\$150,000

**APPENDIX
FINANCIAL TABLES
2016 Municipal Art Plan Revenue Summary and 2015 MAP
Amendments**

2016 CIP provided by CBO and adjusted by departments during budget process

		SPU breakout
Seattle City Light	\$1,116,644	
Seattle Public Utilities	\$882,848	
Drainage and Wastewater Utility		\$554,107
Water		\$71,932
Solid Waste		\$256,810
Department of Finance and Administrative Services	\$0	
Seattle Center 1% for Art	\$12,100	
Seattle Parks and Recreation 1% for Art	\$75,480	
Seattle Department of Transportation 1% for Art	\$1,032,575	
TOTAL Budgeted 1% for Art	\$3,119,647	

Revenue Adjustments

Seattle Public Utilities 2015 true up	\$2,295	
DWU		\$1,731
W		-\$2,885
SW		\$3,450
Finance and Administrative Services	\$100,591	
Seattle Parks and Recreation 2015 supplemental	\$26,000	
SDOT adjustment based on adopted budget	\$582,914	
(total 2016 \$2,306,886)	\$1,274,311	

Adjustments to 2016 CIP for use in allocations**Calculated adjustments**

Seattle City Light at 75% accomplishment rate	\$837,483	
Seattle Public Utilities at 75% Accomplishment rate	\$662,136	
DWU		\$415,580
W		\$53,949
SW		\$192,608

Total 2016 1% for Art by Department for Allocation purposes

Seattle City Light Projected		\$837,483	
Seattle Public Utilities (includes true-up amounts)		\$664,431	
	DWU		\$417,311
	W		\$51,064
	SW		\$196,057
FAS 1% for Art*		\$100,591	
Seattle Center 1% for Art		\$12,100	
Seattle Parks and Recreation 1% for Art		\$101,480	
Seattle Department of Transportation 1% for Art funds		\$2,306,886	
Total 2016 1% for Art Budget		\$4,022,971	
*\$150,591 anticipated (2016 MAP amendment in 2017)			

Uses for 2016 MA Funds

Projects (see list of 2016 MAP Projects)		\$3,421,341	
Administrative Overhead at 15%*		\$601,630	
Total Uses 2015% for Art Funds		\$4022,971	

Except Seattle Center

Amendments to 2015 MAP/Funding

Difference in budget v. payment amounts (see appendix)

Seattle City Light			(\$195,454)
SPU		\$ 266,979	
	DWU		135,055.00
	W		\$30,348
	SW		\$101,576
DFAS reduction in Fire Levy commitment			(\$23,456)
Seattle Center			\$0
Parks			\$0
SDOT			\$55,000
TOTAL change budget v. actual revenue			(\$163,910)

Amendments to 2015 MAP/Projects

(administrative changes noted in accounting activity logs)

Seattle City Light

Seattle Public Utilities

Additional funds allocated to unprogrammed; started Poetry on Buses

Seattle Center

Received \$25,000 for Summer Activations

Parks

Supplemental funds allocated to Yesler Neighborhood Park

Seattle Department of Transportation

Started Fremont Bridge and University Bridge Residences

Added Sidewalk redevelopment project

Added waterfront activity: Waterfront 2016 Summer activation

- Adjustments to projects are reflected in 2015 year end summary and activity report (not included here);
- Prior allocations in project table will reflect adjustments
- Some non-1% projects not shown here can be found among project descriptions

2016 MAP Individual Projects Showing New and Reallocated Funds

Seattle City Light -

Ongoing	Prior Funding	Reallocation	2016 Allocations	Current funding	Est. Project funding	Notes
Denny Substation Design Team (North Downtown Facility)	\$1,227,379		\$656,485	\$1,883,834	\$1,188,834	
Denny Substation (North Downtown Facility) Temporary Art	\$355,932			\$355,932	\$355,932	
Georgetown Steamplant Temporary Project	\$120,000			\$120,000	\$120,000	
Technical Training Center	\$125,000			\$125,000	\$125,000	
T117 (Duwamish Clean Up) Adjacent Street clean-up	\$60,000			\$60,000	\$60,000	
City Light Awareness Project (Solar) includes \$100K from SCL	\$200,000			\$300,000	\$300,000	\$100,000 from MOA with SCL
North Service Center Expansion	\$120,000			\$120,000	\$120,000	
Pollinator Pathway (interest)	\$50,000			\$50,000	\$50,000	
2015 Amendment Projects						
New for 2016						
Unprogrammed Administration	\$12,852		\$55,736	\$68,588		
Total Reallocation & Allocation			\$837,843			

Seattle Public Utilities Drainage and Wastewater

Ongoing	Prior Funding	Reallocation	2016 Allocations	Current funding	Est. Project funding	Notes
South Park Drainage Project	\$250,000			\$250,000		
Madison Valley Stormwater Improvements	\$310,000			\$310,000		Tree replaced 2016
Midvale	\$150,000			\$150,000		
Swale on Yale	\$0					Funding removed 2014
CSO/Southwest	\$400,000			\$400,000		
South Delridge	\$150,000			\$150,000		
North Delridge	\$250,000			\$250,000		
Urban Watershed Film	\$100,000			\$100,000		
Engaging Community	\$100,000	(\$100,000)		\$100,000		Reallocate to Poetry on Buses
Portable Works Purchase/SPU Cultural Perspectives	\$100,000			\$100,000	\$200,000	\$100K Water funds
SPU Development Services Floor	\$35,000			\$35,000	\$70,000	\$35K Water funds
SPU Drainage Artist in Residence	\$200,000	\$200,000		\$400,000	\$3,000,000	Incl. implementation
2015 Amendment Projects						
Poetry on Buses		\$100,000		\$100,000	\$330,000	\$30K Water & other agencies
New for 2016						
12th and Elmgrove Park		\$60,000		\$60,000		
24th Avenue NW Pier (Ship Canal Water Quality)		\$60,000		\$60,000		DWU AIR implementation
2016 Portable Works Purchase (Poetry on Buses)		\$80,000		\$80,000		
Northwest Wonders Portable Works Purchase		\$150,000		\$150,000		
Safe Lots Engagement		\$30,000		\$30,000		
Artists in Engagement: Stories of Water		\$240,000		\$240,000		DWU AIR implementation
Unprogrammed Administration	\$926,885	(\$820,000)	\$354,714	\$461,599		
			\$62,597			
Total Reallocation & Allocation			\$417,311			

Water -

Ongoing	Prior Funding	Reallocation	2016 Allocations	Current funding	Est. Project funding	Notes
Maple Leaf Reservoir	\$130,000			\$130,000	\$150,000	\$50K DPR; move \$30K to Yesle
Landsburg Park	\$115,000					
Urban Farming Residency	\$200,000				\$215,000	\$15K Parks
Water Conservation Outreach Projects/Engaging Community	\$75,000	(\$30,000)		\$45,000		
SPU Development Services Floor	\$35,000			\$35,000	\$70,000	Plus DWU
Cedar Falls Administration Building	\$30,000	\$26,596	\$43,404	\$100,000	\$100,000	
Central Area Water Main					\$200,000	
Cal Anderson Youth Engagement	\$50,000	\$5,000		\$55,000		
2015 Amendment Projects						
Poetry on Buses		\$30,000		\$30,000		
New for 2016						
Unprogrammed Administration	\$44,519	(\$31,596)		\$12,923		
			\$7,659.56			
Total Reallocation & Allocation			\$51,064			

Solid Waste -

Ongoing	Prior Funding	Reallocation	2016 Allocations	Current funding	Est. Project funding	Notes
North and South Transfer Stations	(\$163,771)				\$1,369,918	Combined
North Transfer Station	\$541,256	100,000		\$641,256	\$641,256	
South Transfer Station	\$684,433	(\$163,771)		\$520,662	\$520,662	
South Transfer Phase II	\$308,000	\$22,000		\$330,000	\$330,000	

2015 Amendment Projects

New for 2016

Unprogrammed Administration	\$89,158	\$41,771	\$0.00	\$130,929		
Total Reallocation & Allocation			\$0			

Department of Finance and Administrative Services -

Ongoing	Prior Funding	Reallocation	2016 Allocations	Current funding	Est. Project funding	Notes
Joint Training Facility	\$343,957			\$343,957		
Neighborhood Fire Station Program (incl.10's)	\$1,582,230			\$1,562,292		
Civic Square Open Space Artwork	\$5,315					
Civic Square Open Space Artwork - Fence Project #3 (non 1%)	\$93,037				\$93,037	For 2012-2014
North Police Precinct	\$54,408		\$85,502	\$139,910	\$760,000	Admin not taken 2014
Unprogrammed Administration			\$15,089			
Total Reallocation & Allocation			\$100,591			

Seattle Center -

Ongoing	Prior Funding	Reallocation	2016 Allocations	Current funding	Est. Project funding	Notes
McCaw Hall	\$376,338		\$0			Backfill
KEXP New Home	\$5,000		<u>\$12,100</u>	\$17,100	\$35,000	
Seattle Center Activations (interest and Seattle Center funds)	\$35,000					
McCaw Prototype (interest \$)	\$20,000					
New for 2016						
Seattle Opera/Mercer Arena Temporary Projects					\$35,000	
Administration			\$0			
Total Reallocation & Allocation			\$12,100			

Seattle Parks and Recreation -

Ongoing	Prior Funding	Reallocation	2016 Allocations	Current funding	Est. Project funding	Notes
2008 Levy (\$347,192 overall) - balance in project as of 5/2016	\$60,671	(\$60,671)		\$0		
Golf Projects: New Master plan (2008 Levy)	\$45,368			\$45,368		Funds from Jackson Parks
Yesler Neighborhood Park (2008 Levy)	\$165,492	\$90,671	\$22,100	\$278,263	\$278,263	\$30,000 from Maple Leaf
Maple Leaf Reservoir (inactive)		(\$30,000)				Close out project
Westlake and Lenora	\$100,000			\$100,000		
P-Patch	\$9,800		\$1,700	\$11,500		
New for 2016						
Landbanked Sites			\$42,483	\$42,483		
Smith Cove			\$4,675	\$4,675	TBD	
Ernst Park		\$10,000		\$10,000	TBD	
Unprogrammed	\$55,582	(\$10,000)	\$15,300	\$70,882		
Administration			\$15,222			

Total Reallocation & Allocation

\$101,480

Seattle Department of Transportation

Ongoing	Prior Funding	Reallocation	2016 Allocations	Current funding	Est. Project funding	Notes
Mercer Street Corridor	\$346,518	balance		\$346,518	\$346,518	Funds to Mercer West
SDOT Art Plan Implementation: Sidewalk Stamping	\$5,000			\$5,000	\$5,000	
Spokane Street Viaduct	\$524,675			\$524,675	\$524,675	Mercer West
Mercer Street Corridor, West	\$484,982			\$484,982	\$450,000	
SDOT Arts Enhancement (position - pooled funds)	\$114,311					
Broadway Extension Study	\$9,163		\$3,358	\$12,521	tbd	Proj funds
Third Avenue Improvements (move to Center City Connector)	\$13,400	(\$13,400)		0	\$0	
23 Avenue Improvements	\$235,690			\$235,690	\$235,690	23rd, BTG and 2014TransCorr
Fauntleroy SW Green Boulevard	\$15,300		\$100,000	\$115,300	tbd	Proj funds/2016 Move \$59500,
High Capacity /Eastlake	\$20,400			\$20,400		Proj funds
Center City Connector (Streetcar) - Center City Artist in Residence	\$55,250	\$13,400	\$6,018	\$74,668	tbd	Proj funds; 3rd Ave funds
Shoreline Street Ends	\$20,000	\$10,000		\$30,000		Unprogrammed
Central Waterfront Funding as of 2016 (852,616 +170,000)						
Central Waterfront Design Team Artist (AWV) VA8082 (Pooled)	\$178,916			\$178,916	\$178,916	
Central Waterfront Temporary Projects	\$50,000			\$50,000	\$50,000	Low Res
Central Waterfront AVW Union Street East/West Connections	\$80,000			\$80,000	\$230,000	
Central Waterfront (2013 funding onwards) PM VA80823	\$51,700		\$120,000	\$171,700	tbd	
Central Waterfront Play	\$60,000			\$60,000	\$500,000	
Central Waterfront Tribal	\$250,000			\$250,000	\$280,000	
Waterfront Activation	\$72,000			\$72,000		
Central Waterfront Promenade Commission	\$60,000			\$60,000	\$500,000	
Central Waterfront Lighting Design					\$25,000	
Summer 2016 Activations (new)	\$50,000		\$25,000	\$75,000	\$125,000	50K from OW
Overlook Walk Underpass					tbd	
Photographer in Residence			\$25,000	\$25,000	\$50,000	\$25K from OW; \$25K from Seawall

Seawall Bond Measure Overall Funding as of 2016
\$2,489,030

Seawall Bond Measure (project management and unprogrammed)	\$199,380	\$539,650	\$739,030	\$217,500	
Seawall Habitat Beach	\$360,000	\$40,000	\$400,000	\$360,000	
Seawall Light Project					\$23,063 spent on light
Seawall Sound Project	\$200,000	\$25,000	\$225,000	\$225,000	
Seawall Temporary Projects	\$75,000		\$75,000	\$292,000	Various
Seawall Piers Project	\$500,000	\$500,000	\$1,000,000	\$1,000,000	
Photography Commission		\$25,000	\$25,000		
Safe Routes to Schools/Beach Square	\$80,528		\$80,528		
Westlake Cycle Track	\$127,442		\$127,442		
Pedestrian Masterplan School Safety - Sacajawea /Madrona Tree	\$52,000		\$52,000		
Northgate Pedestrian Bridge	\$34,000		\$34,000		

2015 MAP amendment projects

Fremont Bridge Writing Residency	\$20,000		\$20,000		2015 Paystations
University Bridge Lighting Residency	\$15,000	\$10,000	\$25,000	tbd	2015/2016 Paystations
Sidewalk Development Program	\$15,000		\$15,000	tbd	

New for 2016

Art interruptions 2016	\$60,000		\$60,000		2016 Pedestrian Master Plan In
Safe Routes to Schools - video, youth engagement		\$30,000	\$30,000	tbd	Move
Madison Bus Rapid Transit (BRT)		\$50,000	\$50,000	\$150,000	Move
23rd Avenue Phase II		\$75,884	\$75,884		Move (\$8.5K)
Lander Street Overpass		\$10,000	\$10,000	tbd	Move
New Sidewalks		\$10,000	\$10,000	tbd	Move
Duwamish River Valley				tbd	Move
King Street Station		\$40,000	\$40,000	tbd	Move (Lander Street)

2015 Unprogrammed	\$308,193	(\$120,000)	\$188,193
2016 Unprogrammed			\$202,664
2016 Move Seattle Unprogrammed			\$123,279
Administration			\$346,033
			<hr/>
			\$2,296,887

ADDITIONAL FINANCIAL TABLES

Final 2015 1% for Art Billings and Revenue

	Per 2015 Proposed Budget	SPU breakdown	2015 MAP	SPU breakdown	Revenue as of 2015 year end	SPU breakdown	Difference	SPU breakdown
2015 1% for Art:							-	
Seattle City Light	\$770,402		\$770,402		\$574,948		-\$195,454	
Seattle Public Utilities	\$1,229,476		\$942,049		\$1,209,038		\$266,979	
Drainage and Wastewater Utility		\$582,747		\$445,638		\$580,693		135,055
Water		\$170,634		\$133,266		\$163,614		30348
Solid Waste		476,095		\$363155		\$464,731		101,576
DFAS 1% for Art	\$23,456		\$23,456		0		-\$23,456	
Seattle Center 1% for Art	\$5,790		\$5,790		\$5,790			
Seattle Parks and Recreation 1% for Art	\$5,000		\$86,630		\$86,630			
Seattle Department of Transportation 1% for Art	\$1,529,631		\$2,112,545		\$2,112,545			
Total 2015 1% for Art Revenue	\$3,563,755		\$3,940,883		\$3,988,951		-\$195,454	

Interest accrual

Source	2015 Balance	2015 Accrual	Balance	2016 Allocations	Balance
Seattle City Light	\$73,775	\$18,410	\$92,185	\$10,000	\$82,185
Seattle Public Utilities	\$117,469	\$32,190	\$149,659	\$30,000	\$119,659
General Departments	\$68,728	\$38,395	\$107,123	\$30,000	\$77,123

Interest Allocations

	Prior Allocations	Balance start of 2015	2016 Seattle City Light	2016 SPU	2016 General Departments	Total all funds
Strategic Small projects 2014	\$30,000	\$18,000				
Public Art Workshops	\$93,879	\$25,321				
Public Art Bootcamps	\$30,000		\$10,000	\$30,000	\$20,000	\$90,000
Seattle Presents					\$10,000	

Prior projects funded out of interest include: Pollinator Pathway, Duwamish Revealed, project management time for Seattle Center activation and Put Art in the Parks project management.

