

Zoom 101

Change View Layout
(Speaker, Gallery)

The screenshot shows a Zoom meeting window with a presentation slide. The slide title is "RAINIER BEACH PLAYFIELD SKATEPARK PROJECT". It lists several team members and their roles:

- DANIELLE JACKSON, CO-CHAIR**: C.H.A.M.P.S RESOURCE & SERVICE CENTER. Roles: Volunteer Public Outreach / Engagement, Community Builder / Champion, Grant Applicant.
- SCOTT SHINN, CO-CHAIR**: Parents for Skateparks. Roles: Volunteer Public Outreach / Engagement, Community Builder / Champion, Grant Applicant.
- NIC MORIN, PETER CROMWELL**: Environmental Works. Roles: NMorin@eworks.org, PCromwell@eworks.org, Team Coordination & Project Management, Community Design Process, Landscape Architecture, Analysis, Design & Conceptual Drawings.
- RICHIE CONKLIN**: Evergreen Skateparks. Roles: Skatepark Design, Community Design Process, Preliminary Simulation.
- KAREN SELANDER, PROJECT MANAGER**: Seattle Neighborhoods. Roles: Funding Agency, Community Process, Guidelines, Project oversight.
- PAM KLIMENT, NEIGHBORHOOD PLANNER**: Seattle Parks & Recreation. Roles: Property Owner, Development / Design Guidelines, Project oversight.
- SHAVA LAWSON, DIRECTOR OF FISCAL SERVICES**: SEATTLE PARKS FOUNDATION. Role: Fundraising Support, Fiscal Sponsor.

The slide also features logos for Seattle Neighborhoods, Seattle Parks & Recreation, and Seattle Parks Foundation. A "PROJECT TEAM & CONTACTS" banner is at the bottom of the slide. The Zoom interface includes a top bar with "Zoom Meeting" and "00:34 View", and a bottom toolbar with icons for Unmute, Start Video, Participants, Chat, Share Screen, Record, Raise Hand, and Leave.

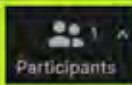

Mute/Unmute

Start/Stop Video

View
Participants
List

Open Chat
Window

Raise Hand

Leave Meeting

RAINIER BEACH PLAY FIELD SKATE PARK

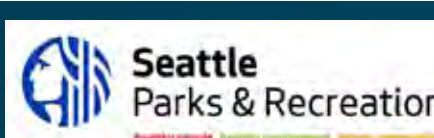

LAND ACKNOWLEDGMENT



We would like to acknowledge that we are on the traditional lands and waters of the first people of Seattle, the Coastal Salish Tribes past and present and honor with gratitude the land itself and the Coastal Salish Peoples.

PROJECT TEAM



DANIELLE JACKSON, CO-CHAIR



- Volunteer Public Outreach / Engagement
- Community Builder / Champion
- Grant Applicant

SCOTT SHINN, CO-CHAIR



Parents for Skateparks

- Volunteer Public Outreach / Engagement
- Community Builder / Champion
- Grant Applicant

NIC MORIN & PETER CROMWELL



Environmental Works
COMMUNITY DESIGN CENTER

- Team Coordination & Project Management
- Community Design Process
- Landscape Architecture
- Analysis, Design & Conceptual Drawings

RICHIE CONKLIN



- Skatepark Design
- Community Design Process
- Preliminary Simulation

KAREN SELANDER, PROJECT MANAGER



Seattle Neighborhoods

- Funding Agency
- Community Process, Guidelines
- Project oversight

PAM KLIMENT, NEIGHBORHOOD PLANNER



Seattle Parks & Recreation

- healthy people healthy environment strong communities
- Property Owner
 - Development / Design Guidelines
 - Project oversight

SHAVA LAWSON, DIRECTOR OF FISCAL SERVICES

SEATTLE PARKS FOUNDATION

- Fundraising Support, Fiscal Sponsor

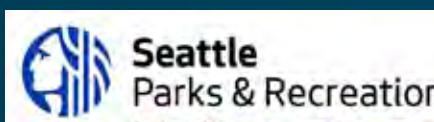

Environmental Works
COMMUNITY DESIGN CENTER

COMMUNITY CONNECTIONS & SPONSORS

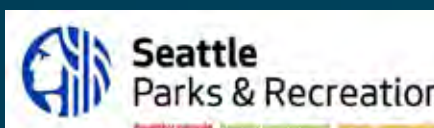

SUMMARY OF PROJECT GOALS



1. Develop a Community-led Concept Design of a Skatepark with Community Gathering Spaces.
2. Incorporate the latest Multi-Use, Public, All-Wheeled Park Design Standards.
3. Provide Equitable Access for All Ages and Abilities.
4. Integrate the Design into the Surrounding Community, Environment, Existing Park Features, and the Neighborhood.
5. Design the Skate Park for All to Enjoy for All Levels of Experience.

PROJECT SCHEDULE & PROCESS



- ➔ **SEPTEMBER:** Project Kick-off (Outreach, Background, Feasibility, Site Analysis)
- ➔ **JAN. 19th:** 1st Community Meeting (Identify community needs, **Design Game/Brainstorm**)
- ➔ **FEBRUARY:** Synthesize into 2-3 Alternatives & Review with City/Steering Committee
- ➔ **APRIL 20th:** 2nd Community Meeting (Review findings, Discuss **Design Alternatives**)
- ➔ **JUNE:** Generate Preferred Alternative & Review with City/Steering Committee
- ➔ **JULY 20th:** 3rd Community Meeting (Present **Preferred Alternative**)
- ➔ **AUGUST:** Finalize Preferred Alternative, Feasibility Report & Cost Estimate

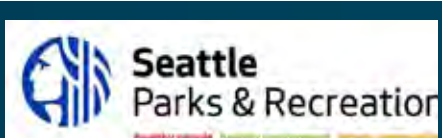

COMMUNICATION & OUTREACH



CHAMPS (Co-Chair): Danielle Jackson
dajackson@champsseattle.org - 206.518.7444



Parents for Skateparks

Parents for Skate Parks (Co-Chair): Scott Shinn
scott.shinn@parents4sk8parks.org



Seattle Parks and Recreation: Pam Kliment
Pamela.Kliment@seattle.gov



Design Consultant: Nic Morin & Peter Cromwell
nmorin@eworks.org / pcromwell@eworks.org



Evergreen Skateparks: Richie Conklin
richie@evergreenskateparks.com



Facebook: www.facebook.com/RBskatepark



Instagram: <https://www.instagram.com/@rbskatepark>

Website: <https://rbskatepark.org/>

NEIGHBORHOOD CONTEXT - LINK 2 LAKE

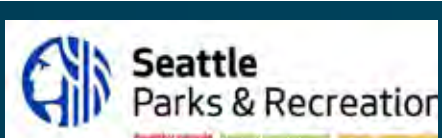
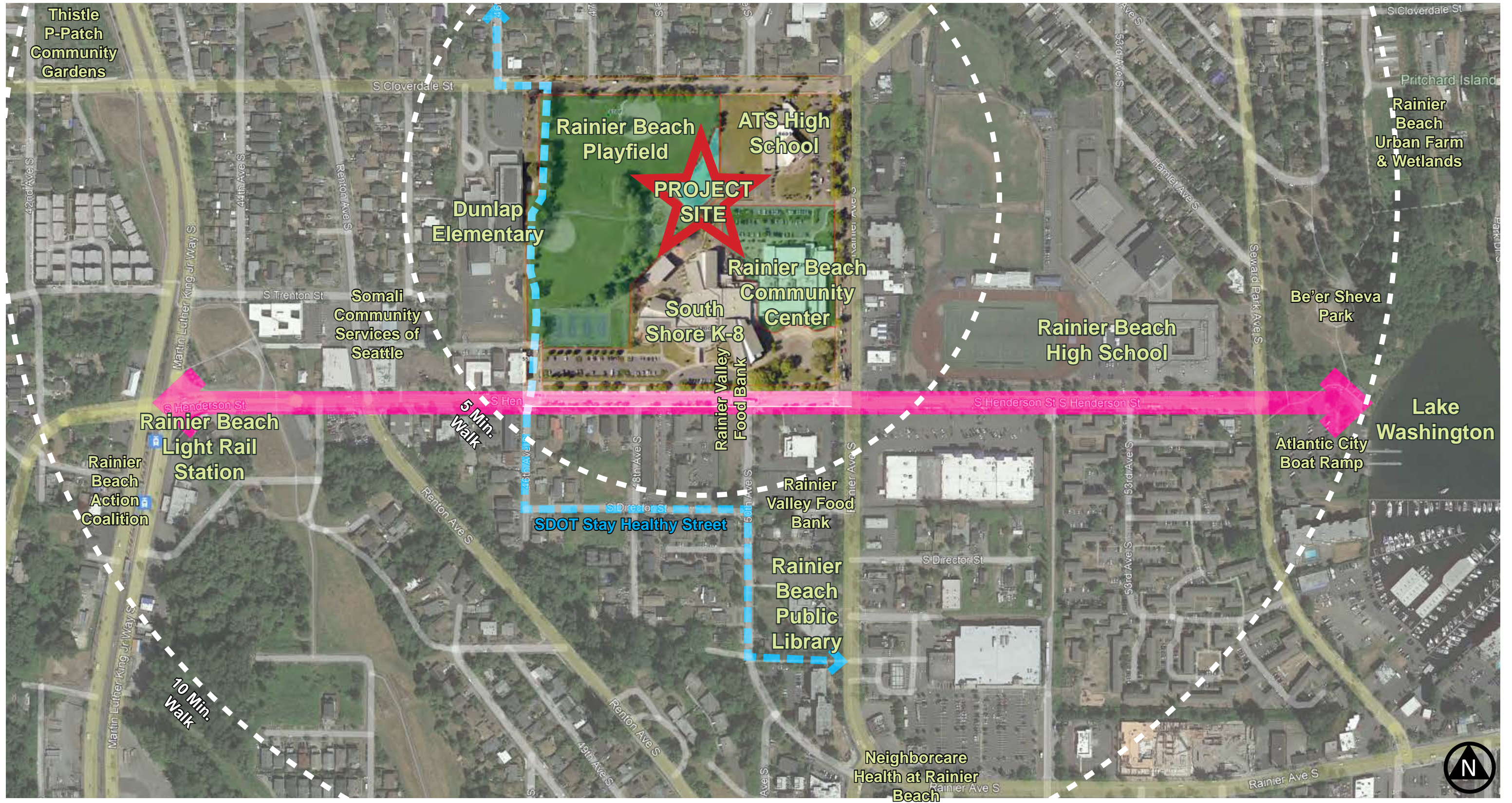

SITE CONTEXT

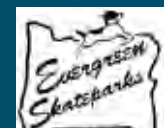
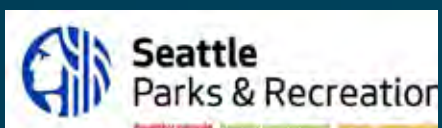
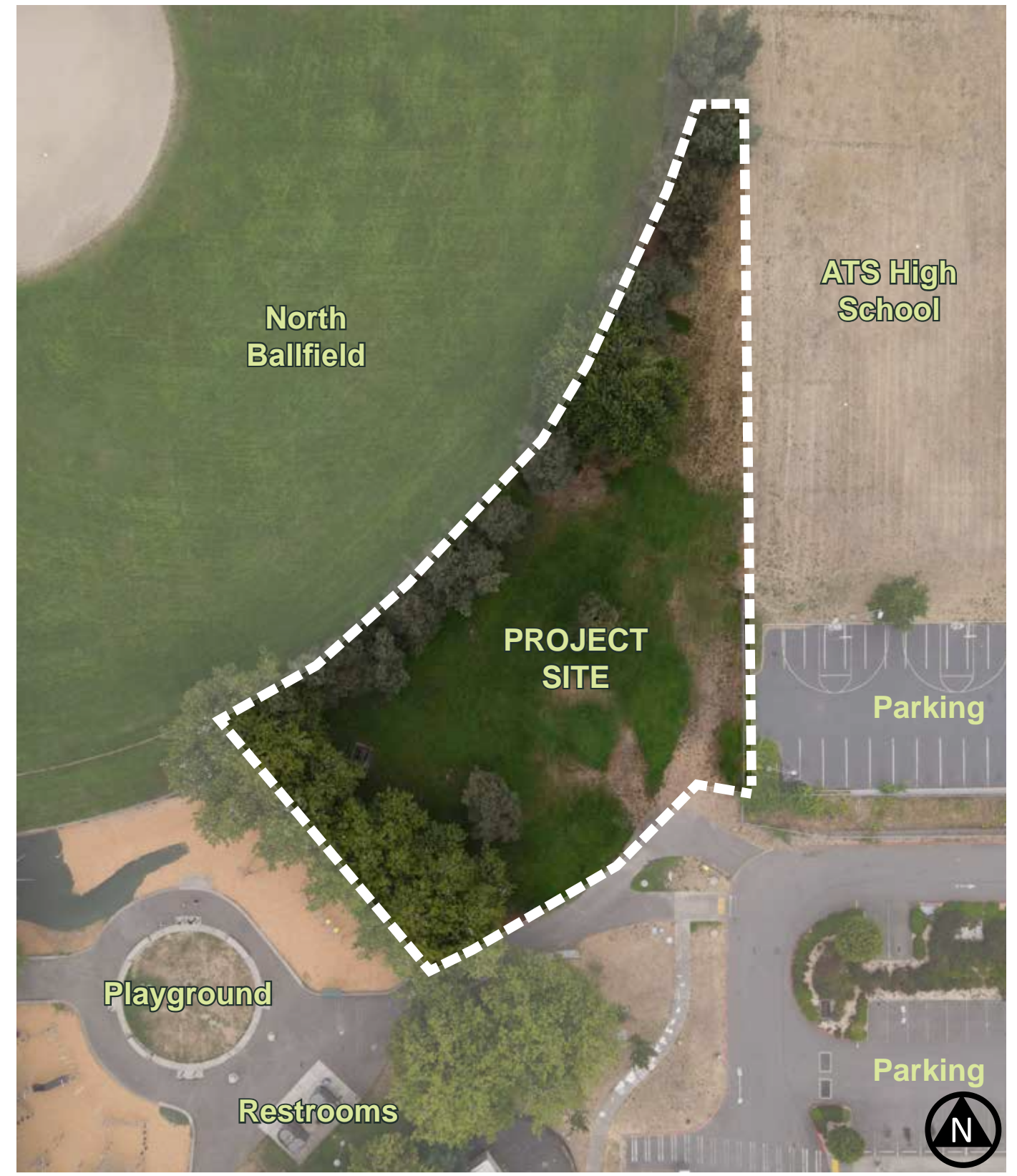
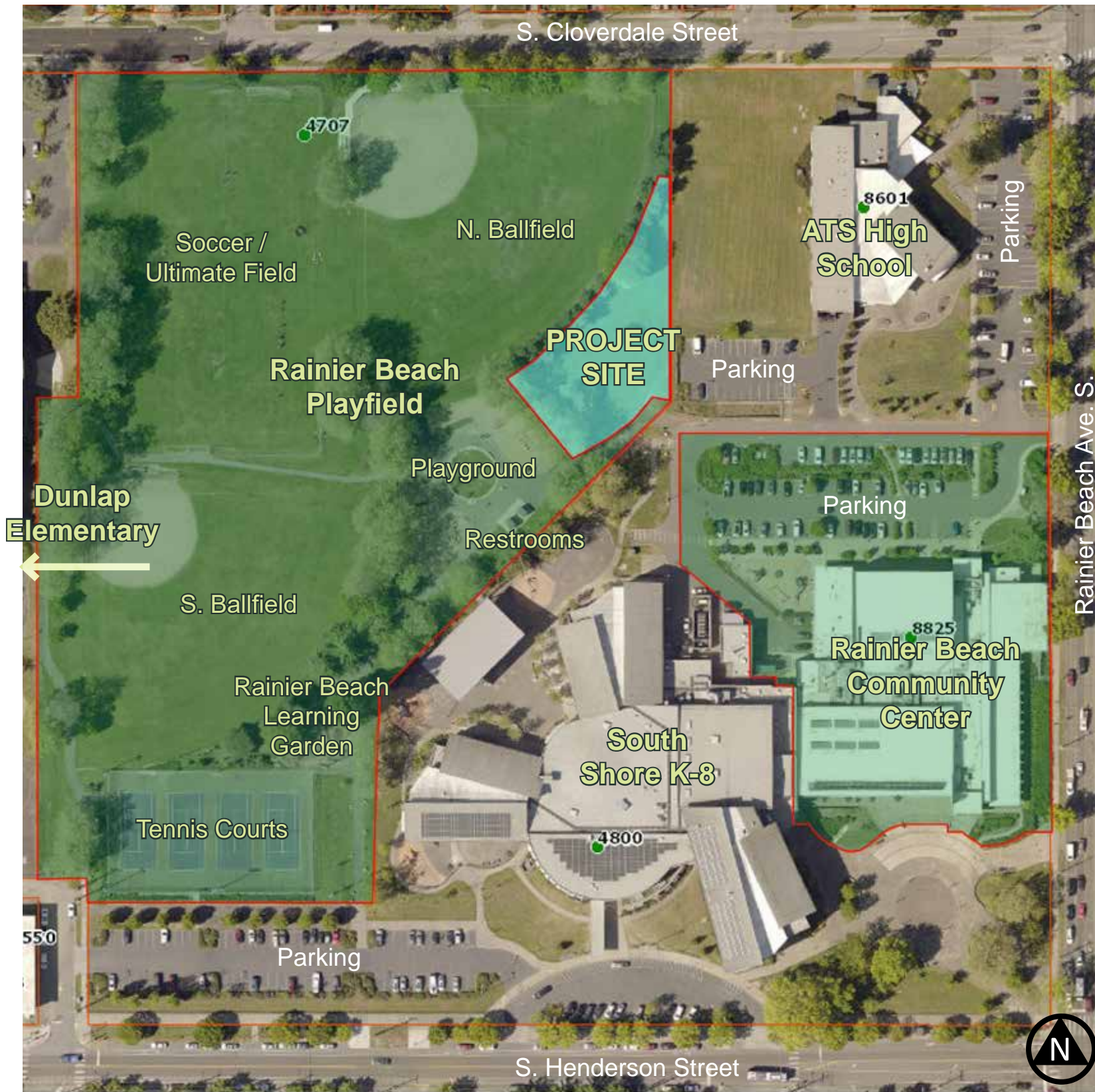

PARK CHARACTER

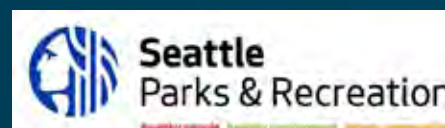

Environmental Works
COMMUNITY DESIGN CENTER

SEATTLE CITYWIDE SKATE PARK PLAN



Southwest										
Name	Status	Size	Square Feet	Year Built	Cost	Designer	Builder	%	%	Contact
Alki Beach										
Delridge Playfield		★	13,000	2011	\$940,000	Grindline	Grindline	50	50	✉
Hiawatha Playfield										
High Point Playfield or Myrtle Reservoir		★								✉
Jack Block Park			5,000	2001		Port of Seattle	Port of Seattle			✉
Marginal Way			6,000	2004	\$50,000	DIY	DIY			✉
River City		★	4,900	2010	\$166,000	Grindline	Grindline	100		✉
Roxhill Park			8,000	2013	\$600,000	California Skateparks	Grindline	10	90	✉
Schmitz Park Bridge				1990		Grindline	Grindline			✉
Seattle Vert Ramp			3,300	2012				100		✉
Northwest										
Name	Status	Size	Square Feet	Year Built	Cost	Designer	Builder	%	%	Contact
65th & Roosevelt										✉
All Together Skate			6,900	2014	\$35,000	Grindline	Seattle Skateboarding Community	10	90	✉
Ballard Bowl			4,000	2005	\$250,000	Airspeed	Grindline	90	10	✉
Ballard Corners Park			200	2009		Barker Landscape Architects	Nathan Arnold Masonry		100	✉
Crown Hill Park			1,500	2011	\$55,000	Pillar Design Studios	Grindline	70	30	✉
Ella Bailey Park			1,500	2006		Cathy Tuttle	Contractor		100	✉
Gas Works Park										✉
Kirke Park						Grindline			100	✉
Lower Woodland Park		★	17,000	2008	\$1,150,000	Wally Hollyday	TF Sahl Construction	40	60	✉
Sandel Playground										✉
SDOT Interurban Trail Project										✉

Central West										
Name	Status	Size	Square Feet	Year Built	Cost	Designer	Builder	%	%	Contact
Magnolia Playfield										✉
Myrtle Edwards Park										✉
Seattle Center 4			10,000	2009	\$2,900,000	Newline	Grindline	20	80	✉
Seattle Center 5		★	13,000	2020	\$2,500,000	Newline	Grindline	20	80	✉
Summit Slope			1,500	2010	\$12,000	Grindline	Contractor		100	✉

Central East										
Name	Status	Size	Square Feet	Year Built	Cost	Designer	Builder	%	%	Contact
Eastlake & Allison										✉
Garfield - Medgar Evers Pool										
Judkins Park			8,000	2013	\$600,000	Grindline	Grindline			✉
Miller Playfield										✉
Pratt Park										✉
Wall of Death				1993		Mowry & Colin Baden	Seattle City Light			✉

Northeast										
Name	Status	Size	Square Feet	Year Built	Cost	Designer	Builder	%	%	Contact
Dahl Playfield			4,000	2010	\$205,000	Newline	Hardcore Shotcrete	10	90	✉
Hubbard Homestead Park			10,000	2015		Newline	TF Sahl Construction		100	✉
Magnuson Park										
Maple Leaf Reservoir										✉
Roosevelt Reservoir										✉
Virgil Flaim Park			7,000	2017	\$855,000	Grindline	Grindline	40	60	✉

Southeast										
Name	Status	Size	Square Feet	Year Built	Cost	Designer	Builder	%	%	Contact
Benefit Park - Phase I			108	2012	\$17,701	Grindline	Grindline		100	✉
Benefit Park - Phase II			1,500	2013	\$41,000	Grindline	Seattle Conservation Corps, Grindline		100	✉
Brighton Playfield										
Genesee Playfield		★								
Jefferson Park		★	18,000	2011	\$1,010,000	Grindline	TF Sahl Construction	40	60	✉
John C. Little Park										
Rainier Beach Playfield		★								✉
Red Bull Skate Space			1,500	2014		Torey Pudwill	CJ Rench		100	✉

Skatepark Size

- Skatedot (25 - 1,500 sq ft)
- Skatespot (1,501 - 10,000 sq ft)
- ★ District Skatepark (10,001 - 30,000 sq ft)
- ▲ Regional Skatepark (30,000+ sq ft)

Skatepark Status

- Sited - This site has been approved for integrated skateable terrain or a skatepark by the City of Seattle. Contact information is for relevant government agency or agent.
- Active - One or more advocates are currently working to fund, design and build something here. Contact information is for lead advocate.
- Designed - An approved design exists for the skatepark or skate feature. Contact the lead advocate for current status!
- Built - Ready to Skate! Contact information is for local stewards.
- RIP/DOA - Dude, what happened to my skatepark? Skatepark demolished or skatepark campaign ended.

Skatepark Terrain

- Transitional Elements
- Streetscape Elements

Get Involved!

- ✉ Send email to primary contact, or [contact us](#) to become the primary contact

SEATTLE SKATE PARKS



Ballard Commons



Crown Hill



Dahl Playfield



Delridge



Hubbard Homestead



Jefferson



Judkins



Lower Woodland



River City

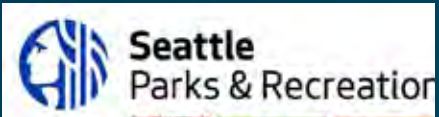
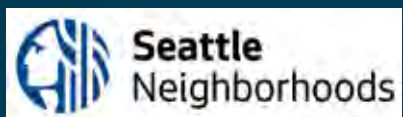

Environmental Works
COMMUNITY DESIGN CENTER

INSPIRATION - SKATE PARK ELEMENTS



INSPIRATION - PARK & ART ELEMENTS

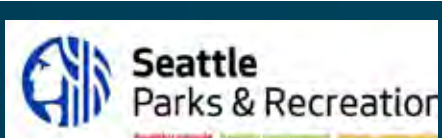

Environmental Works
COMMUNITY DESIGN CENTER

INSPIRATION - GATHERING AREAS & SHELTER

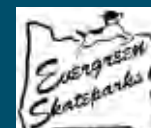
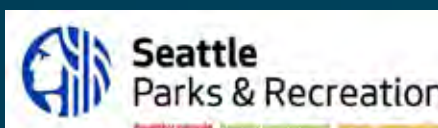

Environmental Works
COMMUNITY DESIGN CENTER

SITE ANALYSIS

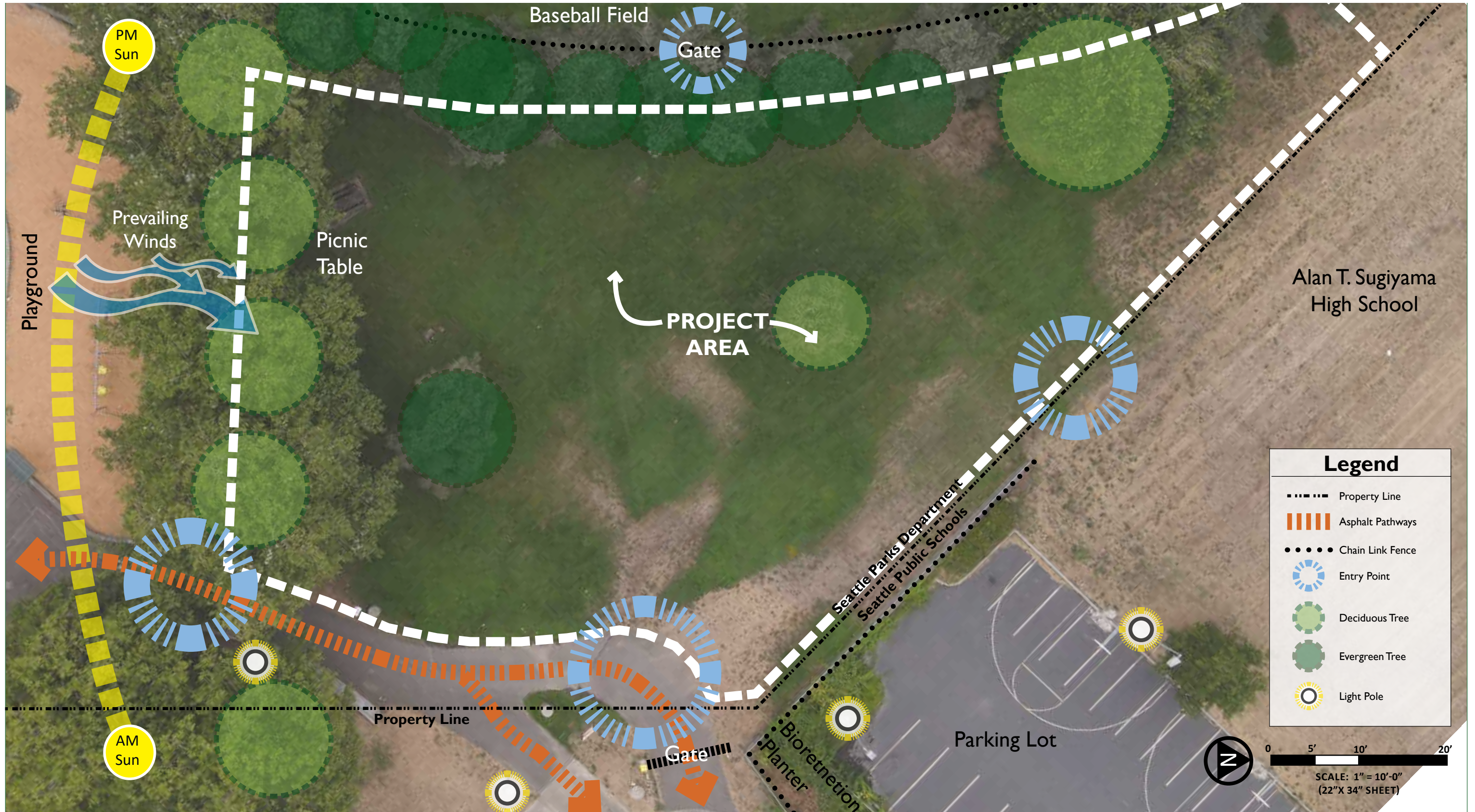

Legend	
	Property Line
	Asphalt Pathways
	Chain Link Fence
	Entry Point
	Deciduous Tree
	Evergreen Tree
	Light Pole

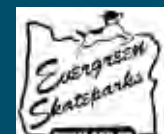
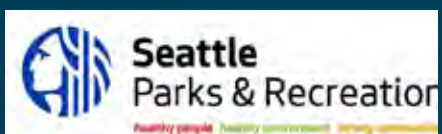
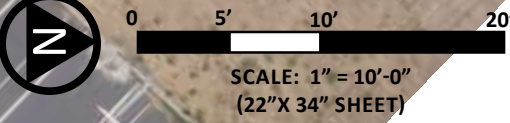

DESIGN GAME PIECES



Benches



Skate Path



Barbeque



Jumps and Transfers



Bioretention



Power for Events and Device Charging



Gaps



Covered Skatepark



Moonscape with Small Transition



Wayfinding



Iconic Art / Sculpture



Flow



Asphalt Walkway



Gathering Area



Picnic Tables



DESIGN GAME EXAMPLE



SUMMARY OF GROUND RULES



- Listen to everyone's viewpoint, common good is informed by all
- Everyone participates, together we know more
- Engage, not recruit
- Practice generosity & be civil
- Be positive & constructive; propose flexible solutions
- Be willing to change your mind when hearing new information
- Seek common ground
- Look for win-win solutions where all can succeed