

Bitter Lake Play Area

2-5 Composite Structure: 56" Critical Fall Height

- Elevated Play Components Accessible by Transfer (10)
 1. Marble Panel
 2. Bee and Flower Pilot Panel
 3. Belt Bridge
 4. Loop Pole
 5. SpyroSlide
 6. Arch Bridge
 7. Digifuse Periscope Panel
 8. Double Swirl Slide
 9. ABC Climber
 10. Corkscrew Climber
- Ground Level Play Components (3)
 1. Table Panel
 2. Garden Hunt Panel
 3. Storefront Panel

2-5 Freestanding Play Components:

1. We-Go-Round (*2-12 ages*) – 40" CFH
2. Full Bucket Seat – 96" CFH

5-12 TreeTops Composite Structure: 96" Critical Fall Height

- Elevated Play Components Accessible by Transfer (5)
 1. Belt Climber
 2. Pod Climber
 3. Double Slide
 4. Net/Swiggle Knot Climber
 5. Marble panel
- Ground Level Play Components (5)
 1. Highwire Climber
 2. Lolliladder
 3. Leaf Panel
 4. Ring-A-Bell Panel
 5. Ring Pull

5-12 Freestanding Play Components:

1. ZipKrooz – 105" CFH
2. Friendship Swing – 96" CFH
3. Belt Seats (2) – 96" CFH
4. Jump Hang – 111" CFH
5. Parallel Bars – 42" CFH
6. Bongo & Sound Chimes Reach Panel

IT IS THE MANUFACTURERS OPINION AND INTENT THAT THE USE AND LAYOUT OF THESE COMPONENTS CONFORM WITH THE AMERICAN SOCIETY FOR TESTING AND MATERIALS (ASTM) STANDARD ASTM F1487

THIS PLAY AREA & PLAY EQUIPMENT IS DESIGNED FOR AGES 2-12 YEARS UNLESS OTHERWISE NOTED ON PLAN.

IT IS THE MANUFACTURERS OPINION THAT THIS PLAY AREA DOES CONFORM TO THE A.D.A. ACCESSIBILITY STANDARDS, ASSUMING AN ACCESSIBLE PROTECTIVE SURFACING IS PROVIDED, AS INDICATED, OR WITHIN THE ENTIRE USE ZONE.

THIS CONCEPTUAL PLAN WAS BASED ON INFORMATION AVAILABLE TO US. PRIOR TO CONSTRUCTION, DETAILED SITE INFORMATION INCLUDING SITE DIMENSIONS, TOPOGRAPHY, EXISTING UTILITIES, SOIL CONDITIONS, AND DRAINAGE SOLUTIONS SHOULD BE OBTAINED, EVALUATED, & UTILIZED IN THE FINAL DESIGN. PLEASE VERIFY ALL DIMENSIONS OF PLAY AREA, SIZE, ORIENTATION, AND LOCATION OF ALL EXISTING UTILITIES, EQUIPMENT, AND SITE FURNISHINGS PRIOR TO ORDERING. SLIDES SHOULD NOT FACE THE HOT AFTERNOON SUN.

CHOOSE A PROTECTIVE SURFACING MATERIAL THAT HAS A CRITICAL HEIGHT VALUE TO MEET THE MAXIMUM FALL HEIGHT FOR THE EQUIPMENT (REF. ASTM F1487 STANDARD CONSUMER SAFETY PERFORMANCE SPECIFICATION FOR PLAYGROUND EQUIPMENT FOR PUBLIC USE, SECTION 8 CURRENT REVISION). THE SUBSURFACE MUST BE WELL DRAINED. IF THE SOIL DOES NOT DRAIN NATURALLY IT MUST BE TILED OR SLOPED 1/8" TO 1/4" PER FOOT TO A STORM SEWER OR A "FRENCH DRAIN".

ACCESSIBLE/PROTECTIVE SURFACING TO BE A COMBINATION OF UNITARY AND LOOSE FILL MATERIALS.

DESIGNED BY:
CM

COPYRIGHT: 10/12/2021
LANDSCAPE STRUCTURES, INC.
601 7th STREET SOUTH - P.O. BOX 198
DELANO, MINNESOTA 55328
PH: 1-800-328-0035 FAX: 1-763-972-6091

Date	Previous Drawing #	Initials

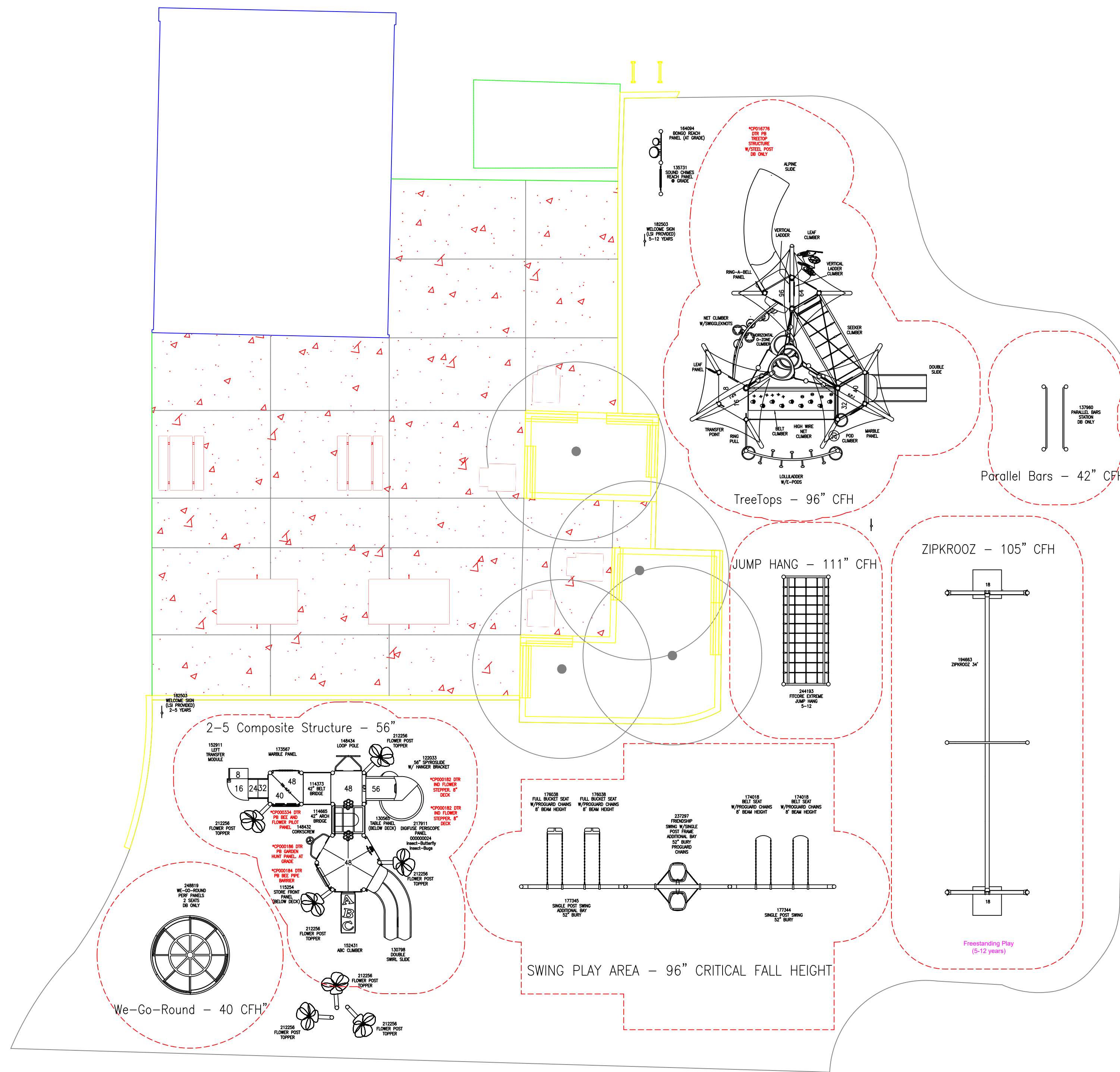

PlayBooster®
(5-12 years) (2)
Max Fall Height: 111 inches

5-12 EQUIPMENT

TOTAL ELEVATED PLAY COMPONENTS	10		
TOTAL ELEVATED COMPONENTS ACCESSIBLE BY RAMP	0	REQUIRED	0
TOTAL ELEVATED COMPONENTS ACCESSIBLE BY TRANSFER	5	REQUIRED	5
TOTAL ACCESSIBLE GROUND LEVEL COMPONENTS SHOWN	9	REQUIRED	3
TOTAL DIFFERENT TYPES OF GROUND LEVEL COMPONENTS	8	REQUIRED	8

Freestanding Play
(2-12 years)
Max Fall Height: 96 inches

SWING PLAY EQUIPMENT

TOTAL ELEVATED PLAY COMPONENTS	0		
TOTAL ELEVATED COMPONENTS ACCESSIBLE BY RAMP	0	REQUIRED	0
TOTAL ELEVATED COMPONENTS ACCESSIBLE BY TRANSFER	0	REQUIRED	0
TOTAL ACCESSIBLE GROUND LEVEL COMPONENTS SHOWN	5	REQUIRED	0
TOTAL DIFFERENT TYPES OF GROUND LEVEL COMPONENTS	1	REQUIRED	1

PlayBooster®
(2-5 years)
Max Fall Height: 56 inches

2-5 EQUIPMENT

TOTAL ELEVATED PLAY COMPONENTS	10		
TOTAL ELEVATED COMPONENTS ACCESSIBLE BY RAMP	0	REQUIRED	0
TOTAL ELEVATED COMPONENTS ACCESSIBLE BY TRANSFER	10	REQUIRED	5
TOTAL ACCESSIBLE GROUND LEVEL COMPONENTS SHOWN	4	REQUIRED	3
TOTAL DIFFERENT TYPES OF GROUND LEVEL COMPONENTS	4	REQUIRED	4

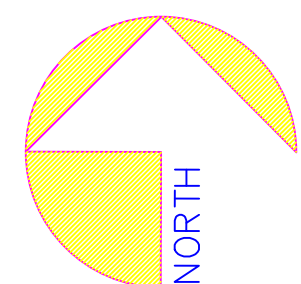
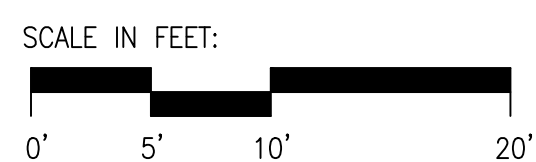

Bitter Lake Playfield

Seattle, WA

PlayCreation, Inc
Landscape Structures
John Mullan

SYSTEM TYPE:
PlayBooster & Freestanding

DRAWING #:
1762401-2-6-2





Welcome



















